

# CREW REAR PREMIUM DOOR KIT



P/N 2883437, 2884276

## BEFORE YOU BEGIN

Read these instructions and check to be sure all parts and tools are accounted for. Please retain these installation instructions for future reference and parts ordering information.

## REQUIRED, SOLD SEPARATELY

The CHASSIS-SIDE hinges required to install these REAR doors are not included in this kit. They are included in FRONT Door Kit PN 2882561, 2882562, 2884275, 2884338 (or equivalent), and are also available in service kit 2207708.

See section **INSTALLATION INSTRUCTIONS**, Step 3, for detail.

## KIT CONTENTS

This Kit includes:

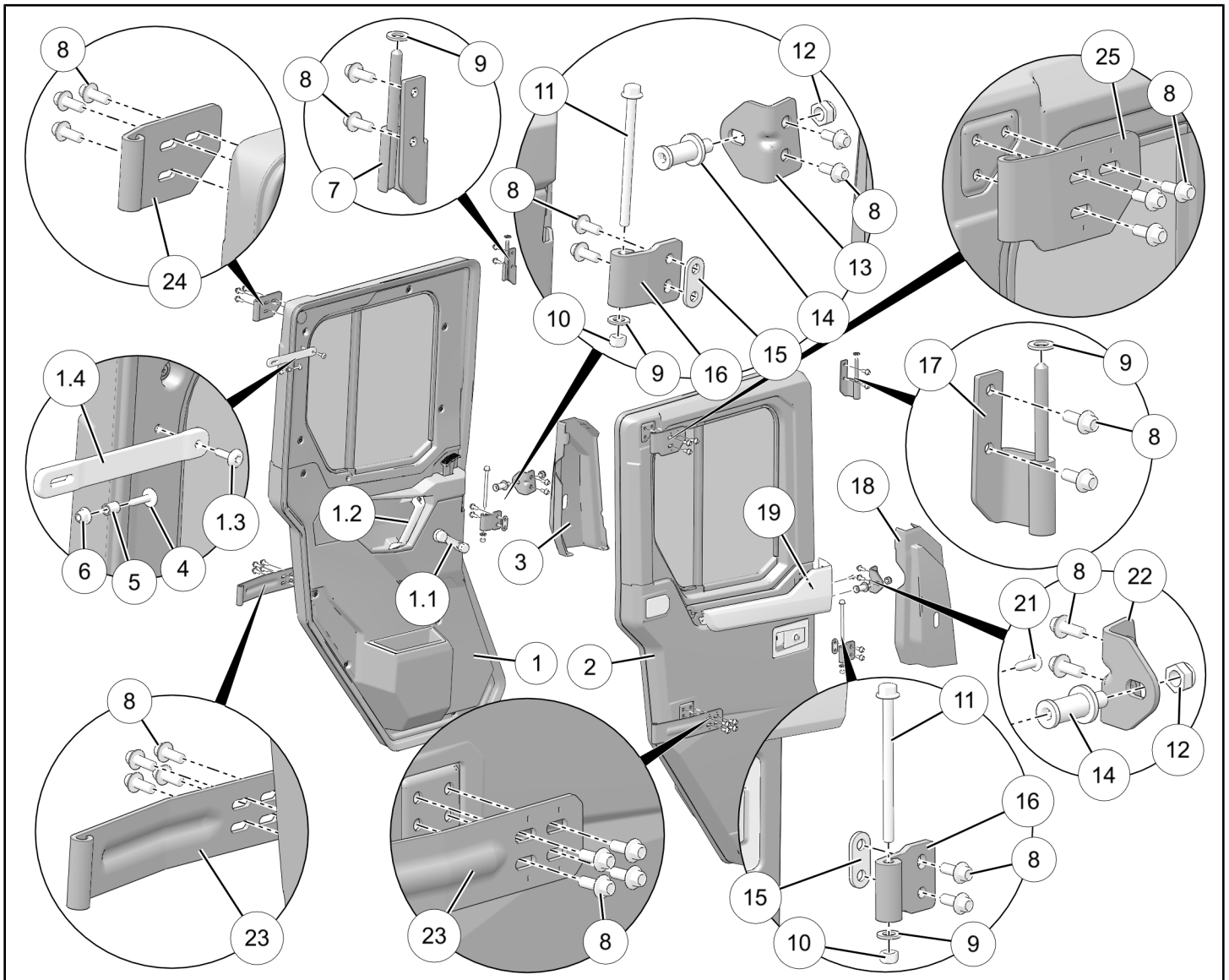

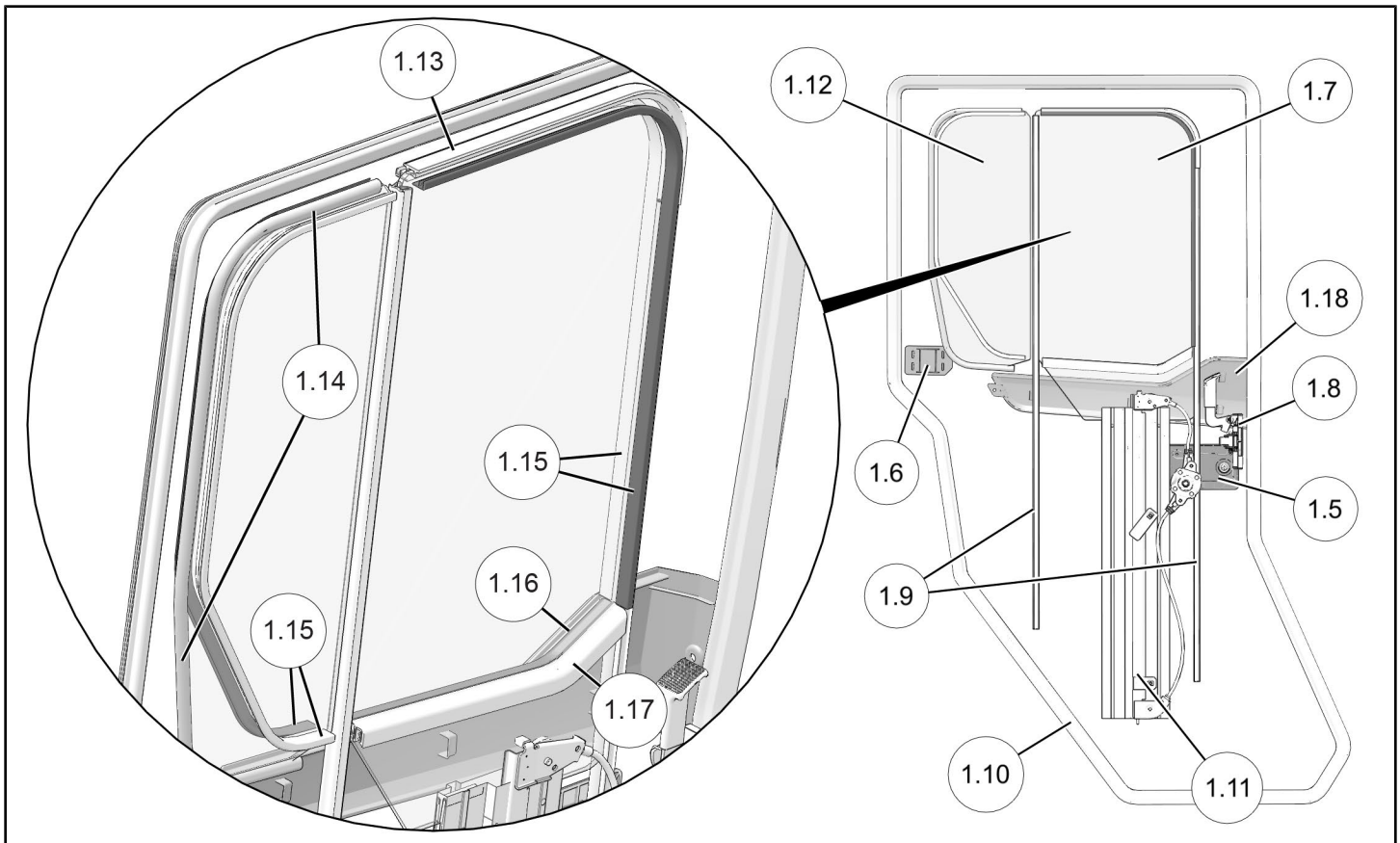

REF	QTY	PART DESCRIPTION	PART NUMBER	INCLUDED IN SERVICE KIT
1	1	Door Assembly, LH (includes parts 1.1–1.18 except as noted below)	-	-
1.1	1	- Crank, Window	-	2207712**
1.2	1	- Handle, Grab, LH	-	2207851**
1.3	1	- Screw, Torx® Truss Head - M6 X 1.0 X 25	7519650	2205280**
1.4	1	- Strap, Limiter	-	2205280**
1.5	1	- Latch Assembly, Exterior	-	2207716*
1.6	1	- Cover, Hinge	-	2207853**
1.7	1	- Glass, Moveable (Front)	-	2207855*
1.8	1	- Latch Assembly, Interior, LH	-	2207715**
1.9	2	- Seal, Moveable Glass, Front/Rear	-	2207852*
1.10	1	- Seal, Door, Full Perimeter	-	2207852*
1.11	1	- Regulator Assembly, LH	-	2207856*
1.12	1	- Glass, Fixed (Rear)	-	2207854*
1.13	1	- Seal, Moveable Glass, Upper	-	2207852*
1.14	1	- Seal, Fixed Glass, Upper/Rear/Lower	-	2207852*
1.15	4	- Seal	-	2207852*
1.16	1	- Seal, Moveable Glass, Lower	-	2207852*
1.17	1	- Seal, Moveable Glass, Lower	-	2207852*

REF	QTY	PART DESCRIPTION	PART NUMBER	INCLUDED IN SERVICE KIT
1.18	1 1	- Panel, Accent, LH (Kit PN 2884276-133 only) - Panel, Accent, LH (Kit PN 2884276-453 only)	5454768-133 5454768-453	- -
2	1	Door Assembly, RH (includes 2.x parts identified below; all <b>other</b> parts same as those identified as 1.x above)	-	-
2.2	1	- Handle, Grab, RH (not shown)	-	2207851**
2.8	1	- Latch Assembly, Interior, RH (not shown)	-	2207715**
2.11	1	- Regulator Assembly, RH (not shown)	-	2207857*
2.18	1 1	- Panel, Accent, RH (Kit PN 2884276-133 only) (not shown) - Panel, Accent, RH (Kit PN 2884276-453 only) (not shown)	5454769-133 5454769-453	- -
3	1	Cover, B-Pillar, LH	5454372-070	-
4	2	Screw, Torx® Truss Head - M6 X 1.0 X 25	7519650	2205280**
5	2	Spacer	5139193	2205280**
6	2	Nut, Hex Flange, Locking - M6 X 1.0	7547339	2205280**
7	1	Hinge, Chassis-Side, Upper LH (front door)	-	2207849**
8	26	Screw, Hex Flange - M8 X 1.25 X 20	7519936	-
9	4	Washer, Nylon - 10.25 X 19.0 X 2.0	5439712	2207849**
10	2	Nut, Hex, Locking - M8 X 1.25	7547480	2207849**
11	2	Screw, Hex Flange - M8 X 1.25 X 120	7519818	2207849**
12	2	Nut, Hex - M12 X 1.75	7540000	2207850**
13	1	Bracket, Striker, LH	-	2207850**
14	2	Pin, Striker	-	2207850**
15	2	Spacer	5265312	2207849**
16	2	Hinge, Chassis-Side, Lower (front door)	-	2207849**
17	1	Hinge, Chassis-Side, Upper RH (front door)	-	2207849**
18	1	Cover, B-Pillar, RH	5454373-070	-
19	1	Panel, Accent, RH (Kit PN 2883437 only)	5454769-070	-
20	1	Panel, Accent, LH (Kit PN 2883437 only) (not shown)	5454768-070	-
21	2	Screw, Torx® Truss Head, High/Low - #14 X 3/4	7519045	-
22	1	Bracket, Striker, RH	-	2207850**
23	2	Hinge, Door-Side, Lower	-	2207708**
24	1	Hinge, Door-Side, Upper LH	-	2207708**
25	1	Hinge, Door-Side, Upper RH	-	2207708**

\* Service kit contains parts and hardware required for ONE side of vehicle.

\*\* Service kit contains parts and hardware required for BOTH sides of vehicle.

## TOOLS REQUIRED

- Safety Glasses
- Pliers, Push Pin Rivet
- Screwdriver Set, Torx®
- Socket Set, Hex Bit, Metric
- Socket Set, Metric
- Socket Set, Torx® Bit
- Torque Wrench
- Wrench Set, Metric

## CONSUMABLES REQUIRED

- Gloves, Chemical Resistant
- Grease, Polaris All Season (or equivalent)

## IMPORTANT

Your Crew Rear Premium Door Kit is exclusively designed for your vehicle. Please read the installation instructions thoroughly before beginning. Installation is easier if the vehicle is clean and free of debris. For your safety, and to ensure a satisfactory installation, perform all installation steps correctly in the sequence shown.

## INSTALLATION INSTRUCTIONS

### IMPORTANT

Polaris recommends completing Steps 1–3 of this Crew Rear Door Kit **PRIOR TO** installing the corresponding Front Door Kit. Installation of FRONT door hinges on **crew** vehicles is different from installation on **non-crew** vehicles.

### NOTE

Polaris recommends two people install this kit.

1. Shift vehicle transmission into “PARK”. Turn ignition switch to “OFF” position and remove key.
2. Open vehicle bed.
3. Install **CHASSIS-SIDE** hinges for **FRONT** doors.

### IMPORTANT

The chassis-side hinges included in this Crew REAR Door Kit will be used for the FRONT doors. Conversely, the chassis-side hinges included in the FRONT Door Kit (sold separately) will be used for the Crew REAR doors.

Swapping hinges is required to accommodate different hinge mounting structure in crew and non-crew vehicles.

As a result, do NOT follow hinge installation instructions included in the Front Door Kit. Follow these instructions instead.

- a. Identify upper **LH** chassis-side hinge ⑦. Notice differences from upper **RH** chassis-side hinge ⑰.

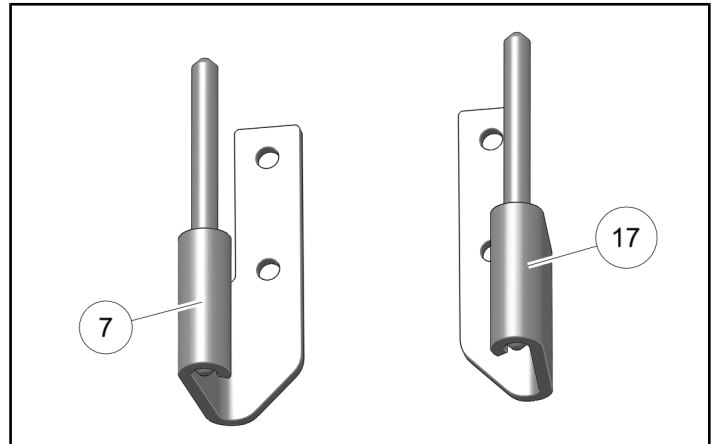

- b. Install upper LH chassis-side hinge ⑦ to B-pillar fitting using two screws ⑧. Partially tighten screws (but still loose enough to allow hinge adjustment). Install nylon washer ⑨ to hinge pin.

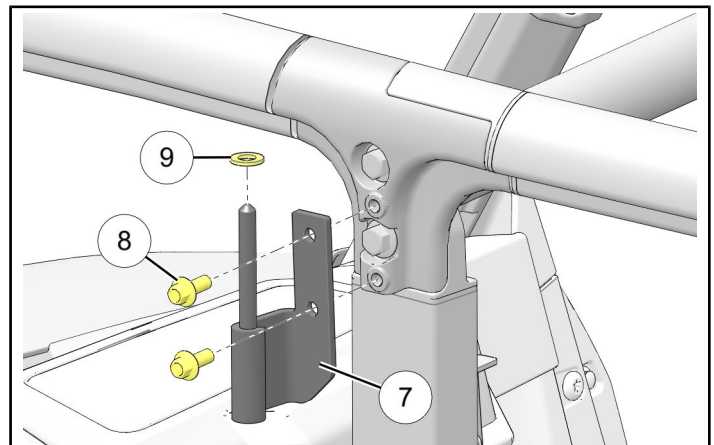

- c. Remove two screws (A) from top of existing B-pillar cover. Retain screws.

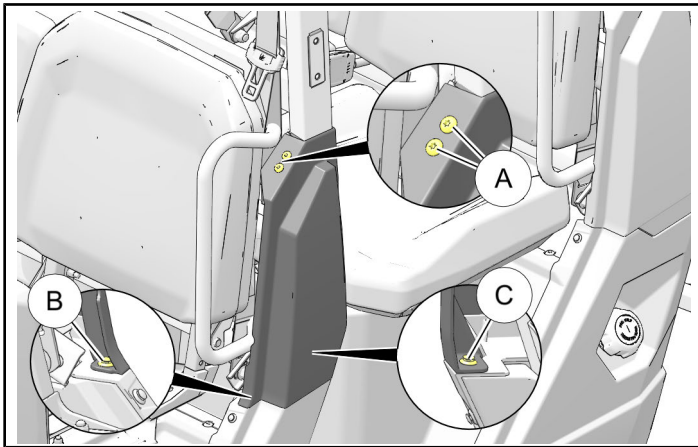

- d. Remove two push pin rivets from bottom interior of B-pillar cover (front rivet (B) and rear rivet (C)), then remove cover. Retain rivets.
- e. Install new LH B-pillar cover (3) using retained screws (A), and push-pin rivets (B) and (C).

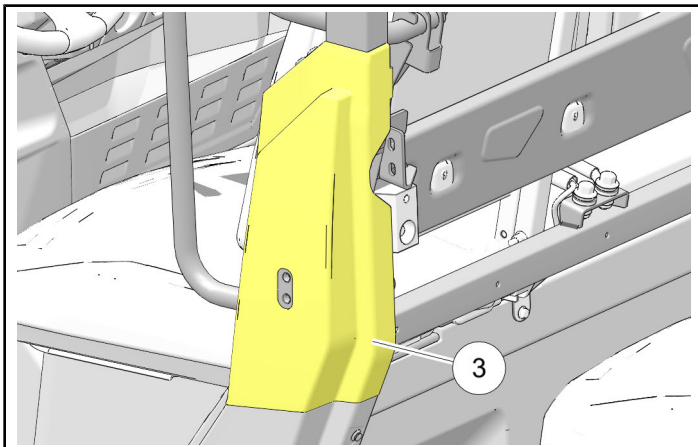

- f. Install spacer (15) and lower chassis-side hinge (16) to B-pillar fitting using two screws (8). Tighten screws.

**NOTE**  
Lower chassis-side hinge (16) is identical for LH/RH.

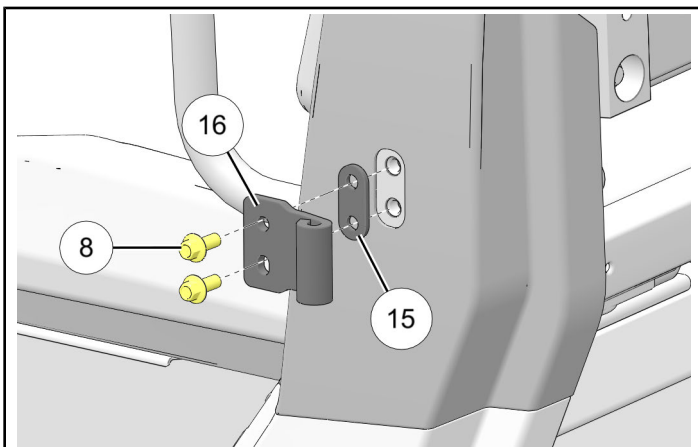

- g. Grease screw (11) and pin on upper chassis-side hinge (7) with Polaris All Season Grease (or equivalent).

**WARNING**  
Follow all chemical manufacturer instructions and safety precautions. Failure to comply may result in severe injury or death.

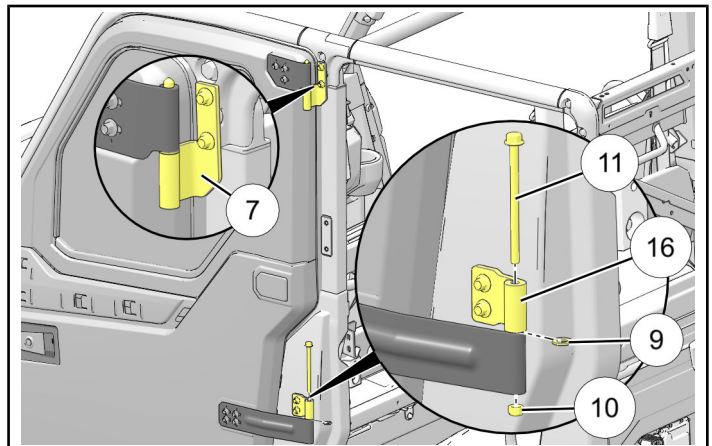

- h. Hang front door assembly on upper chassis-side hinge (7). Align door with lower chassis-side hinge (16), insert nylon washer (9) between chassis and door-side hinges as shown, then install screw (11).

Secure with nut (10). Torque to specification.

**TORQUE**  
8 ft. lbs. (11 Nm) ± 20%

- i. Continue with front door installation per instructions included with Front Door Kit.

When door adjustment is complete, ensure all chassis-side and door-side hinge screws are torqued to specification.

**TORQUE**  
17 ft. lbs. (23 Nm) ± 10%

- j. Repeat Steps a. through i. for RH front door assembly using RH parts as identified in section **KIT CONTENTS**.



4. Install **DOOR-SIDE** hinges to **REAR** doors.

- a. Identify upper **LH** door-side hinge ②④. Notice differences from upper **RH** door-side hinge ②⑤.

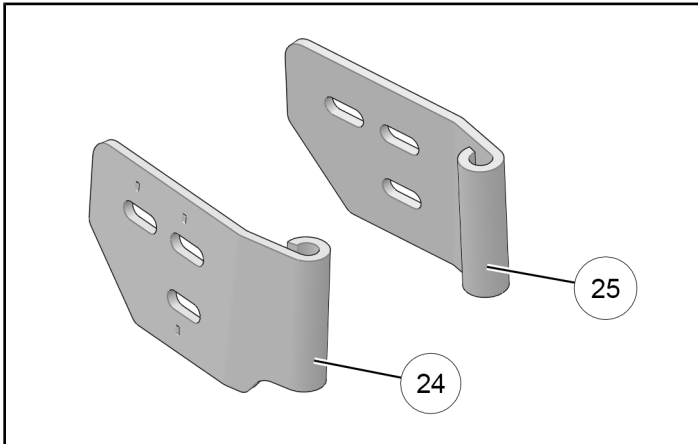

- b. Install upper LH door-side hinge ②④ to LH rear door ① using three screws ⑧. Partially tighten screws (but still loose enough to allow hinge adjustment).

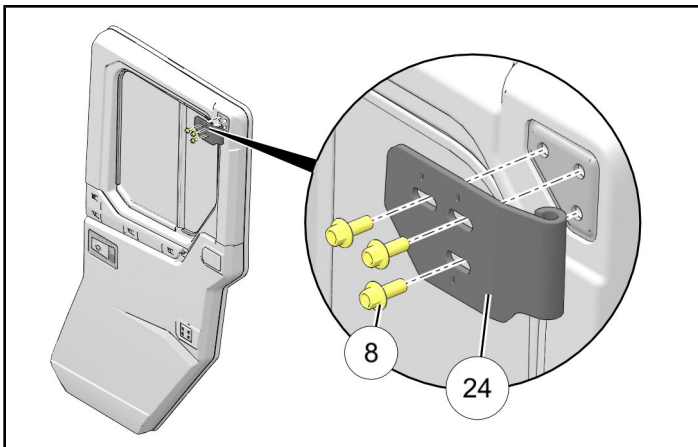

- c. Install lower door-side hinge ②③ to LH rear door ① using four screws ⑧. Partially tighten screws (but still loose enough to allow hinge adjustment).

**NOTE**  
Lower door-side hinge ②③ is identical for LH/RH.

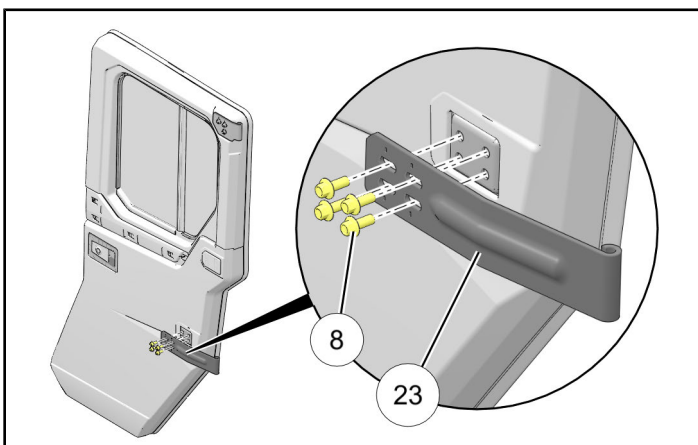

5. Install **CHASSIS-SIDE** hinges for **REAR** doors.

- a. Locate the following items included in the corresponding **FRONT** Door Kit (sold separately):

- Upper LH chassis-side hinge ②⑩ and RH chassis-side hinge ②⑪

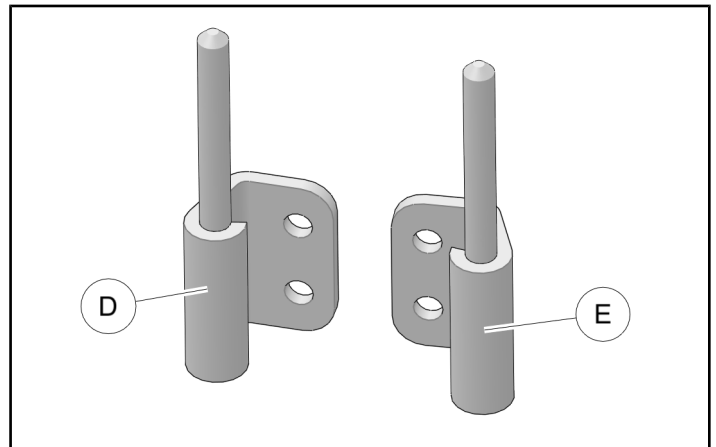

- Lower LH chassis-side hinge ②⑫ and RH chassis-side hinge ②⑬

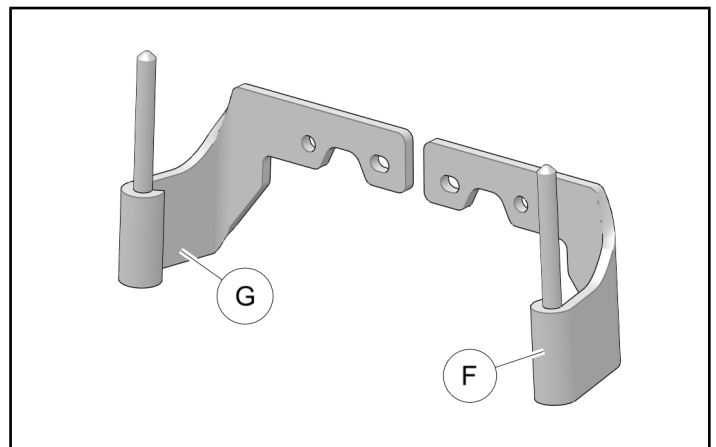

- M8 X 1.25 X 20 hex flange screws ②⑭ (quantity 8)

- Nut plates ②⑮ (quantity 2)

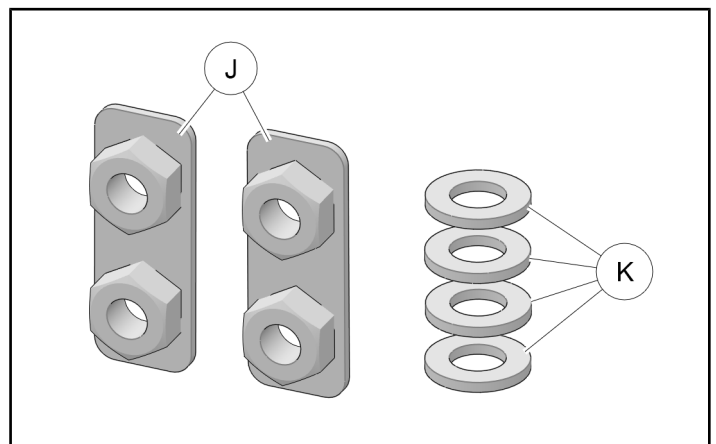

- Nylon washers ②⑯ (quantity 4)

- b. Raise vehicle bed.
- c. Install lower LH chassis-side hinge **F** to chassis fitting using two screws **H**. Tighten screws. Install nylon washer **K** to hinge pin.

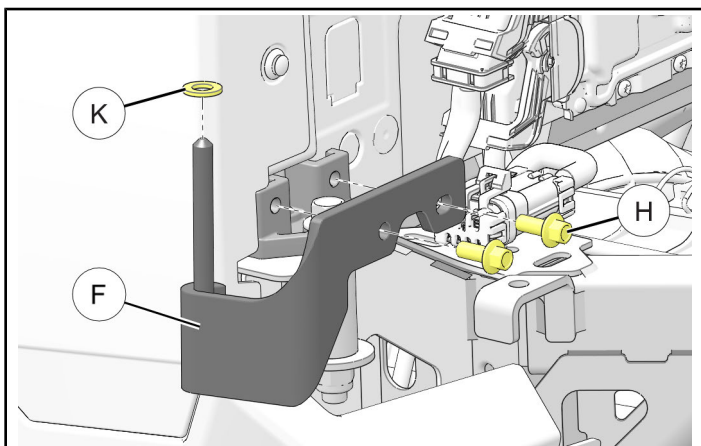

- d. Install upper LH chassis-side hinge **D** to C-pillar fitting using two screws **H** and nut plate **J**. Partially tighten screws (but still loose enough to allow hinge adjustment). Install nylon washer **K** to hinge pin.

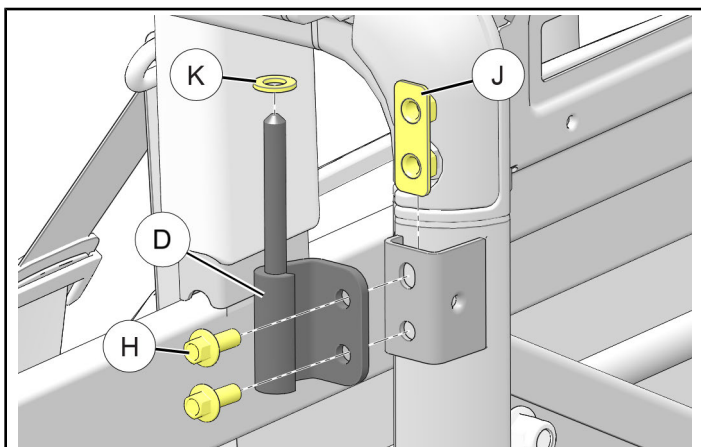

**⚠ WARNING**  
Follow all chemical manufacturer instructions and safety precautions. Failure to comply may result in severe injury or death.

- 6. Grease pins on upper and lower chassis-side hinges **D** and **F** using Polaris All Season Grease (or equivalent).

7. Install and adjust door.

- a. Hang LH door assembly **1** on lower chassis-side hinge **F** first, then upper chassis-side hinge **D**.

**NOTE**  
Lower hinge pin is longer than upper hinge pin to aid door installation.

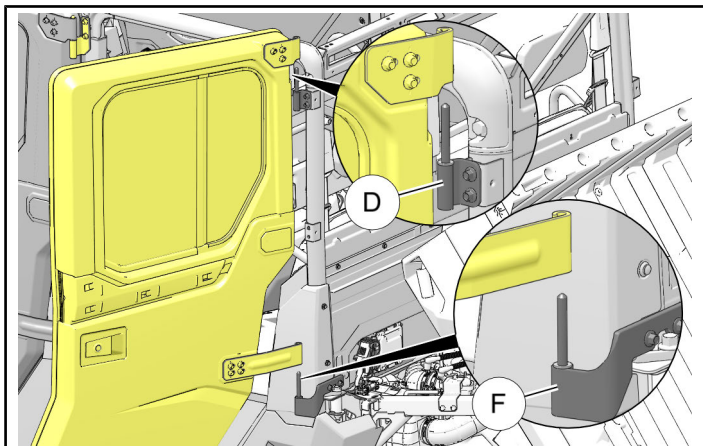

- b. Close and push door inwards while centering door in ROPS/chassis opening, then tighten all screws **H** and **8**.

**TIP**  
Have one person hold and center the door, and a second person tighten the screws.

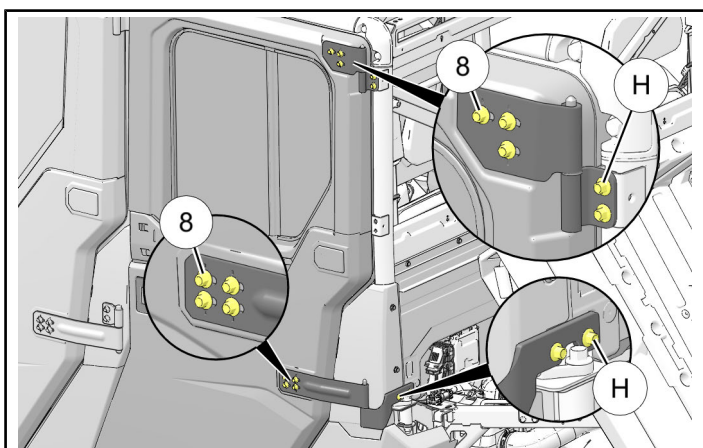

- c. Open and close door to ensure door is still centered in ROPS/chassis opening. Adjust as required.
- d. Torque all door-side and chassis-side hinge screws **H** and **8** to specification.

**TORQUE**  
17 ft. lbs. (23 Nm) ± 10%

- e. Lower vehicle bed.

8. Install and adjust striker.

- a. Identify **LH** striker bracket ⑬. Notice differences from **RH** striker bracket ⑳.

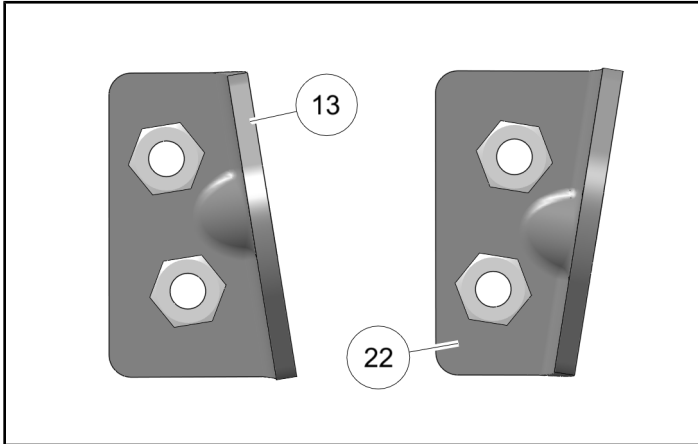

- b. Install striker pin ⑭ to LH striker bracket ⑬ using nut ⑫. Center pin in slot, then tighten nut. Final adjustment will occur later.

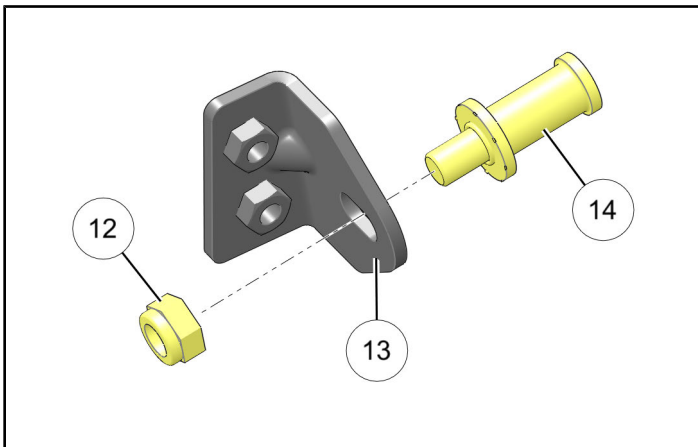

- c. Install LH striker bracket ⑬ to chassis using two screws ⑧. Center bracket in slots, then tighten screws. Final adjustment will occur later.

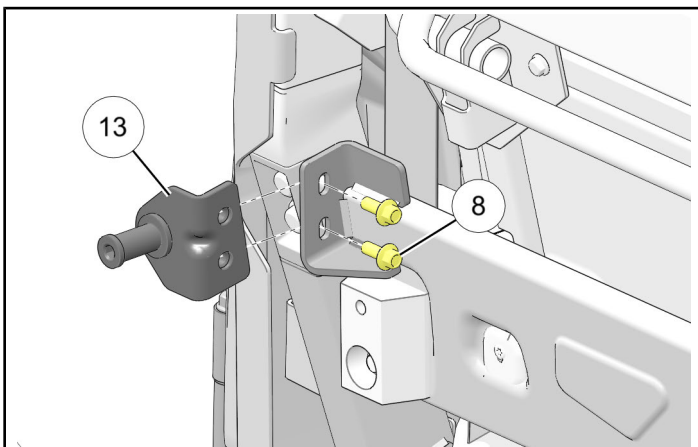

- d. Open door latch (to ensure upper and lower pawls ① are fully opened), then slowly close door and observe striker pin ⑭ entering latch assembly.

Adjust striker pin ⑭ and/or striker bracket ⑬ to achieve the following:

- i. **HEIGHT** ①: Pin ⑭ should be centered vertically between upper and lower pawls. To adjust, loosen two screws ⑧, slide striker bracket ⑬ up or down as required, then retighten screws.
- ii. **DEPTH** ②: As required to achieve desired seal compression and door fairing. To adjust, loosen nut ⑫, slide striker pin ⑭ inboard or outboard as required, then retighten nut.

Ensure depth adjustment is made with door at **FULL** closure as shown (second “click”), not at partial closure (first “click”).

**NOTE**

Nut can be accessed by reaching up from below striker bracket.  
Bracket shown partially transparent for clarity.

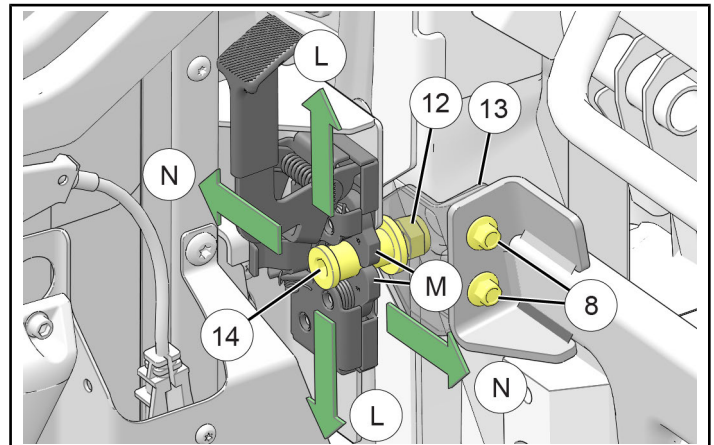

- e. Torque striker screws ⑧ to specification.

**TORQUE**

17 ft. lbs. (23 Nm) ± 10%

- f. Torque striker nut ⑫ to specification.

**TORQUE**

30 ft. lbs. (41 Nm) ± 20%



9. Install limiter strap retaining post to ROPS diagonal support using screw ④, spacer ⑤, and nut ⑥. Torque to specification, then secure strap ⑰ to post.

### TORQUE

7 ft. lbs. (9 Nm) ± 10%

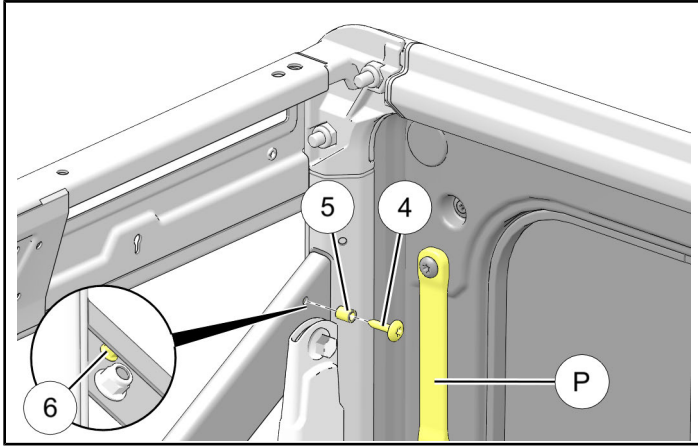

10. If LH accent panel ⑳ is pre-installed from factory, then proceed to Step 11.

Otherwise, install LH accent panel ⑳ to door by sliding receptacles in panel over tabs in door. Secure using screw ㉑. Torque to specification.

### TORQUE

18 in. lbs. (2.0 Nm) ± 20%

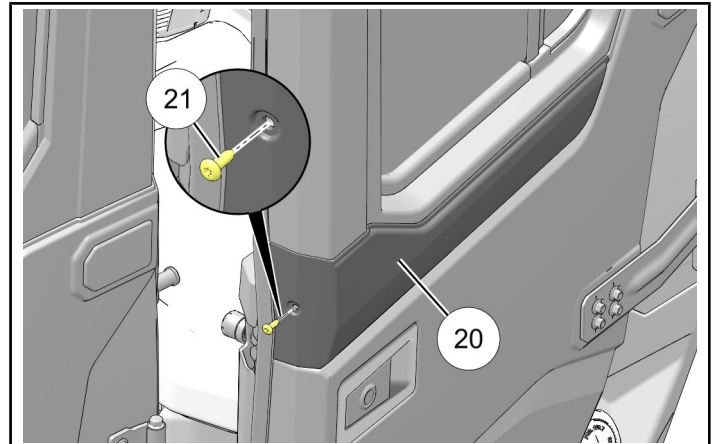

11. Repeat Steps 4–10 for RH door assembly ② using RH parts as identified in section **KIT CONTENTS**.

## FEEDBACK FORM

A feedback form has been created for the installer to provide any comments, questions or concerns about the installation instructions. The form is viewable on mobile devices by scanning the QR code or by clicking [HERE](#) if viewing on a PC.

