

XT PRO LODGE BY OTTER® KIT

POLARIS

ENGINEERED PARTS
ACCESSORIES & APPAREL

P/N 2882199

BEFORE YOU BEGIN

Read these instructions and check to be sure all parts and tools are accounted for. Please retain these installation instructions for future reference and parts ordering information.

KIT CONTENTS

This Kit includes:

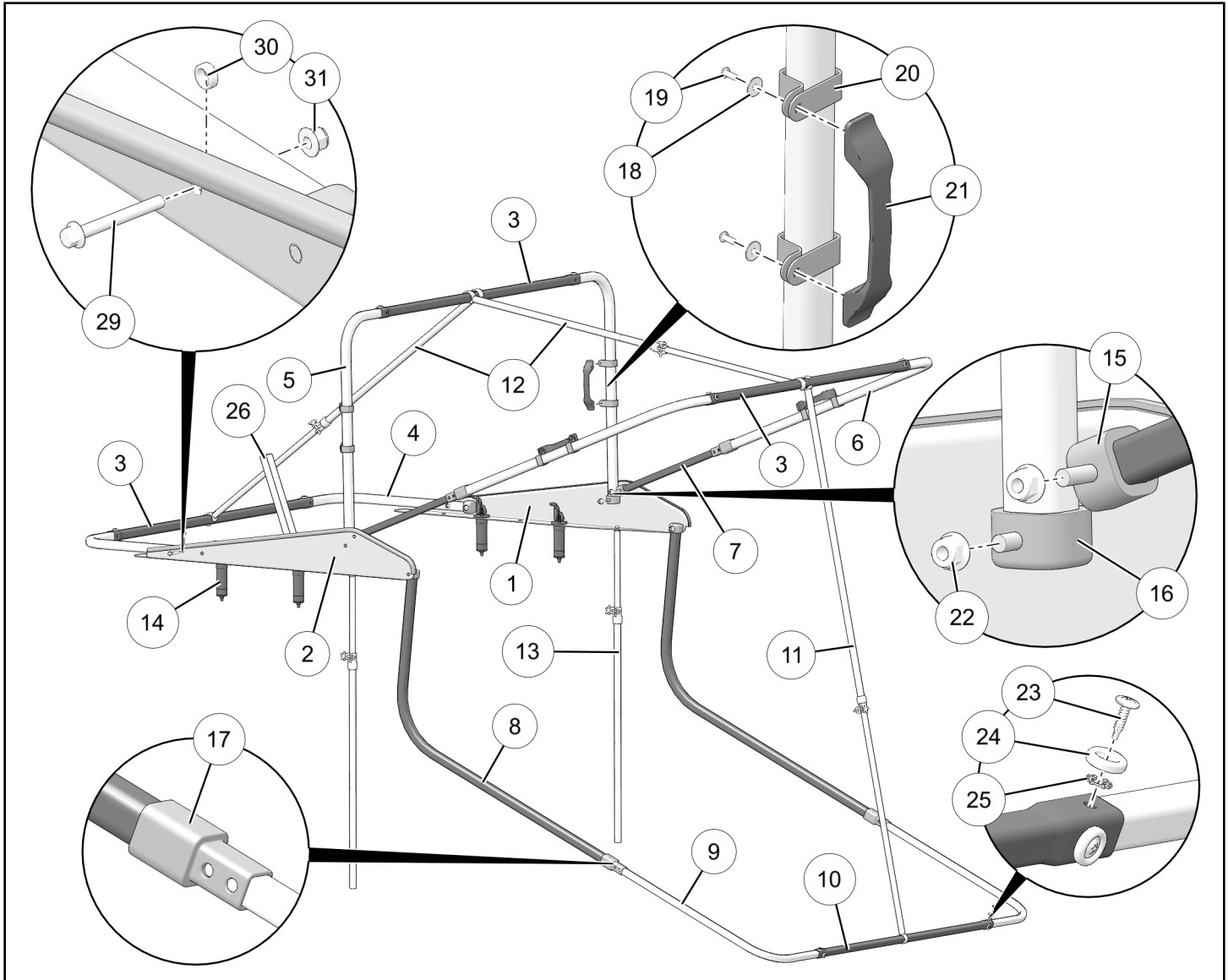

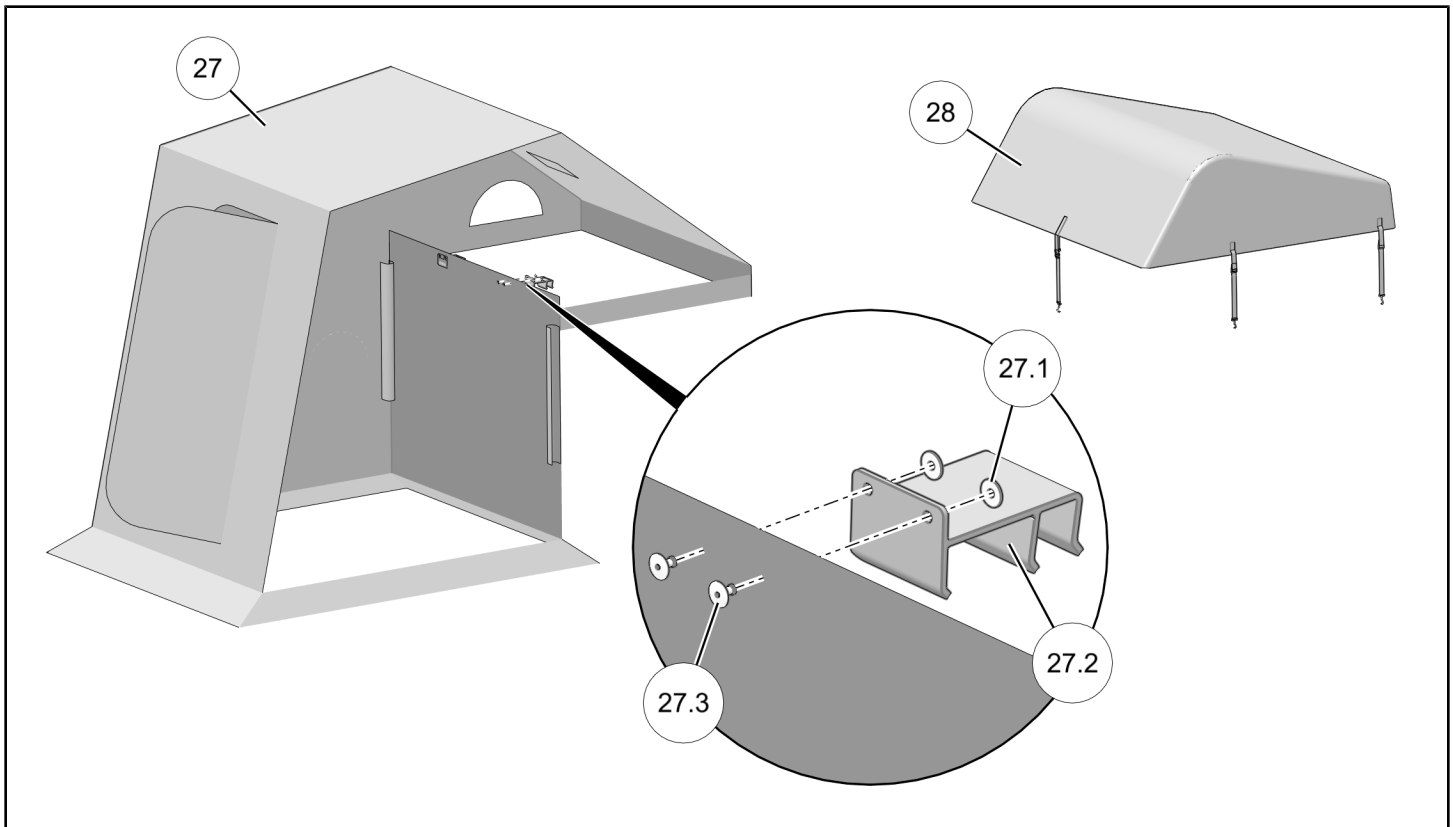

REF	QTY	PART DESCRIPTION	PART NUMBER	INCLUDED IN SERVICE KIT
1	1	Frame Bracket, RH	-	2207980
1.1	1	- Seal, Upper (not shown)	-	2206461
2	1	Frame Bracket, LH	-	2207980
2.1	1	- Seal, Upper (not shown)	-	2206461
3	3	Middle Straight Section	-	2207979 (Qty 1)*
4	2	Cargo Box Elbow	-	2207979 (Qty 1)*
5	2	Center Elbow	-	2207979 (Qty 1)*
6	2	Door Overhead Elbow	-	2207979 (Qty 1)*
7	2	Door Overhead Extension Tube	-	2207979 (Qty 1)*
8	2	Bottom Drop Down Tube	-	2207979 (Qty 1)*
9	2	Bottom Elbow	-	2207979 (Qty 1)*
10	1	Bottom Middle Straight Section	-	2207979 (Qty 1)*
11	1	Adjustable Door Support Tube (inner and outer tubes, end hooks, adjustor clamp, and knob)	-	2207978
12	2	Adjustable Roof Support Tube (inner and outer tubes, end hooks, adjustor clamp, and knob)	-	2207978**
13	2	Adjustable Curtain Support Tube (inner and outer tubes, adjustor clamp, knob, and insert pin)	-	2207978**
14	4	Expansion Anchor Kit, Lock & Ride®	2875250	-
15	2	Cap, Square Tube, Small	-	2206461 (Qty 1)

REF	QTY	PART DESCRIPTION	PART NUMBER	INCLUDED IN SERVICE KIT
16	6	Cap, Square Tube, Large	-	2206461 (Qty 1)
17	4	Connector, Square Tube	-	2206461 (Qty 1)
18	8	Washer, Flat - M4	-	2206461 (Qty 2)
19	8	Screw, Phillips - M4 X 0.7 X 10	-	2206461 (Qty 2)
20	8	Clamp, Handle	-	2206461 (Qty 2)
21	4	Handle	-	2206461 (Qty 1)
22	8	Nut, Hex Flange, Locking - 5/16 – 18	7542343	2206461 (Qty 4)
23	16	Screw, Self-Tapping - #8 X 3/4	-	2206461 (Qty 8)
24	16	Washer, Dome - 0.438 ID X 0.745 OD	-	2206461 (Qty 8)
25	16	Washer, Star - 0.197 X 0.5	-	2206461 (Qty 8)
26	1	Strap, Tie-Down	-	2206461
27	1	Shelter (includes items 27.1–27.3)	2637493	-
27.1	4	- Washer, Flat - 0.20 X 0.67 X 0.048	7556034	2206461
27.2	2	- Clamp, Tailgate	-	2206461
27.3	4	- Rivet, Blind, Steel, Dome Head - 0.187 X 0.440	7621472	2206461
28	1	Cover	2637494	-
29	2	Screw, Hex Flange - M6 X 1.0 X 50	7517932	2206461 (Qty 1)
30	2	Spacer - 12.1 OD X 8.5 ID X 5	-	2206461 (Qty 1)
31	2	Nut, Hex Flange, Locking - M6 X 1.0	7547274	2206461 (Qty 1)

* Service kit contains ONE tube of each part number (tube only, no associated parts).

** Service kit contains ONE SET of tubes (inner and outer), PLUS associated parts.

NOTE

Service kit 2206461 also contains parts (bracket, pin, and associated hardware) for securing the cargo box elbow ④ in earlier kits. These parts have been replaced by ②⑨, ③①, and ③② in later kits.

TOOLS REQUIRED

- Safety Glasses
- Cutting Tool (as required)
- Screwdriver, Phillips
- Socket Set, Hex Bit, Metric
- Socket Set, Metric
- Socket Set, SAE
- Wrench Set, Metric
- Wrench Set, SAE

IMPORTANT

Your XT Pro Lodge by Otter® Kit is exclusively designed for your vehicle. Please read the installation instructions thoroughly before beginning. Installation is easier if the vehicle is clean and free of debris. For your safety, and to ensure a satisfactory installation, perform all installation steps correctly in the sequence shown.

INSTALLATION INSTRUCTIONS

BRACKET ASSEMBLY AND INSTALLATION

1. Shift vehicle transmission into "PARK". Turn ignition switch to "OFF" position and remove key.
2. Assemble and install two LOCK & RIDE® expansion anchors ⑭ to LH frame bracket ② at holes shown. Ensure the following:
 - Tie-down strap ⑳ is installed at LEFT REAR expansion anchor
 - Tie-down strap is oriented with buckle on OUTSIDE of strap
 - Locations of nylon washer ① and steel washer ②

Repeat for RH side using RH frame bracket ① (without tie-down strap ⑳).

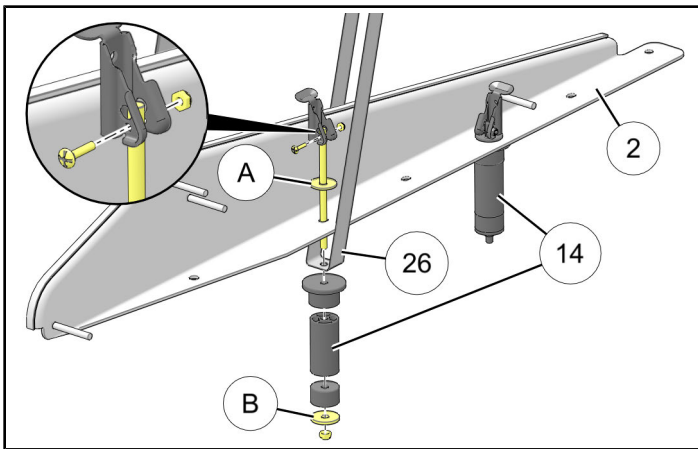

3. Ensure both expansion anchors ⑭ are unlocked, then install frame brackets ① and ② into bed until anchors are fully seated. Depress levers to lock in place.

If installation is loose, remove bracket from bed, tighten nut at base of affected anchor(s), and reinstall.

NOTE

Tie-down strap hidden for clarity.

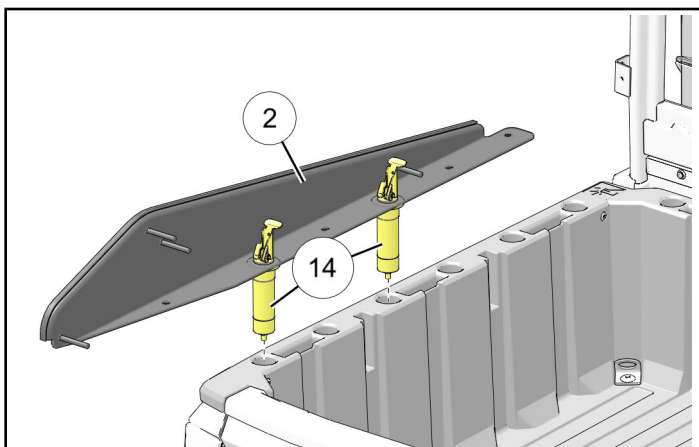

TUBE ASSEMBLY AND INSTALLATION

The shelter frame consists of four U-shaped tube assemblies ①, each installed to RH and LH frame brackets ① and ②. This is a one time task. After these four assemblies are installed to the frame brackets they do not have to be removed or disassembled, even for shelter collapse and transport.

In addition, three centerline support tube assemblies ②, and two vertical support tube assemblies ③ are used. Although these must be installed or removed each time the shelter is opened or closed, each tube assembly itself comes and remains fully assembled.

Assembly and installation occurs from front to rear, starting with U-shaped tube assemblies ①, then centerline support tube assemblies ②. Vertical support tube assemblies ③ will be installed with the shelter fabric in the next section.

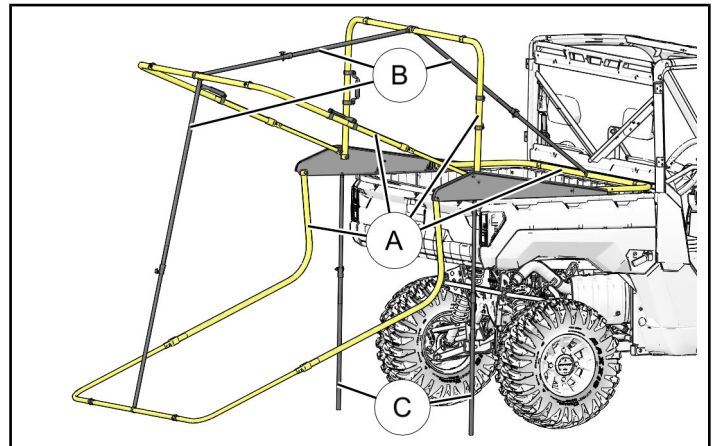

1. Assemble and install U-shaped CARGO BOX tube assembly.

- a. Assemble two CARGO BOX ELBOW tubes ④ to MIDDLE STRAIGHT SECTION tube ③. Push tubes together until fully seated, then secure using four each self-tapping screws ②③, dome washers ②④, and star washers ②⑤.

IMPORTANT

Elbows do not have pre-drilled holes. Self-tapping screws will form their own holes. However, to avoid stripping holes, **HAND TIGHTEN ONLY**.

TIP

Wrap fasteners with duct tape (or equivalent) to minimize loosening during repeated use.

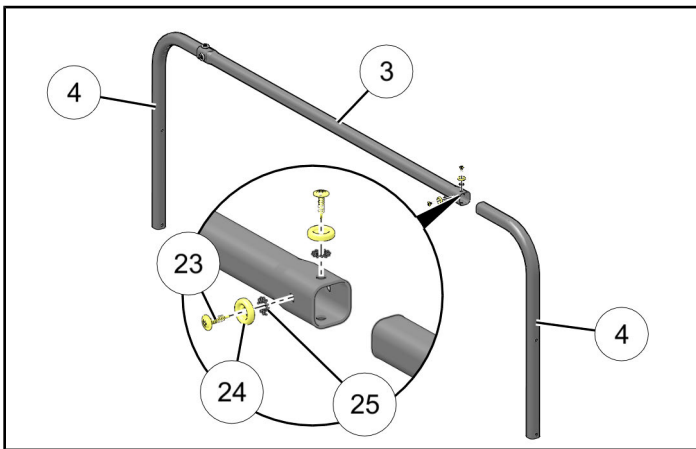

- b. Install large cap ①⑥ to end of each tube ④, ensuring holes in cap align with holes in tube.

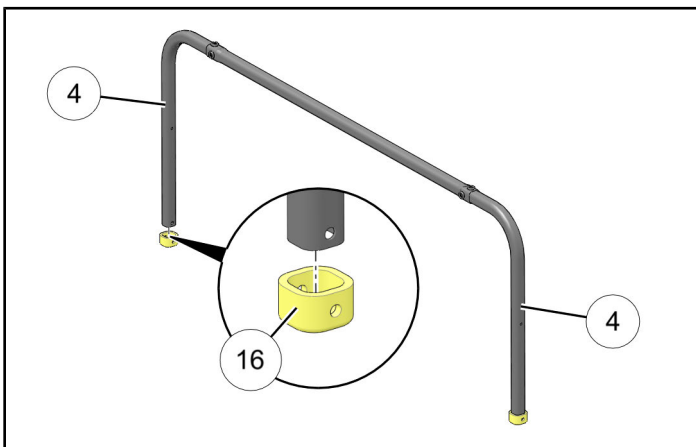

- c. With tube assembly in upright orientation, loosely install one side to bracket stud ①⑩, then install opposite side.

NOTE

If difficulty is encountered when installing tube assemblies to bracket studs, then unlock both LOCK & RIDE® expansion anchors from bracket, lift bracket from vehicle bed, install tube assembly, then reinstall bracket and lock expansion anchors.

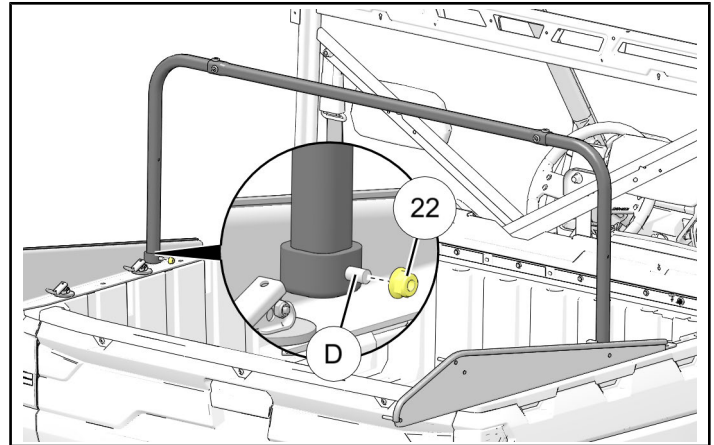

- d. Install nut ②② to each stud ①⑩, but do not overtighten. Tube assembly must be free to rotate on stud.
- e. Rotate tube assembly forward and downward, then secure to LH frame bracket ② using screw ②⑨, spacer ③⑩, and nut ③①. Tighten only until parts are lightly clamped to avoid tube damage.

Repeat for RH side.

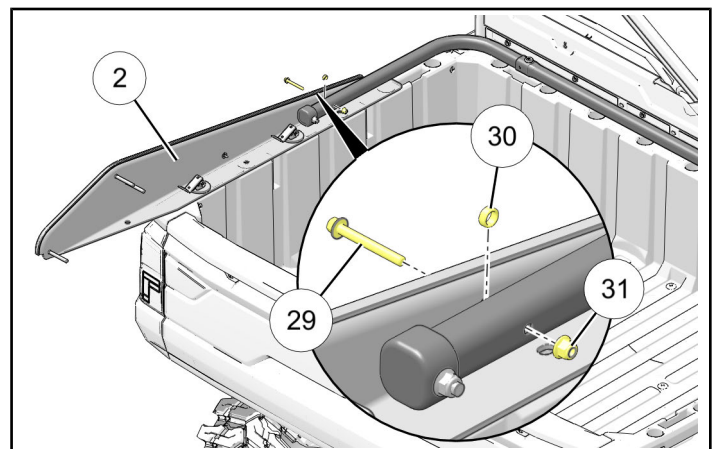

2. Assemble and install U-shaped CENTER tube assembly.

- a. Assemble two CENTER ELBOW tubes ⑤ to MIDDLE STRAIGHT SECTION tube ③. Push tubes together until fully seated, then secure using four each self-tapping screws ②③, dome washers ②④, and star washers ②⑤.

IMPORTANT

Elbows do not have pre-drilled holes. Self-tapping screws will form their own holes. However, to avoid stripping holes, **HAND TIGHTEN ONLY**.

TIP

Wrap fasteners with duct tape (or equivalent) to minimize loosening during repeated use.

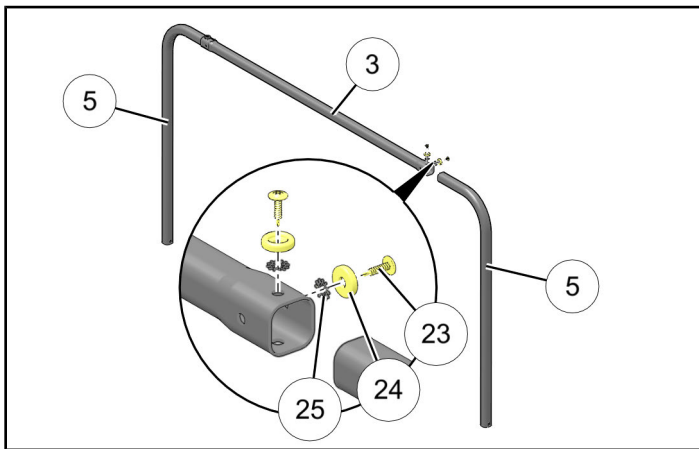

- b. Loosely install two handle clamps ②① and handle ②① to tube ⑤ using two each screws ②⑨ and washers ②⑧. Ensure handle is oriented towards INBOARD side of tube assembly as shown.

Do not tighten fasteners at this time. Handle location will be adjusted later.

Repeat handle installation for opposite side.

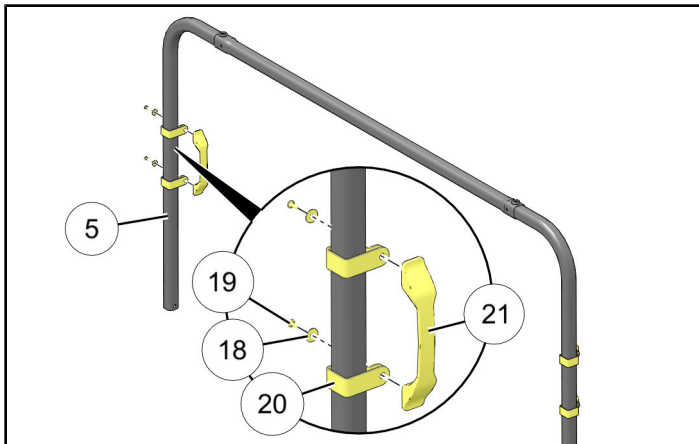

- c. Install large cap ②①⑥ to end of each tube ⑤, ensuring holes in cap align with holes in tube.

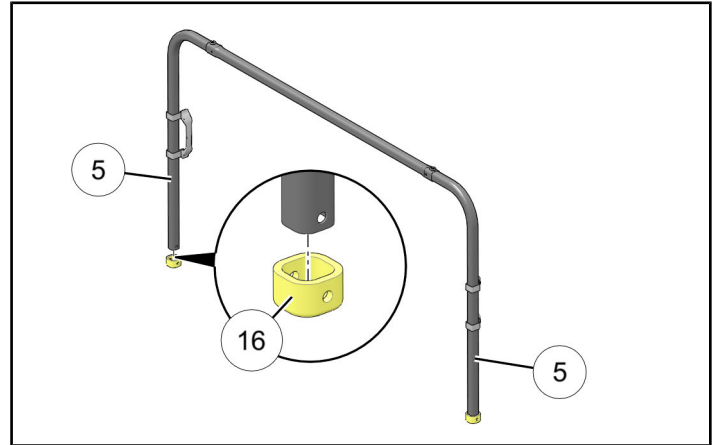

- d. With tube assembly in upright orientation, loosely install one side to bracket stud ②⑤, then install opposite side.

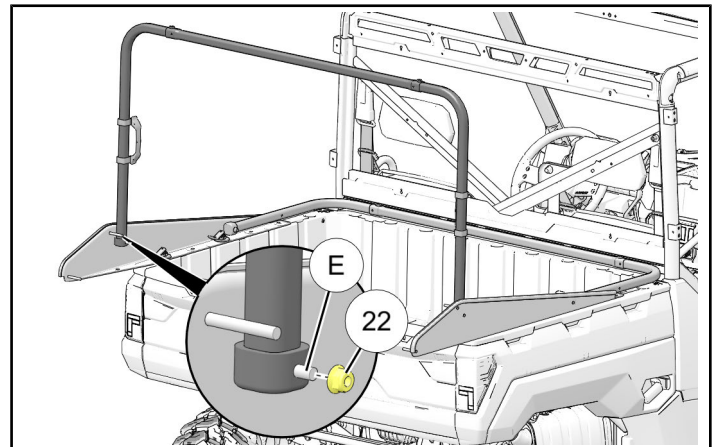

- e. Install nut ②② to each stud ②⑤, but do not overtighten. Tube assembly must be free to rotate on studs.

- f. Using handles, pivot this CENTER tube assembly down against previously installed CARGO BOX tube assembly.

Position handles to prevent interference between the two tube assemblies, then tighten handle fasteners.

3. Assemble and install U-shaped DOOR tube assembly.
 - a. Assemble two DOOR OVERHEAD ELBOW tubes ⑥ to MIDDLE STRAIGHT SECTION tube ③. Push tubes together until fully seated, then secure using four each self-tapping screws ②③, dome washers ②④, and star washers ②⑤.

IMPORTANT

Elbows do not have pre-drilled holes. Self-tapping screws will form their own holes. However, to avoid stripping holes, **HAND TIGHTEN ONLY**.

TIP

Wrap fasteners with duct tape (or equivalent) to minimize loosening during repeated use.

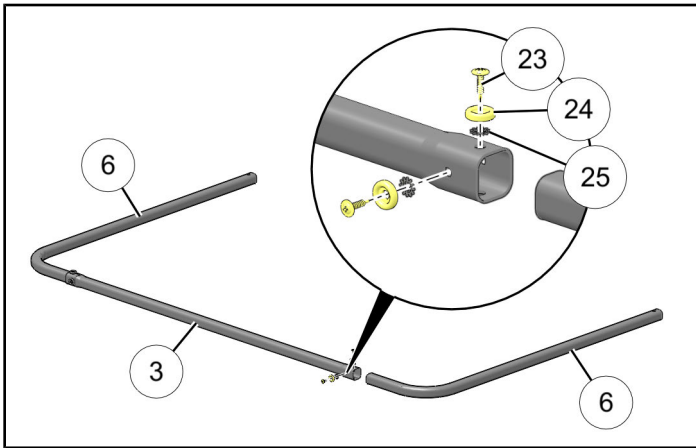

- b. Loosely install two handle clamps ②① and handle ②① to DOOR OVERHEAD ELBOW tube ⑥ using two each screws ②⑨ and washers ②⑧. Ensure handle is oriented towards INBOARD side of tube assembly as shown.

Do not tighten fasteners at this time. Handle location will be adjusted later.

Repeat handle installation for opposite side.

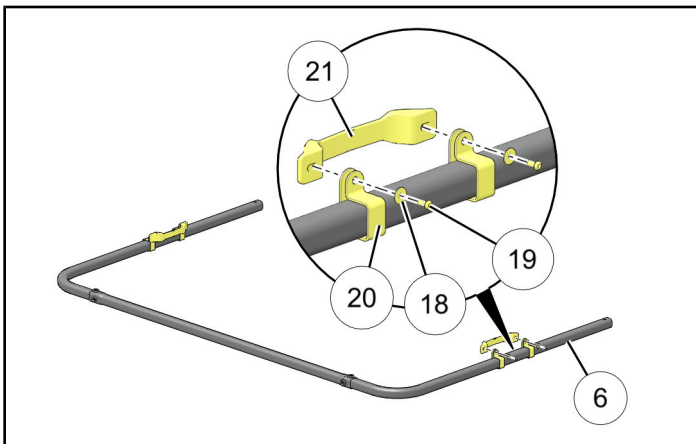

- c. Orient DOOR OVERHEAD EXTENSION tube ⑦ with lock button on **INSIDE** of U-shaped tube assembly.

Install connector ①⑦ (pre-installed on tube ⑦) to tube ⑥ until connector tabs snap into place.

Depress lock button, then fully insert tube ⑦ through connector into tube ⑥.

Repeat for opposite side.

CAUTION

Follow all manufacturer's recommendations for lubricant use, including personal protective equipment. Failure to comply may result in injury.

TIP

Lubricate tubes ⑦ with a lightweight oil to facilitate installation and adjustment.

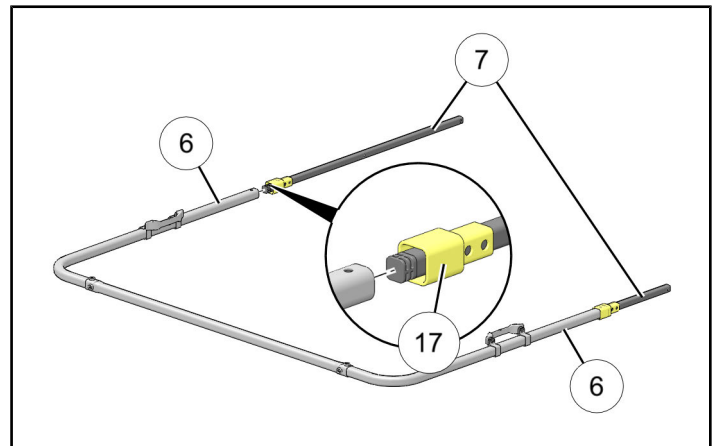

- d. Install small cap ①⑤ to end of each tube ⑦, ensuring holes in cap align with holes in tube.

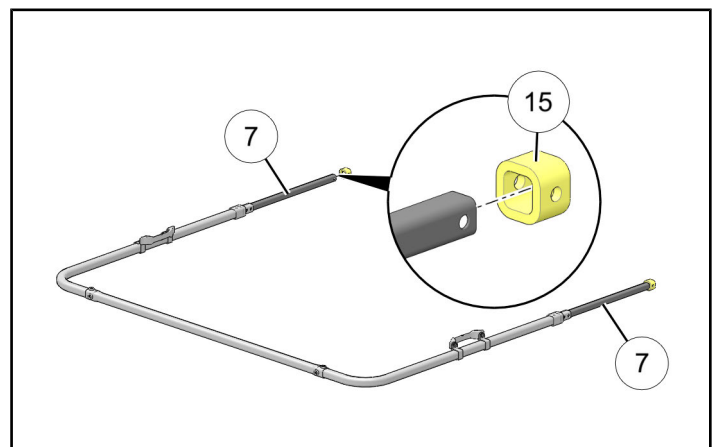

- e. With tube assembly in upright orientation, loosely install one side to bracket stud ⑥, then install opposite side.

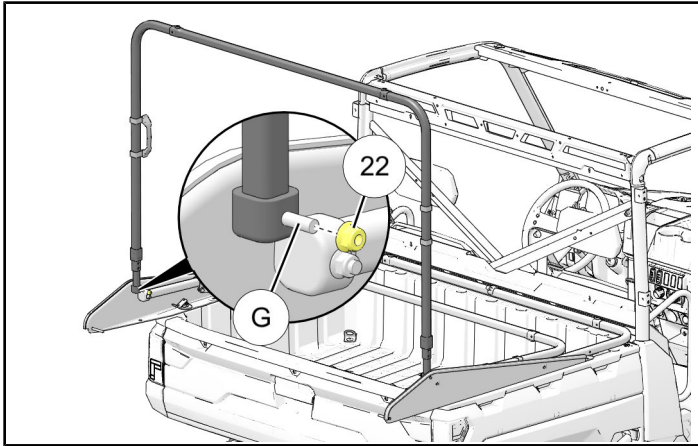

- f. Install nut ②② to each stud ⑥, but do not overtighten. Tube assembly must be free to rotate on studs.
- g. Using handles, pivot this DOOR tube assembly down against previously installed CENTER tube assembly. Position handles to prevent interference between the two tube assemblies, then tighten handle fasteners.

4. Assemble and install U-shaped BOTTOM tube assembly.

- a. Assemble two BOTTOM ELBOW tubes ⑨ to BOTTOM MIDDLE STRAIGHT SECTION tube ⑩. Push tubes together until fully seated, then secure using four each self-tapping screws ②③, dome washers ②④, and star washers ②⑤.

IMPORTANT

Elbows do not have pre-drilled holes. Self-tapping screws will form their own holes. However, to avoid stripping holes, **HAND TIGHTEN ONLY**.

TIP

Wrap fasteners with duct tape (or equivalent) to minimize loosening during repeated use.

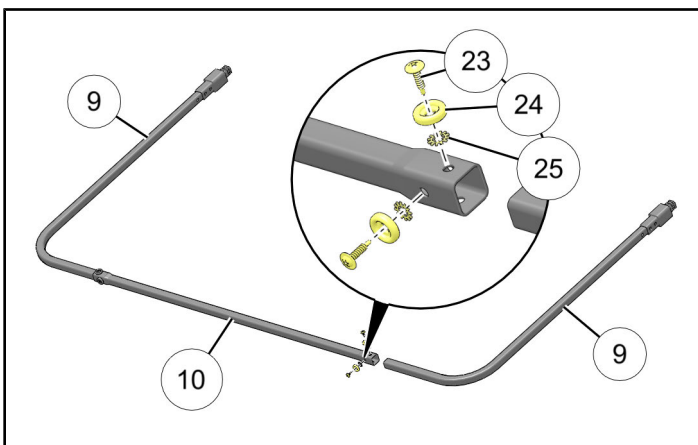

- b. Install connector ①⑦ (pre-installed on tube ⑨) to tube ⑧ until connector tabs snap into place.

Depress lock button, then fully insert tube ⑨ through connector into tube ⑧.

Repeat for opposite side.

⚠ CAUTION

Follow all manufacturer's recommendations for lubricant use, including personal protective equipment. Failure to comply may result in injury.

TIP

Lubricate tubes ⑨ with a lightweight oil to facilitate installation and adjustment.

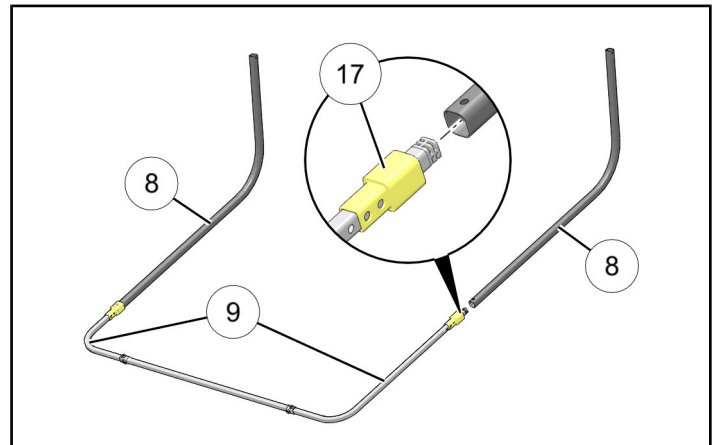

- c. Install large cap ①⑥ to end of each tube ⑧, ensuring holes in cap align with holes in tube.

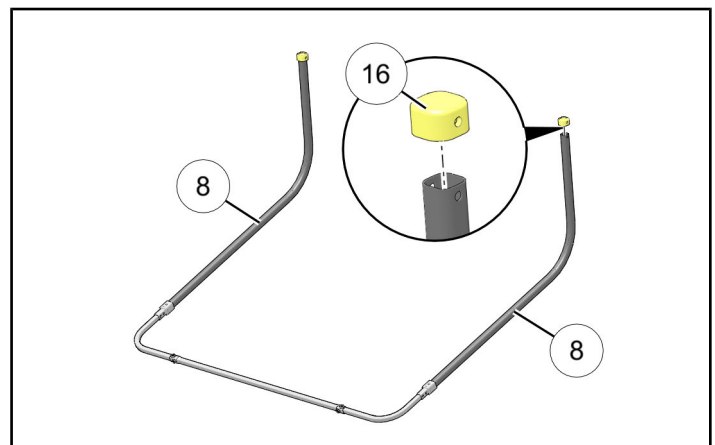

- d. With tube assembly resting on ground, loosely install one side to bracket stud ①, then install opposite side.

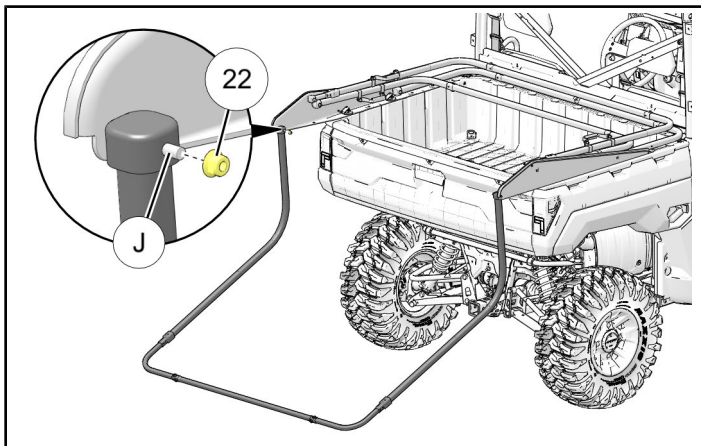

- e. Install nut ② to each stud ①, but do not overtighten. Tube assembly must be free to rotate on studs.

5. Install centerline ROOF SUPPORT tube assemblies.

- a. Using handles, pivot U-shaped DOOR tube assembly ① towards rear of vehicle, gently resting on bottom tube caps ①⑥.

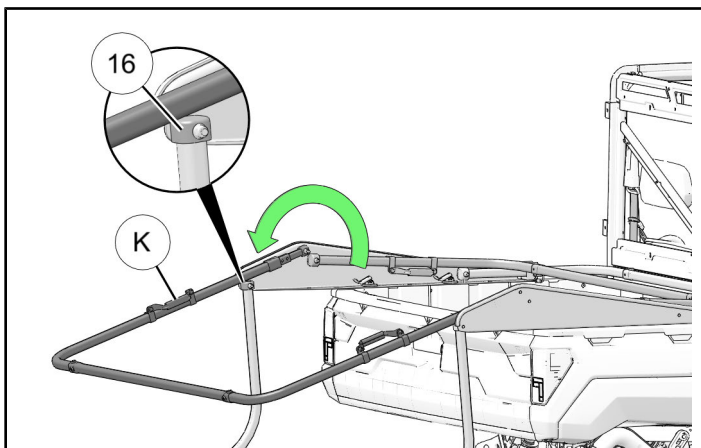

- b. Using handles, pivot U-shaped CENTER tube assembly ① to upright position.

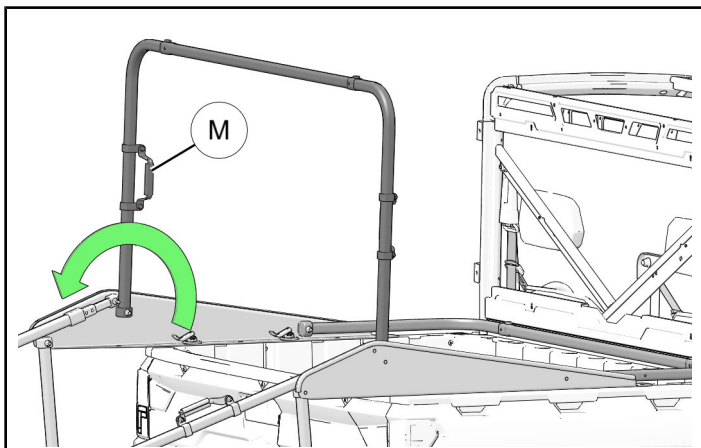

- c. Loosen adjustment knob ① on ADJUSTABLE ROOF SUPPORT tube ①②, clip hooks ① to MIDDLE STRAIGHT SECTION tubes ③, then retighten adjustment knob.

Ensure proper orientation: OPEN sides of hooks should face DOWNWARD as shown.

NOTE

Length of roof support is not critical as long as center tube assembly is approximately upright as shown. Final adjustment will occur later.

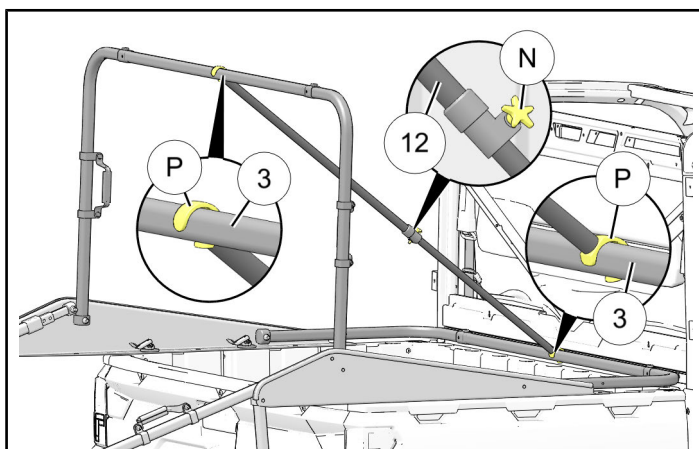

- d. Extend U-shaped DOOR tube assembly ① rearward until lock button engages FIRST hole ① (for shorter length) in tube connector ①⑦. Ensure both sides are locked.

NOTE

Tube connector has a second hole (for longer length) which may be used after shelter installation to provide additional support.

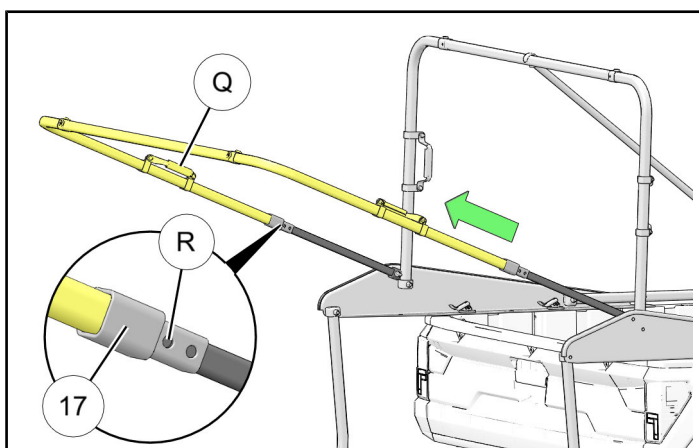

- e. Loosen adjustment knob (N) on ADJUSTABLE ROOF SUPPORT tube (12), clip hooks (P) to MIDDLE STRAIGHT SECTION tubes (3), then retighten adjustment knob.

Ensure proper orientation: OPEN sides of hooks should face DOWNWARD as shown.

NOTE

Length of roof support is not critical as long as center tube assembly is approximately upright as shown. Final adjustment will occur later.

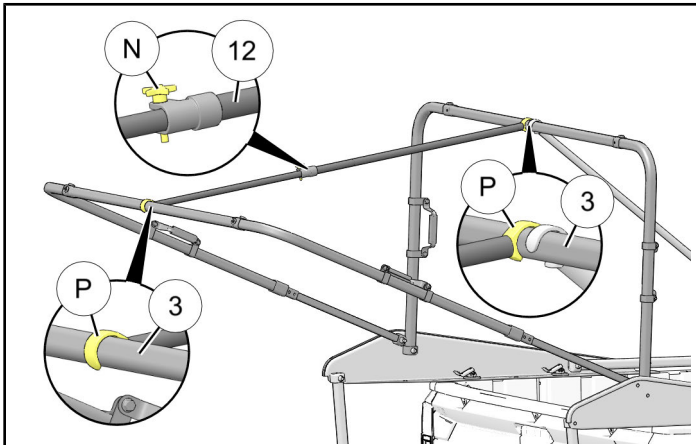

- b. Loosen adjustment knob (N) on ADJUSTABLE ROOF SUPPORT tube (11), clip LARGE hook (P) to MIDDLE STRAIGHT SECTION tube (3) and SMALL hook (U) to BOTTOM MIDDLE STRAIGHT SECTION tube (10), then retighten adjustment knob.

Ensure proper orientation: OPEN sides of hooks should face FORWARD as shown.

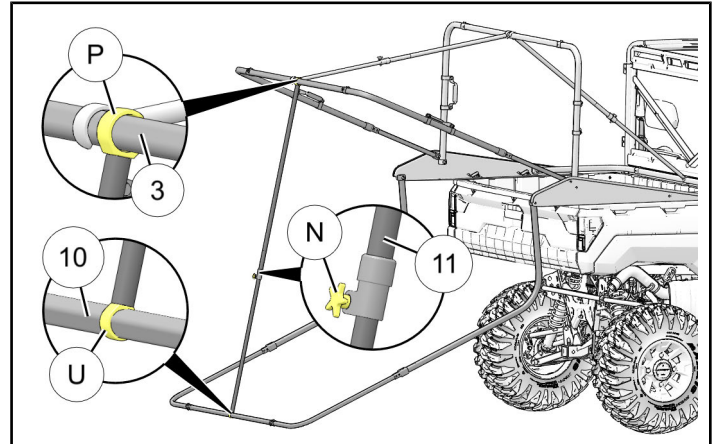

SHELTER AND CURTAIN SUPPORT TUBE INSTALLATION

NOTE

Shelter RH wall hidden for clarity.

6. Install centerline DOOR SUPPORT tube assembly.

- a. Extend U-shaped BOTTOM tube assembly (T) rearward until lock button engages FIRST hole (R) (for shorter length) in tube connector (17). Ensure both sides are locked.

NOTE

Tube connector has a second hole (for longer length) which may be used after shelter installation to provide additional support.

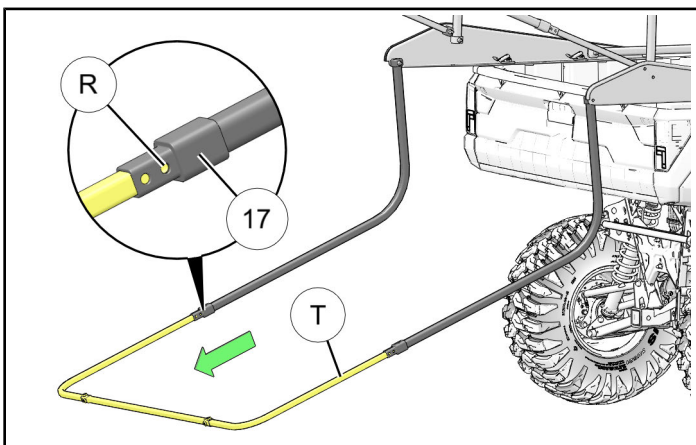

1. If installing shelter on **RANGER XP® 900** or **RANGER CREW® XP 900**, then proceed to next Step 2.

If installing shelter on **RANGER XP® 1000** or **RANGER CREW® XP 1000**, then cut off center leg (A) from each tailgate clamp (B).

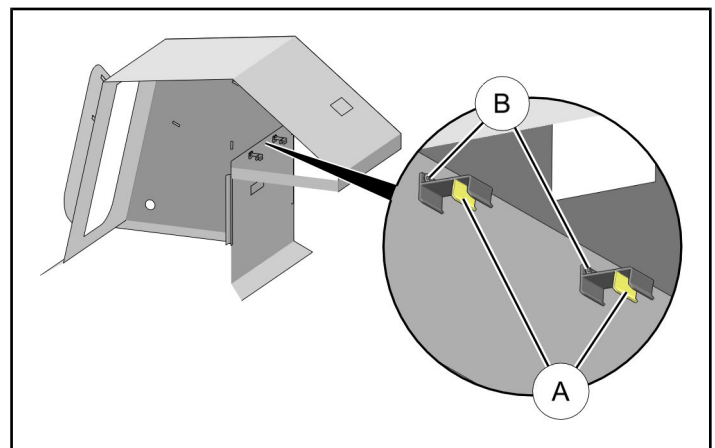

2. Install shelter ⑳.

TIP

Shorten tube lengths as required to facilitate installation of shelter.

- a. Lay shelter over frame assembly, then pull each side wall down on outside of U-shaped tube assemblies.

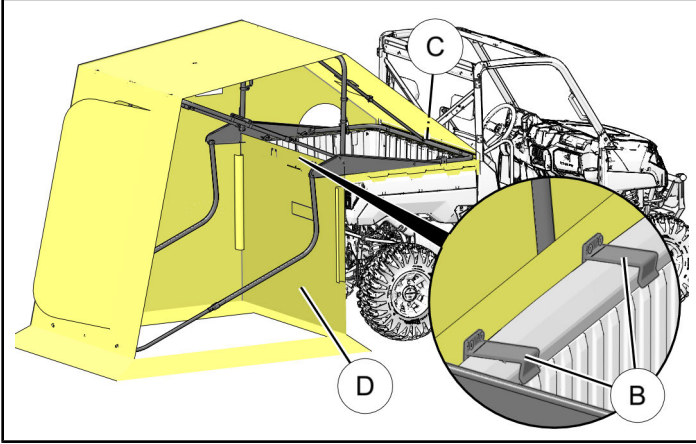

- b. Tuck flap ③ on front of shelter down between vehicle bed and ROPS cross-member, then secure front corners using hook and loop strips.
- c. Pull forward curtain wall ⑩ across vehicle to opposite side. Secure curtain wall to tailgate using two clamps ⑧, and to shelter side wall using hook and loop strips.

3. With ADJUSTABLE CURTAIN SUPPORT tube ⑬ fully collapsed, and pin ⑤ oriented UP, insert tube downward into shelter corner sleeve.

Insert pin into hole in frame ②, extend tube to ground, then tighten adjustment knob.

Repeat for opposite side.

IMPORTANT

Ensure tubes are vertical to keep shelter fabric away from exhaust components.

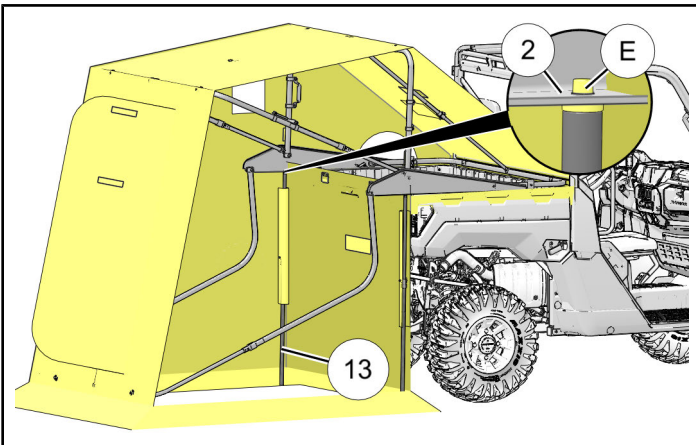

4. Adjust lengths and/or positions of all tube assemblies to achieve the following:

- U-shaped tube assemblies ⑥ are located at intersections of shelter panels.

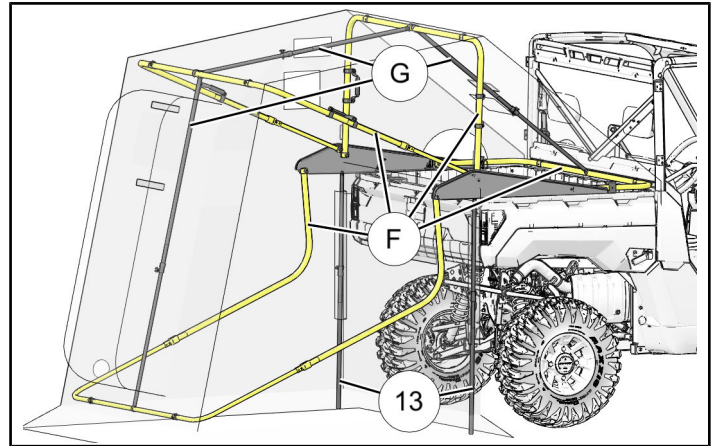

- All tubes are extended so that shelter fabric is snug, not sagging.

NOTE

U-shaped DOOR tube assembly and U-shaped BOTTOM tube assembly have a second adjustment hole to provide added length. See previous section, **POLE ASSEMBLY AND INSTALLATION**, Steps 5d and 6a, for detail.

- Adjustment knobs on three centerline tube assemblies ⑥ and two curtain support tube assemblies ⑬ are tight.
5. Secure shelter to U-shaped tube assemblies using hook and loop strips.
6. **OPTIONAL:** Secure front corners of shelter to ice using Otter® Ice Anchor Kit (sold separately; available from Otter®).

PREPARING SHELTER FOR VEHICLE OPERATION OR TRANSPORT

⚠ WARNING

Shelter must be **FULLY COLLAPSED**, **SECURED** with tie-down strap, and **COVERED** prior to vehicle operation.

If transporting vehicle in non-enclosed trailer then vehicle must **FACE FORWARD**, and shelter must be **FULLY COLLAPSED**, **SECURED**, and **COVERED**.

Otherwise, shelter must be removed.

Failure to comply may allow airflow, vibration, or other factors to separate shelter from vehicle and cause an accident, resulting in serious personal injury or death.

1. Close shelter door and windows.
2. Loosen, collapse, and remove two curtain support tube assemblies **(B)** and three centerline roof support tube assemblies **(A)**.

Place tube assemblies in vehicle bed, securing as required to prevent movement or damage.

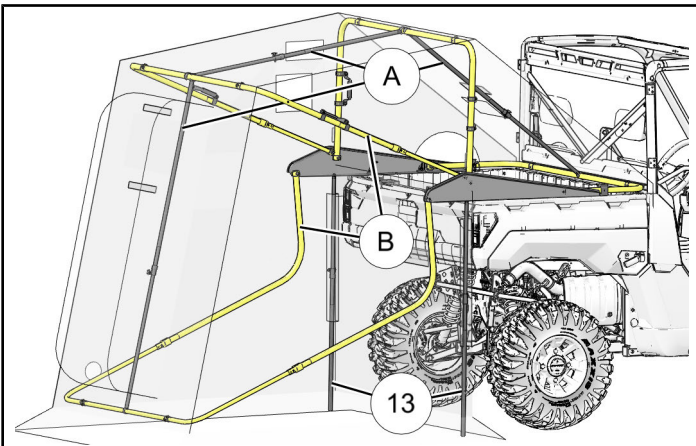

3. Depress lock buttons (LH and RH sides) on U-shaped **DOOR** and **BOTTOM** tube assemblies **(B)**, then fully collapse tube frames.

CAUTION

Use handles **(21)** when pivoting tube assemblies **(B)** into vehicle bed. Handles will keep fingers away from hinge joint and prevent injury.

4. Pivot shelter and U-shaped tube assemblies forward into vehicle bed, neatly tucking and folding shelter as required.

Ensure the following:

- a. If shelter is frozen to the ice, do not forcibly pull it free. Fabric or seam damage may occur. Carefully chip ice away from affected area.

- b. Do not allow shelter fabric to be pinched between hinge brackets and frame tubes. Use care when handling shelter windows. Rough handling, creasing, or crushing may damage windows, especially in very cold weather.
 - c. Use care when stowing gear (and shelter tubes) in vehicle bed **BELOW SHELTER**, especially items with hot or sharp edges. Use extra padding as required.
 - d. Do not pack any gear **ON TOP OF SHELTER**.
5. Secure U-shaped tube assemblies to LH frame bracket using tie-down strap **(26)**.

NOTE

Shelter hidden for clarity.

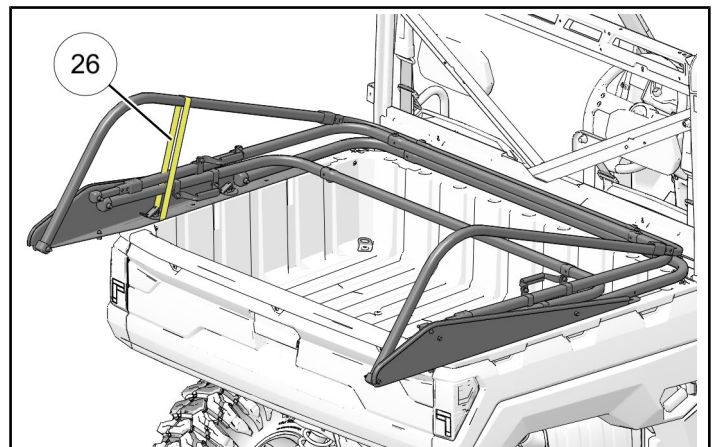

6. Install cover **(28)** over collapsed frame assembly. Tuck cover beneath tube assemblies, then secure to vehicle using three pre-attached tie-down straps **(C)**.

NOTE

Forward left strap hidden.

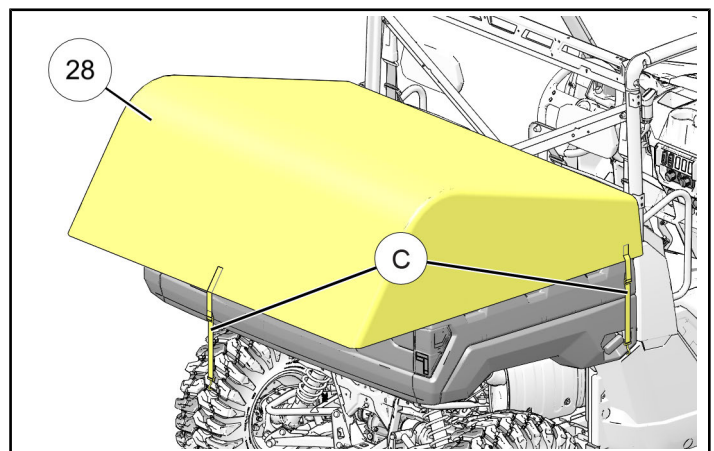

USE AND CARE

1. Safety labeling.

ALWAYS FOLLOW ALL SAFETY LABELING PROVIDED ON THIS PRODUCT!

In addition, observe the following:

⚠ DANGER

DO NOT OPERATE VEHICLE OR ENGINE WITH SHELTER DEPLOYED.

Vehicle operation could result in injury or property damage.

Engine operation may allow carbon monoxide (CO) to accumulate in shelter.

Carbon monoxide is a poison you cannot see or smell. Carbon monoxide can kill you in minutes.

If you feel unwell, exit the shelter immediately.

⚠ DANGER

Fuel-burning equipment (such as heaters, stoves, and lanterns) produce carbon monoxide.

Carbon monoxide is a poison you cannot see or smell. Carbon monoxide can kill you in minutes.

ALWAYS follow ALL manufacturer's instructions for proper equipment use, including equipment location and ventilation.

If you feel unwell, exit the shelter immediately.

CAUTION

Ensure vehicle exhaust components are cool before deploying shelter.

Do not allow shelter fabric to come in contact with hot equipment or hot air. Shelter fabric and/or fabric coatings may be damaged.

2. Gaining access to engine compartment.

CAUTION

To prevent tube damage:

- Do not attempt to raise vehicle bed with support tube assemblies installed.
- Ensure vehicle bed is fully lowered and latched before reinstalling support tube assemblies.

- a. Remove two curtain support tube assemblies ⑬ and three centerline roof support tube assemblies ①, then raise vehicle bed.

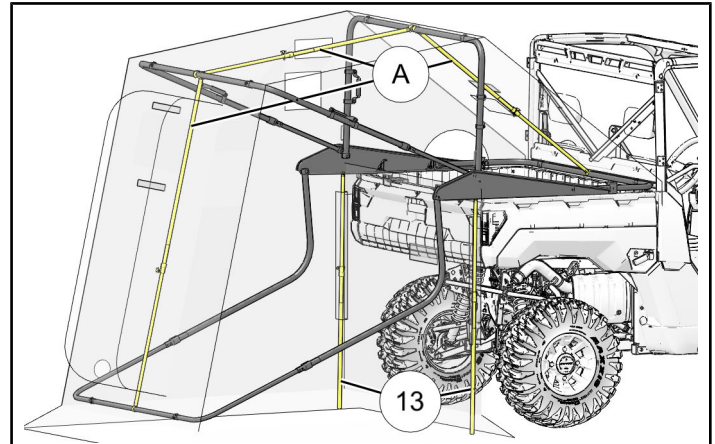

- b. Reverse procedure to restore access. Ensure bed is fully lowered and latched.
3. Ensure shelter fabric is thoroughly dry before packing. Open and air dry as required after use.
4. Clean shelter fabric with warm water and mild detergent.

FEEDBACK FORM

A feedback form has been created for the installer to provide any comments, questions or concerns about the installation instructions. The form is viewable on mobile devices by scanning the QR code or by clicking [HERE](#) if viewing on a PC.

