

# ROOF LINER KIT



**P/N 2882914, 2884416**

## APPLICATION

Verify accessory fitment at [Polaris.com](https://www.polaris.com).

## BEFORE YOU BEGIN

Read these instructions and check to be sure all parts and tools are accounted for. Please retain these installation instructions for future reference and parts ordering information.

## KIT CONTENTS

This kit contains parts for installation of the roof liner only. Prior installation of the Poly Roof Kit, PN 2882911, is also required (sold separately).

This Kit includes:

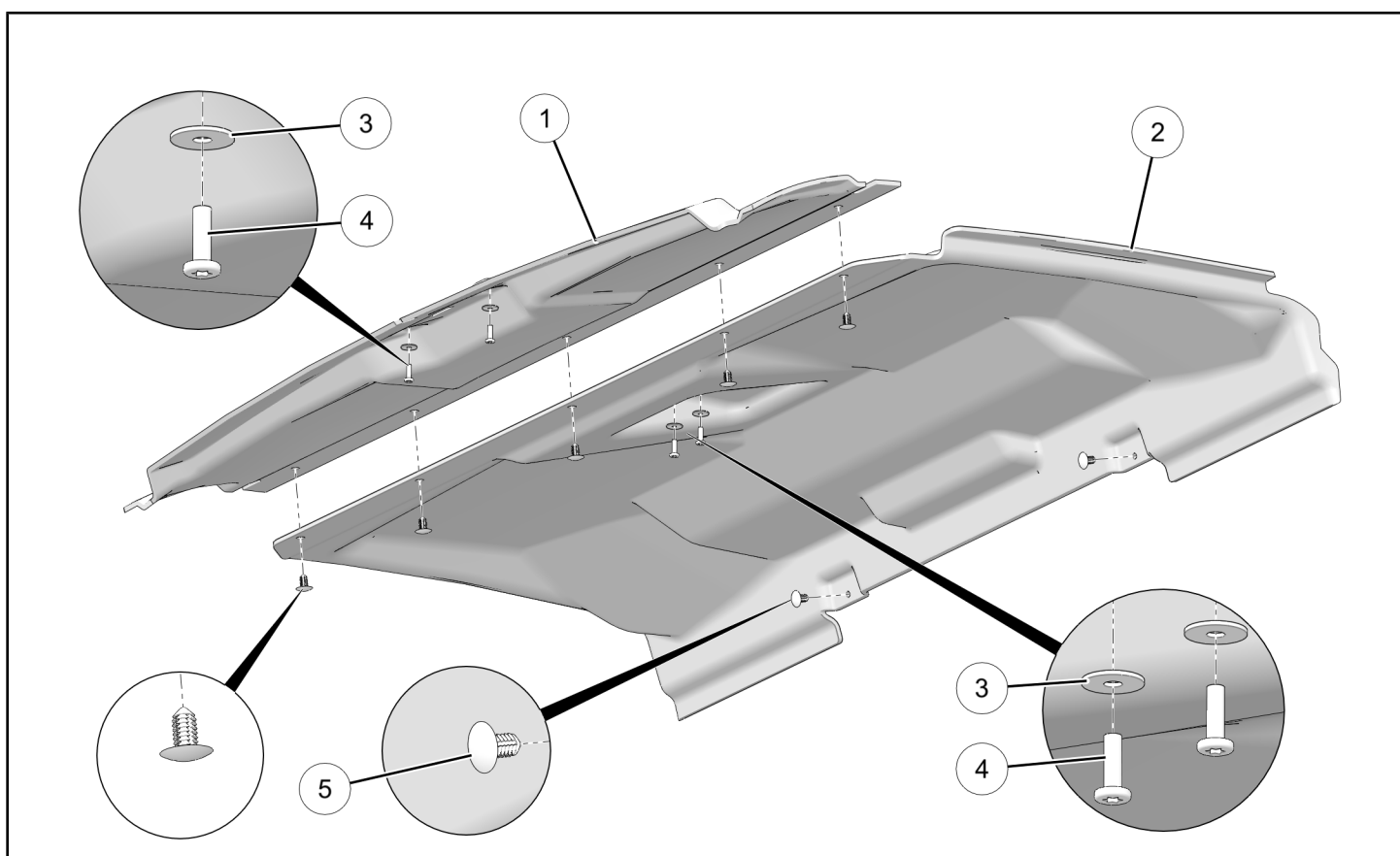

REF	QTY	PART DESCRIPTION	PART NUMBER
1	1	Liner, Front	5814646
2	1	Liner, Rear	5814714
3	4	Washer - 0.2 X 0.67 X 0.048	7556034
4	4	Screw, Torx® Pan Head, High/Low - #10 X 5/8	7518238
5	7	Push Dart	7670088
6	1	Decal, "Be Prepared/Drive Responsibly" (Kit PN 2882914 only) (not shown)	7187261

REF	QTY	PART DESCRIPTION	PART NUMBER
7	1	Decal, "Require Proper Use/Do Your Part" (Kit PN 2882914 only) (not shown)	7187260
8	1	Decal, "Payload" (Kit PN 2882914 only) (not shown)	7187264
9	1	Decal, "Never Operate/Always" (Kit PN 2884416 only) (not shown)	7300076
10	1	Decal, "Require Proper Use/Do Your Part" (Kit PN 2884416 only) (not shown)	7300098
	1	Instructions	9928397

## TOOLS REQUIRED

- Safety Glasses
- Cutting Tool\*
- Screwdriver Set, Torx®

\* Tool requirement dependent on specific installation.

## IMPORTANT

Your Roof Liner Kit is exclusively designed for your vehicle. Please read the installation instructions thoroughly before beginning. Installation is easier if the vehicle is clean and free of debris. For your safety, and to ensure a satisfactory installation, perform all installation steps correctly in the sequence shown.

## INSTALLATION INSTRUCTIONS

- Shift vehicle transmission into "PARK". Turn ignition switch to "OFF" position and remove key.
- OPTIONAL: If installing one or both of the following accessories (sold separately), then modify rear liner ② as described below.
  - Light: Cut oval opening ① or rectangular opening ②, as required, to accommodate light. Install electrical harness per instructions included with accessory.
  - Rear Speakers: Cut two circular openings ③ and open associated fastener holes. Install electrical harness per instructions included with accessory.
- Install front liner ① to roof panel using two each screws ④ and washers ③.

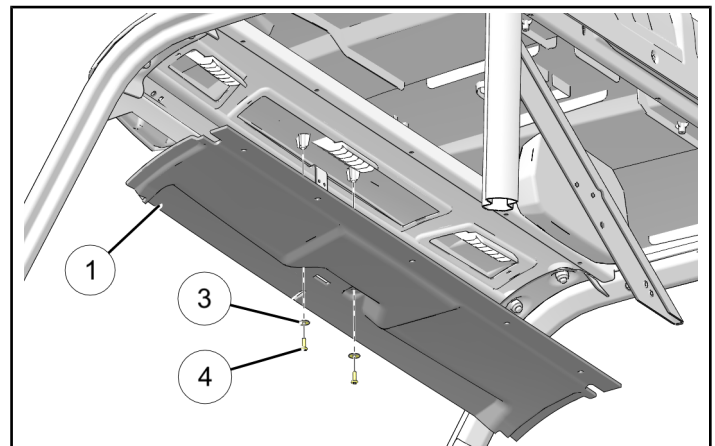
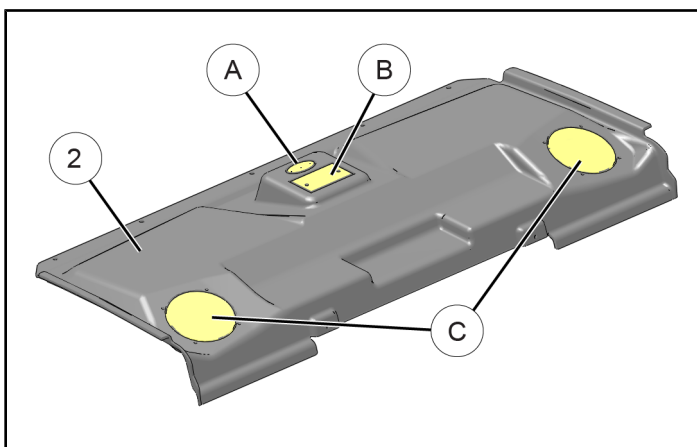

4. Insert both rear segments ① of rear liner ② into roof support channel, then slowly tip liner up, inserting LH and RH edges of liner between ROPS and roof seal.

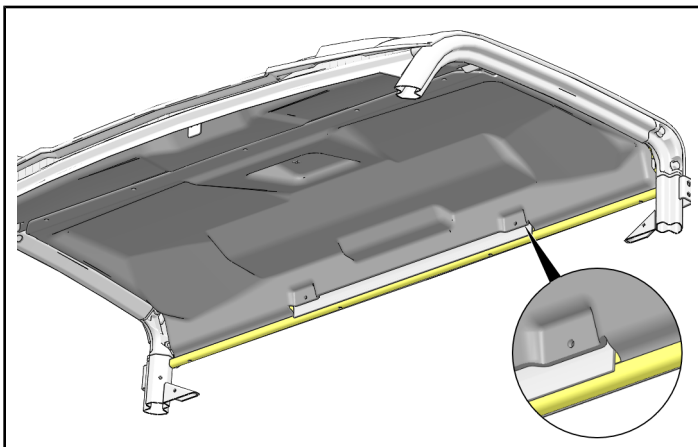
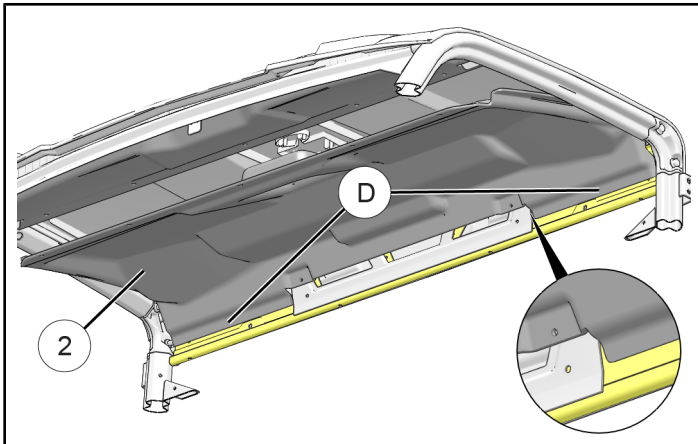

5. If installing optional light, then refer to instructions included with light. Otherwise, install two each screws ④ and washers ③ through rear liner ② into roof.

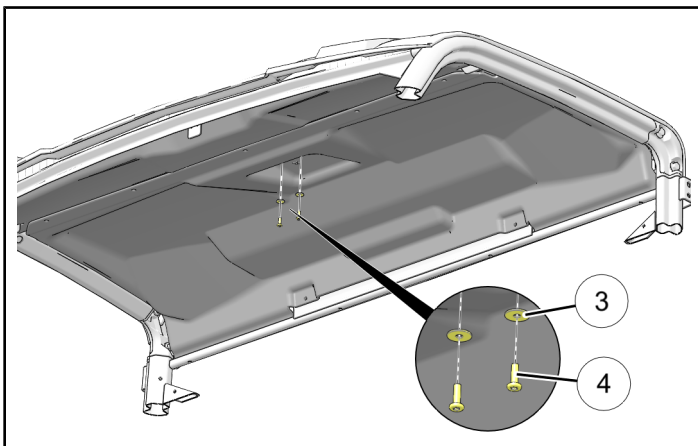

6. Secure rear liner ② by installing seven push darts ⑤, five into front edge and two into rear edge.

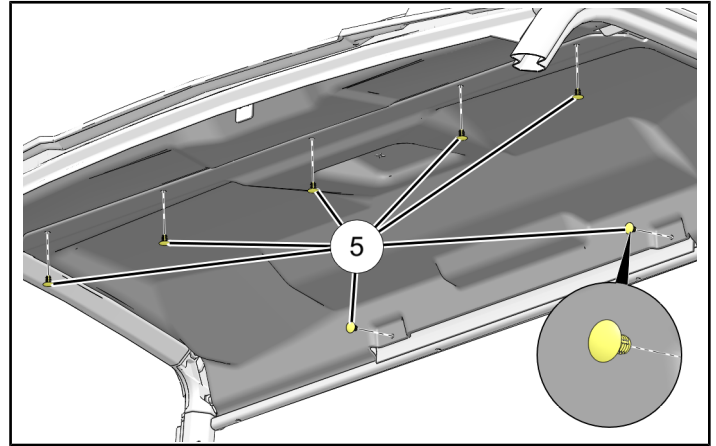

7. Decal application.

### IMPORTANT

Decals required per ANSI/ROHVA standards.

#### MY18 and newer **RANGER XP® 1000**

Apply “Be Prepared/Drive Responsibly” decal ⑥, “Require Proper Use/Do Your Part” decal ⑦, and “Payload” decal ⑧ to front liner ① as shown.

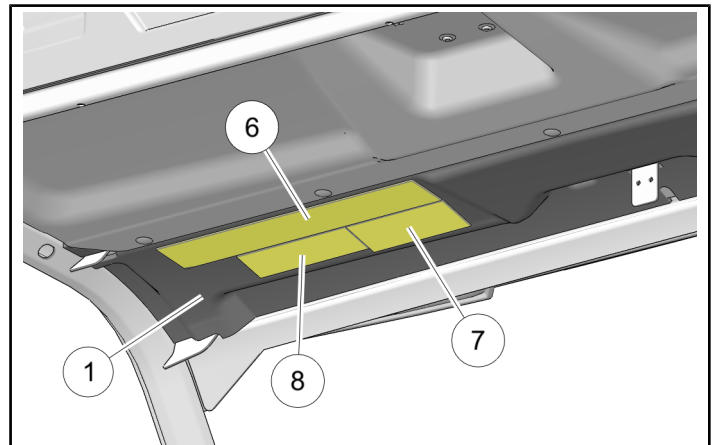

#### MY19 and older **RANGER XP® 900**

All required decals are applied to vehicle from factory. Decals ⑥, ⑦, and ⑧ are not used.

## PRO XD™

Apply “Never Operate/Always” decal ⑨ and “Require Proper Use/Do Your Part” decal ⑩ to front liner ① as shown.

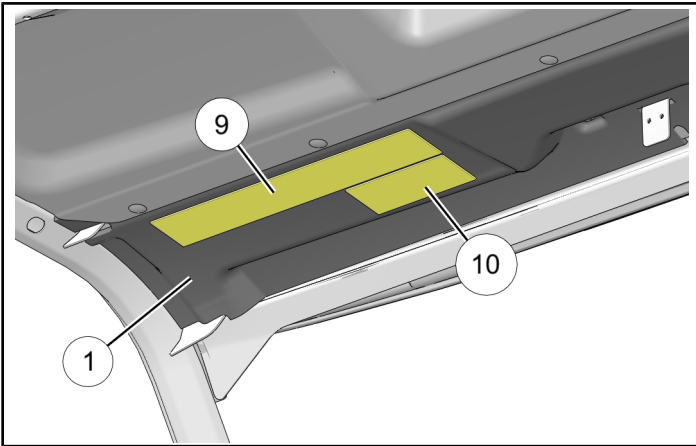

8. If installing optional rear speakers, then refer to instructions included with speakers.

## FEEDBACK FORM

A feedback form has been created for the installer to provide any comments, questions or concerns about the installation instructions. The form is viewable on mobile devices by scanning the QR code or by clicking [HERE](#) if viewing on a PC.

