



# PARKING BRAKE PADS AND SHIMS KIT

## KIT PN 2203148, 2203147

### Application

2005/2006 RANGER 500/700 2X4, 4X4, 6X6

Before you begin, read these instructions and check to be sure all parts and tools are accounted for.

Please retain these installation instructions for future reference and parts ordering information.

### This kit includes:

Qty.	Part Description	Part No.
1	Stator Assembly(Pad and Holder)	
1	Stator Assembly(Pad and Holder)	
1	Shim pack	
1	Hardened Thrust Washer	
2	Compression Spring	
1	Instructions	9920581

**NOTE:** Kit 2203147 has both pad holders

### You will need to supply:

- Two 9/16" Wrenches
- Dial Caliper
- Torque Wrench
- Allen Wrench(some 2006 models)

**IMPORTANT:** For your safety, and to ensure a satisfactory installation, perform all installation steps correctly in the sequence as shown on the attached instructions.

**NOTE:** Do not get oil, grease, or any other fluid on the park brake pads. Damage to or contamination of the pads may cause the pads to function improperly.

## INSTALLATION INSTRUCTIONS

1. Remove the clip pin and pin from the park brake cable.

**NOTE:** Be sure the park brake is not engaged.

2. Slightly loosen the caliper assembly bolts before removing the caliper assembly. This will ease the caliper disassembly procedure later.
3. Loosen the two mount bolts in equal increments. Remove the bolts from the frame and lift park brake caliper assembly out.
4. Remove the two assembly bolts.
5. Slide brake pads off assembly sleeves.
6. Inspect brake pads linings for excessive wear. Replace as needed.
7. Check the three steel balls for any signs of cracking. Replace as needed.
8. Checkball seats in lever and stationary actuator. If excessively worn, replace parts as needed.

9. With stationary actuator, assemble parts in order as shown in the assembly view below. Do not install separator springs or 0.010" thick shims yet. Measure the gap for the brake disk. Disassemble and add shims between hardened washer and inside brake pad as needed to close the gap to 0.203-0.193. Reassemble brake with separator springs. **Note:** There maybe more parts in the service kit than your brake requires. Check the parts list for exact quantities.

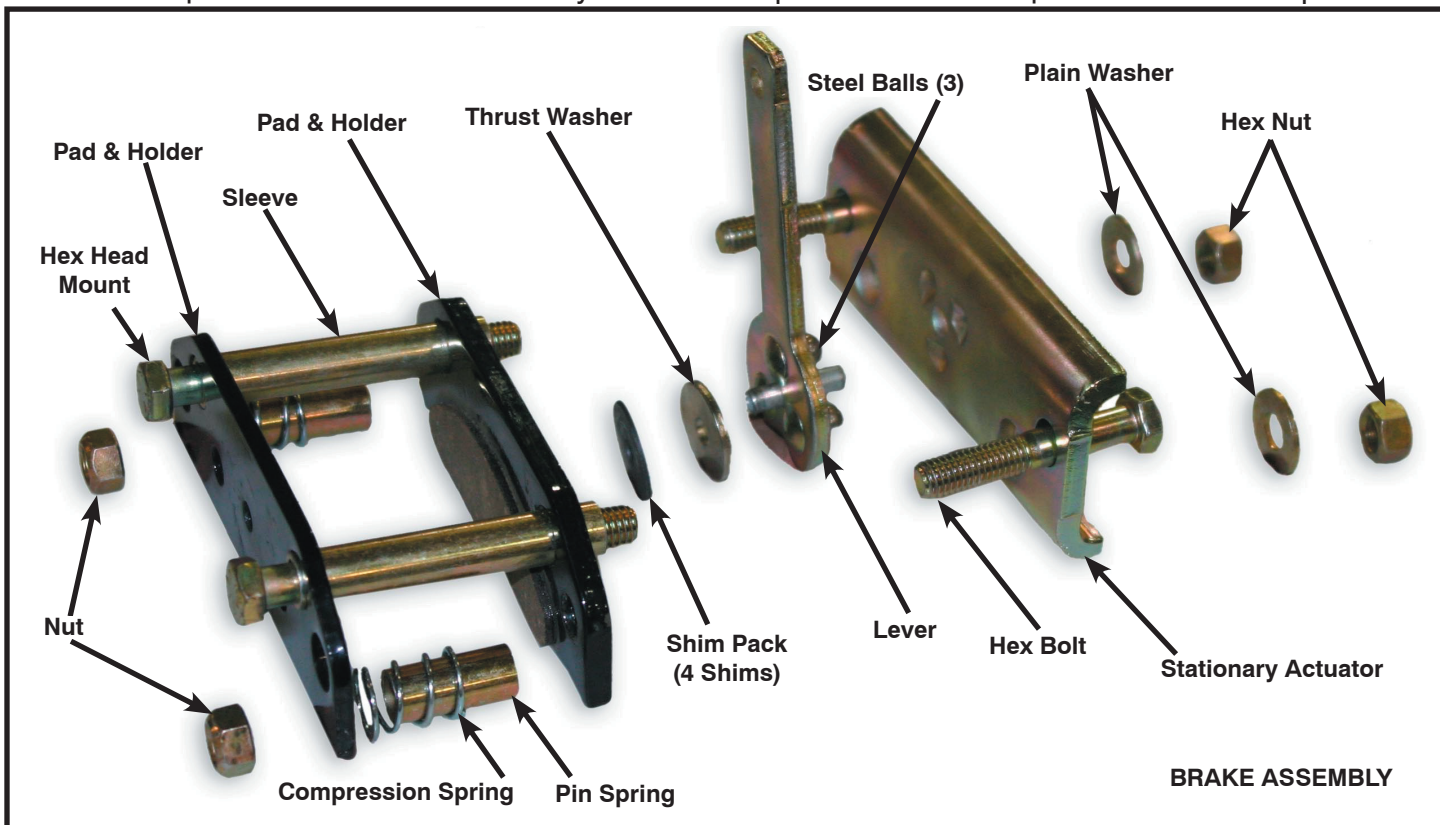

10. Slide assembly bolts through assembly sleeves. Install nuts and tighten to 30-35 ft. lb.
11. Slide mount bolts through mount sleeves of brake. Install hardened washers between bolts and vehicle frame. Install nuts on back of frame. Tighten hex-head bolts to 24 ft. lb. **NOTE:** Some 2006 models and beyond use Allen-head shoulder bolts in place of the sleeves and hardened washers. Tighten shoulder bolts to 30 ft. lb.
12. Install the clip pin and pin from the park brake cable to the actuating lever.
13. Adjust park brake cable and test park brake application, to make sure the pad slides freely on the mount pin and sleeve.
14. Ensure no park brake caliper drag as the disc is rotated.

## Park Brake Caliper Disassembly / Pad Inspection / Pad Installation

1. Measure the thickness of the rear caliper parking brake pads. Replace pads as needed. See ILL. 1 for proper specifications.

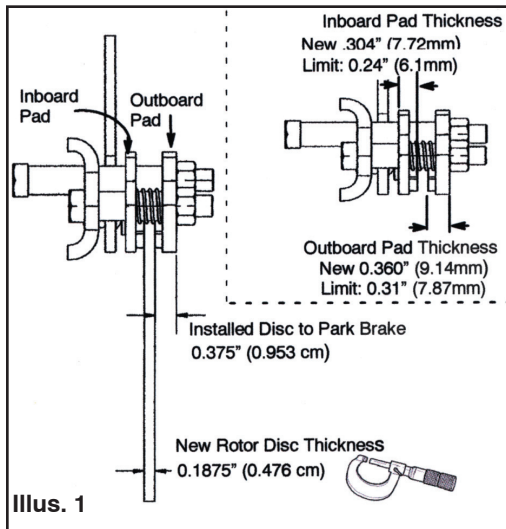

2. Remove the two caliper assembly nuts (A).

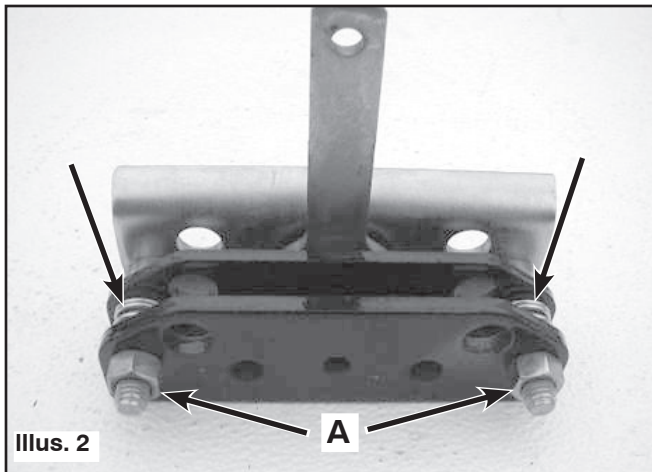

3. Slide the brake pads and springs from the assembly.

**NOTE:** Maintain the lever and the three steel balls for re-assembly.

4. Install the inner brake pad, springs, and outer brake pads. Install the nuts and tighten.

**NOTE:** Torque the caliper assembly nuts as shown in Step 7.

5. Ensure the park brake assembly functions properly by actuating the lever before re-installation.

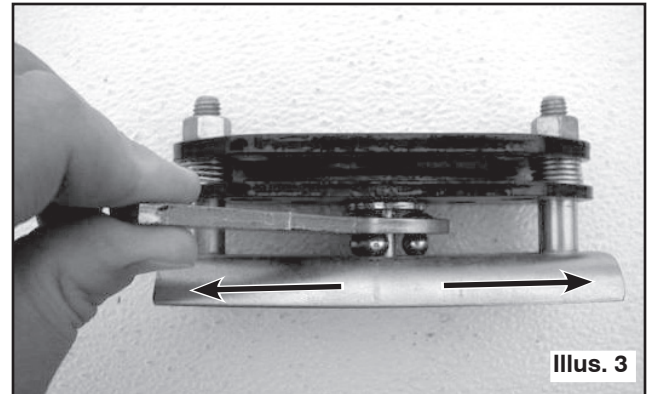

## Park Brake Caliper Installation

6. Install the park brake assembly into place. Tighten the two bolts in increments for proper installation.
7. Torque the two mounting bolts to 18 ft.lbs. (24 Nm); for models with shoulder bolts torque to 30 ft. lbs. (41 Nm)

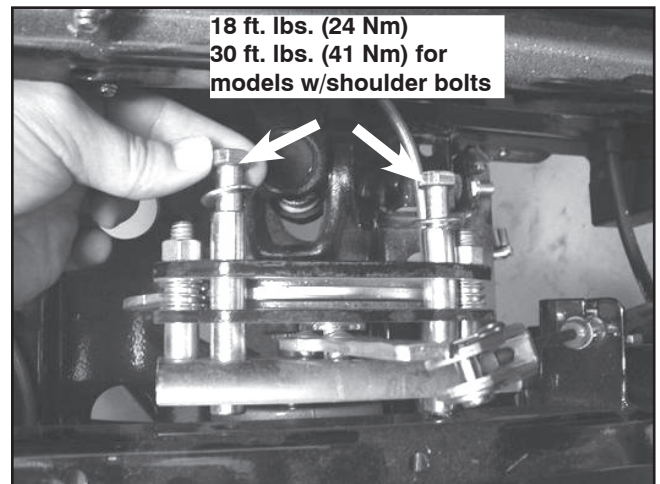

8. Install the cable, pin, and clip pin. Torque the park brake for proper function.



## PARKING BRAKE REAR CALIPER REMOVAL / INSTALL / PAD REPLACEMENT

**NOTE:** Do not get oil, grease, or fluid on the parking brake pads. Damage to the pads may cause the pads to function improperly.

**NOTE:** The RANGER 4x4 parking brake is shown in this procedure, the RANGER 6x6 is very similar.

1. Remove the clip pin and pin (B) from the parking brake cable. **NOTE:** Be sure the parking brake is not engaged.

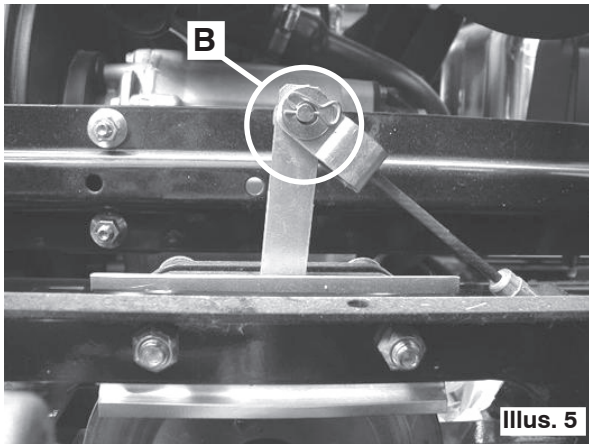

2. If replacing the brake pads, slightly loosen the caliper assembly bolts before removing the caliper assembly (see Ill. 6). This will ease the caliper disassembly procedure later.

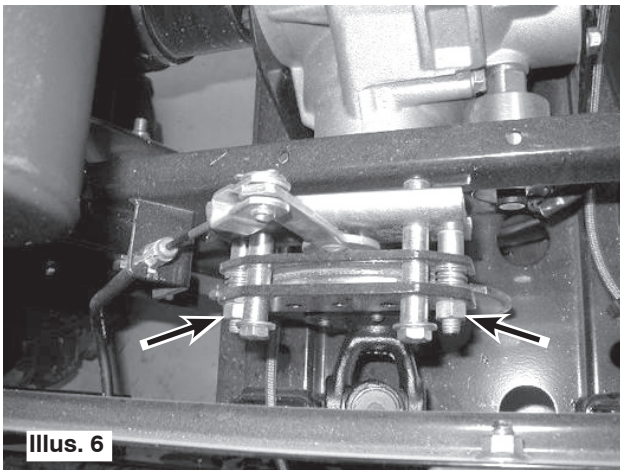

3. Loosen the two brake caliper bolts (C) in equal increments. Remove the bolts from the frame and lift park brake assembly out.

