

# SPARE TIRE RACK KIT



P/N 2883745-XXX, 2884669

## APPLICATION

Verify accessory fitment at [Polaris.com](https://www.polaris.com).

## BEFORE YOU BEGIN

Read these instructions and check to be sure all parts and tools are accounted for. Please retain these installation instructions for future reference and parts ordering information.

## REQUIRED SOLD SEPARATELY

Only parts for installation of the Spare Tire Rack Kit are included. For complete installation on multi-passenger vehicles, the following additional kit is required (sold separately):

- *Spare Tire Rack Mount Kit*, P/N 2884669 (Multi-Passenger Vehicles Only)

## KIT CONTENTS

### SPARE TIRE RACK KIT, P/N 2883745-XXX

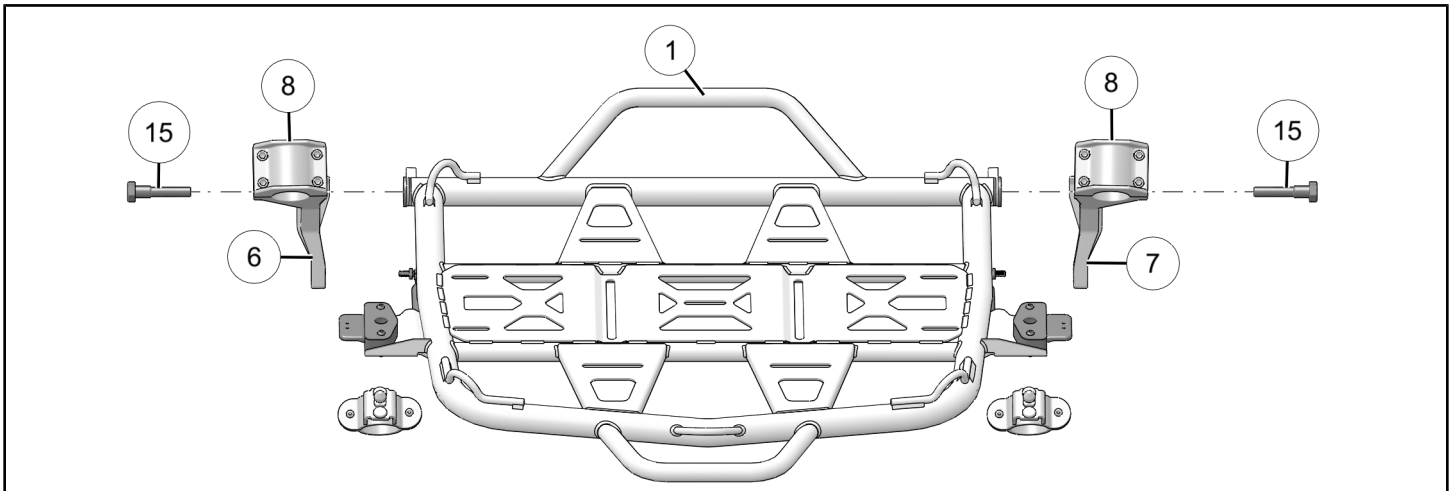

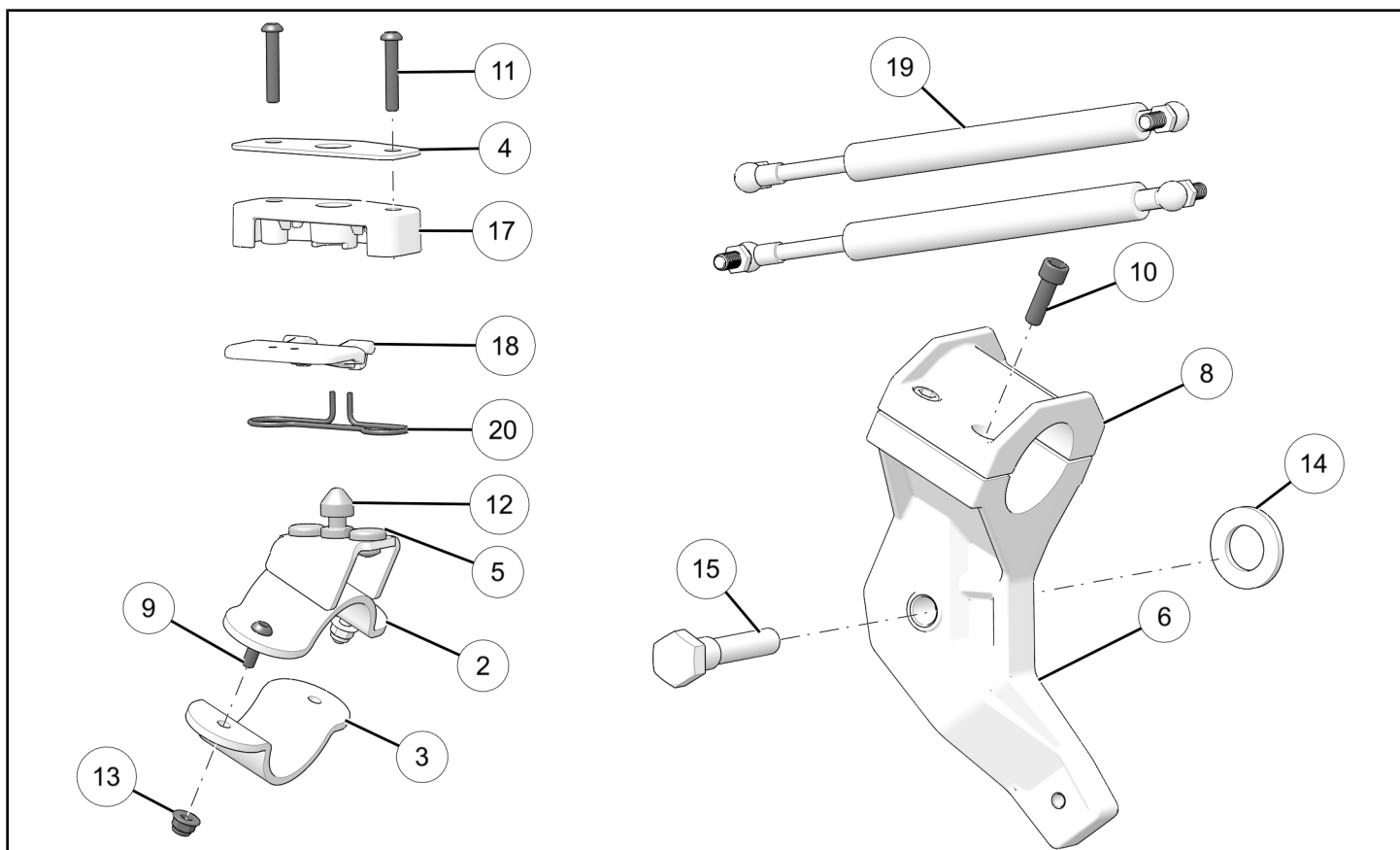

REF	QTY	PART DESCRIPTION	P/N AVAILABLE SEPARATELY	AVAILABLE SERVICE KIT
1	1	Weld-Rack, Spare Tire	n/a	n/a
2	2	Weld-Post Clamp, Black	1024952-458	n/a
3	2	Bracket-Clamp, Tube, Black	5267923-458	n/a
4	2	Plastic-Backer, Latch, Black	5268453-458	n/a
5	4	Bumper-Rubber	n/a	2207772
6	1	Pivot-Rack, Spare Tire, Left-Hand, Black	5634203-458	n/a
7	1	Pivot-Rack, Spare Tire, Right-Hand, Black	5634204-458	n/a
8	2	Clamp-Pivot, Black	5634205-458	n/a
9	4	Screw-Hex Button Head, M6 x 1.0 x 20	7517391	2207772
10	8	Screw-Socket Head, M8 x 1.25 x 25	7518142	2207772
11	4	Screw-Hex Button Head, M6 x 1.0 x 35	7519253	2207772
12	2	Plunger-Latch, Thread	n/a	2207772
13	4	Nut-Hex Flange, M6 x 1.0	7547453	2207772
14	2	Bushing-Pivot	n/a	2207772
15	2	Pin-Pivot, M16, Threaded	n/a	2207772
16	1	Assembly-Strap, Tire (not shown)	2689506	n/a
17	2	Plate-Top, Latch	5437119	n/a

REF	QTY	PART DESCRIPTION	P/N AVAILABLE SEPARATELY	AVAILABLE SERVICE KIT
18	2	Handle–Latch	5437121	n/a
19	2	Strut–Gas	7045212	n/a
20	2	Spring–Latch	7081466	n/a

## SPARE TIRE RACK MOUNT KIT, P/N 2884669 (MULTI-PASSENGER VEHICLES ONLY)

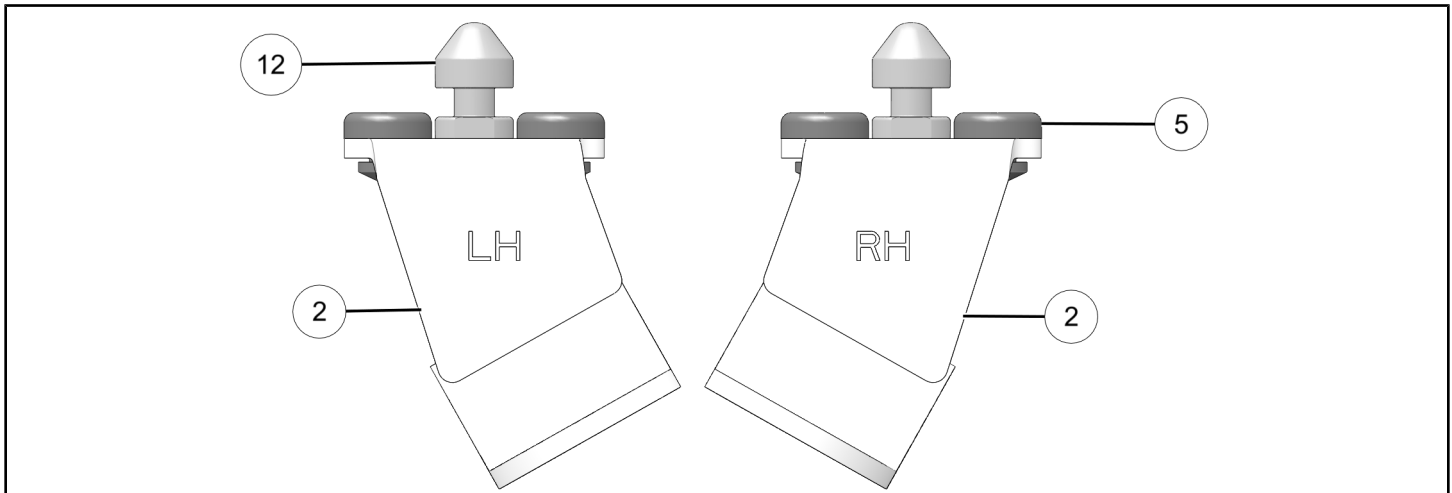

REF	QTY	PART DESCRIPTION	P/N AVAILABLE SEPARATELY	AVAILABLE SERVICE KIT
2	1 1	Weld–Post Clamp, Right-Hand Weld–Post Clamp, Left-Hand	n/a n/a	n/a n/a
5	4	Bumper–Rubber	n/a	2207772
12	2	Plunger–Latch, Thread	n/a	2207772

## TOOLS REQUIRED

- Safety Glasses
- Hammer, Soft Face
- Hex Key Set, Metric
- Socket Set, Hex Bit, Metric
- Socket Set, Metric
- Tape Measure
- Torque Wrench
- Wrench Set, Metric

## IMPORTANT

Your Spare Tire Rack Kit is exclusively designed for your vehicle. Please read the installation instructions thoroughly before beginning. Installation is easier if the vehicle is clean and free of debris. For your safety, and to ensure a satisfactory installation, perform all installation steps correctly in the sequence shown.

# INSTALLATION INSTRUCTIONS

## NOTE

Due to weight of kit components, Polaris® recommends two people install this kit.

## ⚠ WARNING

Use caution when securing tire and latching rear tire rack. Failure to properly secure tire and latch tire rack can result in tire rack components and/or tire to separate from vehicle and cause an accident, resulting in serious personal injury or death.

## VEHICLE PREPARATION

### GENERAL

1. Shift vehicle transmission into PARK. Turn ignition switch to OFF position and remove key from vehicle.

### ACCESSORY INSTALLATION

1. Align pivot bracket ⑥ and clamp ⑧ with one another on rear ROPS. Loosely install with four pivot fasteners ⑩.

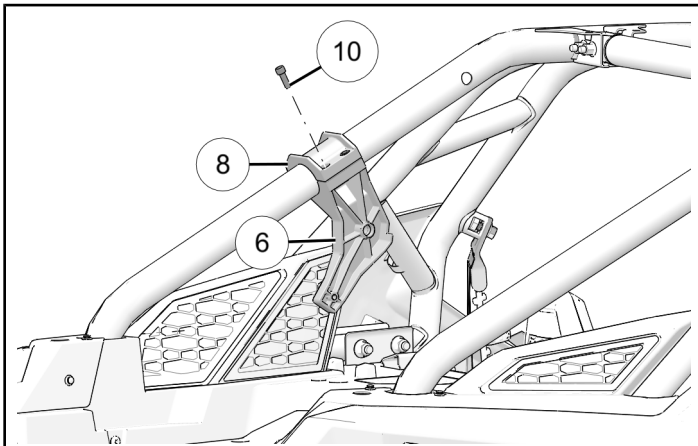

2. Position pivot bracket assembly at specified location.

## TIP

Pivot bracket assembly should be loose enough that it can be repositioned with soft face hammer, if needed.

- Two Passenger

## MEASUREMENT

Measurement ①:  
Inside edge of ROPS hole to face of clamp.  
**9-1/4 in (234.9 mm)**

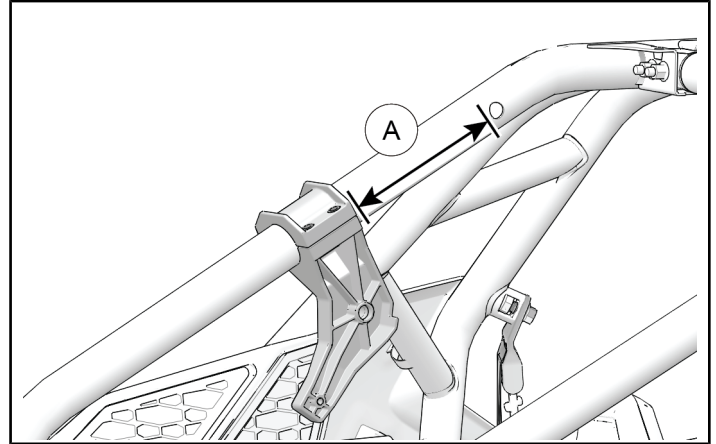

- Multi-Passenger

## TORQUE

Measurement ①:  
Inner fender to intersection of clamp face and ROPS tube.  
**13-1/2 in (342.9 mm)**

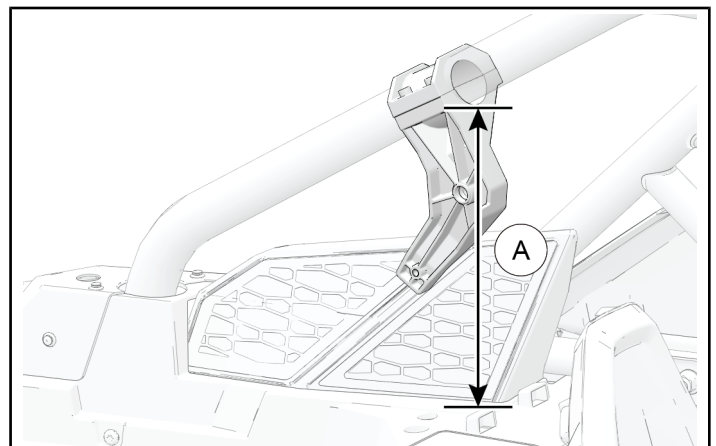

3. Repeat steps 1-2 for opposite side.

4. Verify that pivot bracket assemblies are at equal height along rear ROPS and equally spaced across vehicle. Verify distance between two assemblies.

#### TIP

Pivot bracket assembly should be loose enough that it can be repositioned with soft face hammer, if needed.

#### MEASUREMENT

Measurement ⑧:

Inside bottom of clamp to inside bottom of clamp.

Two Passenger	31–3/16 in (792.0 mm)
Multi-Passenger	31 in (788.0 mm)

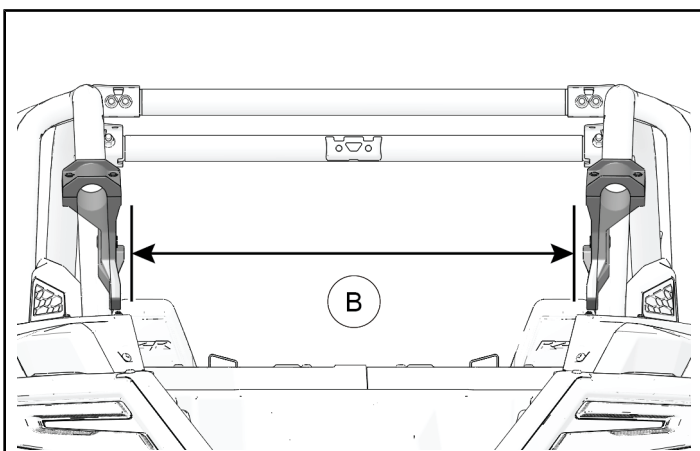

5. Install one strut ⑲ on each side. Note orientation of strut in graphic below.

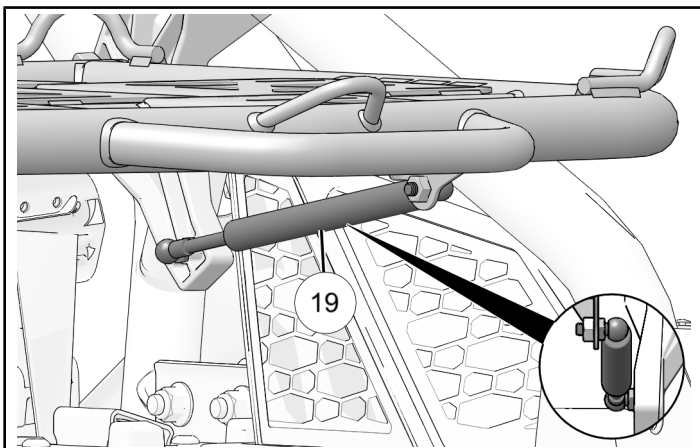

6. Position tire rack in rear cargo box and pass pin ⑮ through pivot bracket, bushing ⑭ (two passenger vehicles only), and thread into tire rack.

#### TIP

Pivot bracket may require adjustment to properly align with tire rack.

#### IMPORTANT

Bushing ⑭ not used on multi-passenger vehicles.

#### TORQUE

Pin ⑮:

60 ft-lbs (81 N·m)

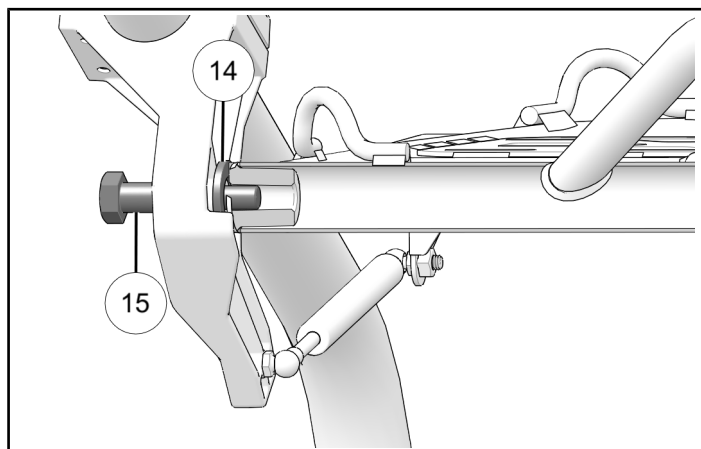

7. Verify pivot bracket distance apart from one another.

#### MEASUREMENT

Measurement ⑧:

Inside bottom of clamp to inside bottom of clamp.

Two Passenger	31–3/16 in (792.0 mm)
Multi-Passenger	31 in (788.0 mm)

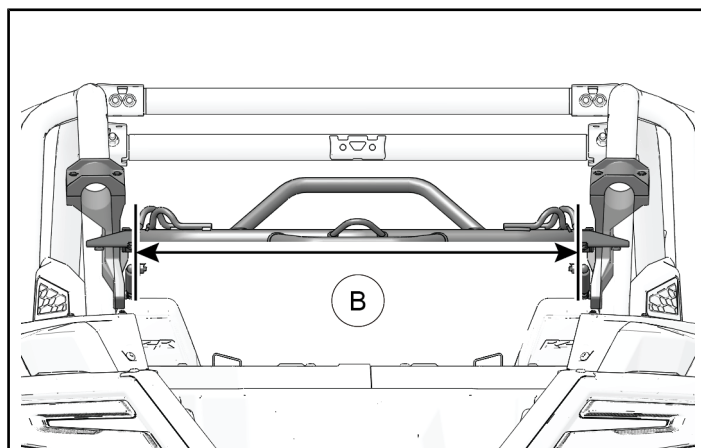

8. Verify assembly positioning before torquing pivot bracket fasteners.

#### TORQUE

Pivot Bracket Fasteners ⑩:  
**16 ft-lbs (22 N·m)**

- Two Passenger

#### MEASUREMENT

Measurement ①:  
Inside edge of ROPS hole to face of clamp.  
**9-1/4 in (234.9 mm)**

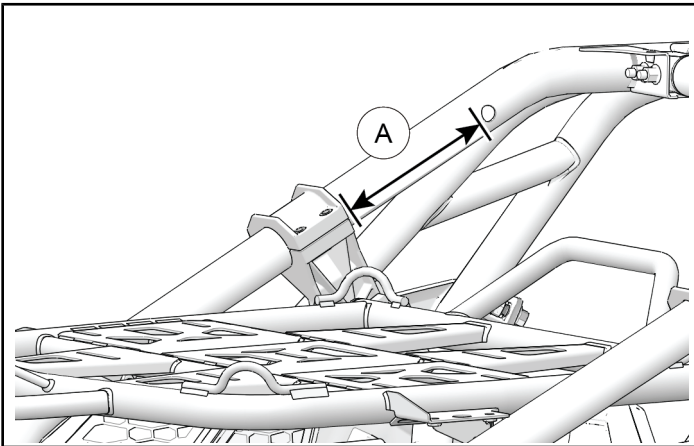

- Multi-Passenger

#### TORQUE

Measurement ①:  
Inner fender to intersection of clamp face and ROPS tube.  
**13-1/2 in (342.9 mm)**

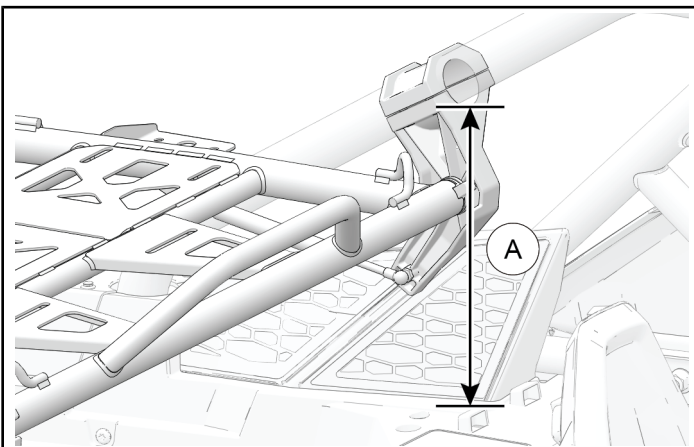

9. Install each post clamp onto ROPS with clamp bracket ③, two clamp fasteners ⑨, and two clamp nuts ⑬. Ensure latch plunger aligns with tire rack, as shown.

#### IMPORTANT

*Spare Tire Rack Mount Kit*, P/N 2884669 must be used for this step if installing on multi-passenger vehicle. Follow **RH** or **LH** markings for proper placement.

#### IMPORTANT

Clamp brackets will be very close to ROPS curve when correctly positioned. Accurate alignment is critical to spare tire rack functionality. Ensure rack can be raised and lowered onto latch plungers without interference.

#### TORQUE

Clamp Fasteners ⑨:  
**9 ft-lbs (12 N·m)**

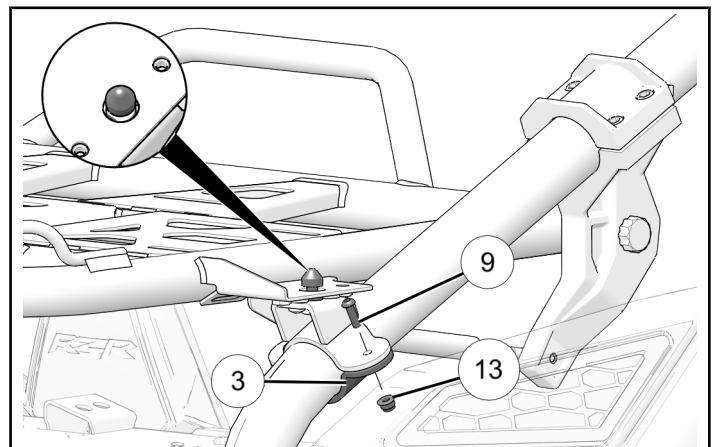

10. Hook handle ⑮ onto latch spring ⑳ and install into bottom of latch plate ⑰. Pass two latch fasteners ⑪ through latch backer ④ before installing latch assembly to post clamp. Repeat this procedure for opposite side.

#### TORQUE

Latch Fasteners ⑪:  
**9 ft-lbs (12 N·m)**

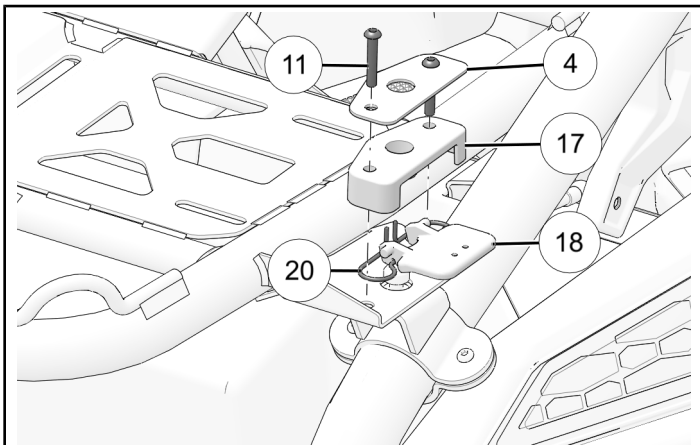

11. Ensure spare tire rack comes into contact with rubber bumpers on both sides. Inconsistent contact may result in one or two dysfunctional latches.

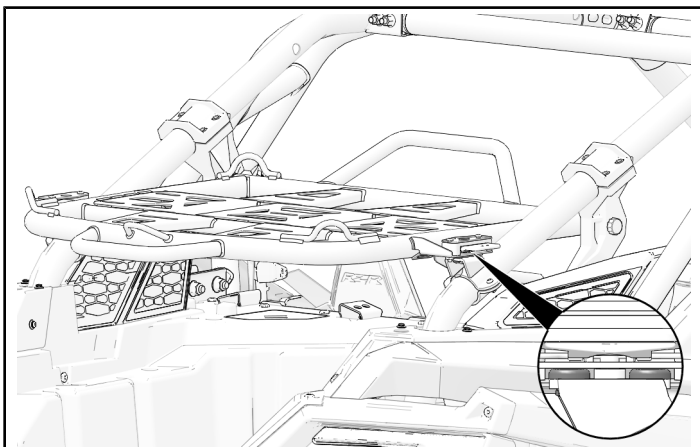

## FEEDBACK FORM

A feedback form has been created for the installer to provide any comments, questions or concerns about the installation instructions. The form is viewable on mobile devices by scanning the QR code or by clicking [HERE](#) if viewing on a PC.

