

TRAILING ARM GUARD KIT

P/N 2879496



Application

RZR XP 1000, RZR XP4 1000

Before you begin, read these instructions twice and check to be sure all parts and tools are accounted for. Please retain these installation instructions for future reference and parts ordering information.

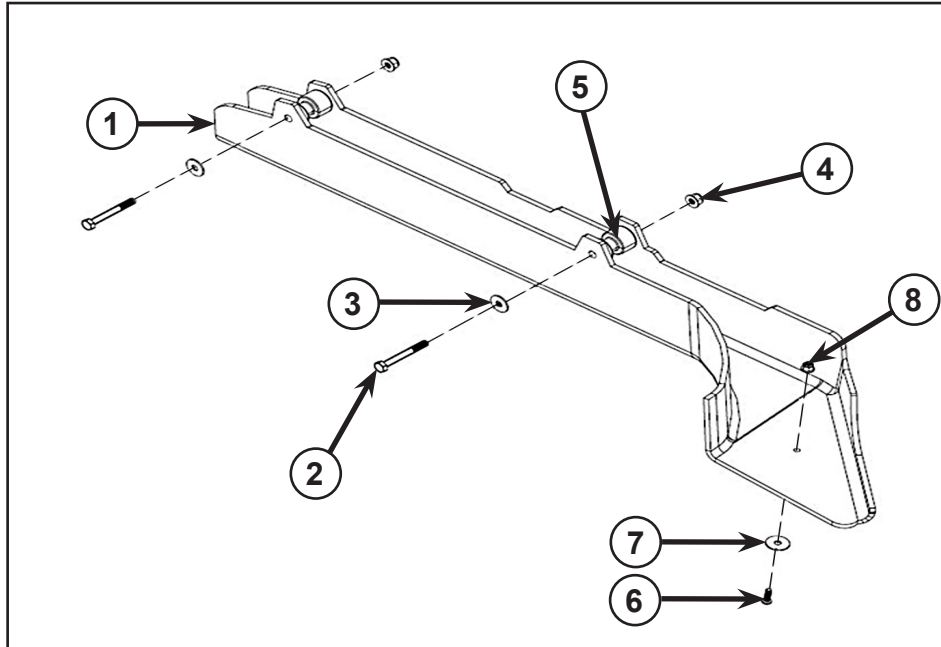

Kit Contents:

<u>Ref</u>	<u>Qty</u>	<u>Part Description</u>	<u>Part Number</u>
1	2	Trailing Arm Guard	-
2*	4	Screw-HXFL-M8X1.25X65	-
3*	4	Washer, Fender-M8	-
4*	4	Flange Nut-M8X1.25, Nyloc	-
5*	4	Bushing	-
6*	2	Screw, Button HD M6-1.0X20, Black RIE	-
7*	2	Washer, Fender-1/4", Black Zinc	-
8*	2	Flange Nut-M6X1.0, Nyloc	-
9	2 ft	Foam	-
10	4	Spacer, Brakeline (Black Anodized)	-
	1	Instructions	9924563

Items marked (*) are included in Hardware Kit PN 2205185.

Tools Required:

Safety Goggles
Metric Allen Set
Metric Socket Set
Metric Wrench Set

APPROXIMATE ASSEMBLY TIME: 10-15 minutes

IMPORTANT: Your Polaris TRAILING ARM GUARD is exclusively designed for your vehicle. Please read the installation instructions thoroughly before beginning. Installation is easier if the vehicle is clean and free of debris. For your safety, and to ensure a satisfactory installation, perform all installation steps correctly in the sequence shown.

INSTALLATION INSTRUCTIONS:

1. Place the vehicle transmission in "PARK" and turn the key to "OFF" position. Remove the key from vehicle.
2. Get under the vehicle, slide and place the trailing arm guard. Figure 1.

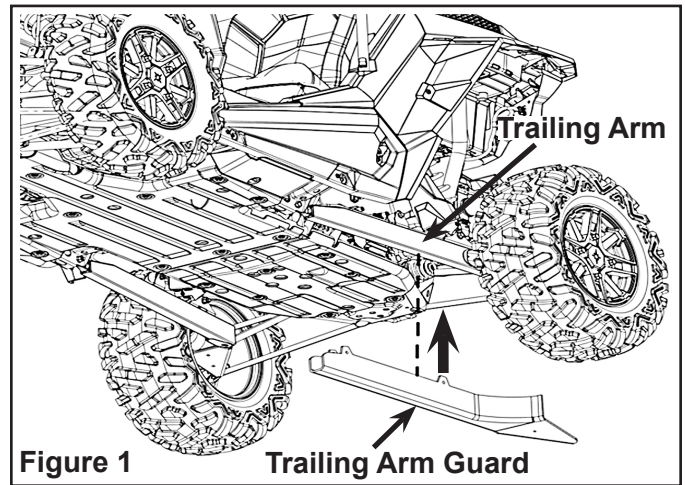

3. Install the trailing arm guard onto the trailing arm from the underside of the vehicle. Figure 2.

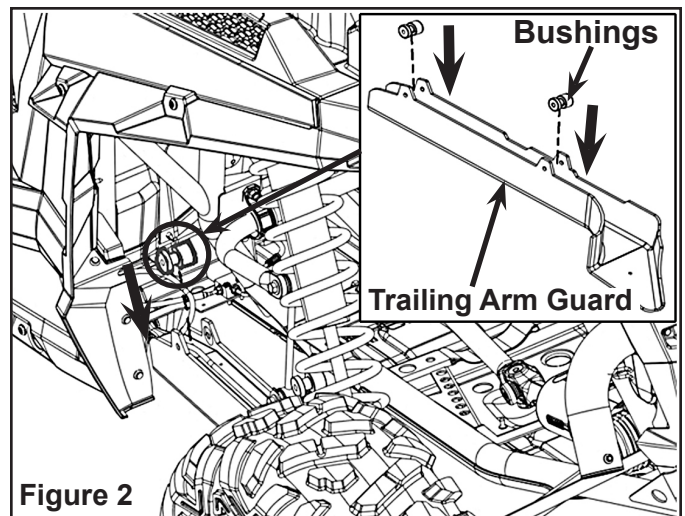

4. Install M8 screws, Bushings, M8 washers, and M8 nuts on guard at two locations. Figure 3.

NOTE: Tightening torque: 12-15 lbs. (53.3-66.7 N).

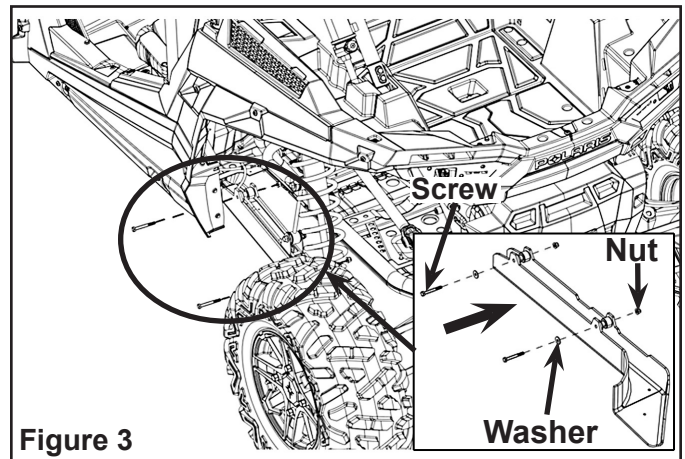

5. Attach the M6 screw, M6 washer and M6 nut.
Figure 4.

NOTE: Tightening torque: 12-15 lbs. (53.3-66.7 N).

6. Repeat the same procedure again to install the trailing arm guard on the other side.

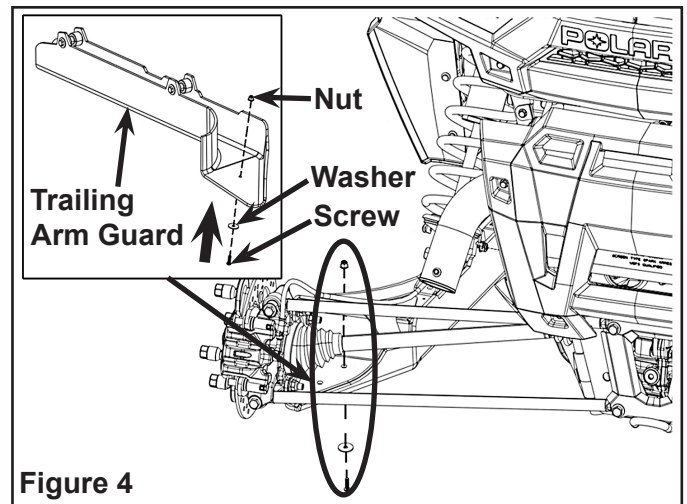

Figure 4