

SKID PLATE KIT



P/N 2880291

APPLICATION

RZR 4 900

BEFORE YOU BEGIN

Read these instructions thoroughly and make sure all parts and tools are accounted for. Please retain these installation instructions for future reference and parts ordering information.

KIT CONTENTS

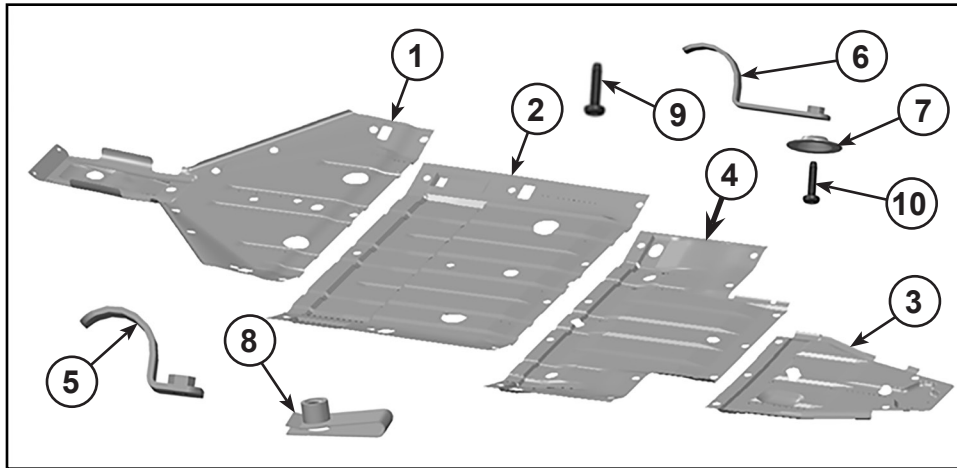

| Ref | Qty | Part Description | Part Number |
|-----|-----|--|-------------|
| 1 | 1 | Skid Plate, Front | 5451379 |
| 2 | 1 | Skid Plate, Middle | 5451380 |
| 3 | 1 | Skid Plate, Rear | 5451381 |
| 4 | 1 | Middle Skid Plate, Rear | 5451382 |
| 5* | 8 | J-Hook, 1.25" Dia | - |
| 6* | 4 | J-Hook, 1.75" Dia | - |
| 7* | 26 | Cup Washer | - |
| 8* | 4 | U-Clip | - |
| 9* | 2 | Torx Screw-M6X1.0X16 HD, Self Drilling | - |
| 10* | 26 | Torx Screw-M6X1.0X25 HD, Self Drilling | - |
| | 1 | Instructions | 9925135 |

ITEMS MARKED (*) ARE INCLUDED IN HARDWARE KIT PN 2205293.

TOOLS NEEDED

Safety Glasses

Torx Wrench Set

Drill and Drill Bits

APPROXIMATE ASSEMBLY TIME

15 mins

IMPORTANT

Your Polaris SKID PLATE KIT is exclusively designed for your vehicle. Please read the installation instructions thoroughly before beginning. Installation is easier if the vehicle is clean and free of debris. For your safety, and to ensure a satisfactory installation, perform all installation steps correctly in the sequence shown.

INSTALLATION INSTRUCTIONS

1. Put the vehicle transmission into “**PARK**” and turn the key to the “**OFF**” position. Remove the key from the vehicle.
2. Remove the stock skid plates (Front (A), Middle (B) and Rear (C)), for removal of plates lift the vehicle and/or get underneath the vehicle and remove M6 screws and relevant washers at twelve places. See Figures.

NOTE: Removed screws and washers should not be reused.

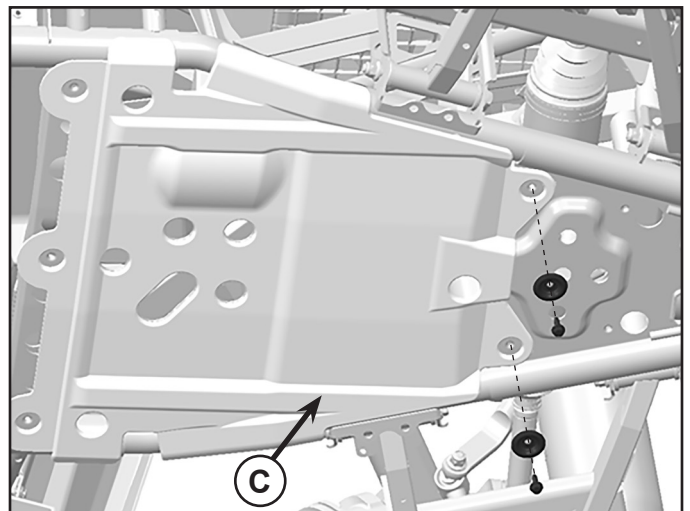
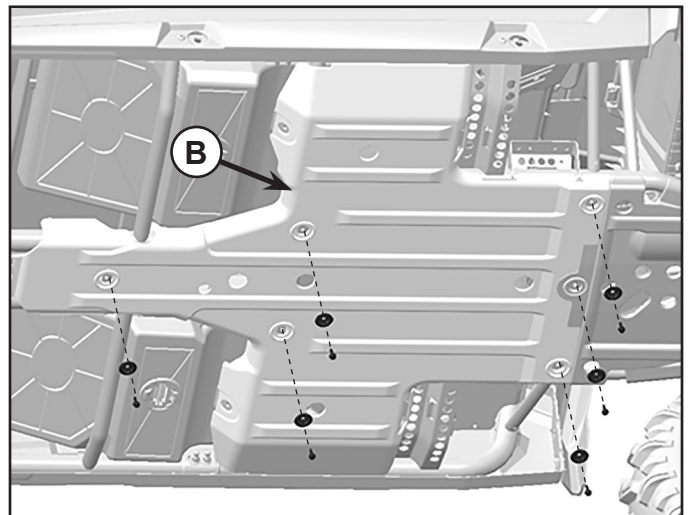
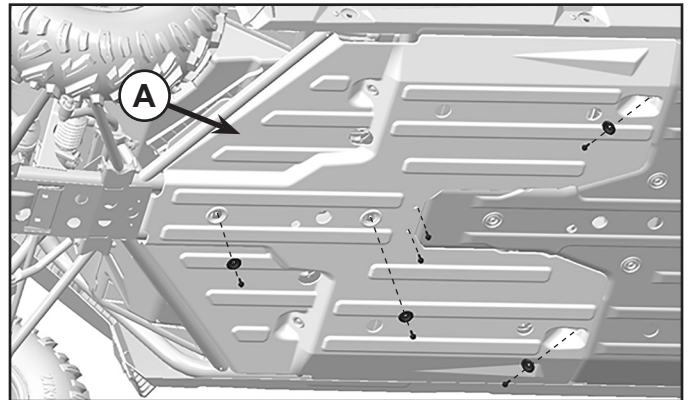

IMPORTANT: Install all fasteners by hand, once all the fasteners are in place tighten to 6 ft. lbs. (8.13 Nm).

3. Install the new rear skid plate (3) using M6 screws (10) and washers (7) at two locations as shown in figure.

NOTE: Do not tighten the screws at this time.

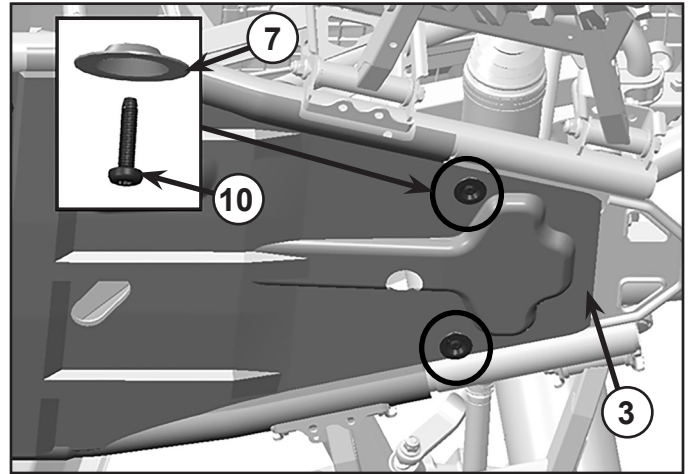

4. Align rear middle skid plate (4) with the three holes of rear skid plates (3) and attach it using M6 screws (10) and relevant washers (7) at three location and use U-clips (8), M6 screws (10) and relevant washers (7) at four locations. See Figure.

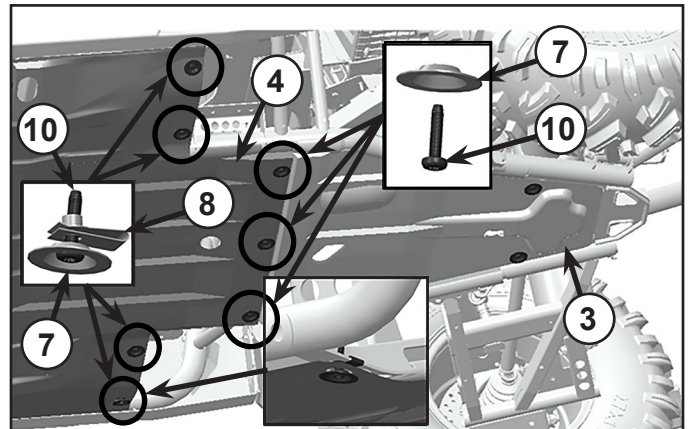

5. Align middle skid plate (2) with the four holes of rear middle skid (4) plates and attach it using J-hooks (6), M6 screws (10) and washers (7) at seven locations. See Figure.

NOTE: Insert J-hooks (5) by hand from the cut-out of skid plate as shown in figure.

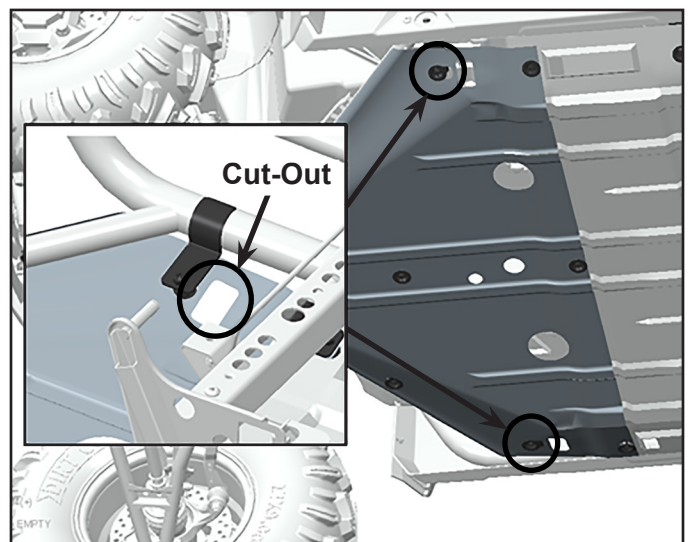
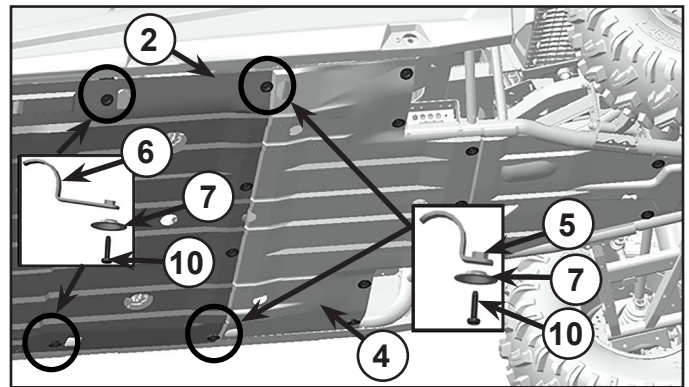

6. Align front skid plate (1) with the three holes of middle skid plates and attach it using J-hooks (6), M6 screws (10) and washers (7) at two locations. Attach the front part of the plate with two M6 screws (9). See Figure.

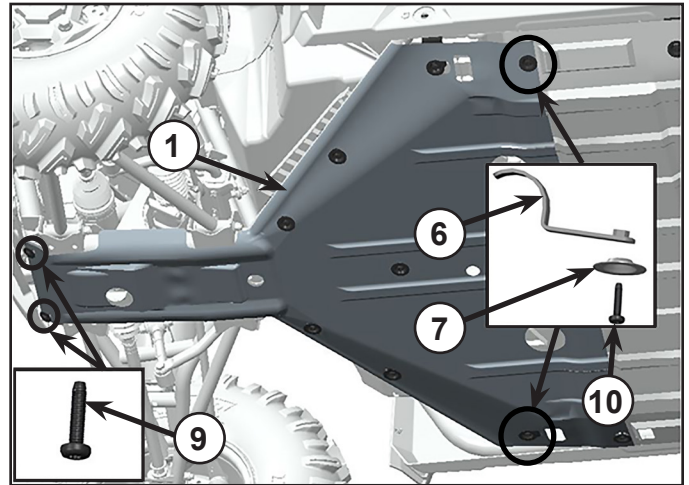

7. Mount the skid plate by using J-hooks (5), M6 screws (10) and washers (7) at six locations.

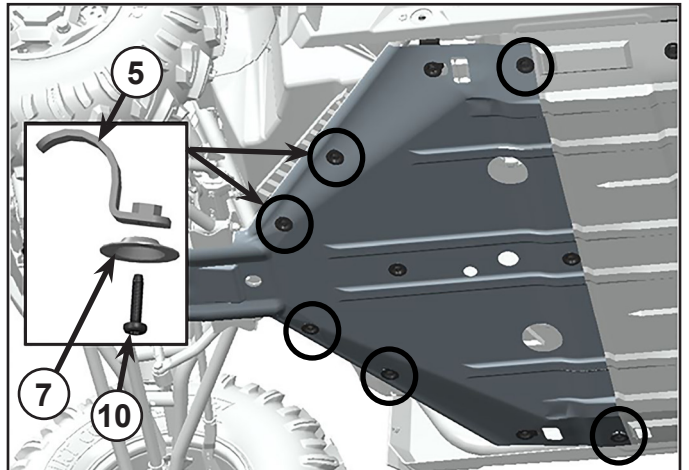

8. Mount the front and middle skid plate with chassis bar by using J-hooks (5, 6), which are fitted to the plate with M6 screws and relevant washers.

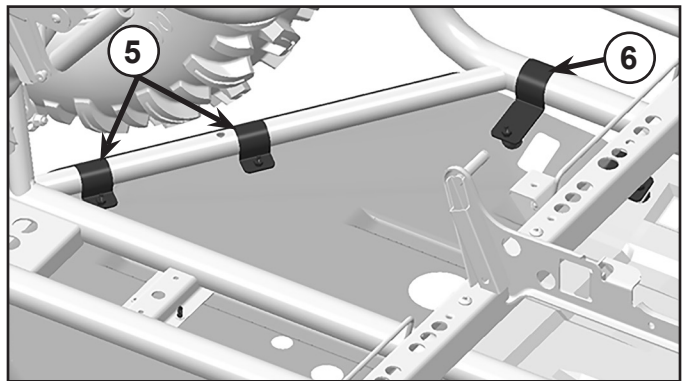

9. Torque all M6 screws to 6 ft. lbs. (8.13 Nm).