

HMW SKID PLATE KIT



P/N 2879455, 2881615

APPLICATION

Verify accessory fitment at Polaris.com.

BEFORE YOU BEGIN

Read these instructions and check to be sure all parts and tools are accounted for. Please retain these installation instructions for future reference and parts ordering information.

KIT CONTENTS

If installing this Skid Plate Kit on MY15 or older RZR vehicles, then Skid Plate Adapter Bracket Kit, PN 2206329 (purchased separately), is also required.

This Kit includes:

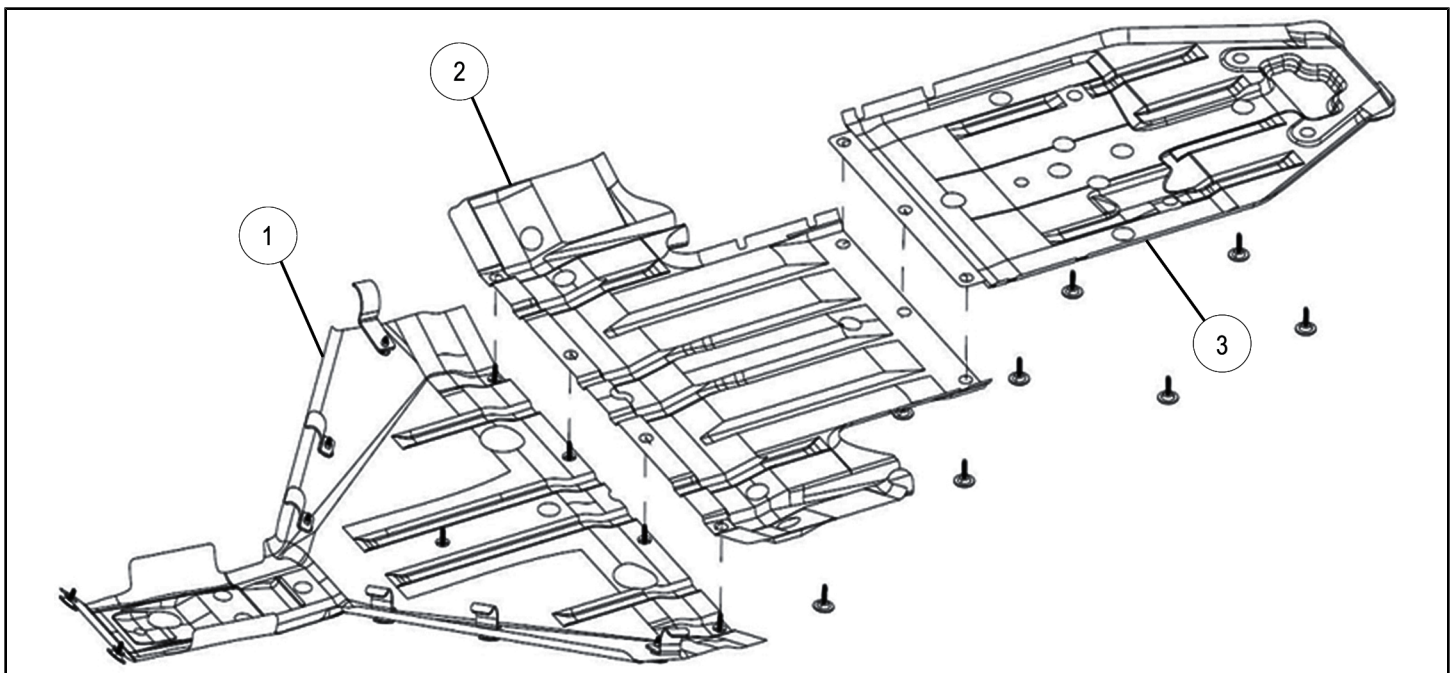

REF	QTY	PART DESCRIPTION	PART NUMBER
1	1	Skid Plate, Front, HMW (High Molecular Weight)	-
2	1	Skid Plate, Middle, HMW (High Molecular Weight)	-
3	1	Skid Plate, Rear, HMW (High Molecular Weight)	-
4*	23	Screw, Torx® - M6 X 1.0 X 25	-
5*	23	Washer, Cup	-
6*	2	Screw, Torx® - M6 X 1.0 X 16	-
7*	4	J-Hook, 1.25 inch Diameter	-
8*	2	J-Hook, 1.75 inch Diameter	-
9*	2	Washer, Flat	-
	1	Instructions	9924774

Items marked (*) are included in Hardware Kit PN 2205208.

TOOLS REQUIRED

- Safety Glasses
- Socket Set, Metric

- Socket Set, Torx® Bit
- Torque Wrench

IMPORTANT

Your HMW SKID PLATE KIT is exclusively designed for your vehicle. Please read the installation instructions thoroughly before beginning. Installation is easier if the vehicle is clean and free of debris. For your safety, and to ensure a satisfactory installation, perform all installation steps correctly in the sequence shown.

ASSEMBLY TIME

Approximately 20–25 minutes

INSTALLATION INSTRUCTIONS

1. Place vehicle in "PARK". Turn key to "OFF" position and remove from vehicle.
2. Remove existing skid plate (A) by removing seventeen screws (B) and washers (C).

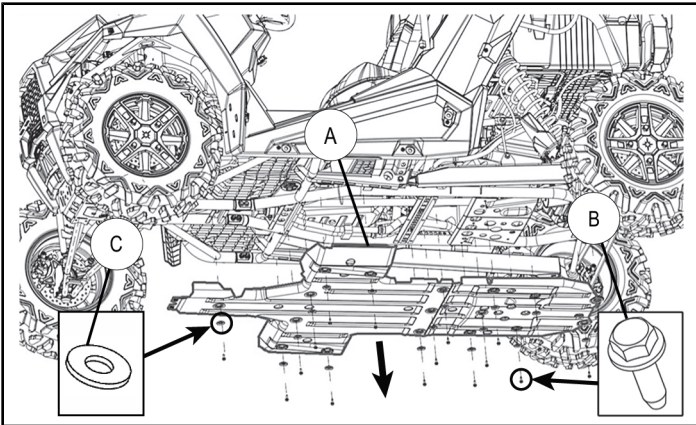

3. If installing this Skid Plate Kit on MY15 or older RZR vehicles, then install Skid Plate Adapter Bracket Kit (PN 2206329, purchased separately) at this time.

NOTE

Skid Plate Adapter Bracket Kit moves two rear fastener attachment locations forward and outboard.

4. Loosely install rear skid plate (3) using five each screws (4) and cup washers (5).

NOTE

Three screws at forward edge of panel will be installed in next step.

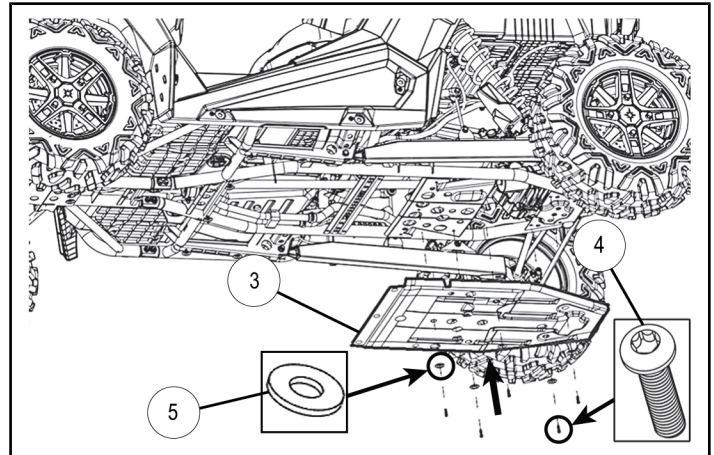

5. Loosely install middle skid plate (2) using five each screws (4) and cup washers (5).

NOTE

Four screws at forward edge of panel will be installed in next step.

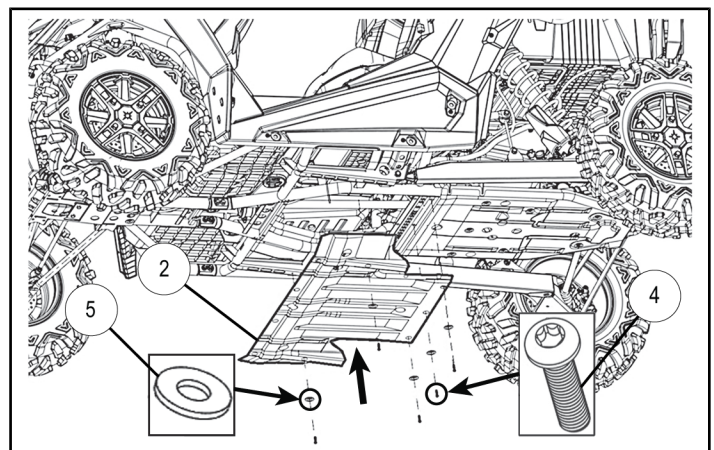

6. Remove LH rocker panel (D) by removing fasteners (E) (six plastic push pins and five screws). Retain fasteners.

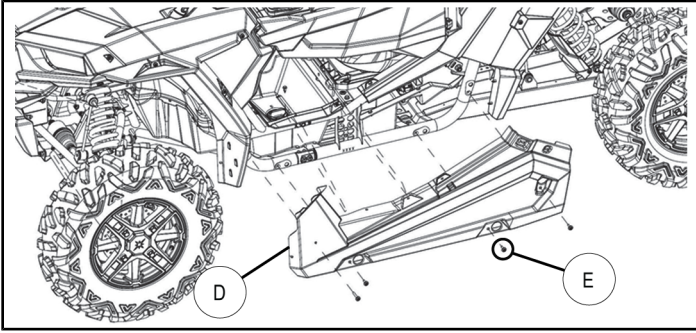

7. Repeat Step 6 for RH rocker panel.
 8. Install front skid plate ①.
 a. Loosely install two J-hooks ⑧ and four J-hooks ⑦ to skid plate using six each screws ④ and cup washers ⑤.

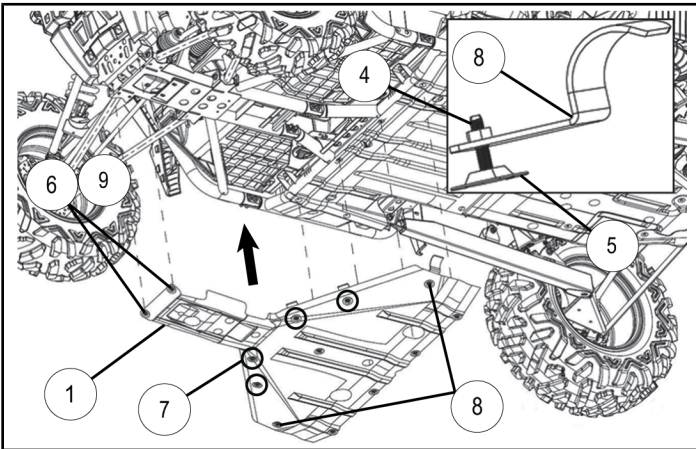

- b. Lift skid plate into place, then install all six J-hooks to vehicle frame.
 c. Loosely install rear edge of skid plate using four each screws ④ and cup washers ⑤.
 d. Loosely install center of skid plate using one each screw ④ and cup washer ⑤.
 e. Loosely install front edge of skid plate using two (short) screws ⑥ and flat washers ⑨.

9. Torque all screws ④ and ⑥ to specification:

**Vehicles WITH Adapter Bracket Kit
 (see Step 3):**

TORQUE

Into vehicle frame and J-hooks: 15 ft. lbs. (20 Nm)
 Into adapter bracket clip nuts: 8 ft. lbs. (11 Nm)

Vehicles WITHOUT Adapter Bracket Kit:

TORQUE

15 ft. lbs. (20 Nm)

10. Reinstall LH and RH rocker panels using retained fasteners (E). Torque screws to specification.

TORQUE

8 ft. lbs. (11 Nm)