

PIDD (POLARIS INTERACTIVE DIGITAL DISPLAY) MOUNT KIT

P/N 2880497



APPLICATION

Verify accessory fitment at Polaris.com.

BEFORE YOU BEGIN

Read these instructions and check to be sure all parts and tools are accounted for. Please retain these installation instructions for future reference and parts ordering information.

KIT CONTENTS

This kit contains parts for installation of the PIDD mount only. Prior installation of one of the following additional kits is also required (sold separately):

- PIDD 2.0 Kit (PN 2881554)
- PIDD Kit (PN 2880402)

This Kit includes:

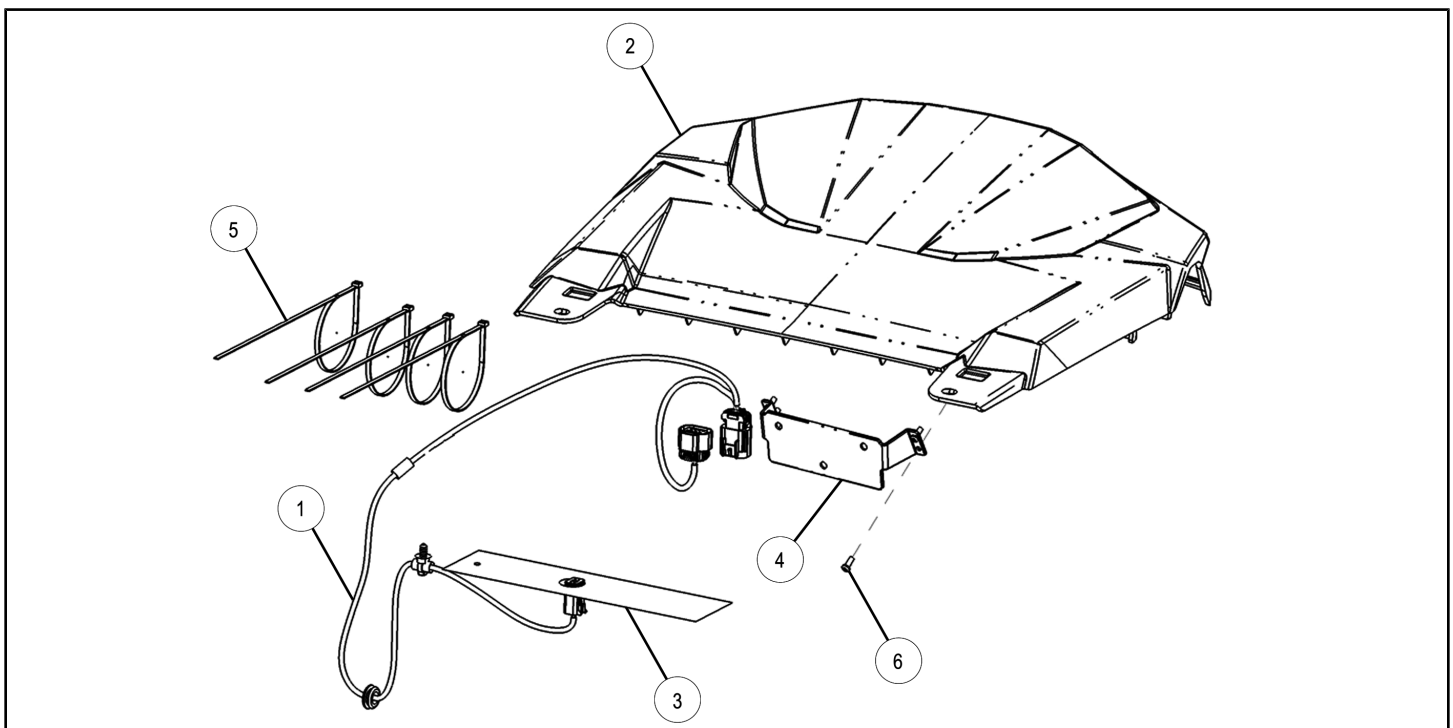

REF	QTY	PART DESCRIPTION	PART NUMBER
1	1	GPS Harness	2412817
2	1	Upper Instrument Panel	2635333
3	1	Paper Template	-
4	1	Mount Bracket, MFD	5451298
5	4	Cable Tie	7080492
6	4	Screw, #10 X 1/2, Hi-Lo, Torx®	7512076
	1	Instructions	9925417

TOOLS REQUIRED

- Safety Glasses
- Drill
- Drill Bit: 1/4 inch, 7/8 inch, 1 inch

- Screwdriver Set, Torx®
- Torque Wrench

IMPORTANT

Your PIDD (POLARIS INTERACTIVE DIGITAL DISPLAY) MOUNT KIT is exclusively designed for your vehicle. Please read the installation instructions thoroughly before beginning. Installation is easier if the vehicle is clean and free of debris. For your safety, and to ensure a satisfactory installation, perform all installation steps correctly in the sequence shown.

ASSEMBLY TIME

Approximately 30 minutes

INSTALLATION INSTRUCTIONS

1. Park the vehicle. Turn key to “OFF” position and remove the key from vehicle.
2. Remove driver’s seat. Disconnect the black negative and the red positive cable from the battery.
3. Remove center hood (A) by twisting two knobs and pulling up from the vehicle.
5. Remove switches, 12V receptacle, and key switch, from old dash panel. Reinstall components into the new instrument panel provided.
6. Center template ③ in between radiator brackets. Small hole on template should be located to the passenger side of the vehicle. Use 1/4 inch drill bit for making small hole and 1 inch drill bit for larger hole for GPS mounting.

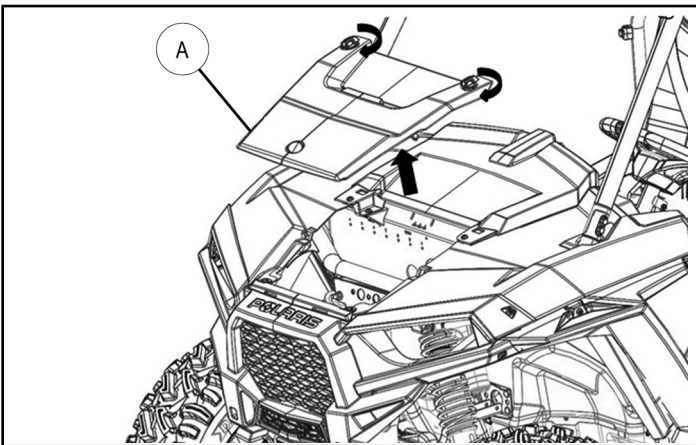

4. Disconnect the switches, connections and remove upper instrument panel (B) by removing two screws (C). Retain the screws for reassembly.

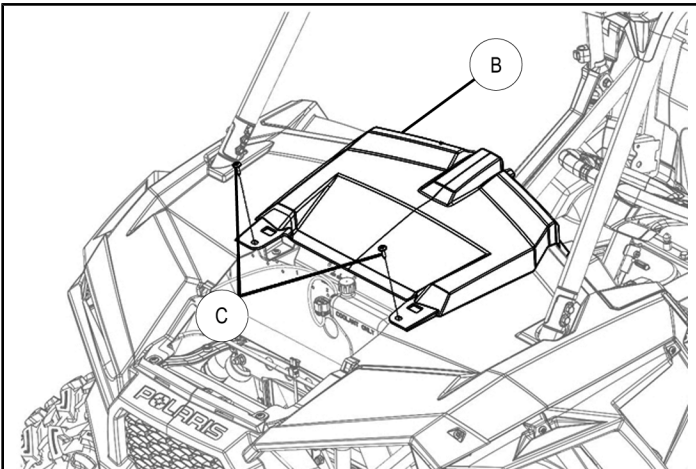

NOTE

Use template on last page for marking hole location on the vehicle.

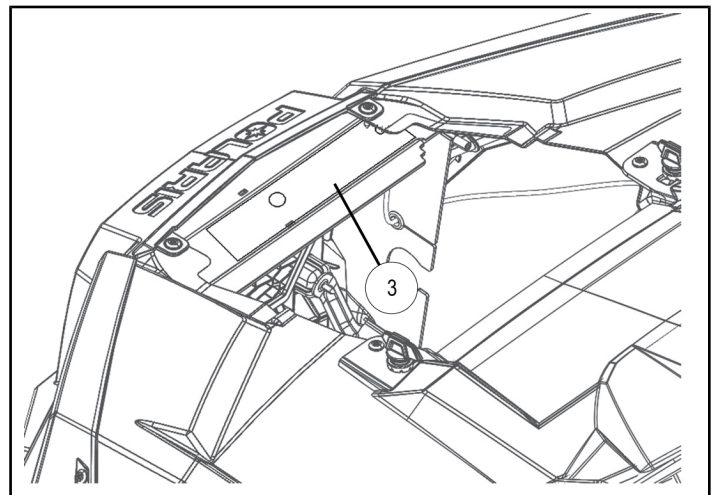

7. Route the GPS harness ① starting from main connector working your way down the frame tube and through the hole in the side of your fan shroud. Push grommet (D) into hole that you previously fed the GPS connector through. Install clamp (E) onto frame brace (F). Ensure the proper fitment of clamps and the grommet and harness routing through it.

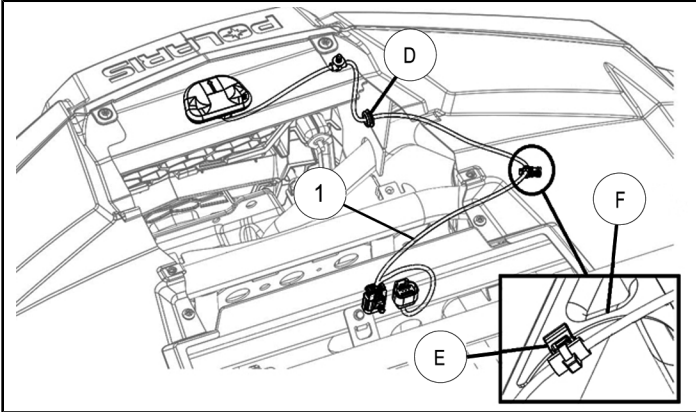

8. Remove cap (G) of GPS connector (H). Connect GPS connector to main harness connector (J).

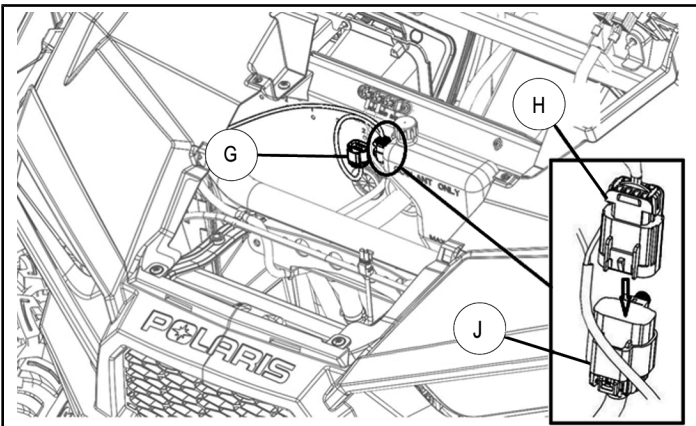

9. Assemble the display (K) and mount bracket ④. Install the display assembly onto the upper instrument panel with four screws ⑥. Torque screws to specification.

NOTE

24 in. lbs. (2.7 Nm)

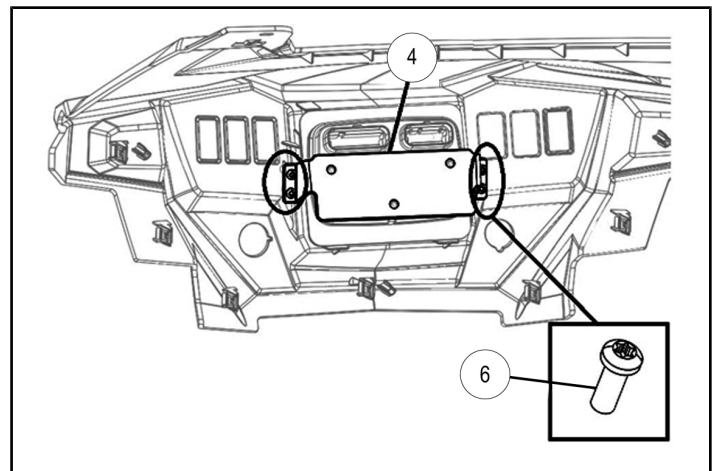
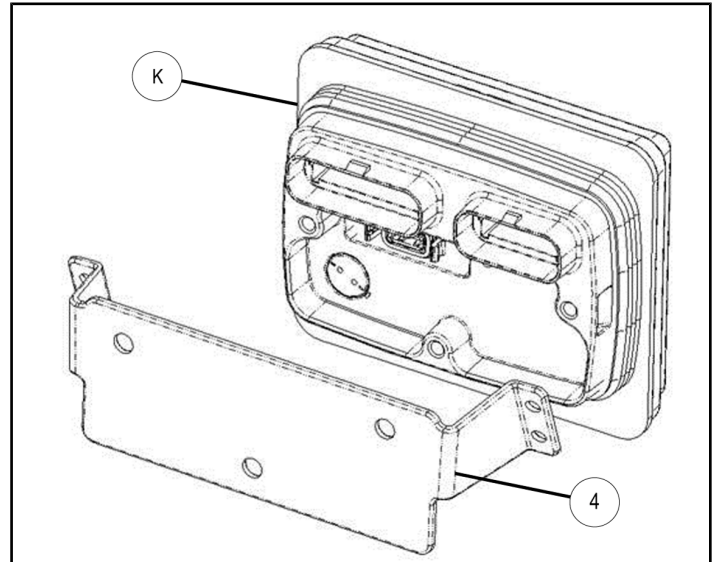

10. Drill a 7/8 inch hole on to the double din panel in the approximate location shown below. Fit the rubber grommet (M) into the drilled hole and pass the USB harness (L) through it. Ensure the harness routed properly.

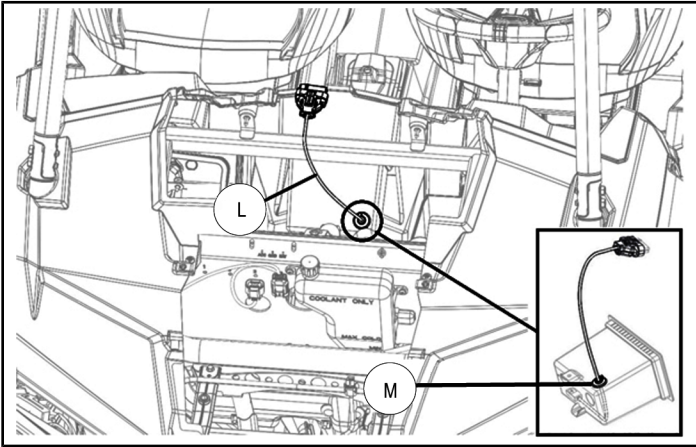

11. Connect the USB harness connector (N) to the digital display box (P).

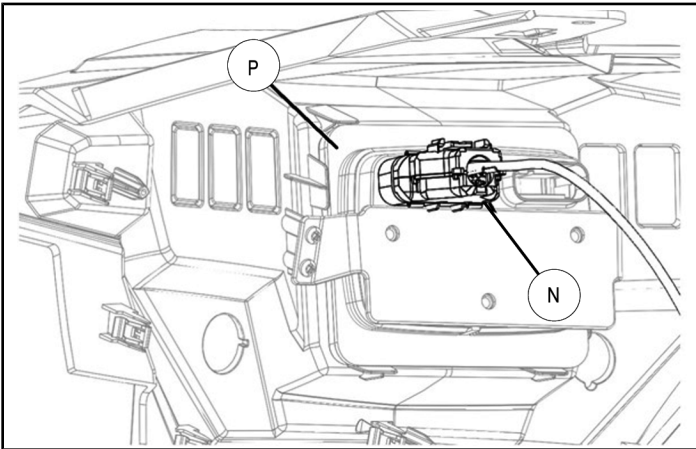

12. Reconnect the switches, connections properly and install upper instrument panel ② on to the vehicle body. Reinstall two screws (C) removed in Step 4. Torque screws to specification.

TORQUE

6 ft. lbs. (8.1 Nm)

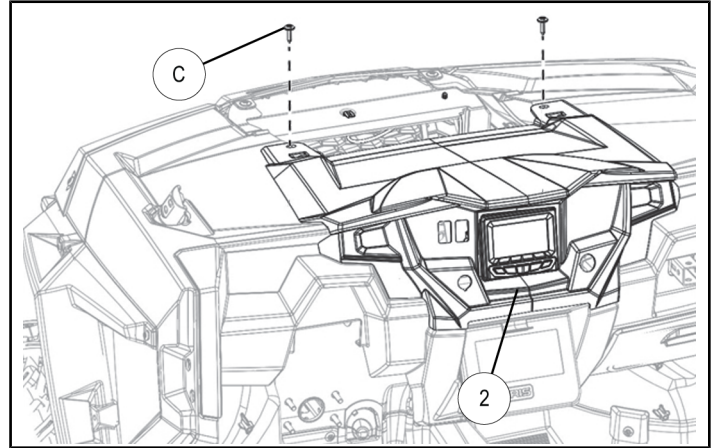

13. Reinstall center hood (A) and reconnect the black negative and the red positive cable to the battery. Reinstall the driver's seat.

14. Turn on key and test functionality.

TEMPLATE (SCALE 1:1)

