

# HI CLEAR FRONT BUMPER KIT

**POLARIS**

ENGINEERED PARTS  
ACCESSORIES & APPAREL

P/N 2880479

## APPLICATION

RZR 900, RZR 900 S, RZR XP 1000 AND RZR XP 4 1000

## BEFORE YOU BEGIN

Read these instructions thoroughly and make sure all parts and tools are accounted for. Please retain these installation instructions for future reference and parts ordering information.

**IMPORTANT:** Recommend Installing WINCH KIT (PN 2880592, 2880593, 2880788 or 2880789) prior to installing HI CLEAR FRONT BUMPER KIT. Winch mount bracket (PN 5259449) may be needed if installing on MY 14 RZR XP 1000 and RZR XP 4 1000.

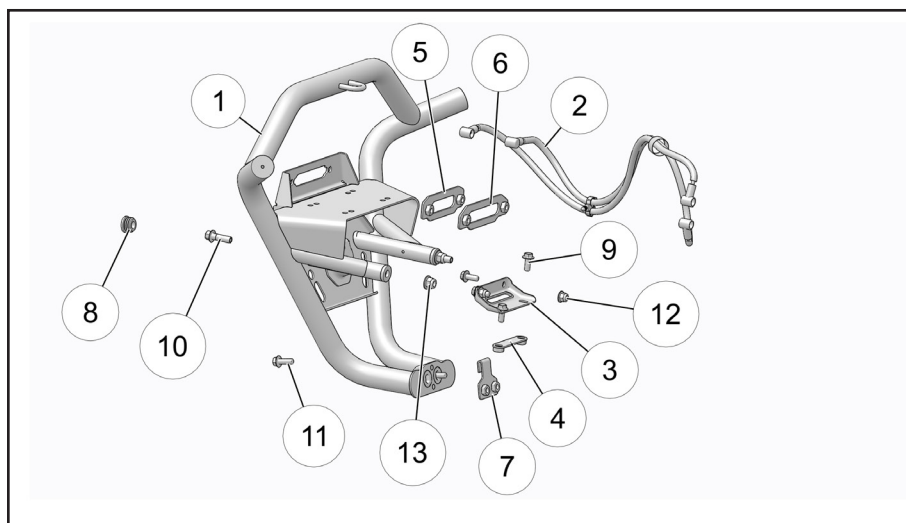

## KIT CONTENTS

Ref	Qty	Part Description	Part Number
1	1	Weld Front Bumper	1021466
2	1	Cable	4015044
3	1	Bracket Bumper Support	5260162
4	1	Plate Weldment	5260168
5	1	Backer Plate 3500	5260830
6	1	Backer Plate 4500	5260831
7	1	Backer Plate lower	5260902
8	2	Plug	5450305
9*	4	Screw M10X1.0X25	7519071
10*	2	Screw M12X1.75X40	7519730
11*	2	Screw M10X1.5X30	7519764
12*	2	Nut M10X1.5	7547313
13*	2	Nut M12X1.75	7547441
	1	Instructions	9925529

ITEMS MARKED (\*) ARE INCLUDED IN HARDWARE KIT PN 2205957.

## TOOLS NEEDED

Torx Driver  
Safety Glasses

Metric Wrench Set  
Metric Socket Set and Ratchet

## APPROXIMATE ASSEMBLY TIME

20-25 mins

## IMPORTANT

Your Polaris HI CLEAR FRONT BUMPER KIT is exclusively designed for your vehicle. Please read the installation instructions thoroughly before beginning. Installation is easier if the vehicle is clean and free of debris. For your safety, and to ensure a satisfactory installation, perform all installation steps correctly in the sequence shown.

## INSTALLATION INSTRUCTIONS

1. Park the vehicle. Turn the key to "OFF" position and remove from the vehicle.
2. Remove front grill from the Facia.

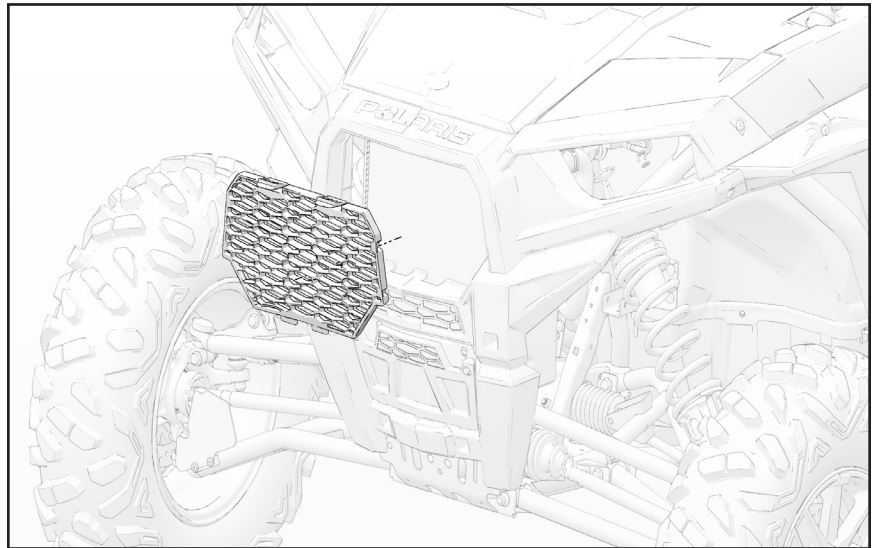

3. Remove winch cover (A) by removing two screws (B) as shown in figure. Keep winch cover and screws for reuse.

**NOTE:** Front Facia may be removed to ease in installation.

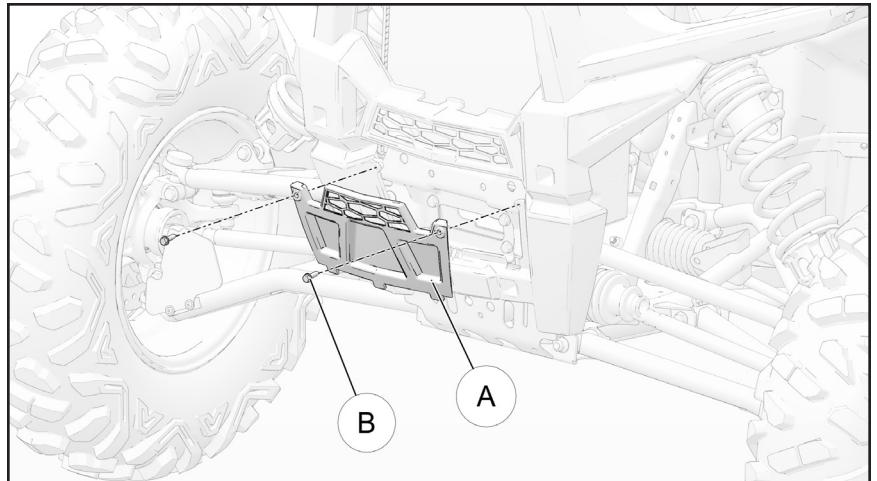

4. **MY 14:** Remove suspension mount weldment (G) (If present in the vehicle) by removing four M8 bolts (H) from fairlead mount bracket. Also remove M10 nuts (J) and relevant M10 screws (K) from upper control arm.

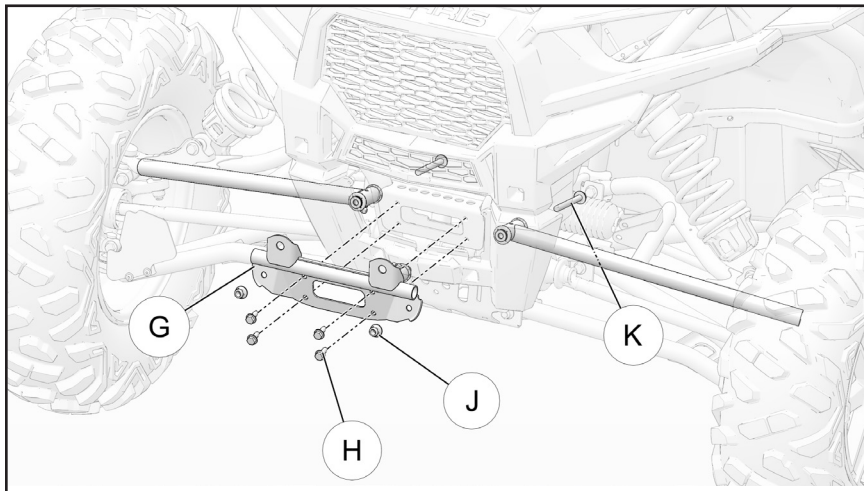

5. **MY 14:** Install front Suspension mount bracket (PN 5259449) (C) instead of suspension mount weldment (G) removed in step 4. Torque M8 screws (D) to 16 ft. lbs. (21.7 Nm). Torque M10 screws (F) to 40 ft. lbs. (54.2 Nm).

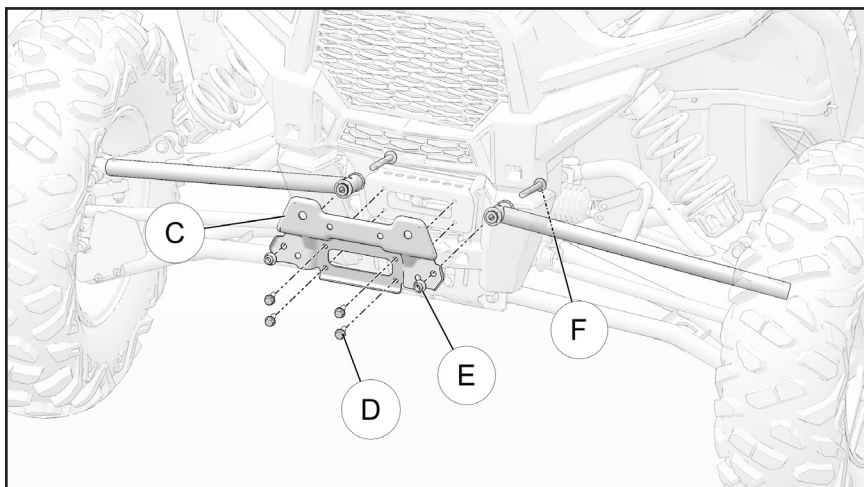

6. Fasten bracket bumper support (3) on to the front suspension mount bracket by hand tighten M10 screws (9) and M10 nuts (12).

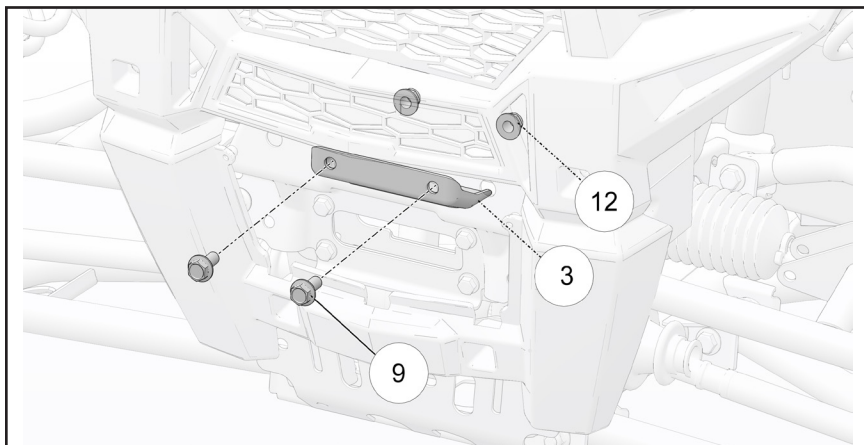

7. Mount bracket bumper support (3) on to the fairlead mount bracket by fastening plate weldment (4) and two M10 screws (9). Torque to 40 ft. lbs. (54.2 Nm).

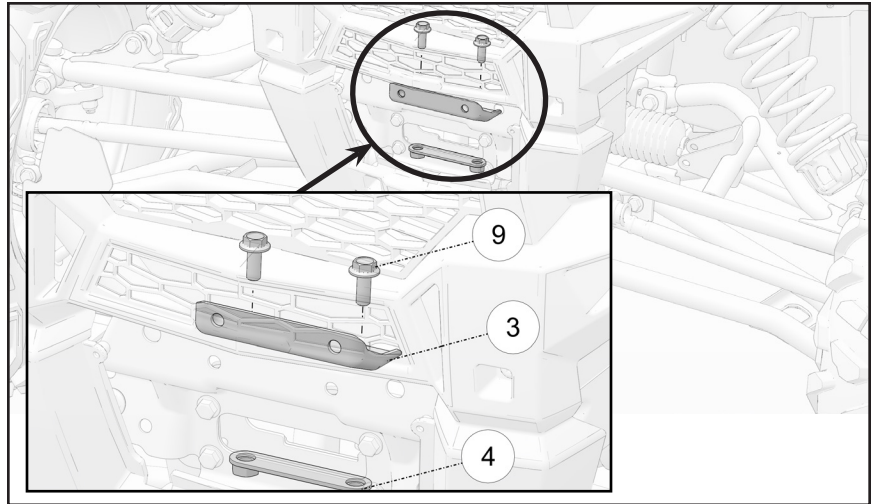

8. Put backer plate lower (7) on to the chassis bracket (L) and align holes with the bracket.

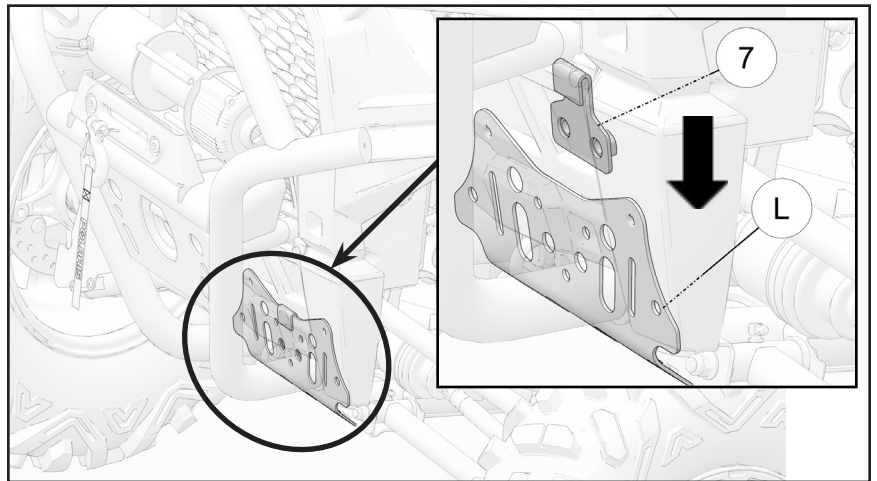

9. Re-install winch cover and front grill removed in Steps 2 and 3.(Optional).

10. Depending on winch installed backer plate (5) for 3500 Winch and backer plate (6) for 4500 Winch is needed.

**NOTE:** Depending on winch install roller fairlead (R) for 3500 Winch or fairlead hawse (P) for 4500 Winch by using two M10 screws (Q). Apply torque to 40 ft. lbs. (54.2 Nm).

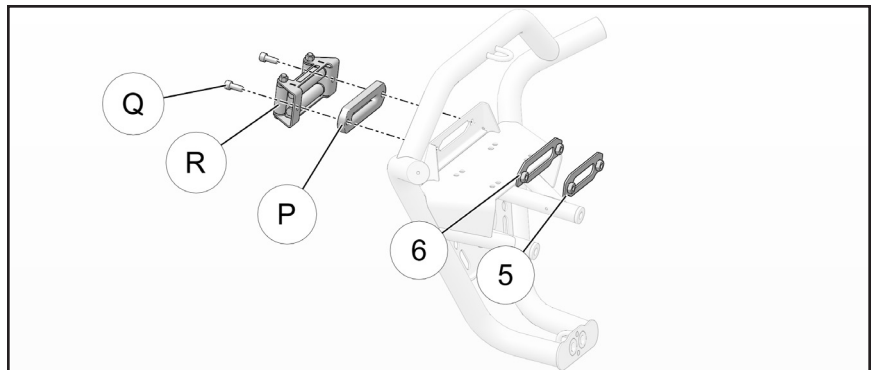

11. Install Winch (N) 3500 or 4500 on weld front bumper (1) using four M8 screws. Apply torque to 16 ft. lbs. (21.7 Nm).

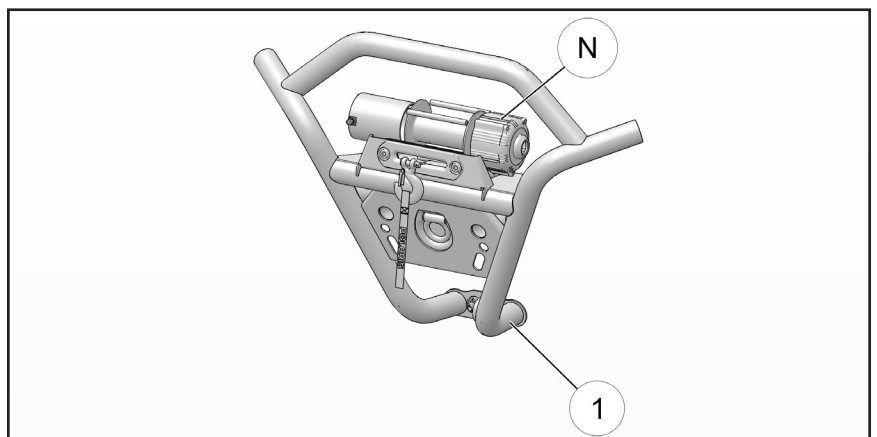



12. Align the weld front bumper (1) to the holes of the front suspension mount bracket (C) on the vehicle frame as shown in figure.

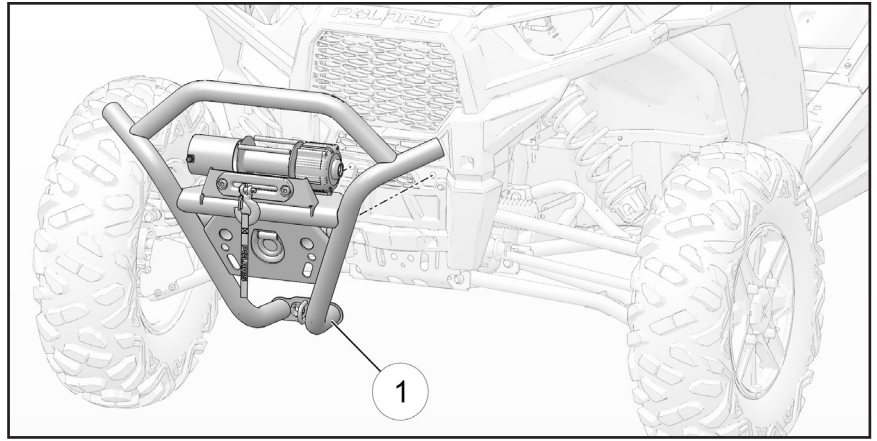

13. Loosely install weld front bumper by fastening two M12 screws (10) and relevant nuts (13) as shown in figure.

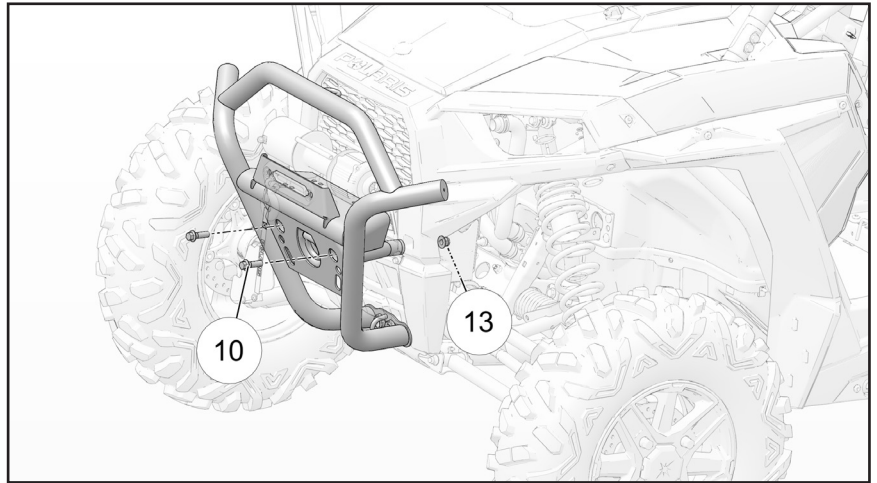

14. Fasten two M10 screws (11) on the weld front bumper as shown in figure. Torque top and bottom screws to 40 ft. lbs. (54.2 Nm).

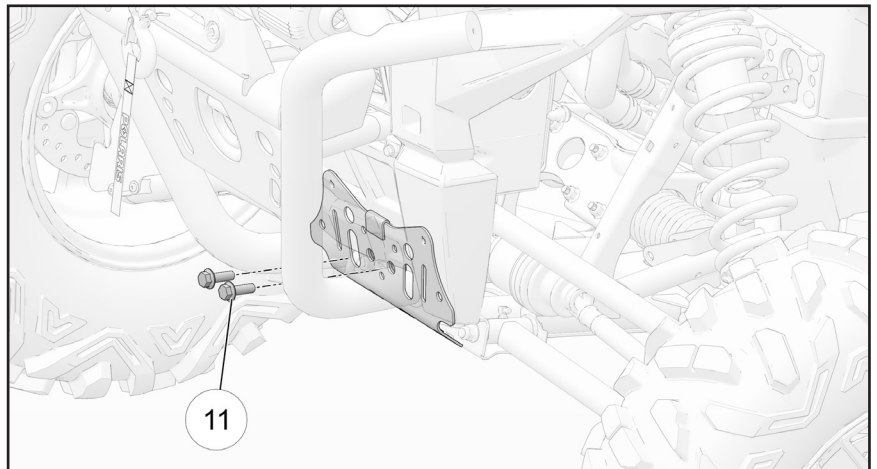

15. Push the two caps (8) on to the front bumper assembly as shown in figure.

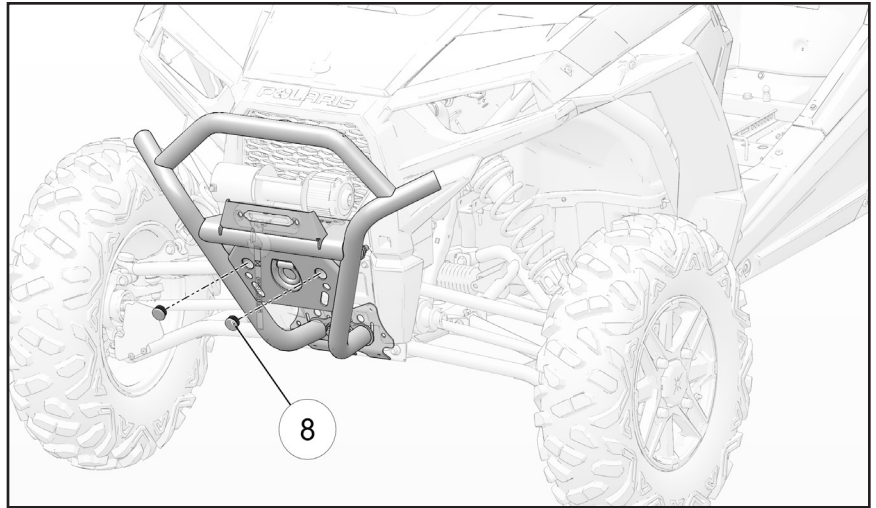

16. Connect cable (2) on to the winch and connect other end to contactor (M). Apply torque to connector nuts 1.5 to 2 ft. lbs. (2 to 2.7 Nm).

**NOTE:** Use winch install kit instructions to complete the winch install.

