

HEATER KIT



P/N 2881552

APPLICATION

RZR 900, RZR 1000 and RZR XP 1000

BEFORE YOU BEGIN

Read these instructions and check to be sure all parts and tools are accounted for. Please retain these installation instructions for future reference and parts ordering information.

KIT CONTENTS

This Kit includes:

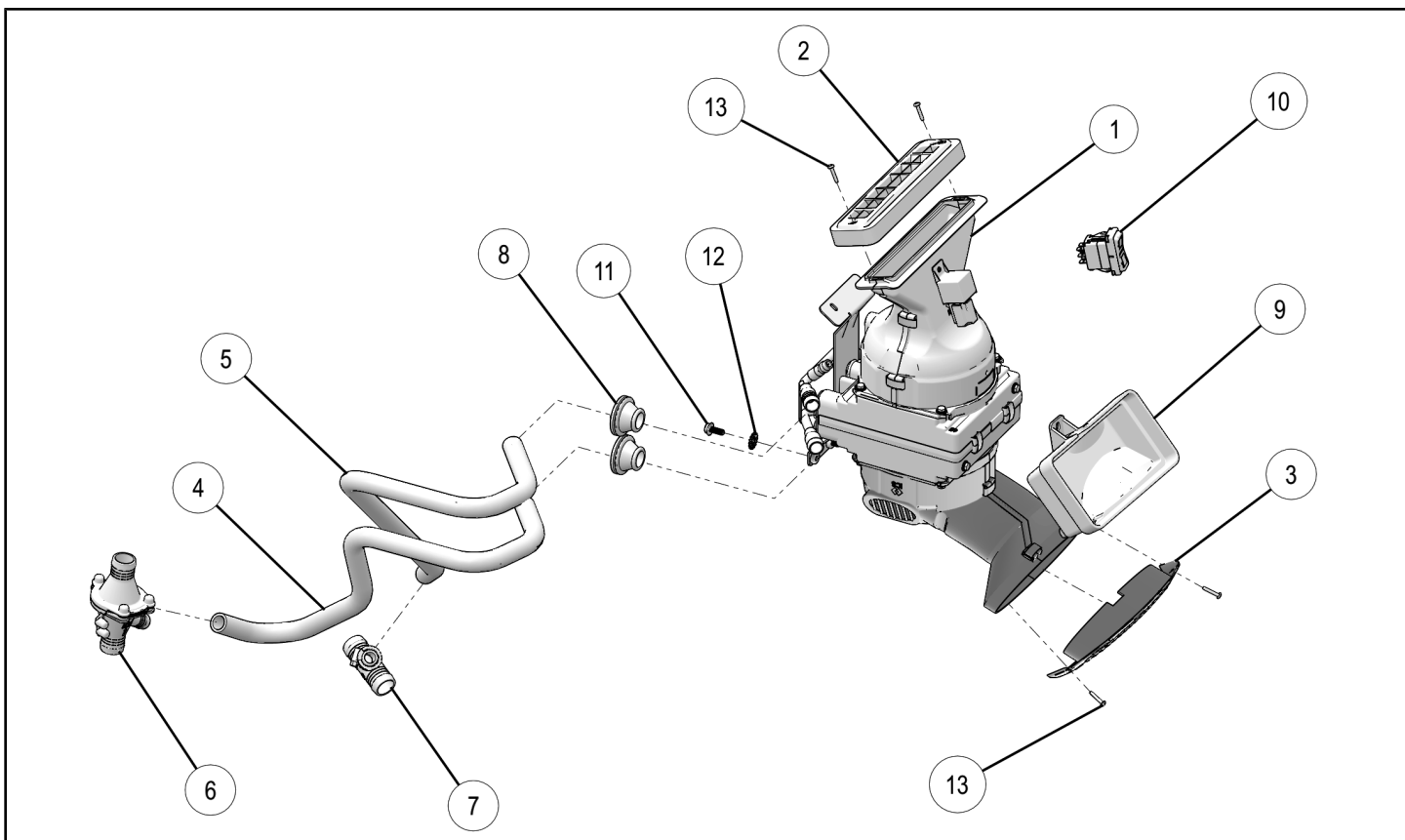

REF	QTY	PART DESCRIPTION	PART NUMBER
1	1	Heater Core Assembly	2636029
2	1	Upper Air Vent	-
3	1	Lower Air Vent	-
4	1	Heater Bottom Hose (Shorter Hose)	-
5	1	Heater Top Hose (Longer Hose)	-
6	1	Thermostat	-
7	1	Y-Joint	-
8	2	Grommet	-

REF	QTY	PART DESCRIPTION	PART NUMBER
9	1	Storage Box	-
10	1	Heater Switch	-
11*	2	Screw	-
12*	2	Star Washer	-
13*	4	Torx® Screw	-
	1	Instructions	9926618

Items marked (*) are included in Hardware Kit PN 2206167.

TOOLS REQUIRED

- Safety Glasses
- Drill Bits
- Drill
- Torx® Drivers
- Standard and Metric Wrench Set
- Pliers

IMPORTANT

Your HEATER KIT is exclusively designed for your vehicle. Please read the installation instructions thoroughly before beginning. Installation is easier if the vehicle is clean and free of debris. For your safety, and to ensure a satisfactory installation, perform all installation steps correctly in the sequence shown.

ASSEMBLY TIME

Approximately 60 minutes

INSTALLATION INSTRUCTIONS

NOTE

It may be necessary to remove previously installed accessories to install heater kit such as a windshield and windshield wiper motor assembly.

1. Place vehicle in "PARK". Turn key to "OFF" position and remove from vehicle.
2. Disconnect ground cable from battery. Remove hood (A).

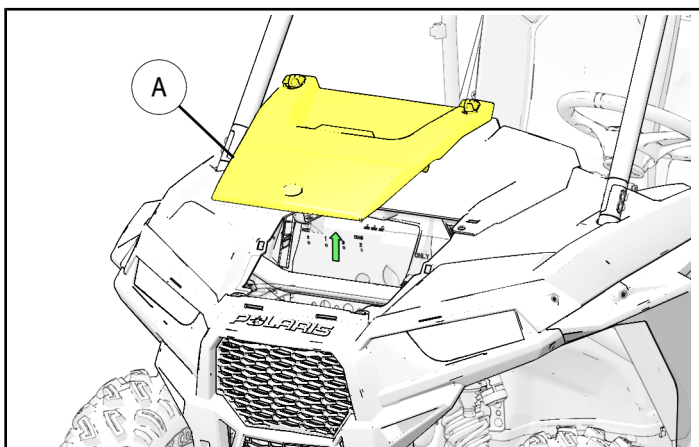

3. Remove upper instrument panel (B) by removing two screws and disconnecting ignition, headlight switch, accessory plug, AWD switch, and any other accessory controls that may have been added.

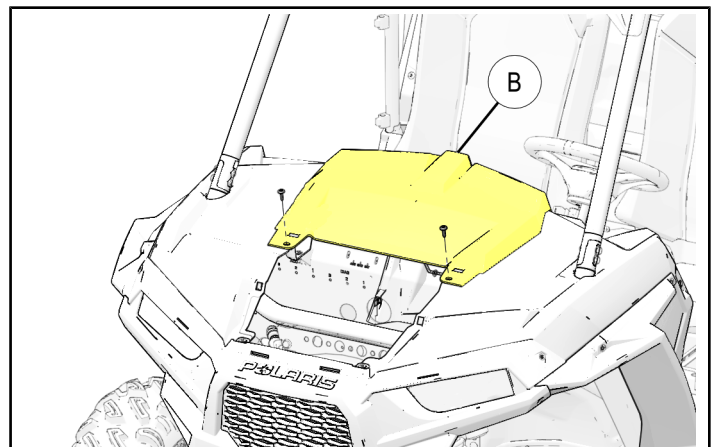

4. Remove center storage compartment support bracket (C) by removing bolts as shown. Remove center storage compartment (D).

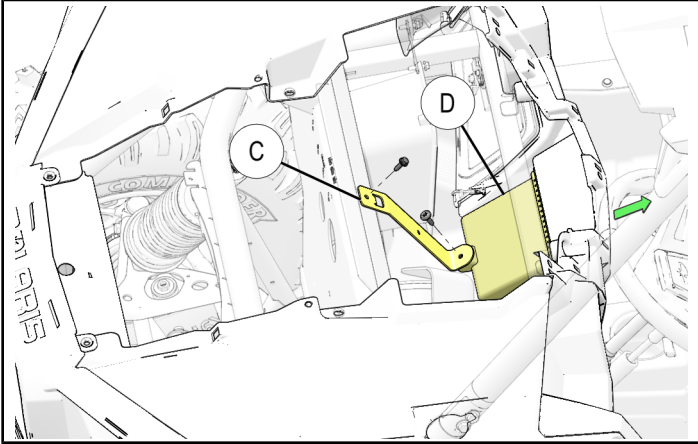

5. Remove lower instrument panel (E) by removing passenger grab bar. Then remove two screws in center and pull on edges until retaining clips release.

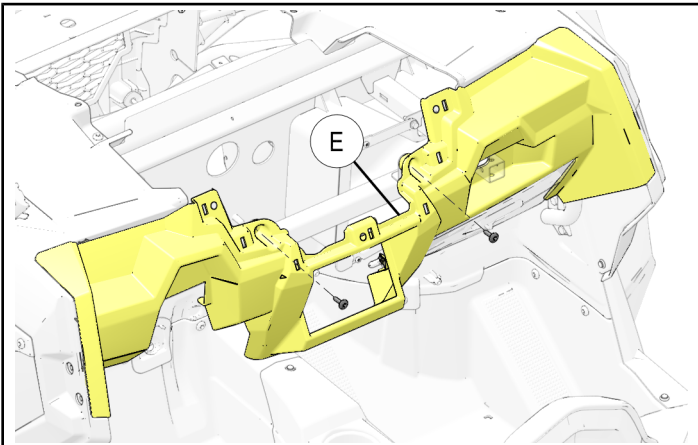

6. Locate firewall hose template. Position template on inside of firewall as shown (Use Template 1, attached at end of instructions). Mark center of each hole using a sharp punch or awl. From inside of firewall drill holes using a 1 3/8" hole saw.

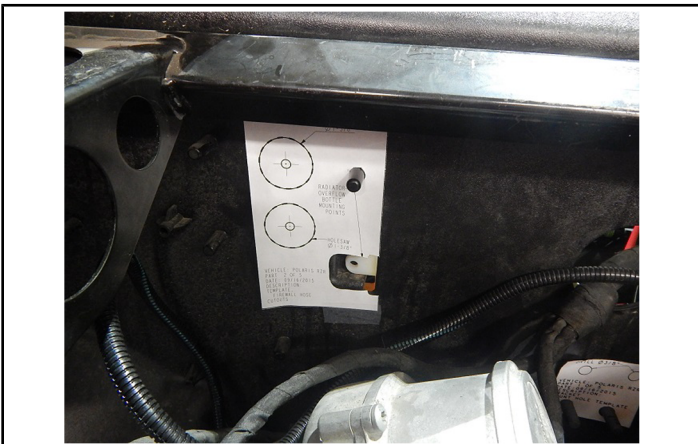

7. Locate bracket mount template. Position template on inside of firewall as shown (Use Template 2, attached at end of instructions). Repeat marking process described in previous Step. From inside of firewall drill out holes using a 3/8" drill bit.



8. Install hoses ④ ⑤ to heater assembly using supplied hose clamps. Put shorter hose ④ on bottom heater core nipple and longer hose ⑤ on top.

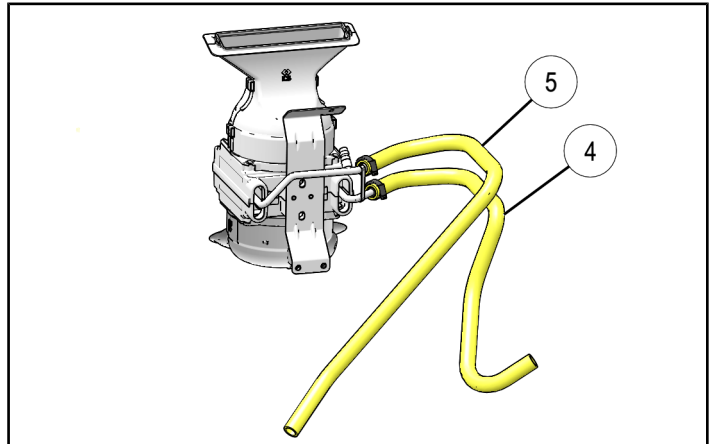

9. Position heater assembly ① using top mounting location and fastener of center storage box previously removed. Be sure to route all wiring away from any sharp edges. It is recommended that all wires are routed to center of vehicle. Install 6 mm bolts ⑪ and star washers ⑫ through from outside of firewall to lower holes on mounting bracket. If a windshield wiper motor assembly was removed for this install, reinstall at this time. Check for clearance around heater assembly and tighten all fasteners.

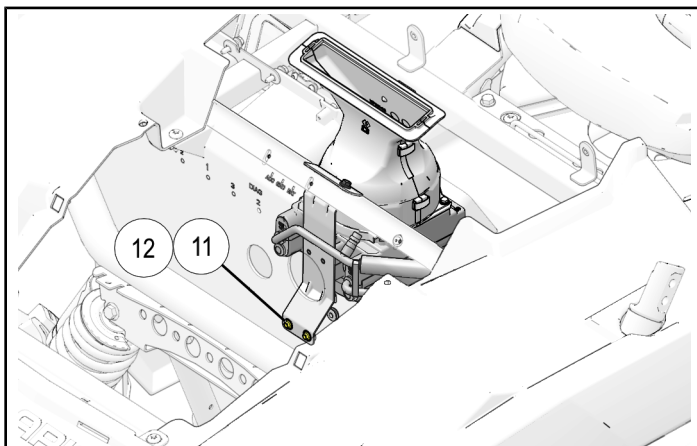
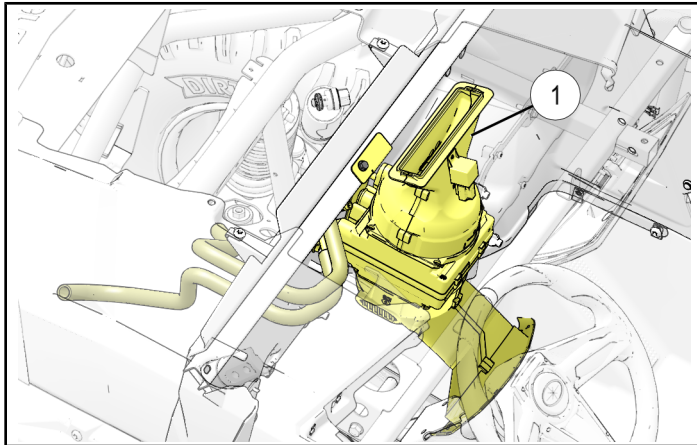

10. Route heater power leads through firewall grommet. Attach black wire to ground, red wire to battery power and yellow/red wire to keyed power.

11. Route hoses through 1 3/8" holes in firewall. Install supplied grommets ⑧ onto each hose as shown. A small amount of lubricant may be used such as window cleaner to aid in installation. Seat grommets ⑧ into holes in firewall. Position hoses as to not allow kinks.

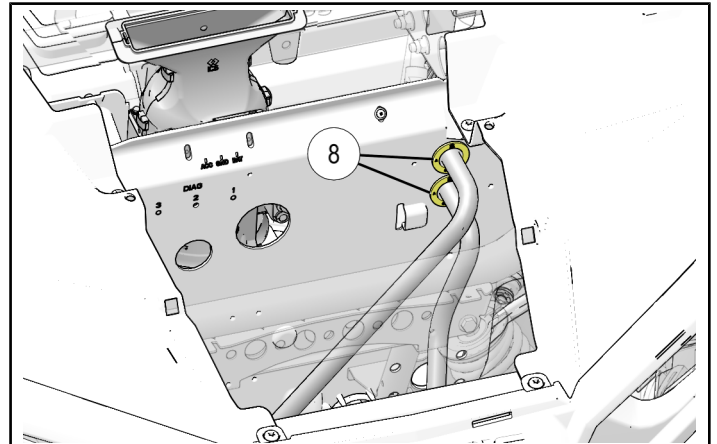

12. Place coolant clamps on coolant return hose as shown. Cut hose between clamps. Remove 1" of hose from one of ends to make room for thermostat assembly. Install thermostat assembly ⑥ between two hose ends. Arrow on thermostat assembly ⑥ should be pointing upward and connection should be in line with hose as shown. Tighten hose clamps on top and bottom of assembly.

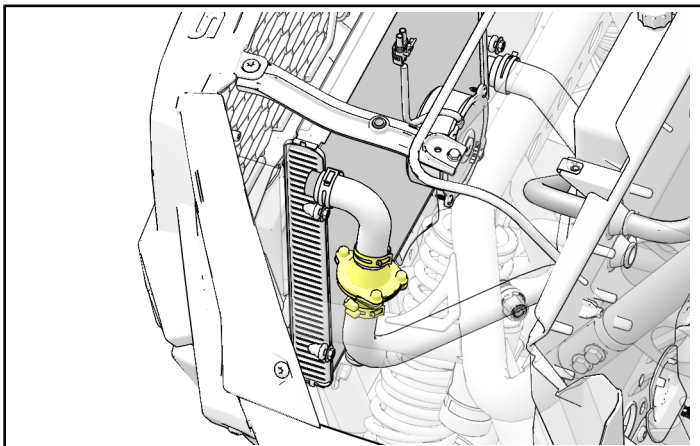
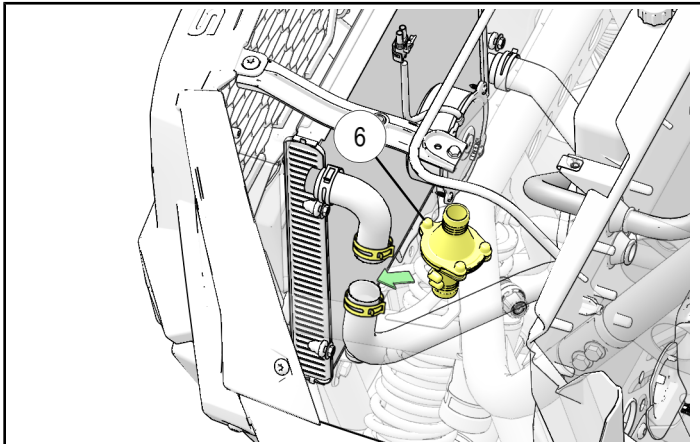

13. Install bottom hose ④ from heater core onto thermostat assembly ⑥ and secure with a hose clamp. Install a coolant clamp onto lower heater hose near thermostat assembly before removing coolant clamps above and below thermostat assembly.

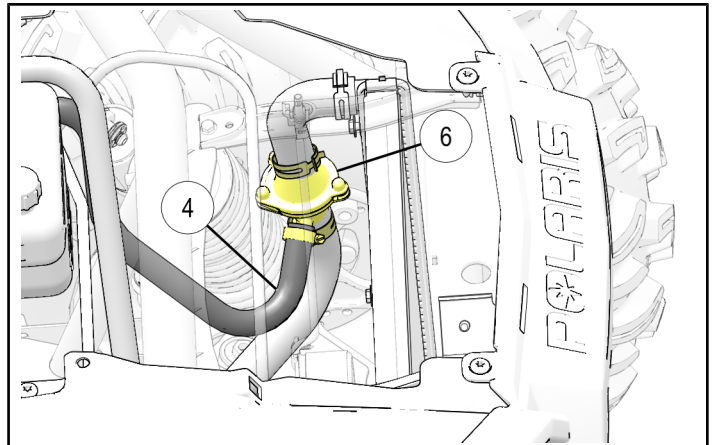

14. Install clamps onto engine coolant supply hose as shown. Cut coolant hose between clamps. Remove 1" of hose from one of ends to make room for "Y" fitting. Install "Y" fitting ⑦ and secure with supplied hose clamps.

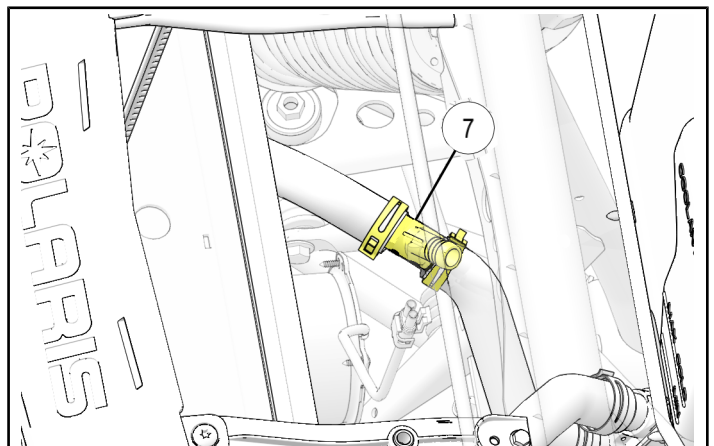
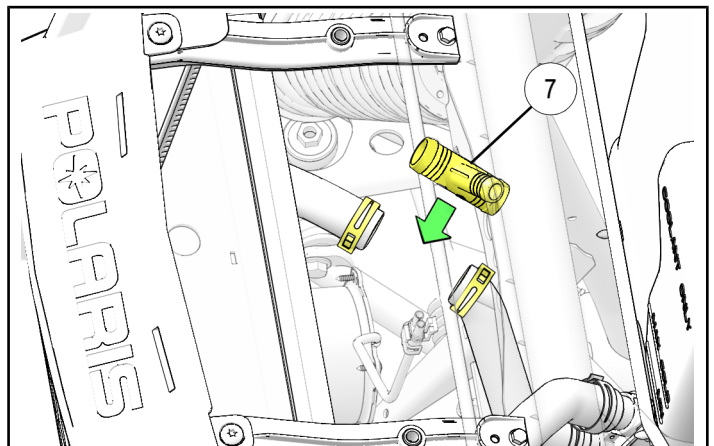

15. Install top hose ⑤ from heater core to small part of “Y” fitting ⑦ as shown and tighten clamp. System is now closed and all coolant clamps can be removed.

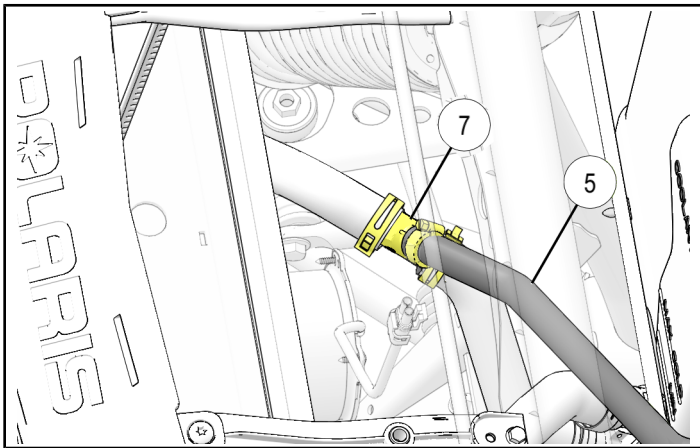

16. Locate lower vent template. Lay template starting on bottom right side going up and to left. Top left should align with indentation on top and side. Cut along line at bottom of template as shown (Use Template 3, attached at end of instructions). Install lower vent ③ using two Torx® head screws ⑬ provided as shown.

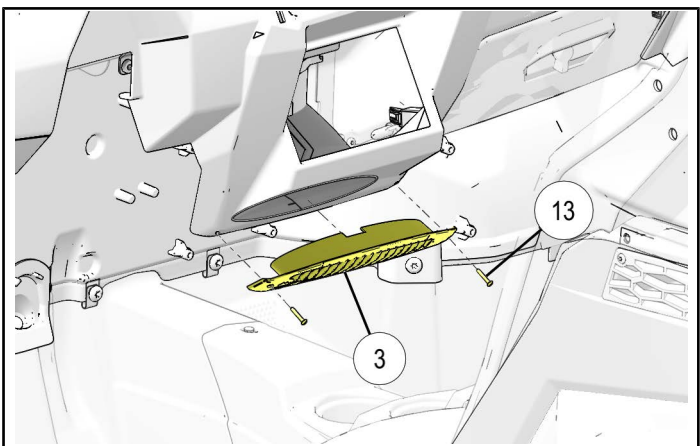

17. Secure center storage compartment ⑨ cap to back of heater assembly using fastener provided as shown.

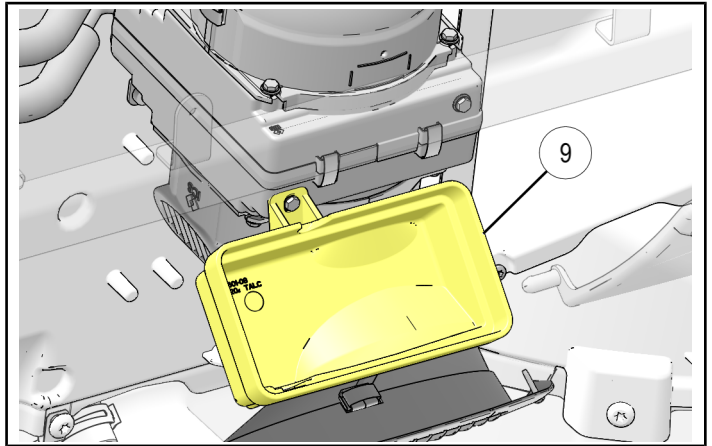

18. Reinstall lower instrument panel using fasteners removed previously.

19. Locate center storage compartment removed in Step 4. Wrap box cut template around outside of box as shown (Use Template 4, attached at end of instructions). Cut along edge of template at back of box.



20. If your center storage compartment is equipped with flip down front lid do following.
 Drill a hole 3/16" in diameter through top lip of storage box 1" from both outer edges.
 Drill a 3/16" hole in center of bottom lip. Insert storage box into place and secure with screws provided as shown.

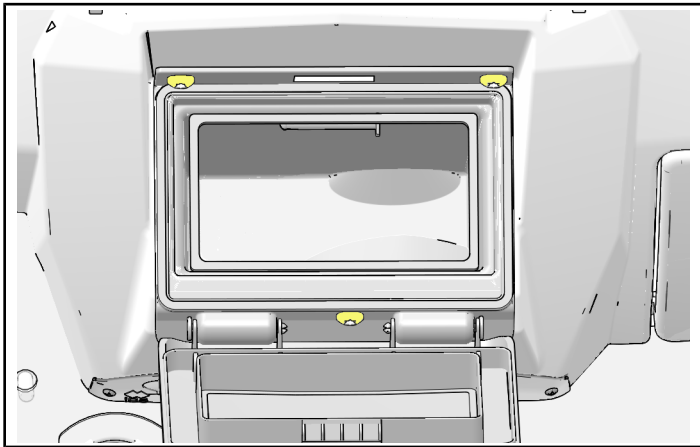

21. If your storage compartment does NOT have flip down front lid do following.
 Drill 3/16" holes in each corner of storage box.
 Insert storage box and secure with screws provided.

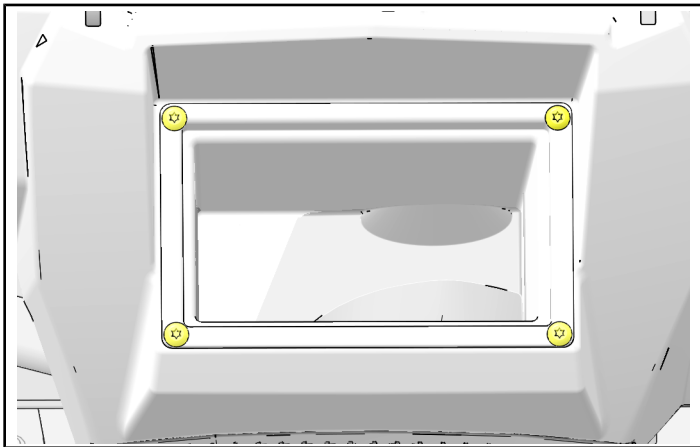

22. Locate upper instrument panel. Lay template on upper instrument panel and cut panel along dotted line for installing defrost vent ②. (Use Template 5, attached at end of instructions).

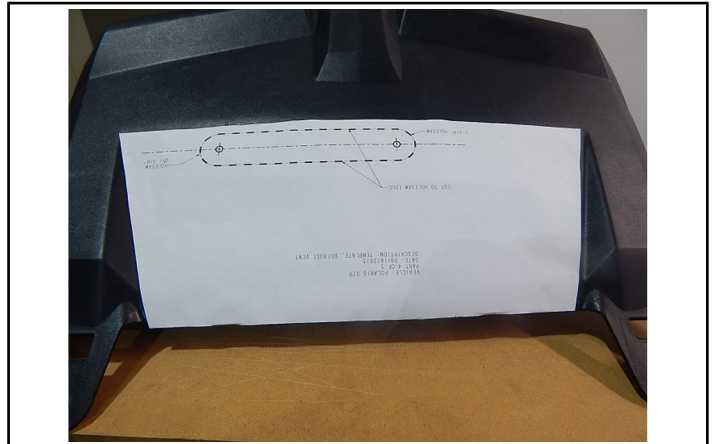

23. Cut out one of accessory knock outs in upper instrument panel to mount heater control switch ⑩. Install switch ⑩ into upper instrument panel. Connect heater wire harness to back of control switch.

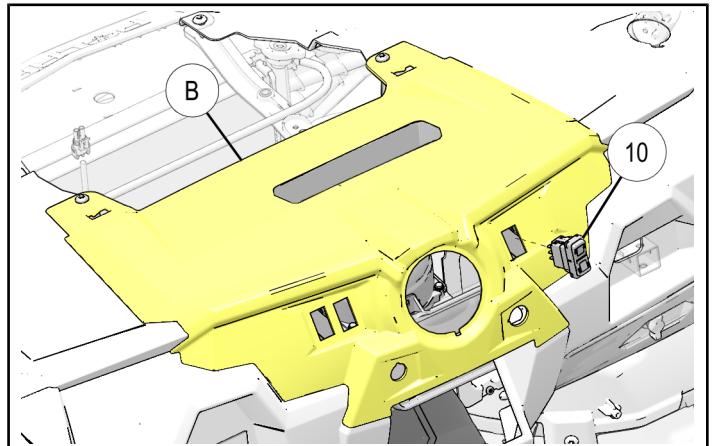

24. Install top defrost vent ② and secure with two Torx® screws ⑬ provided.

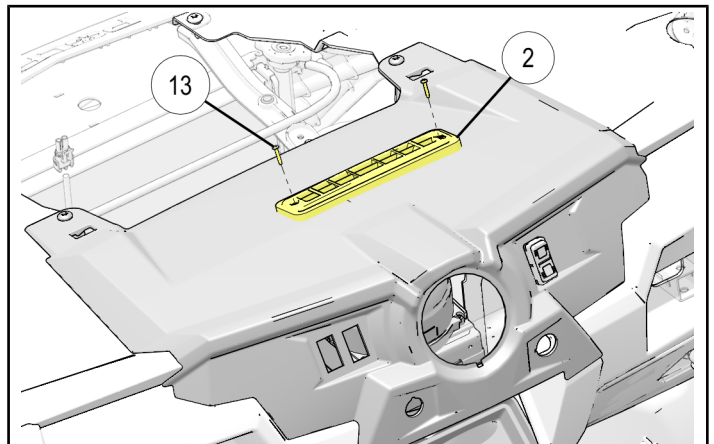

25. Check all hose connections at this time to make sure all hose clamps are tight.
26. Remove radiator cap and fill with coolant to top of radiator. Remove cap on bleed port located on top inlet of heater core. Snap bleeder onto port. Connect a hand vacuum pump to end of hose. Draw out air with vacuum pump until line is free of air. Fill radiator to top and reinstall radiator cap. Disconnect bleeder and reinstall bleed port cap.
27. Reconnect all items unplugged when upper IP was removed. Reinstall assembly and secure with original fasteners.
28. Reconnect battery and reinstall any remaining accessories removed prior.
29. Run machine through two complete fan cycles. Allow to cool and top off engine coolant recovery bottle.

Template 1

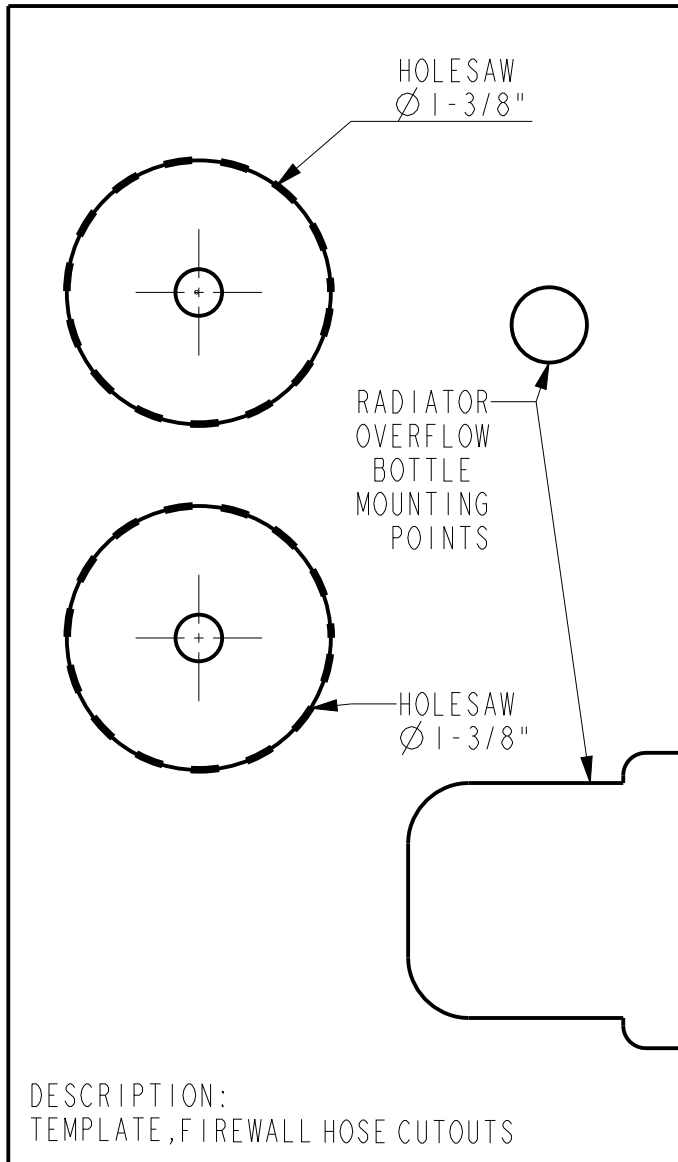

Measure the template after printing to make sure the template has printed correctly.

Template 2

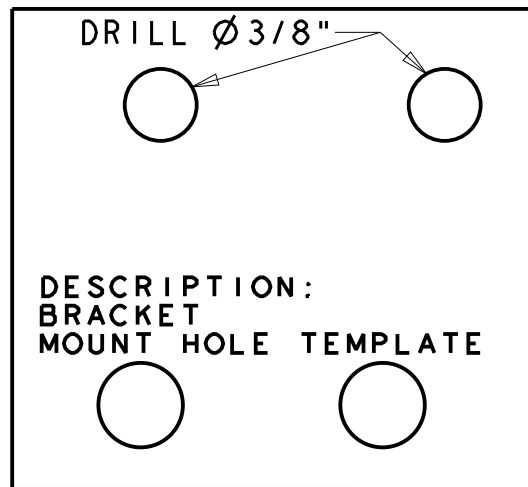

Measure the template after printing to make sure the template has printed correctly.

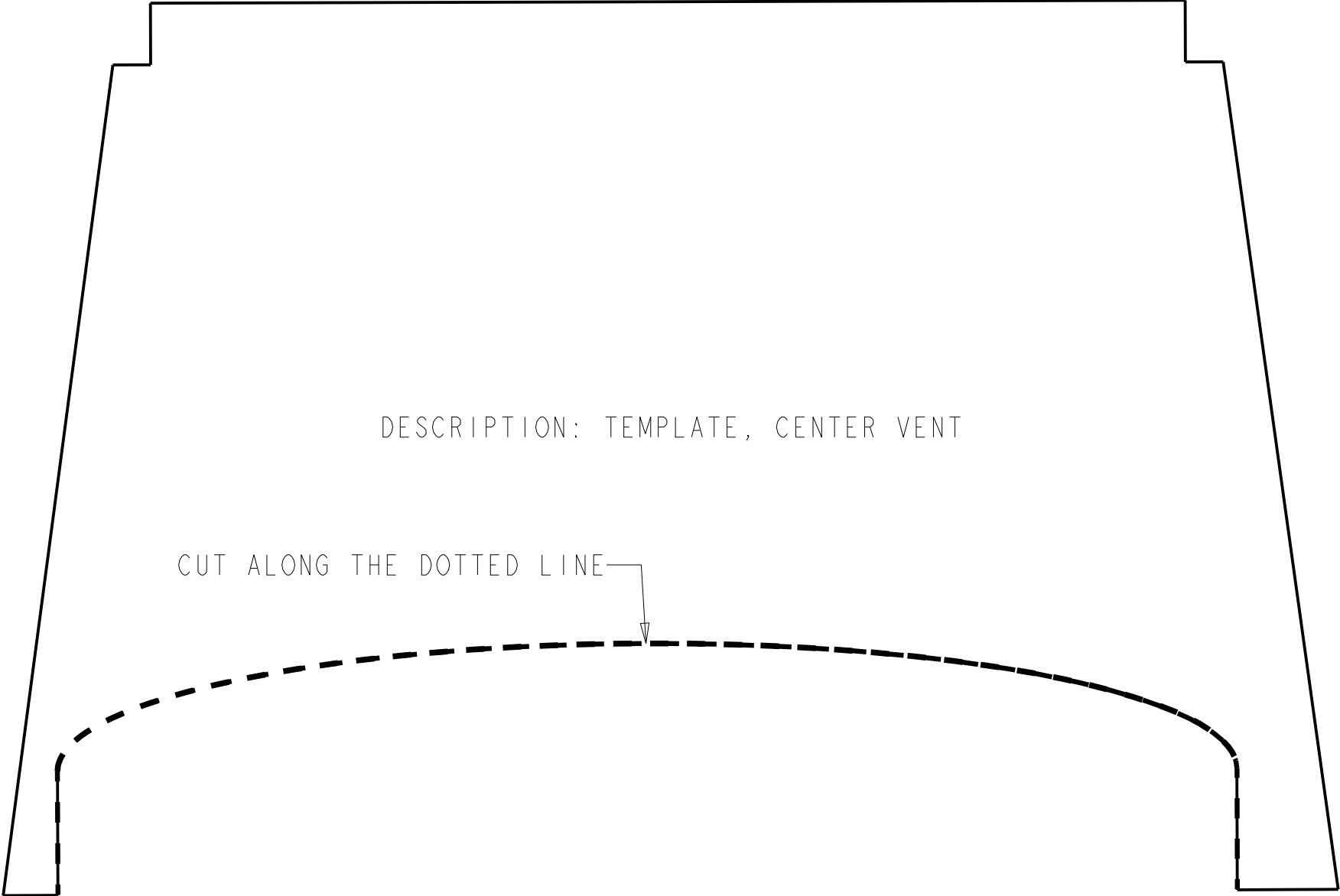

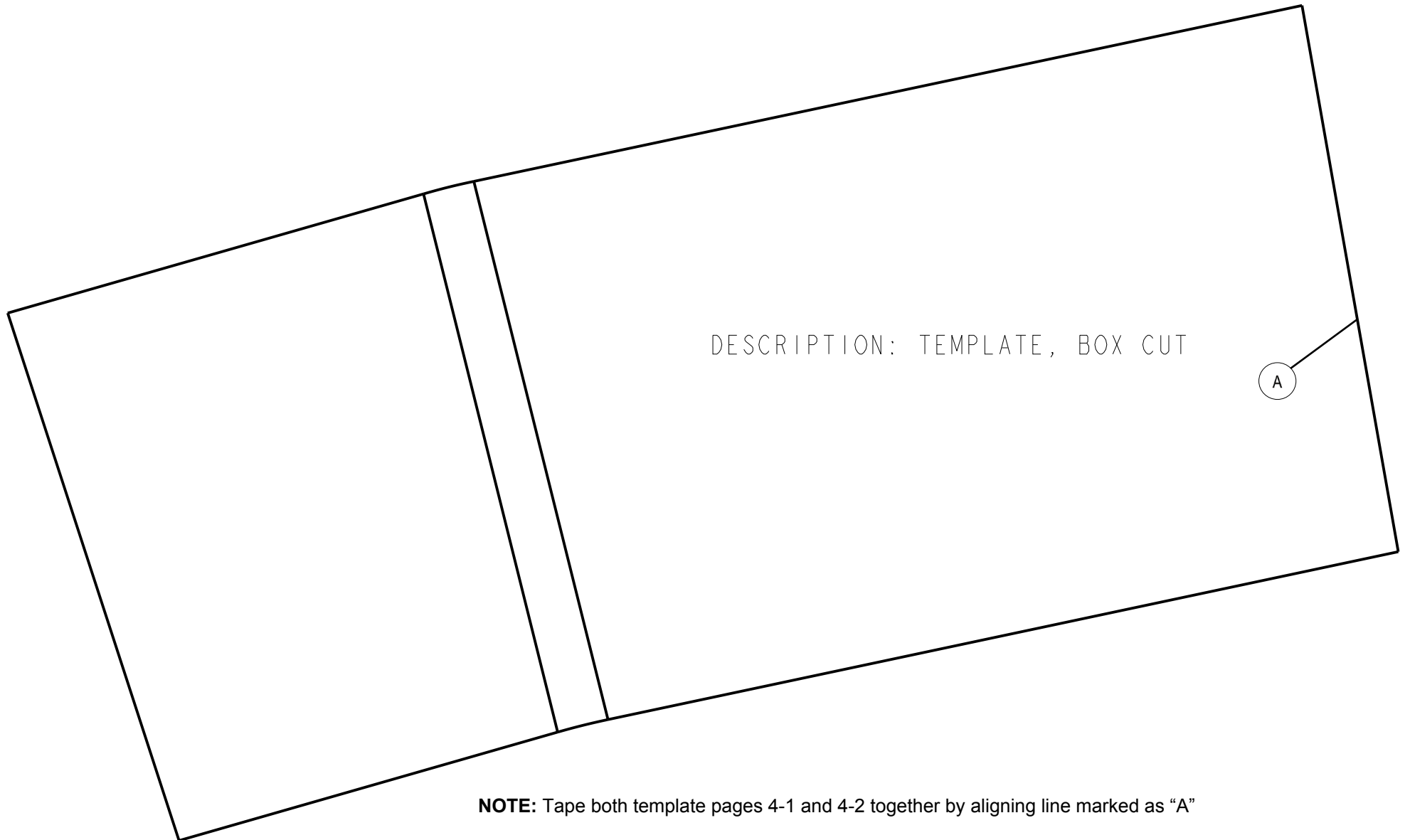

DESCRIPTION: TEMPLATE, BOX CUT

A

NOTE: Tape both template pages 4-1 and 4-2 together by aligning line marked as "A"

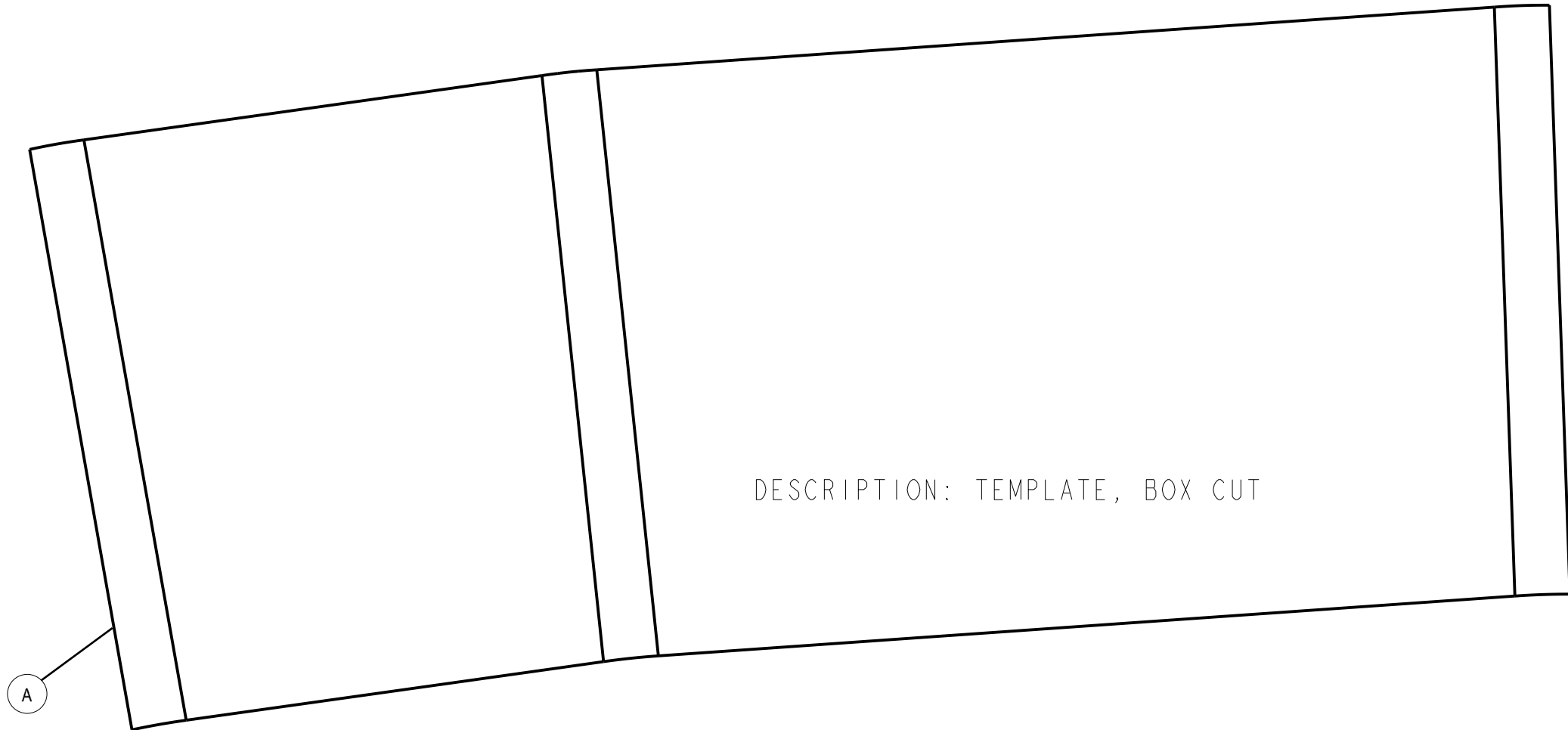

NOTE: Tape both template pages 4-1 and 4-2 together by aligning line marked as "A"

Template 5

