

# HEATER KIT



P/N 2884386

## BEFORE YOU BEGIN

Read these instructions and check to be sure all parts and tools are accounted for. Please retain these installation instructions for future reference and parts ordering information.

## APPLICATION

Verify accessory fitment at [www.polaris.com](http://www.polaris.com).

## KIT CONTENTS

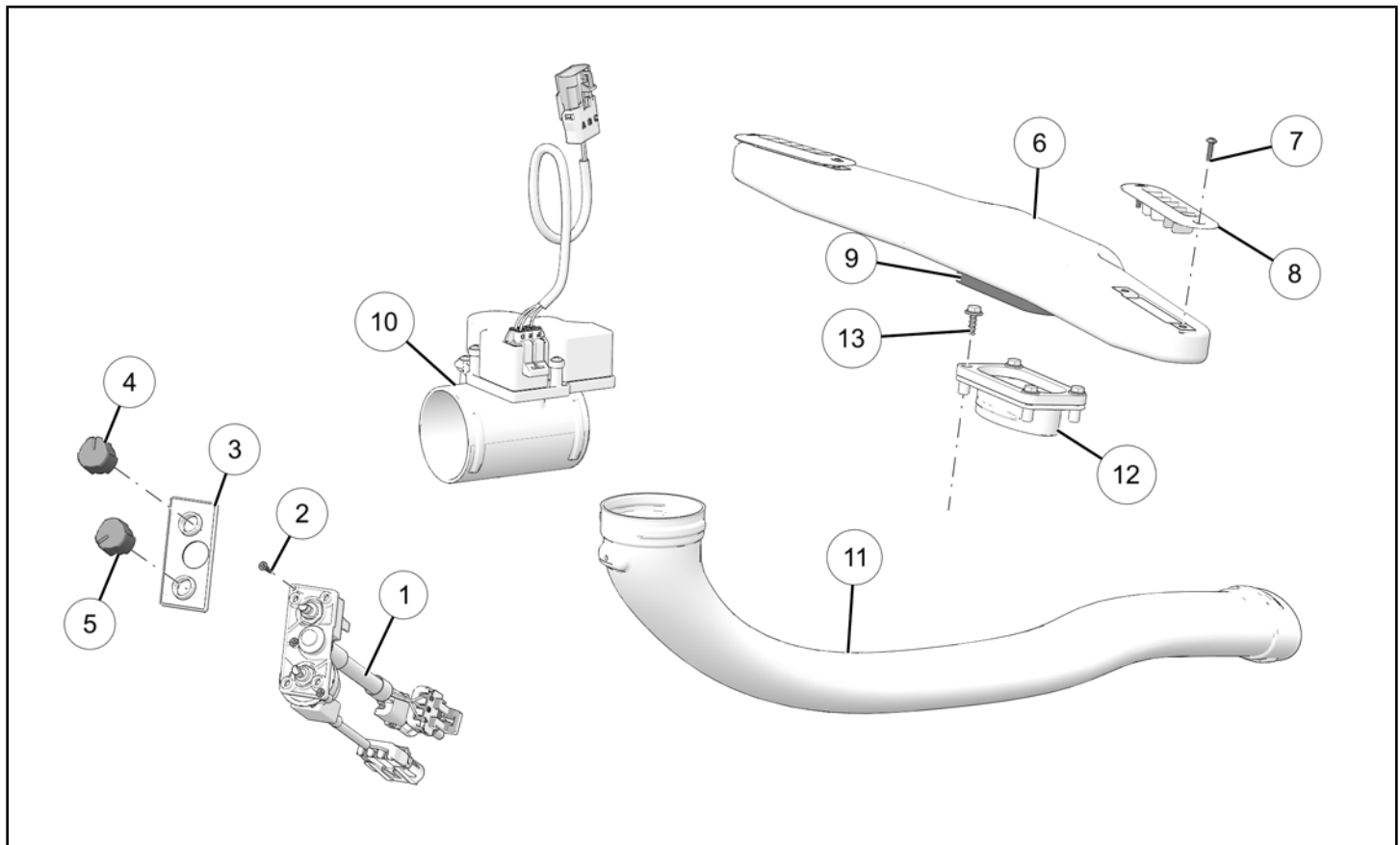

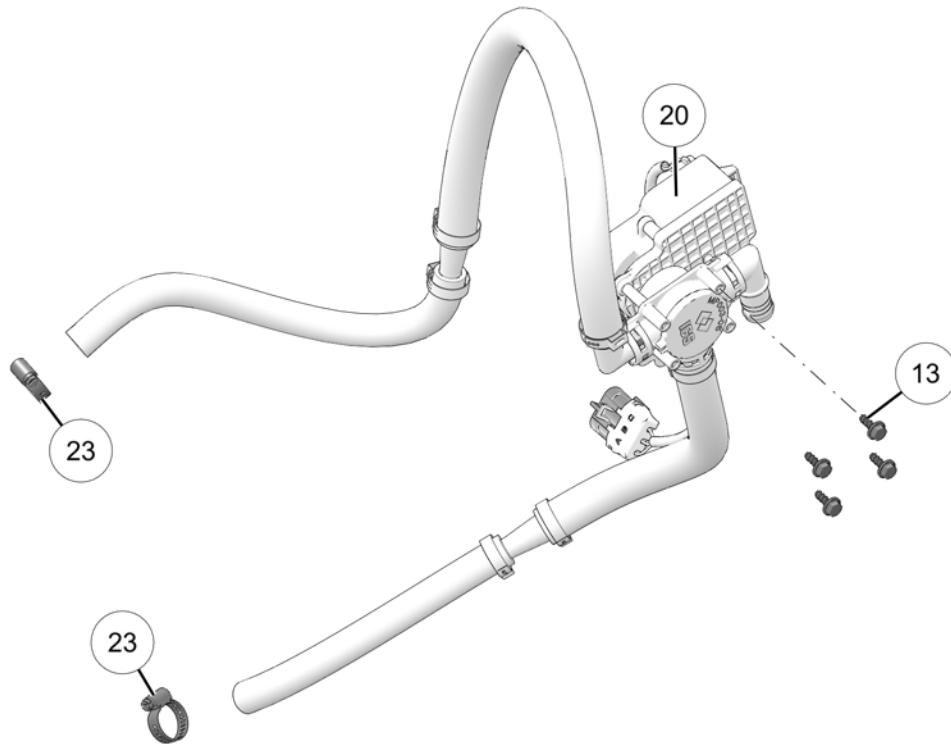
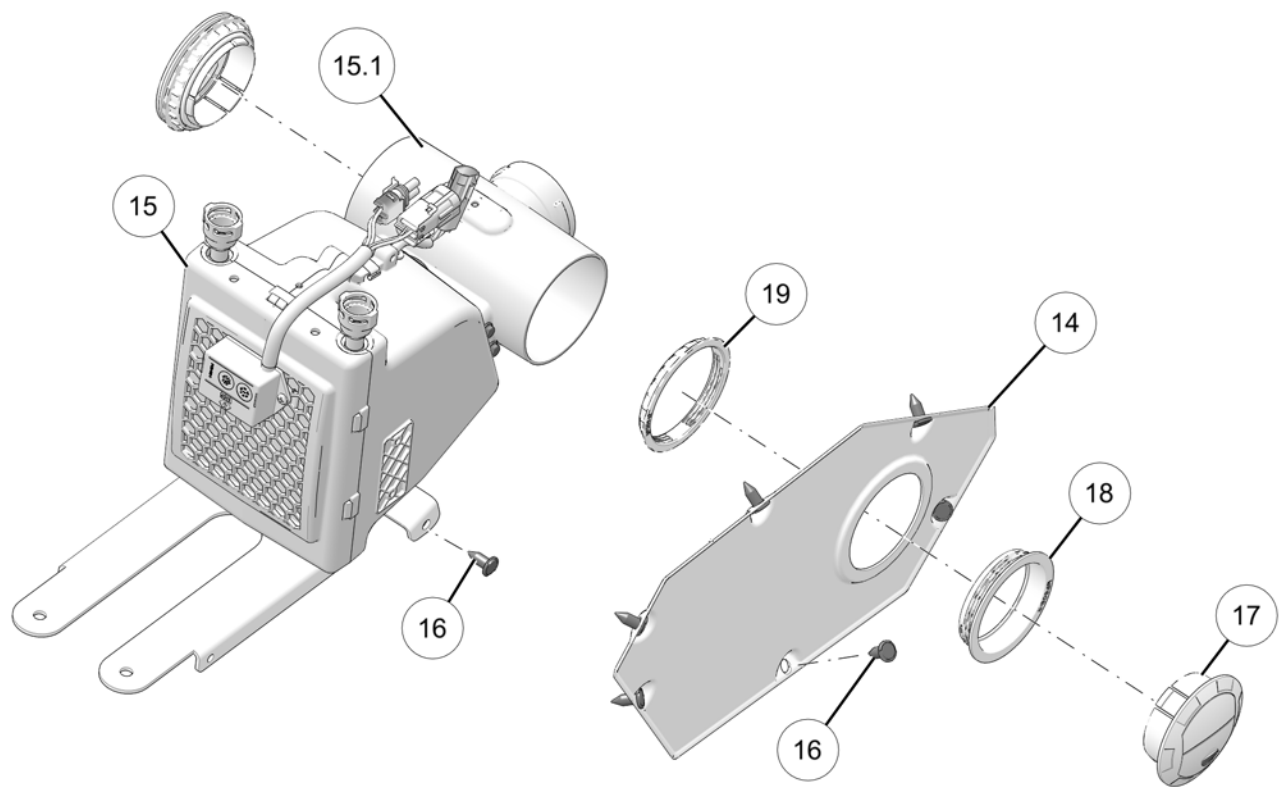

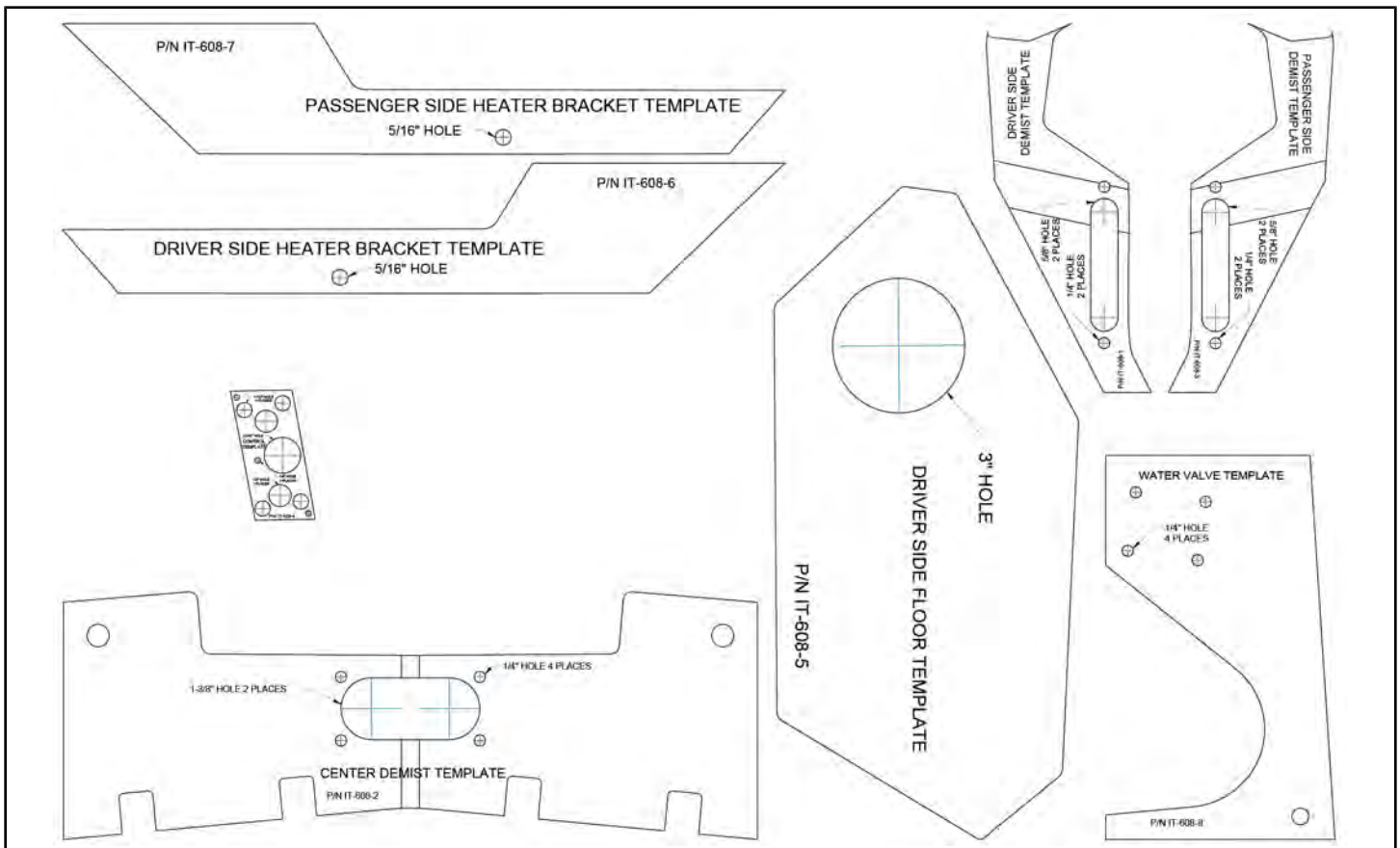
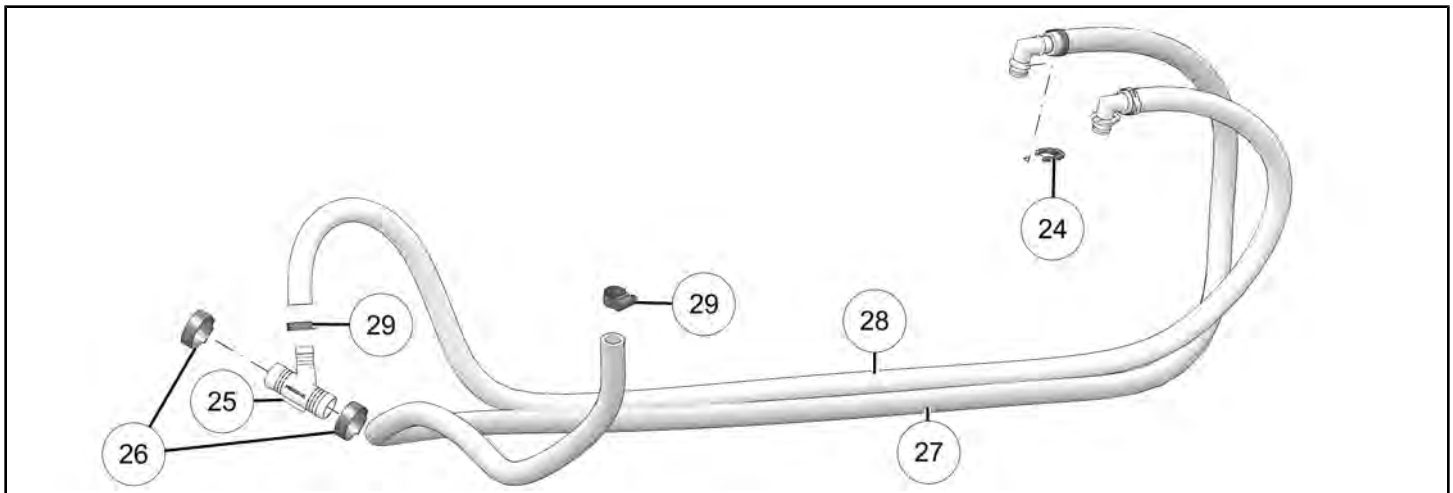

REF	QTY	PART DESCRIPTION	P/N AVAILABLE SEPARATELY	AVAILABLE SERVICE KIT
1	1	Harness–Control Panel	n/a	2415512
2	3	- Screw–Flat Head, Thread Forming, #4 x 1/2 in	n/a	2415512
3	1	- Cover–Front, Control Panel	n/a	2415512
4	1	- Knob–Fan	n/a	2415512
5	1	- Knob–Temperature	n/a	2415512
6	1	- Duct–Demist Vents	n/a	2638241
7	4	- Screw–Phillips Thread Forming, #6 x 1/2 in	n/a	2638241
8	2	- Grille–Vent	n/a	2638241

REF	QTY	PART DESCRIPTION	P/N AVAILABLE SEPARATELY	AVAILABLE SERVICE KIT
9	1	- Gasket–Demist Duct	n/a	2638241
10	1	Assembly–Mode Control	n/a	2415510
11	1	Duct–Main	n/a	n/a
12	1	Adapter–Duct, Gasket	n/a	n/a
13	8	Screw–Hex Head, 4.8 x 1.59 x 15 mm, HI/LO	n/a	n/a
14	1	Plate–Cover, Center Console	n/a	n/a
15	1	Assembly–Heater	n/a	n/a
15.1	1	- Duct–Blower Output	n/a	n/a
16	8	Rivet–Push-Pin, 8 mm	n/a	2208431
17	2	Louver–Vent	n/a	2638007
18	2	Vent–Insert, 3 in	n/a	2638007
19	2	Vent–Ring Threaded, 3 in	n/a	2638007
20	1	Assembly–Electronic Temperature Control	n/a	2415511
21	15	Cable Tie	n/a	2208431
22	1	Harness–Heater (not shown; see <i>Harness Detail</i> section)	n/a	n/a
23	2	Clamp–Hose, 7/8 in	n/a	2208431
24	2	Clip–Retaining	n/a	n/a
25	1	“Y”, 5/8 in Outer Diameter	n/a	n/a
26	2	Clamp–Hose, 1-1/2 in	n/a	2208431
27	1	Hose–Inlet, 125 in	n/a	2638309
28	1	Hose–Outlet, 93 in	n/a	2638309
29	2	Clamp–Hose, 1 in	n/a	2208431
—	1	Template–Demist, Driver Side	n/a	n/a
—	1	Template–Demist, Passenger Side	n/a	n/a
—	1	Template–Demist, Center	n/a	n/a
—	1	Template–Control	n/a	n/a
—	1	Template–Center Console, Driver Side	n/a	n/a
—	1	Template–Center Console, Heater Bracket, Driver Side	n/a	n/a
—	1	Template–Center Console, Heater Bracket, Passenger Side	n/a	n/a
—	1	Template–Water Valve	n/a	n/a

## TOOLS REQUIRED

- Safety Glasses
- Cutting Tool
- Deburring Tool
- Drain Pan

- Drill
- Drill Bit:
  - 1/8 in (3 mm)
  - 1/4 in (6 mm)
  - 5/16 in (8 mm)
  - 11/32 in (8.5 mm)
  - 1/2 in (12.5 mm)
  - 5/8 in (16 mm)
  - 13/16 in (20.5 mm)
  - 1-3/8 in (35 mm)
  - **Step Drill Bit**
- Hole Saw:
  - 3 in (76 mm)
- Pliers, Hose Pinch-Off (two required)
- Pliers, Push Pin Rivet
- Scissors
- Screwdriver Set, Torx®
- Service Manual
- Socket Set, Metric
- Socket Set, Torx® Bit
- Torque Wrench
- Wrench Set, Metric

## CONSUMABLES REQUIRED

- Antifreeze, POLARIS 50/50 Premix, 2-4 quarts
- Cleaning Solution (99% water + 1% mild dishwashing detergent)
- Isopropyl Alcohol (IPA)
- Gloves, Chemical Resistant
- Solvent Wipe (99% Isopropyl Alcohol)
- Silicone Lubricant

## IMPORTANT

Your Heater Kit is exclusively designed for your vehicle. Please read the installation instructions thoroughly before beginning. Installation is easier if the vehicle is clean and free of debris. For your safety, and to ensure a satisfactory installation, perform all installation steps correctly in the sequence shown.

## INSTALLATION INSTRUCTIONS

### VEHICLE PREPARATION

#### GENERAL

1. Shift vehicle transmission into PARK.
2. Turn key to OFF position and remove from vehicle.

#### COOLANT DRAINING

1. Refer to the *Service Manual* for procedures on draining the coolant.

#### CAB ACCESSORY REMOVAL

1. Remove windshield (if equipped).
2. Remove rear panel (if equipped).

### CENTER HOOD PANEL REMOVAL

1. Remove and keep two hood fasteners. Move hood towards rear of vehicle to remove.

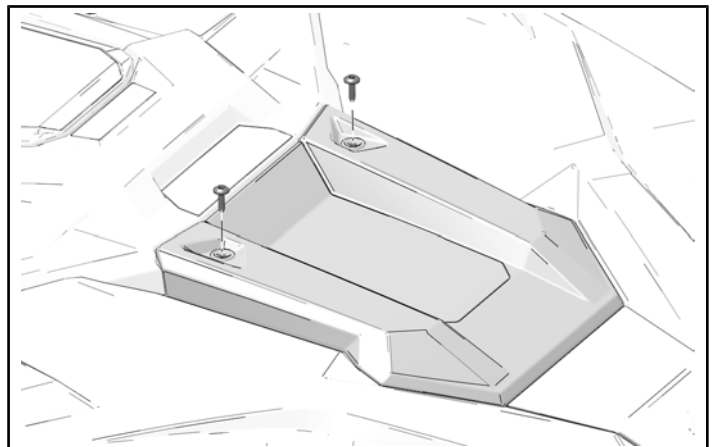

## DASHBOARD STORAGE REMOVAL

1. Open center dashboard storage compartment.

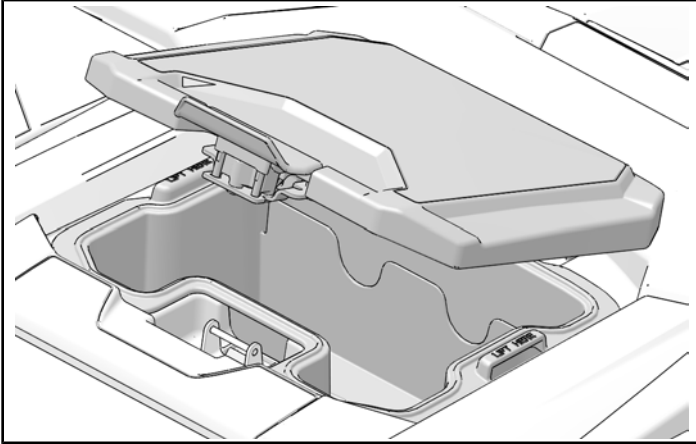

2. Remove storage compartment from dashboard.

### TIP

If removing storage compartment is difficult, carefully use tool to pry storage compartment upwards where marked "LIFT HERE."

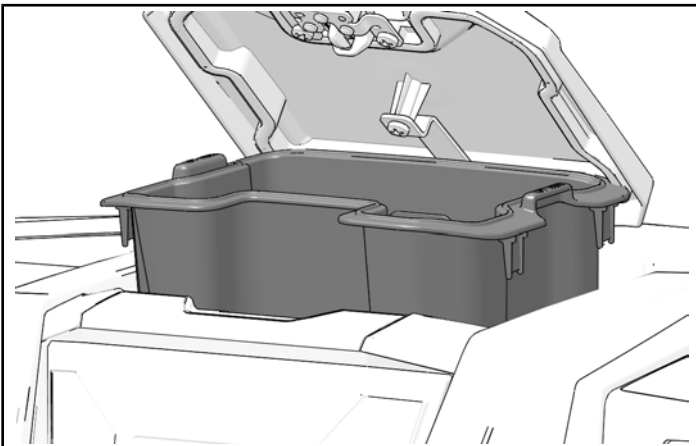

## DASHBOARD TOP REMOVAL

1. Carefully pull up to remove left, center, and right dashboard trim pieces.

### TIP

Release steering tilt lock for improved access.

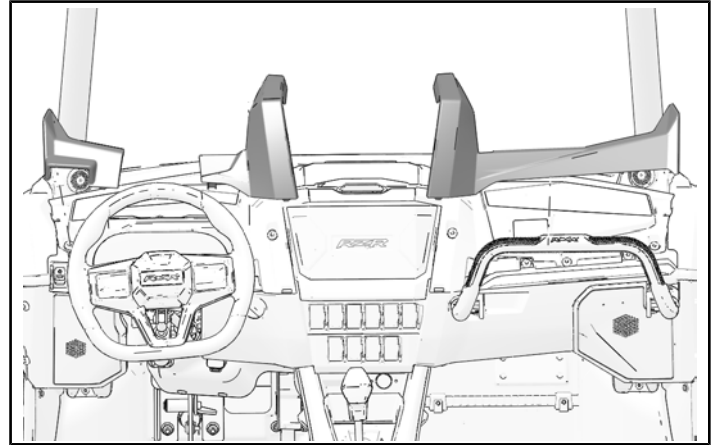

2. Open glove box lid. Remove and keep four dashboard fasteners around glove box opening.

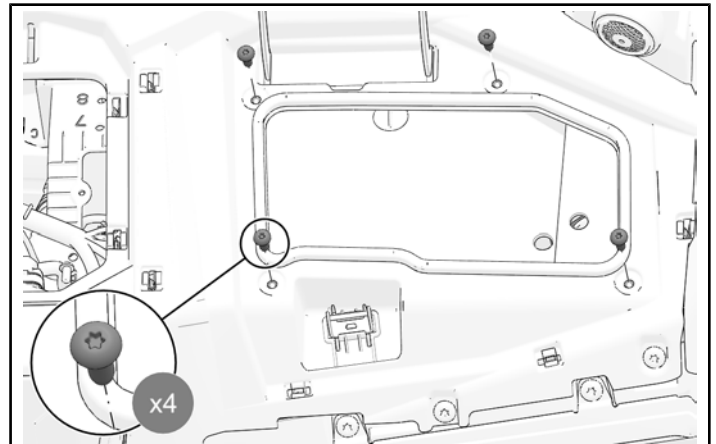

3. Remove and keep three front dashboard fasteners around glove box opening.

**TIP**

Make note of different screw sizes in steps 2 and 3.

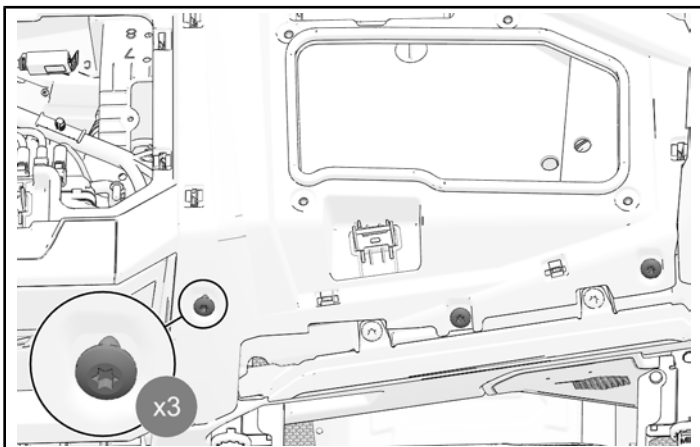

4. Tilt steering wheel down. Remove and keep four dashboard fasteners from dashboard surrounding steering wheel.

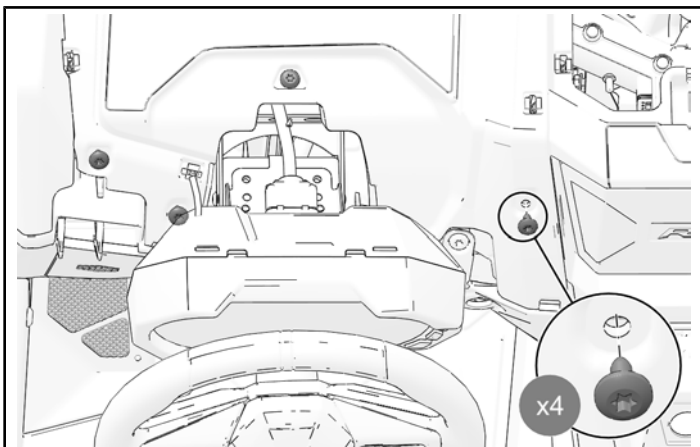

5. Remove and keep two dashboard fasteners from front of vehicle.

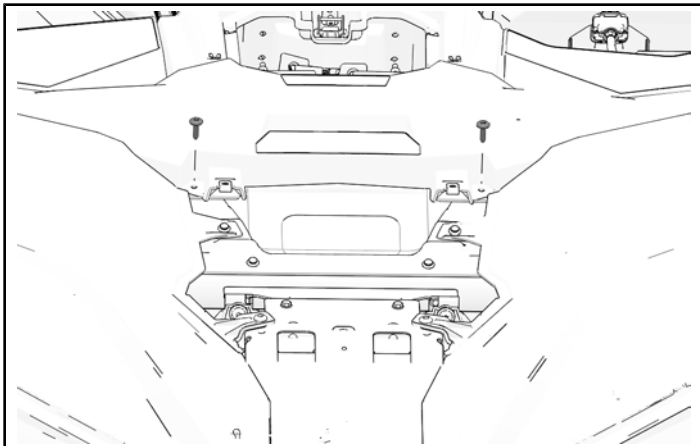

6. Remove and keep two push-pin rivets from front side hood panels.

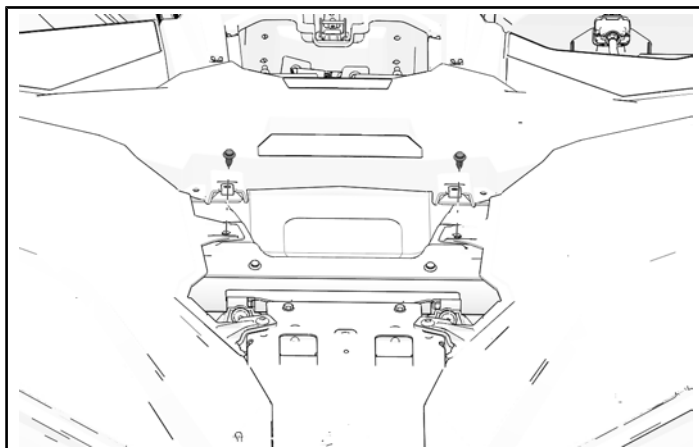

7. Carefully lift edge of left front hood panel to release tab from dashboard top as shown.

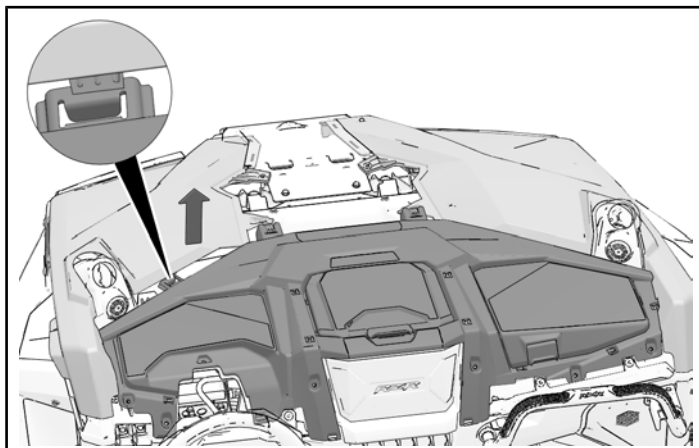

8. Carefully lift edge of right front hood panel to release tab from dashboard top as shown.

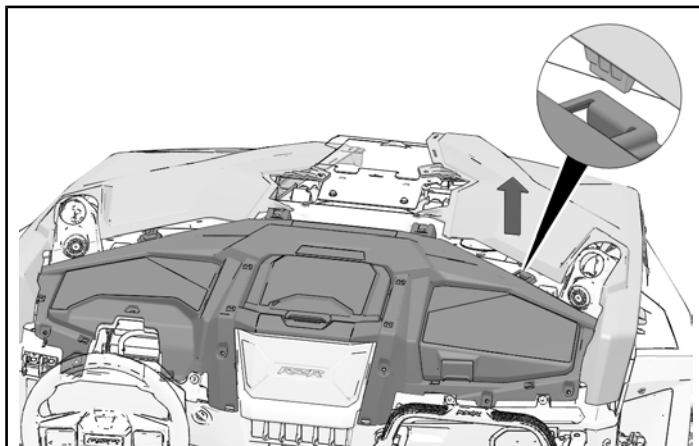



- Carefully keep panels up-and-away from tabs and remove dashboard top by tilting rear section up and pulling out toward rear.

#### TIP

Two people are recommended to complete this step.

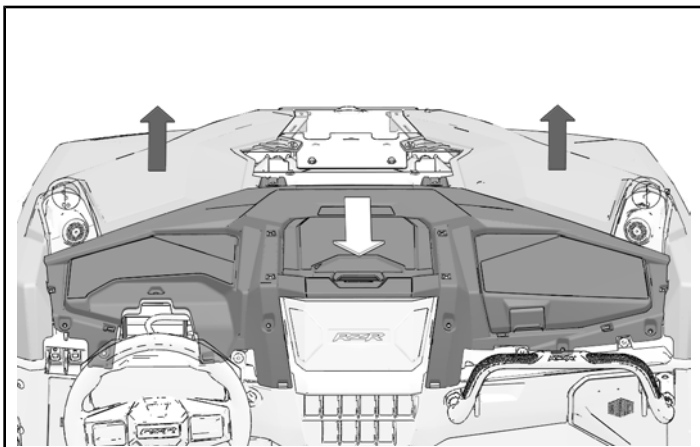

## SEAT REMOVAL

### FRONT SEAT REMOVAL

- Pull up on lever, located below front of seat.

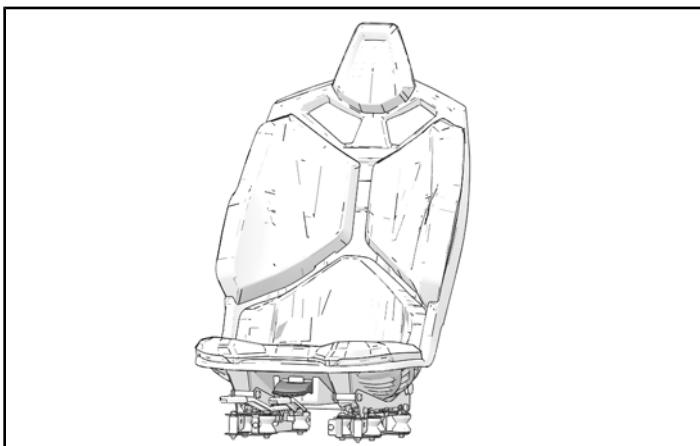

- Tilt seat assembly forward and pull back slightly to disengage from receiver tube and remove seat from vehicle.

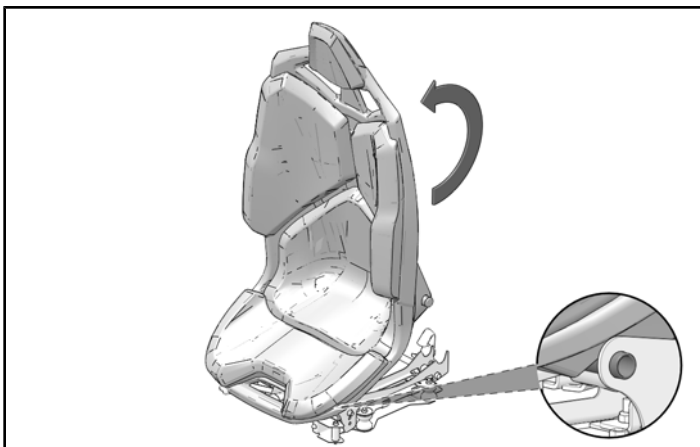

## REAR SEAT REMOVAL

#### NOTE

Left rear seat shown; right rear similar.

- Push lever on back of headrest to disengage from receiver tube. Remove seat backrest from vehicle.

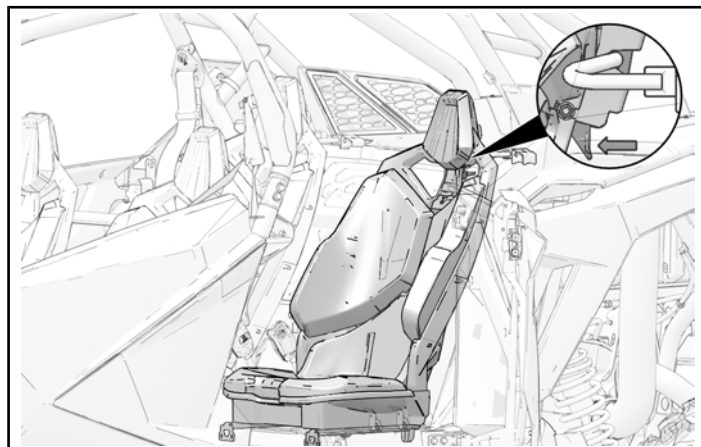

- Remove and keep four seat bracket fasteners. Remove seat from rear seat panel.

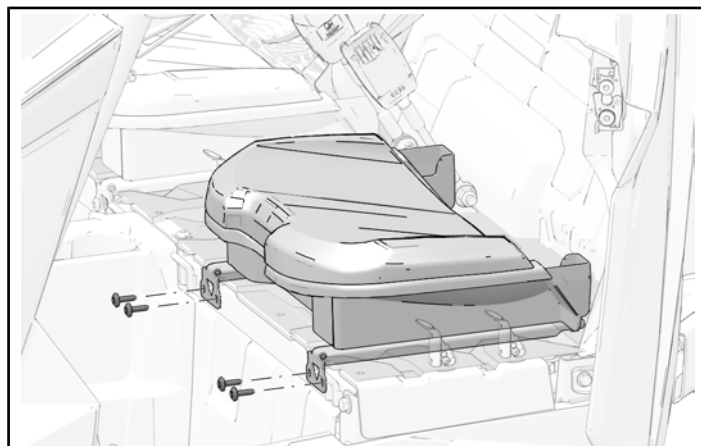

### REAR SEAT PANEL REMOVAL

- Remove and keep eleven seat panel fasteners.





2. Remove and keep one push-pin rivet from right-rear of seat panel.

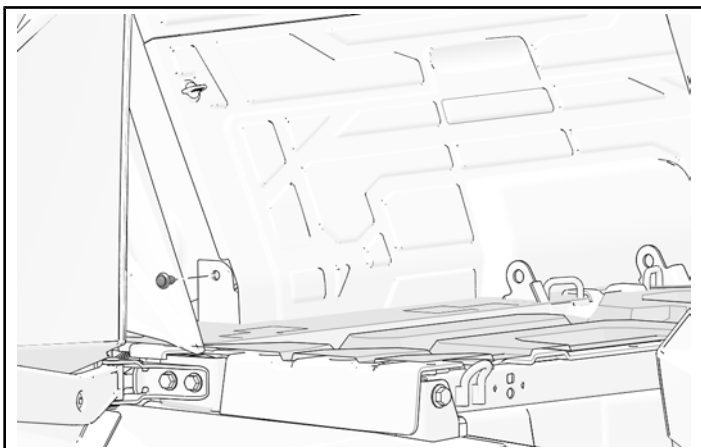

3. Remove seat panel from vehicle.

### **REAR CENTER CONSOLE DISASSEMBLY**

#### **IMPORTANT**

Note size difference of fasteners removed in steps 1 and 2.

1. Remove and keep two center console top fasteners (longer).

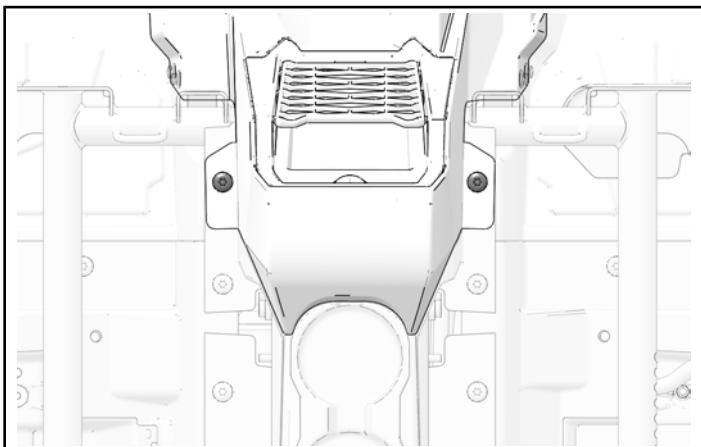

2. Remove and keep four center console side fasteners (shorter).

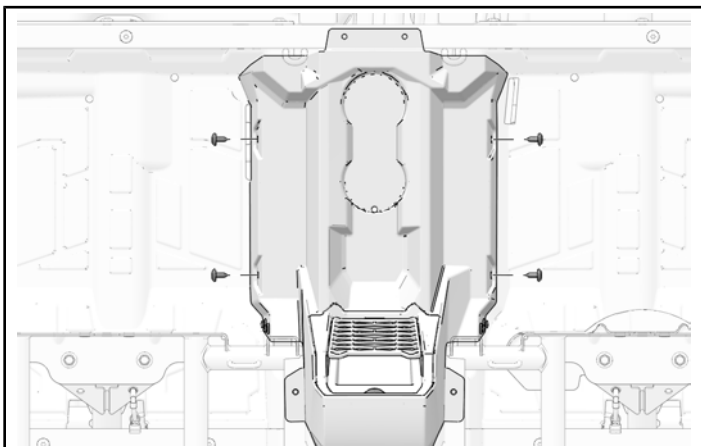

3. Remove and keep four push-pin rivets.

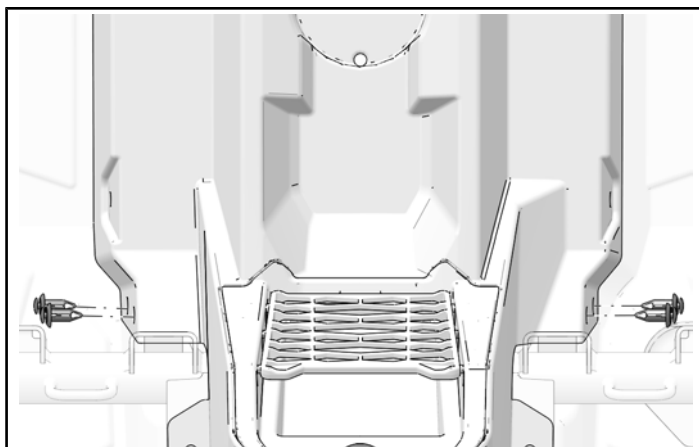

### **FRONT CENTER CONSOLE DISASSEMBLY**

#### **STORAGE COMPARTMENT REMOVAL**

Storage Compartment Removal applies to two-passenger vehicles only.

1. Open center console.

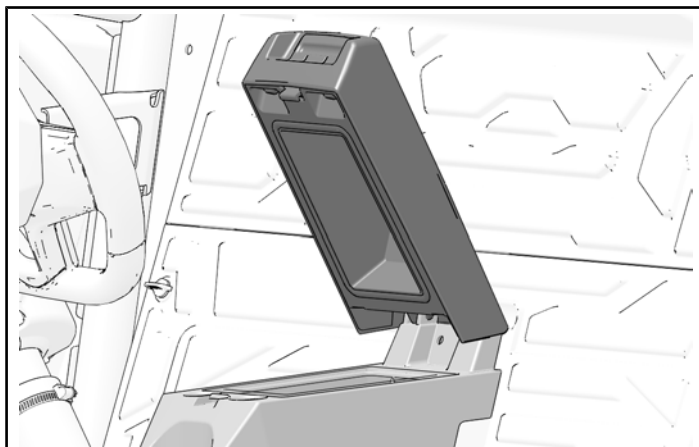

2. Turn each knob 1/4 to disengage from center console panel.

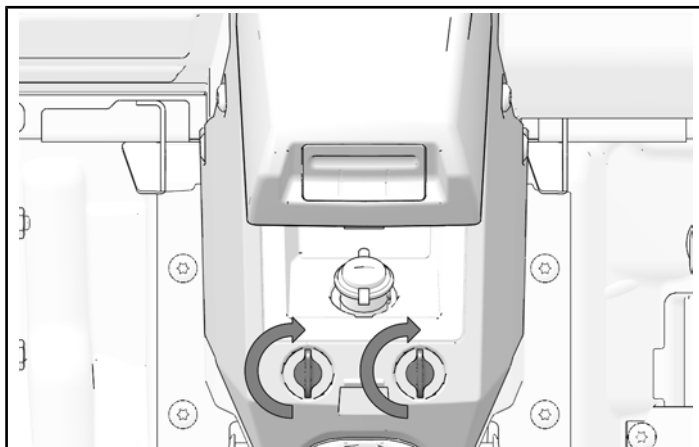

3. Remove and keep storage compartment.

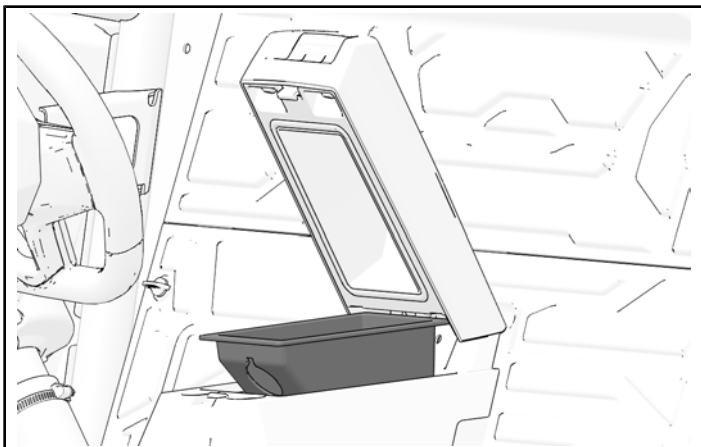

4. Disconnect 12 volt outlet from within center console cavity.

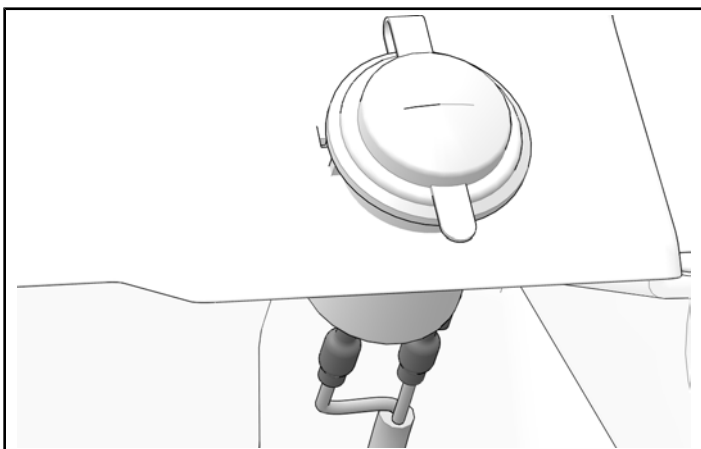

5. Remove and keep two center console fasteners from driver side.

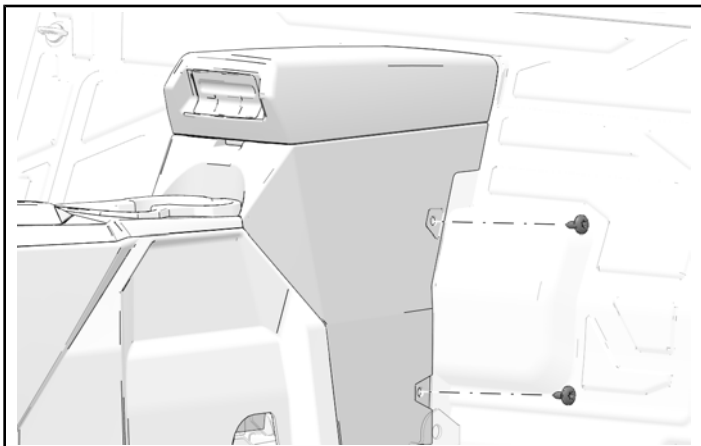

6. Remove and keep two center console fasteners from passenger side.



7. Remove center console storage compartment from vehicle.

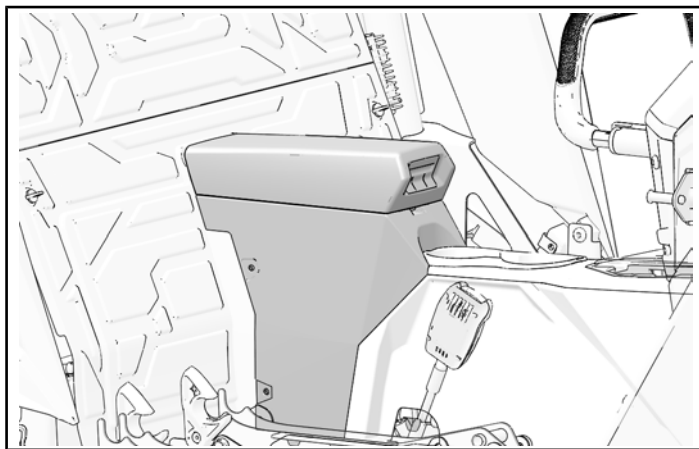

#### LEFT-HAND PANEL DISASSEMBLY

1. Remove and keep one push-pin rivet from center console.

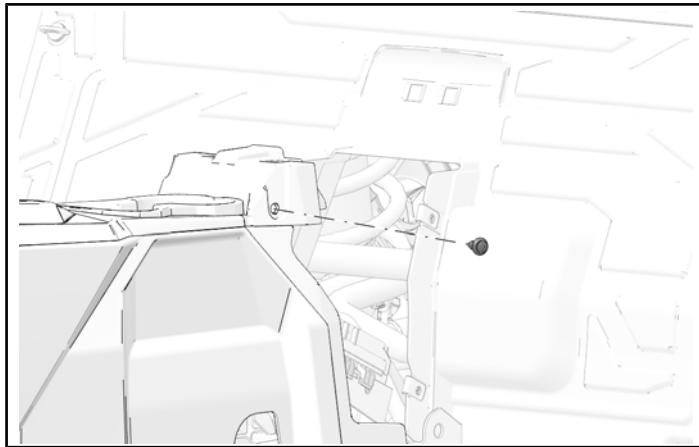

2. Remove and keep eight center console fasteners from driver's side.

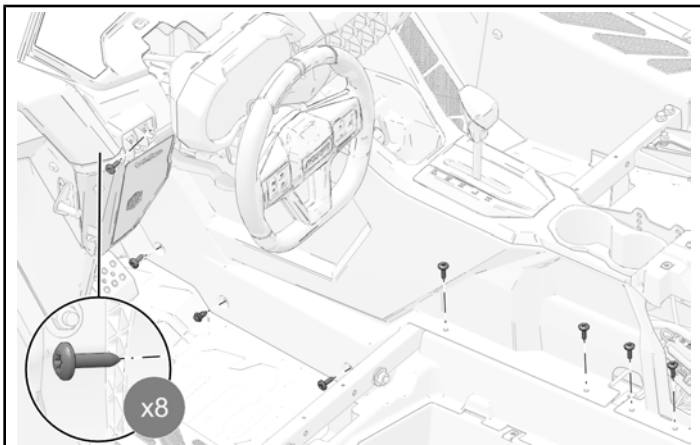

3. Remove and keep one push-pin rivet and fuse block fastener.

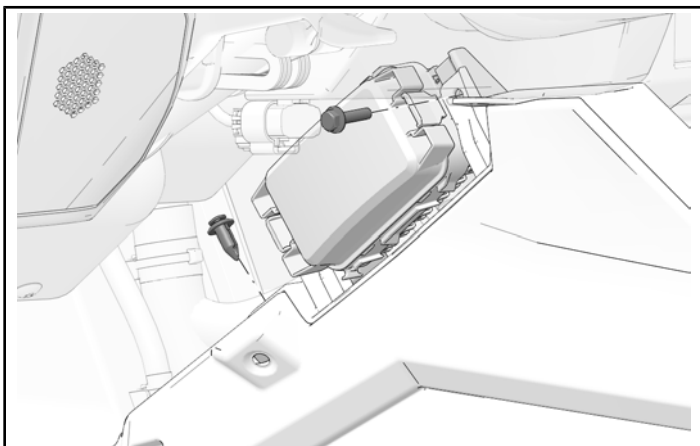

4. Loosen, but do not remove, left-hand fuse block fastener.

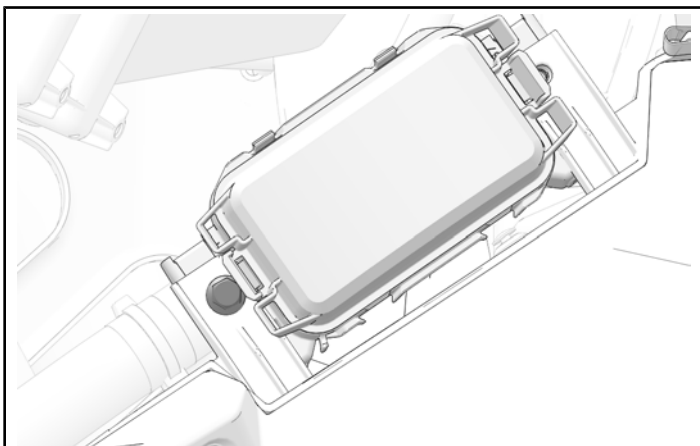

5. Rotate fuse block upwards towards front of vehicle to access push-pin rivet beneath fuse block.

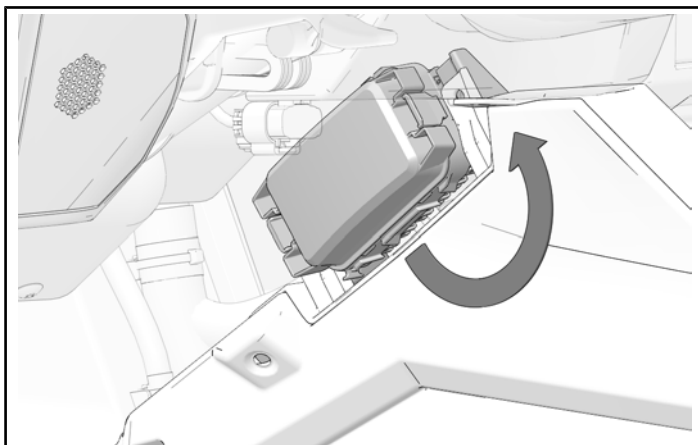

6. Remove and keep push-pin rivet.

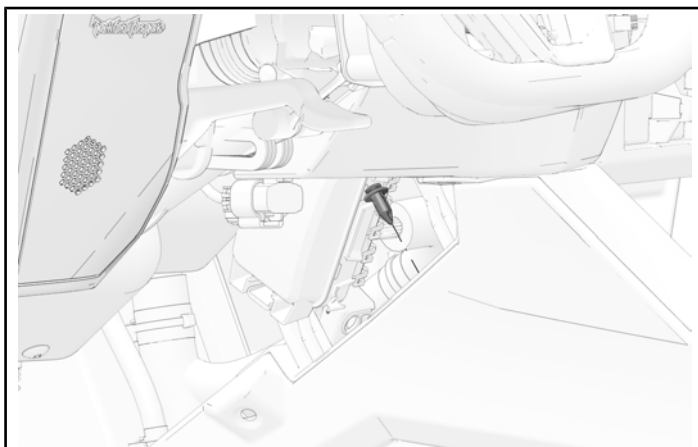

#### RIGHT-HAND PANEL DISASSEMBLY

1. Remove and keep one push-pin rivet from center console.

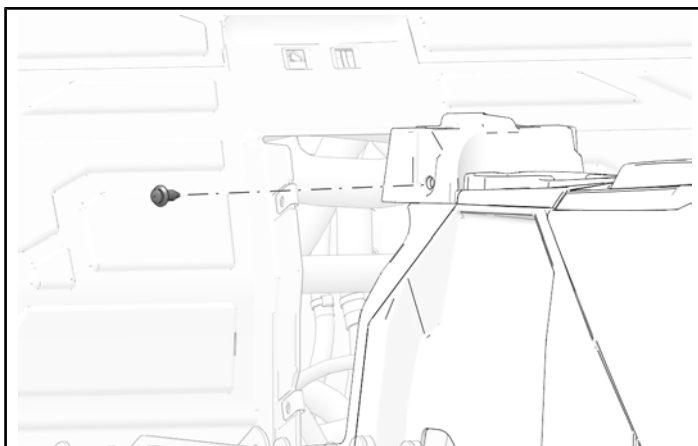

2. Remove and keep eight center console fasteners from passenger's side.

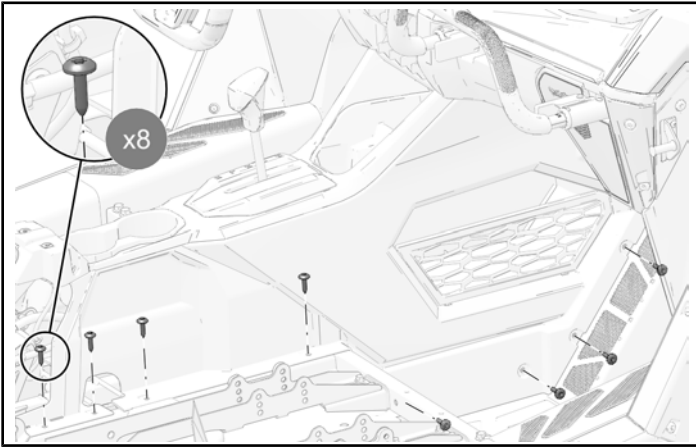

3. Remove and keep two push-pin rivets.

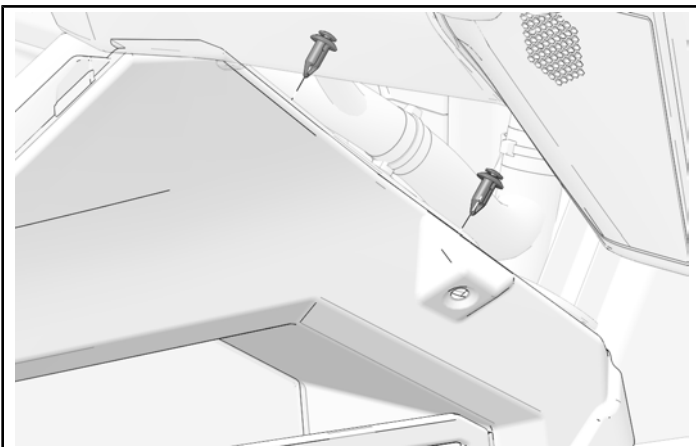

4. Carefully lift center panel upwards to remove side panels from vehicle.

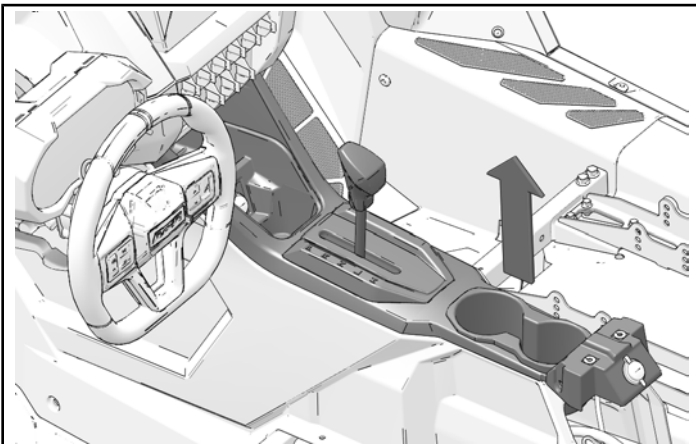

## CLOSE-OFF PANEL REMOVAL

1. Turn each knob 1/4 to disengage and remove top close-off panel.

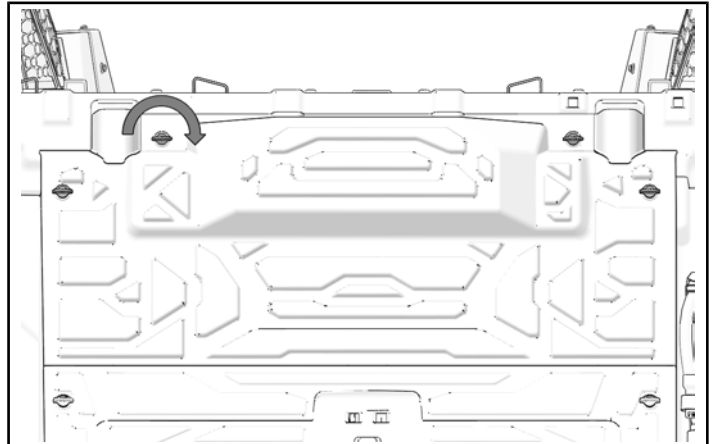

2. Turn each knob 1/4 to disengage and remove bottom close-off panel.

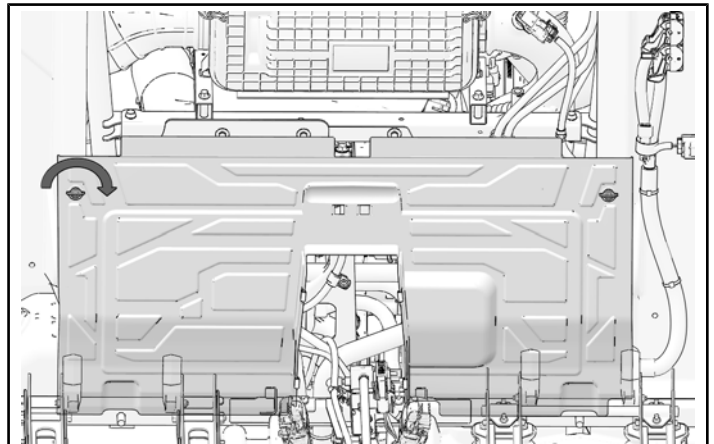

## ACCESSORY INSTALLATION

### DASHBOARD VENT INSTALLATION

#### DRIVER AND PASSENGER DEMIST TEMPLATES

1. Clean dashboard surface with isopropyl alcohol.

#### **⚠ WARNING**

Isopropyl alcohol is hazardous to your health. See isopropyl alcohol packaging for proper handling instructions, including recommended personal protective equipment such as goggles and chemical resistant gloves.

2. Peel backing from demist vent templates. Adhere each template onto top of dashboard, as shown.
3. Drill two **1/4 in (6 mm)** holes in each template, where marked.

4. Drill two **5/8 in (16 mm)** holes in each template, where marked. Use a cutting tool to remove remaining plastic, as marked by template. Use a deburring tool, as needed.

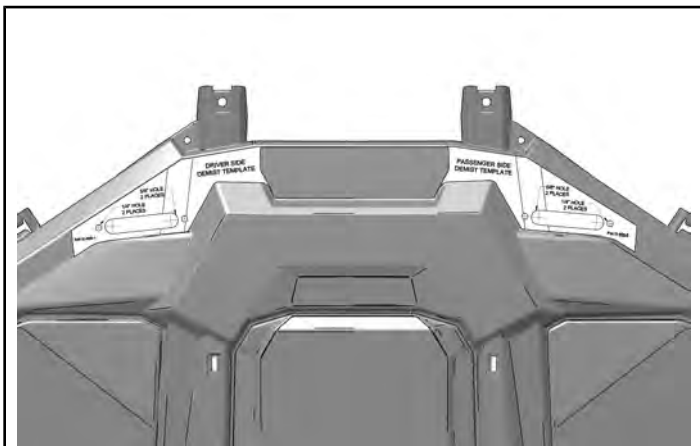

### CENTER DEMIST TEMPLATE

1. Clean upper firewall surface with isopropyl alcohol.

#### ⚠ WARNING

Isopropyl alcohol is hazardous to your health. See isopropyl alcohol packaging for proper handling instructions, including recommended personal protective equipment such as goggles and chemical resistant gloves.

2. Peel backing from center demist template. Adhere template onto top of firewall, as shown.
3. Drill four **1/4 in (6 mm)** holes in template, where marked.
4. Drill two **1-3/8 in (35 mm)** holes in template, where marked. Use a cutting tool to remove remaining plastic, as marked by template. Use a deburring tool, as needed.

#### TIP

Use a step drill bit.

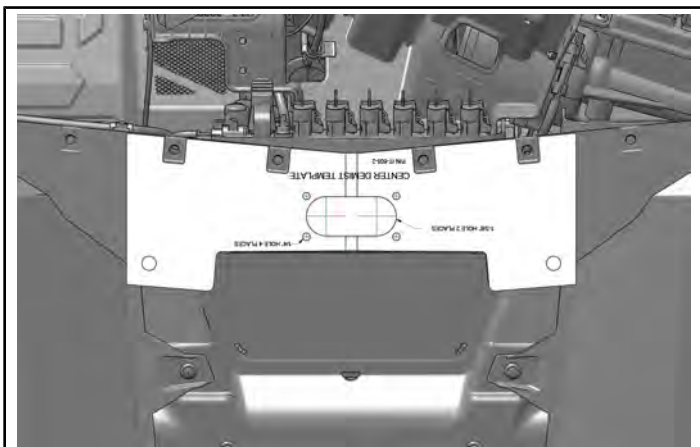

### DEMIST VENT INSTALLATION

1. Place one vent **⑧** in each dashboard vent hole. Align demist duct **⑥** with underside of dashboard and install with four vent fasteners **⑦**. Torque fasteners until fully seated.

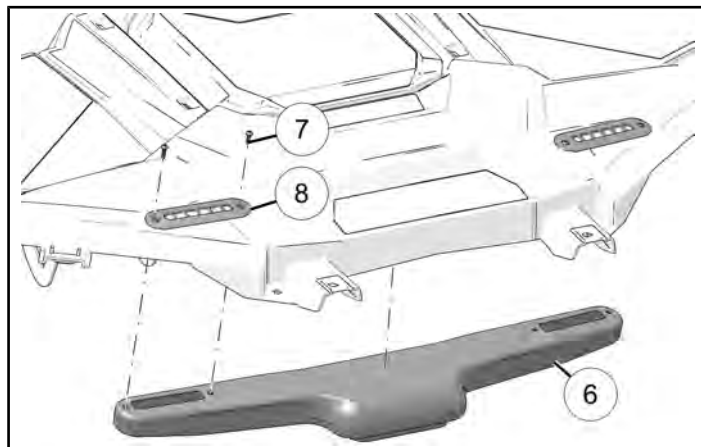

2. Align duct adapter **⑫** with hole in upper firewall. Install with four duct adapter fasteners **⑬**. Torque fasteners until full seated.

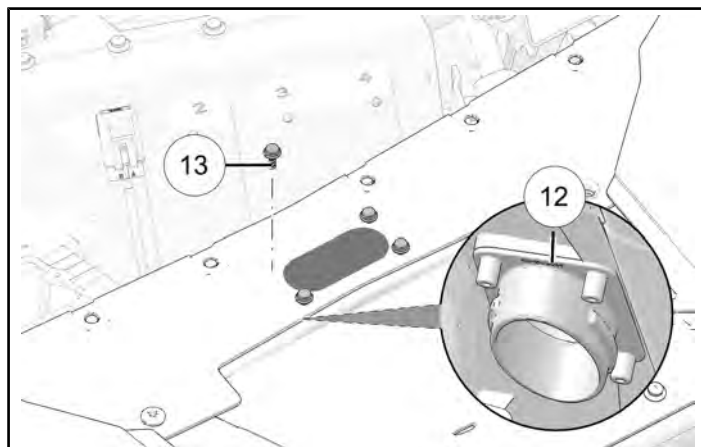

3. From inside of vehicle, put main duct **⑪** through opening in firewall.

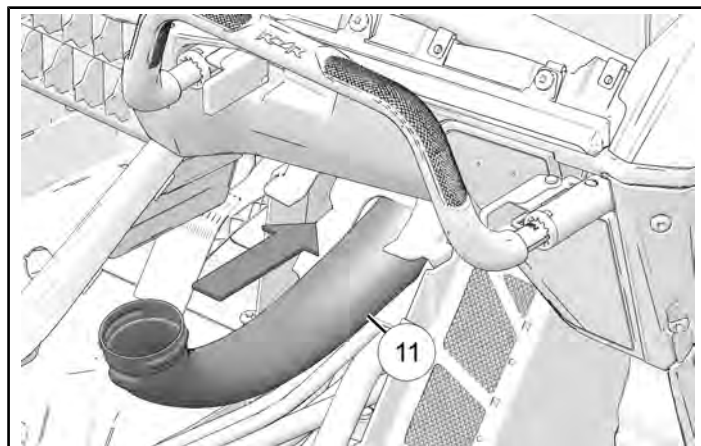



4. Maneuver main duct ⑪ upright and install onto duct adapter.

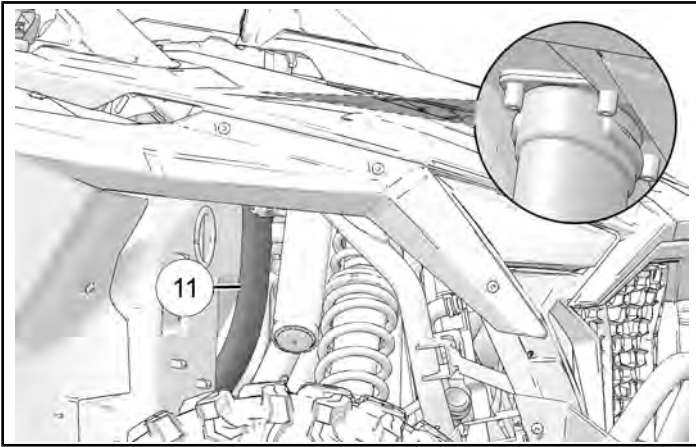

## LEFT-HAND CONSOLE PREPARATION

### FLOOR VENT TEMPLATE

1. Clean console panel surface with isopropyl alcohol.

#### ⚠ WARNING

Isopropyl alcohol is hazardous to your health. See isopropyl alcohol packaging for proper handling instructions, including recommended personal protective equipment such as goggles and chemical resistant gloves.

2. Peel backing from floor vent template. Adhere template onto console panel, as shown.
3. Use a hole saw to cut one **3 in (76 mm)** hole in template, where marked.

#### TIP

Drill pilot hole first.

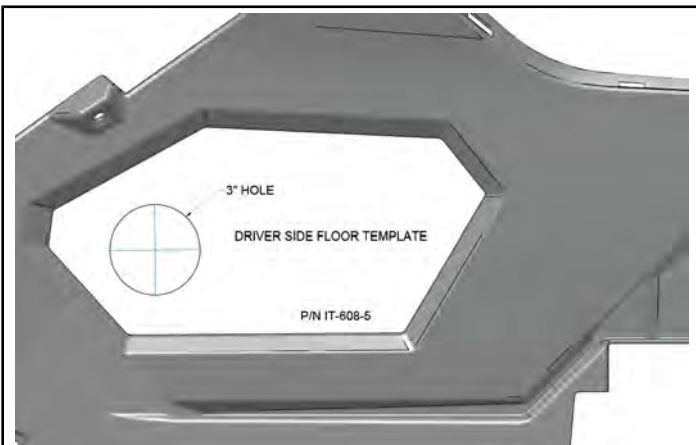

## HEATER BRACKET TEMPLATE

1. Clean console panel surface with isopropyl alcohol.

#### ⚠ WARNING

Isopropyl alcohol is hazardous to your health. See isopropyl alcohol packaging for proper handling instructions, including recommended personal protective equipment such as goggles and chemical resistant gloves.

2. Peel backing from heater bracket template. Adhere template onto console panel, as shown.
3. Drill one **5/16 in (8 mm)** hole in template, where marked.

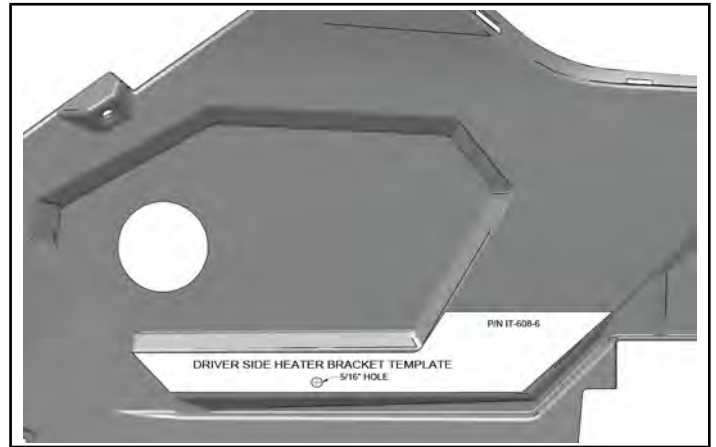

## FLOOR VENT INSTALLATION

1. Install vent insert ⑱ and vent ring ⑲ with console panel in between.

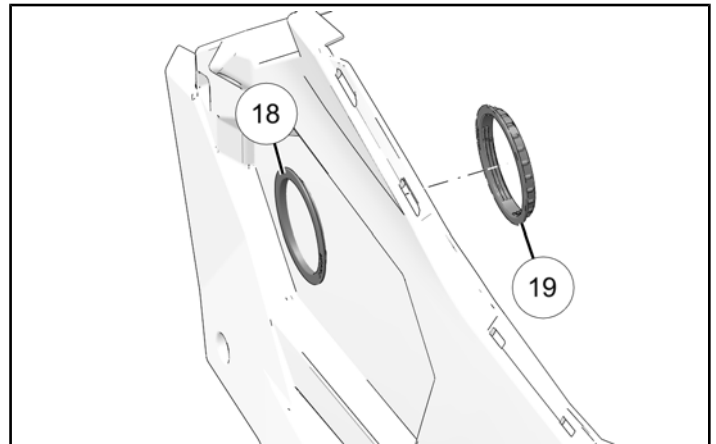



## RIGHT-HAND CONSOLE PREPARATION

### STORAGE COMPARTMENT PREPARATION

1. Remove storage net from console panel.

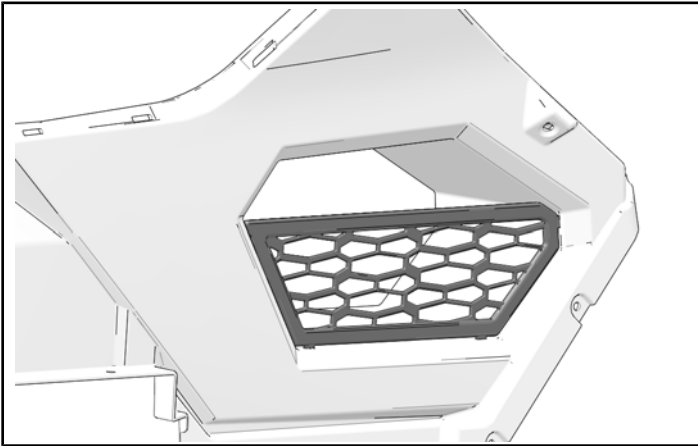

2. Cut and remove storage compartment along flange line.

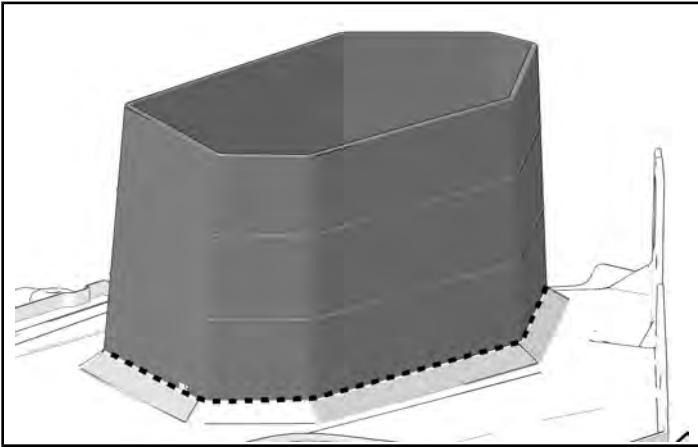

3. Align cover plate ⑭ with console panel and mark console panel, as shown. Use witness lines on cover plate as a guide. Cut along marked lines and flange of console panel. Leave approximately **1/8 in** of plastic from edge of flange so that cover plate fully covers opening.

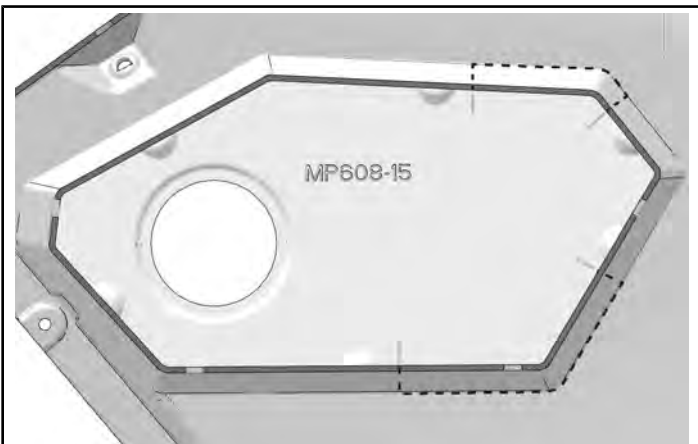

4. Align cover plate ⑭ with console panel and mark six holes. Remove cover plate and drill six **5/16 in (8 mm)** holes.

### IMPORTANT

Do not install cover plate at this time.

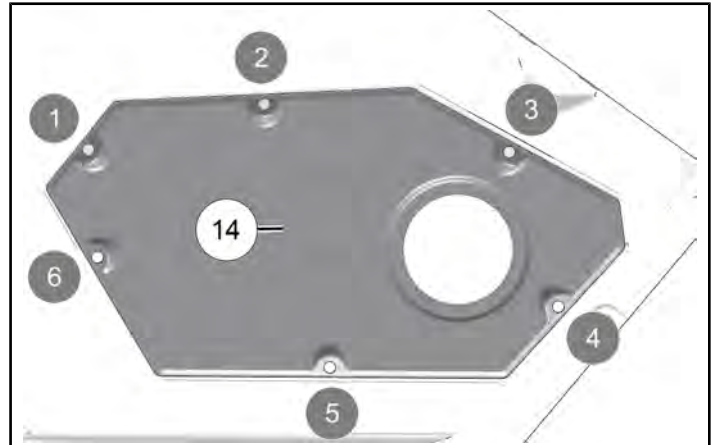

### HEATER BRACKET TEMPLATE

1. Clean console panel surface with isopropyl alcohol.

### ⚠ WARNING

Isopropyl alcohol is hazardous to your health. See isopropyl alcohol packaging for proper handling instructions, including recommended personal protective equipment such as goggles and chemical resistant gloves.

2. Peel backing from heater bracket template . Adhere template onto console panel, as shown.
3. Drill one **5/16 in (8 mm)** hole in template, where marked.

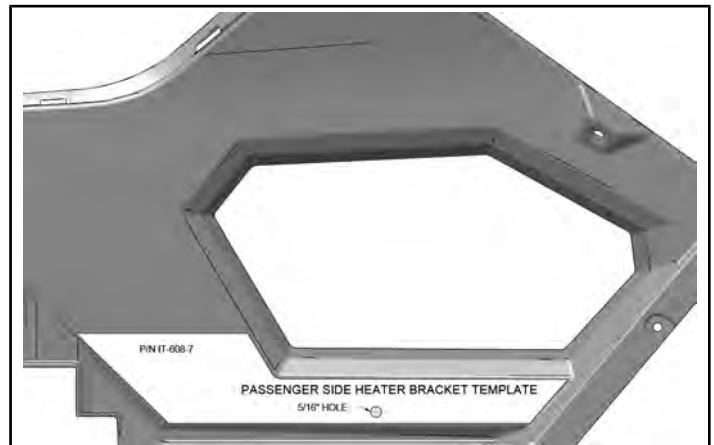

## FLOOR VENT INSTALLATION

1. Install vent insert **18** and vent ring **19** with cover panel **14** in between.

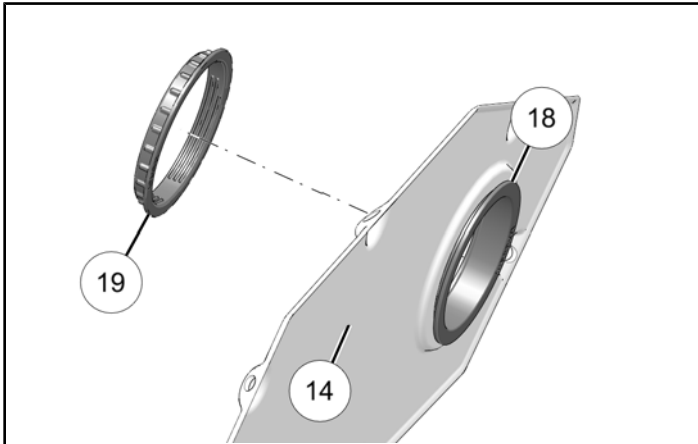

## CONTROL INSTALLATION

1. Place control assembly **1** behind dashboard and align with drilled holes.

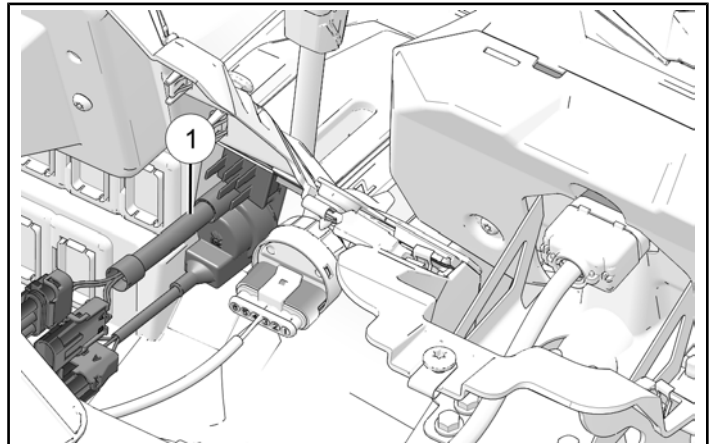

## DASHBOARD CONTROL INSTALLATION

### CONTROL TEMPLATE

1. Clean dashboard surface with isopropyl alcohol.

#### ⚠ WARNING

Isopropyl alcohol is hazardous to your health. See isopropyl alcohol packaging for proper handling instructions, including recommended personal protective equipment such as goggles and chemical resistant gloves.

2. Peel backing from controls template. Adhere template onto front of dashboard, as shown.
3. Drill four **11/32 in (8.5 mm)** holes in template, where marked.
4. Drill two **1/2 in (12.5 mm)** holes in template, where marked.
5. Drill one **13/16 in (20.5 mm)** hole in template, where marked.
6. Drill three **1/8 in (3 mm)** holes in template, where marked.

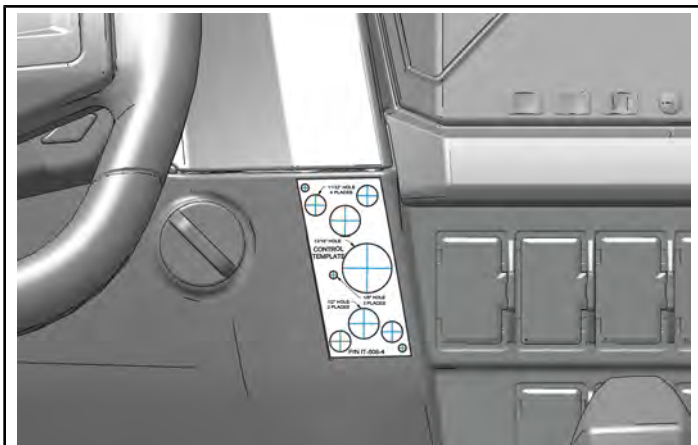

2. Install control assembly to dashboard with three screws **2**. Torque until screws are fully seated.

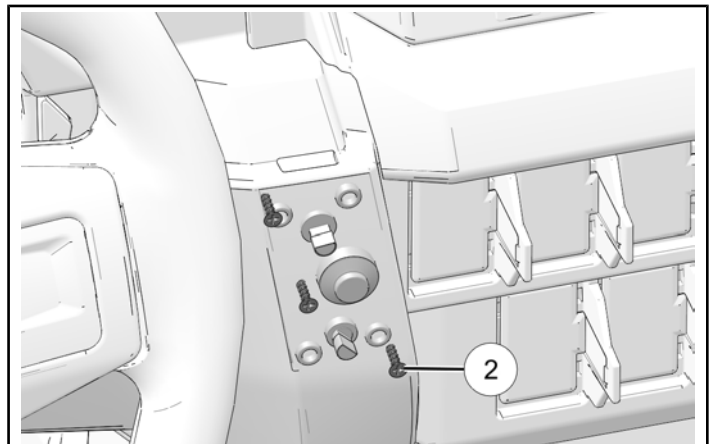

3. Align control face-plate **3** with control assembly and press until plate snaps into place.

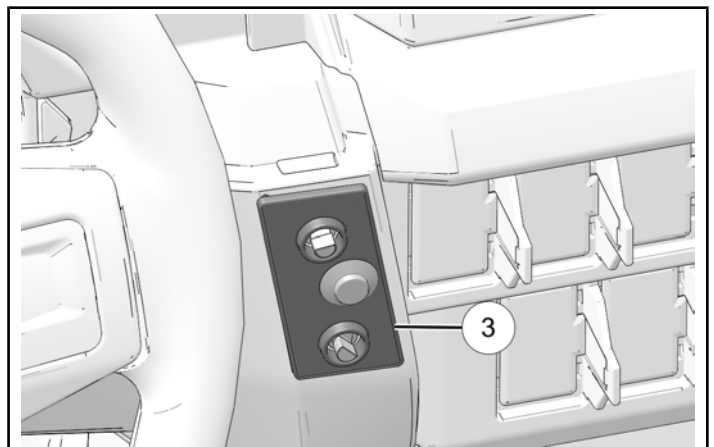

4. Install two control knobs ④ and ⑤ onto control assembly.

#### TIP

Control knobs are different from one another. Loosely install knobs in left-most position and then turn right to make sure correct knob is installed.

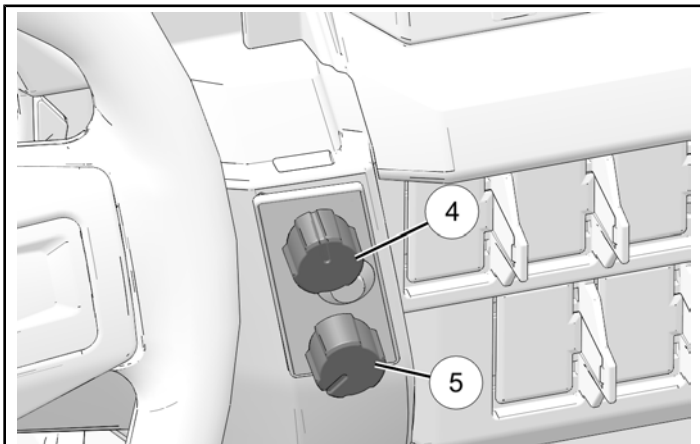

### HEATER ASSEMBLY INSTALLATION

#### NOTICE

Top center console panel hidden for clarity.

1. Remove and keep two nuts from shifter bracket.

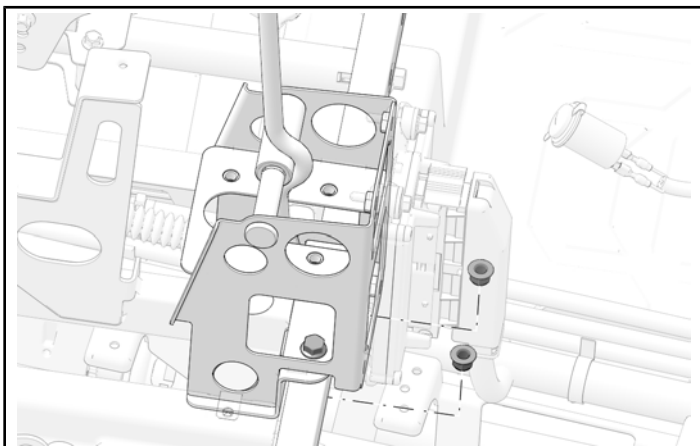

2. From passenger side, place heater assembly ⑮ in center console opening.

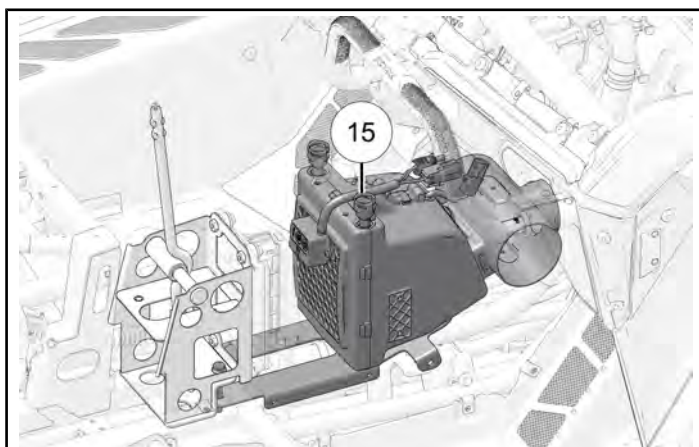

3. Place mode control assembly ⑩ between main duct and heater assembly.

#### IMPORTANT

Make sure main chassis harness routes to the driver side of duct assembly, when installed.

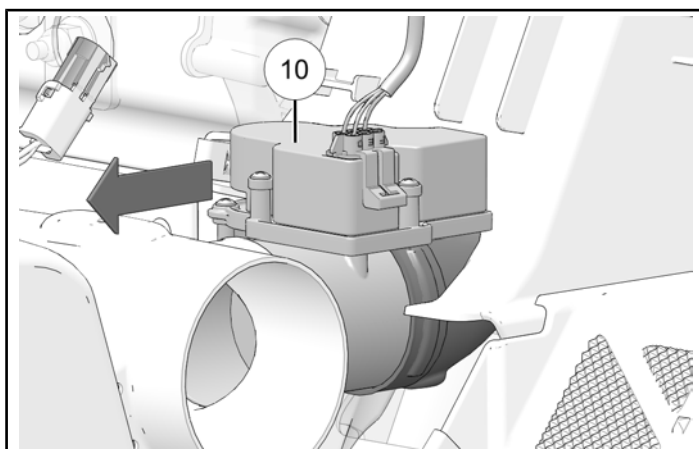

4. Install mode control assembly ⑩ into heater assembly.

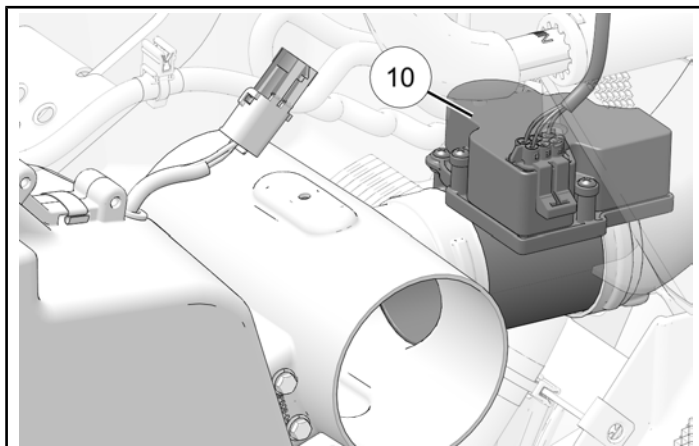



5. Install heater assembly to shifter bracket fasteners with retained nuts. Counter-hold nuts and torque shifter bracket fasteners to specification.

#### TORQUE

Shifter Bracket Fasteners:  
**18 ft-lbs (25 N·m)**

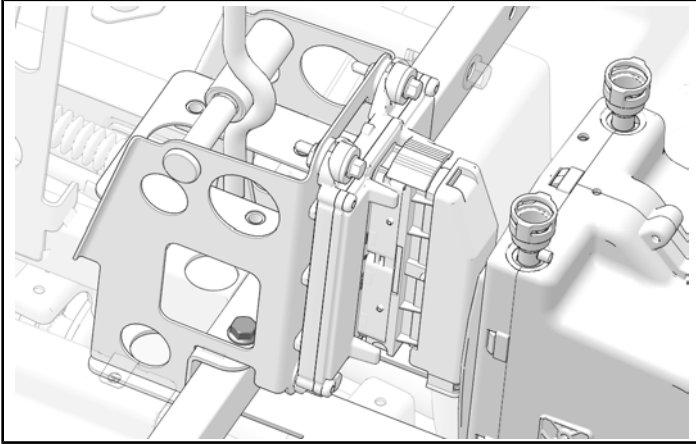

### WATER VALVE INSTALLATION

#### WATER VALVE TEMPLATE

1. Clean rear panel surface with isopropyl alcohol.

#### ⚠ WARNING

Isopropyl alcohol is hazardous to your health. See isopropyl alcohol packaging for proper handling instructions, including recommended personal protective equipment such as goggles and chemical resistant gloves.

2. Peel backing from water valve template. Adhere template onto rear panel, as shown.
3. Drill four **1/4 in (6 mm)** holes in template, where marked.

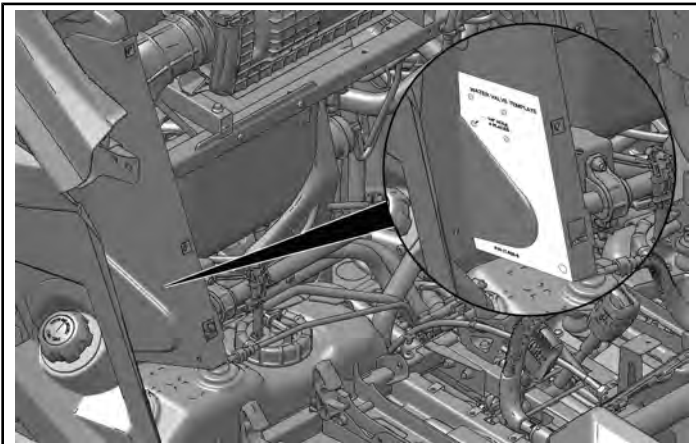

### WATER VALVE INSTALLATION

1. Align water valve ⑳ with drilled holes and install with four water valve fasteners ⑬. Torque fasteners until fully seated.

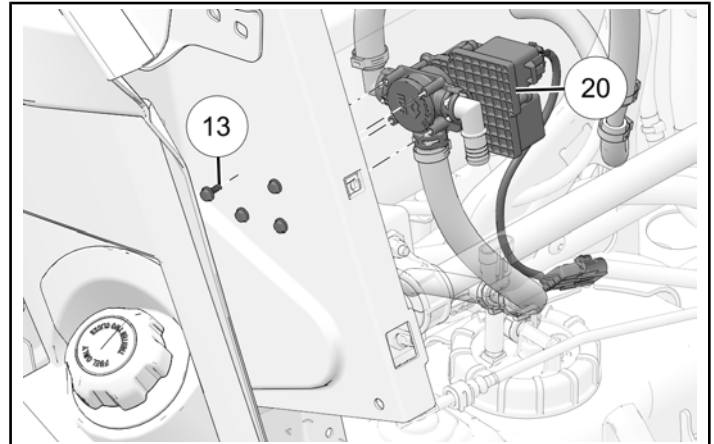

### HEATER HOSE ROUTING

1. Identify coolant hose, coming from coolant overflow bottle, and cut in the middle.

#### TIP

Hose is larger in diameter and routes towards gas tank.

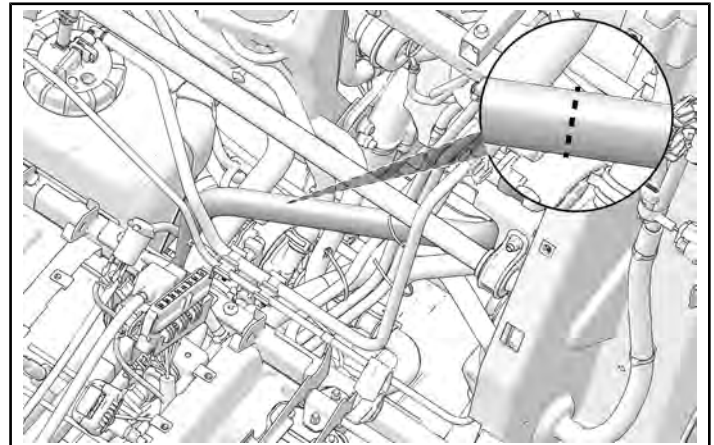

2. Install Y-pipe ②⑤ between two ends of coolant hose with clamps ②⑥

#### TORQUE

Clamp Fasteners:  
**30-50 in-lbs (3-6 N·m)**

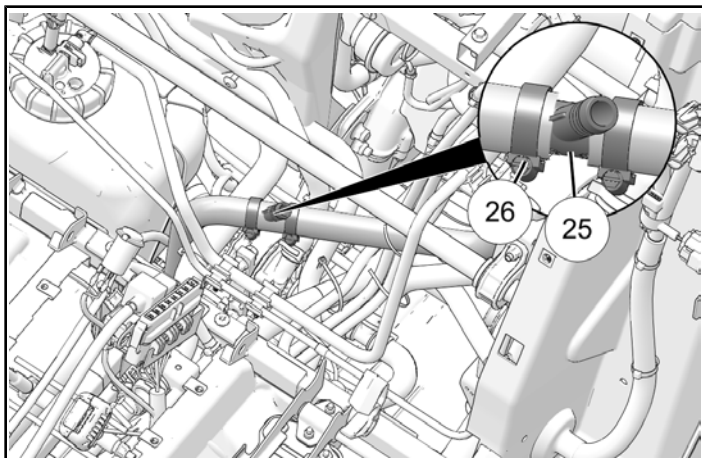

3. Route outlet hose ②⑧ (93 in) under shifter mount and along passenger side of heater assembly. Wrap hose around front side of heater.

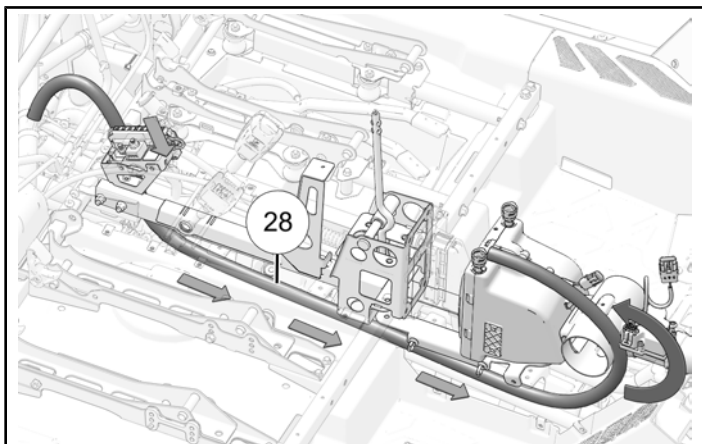

4. Install port into heater with retaining clip ②④.

#### TIP

Use silicone lube on O-ring.

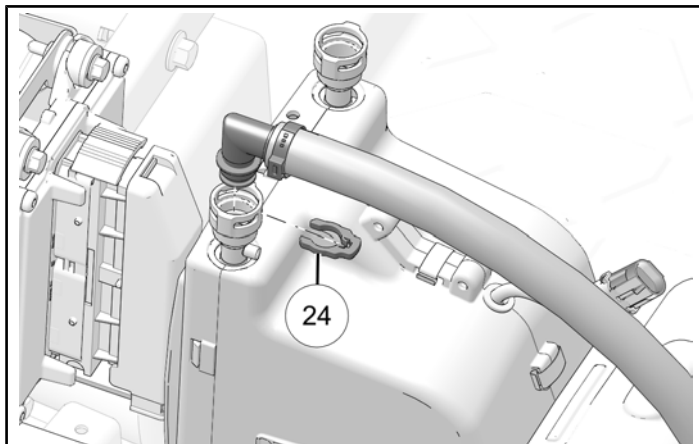

5. Cut hose to length (two passenger vehicles only). Install hose to Y-pipe with clamp ②⑨.

#### NOTICE

Hose does not need to be trimmed for multi-passenger vehicles.

#### TORQUE

Clamp Fasteners:  
**30-50 in-lbs (3-6 N·m)**

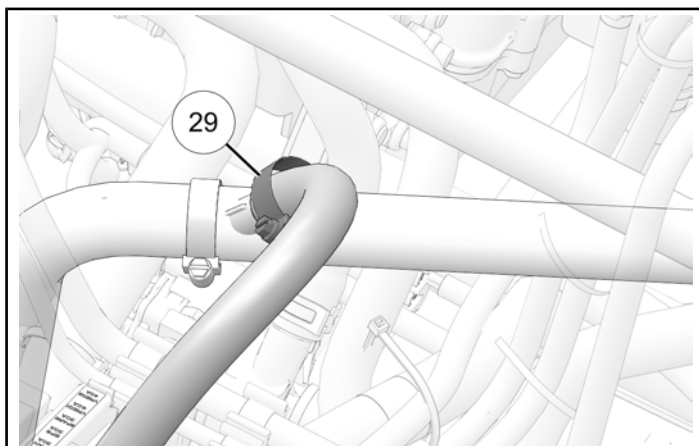

6. Route inlet hose ②⑦ (125 in) along driver side of heater assembly. Wrap hose around front side of heater.

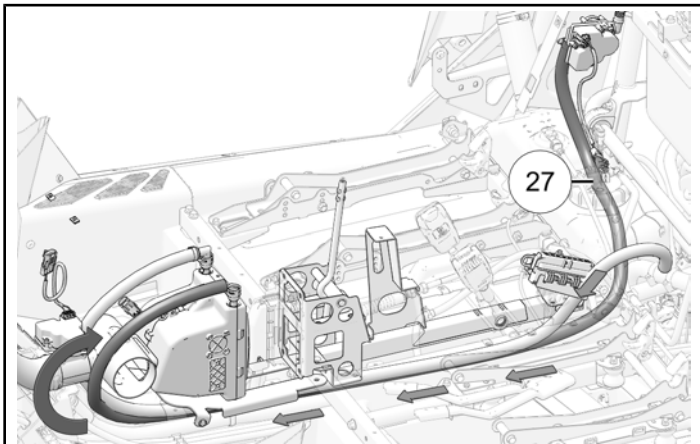

7. Install port into heater with retaining clip ②④.

**TIP**

Use silicone lube on O-ring.

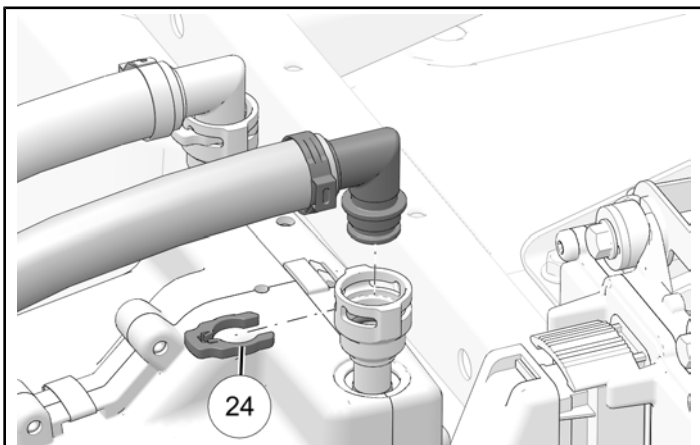

8. Cut inlet hose to length (two passenger vehicles only). Install hose to water valve with clamp ②⑨.

**NOTICE**

Hose does not need to be trimmed for multi-passenger vehicles.

**TORQUE**

Clamp Fasteners:  
**30-50 in-lbs (3-6 N·m)**

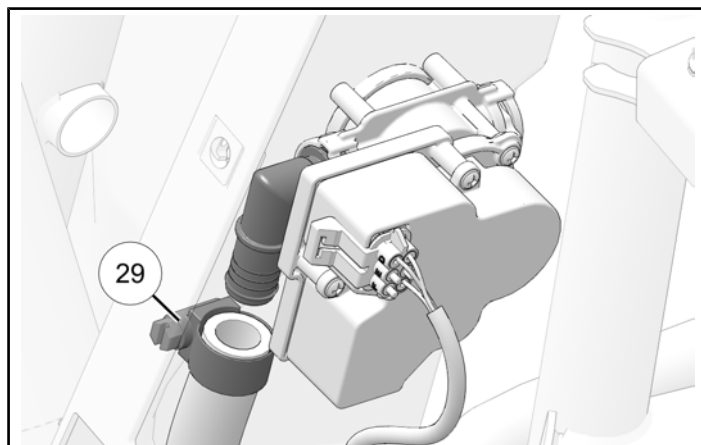

**WATER VALVE HOSE ROUTING**

**HEAT SHIELD REMOVAL**

1. Remove and keep three fasteners to remove rear close-off shield.

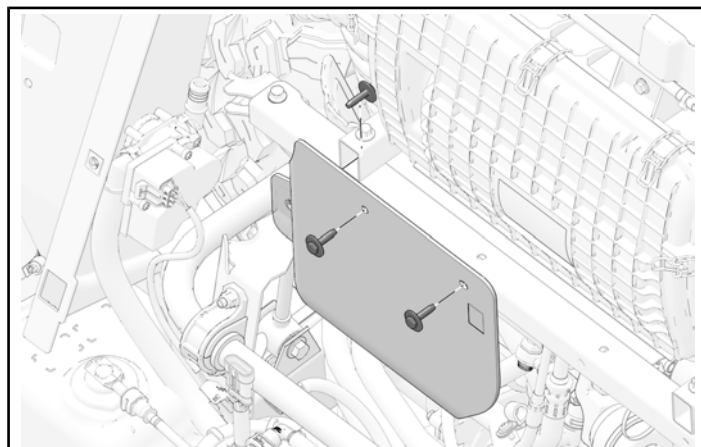



## WATER VALVE HOSE ROUTING

1. Remove and discard oil cooler hose.

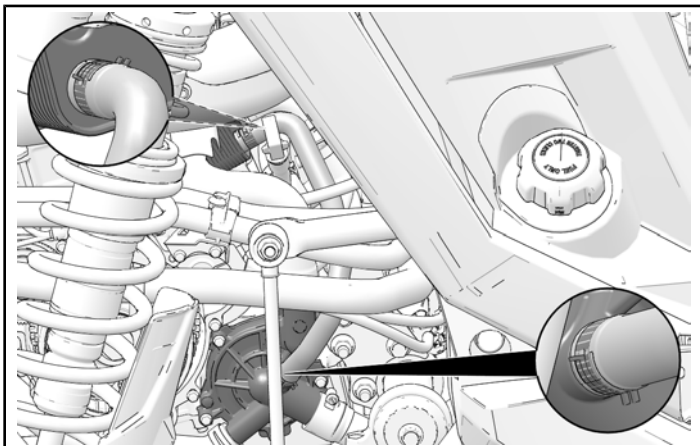

2. Install hose assembly, coming from top of water valve, to oil cooler with clamp 23.

### **TORQUE**

Clamp Fasteners:  
**30-50 in-lbs (3-6 N·m)**

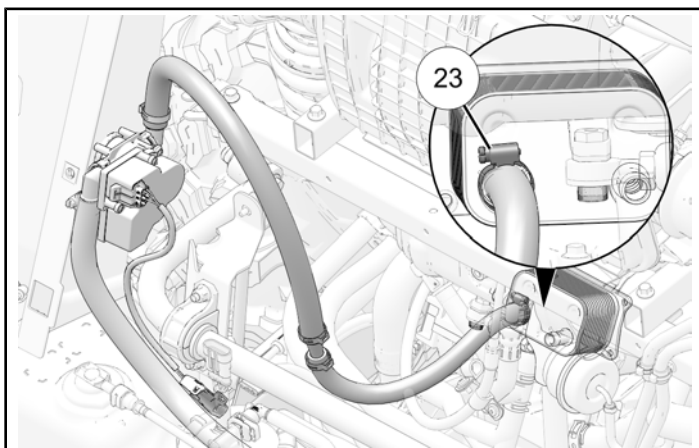

3. Install hose assembly, coming from bottom of water valve, to water pump with clamp 23.

### **TORQUE**

Clamp Fasteners:  
**30-50 in-lbs (3-6 N·m)**

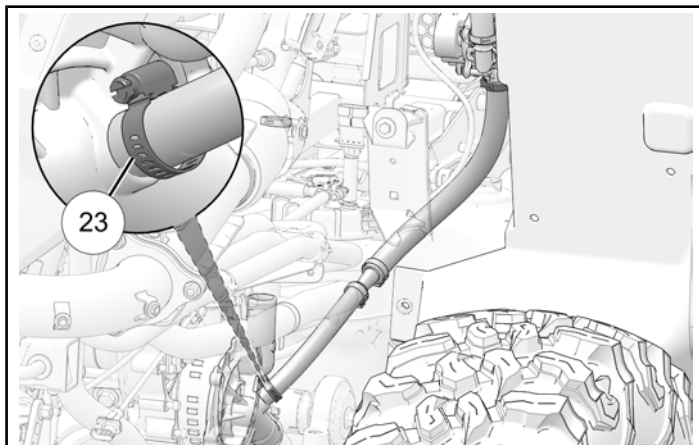

## HEAT SHIELD INSTALLATION

1. Install close-off shield with three retained fasteners. Torque fasteners to specification.

### **TORQUE**

Close-off Shield Fasteners:  
**13 ft-lbs (18 N·m)**

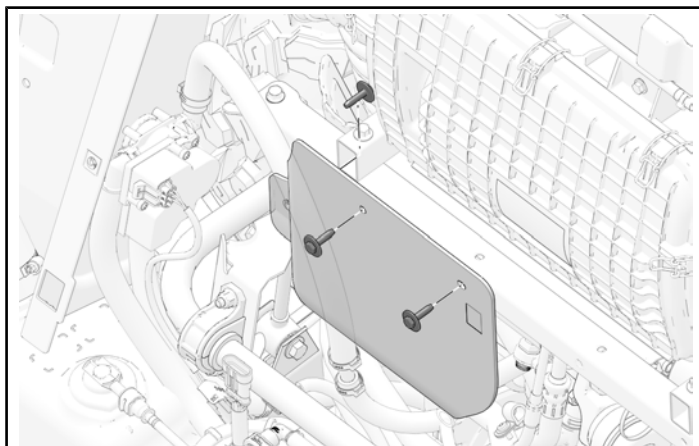

2. Use cable ties 21 to make sure hoses are routed away from sway bar and direct contact with heat sources.

## HEATER HARNESS ROUTING

1. Connect heater harness ② to water valve.

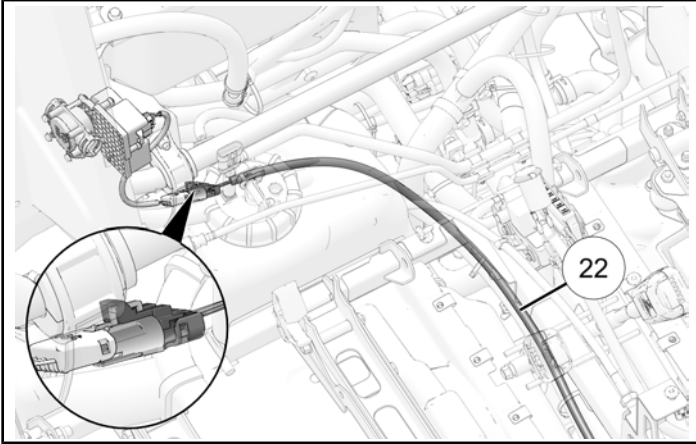

2. Route heater harness ② along passenger side and heater hose. Install with cable ties ①, as needed.

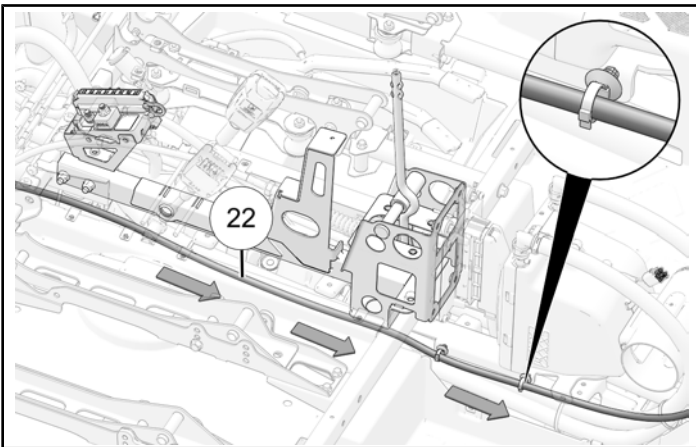

3. Route harness under dashboard into accessory mounting panel. Install to Polaris Pulse® bar. Install fuse relay onto accessory mounting panel.

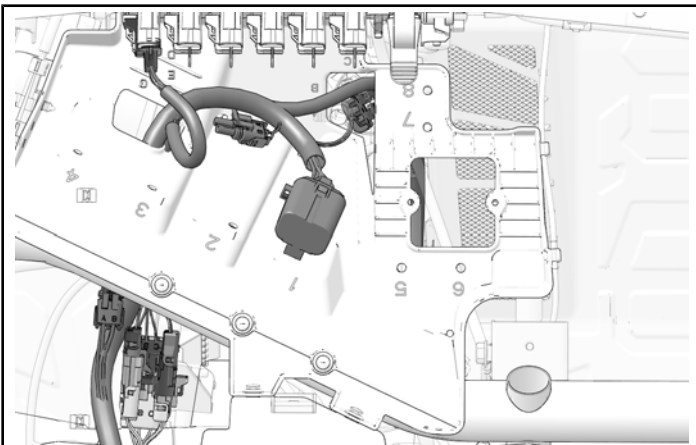

4. Connect heater harness to mode control assembly.

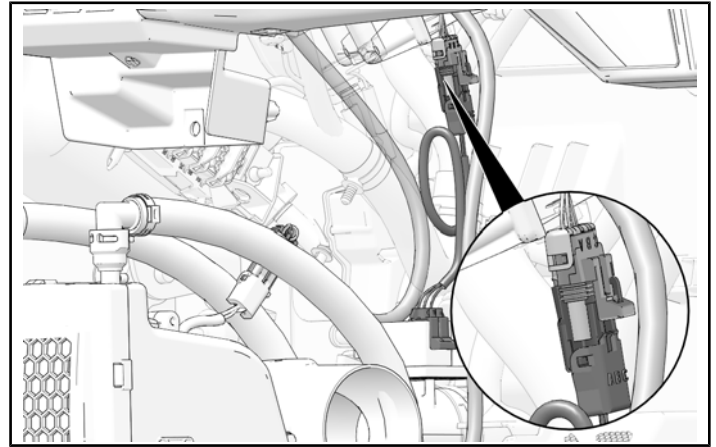

5. Connect heater harness to heater assembly.

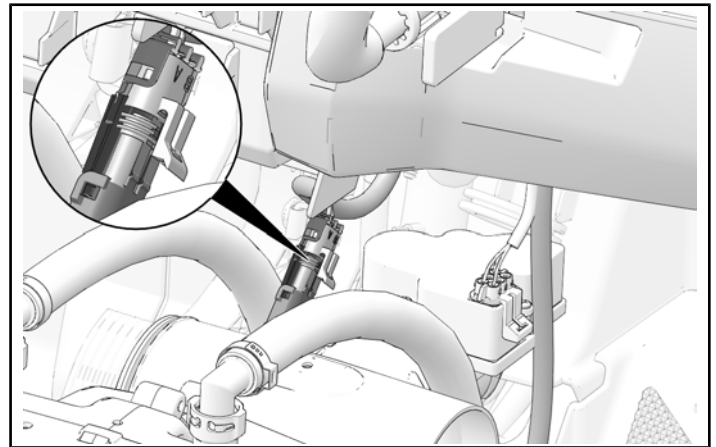

6. Connect heater harness to PWM module, located on front of heater assembly.

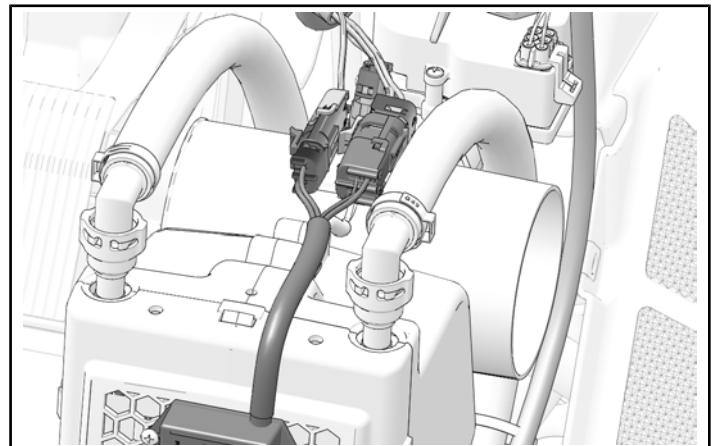

7. Route remaining connectors through opening in accessory mounting panel and towards control panel. Connect corresponding connectors to control panel.

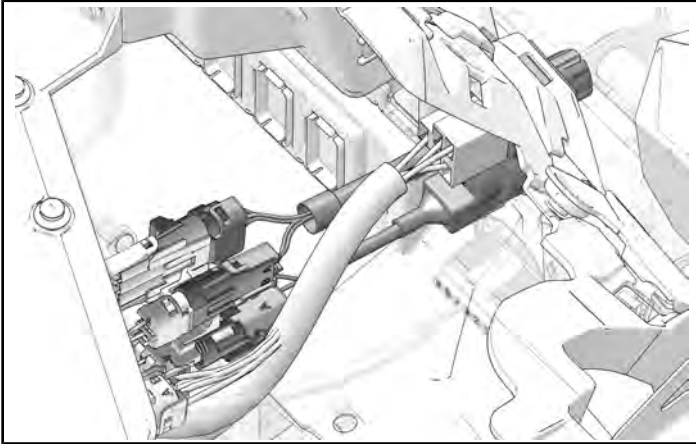

2. Turn each knob 1/4 to securely engage with back panel.

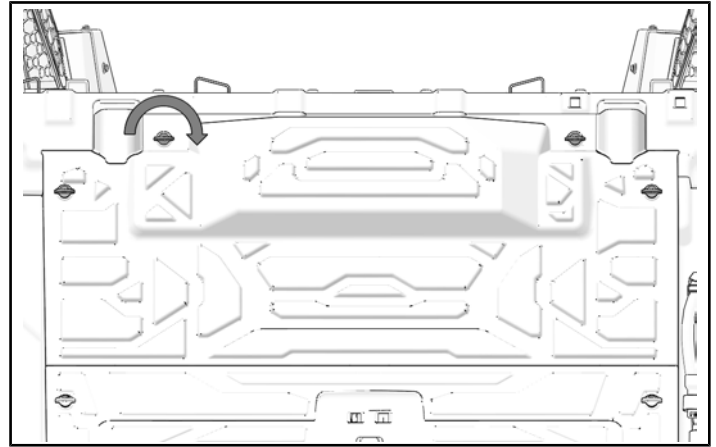

## REAR CENTER CONSOLE ASSEMBLY

### IMPORTANT

Note size difference of fasteners installed in steps 2 and 3.

1. Refer to the *Service Manual* for procedures on refilling the coolant and bleeding the coolant system.
2. Turn vehicle on and operate heater system until the air output is warm/hot. Turn temperature control to cool the air output and let system run for a few minutes. Turn temperature control to warm the air output until cooling fan cycles.
3. Verify coolant level.

## CLOSE-OFF PANEL INSTALLATION

1. Turn each knob 1/4 to securely engage with back panel.

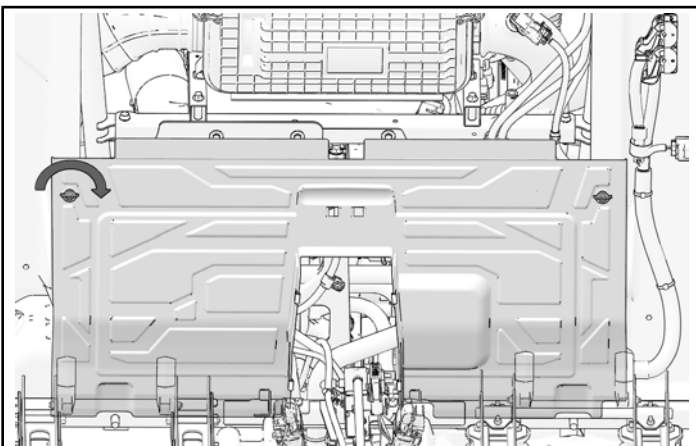

1. Align rear center console with front center console.
2. Install front portion with four retained push-pin rivets.

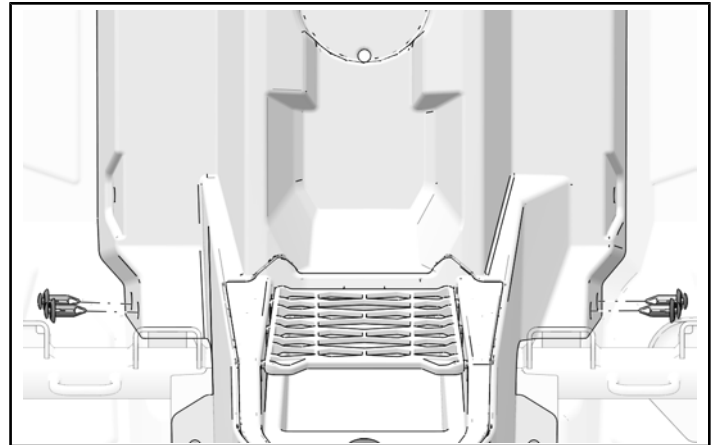

3. Install sides with four center console side fasteners (shorter).

#### **TORQUE**

Center Console Fasteners (Shorter):  
**89 in-lbs (10 N·m)**

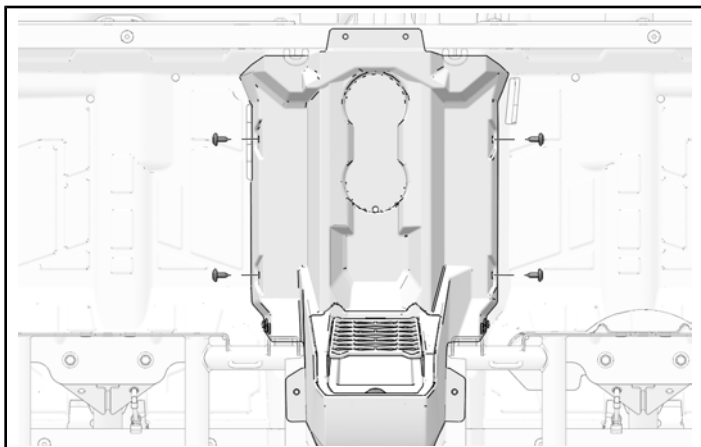

4. Install to front-center console with two center console top fasteners (longer).

#### **TORQUE**

Center Console Fasteners (Longer):  
**89 in-lbs (10 N·m)**

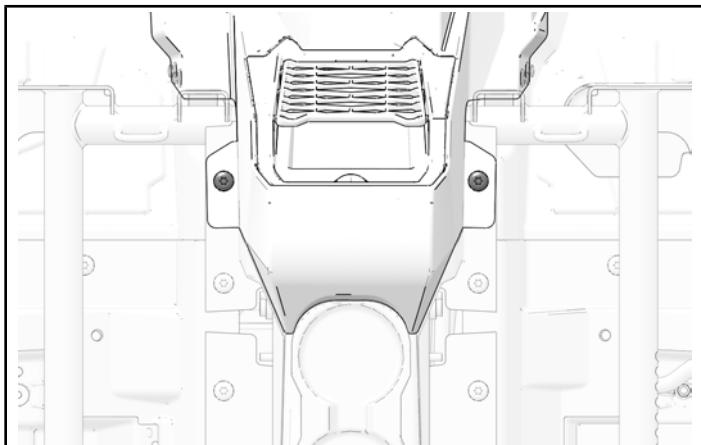

## **FRONT CENTER CONSOLE REASSEMBLY**

### **HEATER FITMENT**

1. Carefully lift center panel upwards and position side panels for installation.

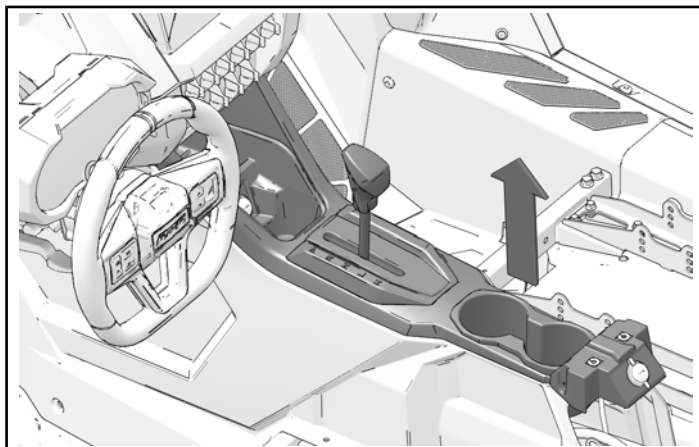

2. Install heater bracket to console panel with one push-pin rivet 16 per side.

#### **TIP**

Reach through opening in right-hand panel and align heater bracket with holes drilled in panels.

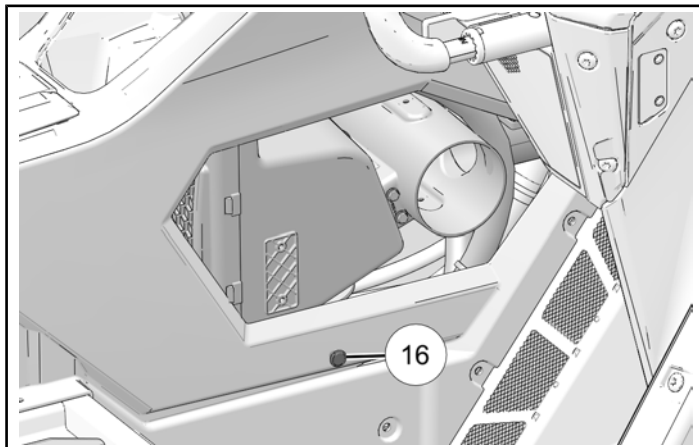

### **RIGHT-HAND PANEL INSTALLATION**

1. Install two push-pin rivets .

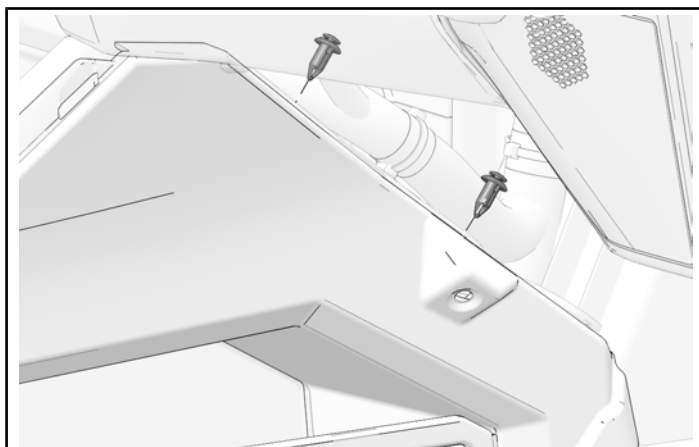

2. Install passenger side panel with eight retained center console fasteners and one push-pin rivet.

#### TORQUE

Center Console Fasteners:  
**89 in-lbs (10 N·m)**



#### LEFT-HAND PANEL INSTALLATION

1. Install push-pin rivet.

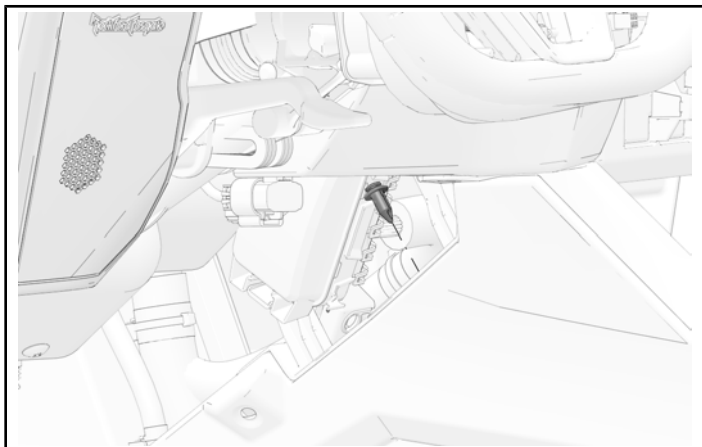

2. Install retained push-pin rivet and fuse block fastener. Torque two fuse block fasteners to specification.

#### TORQUE

Fuse Block Fasteners:  
**31 in-lbs (3.5 N·m)**

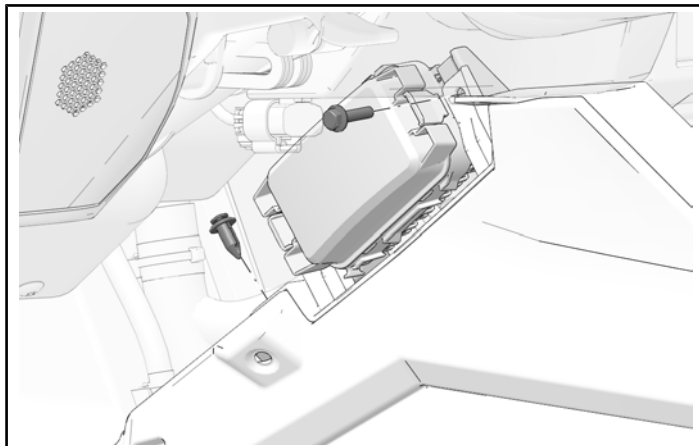

3. Install driver side panel with eight retained center console fasteners and one push-pin rivet.

#### TORQUE

Center Console Fasteners:  
**89 in-lbs (10 N·m)**

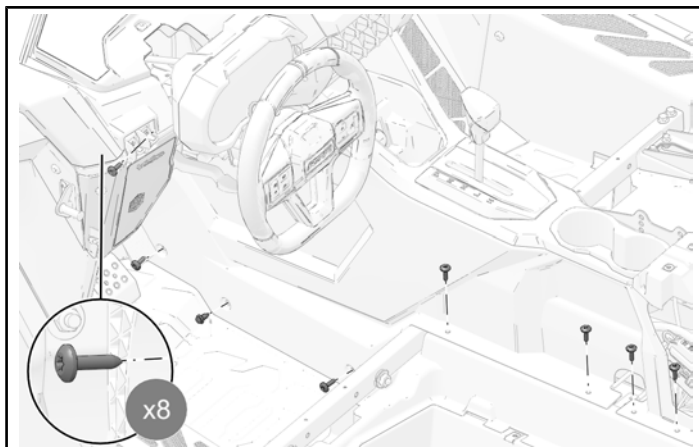

#### STORAGE COMPARTMENT INSTALLATION

Storage Compartment Installation applies to two-passenger vehicles only.

1. Position console storage compartment for installation.



2. Install console storage compartment with two retained center console fasteners from passenger side.

#### TORQUE

Center Console Fasteners:  
**89 in-lbs (10 N·m)**

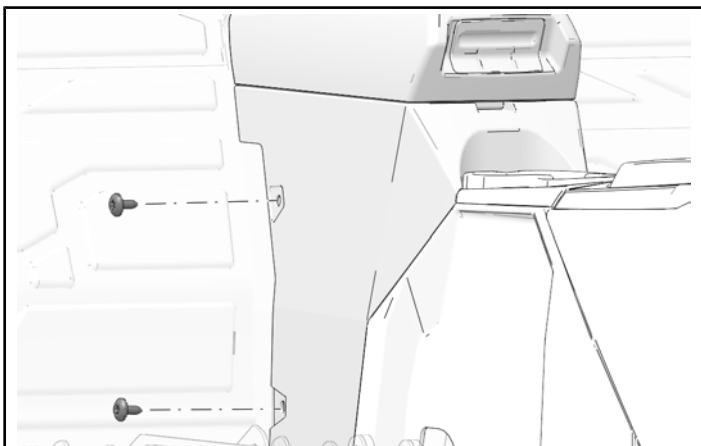

3. Install console storage compartment with two retained center console fasteners from driver side.

#### TORQUE

Center Console Fasteners:  
**89 in-lbs (10 N·m)**

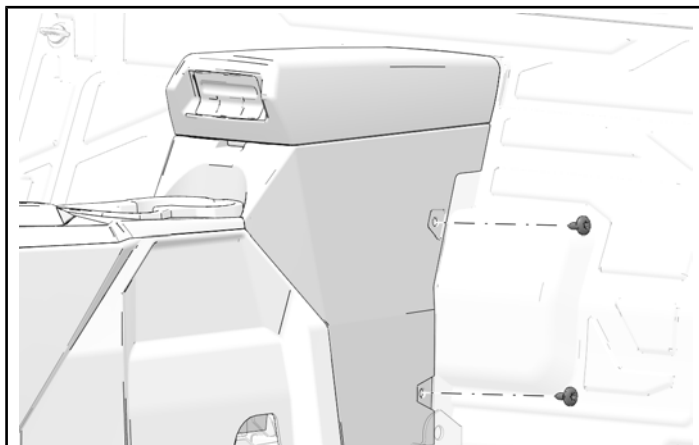

4. Open center console.

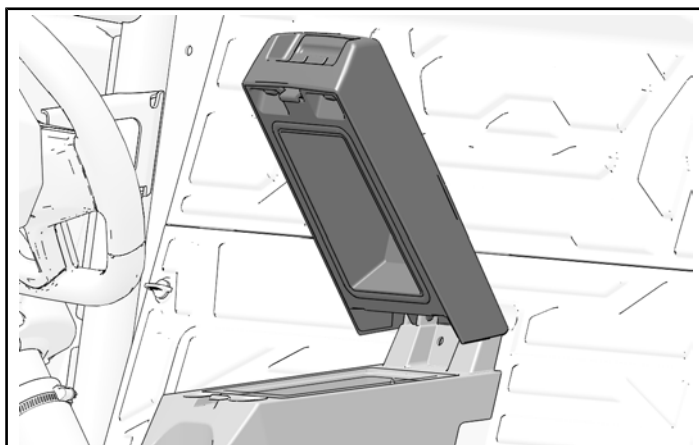

5. Connect 12 volt outlet from within center console cavity.

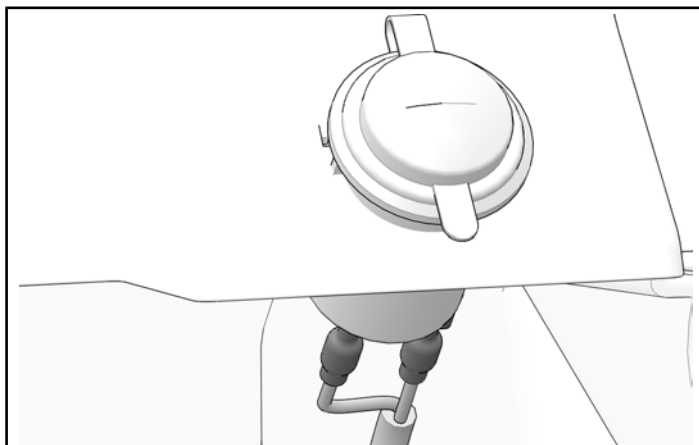



6. Install storage compartment.

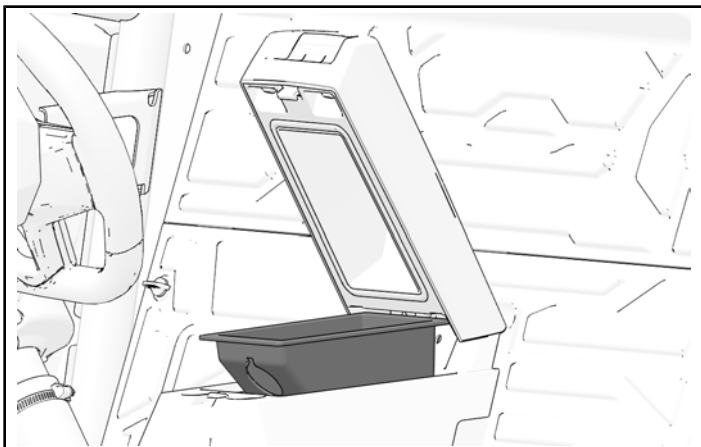

7. Turn each knob 1/4 to engage with center console panel.

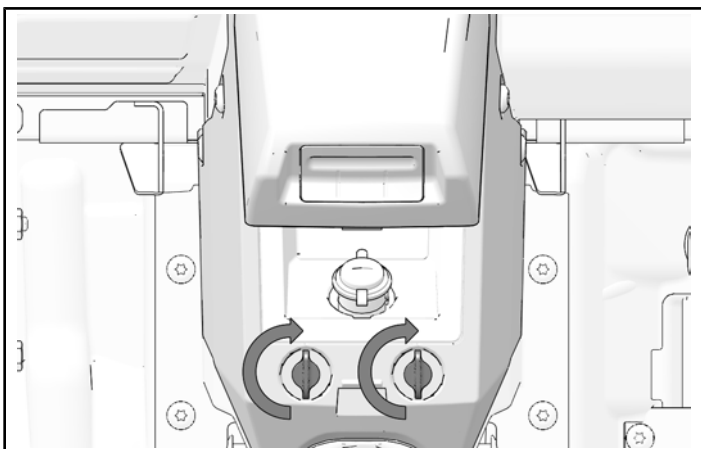

## FLOOR VENT INSTALLATION

1. Install cover plate ⑭ with six push-pin rivets ⑯.

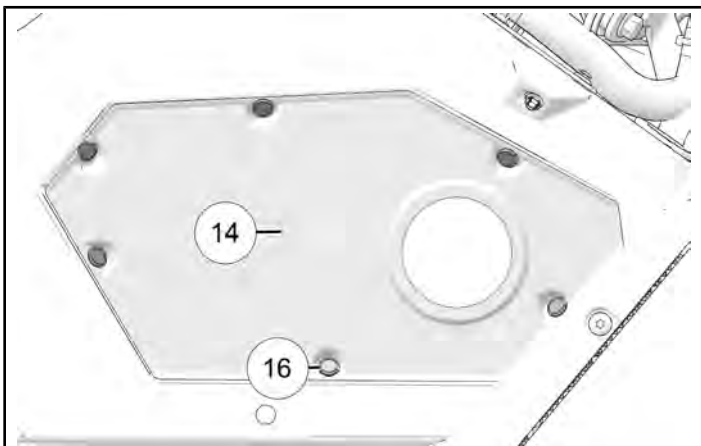

2. Align floor vents with output tube on heater assembly and install passenger and driver floor vents ⑰.

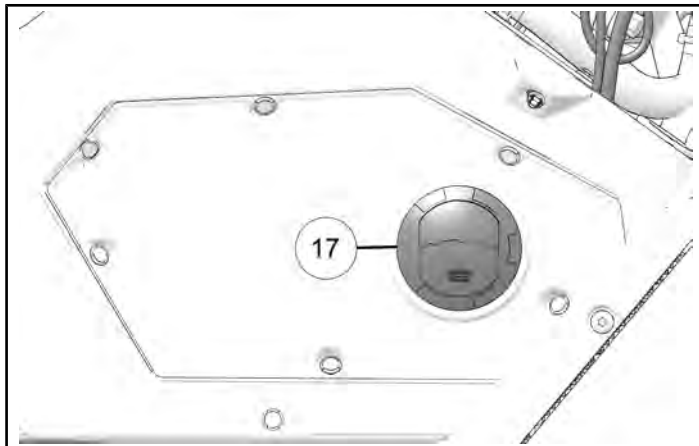

## SEAT INTALLATION

### REAR SEAT PANEL INSTALLATION

1. Position rear seat panel in vehicle and install with eleven seat panel fasteners.

#### TORQUE

Seat Panel Fasteners:  
**89 in-lbs (10 N·m)**



2. Reinstall one push-pin rivet in right-rear of seat panel.

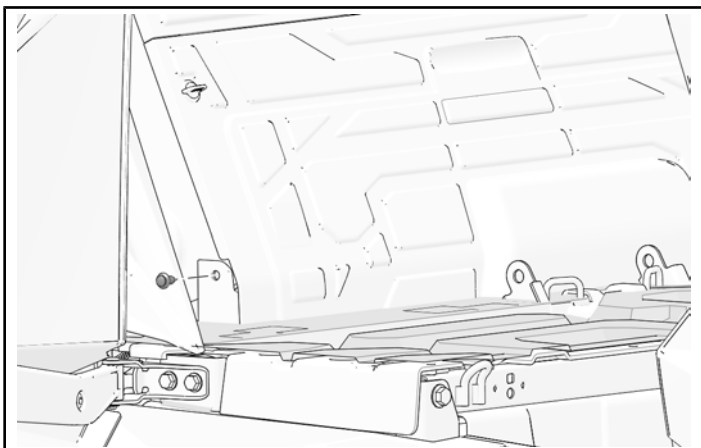

## REAR SEAT INSTALLATION

### NOTICE

Left rear seat shown; right rear similar.

1. Install seat base with four seat bracket fasteners.

### TORQUE

Seat Bracket Fasteners:  
**71 in-lbs (8 N·m)**

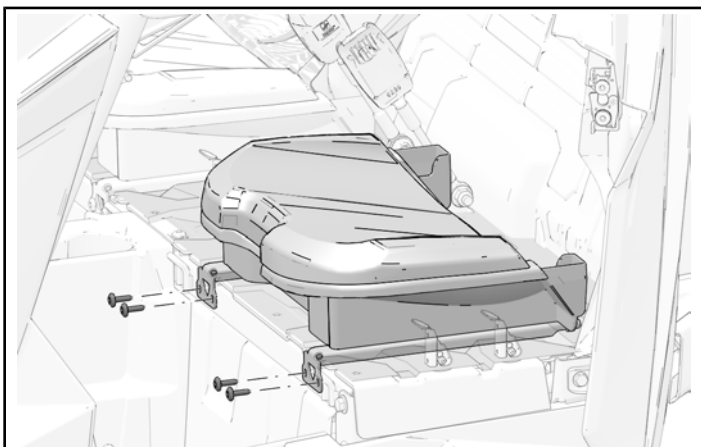

2. Position backrest assembly into seat base and lean back until headrest engages with receiver tube.

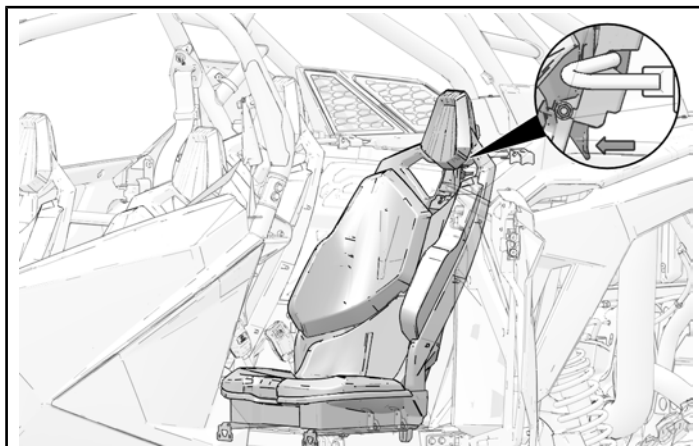

## FRONT SEAT INSTALLATION

1. Tilt seat towards steering wheel and hook seat base onto front receiver tubes.

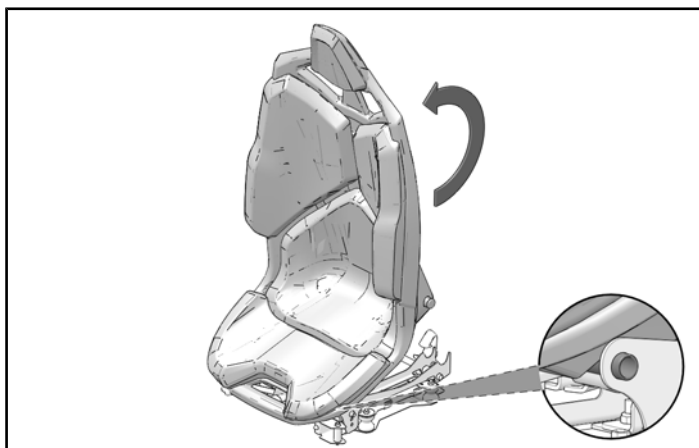

2. Lower seat onto rear receiver tubes.

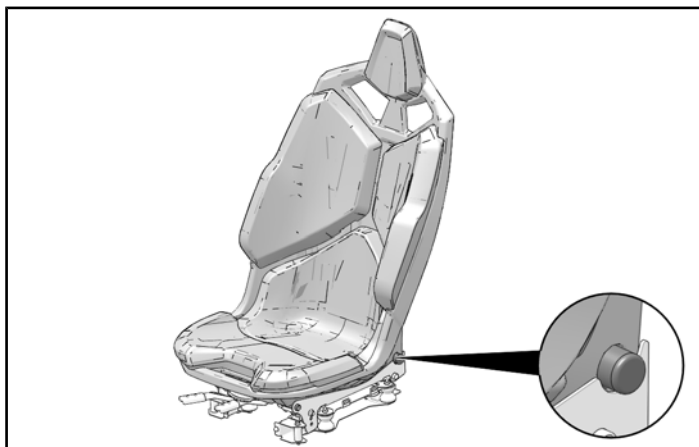

## DASHBOARD TOP INSTALLATION

1. Carefully lift panels up-and-away from tabs and install dashboard top into place by tilting rear section up and installing front section first, then lower rear section into place.

### TIP

Two people are recommended to complete this step.

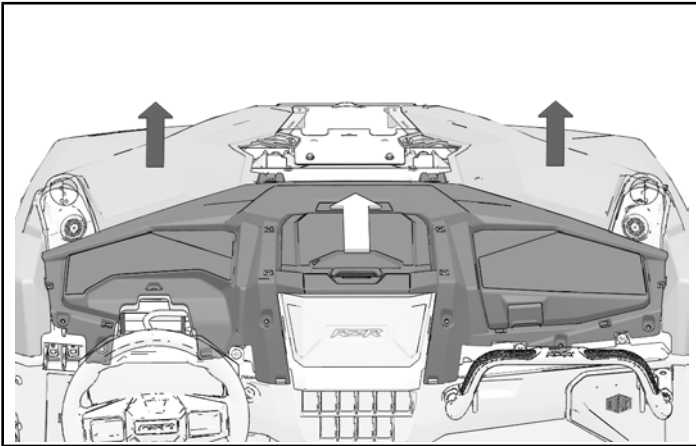

2. Make sure tabs on panels are aligned in slots on dashboard top. (Passenger-side panel shown; driver-side panel similar.)

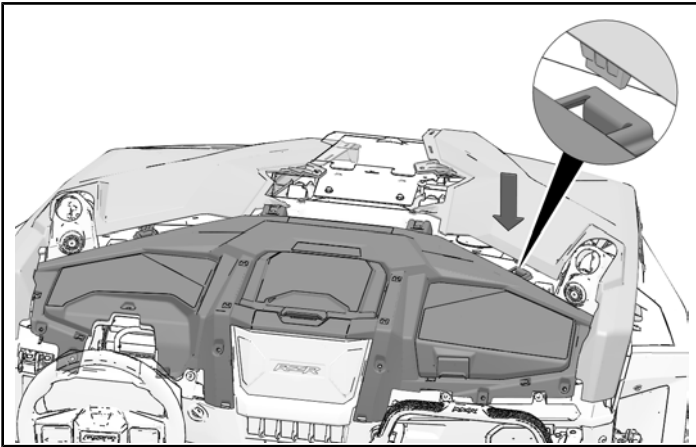

3. Make sure both rubber boots are properly seated around hood panels. Only upper lip should be visible, as shown with inset.

### TIP

Push up on inside of fender to ease installation.

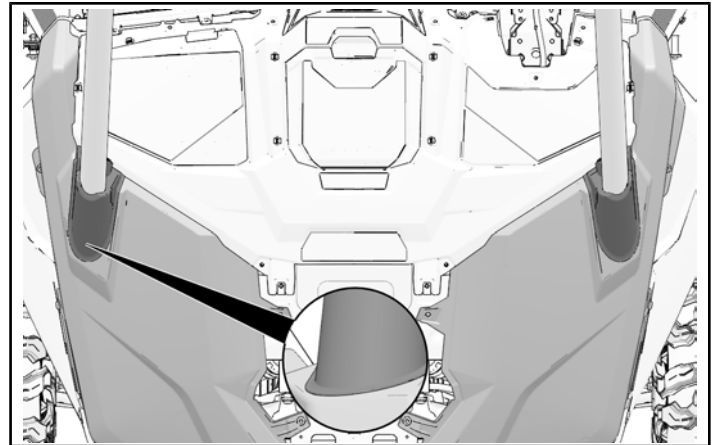

4. Reinstall two retained front dashboard fasteners into front edge of top dashboard.

### TORQUE

Front Dashboard Fasteners:  
**88 in-lbs (10 N·m)**

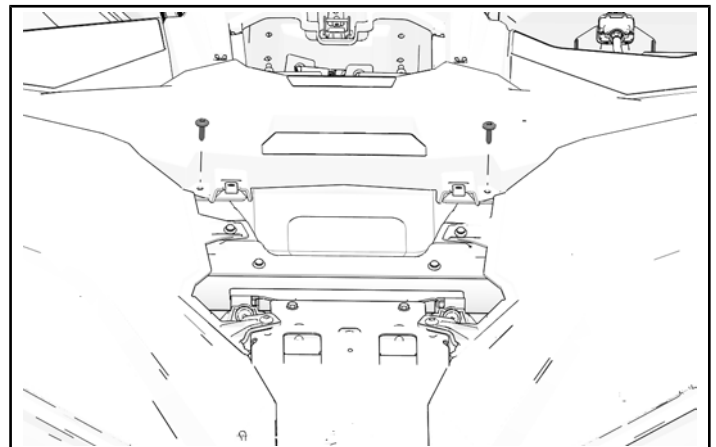

5. Install hood panels to vehicle with two retained push-pin rivets

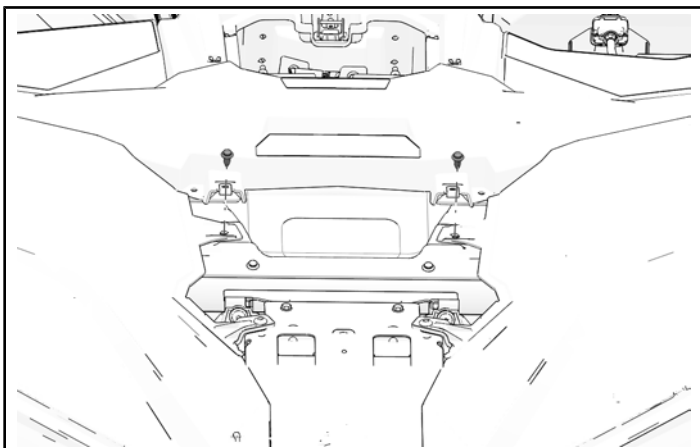

6. Tilt steering wheel down. Install four retained screws through dashboard top and torque to specification.

#### TORQUE

Dashboard Fasteners:  
**88 in-lbs (10 N·m)**

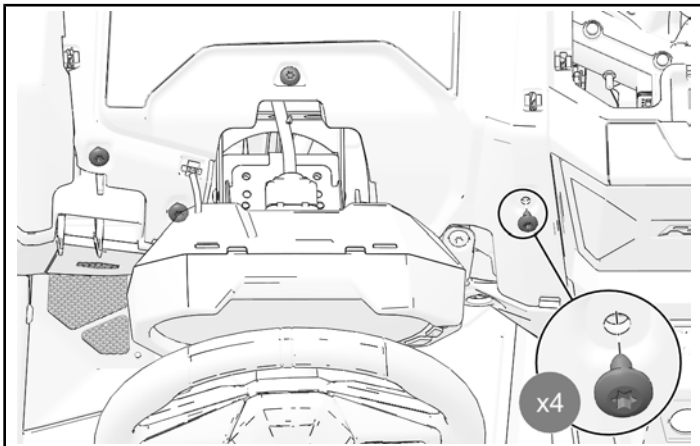

7. Open glove box lid and reinstall storage compartment. Install four retained dashboard fasteners around glove box opening.

#### TORQUE

Dashboard Fasteners:  
**88 in-lbs (10 N·m)**

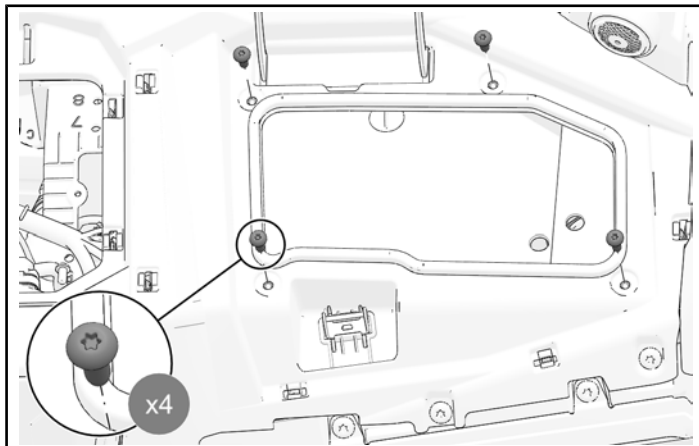

8. Install front of dashboard with three retained dashboard fasteners.

#### TORQUE

Dashboard Fasteners:  
**88 in-lbs (10 N·m)**

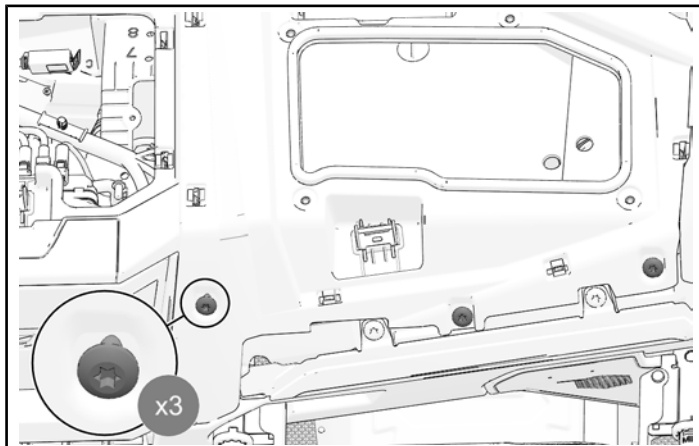

9. Install retained left, center, and right dashboard trim pieces.

#### TIP

Release steering tilt lock for improved access.

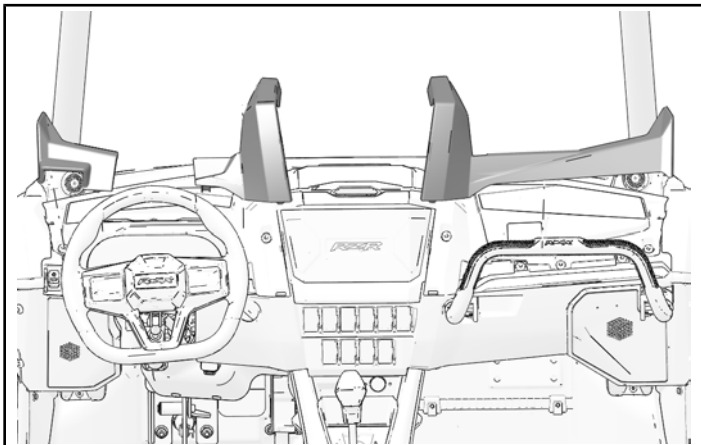

### DASHBOARD STORAGE INSTALLATION

1. Slide storage compartment into dashboard cavity.

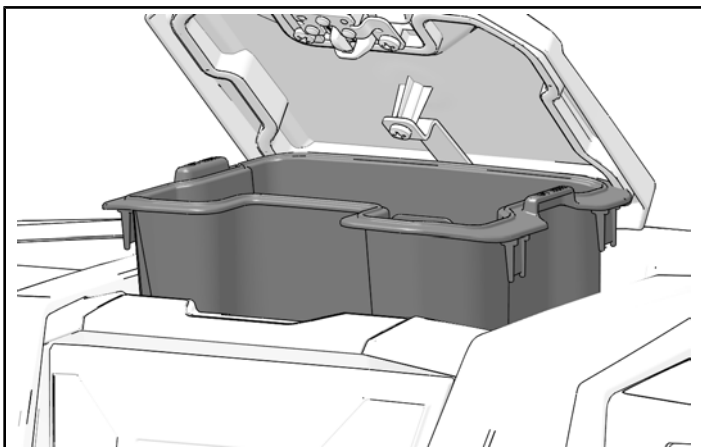

### FEEDBACK FORM

A feedback form has been created for the installer to provide any comments, questions or concerns about the installation instructions. The form is viewable on mobile devices by scanning the QR code or by clicking [HERE](#) if viewing on a PC.



### CENTER HOOD PANEL INSTALLATION

1. Move panel forward until tabs slide into front hood panel and install with two hood fasteners.

#### TORQUE

Hood Fasteners:  
**88 in-lbs (10 N·m)**

