

# TIP OUT WINDSHIELD KIT

**POLARIS**

ENGINEERED PARTS  
ACCESSORIES & APPAREL

P/N 2884662

## BEFORE YOU BEGIN

Read these instructions and check to be sure all parts and tools are accounted for. Please retain these installation instructions for future reference and parts ordering information.

## APPLICATION

Verify accessory fitment at [www.polaris.com](http://www.polaris.com).

## ACCESSORY WEIGHT

Accessories, passengers, and other factors may negatively affect ride performance. Refer to your vehicle's owner's manual for maximum weight capacity and suspension adjustment procedures.

## KIT CONTENTS

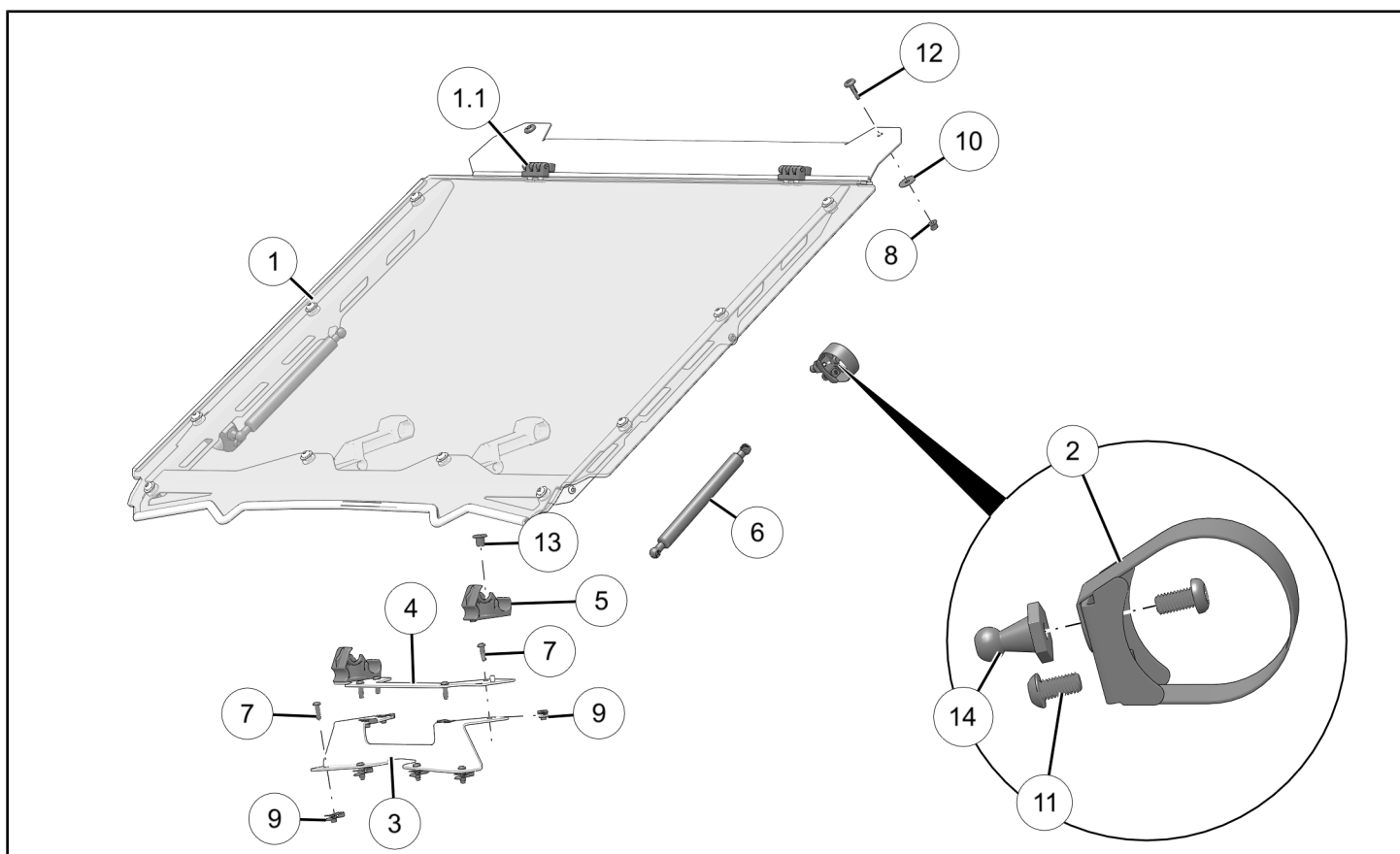

REF	QTY	PART DESCRIPTION	P/N AVAILABLE SEPARATELY	AVAILABLE SERVICE KIT
1	1	Assembly-Windshield, Tip Out	n/a	n/a
1.1	2	- Hinge-Nylon	n/a	2208944
2	2	Weld-Clamp	n/a	2208577
3	1	Bracket-Dashboard	n/a	2208577
4	1	Plate-Dashboard	n/a	2208577
5	2	Latch-Lower Snap	n/a	2208577

REF	QTY	PART DESCRIPTION	P/N AVAILABLE SEPARATELY	AVAILABLE SERVICE KIT
6	2	Strut–Gas	n/a	2208577
7	8	Screw–Torx® Pan Head, M6 x 1.0 x 20 mm	n/a	2208577
8	2	Nut–Hex Flange, M6	n/a	2208577
9	8	U-Nut, M6 x 1.0 mm	n/a	2208577
10	2	Washer–Mounting	n/a	2208577
11	7	Screw–Torx® Pan Head, M6 x 1.0 x 12 mm	n/a	2208577
12	2	Screw–Torx® Pan Head, M6 x 1.0 x 25 mm	n/a	2208577
13	2	Bolt–Keeper	n/a	2208577
14	4	Strut–Ball-End	n/a	n/a

## TOOLS REQUIRED

- Safety Glasses
- Drill
- Drill Bit:
  - **5/16 in (8 mm)**
- Pin Punch Set
- Pliers, Push Pin Rivet
- Screwdriver Set, Torx®
- Socket Set, Metric
- Socket Set, Torx® Bit
- Torque Wrench
- Wrench Set, Metric

## IMPORTANT

Your Tip Out Windshield Kit is exclusively designed for your vehicle. Please read the installation instructions thoroughly before beginning. Installation is easier if the vehicle is clean and free of debris. For your safety, and to ensure a satisfactory installation, perform all installation steps correctly in the sequence shown.

## INSTALLATION INSTRUCTIONS

### WARNING

If transporting vehicle in non-enclosed trailer then vehicle must **FACE FORWARD**, or windshield must be removed.

Failure to comply may allow airflow, vibration, or other factors to separate windshield from vehicle and cause an accident, resulting in serious personal injury or death.

### WARNING

Do not drive vehicle with windshield tipped up at speeds exceeding 55 mph (89 km). Driving at excessive speeds may cause airflow to lift windshield and cause a loss of vehicle control resulting in accident or death.

## VEHICLE PREPARATION

### GENERAL

1. Shift vehicle transmission into PARK.
2. Turn key to OFF position and remove from vehicle.

### DASHBOARD STORAGE REMOVAL

1. Open center dashboard storage compartment.

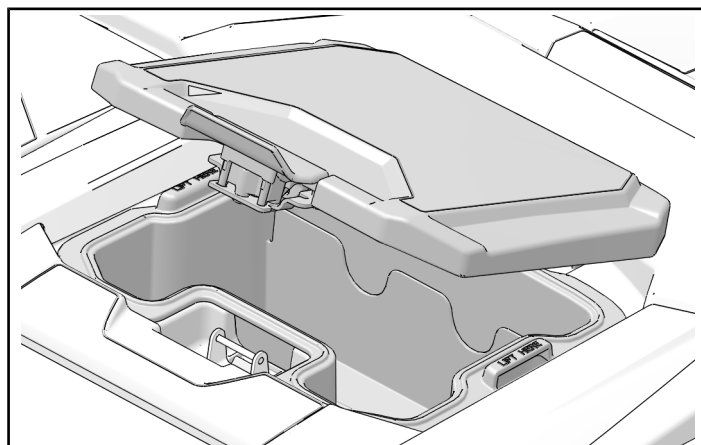

2. Remove storage compartment from dashboard.

#### TIP

If removing storage compartment is difficult, carefully use tool to pry storage compartment upwards where marked "LIFT HERE."

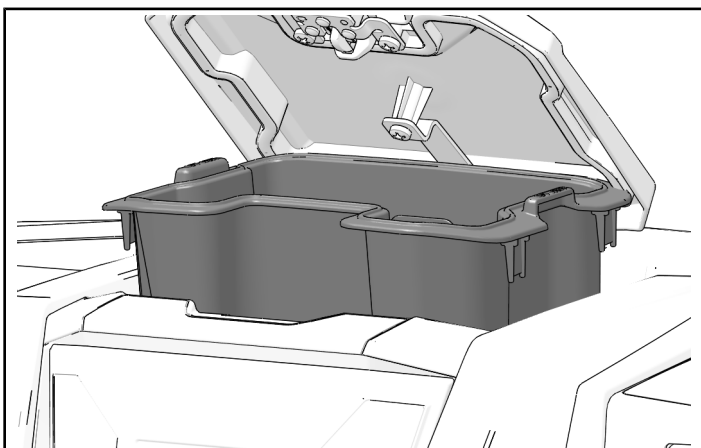

### CENTER HOOD PANEL REMOVAL

1. Remove and keep two hood fasteners. Move hood towards rear of vehicle to remove.

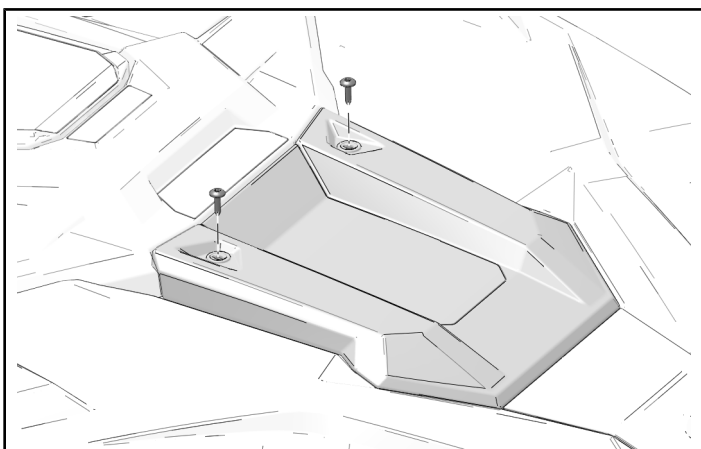

### DASHBOARD TOP REMOVAL

1. Carefully pull up to remove left, center, and right dashboard trim pieces.

#### TIP

Release steering tilt lock for improved access.

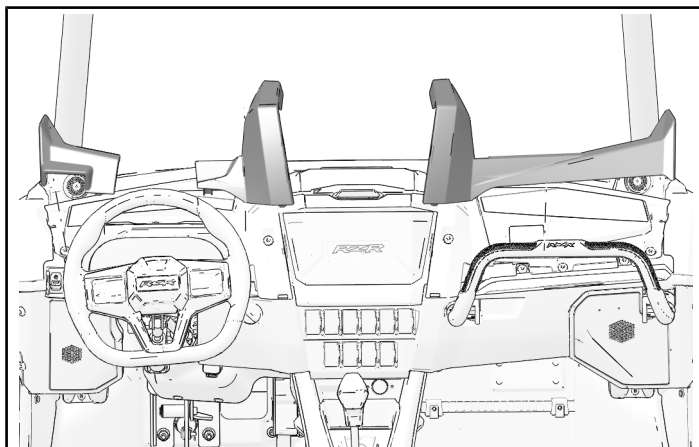

2. Open glove box lid. Remove and retain four dashboard fasteners around glove box opening.

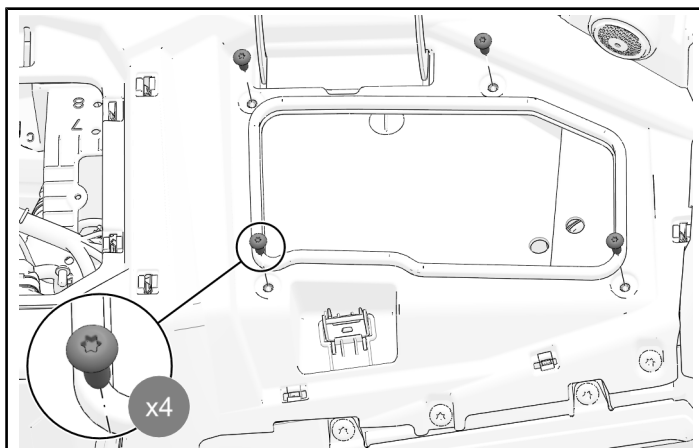

3. Remove and retain three front dashboard fasteners around glove box opening.

**TIP**

Make note of different screw sizes in steps 2 and 3.

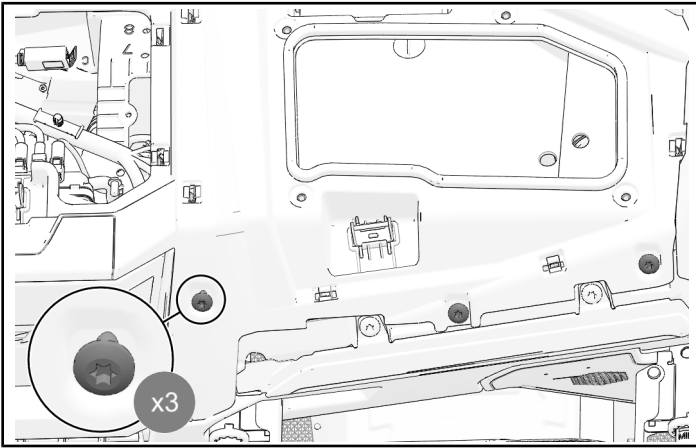

4. Tilt steering wheel down. Remove and retain four dashboard fasteners from dashboard surrounding steering wheel.

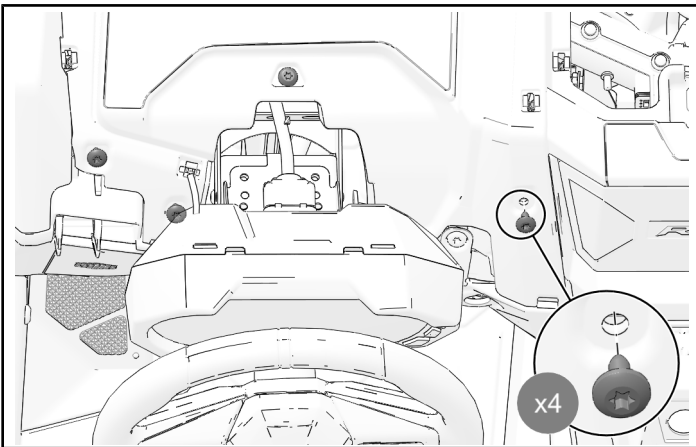

5. Remove and retain two dashboard fasteners from front of vehicle.

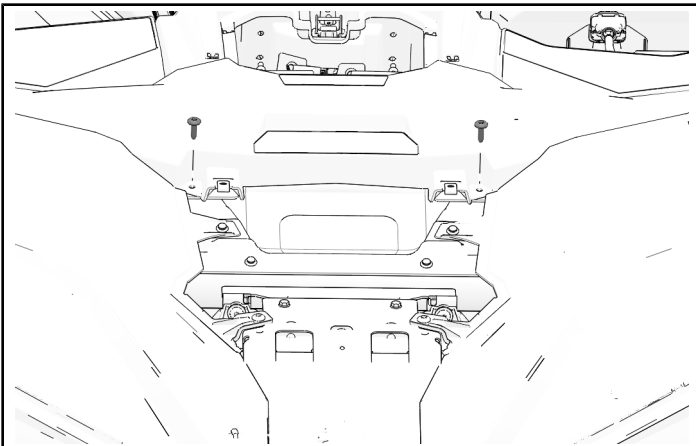

6. Remove and retain two push-pin rivets from front side hood panels.

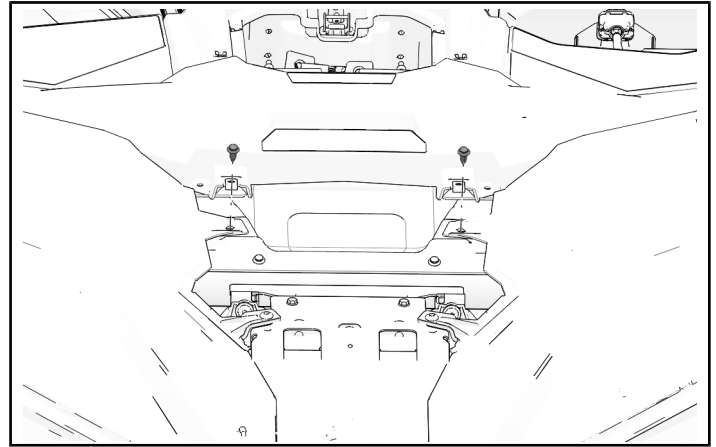

7. Carefully lift edge of left front hood panel to release tab from dashboard top as shown.

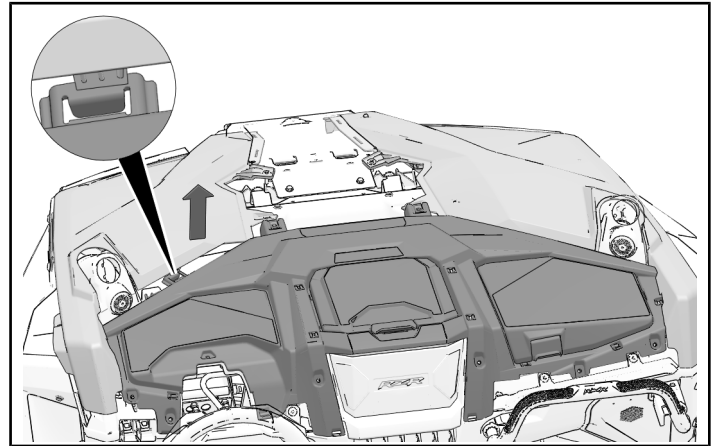

8. Carefully lift edge of right front hood panel to release tab from dashboard top as shown.

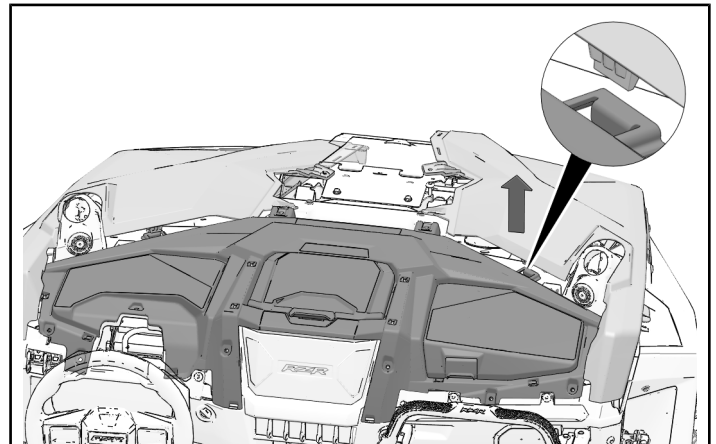

- Carefully keep panels up-and-away from tabs and remove dashboard top by tilting rear section up and pulling out toward rear.

#### TIP

Two people are recommended to complete this step.

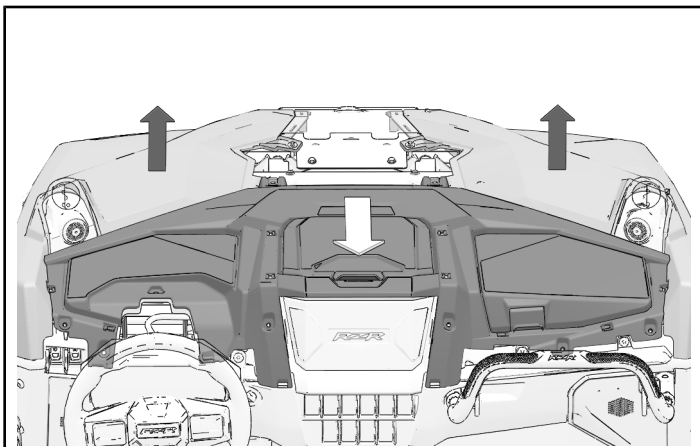

## ACCESSORY INSTALLATION

### DASHBOARD BRACKET INSTALLATION

- Install four U-nuts ⑨ onto edge of firewall.

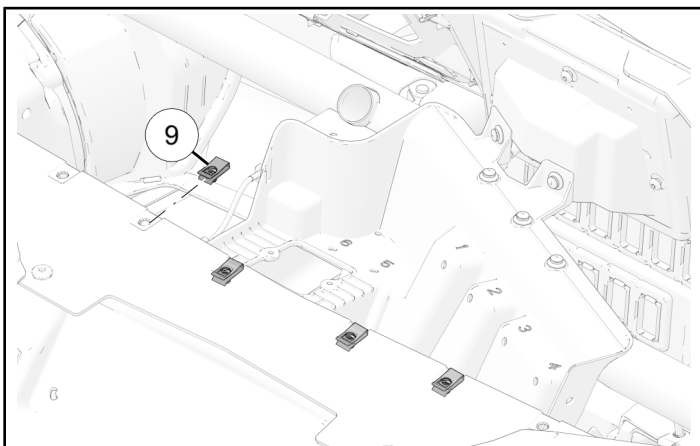

- Align dashboard bracket ③ with U-nuts and install with four fasteners ⑦.

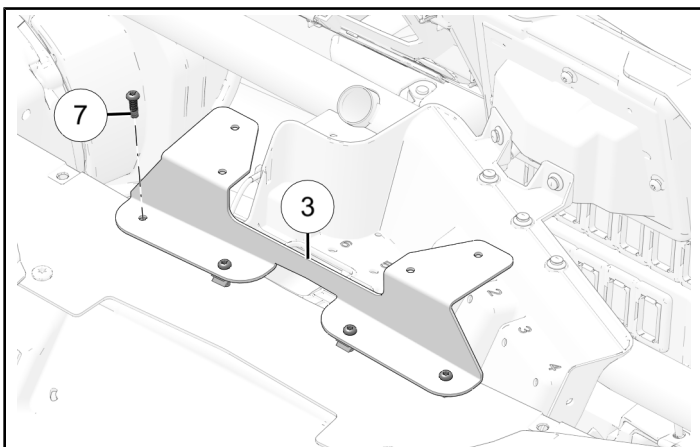

- Install four U-nuts ⑨ onto dashboard bracket.

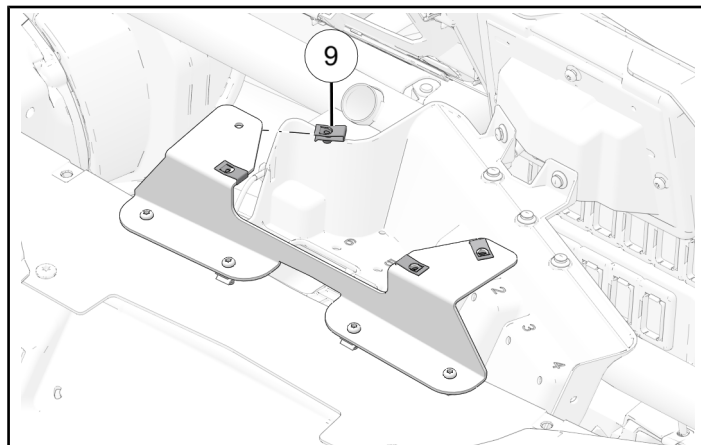

- Torque four dashboard bracket fasteners ⑦ to specification.

#### TORQUE

Dashboard Bracket Fasteners ⑦:  
**88 in-lbs (10 N·m)**

### DASHBOARD PLATE INSTALLATION

- Detach template page located at the end of this instruction.
- Locate REFERENCE DIMENSION on each template page.

Verify REFERENCE DIMENSION is exact and template(s) were printed to proper scale.

#### NOTE

If REFERENCE DIMENSION is not exact, reprint template page from electronic file. Adjust print setting to **“Actual Size”** to obtain 1:1 scale. Electronic file available from your **Authorized Dealer**.

- Cut out each template and align to underside of dashboard panel, as shown. Mark four drill points.

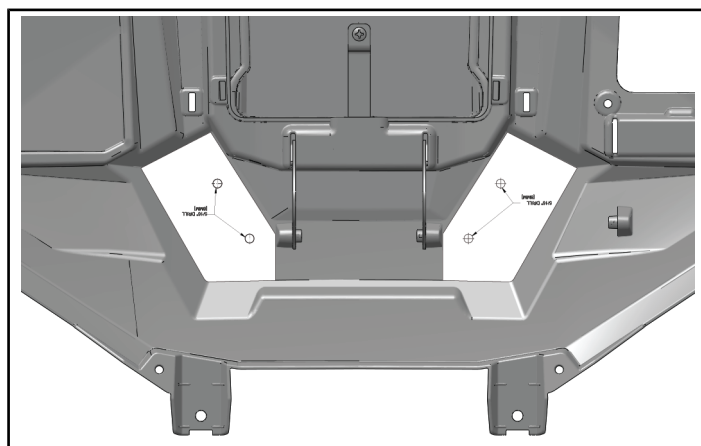



4. Drill four **5/16 in (8 mm)** holes at marked locations.

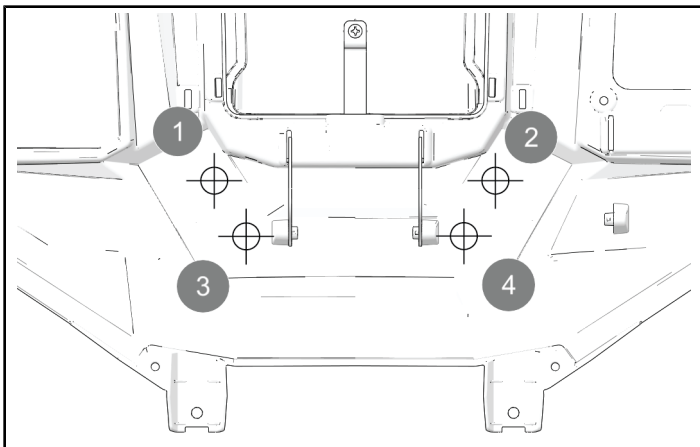

5. Put dashboard in installed-position.  
6. Install four fasteners ⑦ through dashboard plate ④, dashboard, and into U-nuts on dashboard bracket.

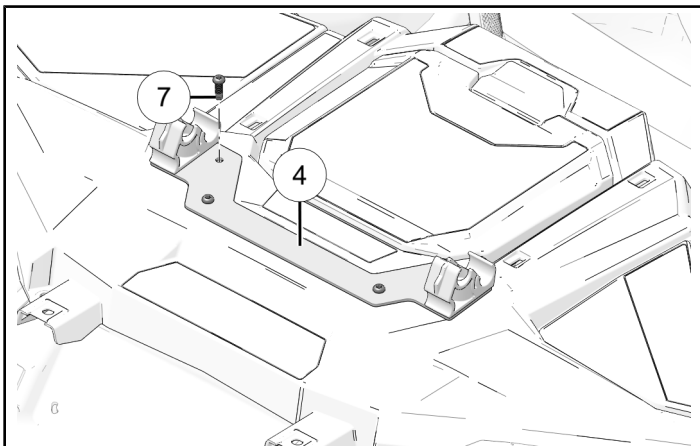

7. Torque four fasteners ⑦ to specification.

#### TORQUE

Dashboard Plate Fasteners ⑦:  
**88 in-lbs (10 N·m)**

## DASHBOARD INSTALLATION

1. Reinstall two retained front dashboard fasteners into front edge of top dashboard.

#### TORQUE

Front Dashboard Fasteners:  
**88 in-lbs (10 N·m)**

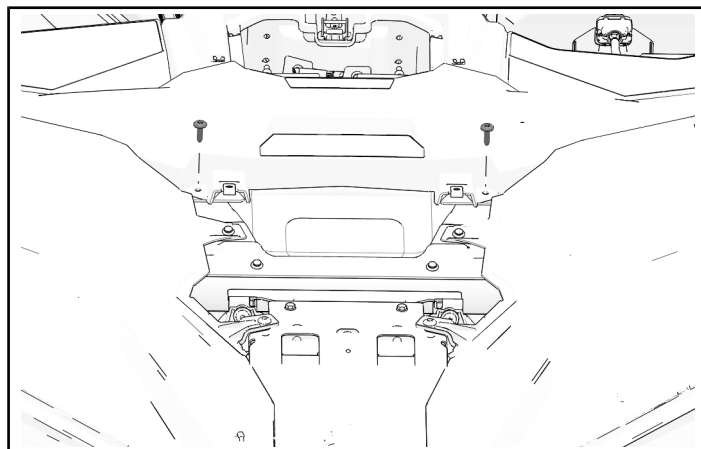

2. Install hood panels to with two retained push-pin rivets

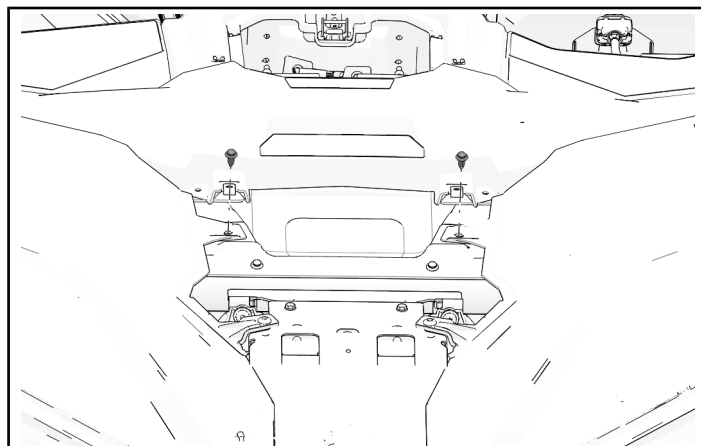

3. Tilt steering wheel down. Install four retained screws through dashboard top and torque to specification.

#### TORQUE

Dashboard Fasteners:  
**88 in-lbs (10 N·m)**

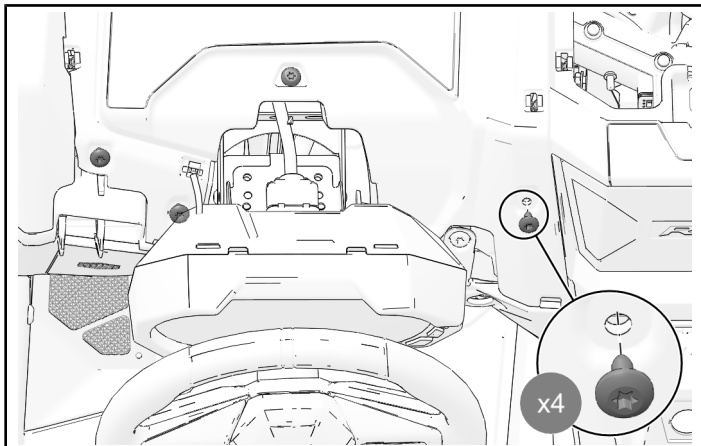

4. Open glove box lid and reinstall storage compartment. Install four retained dashboard fasteners around glove box opening.

#### TORQUE

Dashboard Fasteners:  
**88 in-lbs (10 N·m)**

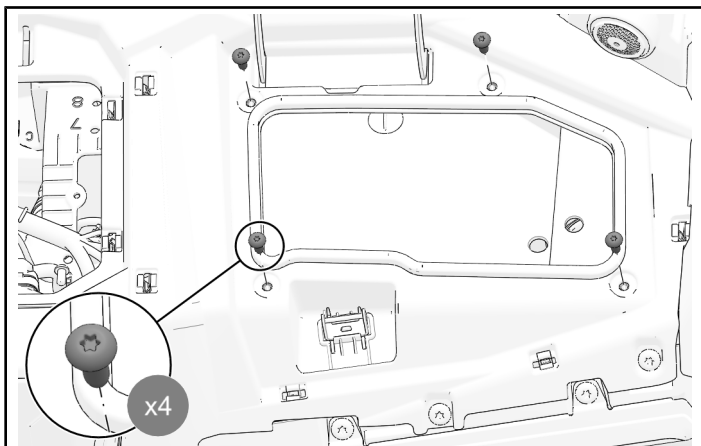

5. Install front of dashboard with three retained dashboard fasteners.

#### TORQUE

Dashboard Fasteners:  
**88 in-lbs (10 N·m)**

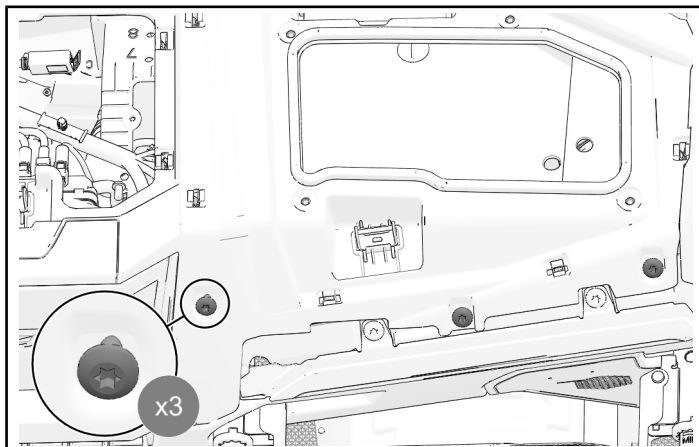

6. Install retained left, center, and right dashboard trim pieces.

#### TIP

Release steering tilt lock for improved access.

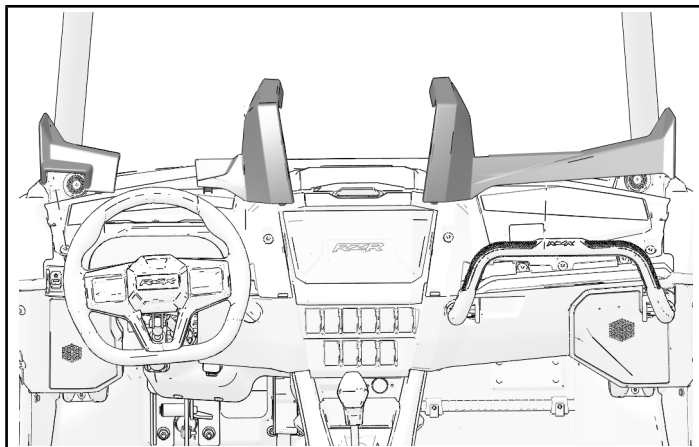

## WINDSHIELD INSTALLATION

1. Lean windshield against roll-cage. Install top of windshield with two fasteners ⑫, two washers ⑩, and two nuts ⑧.

Do not torque fasteners at this time.

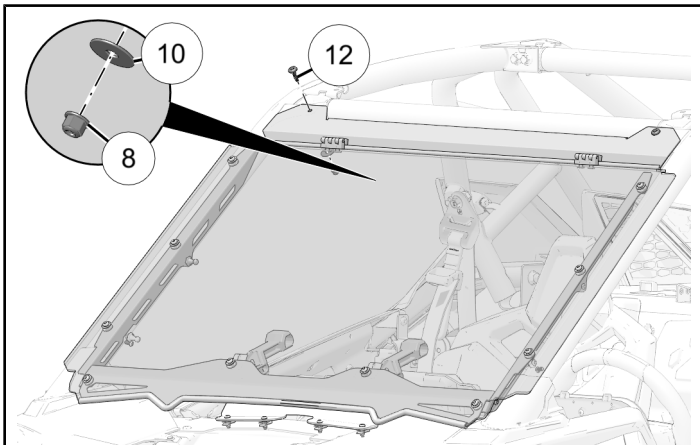

2. Install strut ⑥ to ball-end.

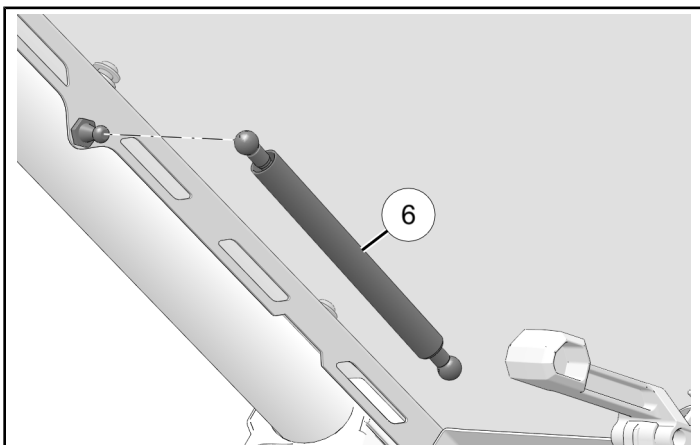

3. Assembly strut ball-end ⑭ onto clamp ② with one fastener ⑪. Counter-hold ball-end and torque fastener to specification.

### TORQUE

Clamp Fastener ⑪:  
88 in-lbs (10 N·m)

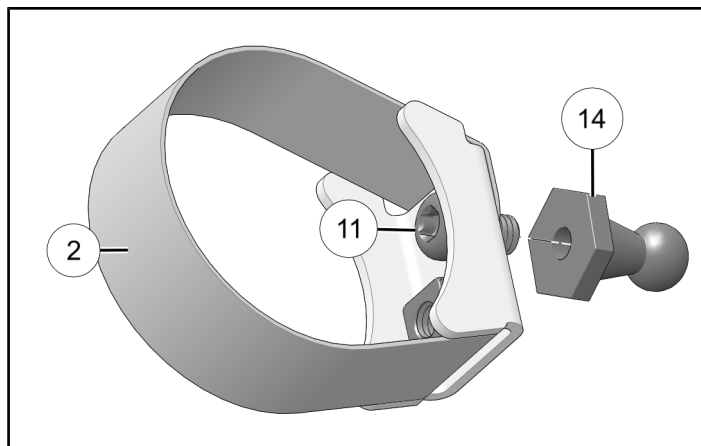

4. Wrap clamp ② around A-pillar and position within inset of windshield frame. Loosely tighten clamp with one clamp fastener ⑪.

Do not over torque fasteners. Adjustments may be needed.

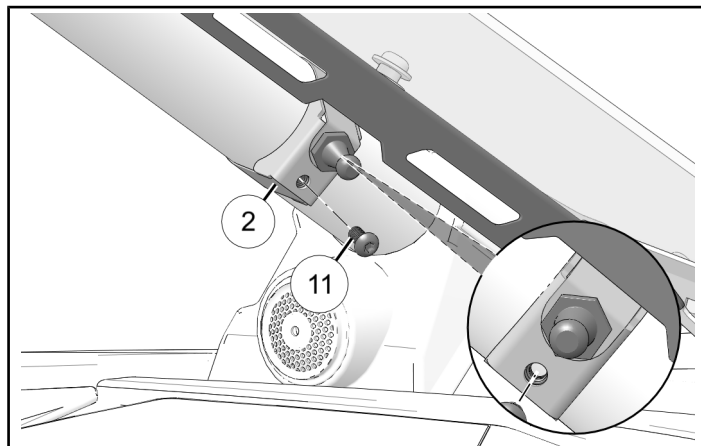



5. Lift windshield up and install strut ⑥ to ball-end of clamp assembly.

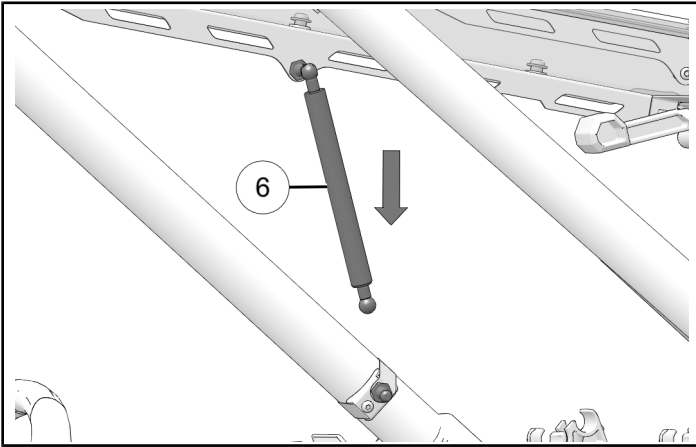

6. Lift windshield latches to open windshield and rest latches on front latch snap position.

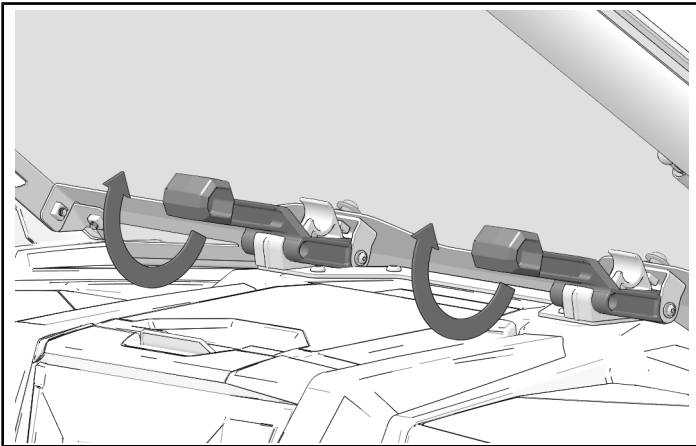

7. Adjust clamp positioning so that windshield operates properly:
- Windshield latches must rest evenly on dashboard plate assembly.
  - Clamps must be at equal height.
  - Windshield must open and close smoothly without interference from strut positioning.

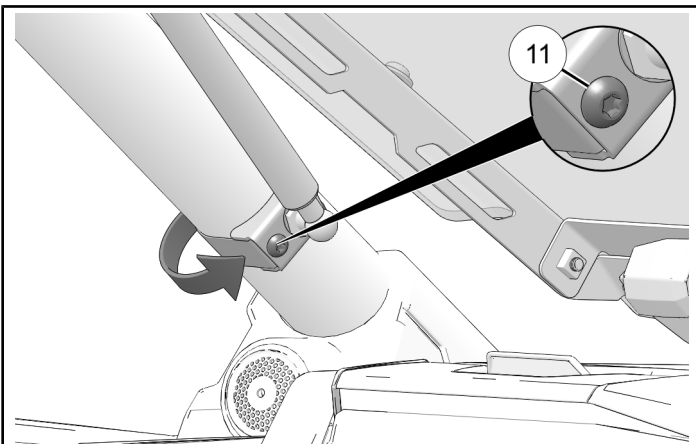

8. Tighten clamp fasteners ⑪ to specification.

#### TORQUE

Clamp Fasteners ⑪:  
**15 in-lbs (1 N·m)**

9. Counter-hold nuts ⑧ and torque two windshield fasteners ⑫ to specification.

#### TORQUE

Top Windshield Fasteners ⑫:  
**88 in-lbs (10 N·m)**

## VEHICLE REASSEMBLY

### CENTER HOOD PANEL INSTALLATION

1. Move panel forward until tabs slide into front hood panel and install with two hood fasteners.

#### TORQUE

Hood Fasteners:  
**88 in-lbs (10 N·m)**

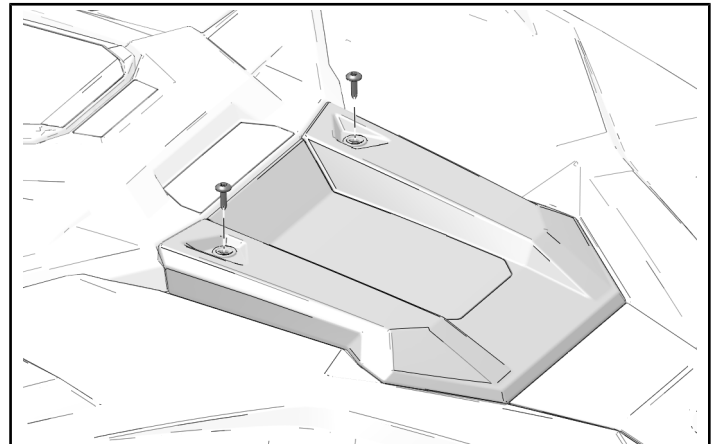

### DASHBOARD STORAGE INSTALLATION

1. Slide storage compartment into dashboard cavity.

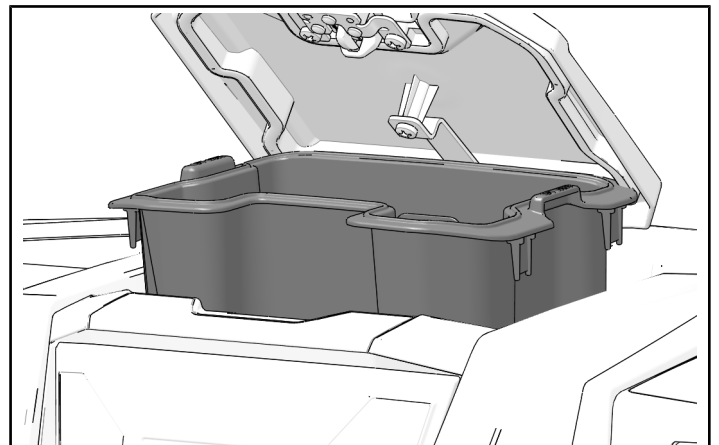

## OPERATION

### TIP OUT OPERATION

1. Lift up latches simultaneously.

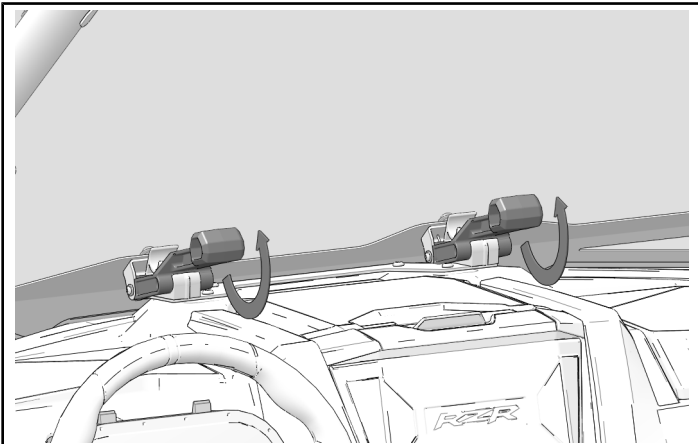

2. Rest latches on front latch snap position. Make sure latches snap into place.

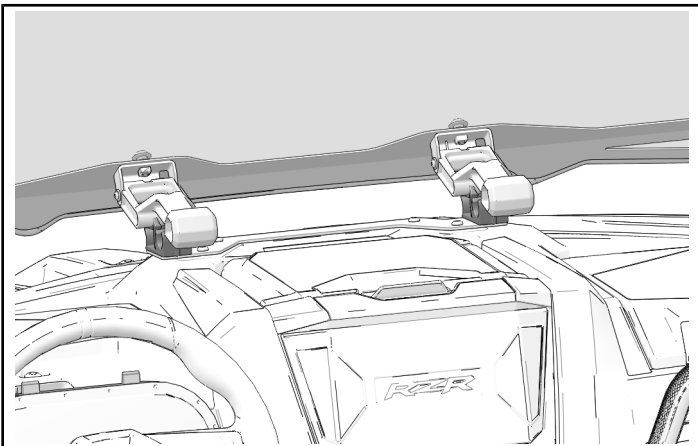

### LOCKING OPERATION

1. Make sure latches engage in front and top locations when closing windshield.

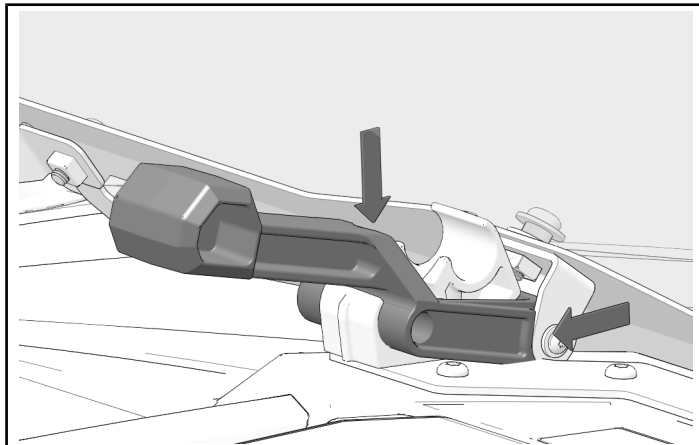

## INSTRUCTION FEEDBACK FORM

A feedback form has been created for the installer to provide any comments, questions or concerns about the installation instructions. The form is viewable on mobile devices by scanning the QR code or by clicking [HERE](#) if viewing on a PC.



