

PLOW MOUNT KIT



P/N 2884764

BEFORE YOU BEGIN

Read these instructions and check to be sure all parts and tools are accounted for. Please retain these installation instructions for future reference and parts ordering information.

APPLICATION

Verify accessory fitment at www.polaris.com.

KIT CONTENTS

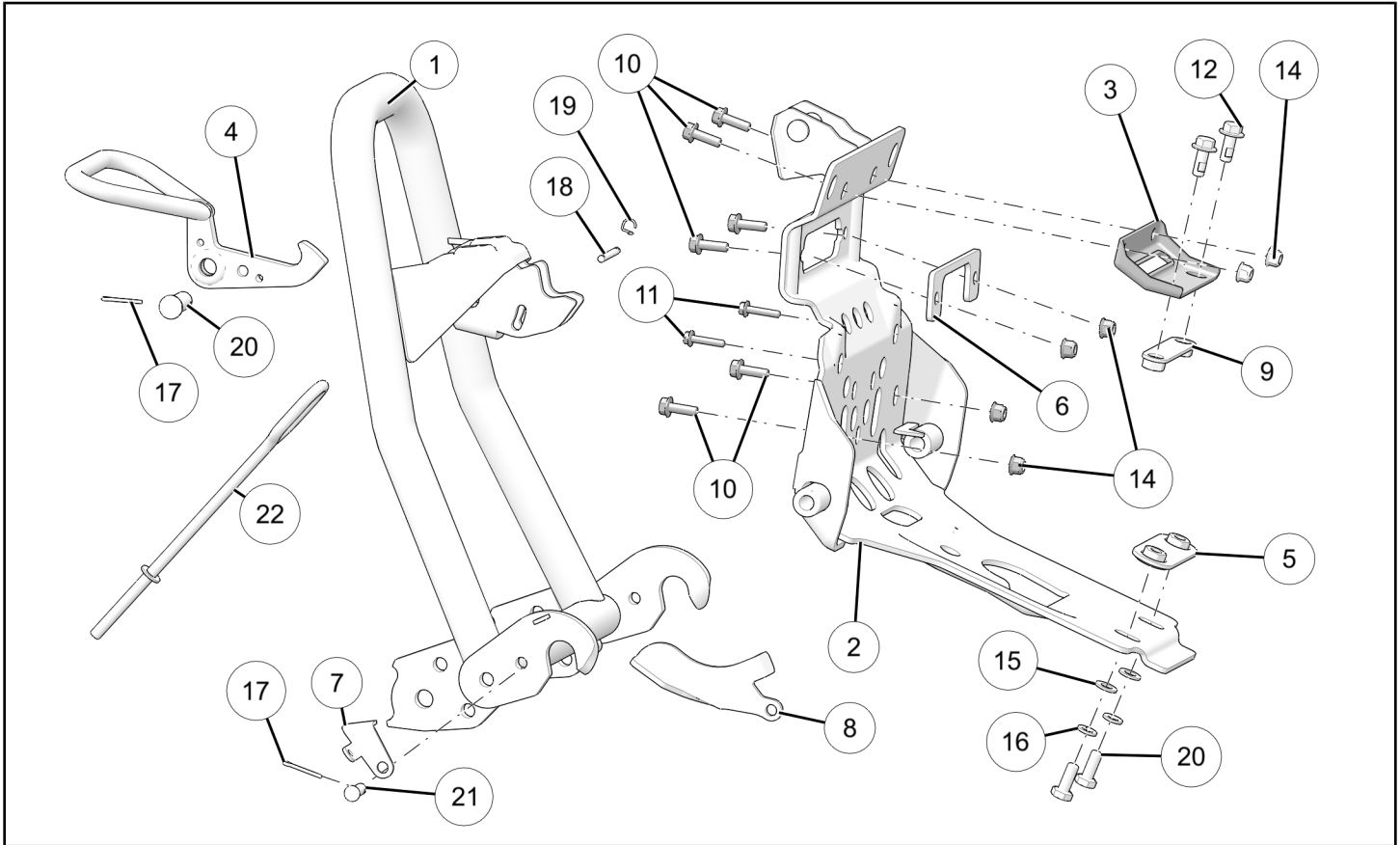

REF	QTY	PART DESCRIPTION	P/N AVAILABLE SEPARATELY	AVAILABLE SERVICE KIT
1	1	Mount Plate	1026122	n/a
2	1	Mid Mount	1026123	n/a
3	1	Bracket-Bumper Support, Upper	5265124	n/a
4	1	Handle Lock	n/a	n/a
5	1	Tightening Plate	n/a	n/a
6	1	Fairlead Adapter Plate	n/a	n/a
7	1	Lower Side Support Bracket	n/a	n/a
8	1	Kickstand Lever	n/a	n/a

REF	QTY	PART DESCRIPTION	P/N AVAILABLE SEPARATELY	AVAILABLE SERVICE KIT
9	1	Weldment Plate	n/a	2208483
10	6	Screw–Hexflange, M8 x 1.25 x 25	n/a	2208483
11	2	Screw–Hexflange, M6 x 1.0 x 30	n/a	2208483
12	2	Screw–Hexflange, M10 x 1.25 x 25	n/a	2208483
13	2	Screw–Hex, M10 x 1.5 x 25	n/a	2208483
14	6	Nut–Flange, Nylon Locking, M8 x 1.25	n/a	2208483
15	2	Washer–10.5 x 20 x 2	n/a	2208483
16	2	Washer–10.2 x 18.1 x 2.2	n/a	2208483
17	2	Split Pin	n/a	2208483
18	1	Pin	n/a	2208483
19	1	Lock Pin	n/a	2208483
20	1	Clevis Pin 16mm x 40mm	n/a	2208483
21	1	Clevis Pin 9.87mm x 28mm	n/a	2208483
22	1	Winch Link–Mid Size	n/a	2205057
23	1	Nut–Nylon Locking, M10 x 1.5	n/a	2205057

TOOLS REQUIRED

- Safety Glasses
- Socket Set, Metric
- Wrench Set, Metric
- Socket Set, Torx® Bit
- Pliers, Needle Nose
- Torque Wrench

IMPORTANT

Your Plow Mount Kit is exclusively designed for your vehicle. Please read the installation instructions thoroughly before beginning. Installation is easier if the vehicle is clean and free of debris. For your safety, and to ensure a satisfactory installation, perform all installation steps correctly in the sequence shown.

INSTALLATION INSTRUCTIONS

VEHICLE PREPARATION

GENERAL

1. Shift vehicle transmission into Park.
2. Turn key to OFF position and remove from vehicle.

CENTER HOOD PANEL REMOVAL

1. Turn quarter-turn fasteners to unlock hood from vehicle.

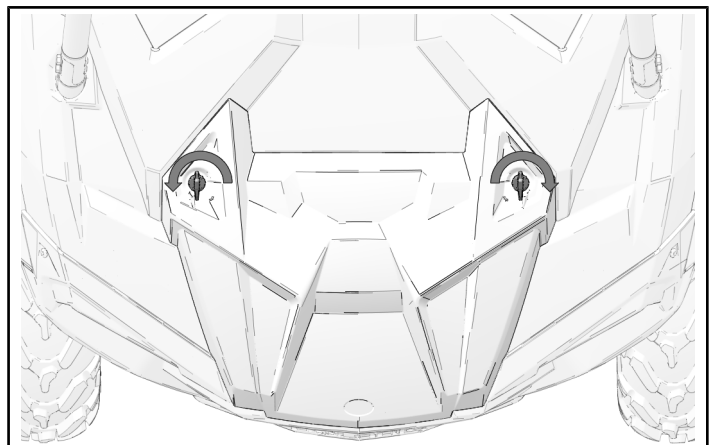

2. Move hood forward to remove from vehicle.

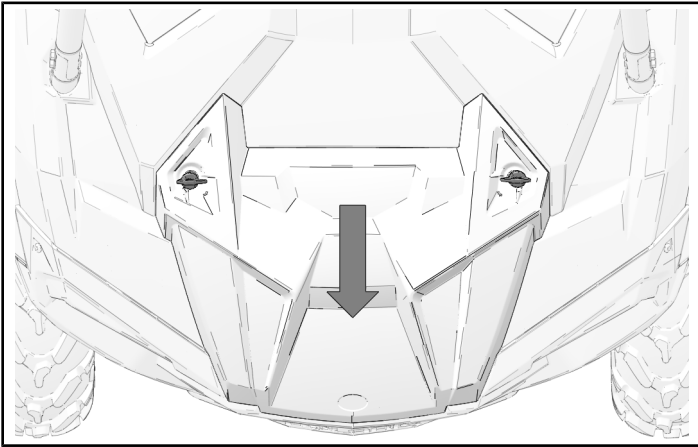

3. Disconnect headlight connectors and accent light connectors.

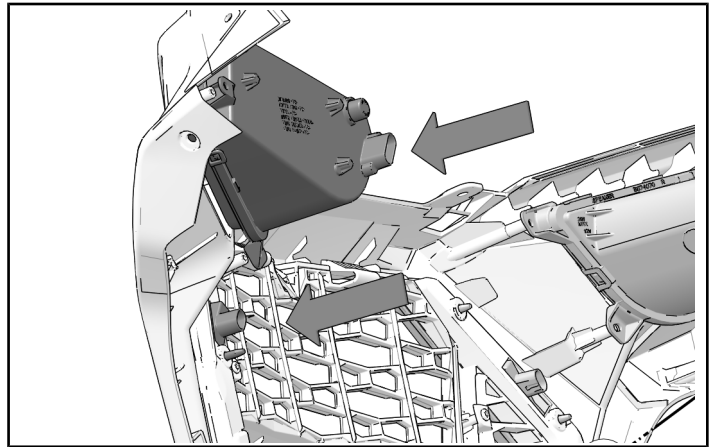

ACCESSORY INSTALLATION

1. Remove and keep two screws (A). Remove winch cover.

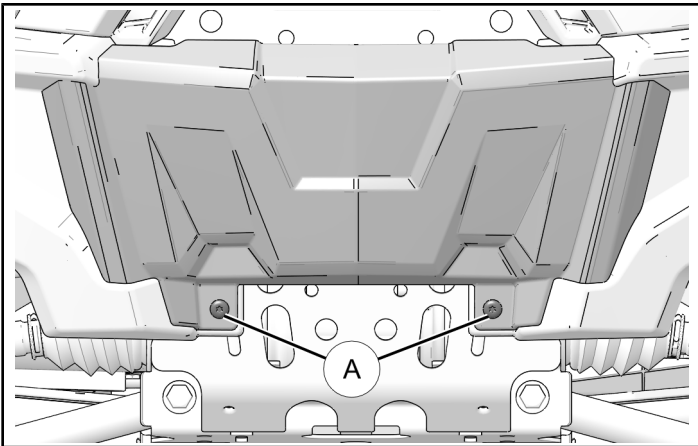

2. Remove and keep eight screws (B) to remove front fascia.

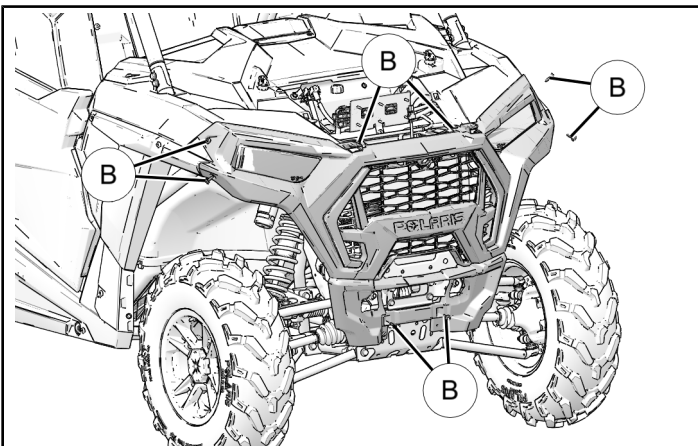

4. Install upper bumper bracket support (3) using screws (12) and weldment plate (9).

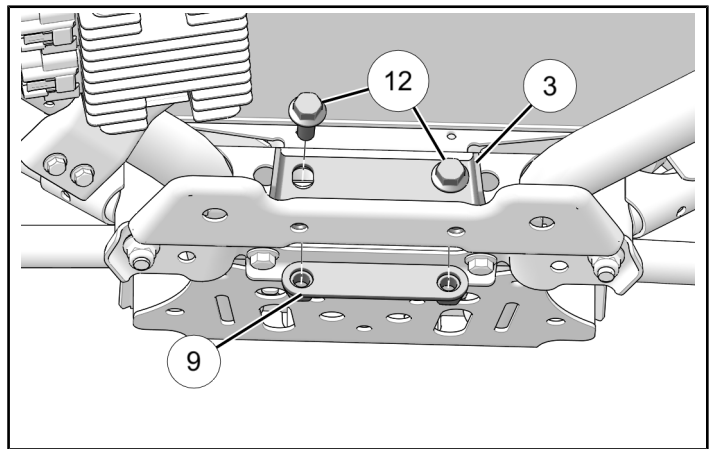

5. Install fairlead.

- If fairlead uses standard mounting holes then install winch fairlead onto mounting plate using screws ⑩ and nuts ⑭.

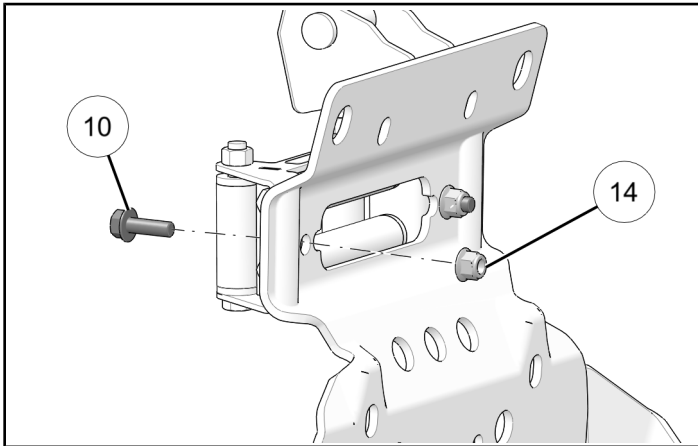

- If fairlead uses inner holes then fairlead adapter is required. Install fairlead and fairlead adapter ⑥ to mounting plate using screws ⑩ and nuts ⑭.

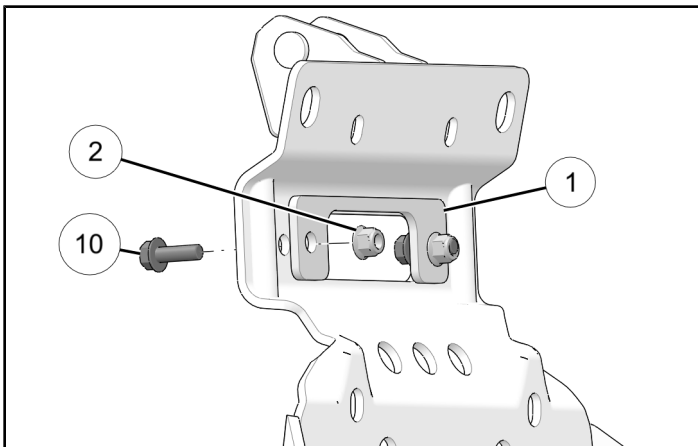

6. Install mounting plate ② using screws ⑩ and nuts ⑭.

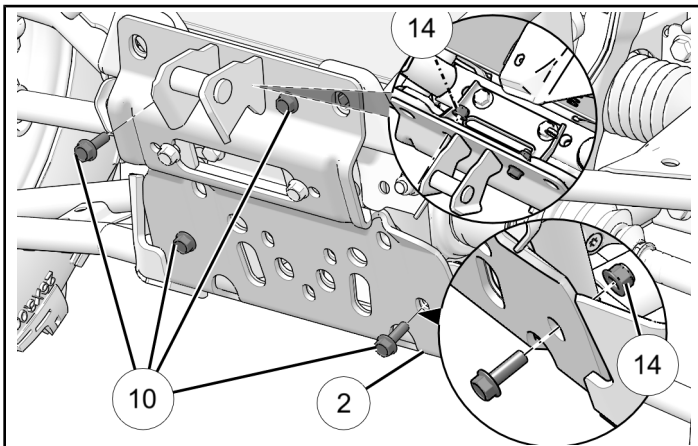

7. Install tightening plate ⑤ with washers ⑮ and ⑯ and screws ⑬.

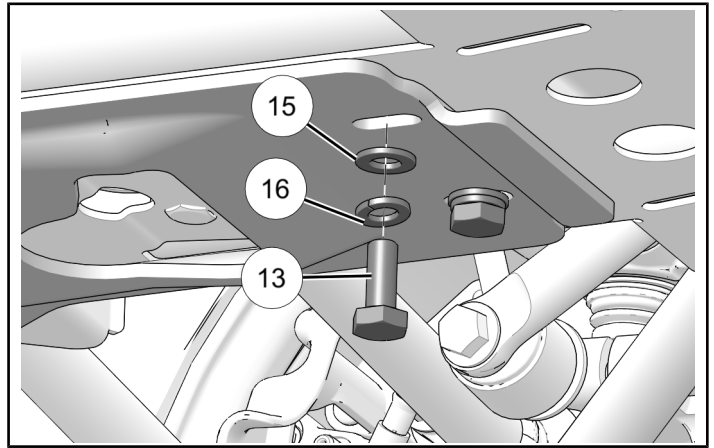
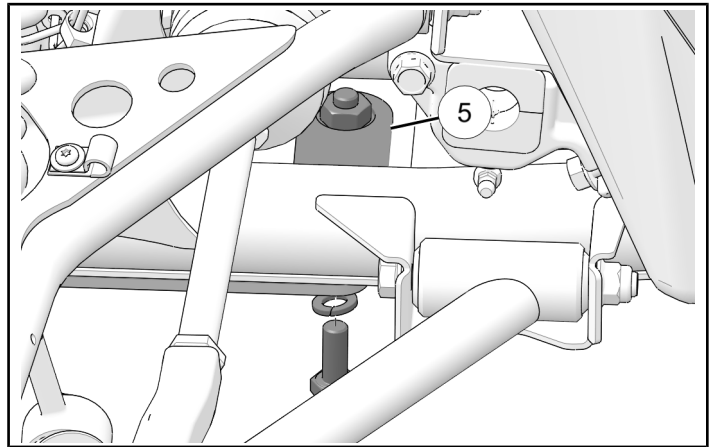

8. Torque screws ⑩, ⑫, and ⑬ to specification.

TORQUE

40 ft-lbs (54 N·m)

VEHICLE REASSEMBLY

GENERAL

1. Reconnect four light connectors.

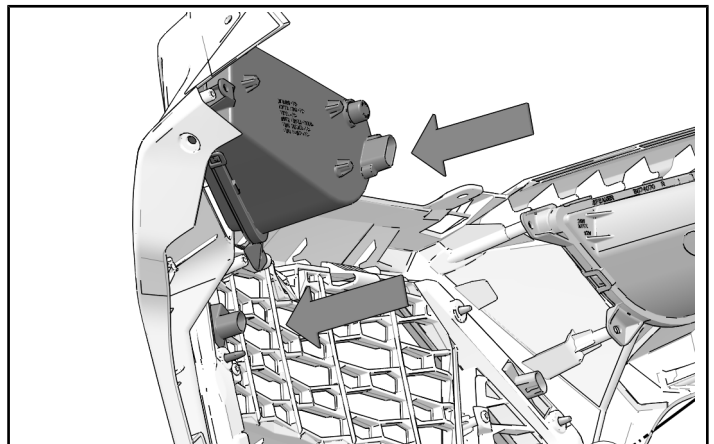

2. Install front fascia with six screws (B).

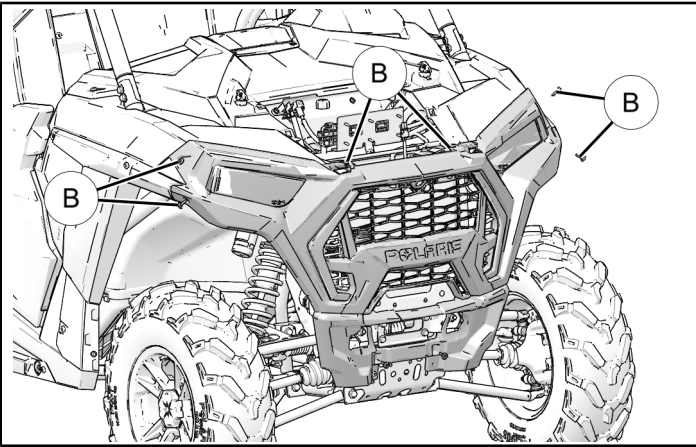

3. Install two screws (11).

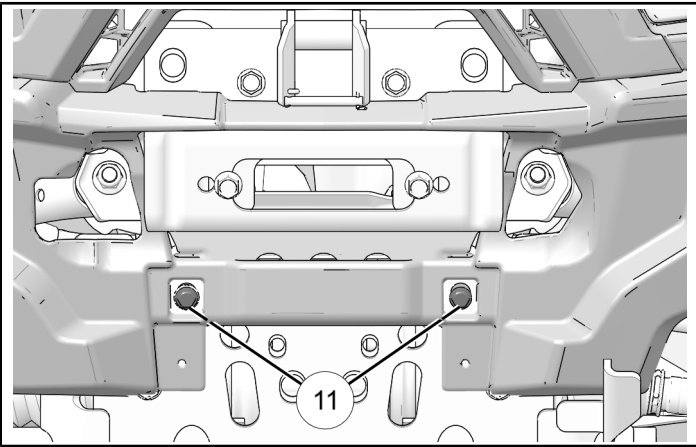

4. Install optional winch cover with screws (A)

CENTER HOOD PANEL INSTALLATION

1. Move hood rearward.

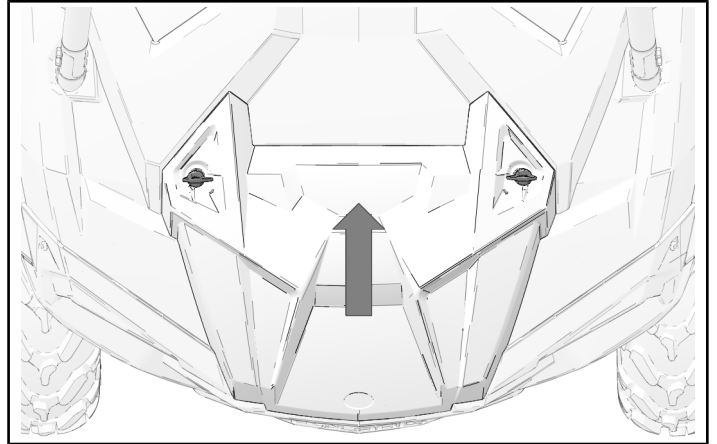

2. Turn quarter-turn fasteners to lock hood to vehicle.

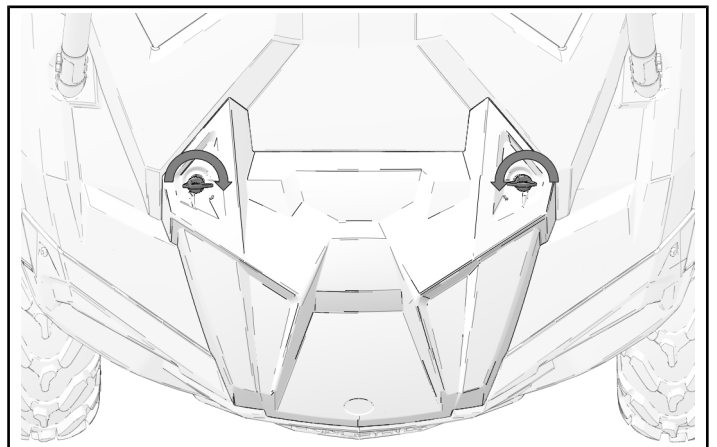

OPERATION

HOOK UP ASSEMBLY

1. Attach plow hookup.

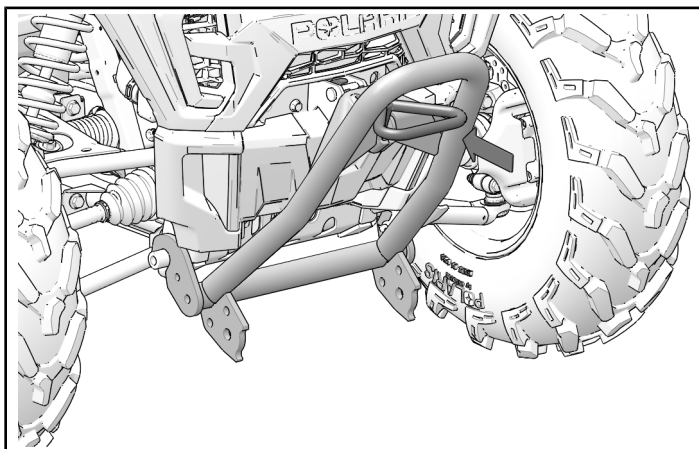
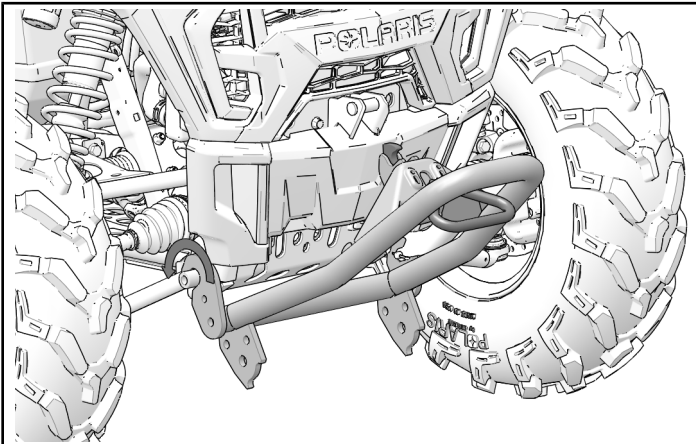

2. Insert pins ③.

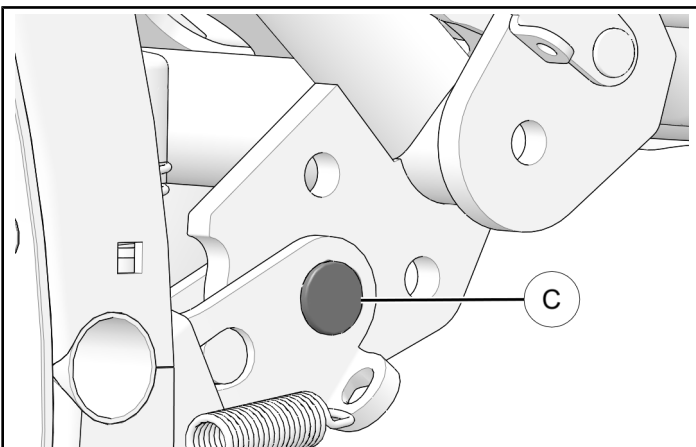

3. Insert split pins and bend to secure.

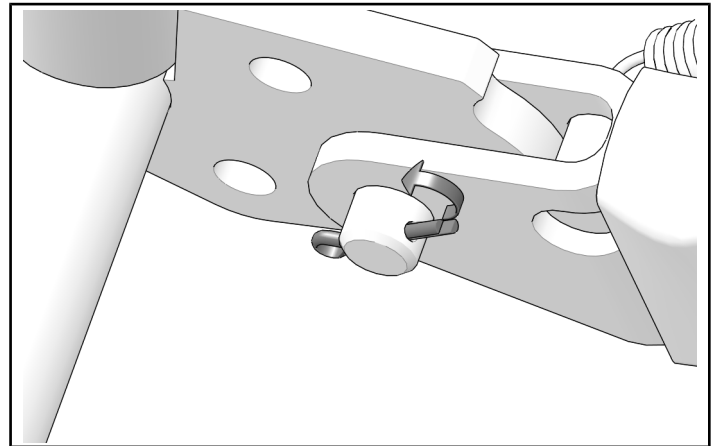

4. Install winch link ② into plow assembly.

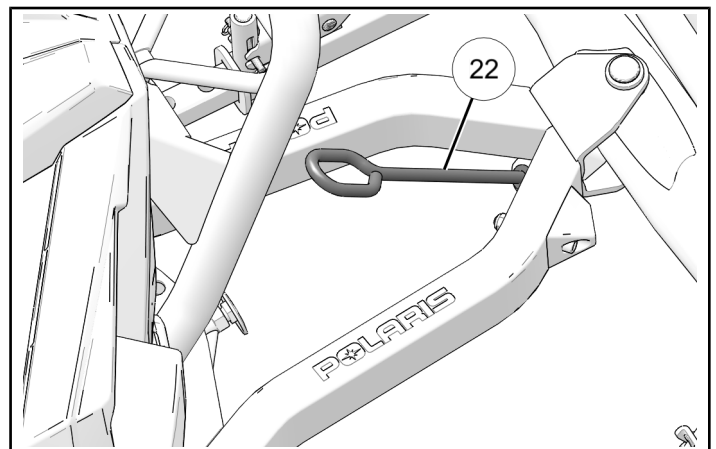

5. Attach winch to winch link.

IMPORTANT

The first adjustment requires kickstand height adjustment, depending on ground clearance. It may be necessary to repeat this exercise if accessories are added that affect ground clearance.

NOTICE

If vehicle height is too low, vehicle height may require adjustment. Refer to owner's manual for suspension adjustment procedures.

DISCONNECTING THE PLOW ASSEMBLY

1. Lower plow onto ground using winch until there is no tension in cable.
2. Disconnect winch from winch link.
3. Lower kickstand until it locks. Kickstand shoe should not touch the ground. If it is refer to *Kickstand Adjustment*.

4. Pull up on handle.

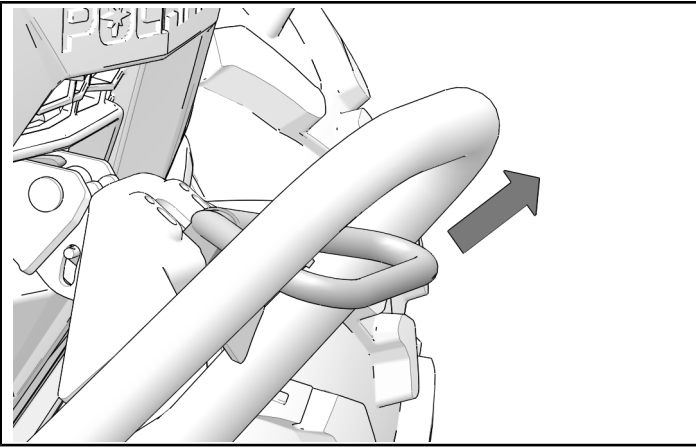

5. Turn assembly away from vehicle.

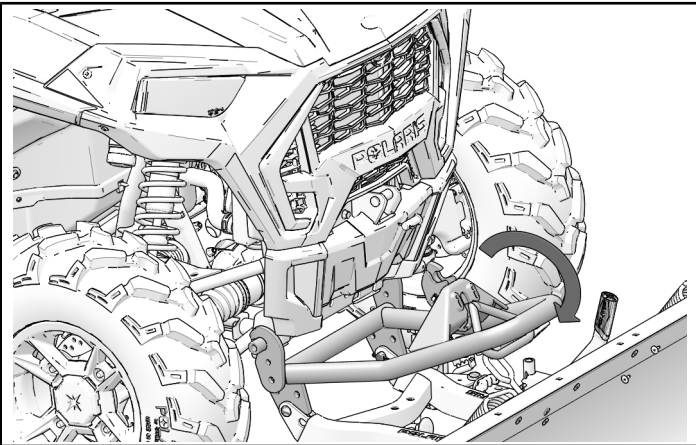

6. Back vehicle in a straight line until push-frame assembly is not touching vehicle.

CONNECTING THE PLOW ASSEMBLY

1. Align vehicle with assembly. Make sure pins are lined up with opening on the push-frame assembly.
2. Drive forward until vehicle is fully engaged in attachment plates on both sides.

3. Rotate assembly up by hand until hook engages with upper mount of plow mount plate. If hook does not fully engage check for snow and ice accumulation on lower pins of the mount plate. The kickstand should be off of the ground. If it is not refer to *Kickstand adjustment*.

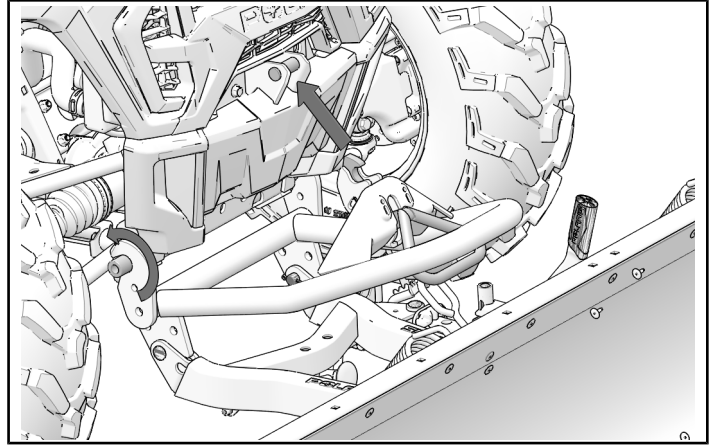

4. Connect winch hook to winch link.
5. Lift plow assembly with winch until kickstand is retracted automatically. Plow should be in top 1/3 of its travel.

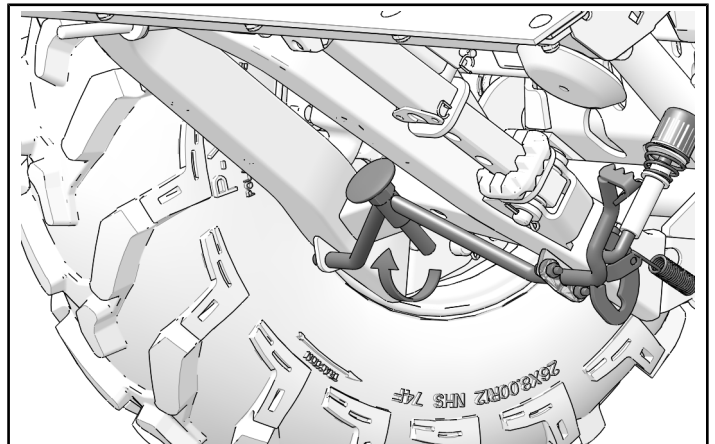

WINCH LINK ADJUSTMENT

⚠ CAUTION

The plow could become disconnected during adjustment. Always lower plow to the ground when making adjustments to avoid injury.

1. Attach plow assembly to vehicle and connect winch cable to winch link.
2. Raise plow until winch auto stop engages or winch hook contacts fairlead.
3. Lift up blade by hand to determine if it is at maximum lift height.
4. Adjust winch link so plow is at maximum lift height when winch auto stop engages or the winch hook contacts fairlead.

- Lower plow to the ground and adjust nut on bottom of winch link as required.
- Repeat steps until maximum lift height is achieved.

KICKSTAND ADJUSTMENT

⚠ CAUTION

The plow could become disconnected during adjustment. Always lower plow to the ground when making adjustments to avoid injury.

The kickstand must support push frame so the opening of push frame assembly lines up with mount plate pins for easy installation and removal of plow assembly.

- Loosen jam nut ① and screw kickstand shoe up or down to achieve desired height.
- Check height to make sure hook up openings and mount plate pins are aligned.
- Tighten jam nut to secure kickstand in place.

NOTICE

It may be necessary to install jam nut on opposite side of kickstand if additional adjustment is required.

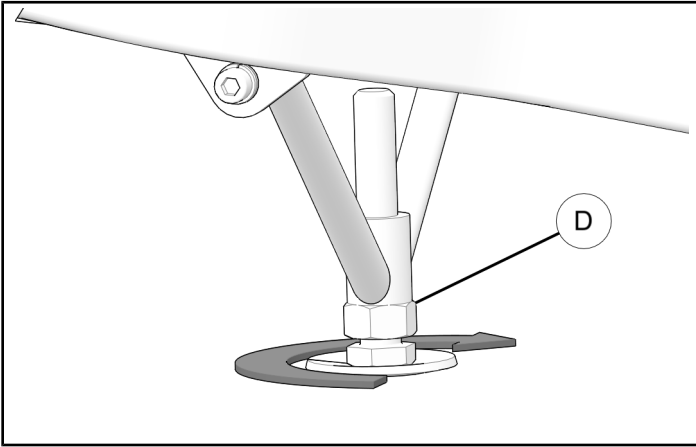

INSTRUCTION FEEDBACK FORM

A feedback form has been created for the installer to provide any comments, questions or concerns about the installation instructions. The form is viewable on mobile devices by scanning the QR code or by clicking [HERE](#) if viewing on a PC.



ADJUSTMENT OF AUTO RETRACTING KICKSTAND

⚠ CAUTION

The plow could become disconnected during adjustment. Always lower plow to the ground when making adjustments to avoid injury.

The auto retracting kickstand should be triggered when cap of J-Rod makes contact with kickstand lever of machine. This should take place in last 1/3 of plow's travel. Follow the steps below if kickstand fails to release properly:

- Make sure plow is achieving its maximum lift height by lifting up on blade to make sure plow is against stops at full lift. If it does not, refer to *Winch Link Adjustment*.
- Loosen jam nut on bottom of cap and screw cap in or out to achieve desired adjustment.

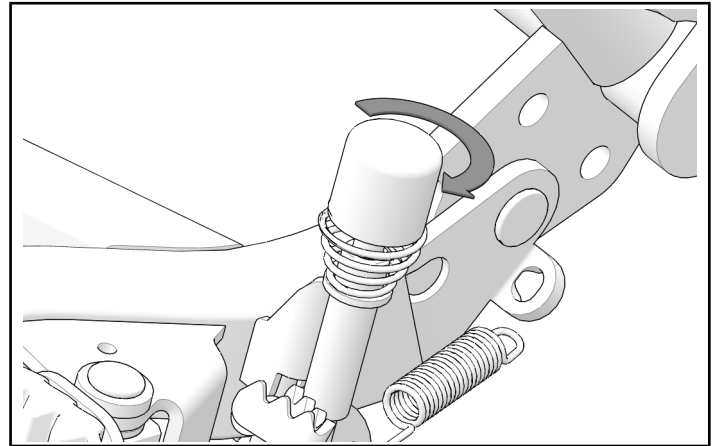

- Test kickstand assembly by putting kickstand down and lifting plow system with winch to it's max lift height.
- Repeat process until kickstand releases in top 1/3 of plow's travel.
- Tighten jam nut to secure cap in place.