

# POLY ROOF KIT



**P/N 2881206, 2881607, 2881608**

## APPLICATION

Verify accessory fitment at [Polaris.com](http://Polaris.com).

## BEFORE YOU BEGIN

Read these instructions and check to be sure all parts and tools are accounted for. Please retain these installation instructions for future reference and parts ordering information.

## KIT CONTENTS

This Kit includes:

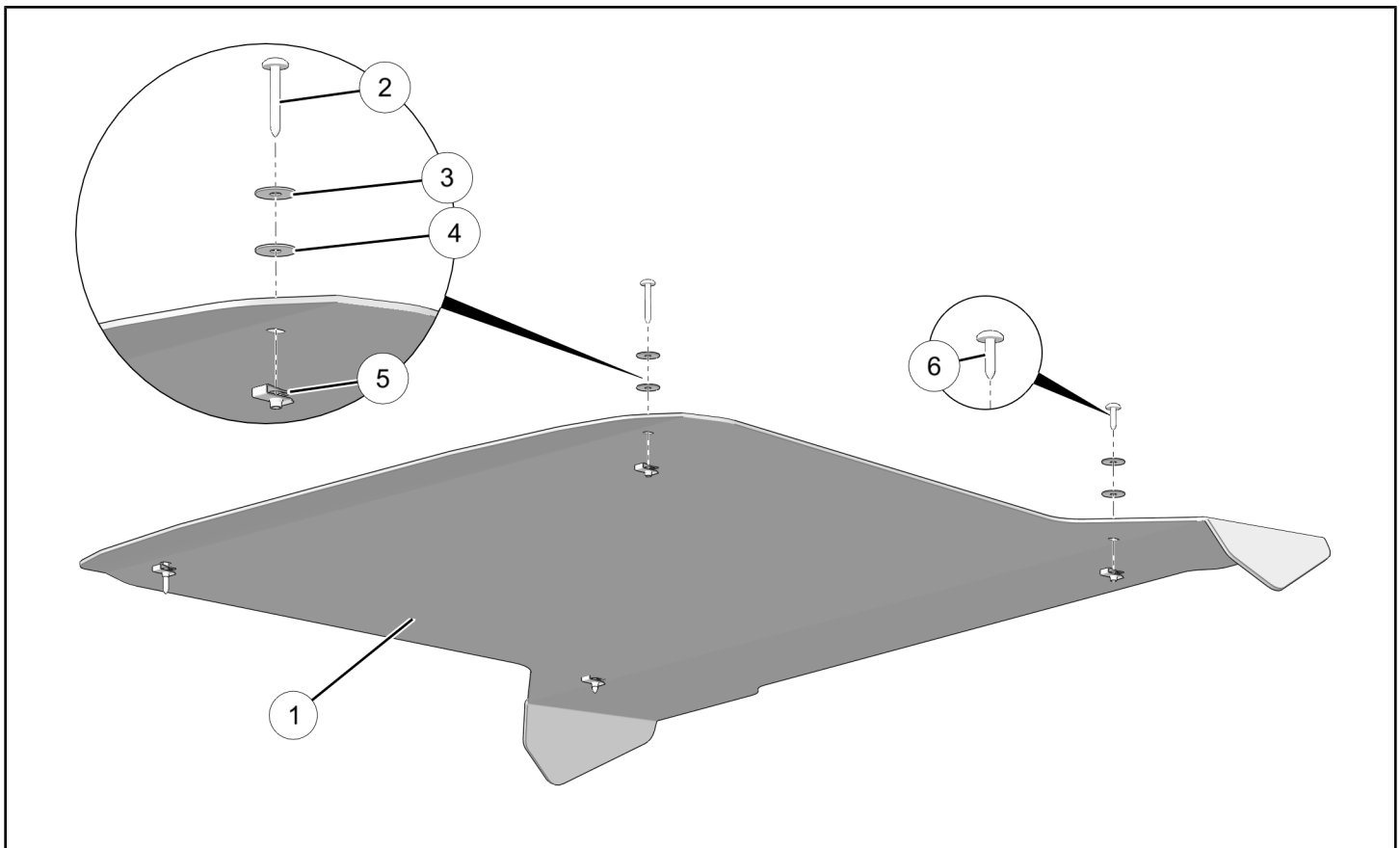

| REF | QTY | PART DESCRIPTION                        | PART NUMBER |
|-----|-----|---|-------------|
| 1   | 1   | Roof Panel, Poly                        | -           |
| 2*  | 2   | Screw, Torx® Truss Head - M6 X 1.0 X 45 | 7519722     |
| 3*  | 4   | Washer, Steel - 0.281 X 1.00 X 0.051    | 7556329     |
| 4*  | 4   | Washer, Rubber - 0.281 X 1.00 X 0.051   | -           |
| 5*  | 4   | Nut, Clip                               | 7081305     |
| 6*  | 2   | Screw, Torx® Truss Head - M6 X 1.0 X 25 | 7519650     |
| 7   | 1   | Tape, Foam - 3 mm (not shown)           | -           |

| REF | QTY | PART DESCRIPTION               | PART NUMBER |
|-----|-----|--------------------------------|-------------|
| 8   | 1   | Tape, Foam - 10 mm (not shown) | -           |
|     | 1   | Instructions                   | 9926208     |

Items marked (\*) are included in Hardware Kit PN 2206019.

## TOOLS REQUIRED

- Safety Glasses
- Screwdriver Set, Torx®
- Socket Set, Torx® Bit
- Torque Wrench

## IMPORTANT

Your POLY ROOF KIT is exclusively designed for your vehicle. Please read the installation instructions thoroughly before beginning. Installation is easier if the vehicle is clean and free of debris. For your safety, and to ensure a satisfactory installation, perform all installation steps correctly in the sequence shown.

## ASSEMBLY TIME

Approximately 10 minutes

## INSTALLATION INSTRUCTIONS

1. Remove two screws (A) from upper rear side of visor. Screws will not be reused.

### NOTE

Do not remove two screws from lower front side of visor. Roof panel ① will be installed on top of visor.

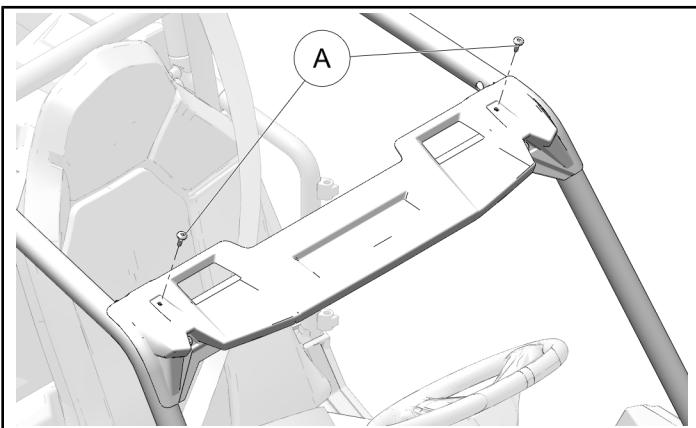

2. OPTIONAL: Replace two clip nuts (B) on forward ROPS cross-member, upper rear gussets, with new clip nuts (5).

### NOTE

Existing clip nuts may remain if in good condition.

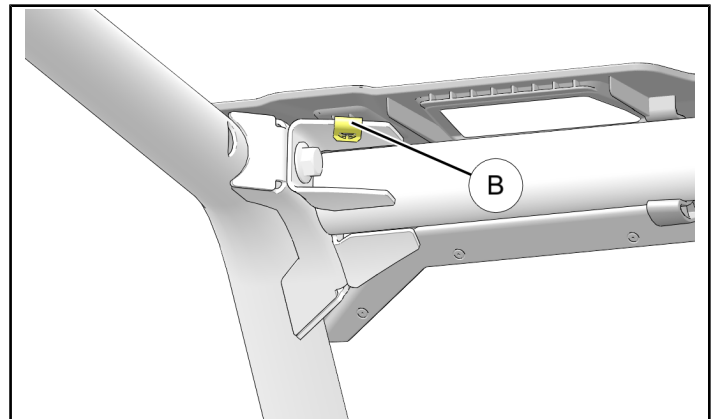

3. Install two clip nuts (5) to rear ROPS cross-member, upper OUTBOARD gussets. Upper inboard gussets will not be used.

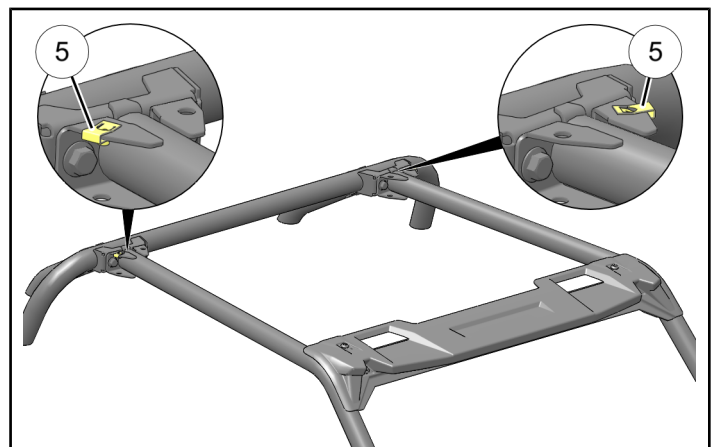

4. Lay roof panel ① upside down on protective surface.

5. Install foam tape at locations where roof will contact ROPS.
  - a. Clean underside of roof panel ① as required to ensure proper foam tape adhesion.
  - b. Peel adhesive backing from 3 mm foam tape ⑦, then apply tape to FRONT edge of roof panel ① as shown, trimming as required. Press tape firmly into place.

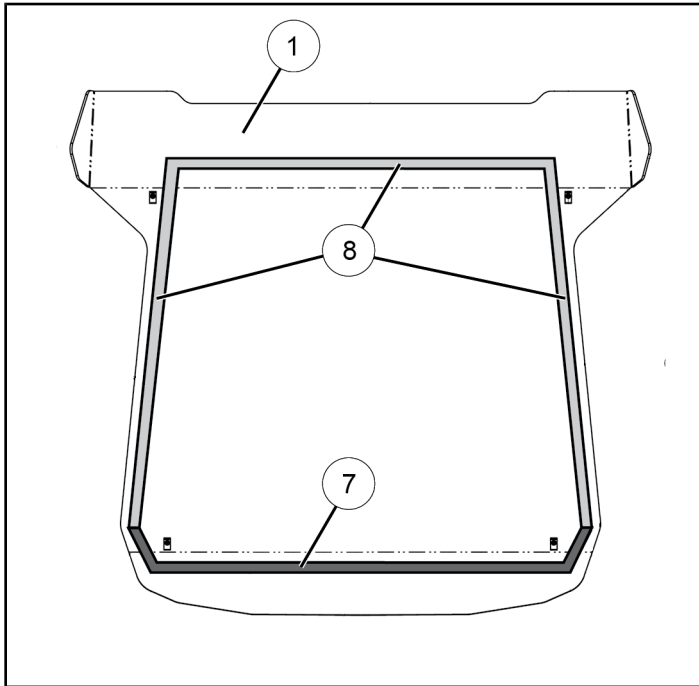

- c. Peel adhesive backing from 10 mm foam tape ⑧, then apply tape to SIDE and REAR edges of roof panel ① as shown, trimming as required. Press tape firmly into place.

6. Lay roof panel ① on ROPS, aligning all four fastener holes with nut clips ⑤ (and ⑧, if applicable).
7. Loosely install FRONT edge of roof panel ① to ROPS using two each 45 mm screws ②, steel washers ③, and rubber washers ④. Ensure steel washer is beneath screw head, and rubber washer is against roof.

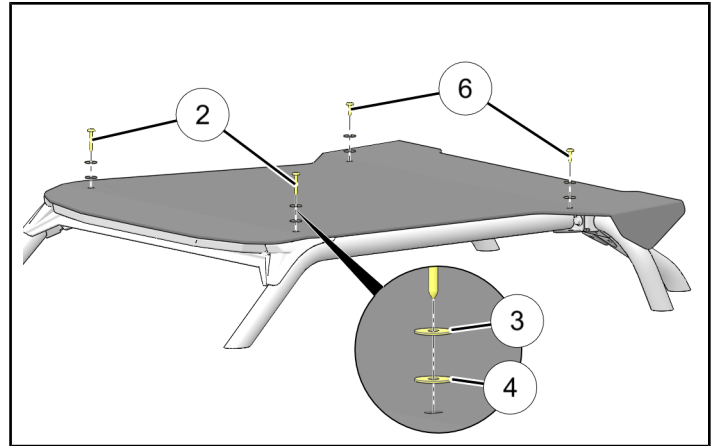

8. Loosely install REAR edge of roof panel ① to ROPS using two each 25 mm screws ⑥, steel washers ③, and rubber washers ④. Ensure steel washer is beneath screw head, and rubber washer is against roof.
9. Torque all screws to specification.

#### TORQUE

$8 \pm 1$  ft. lbs. ( $11 \pm 1$  Nm)

## FEEDBACK FORM

A feedback form has been created for the installer to provide any comments, questions or concerns about the installation instructions. The form is viewable on mobile devices by scanning the QR code or by clicking [HERE](#) if viewing on a PC.

#### FEEDBACK FORM

