

WINDSHIELD WIPER KIT

P/N 2879526

Application

RZR 900, RZR 900 S, RZR XP 1000 AND RZR 1000 XP4

POLARIS

ENGINEERED PARTS
ACCESSORIES & APPAREL

Before you begin, read these instructions twice and check to be sure all parts and tools are accounted for. Please retain these installation instructions for future reference and parts ordering information.

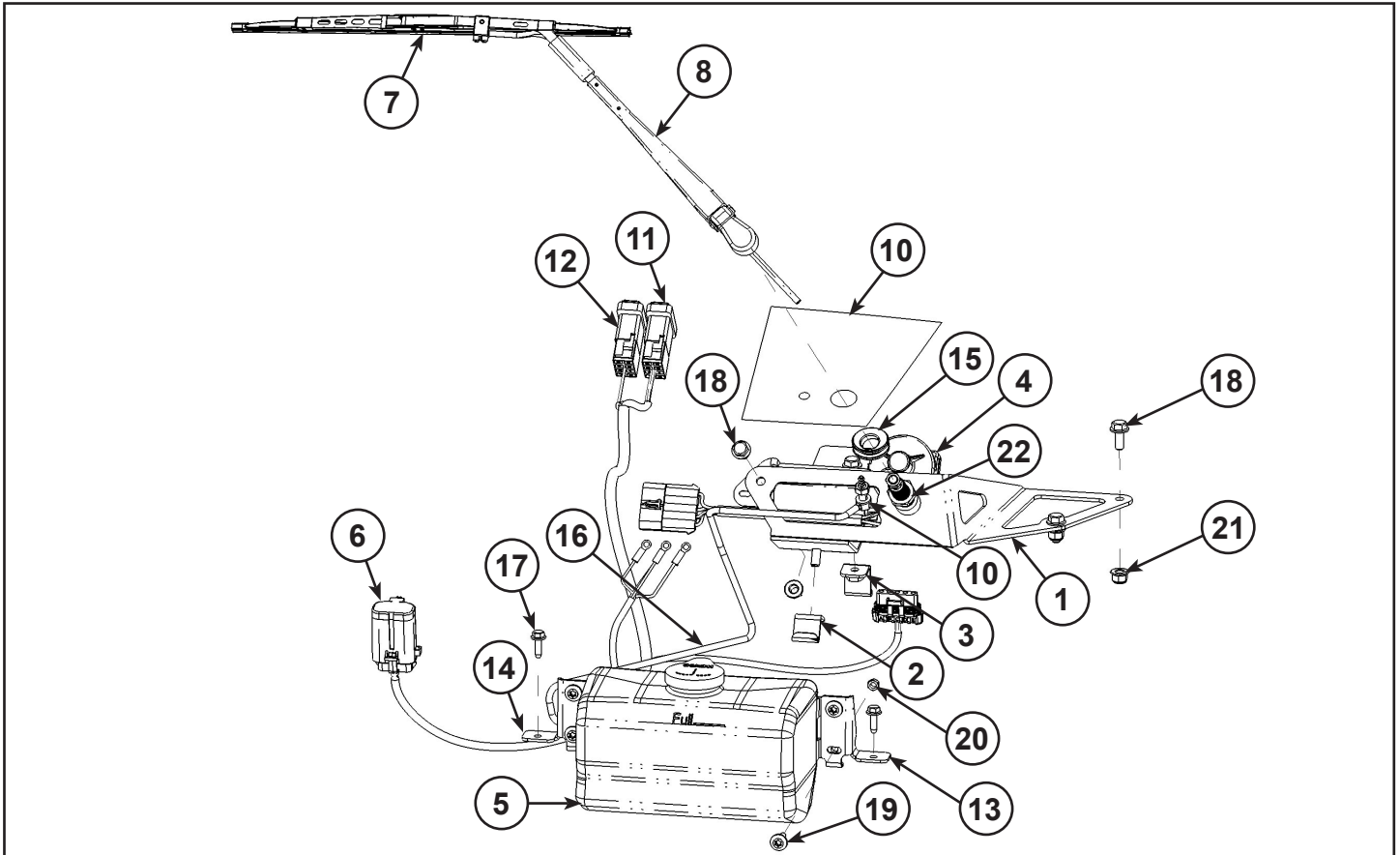

Kit Contains:

<u>Ref</u>	<u>Qty</u>	<u>Part Description</u>	<u>Part Number</u>
1	1	Wiper Mount Weldment	1020080
2	1	Front Wiper Mount Hook Weldment	1020081
3	1	Rear Wiper Mount Hook Weldment	1020082
4	1	Wiper Motor Assembly	1204977
5	1	Washer Bottle Assembly, Windshield	2205139
6	1	Wiper Harness, Windshield	2412873
7	1	Wiper Blade	2634843
8	1	Blade Arm	2635455
9	1	Tube Fitting	-
10	1	Template	-
11	1	Wiper Switch, Wash	4014071
12	1	Wiper Switch, Low/High	4014072
13	1	Windshield Wiper Bracket, LH	5259685
14	1	Windshield Wiper Bracket, RH	5259686
15*	1	Windshield Wiper Grommet, Black	5415099
16*	1	Wiper Hose Washer, RH	7052614

<u>Ref</u>	<u>Qty</u>	<u>Part Description</u>	<u>Part Number</u>
17*	2	Flange Hex Screw-M6X1.0X20, HD, TDFM, BK	7518529
18*	5	Flange Hex Bolt-M8X1.25X20, HD	7518702
19*	4	Screw, TXTH-M6X1.0X25 RIE	7519650
20*	4	Nut-6mmX1, Nyloc-2	7546703
21*	5	Flange Nut-M8X1.25, Nyloc-Olive D	7547332
22	1	Jam Nut-M16X2	-
	1	Instructions	9925034

Items marked (*) are included in Hardware Kit PN 2205206.

Tools Required:

Metric Socket Set Drill 5/16" Drill Bit 1" Holes Saw

APPROXIMATE INSTALLATION TIME: 30 minutes

IMPORTANT: Your Polaris WINDSHIELD WIPER KIT is exclusively designed for your vehicle. Please read the installation instructions thoroughly before beginning. Installation is easier if the vehicle is clean and free of debris. For your safety, and to ensure a satisfactory installation, perform all installation steps correctly and in the sequence shown.

INSTALLATION INSTRUCTIONS:

1. Park the vehicle. Turn the key to "OFF" position and remove from the vehicle.
2. Remove driver seat. Disconnect black negative and red positive cable from battery.
3. Remove center hood by twisting two knobs and pulling up from the vehicle. Figure 1.

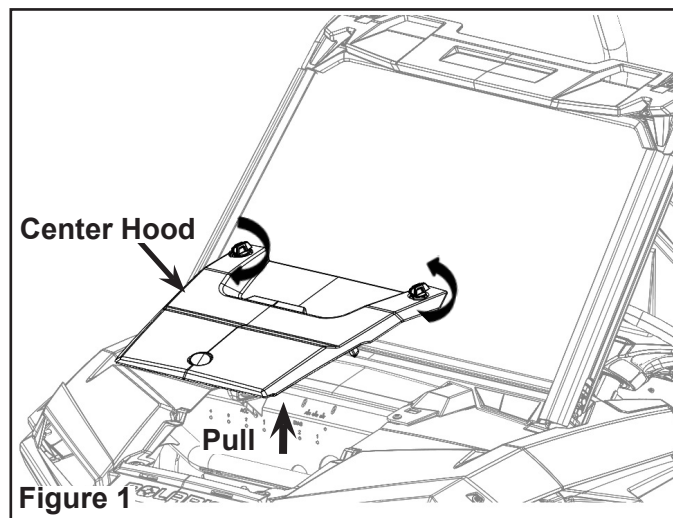

4. If windshield is installed, remove it by removing four screws, relevant washers and nuts. Figure 2.

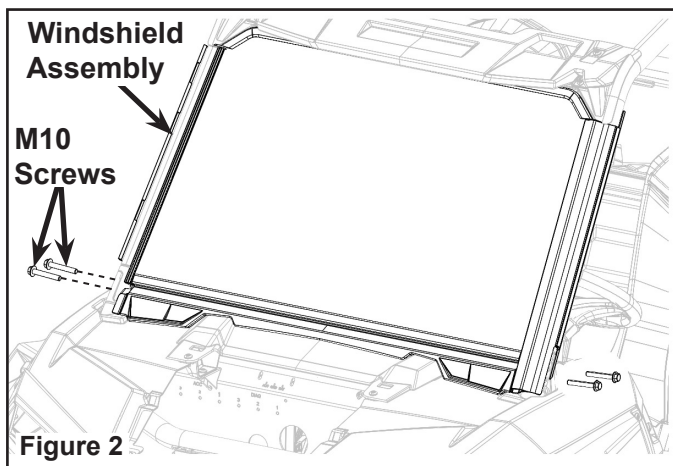

5. Remove the existing M6 screws from front bumper frame and install the wiper bottle brackets (PN 5259685 and 5259686) by attaching two M6 screws (PN 7518529) provided in the kit. Tighten screws to torque 6 ft. lbs. (8.13 Nm). Figure 3.

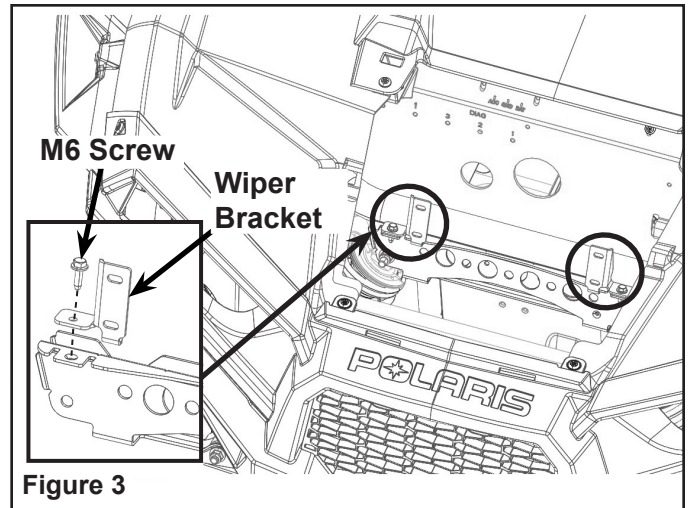

6. Mount the washer bottle assembly (PN 2205139) on to the brackets by attaching four M6 screws (PN 7519650) and relevant M6 nuts (PN 7546703). Tighten screws to torque 6 ft. lbs. (8.13 Nm). Figure 4.

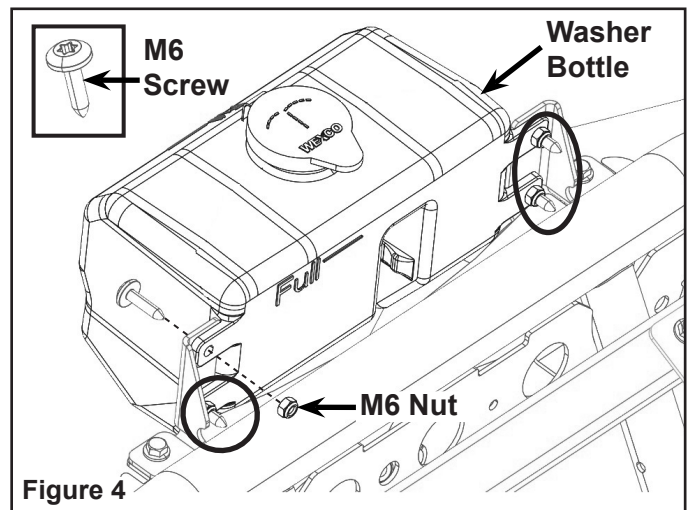

7. Remove upper instrument panel by removing two screws. Disconnect the switches and connections. Retain the screws for reassembly. Figure 5.

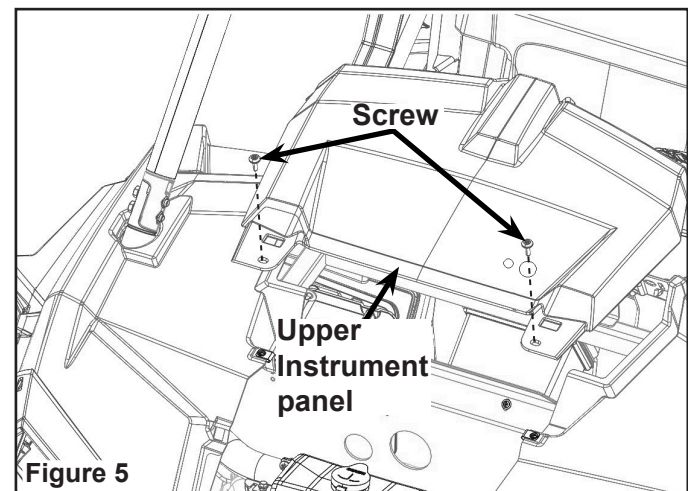

8. Put the paper template parallel to the base and left side of instrument panel as shown and mark the hole positions on to the panel. Figure 6.

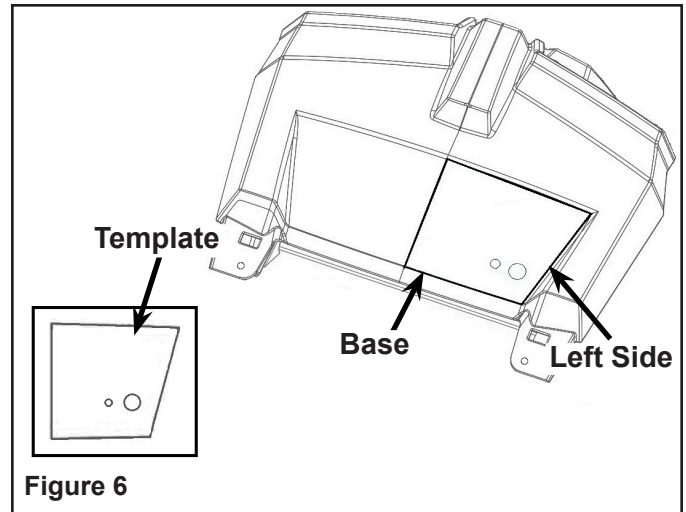

9. On the pre-marked area on the instrument panel, drill the holes through using 1" drill bit for larger hole and 5/16" drill bit for smaller hole. Install grommet (PN 5415099) into the drilled large (1") size hole as shown. Figure 7.

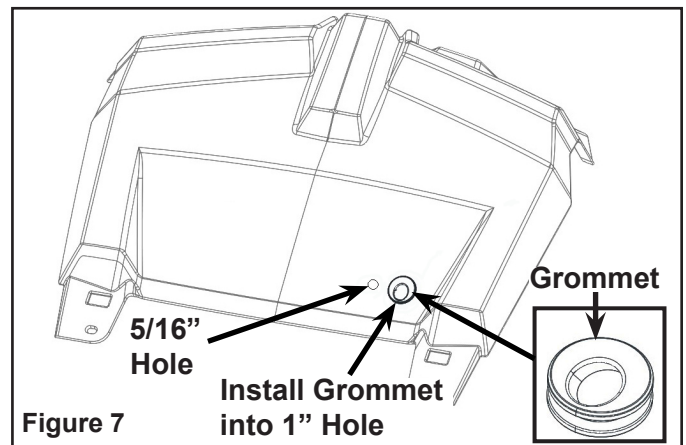

10. Remove dash panel by removing two screws. Retain the screws for reassembly. Figure 8.

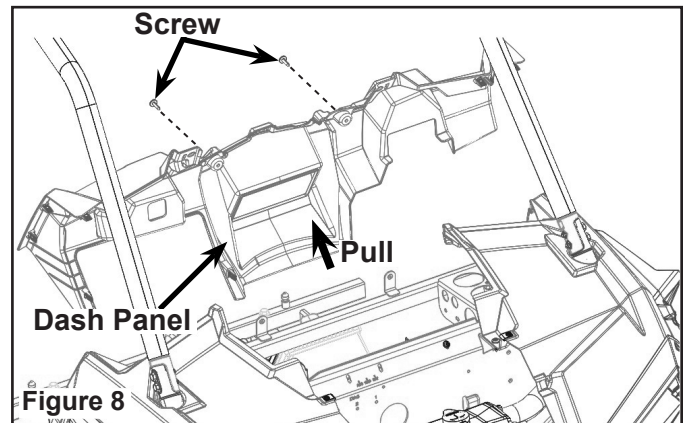

11. Install wiper mount (PN 1020080) on the dash frame by fastening four M8 bolts (PN 7518702) and relevant M8 nuts (PN 7547332) and front and rear weldment hooks (PN 1020081 and 1020082). Tighten bolts to torque 16 ft. lbs. (21.7 Nm). Figure 9.

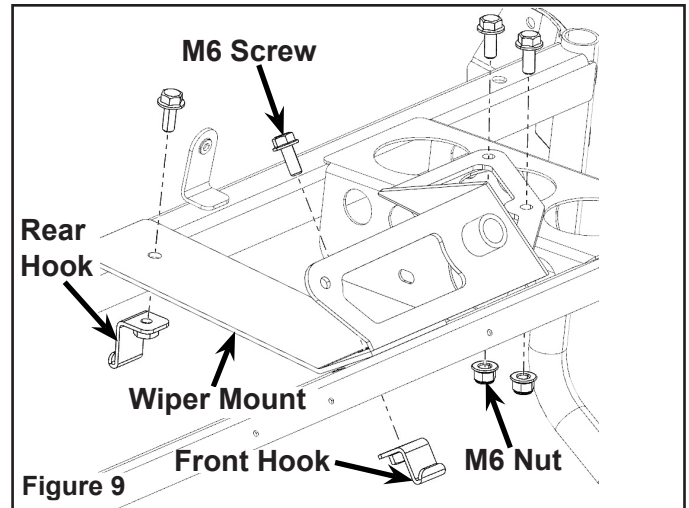

12. Remove the nuts from wiper motor shaft and install wiper motor (PN 1204977) on the wiper bracket by reinstalling M16 nut, rubber washer and M8 bolt (PN 7518702) and relevant M8 nut (PN 7547332). Tighten M16 nut to torque 12.5-17 ft. lbs. (17-23 Nm). Tighten M8 bolt to torque 16 ft. lbs. (21.7 Nm). Figure 10.

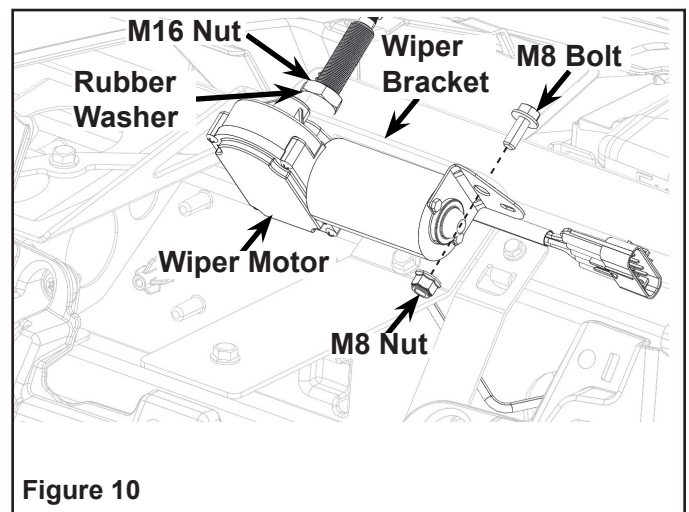

13. Install the wiper harness (PN 2412873). Ensure the harness routed properly. Figure 11.

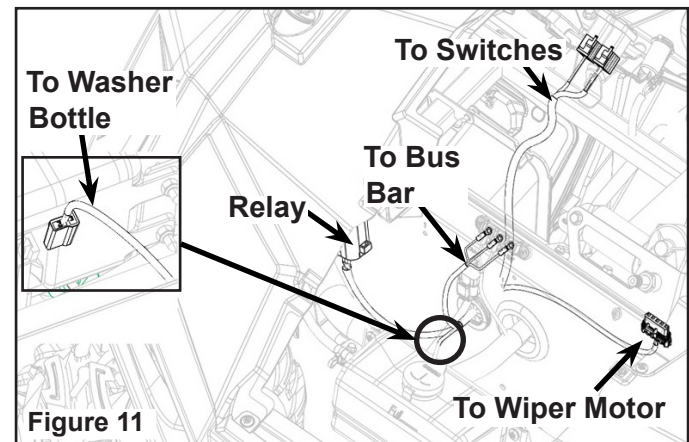

14. Cut down the instrument panel inside at the pre-marked areas to install the switches (PN 4014071 and 4014072). Figure 12.
15. Reinstall the dash panel removed in Step 9.

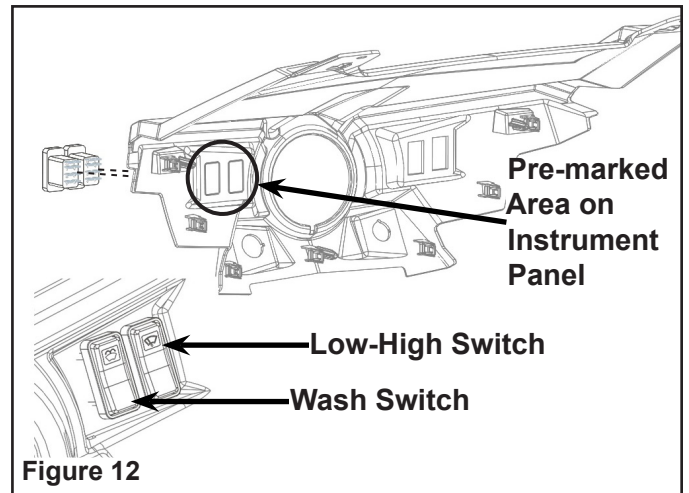

16. Remove nut from the connector and install the connector into the drilled hole on the upper instrument panel as shown. Secure the removed nut. Connect the wiper hose (PN 7052614) to inlet of connector. Figure 13

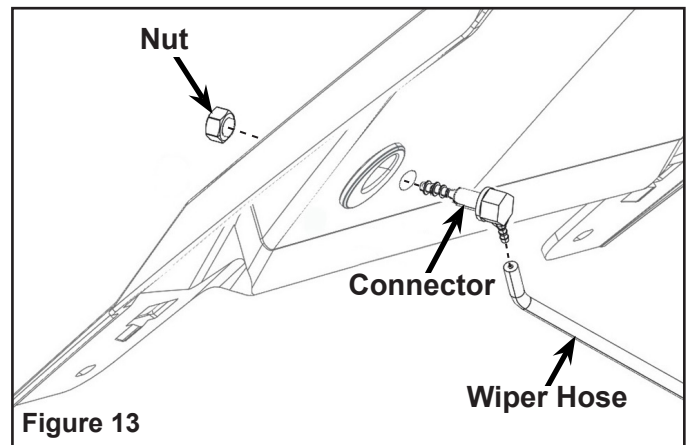

17. Connect the wiper harness to switches installed. Reconnect all the connections and reinstall upper instrument panel. Route the wiper hose properly as shown and connect to the washer bottle. Ensure the motor shaft pass through the grommet. Secure instrument panel by attaching two screws. Figure 14.

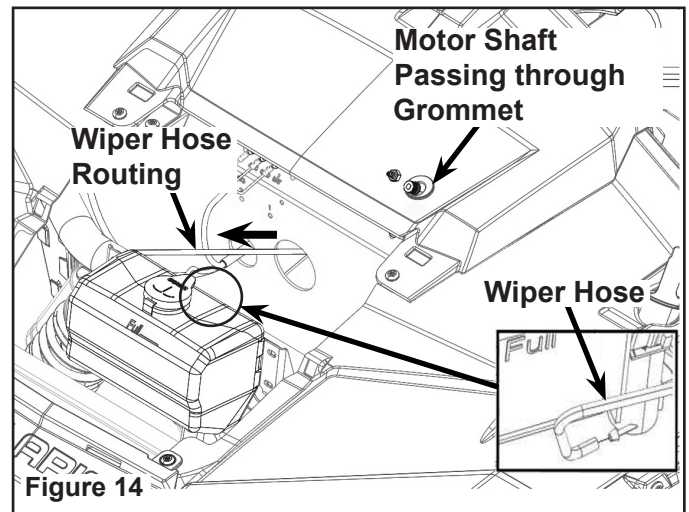

18. Reinstall the windshield.
19. Attach the wiper blade (PN 2634843) to the wiper arm (PN 2635455). Ensure that wiper blade snug properly. Figure 15.

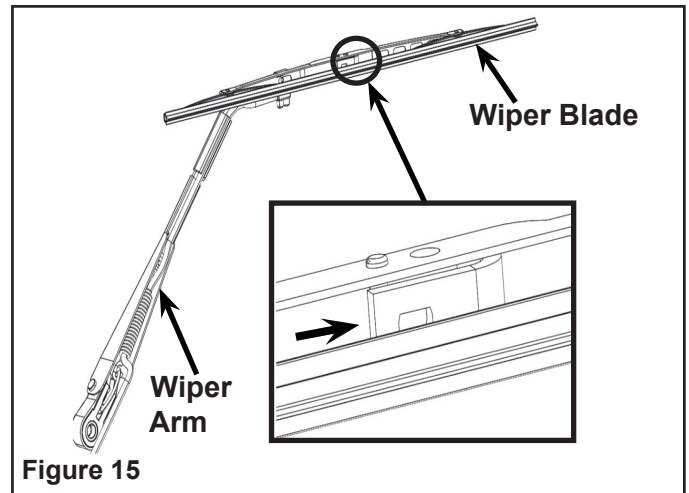

20. Install wiper blade arm on to the wiper motor shaft and tighten by securing the nut removed from wiper motor shaft in Step 11. Tighten wiper arm nut to torque 10.3-13.2 ft. lbs. (14-18 Nm). Connect the wiper arm hose end to the outlet of the connector. Figure 16.

NOTE: Route the washer hose around the wiper arm properly. Incorrect routing will rip off the hose.

21. Reinstall center hood. Connect the battery terminals and reinstall the driver's seat.
22. Adjust position of wiper arm on shaft as needed by removing mounting nut and reclocking wiper arm on wiper motor shaft.
23. Turn on key and test functionality.

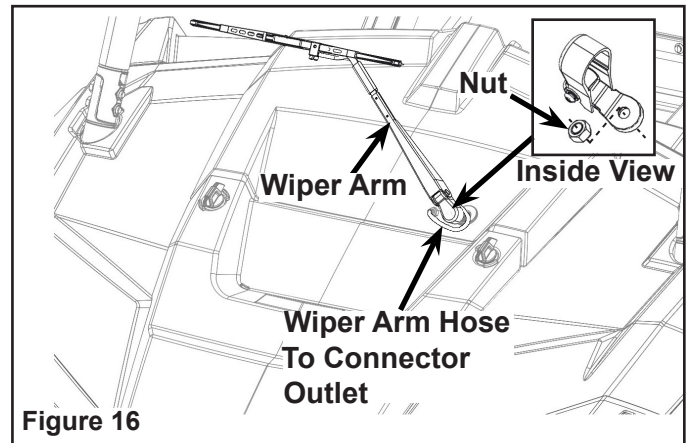

PAPER TEMPLATE: SCALE (1:1):

NOTE: Below template (Figure 17) is not as per the actual size and only for reference.

