

WHISKER GUARD KIT



P/N 2884948-XXX

BEFORE YOU BEGIN

Read these instructions and check to be sure all parts and tools are accounted for. Please retain these installation instructions for future reference and parts ordering information.

APPLICATION

Verify accessory fitment at www.polarisslingshot.com.

DISCLAIMER ACCESSORY WEIGHT

When adding accessories, equipment, passengers and luggage to your vehicle, do not exceed the total weight capacity of the vehicle or of the front or rear axle (GVWR or GAWR as indicated on the Safety Compliance Certification label). Ask an authorized dealer for specific weight information if you need assistance. It is the owner's responsibility to use the Polaris Slingshot Accessories website as a tool for limiting the amount of accessories, based on maximum allowable vehicle weight requirements. It may be a violation of the Clean Air Act or the NHTSA regulations to disregard these requirements. For a complete listing of the accessories that are available for your vehicle, please contact your authorized dealer or visit the online store web site: Web Address (United States): <http://www.polaris.com/en-us/slingshot/shop/accessories>.

KIT CONTENTS

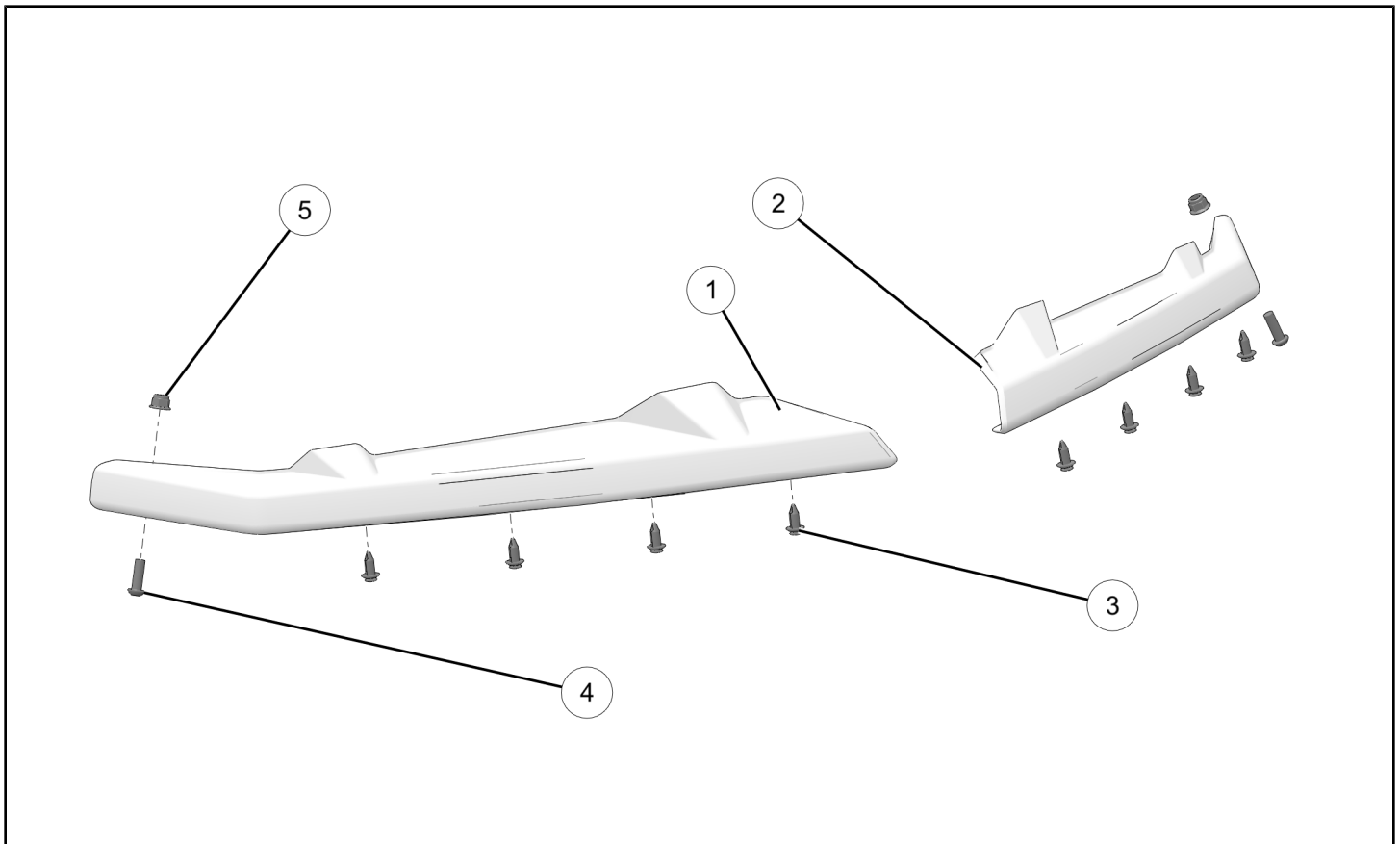

NOTICE

XXX = Polaris Slingshot® color code (For example: 070 = Black)

REF	QTY	PART DESCRIPTION	P/N AVAILABLE SEPARATELY
1	1	Guard – Whisker, RH	5457642-XXX
2	1	Guard – Whisker, LH	5457641-XXX
3	10	Rivet – Push Lock .315 .325 x .787	7661855
4	2	Screw – Torx M8 x 1.25 x 25 mm	7519728
5	2	Nut – Hex M8 x 1.25 mm	7547454

TOOLS REQUIRED

- Safety Glasses
- Drill
- Drill Bit:
 - 5/16 in (8.5 mm)
- Push Dart (Panel Clip) Tool
- Socket Set, Torx® Bit
- Torque Wrench
- Wrench Set, Metric
- Vehicle Lift/Support Equipment

CONSUMABLES REQUIRED

- Cloth, Non-Abrasive (Cheesecloth or equivalent)
- Isopropyl Alcohol (IPA)

IMPORTANT

Your Whisker Guard Kit is exclusively designed for your vehicle. Please read the installation instructions thoroughly before beginning. Installation is easier if the vehicle is clean and free of debris. For your safety, and to ensure a satisfactory installation, perform all installation steps correctly in the sequence shown.

INSTALLATION INSTRUCTIONS

VEHICLE PREPARATION

GENERAL

1. Park vehicle on a flat surface.
2. Shift vehicle to NEUTRAL.
3. Press START/STOP button to turn vehicle OFF.
4. Remove key fob from proximity of vehicle.

LIFT VEHICLE

⚠ WARNING

- Serious injury or death can occur if the vehicle moves or falls while elevated. When elevating is necessary, make sure the vehicle is properly elevated and stable before performing service.
- DO NOT attempt to elevate your vehicle without proper equipment. If you're not familiar with using floor jacks or lift mechanisms, see your dealer for service.

1. To elevate the SLINGSHOT vehicle, use automotive-quality floor jacks. Use the floor jacks on a firm, flat surface.
2. Make sure the floor jacks are positioned under the frame rails in the front where the lower control arm mounts to the frame, or in the rear where the frame rails meet.

① Bottom View of Lift Points

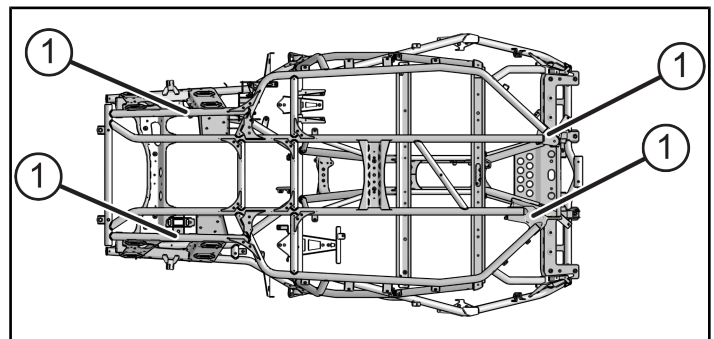

② Side View of Lift Points

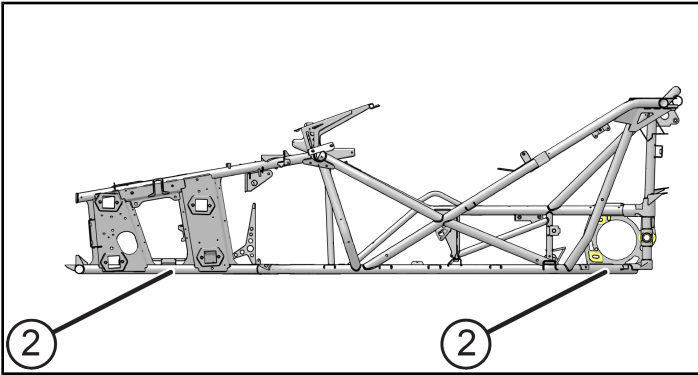

ACCESSORY INSTALLATION

NOTICE

Left side of vehicle shown, right side similar.

1. Remove and discard the fastener and nut located at the outer edge of the front wing and lower accent panel.

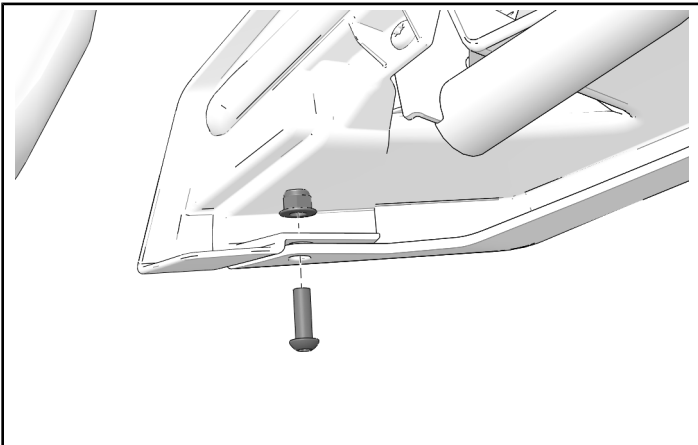

2. Clean the wing surface using Isopropyl Alcohol and a clean, non-abrasive cloth.

⚠ WARNING

Isopropyl alcohol is hazardous to your health. See isopropyl alcohol packaging for proper handling instructions, including recommended personal protective equipment such as goggles and chemical resistant gloves.

3. Put the whisker guard ② on the panel.

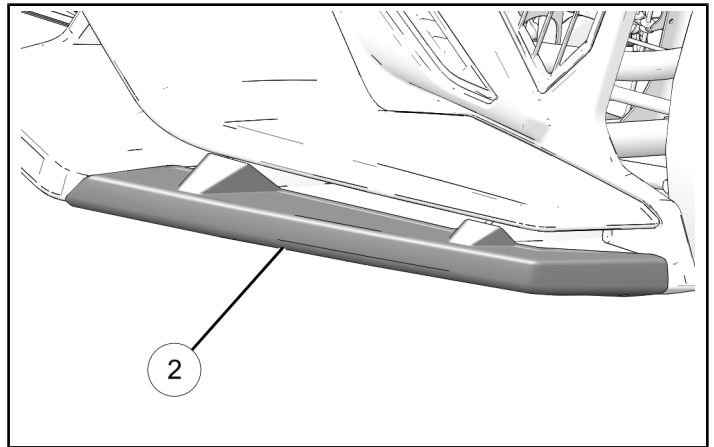

4. Loosely install screw ④ and nut ⑤.

Do not torque fastener at this time.

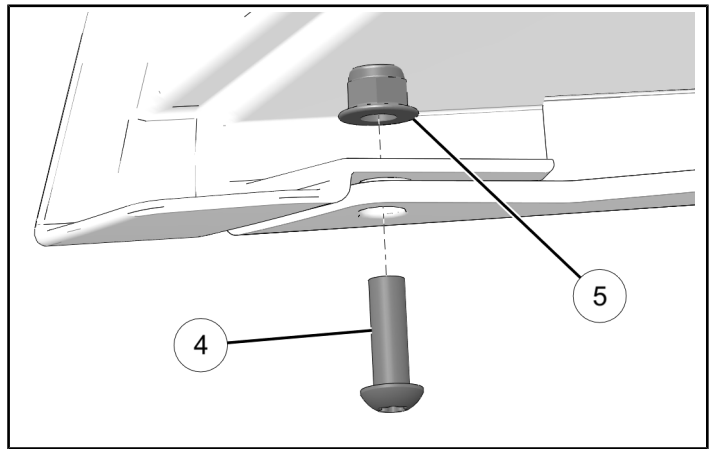

5. Hold the whisker guard ② in place and drill the outermost hole, closest to the fastener. Drill only through the bottom wing surface.

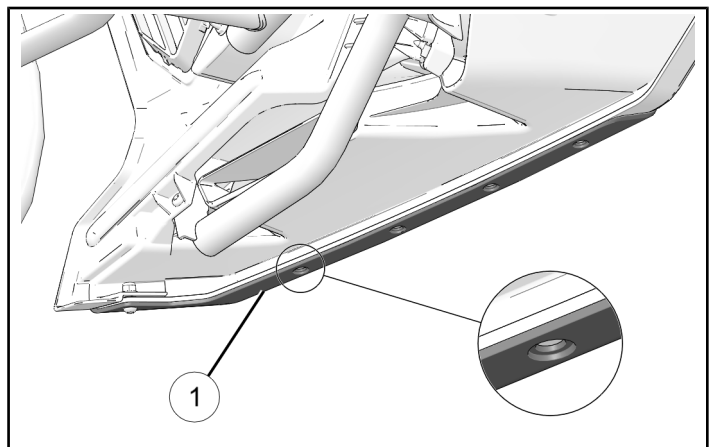

6. Insert push lock rivet ③ into the hole, but do not lock.

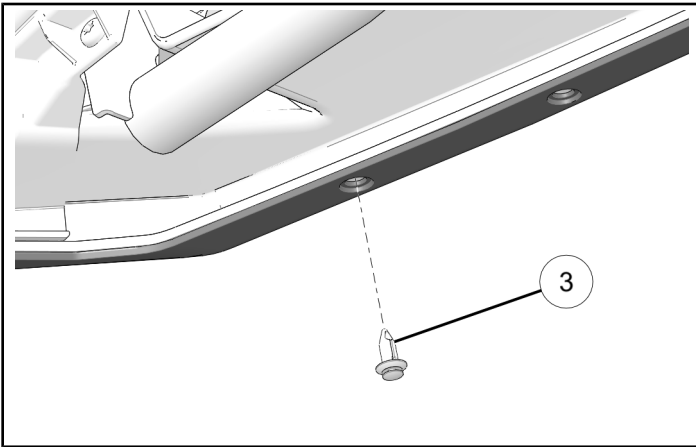

7. Hold in place and drill remaining holes one at a time, working from the outside in. Insert push lock rivet ③ after drilling each hole, but do not lock.

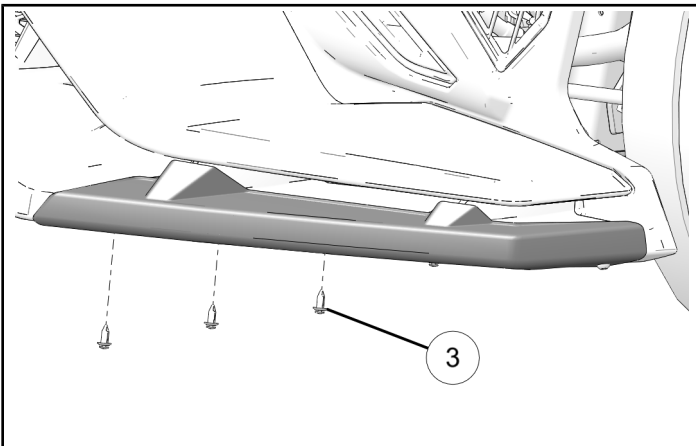

8. Hold nut and torque screw ④ to specification.

TORQUE

Whisker Guard Screw ④:
36 in-lbs (4 N·m)

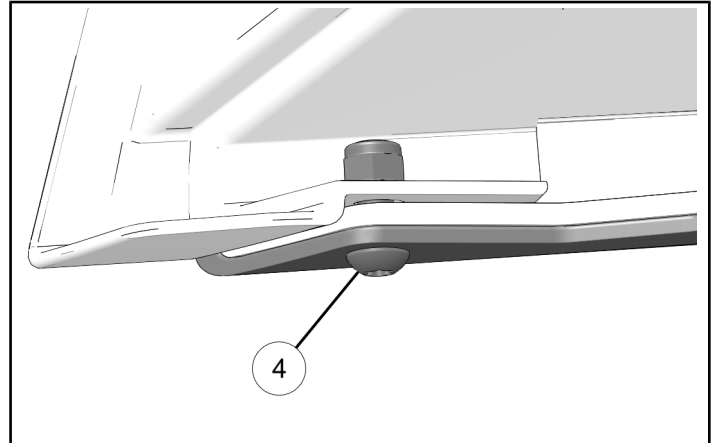

9. Lock all push lock rivets.

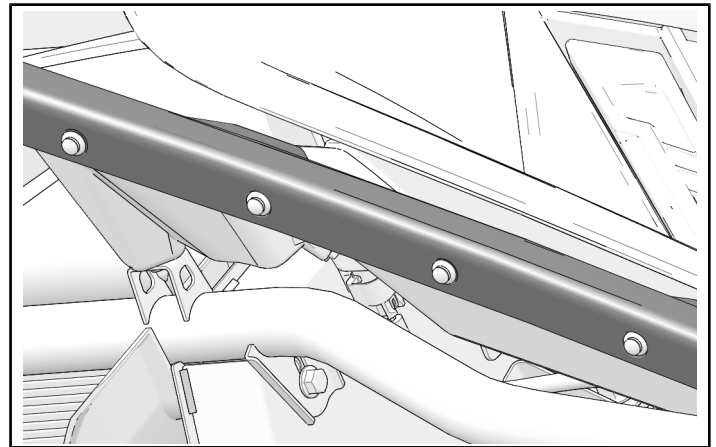

INSTRUCTION FEEDBACK FORM

A feedback form has been created for the installer to provide any comments, questions or concerns about the installation instructions. The form is viewable on mobile devices by scanning the QR code or by clicking [HERE](#) if viewing on a PC.

