

GARAGE DOOR OPENER BY HOMELINK® KIT

P/N 2881814



APPLICATION

All 2015 and newer Slingshot® models

BEFORE YOU BEGIN

Read these instructions and check to be sure all parts and tools are accounted for. Please retain these installation instructions for future reference and parts ordering information.

DISCLAIMER ACCESSORY WEIGHT

When adding accessories, equipment, passengers and luggage to your vehicle, do not exceed the total weight capacity of the vehicle or of the front or rear axle (GVWR or GAWR as indicated on the Safety Compliance Certification label). Ask an authorized dealer for specific weight information if you need assistance. It is the owner's responsibility to use the Polaris Slingshot Accessories website as a tool for limiting the amount of accessories, based on maximum allowable vehicle weight requirements. It may be a violation of the Clean Air Act or the NHTSA regulations to disregard these requirements. For a complete listing of the accessories that are available for your vehicle, please contact your authorized dealer or visit the online store web site:

Web Address (United States): <http://www.polaris.com/en-us/slingshot/shop/accessories>.

KIT CONTENTS

This kit contains parts for installation of Garage Door Opener by HomeLink® Kit for 2015 – 2017 Slingshot® models only. For 2018 and newer Slingshot® models, full installation will also require Garage Door Opener Harness Kit PN 2883417 (sold separately).

This Kit includes:

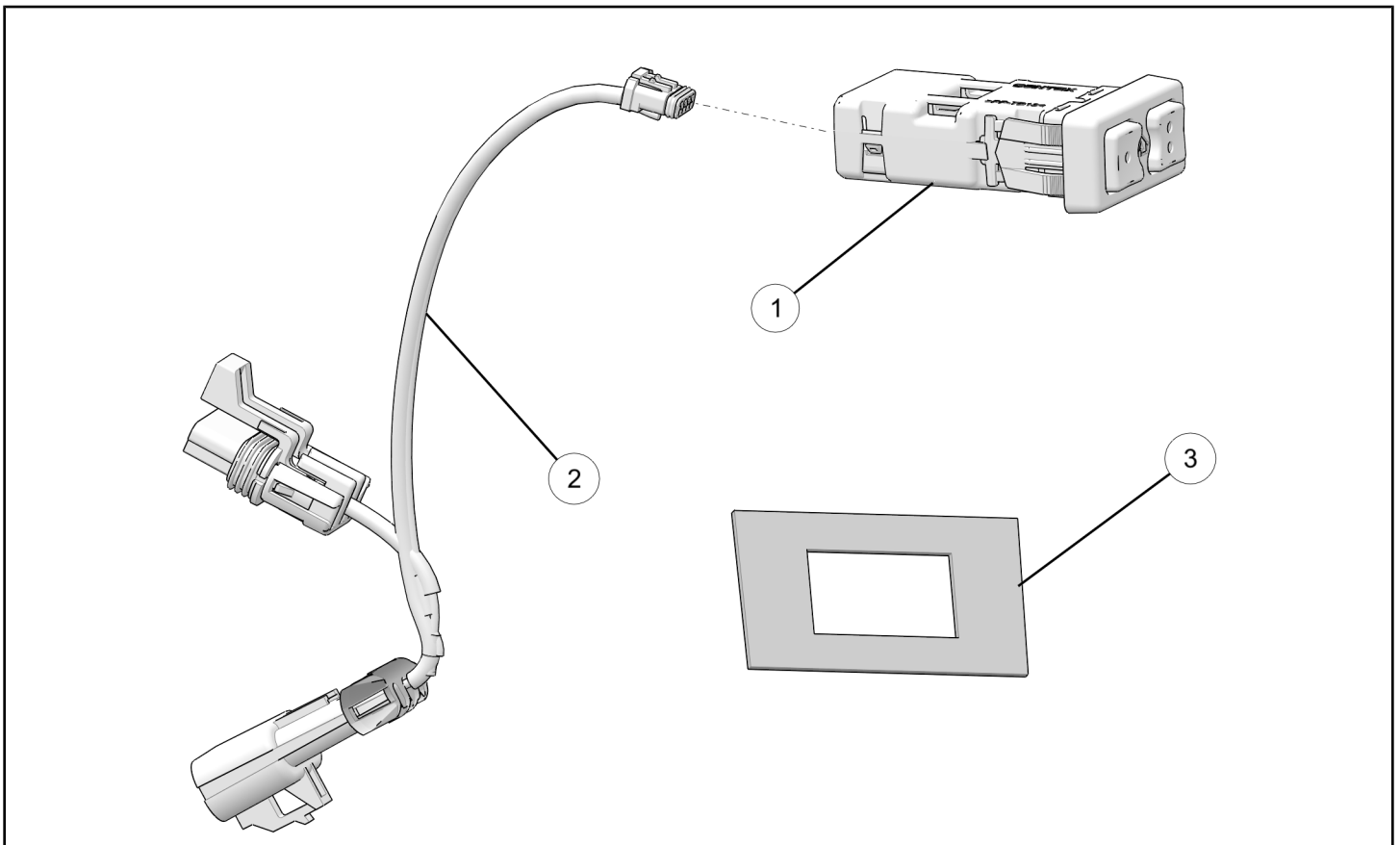

REF	QTY	PART DESCRIPTION	PART NUMBER
1	1	Garage Door Opener Module	4015371
2	1	Garage Door Opener Harness	2413773
3	1	Garage Door Opener Template	5263676
	1	Instructions	9927730

TOOLS REQUIRED

- Drill
- Hex Key Set, Metric
- Tape
- Drill bit: 1/4 in. (6 mm)

IMPORTANT

Your Garage Door Opener by HomeLink® Kit is exclusively designed for your vehicle. Please read the installation instructions thoroughly before beginning. Installation is easier if the vehicle is clean and free of debris. For your safety, and to ensure a satisfactory installation, perform all installation steps correctly in the sequence shown.

ASSEMBLY TIME

Approximately 20 minutes

INSTALLATION INSTRUCTIONS

1. Shift vehicle transmission to NEUTRAL. Turn key to OFF position and remove from vehicle

Apply parking brake.

HOMELINK® INSTALLATION

1. Place garage door opener template ③ on dash ① and secure in place with tape.

Mark four holes inside each corner of stencil and drill using 1/4 in. (6 mm) drill bit. Use caution not to rub drill on dashboard pieces.

Once holes are drilled, use small cutting tool to connect four drilled corners. Avoid edges of dashboard pieces when cutting.

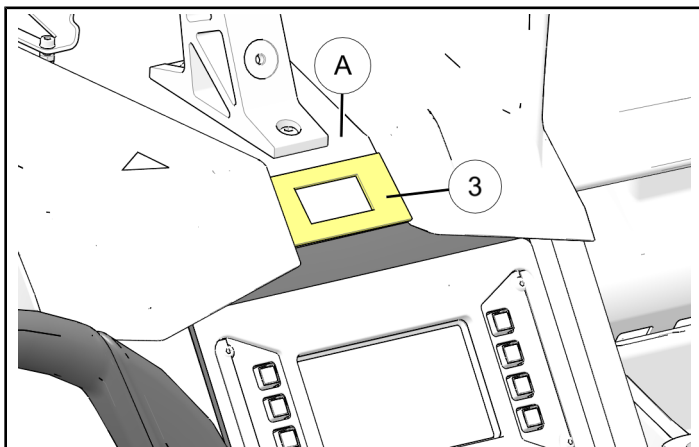

2. Connect garage door opener harness ② to garage door opener module ①.

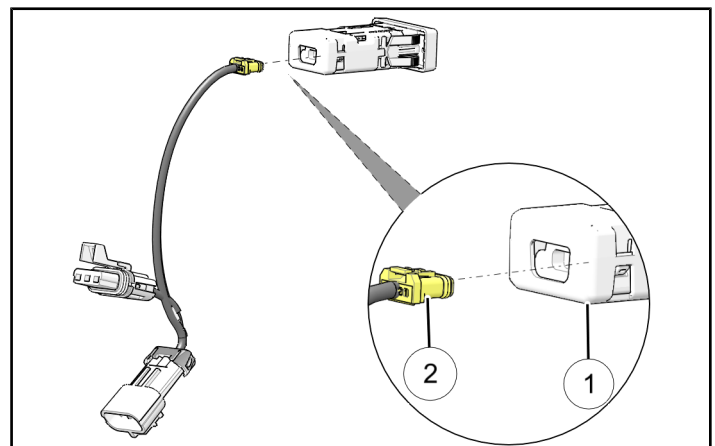

3. Route garage door opener harness through opening created in **Step 1** before installing garage door opener module ① in same opening.

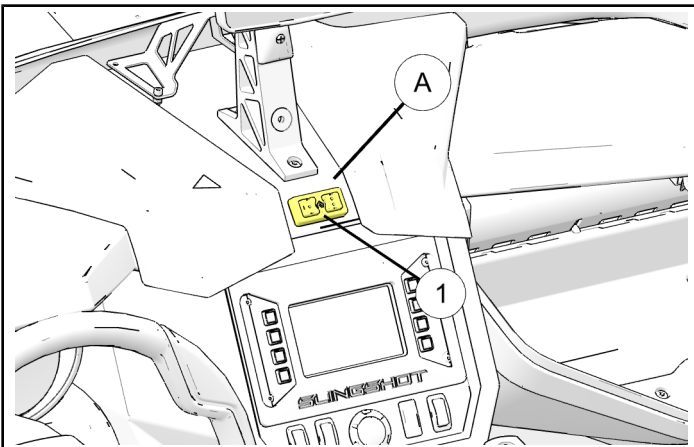
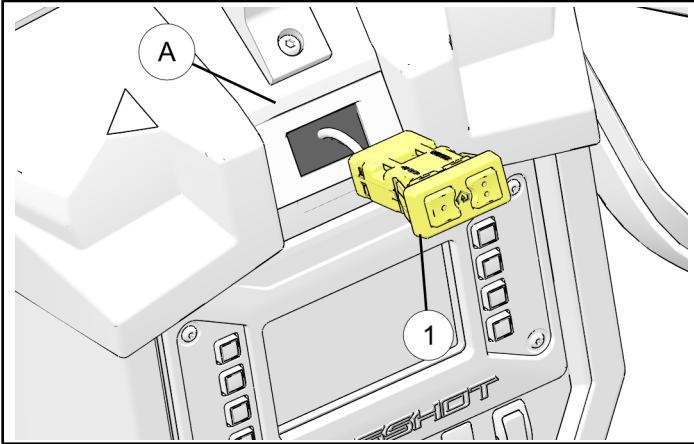

4. If installing on vehicle model year 2018 or newer, proceed to Kit Instructions for kit PN 2883417.

If installing on vehicle model year 2014 to 2017, continue on to **step 5**.

5. Remove and retain four screws ②, and infotainment assembly ③ with wires still attached. Rest infotainment assembly ③ carefully on center console where it will not be damaged.

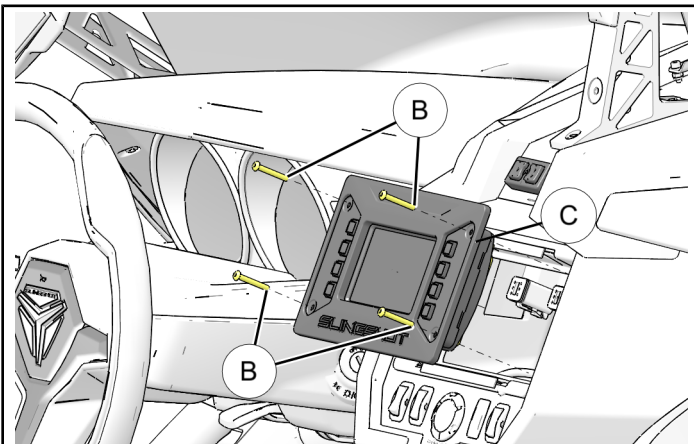

6. Carefully pull up on tab of electrical harness connector ④ to disconnect infotainment harness connector ⑤ from electrical harness ④ connector.

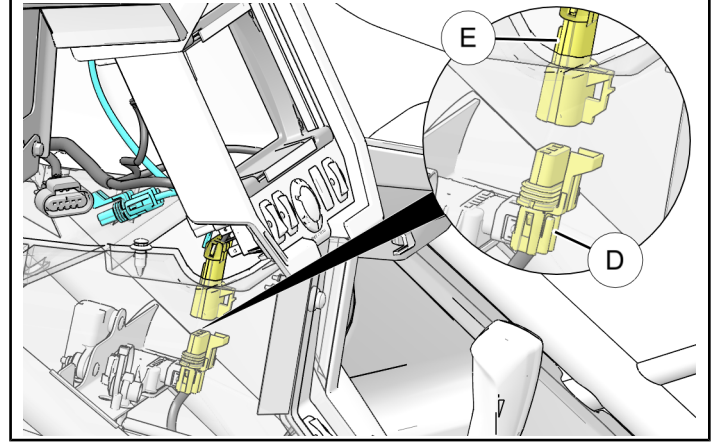

7. Connect infotainment harness connector ⑤ to garage door opener harness connector ⑥. Connect electrical harness connector ④ to garage door opener harness connector ⑦.

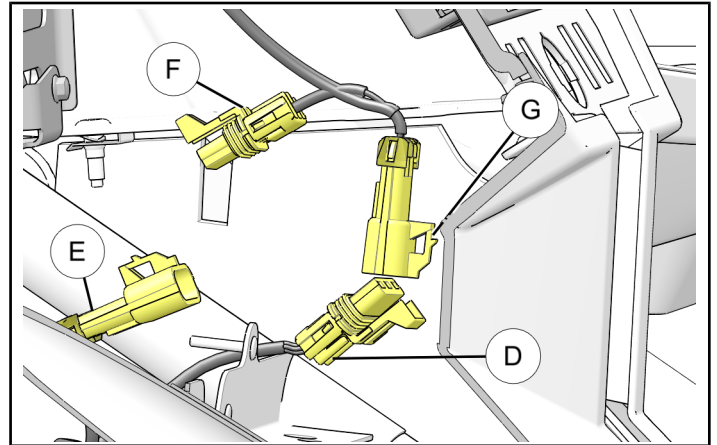

8. Reinstall infotainment assembly ③, and four retained screws ② removed in **Step 5** of this section.

Torque four bezel mounting screws ② to specification.

TORQUE

2015-2017: 36 in. lbs (4 Nm)

PROGRAMMING 2-BUTTON HOMELINK®

CAUTION

Before programming HomeLink® to garage door opener or gate operator, ensure that people and objects are out of way of device to prevent potential harm or damage. Garage door or gate will open and close while programming HomeLink®. Do not program HomeLink® if people or pets are in path of door or gate. Moving garage door or gate can cause serious injury or death to people and pets or damage to objects.

Vehicle exhaust contains carbon monoxide, dangerous gas. Do not run vehicle's engine while programming HomeLink®. Exhaust gas can cause serious injury or death. When programming garage door opener, it is advised to park outside of garage.

Do not use HomeLink® with any garage door opener that lacks safety stop and reverse features as required by U.S. federal safety standards (this includes any garage door opener model manufactured before April 1, 1982). Garage door that cannot detect object signaling door to stop and reverse - does not meet current U.S. federal safety standards.

BEFORE PROGRAMMING HOMELINK®

- Garage door opener, gate, or other device may operate during programming process. Ensure surrounding area is clear of people or objects to prevent injury or damage.
- Using new garage door remote batteries is recommended for most accurate programming.
- Garage door openers manufactured after 1995 may be equipped with rolling code protection. Stepladder may be needed to reach **Learn** or **Smart** button on garage door opener.
- Instructions below apply to majority of HomeLink® use cases. Some HomeLink® applications or HomeLink® compatible systems may require slightly different instructions. Please visit <http://www.HomeLink.com/2-button> for device specific instructions.

PROGRAMMING BRAND NEW HOMELINK®

ROLLING CODE PROGRAMMING

1. Sommer® Garage Door Opener ONLY

NOTE

If programming two devices, and only one is Sommer®, program Sommer® unit first.
Follow **Reprogramming Single HomeLink® Button** instructions for second device.

- a. Press and hold both HomeLink® buttons for 20 seconds, until LED turns off. HomeLink® is now ready to be programmed to Sommer® rolling code opener garage door.
- b. Continue programming with **Step 3 of this section**.

2. Standard Garage Door Opener

- a. At garage door opener in garage, locate **Learn** or **Smart** button (usually near where hanging antenna wire is attached to unit). If there is difficulty locating **Learn** or **Smart** button, reference garage door opener's manual.
- b. Press and release **Learn** or **Smart** button (name and color of button may vary by manufacturer).

NOTE

Once button is pressed, there are typically about 10 – 20 seconds in which to initiate next step.

- c. Continue programming with **Step 3 of this section**.
3. At vehicle, press and release programmed HomeLink® button. Repeat press and release sequence up to 3 times to complete training process. HomeLink® should now activate rolling code equipped device.
 4. To program additional HomeLink® buttons, repeat this process.
 5. Once programmed, both HomeLink® and/or original garage door remote may be used to activate device (e.g. garage door, entry lock, gate, etc.).

NON-ROLLING CODE PROGRAMMING

1. Position garage door remote 1 – 3 inches away from HomeLink® buttons, keeping HomeLink® indicator light in view.
2. Garage Door Opener and Entry Gate Programming
 - **Garage Door Opener Programming**
 - a. Using both hands, simultaneously press and hold both desired HomeLink® button and garage door remote button. **DO NOT** release until HomeLink® indicator light flashes slowly and then changes to solid or rapidly flashing. Change in flashing indicates frequency signal has been learned.
 - b. Continue programming with **Step 3 of this section.**
 - **Entry Gate Programming**

NOTE

Some gate operators and garage door openers may require “cycling” procedure.

- a. Using both hands, hold HomeLink® button continuously, while simultaneously pressing and releasing garage door remote button at 2 second intervals. **DO NOT** release until HomeLink® indicator light flashes slowly and then changes to solid or rapidly flashing. Change in flashing indicates frequency signal has been learned.
 - b. Continue programming with **Step 3 of this section.**
3. Press and hold programmed HomeLink® button and observe indicator light.
 - If indicator light is solid/continuous, programming is complete and device should activate when HomeLink® button is pressed and released.
 - If indicator light blinks rapidly, proceed with instructions listed in **Rolling Code Programming** section.
 - Second person may make following steps quicker and easier.
 - Use stepladder or other stable, safe device.

REPROGRAMMING HOMELINK® BUTTON

When following procedure is performed, buttons which are already programmed can be overwritten:

1. Press and hold desired HomeLink® button. After about 20 seconds, HomeLink® indicator will start slowly flashing.
2. Continue with **Rolling Code Programming** or **Non-Rolling Code Programming** section.

ERASING HOMELINK® PROGRAMMING (BOTH BUTTONS)

1. Press and hold both buttons for 10 seconds until HomeLink® indicator light changes from solid to flashing indicator.

IMPORTANT

If vehicle is sold, erase HomeLink® programming.

FOR FURTHER ASSISTANCE

To view custom training videos and instructions for major garage door brands, gates, and other HomeLink® compatible products, visit <http://www.HomeLink.com/>.

FCC (USA) AND IC (CANADA)

This device complies with FCC rules part 15 and Industry Canada RSS-210. Operation is subject to following two conditions:

1. This device may not cause harmful interference.
2. This device must accept any interference that may be received including interference that may cause undesired operation.

⚠ WARNING

Transmitter has been tested and complies with FCC and IC rules. Changes or modifications not expressly approved by party responsible for compliance could void user's authority to operate device.

This equipment complies with FCC radiation exposure limits set forth for uncontrolled environment. End Users must follow specific operating instructions for satisfying RF exposure compliance. This transmitter must be at least 20cm from user and must not be co-located or operating in conjunction with any other antenna or transmitter.

Term "IC:" before certification/registration number only signifies that Industry Canada technical specifications were met.

FEEDBACK FORM

A feedback form has been created for the installer to provide any comments, questions or concerns about the installation instructions. The form is viewable on mobile devices by scanning the QR code or by clicking [HERE](#) if viewing on a PC.

FCC (USA) AND IC (CANADA)

Cet appareil est conforme aux normes FCC partie 15 des règles et Industrie Canada RSS-210. Son fonctionnement est soumis aux deux conditions suivantes:

1. Ce dispositif ne peut causer des interférences nuisibles, et
2. Cet appareil doit accepter toute interférence qui peuvent être reçues, y compris les interférences qui peuvent provoquer un fonctionnement indésirable.

⚠ WARNING

L'émetteur a été testé et est conforme aux règles de la FCC et IC. Les changements ou modifications non expressément approuvés par la partie responsable de la conformité pourraient annuler l'autorité de l'utilisateur à utiliser l'appareil.

Cet équipement est conforme aux limites FCC d'exposition aux radiations définies pour un environnement non contrôlé. Les utilisateurs finaux doivent suivre les instructions de fonctionnement spécifiques pour satisfaire aux normes d'exposition aux RF. Cet émetteur doit être d'au moins 20cm de l'utilisateur et ne doit pas être co-située ni fonctionner en conjonction avec une autre antenne ou émetteur.

Le terme "IC:" devant le numéro de certification / enregistrement signifie seulement que les spécifications techniques d'Industrie Canada ont été respectées.

FEEDBACK FORM

