

DEAD PEDAL KIT



SLINGSHOT

P/N 2884947

BEFORE YOU BEGIN

Read these instructions and check to be sure all parts and tools are accounted for. Please retain these installation instructions for future reference and parts ordering information.

APPLICATION

Slingshot® models with AutoDrive transmission.

Verify accessory fitment at www.polarisslingshot.com.

DISCLAIMER ACCESSORY WEIGHT

When adding accessories, equipment, passengers and luggage to your vehicle, do not exceed the total weight capacity of the vehicle or of the front or rear axle (GVWR or GAWR as indicated on the Safety Compliance Certification label). Ask an authorized dealer for specific weight information if you need assistance. It is the owner's responsibility to use the Polaris Slingshot Accessories website as a tool for limiting the amount of accessories, based on maximum allowable vehicle weight requirements. It may be a violation of the Clean Air Act or the NHTSA regulations to disregard these requirements. For a complete listing of the accessories that are available for your vehicle, please contact your authorized dealer or visit the online store web site: Web Address (United States): <http://www.polaris.com/en-us/slingshot/shop/accessories>.

KIT CONTENTS

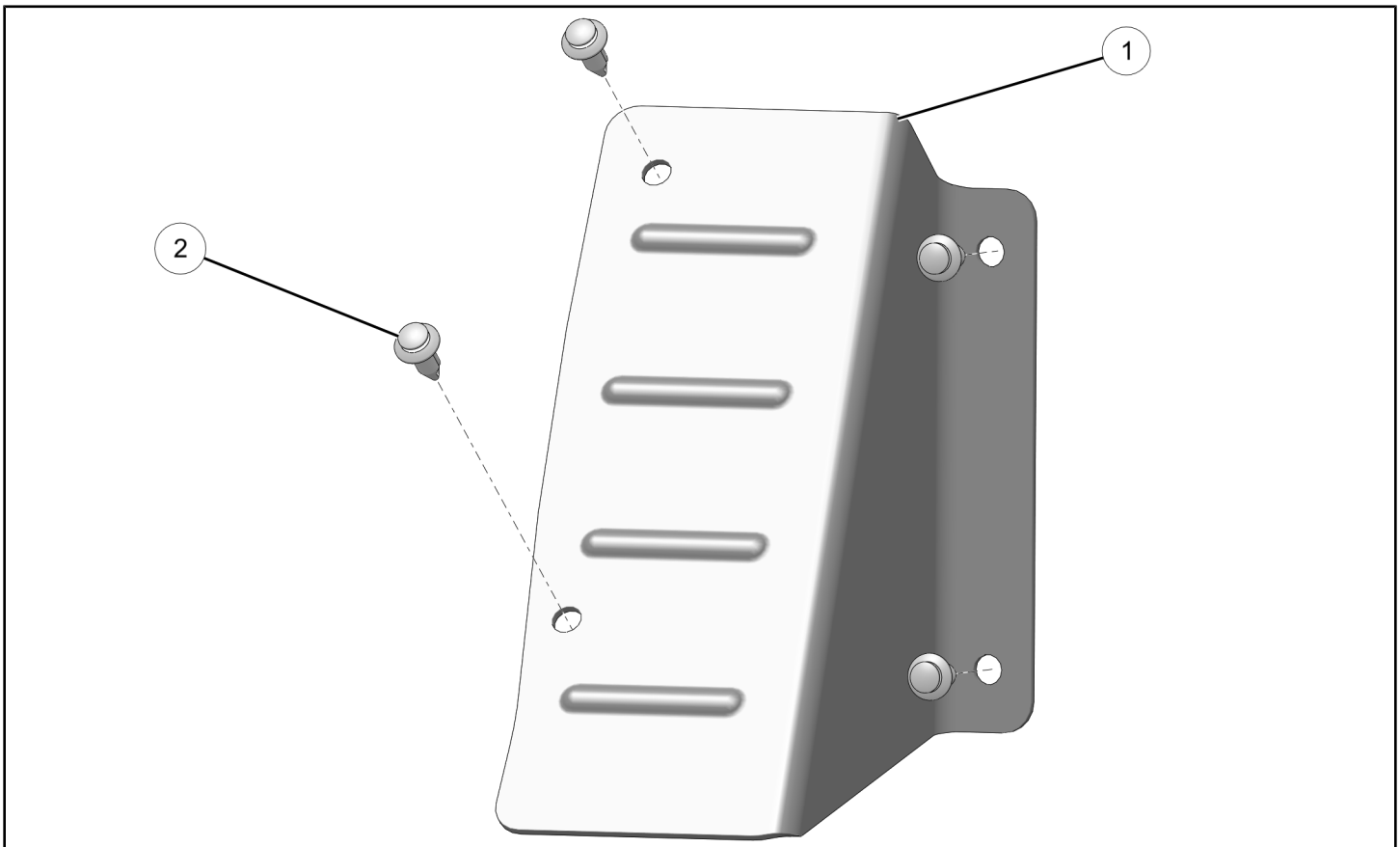

REF	QTY	PART DESCRIPTION	P/N AVAILABLE SEPARATELY
1	1	Footrest, Accessory	n/a
2	4	Rivet – Push-Pin .315–.325 x .787	7661855

TOOLS REQUIRED

- Safety Glasses
- Drill
- Drill Bit:
 - 5/16 in (8.5 mm)
- Flashlight
- Hammer, Soft Face
- Marking Tool
- Push Dart (Panel Clip) Tool

IMPORTANT

Your Dead Pedal Kit is exclusively designed for your vehicle. Please read the installation instructions thoroughly before beginning. Installation is easier if the vehicle is clean and free of debris. For your safety, and to ensure a satisfactory installation, perform all installation steps correctly in the sequence shown.

INSTALLATION INSTRUCTIONS

VEHICLE PREPARATION

GENERAL

1. Park vehicle on a flat surface.
2. Shift vehicle to NEUTRAL.
3. Press START/STOP button to turn vehicle OFF.
4. Set parking brake.
5. Remove key fob from proximity of vehicle.

ACCESSORY INSTALLATION

MODEL YEAR 2020 AND OLDER

1. Set Dead Pedal ① on the floor board.

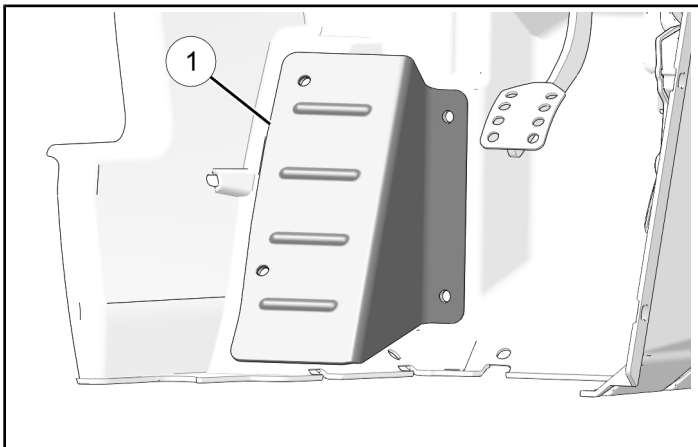

2. Mark the four holes. Drill the marked holes, keeping the drill perpendicular to the floor board surface.

IMPORTANT

Control tool depth. Make sure tool is clear of all other parts and components to prevent damage to vehicle.

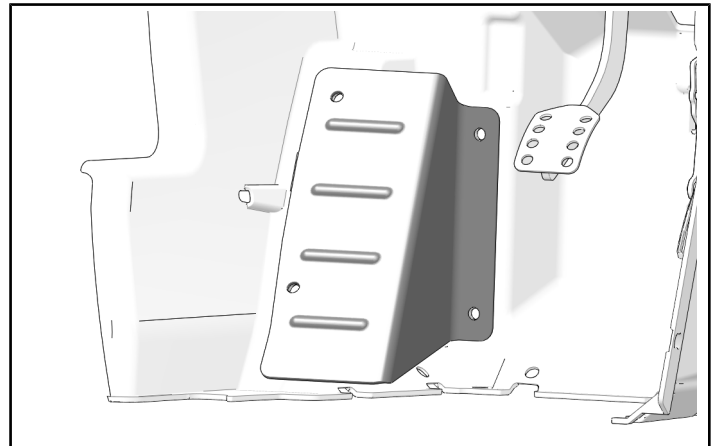

ALL MODELS

1. Set Dead Pedal ① in position. Insert a push pin rivet ② into each hole. If necessary, lightly tap into place with a soft face hammer.

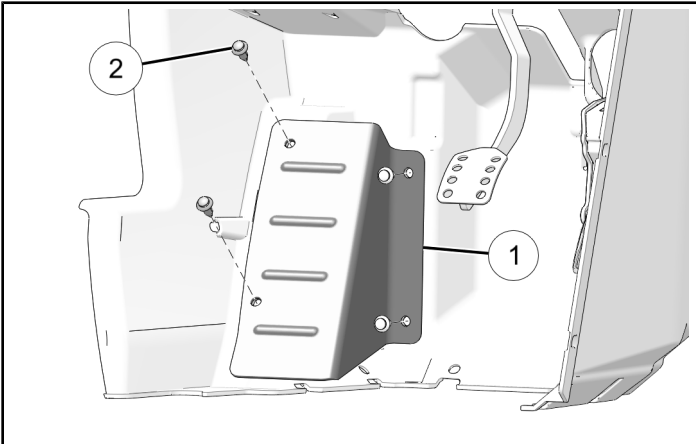

INSTRUCTION FEEDBACK FORM

A feedback form has been created for the installer to provide any comments, questions or concerns about the installation instructions. The form is viewable on mobile devices by scanning the QR code or by clicking [HERE](#) if viewing on a PC.

