

HIGH FLOW AIR INTAKE KIT



SLINGSHOT

P/N 2882330

APPLICATION

All Slingshot Models

BEFORE YOU BEGIN

Read these instructions and check to be sure all parts and tools are accounted for. Please retain these installation instructions for future reference and parts ordering information.

DISCLAIMER ACCESSORY WEIGHT

When adding accessories, equipment, passengers and luggage to your vehicle, do not exceed the total weight capacity of the vehicle or of the front or rear axle (GVWR or GAWR as indicated on the Safety Compliance Certification label). Ask an authorized dealer for specific weight information if you need assistance. It is the owner's responsibility to use the Polaris Slingshot Accessories website as a tool for limiting the amount of accessories, based on maximum allowable vehicle weight requirements. It may be a violation of the Clean Air Act or the NHTSA regulations to disregard these requirements. For a complete listing of the accessories that are available for your vehicle, please contact your authorized dealer or visit the online store web site:

Web Address (United States): <http://www.polaris.com/en-us/slingshot/shop/accessories>.

KIT CONTENTS

This Kit includes:

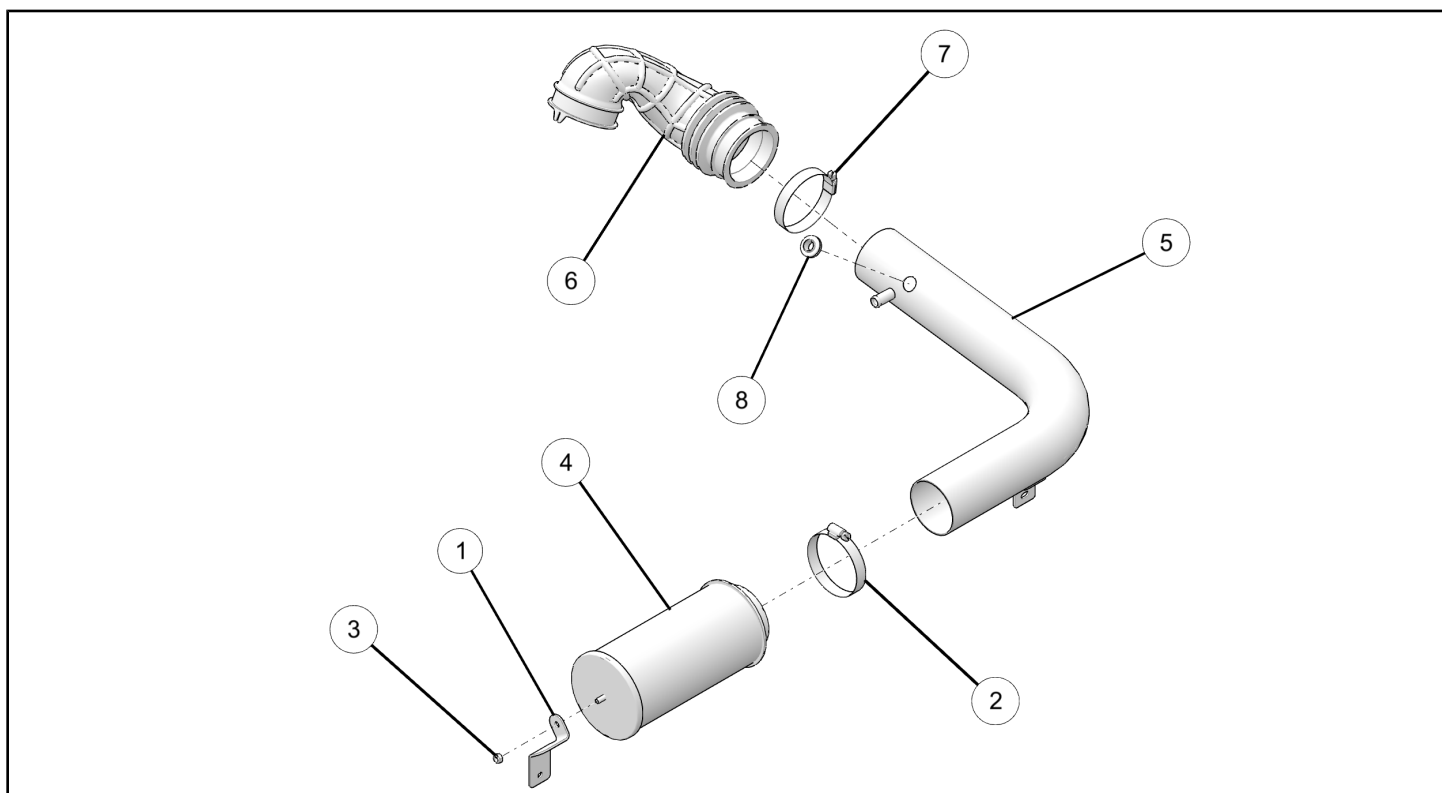

REF	QTY	PART DESCRIPTION	PART NUMBER
1	1	Intake Bracket	5263304
2	1	Hose Clamp	7081831
3	1	Nut - 6mm X 1	7546703

REF	QTY	PART DESCRIPTION	PART NUMBER
4	1	Air - Filter	7082138
5*	1	Intake Pipe	5339862
6*	1	Air Intake Hose	5415896
7*	1	Hose Clamp	7081831
8*	1	Sensor Grommet	5416011
	1	Instructions	9927592

Items marked (*) are included in Intake Hose Assembly (PN 1241103).

TOOLS REQUIRED

- M10 Wrench
- Flat Head Screw Driver
- Torque Wrench
- Pliers
- Safety Glasses

IMPORTANT

Your HIGH FLOW AIR INTAKE KIT is exclusively designed for your vehicle. Please read the installation instructions thoroughly before beginning. Installation is easier if the vehicle is clean and free of debris. For your safety, and to ensure a satisfactory installation, perform all installation steps correctly in the sequence shown.

ASSEMBLY TIME

Approximately 45 minutes

INSTALLATION INSTRUCTIONS

REMOVAL OF STOCK AIR INTAKE

1. Put the transmission in "NEUTRAL" and turn the key to the "OFF" position. Remove the key from vehicle. Apply the parking brake.
2. Open the hood (A) using latch (B) located in front of vehicle between the middle set of lights. Pull rearward and up to get the hood to open.

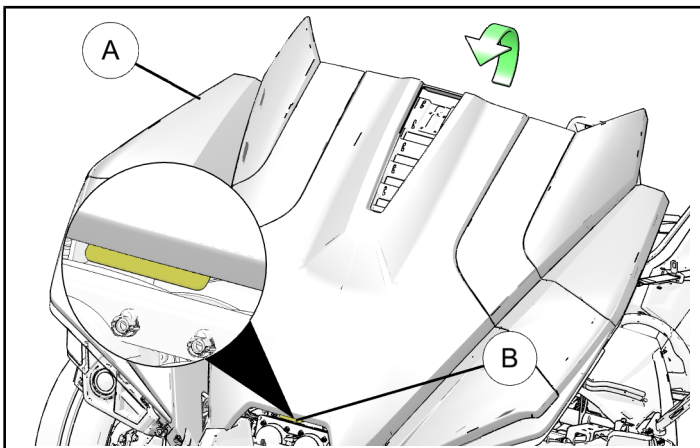

3. Remove air temperature sensor (C) located on the rubber air intake pipe (D) by pulling firmly on its base.

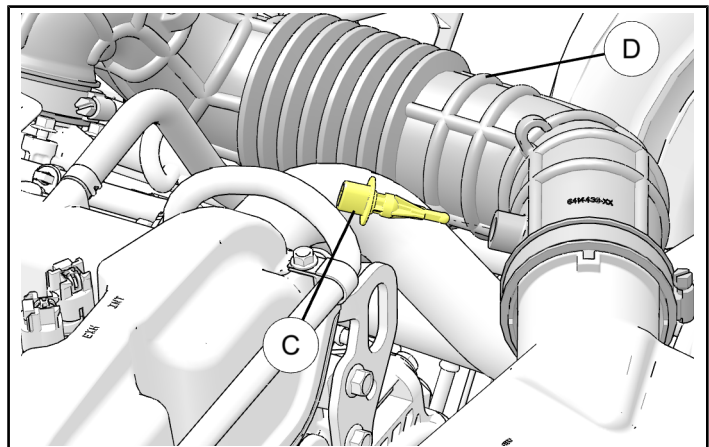

4. Disconnect small diameter rubber breather hose (F) that goes into the rubber air intake pipe (D) by removing hose spring clamp (E) using pliers and firmly pulling. Leave this hose connected on the engine side. It will be installed to new high flow air intake assembly.

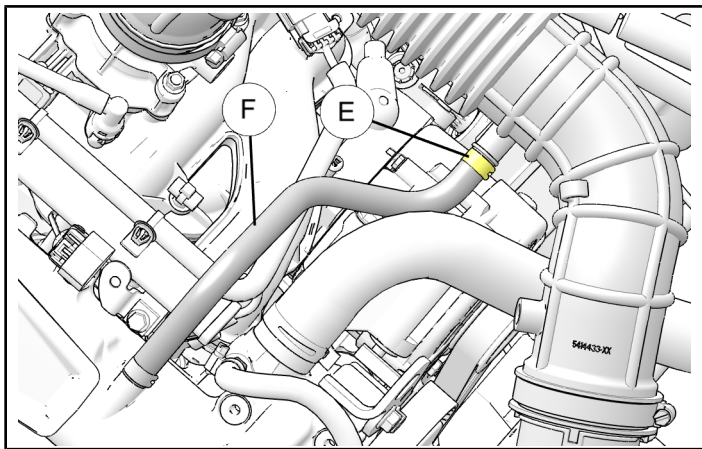

5. Using M10 Wrench remove three bolts (G) securing stock air box (H).

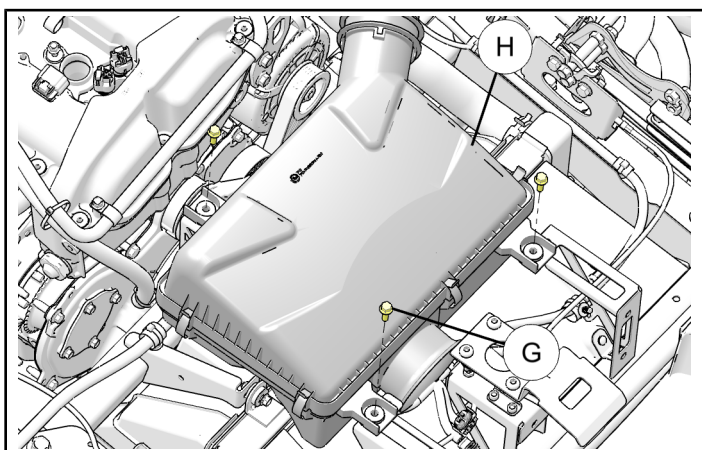

6. Using a screw driver loosen pipe clamp (J) around the rubber pipe (D) located at the engine side. Retain clamp (J) for reinstallation.

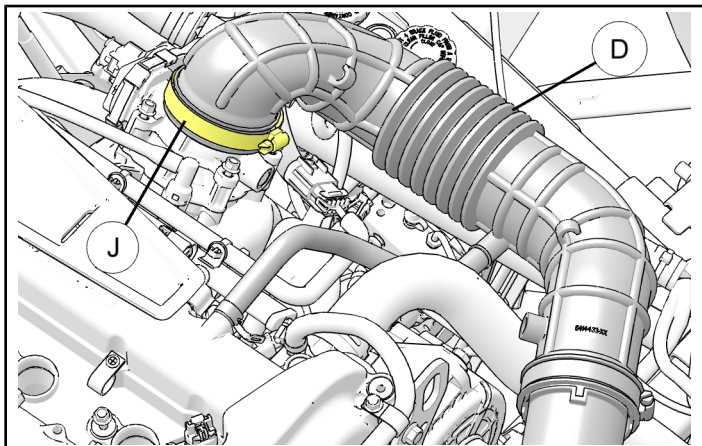

7. Remove stock air intake system.

PRE ASSEMBLE HIGH FLOW AIR INTAKE

1. Slide hose clamps (2) and (7) on either side of metal intake pipe (5). Do not tighten at this time.

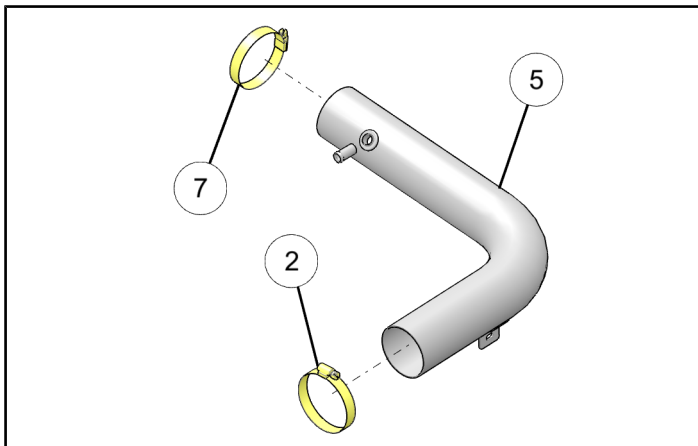

2. Slide air filter (4) on to metal air intake pipe (5). Position air filter so that only its rims sits on pipe, pipe should not protrude into air filter chamber. Slide pipe clamp (2) over edge of air filter as shown. Tighten pipe hose clamp (2) to specification.

TORQUE

35 in. lbs. (3.95 Nm)

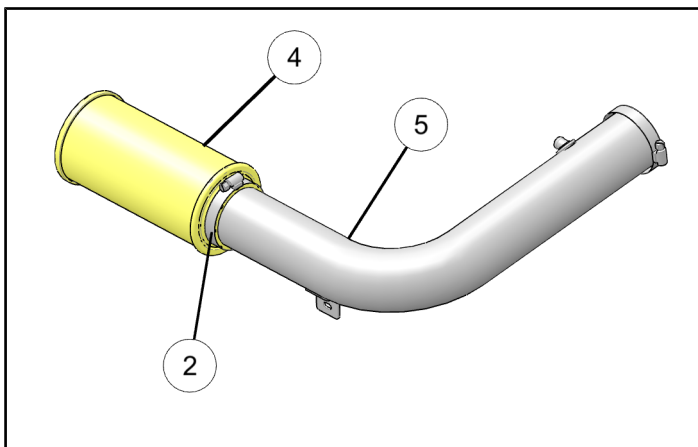

3. Install mounting bracket ① on end of air filter ④ by aligning hole on the bracket with bolt on air filter assembly as shown. Install nut ③ onto the bracket ①. Hand tighten nut ③ at this time.

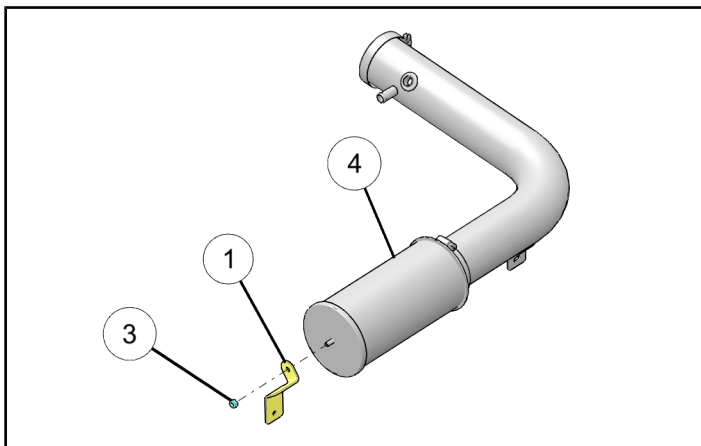

INSTALL HIGH FLOW AIR INTAKE

1. Using 10mm wrench remove two bolts (K) at the top of radiator (L).

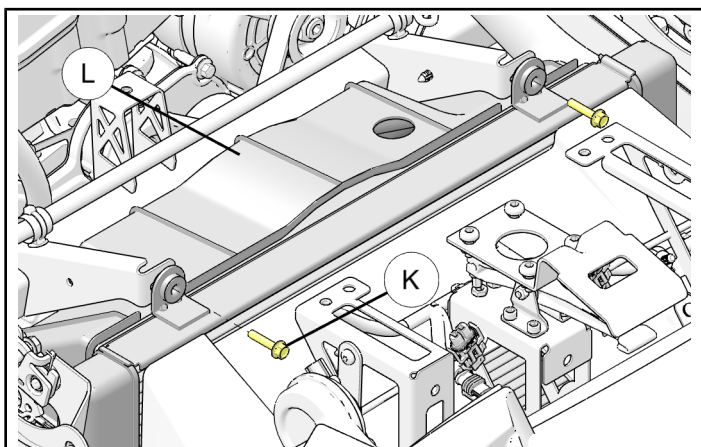

2. Align high flow air intake mounting tabs (M) with radiator (L) holes. High flow air intake goes at the front of radiator tabs as shown.

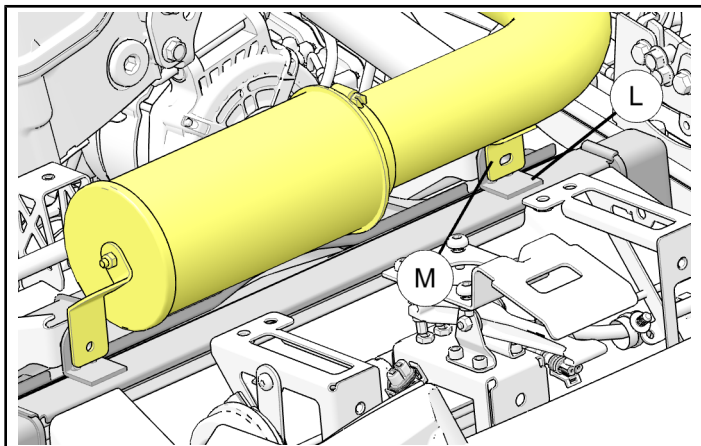

3. Reinstall radiator bolts (K). Torque bolts to specification.

TORQUE

8 ft. lbs. (10.84 Nm)

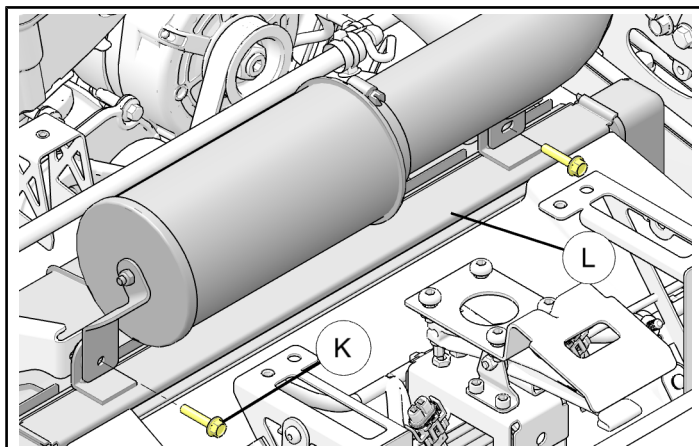

4. Properly align and position air intake mounting tab at end of air filter ④. Using 10mm wrench tighten nut ③ to specification.

TORQUE

40 in. lbs. (4.51 Nm)

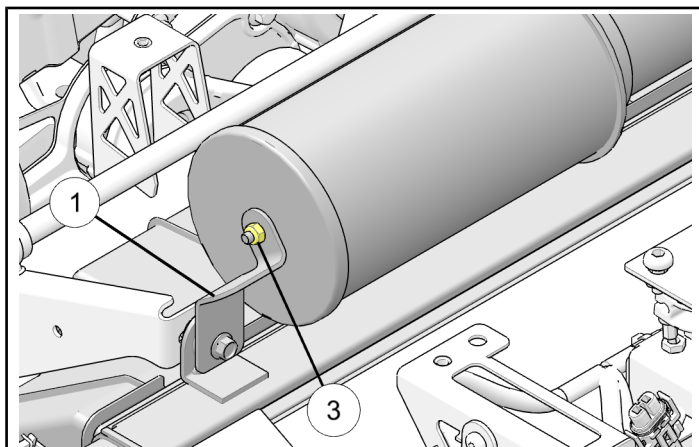

5. Install rubber hose ⑥ of air intake on to engine side and to the intake pipe ⑤ as shown.

NOTE

The rubber hose has alignment feature (circled below) on engine side mounting.

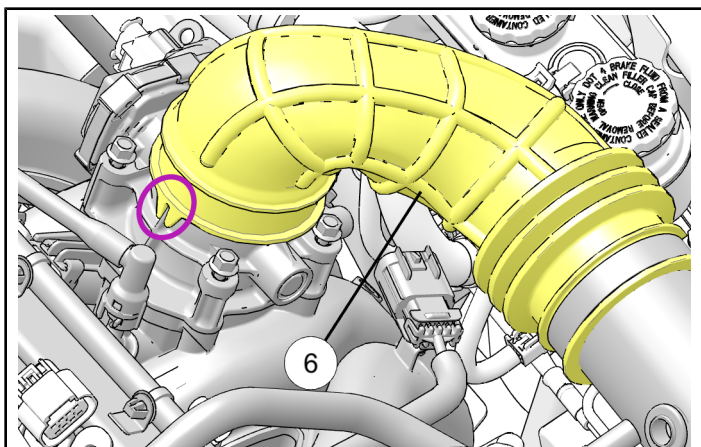

6. Position hose clamps (J) and ⑦ into ribs of rubber hose ⑥ and torque to specification.

TORQUE

35 in. lbs. (3.95 Nm)

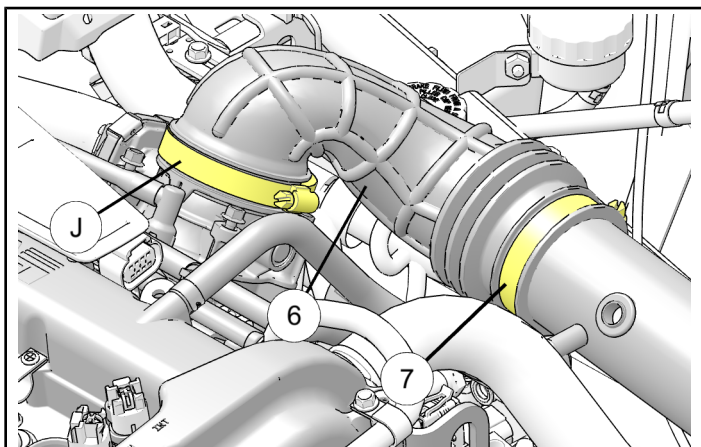

7. Reinstall air temperature sensor (C) by pushing it through rubber grommet ⑧.

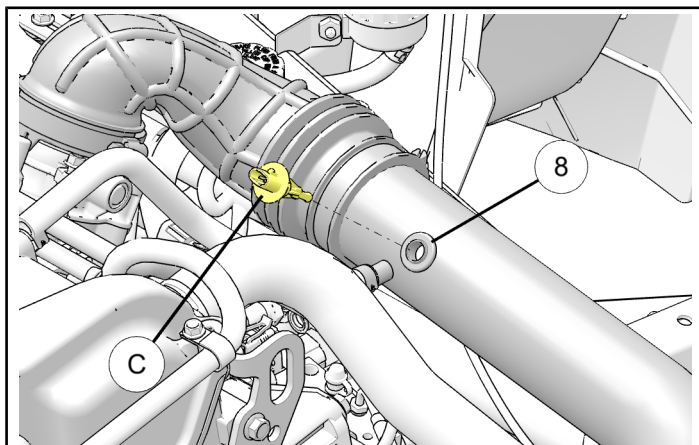

8. Reinstall breather hose (F) using pliers to compress the hose spring clamp (E) and firmly pushing on to the pipe nipple.

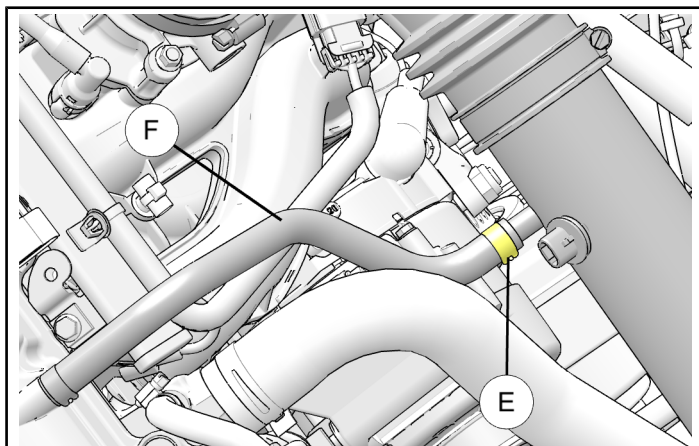

9. Close the hood (A) and ensure it latches.