

SLR WHEEL KIT



P/N 2882340

SLINGSHOT

APPLICATION

Slingshot

BEFORE YOU BEGIN

Read these instructions and check to be sure all parts and tools are accounted for. Please retain these installation instructions for future reference and parts ordering information.

DISCLAIMER ACCESSORY WEIGHT

When adding accessories, equipment, passengers and luggage to your vehicle, do not exceed the total weight capacity of the vehicle or of the front or rear axle (GVWR or GAWR as indicated on the Safety Compliance Certification label). Ask an authorized dealer for specific weight information if you need assistance. It is the owner's responsibility to use the Polaris Slingshot Accessories website as a tool for limiting the amount of accessories, based on maximum allowable vehicle weight requirements. It may be a violation of the Clean Air Act or the NHTSA regulations to disregard these requirements. For a complete listing of the accessories that are available for your vehicle, please contact your authorized dealer or visit the online store web site:

Web Address (United States): <http://www.polaris.com/en-us/slingshot/shop/accessories>.

KIT CONTENTS

This Kit includes:

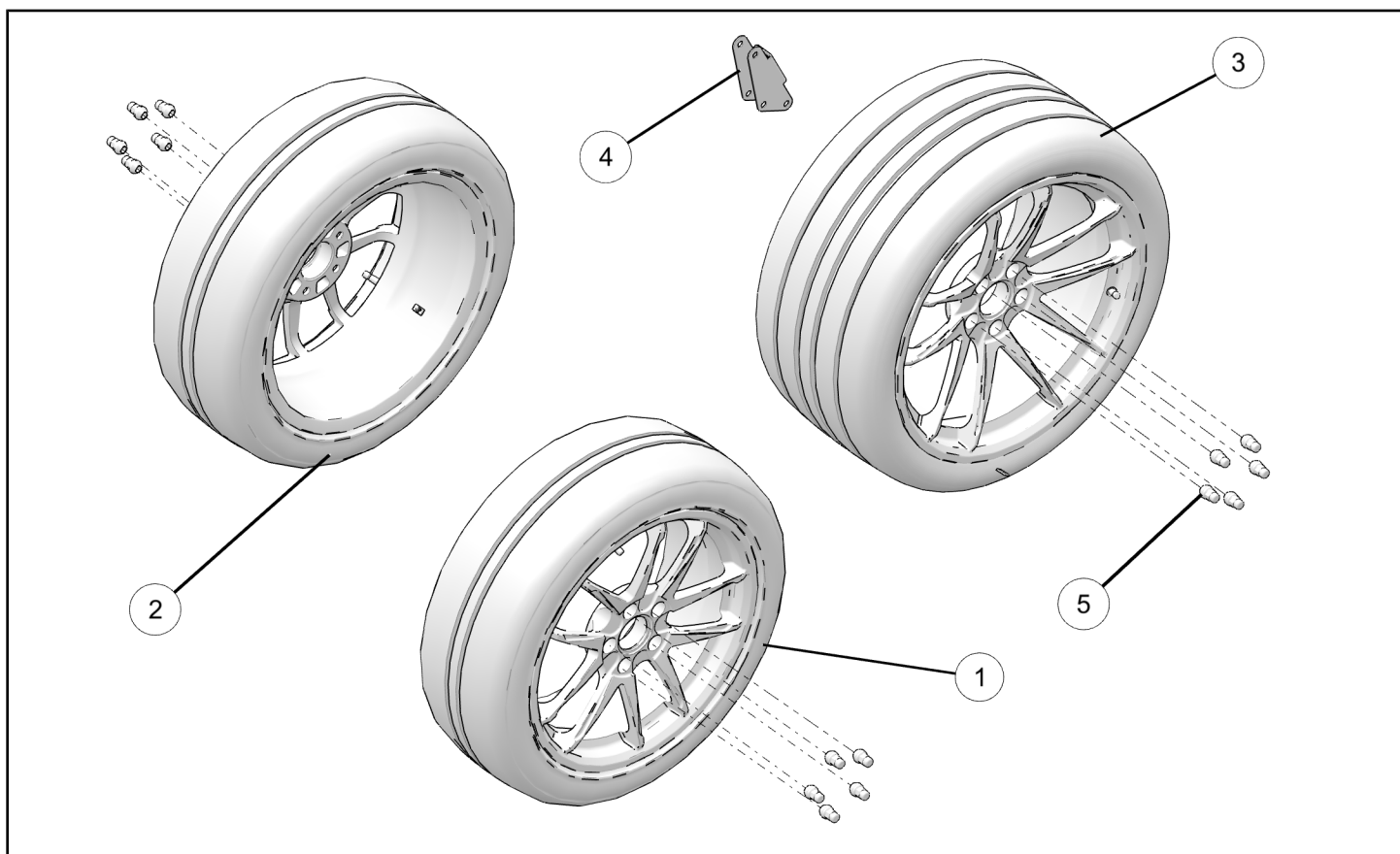

REF	QTY	PART DESCRIPTION	PART NUMBER
1	1	Front Tire/Wheel Assembly, LH	1522878
2	1	Front Tire/Wheel Assembly, RH	1522879
3	1	Rear Tire/Wheel Assembly	1522880
4	1	Rear Shock Clevis, 20"	5139610
5	15	Lug Nut, M12 X 1.25	7547510
	1	Instructions	9927607

TOOLS REQUIRED

- Safety Glasses
- 17mm Wrench
- Torque Wrench
- Floor Lift
- T40 Torx®
- 15mm Wrench

IMPORTANT

Your SLR WHEEL KIT is exclusively designed for your vehicle. Please read the installation instructions thoroughly before beginning. Installation is easier if the vehicle is clean and free of debris. For your safety, and to ensure a satisfactory installation, perform all installation steps correctly in the sequence shown.

ASSEMBLY TIME

Approximately 30 minutes

INSTALLATION INSTRUCTIONS

IMPORTANT

Upon installation, the electronic stability control software must be reset. For additional information, reference the important note below "STABILITY CONTROL VARIANT PROGRAMMING" section.

1. Put the transmission in "NEUTRAL" and turn the key to the "OFF" position. Remove the key from vehicle. Apply the parking brake.
2. Remove belt cover (B) by removing two screws (A) using T40 Torx®.

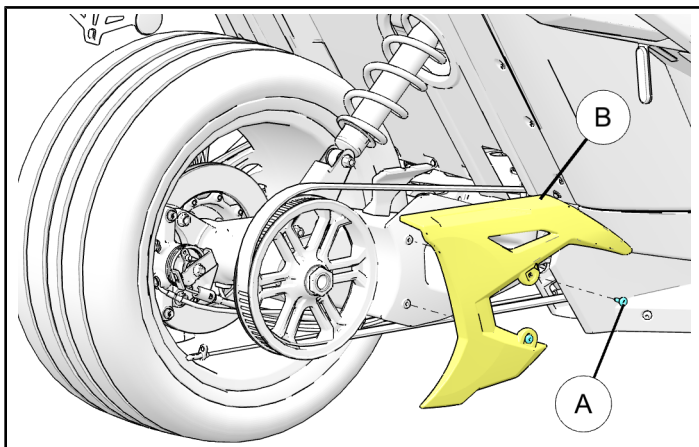

3. Using 17mm wrench, break five rear wheel lug nuts (C) by slightly loosening nuts before lifting the vehicle. Follow the same for front wheels.

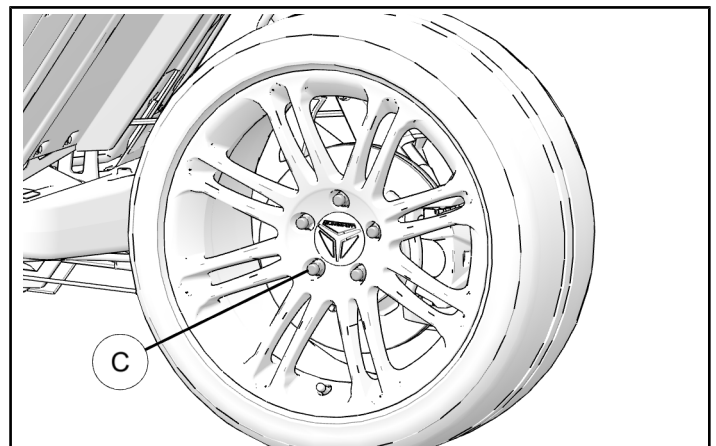

CLEVIS REMOVAL AND INSTALLATION

NOTE

The below step can be skipped if the vehicle already has 20" wheels/clevis.

1. Using 17mm wrench remove one upper nut (D) and two lower nuts (E) from clevis bolts (F) (G) as shown. Rotate sprockets to access lower nuts. Retain fasteners for re-installation.

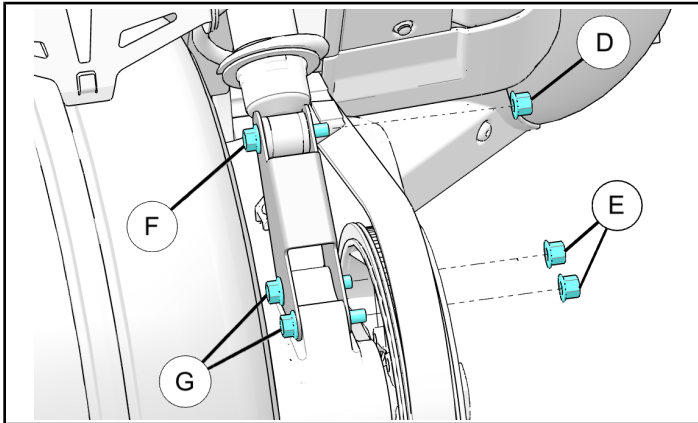

2. Use floor lift to slowly lift rear of the vehicle. Continuously check clevis bolts, at certain height all bolts will become loose. Leave floor jack at this height and remove three bolts (F) and (G). Retain fasteners for re-installation. Refer to "Lift Placement" section on last page of the instructions for proper lift placement.

⚠ WARNING

Serious injury may result if the vehicle tips or falls. Be sure the vehicle is secure before beginning wheel removal and installation processes. Always wear eye protection.

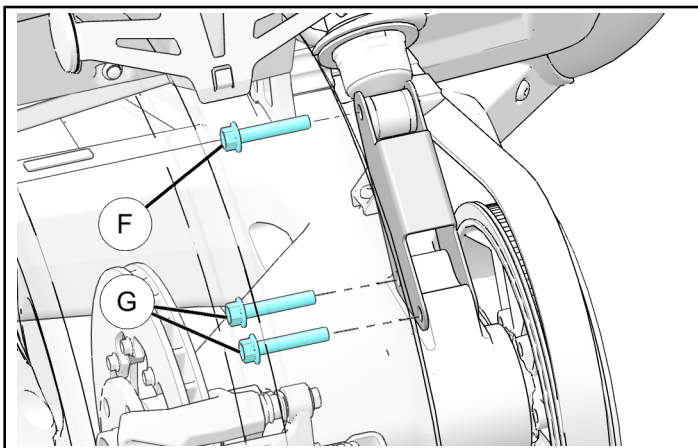

3. Position the premium lower shock clevis (4) onto the swingarm and install two bolts (G) and nuts (E) using 15mm wrench. Torque bolts to specification using torque wrench.

TORQUE

50 ft. lbs. (67.8 Nm)

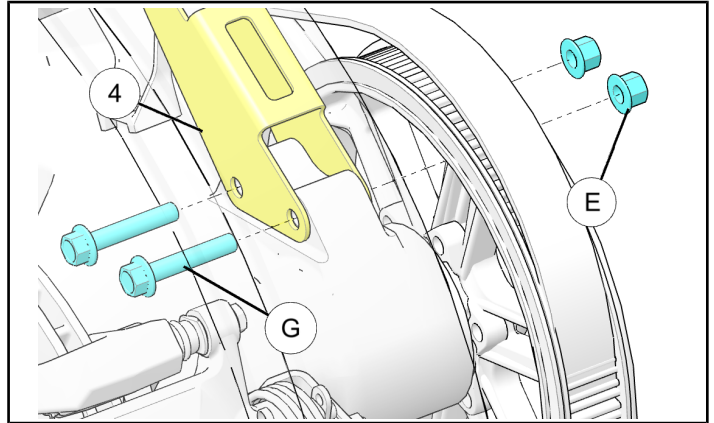

4. Install clevis (4) to rear shock at the top using bolt (F) and nut (D). Torque bolt to specification. This joint should be torqued under a lightly loaded state to account for clearances.

TORQUE

50 ft. lbs. (67.8 Nm)

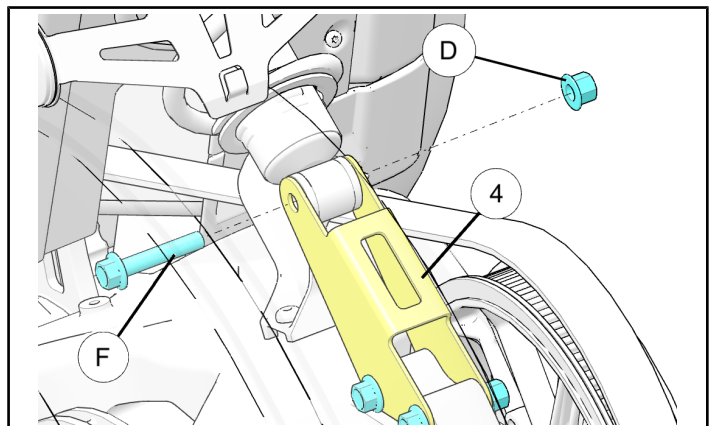

5. Reinstall belt cover (B) and screws (A).

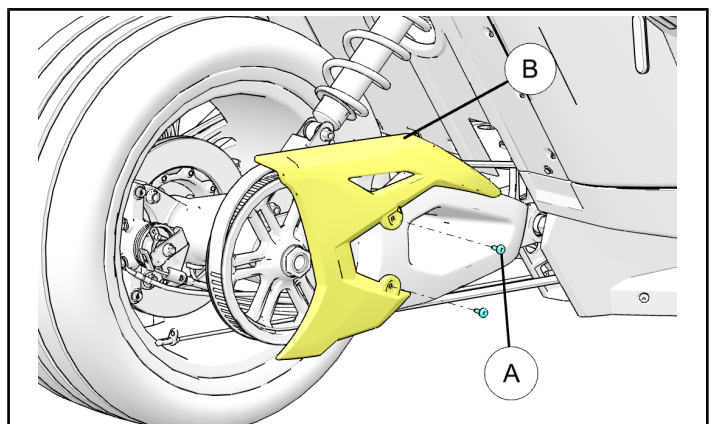

REAR WHEEL REMOVAL AND INSTALLATION

1. Remove five lug nuts (C) from rear wheel (H) using 17mm wrench.

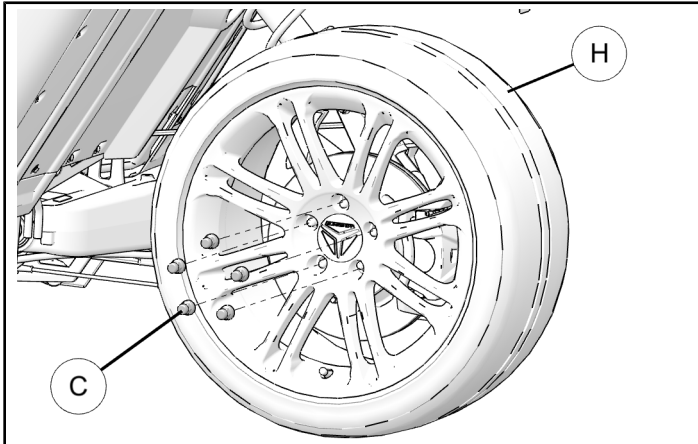

2. Carefully remove rear wheel (H) from wheel bolts and set aside.

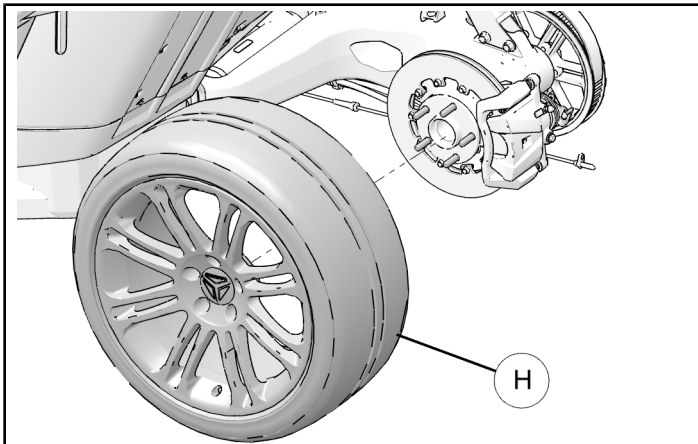

3. Place rear wheel assembly (3) onto the wheel mounting bolts.

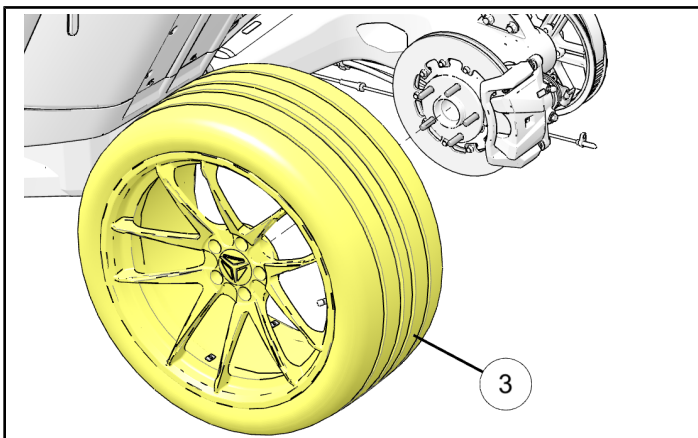

4. Hand tighten five lug nuts (5), ensuring the wheel hub face is mated to the axle hub face. Torque lug nuts (5) to specification in a star pattern.

TORQUE

75 ft. lbs. (101.7 Nm)

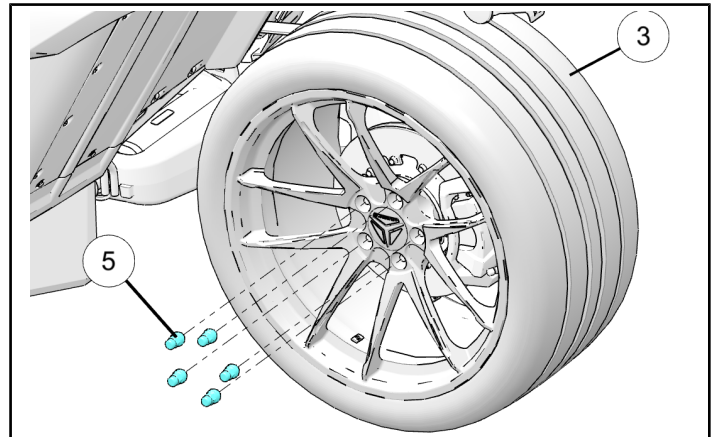

5. Lower the vehicle to the ground.

FRONT WHEEL REMOVAL AND INSTALLATION

1. Use floor lift to slowly lift front LH side of vehicle. Refer to "Lift Placement" section on last page of the instructions for proper lift placement.

⚠ WARNING

Serious injury may result if the vehicle tips or falls. Be sure the vehicle is secure before beginning wheel removal and installation processes. Always wear eye protection.

2. Remove five lug nuts (C) from driver side front wheel (J) using 17mm wrench.

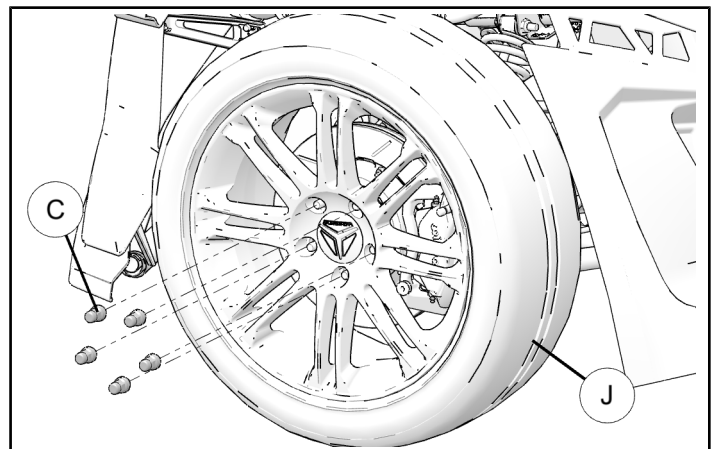

3. Carefully remove driver side front wheel (J) from wheel mounting bolts and set aside.

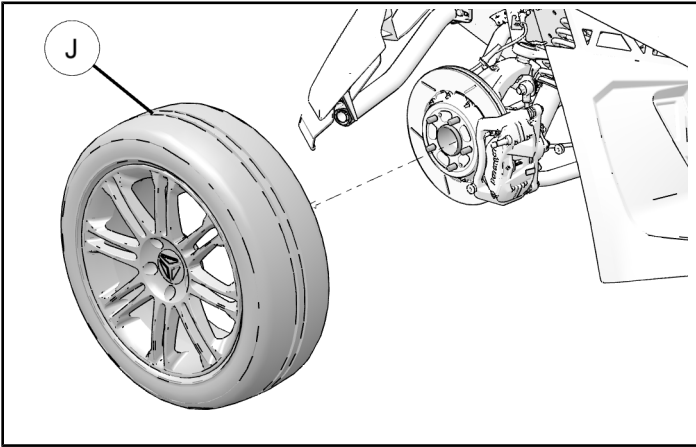

4. Check the directional arrows on the tire to ensure the correct placement of the front wheel assembly ①. Place driver side front wheel assembly ① onto the wheel mounting bolts.

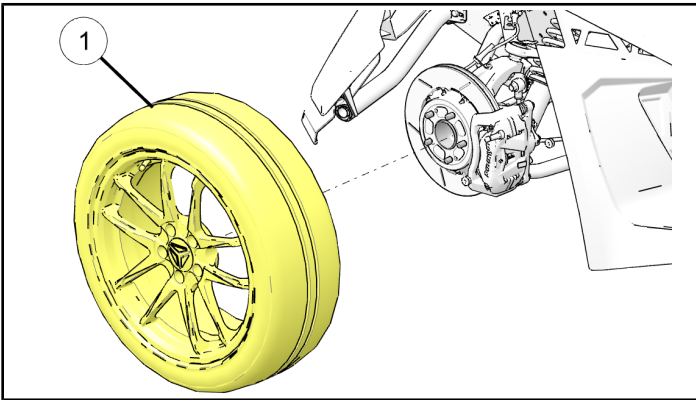

5. Hand tighten five lug nuts ⑤, ensuring the wheel hub face is mated to the bearing hub face. Torque lug nuts ⑤ to specification in a star pattern.

TORQUE

75 ft. lbs. (101.7 Nm)

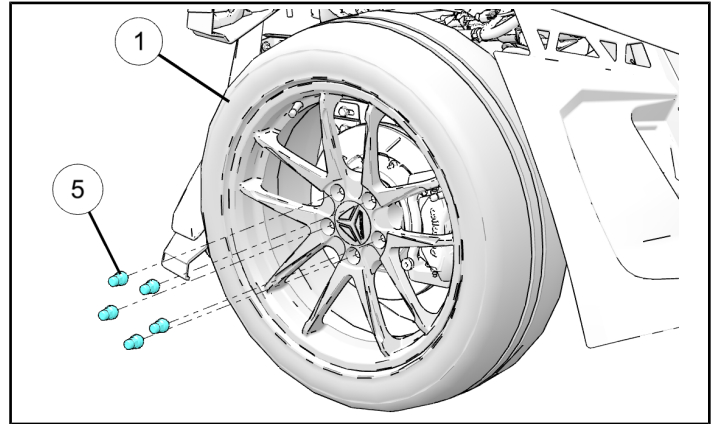

6. Lower the vehicle to the ground.
7. Repeat steps 1 through 6 for installing passenger side front wheel assembly ②.

⚠ WARNING

Ensure proper alignment of wheels. If wheels are improperly installed, it could affect vehicle handling and tire wear resulting in personal injury or death.

STABILITY CONTROL VARIANT PROGRAMMING

IMPORTANT

When installation is complete, the new Premium Electronic Stability Control Variant must be set. Dealer must follow procedure to set this variant in Digital Wrench. THIS IS NECESSARY TO ENSURE PROPER VEHICLE FUNCTIONALITY.

LIFT PLACEMENT

WARNING

Serious injury may result if the vehicle tips or falls. Be sure the vehicle is secure before beginning this procedure. Always wear eye protection.

IMPORTANT

Always ensure lift is placed on frame.

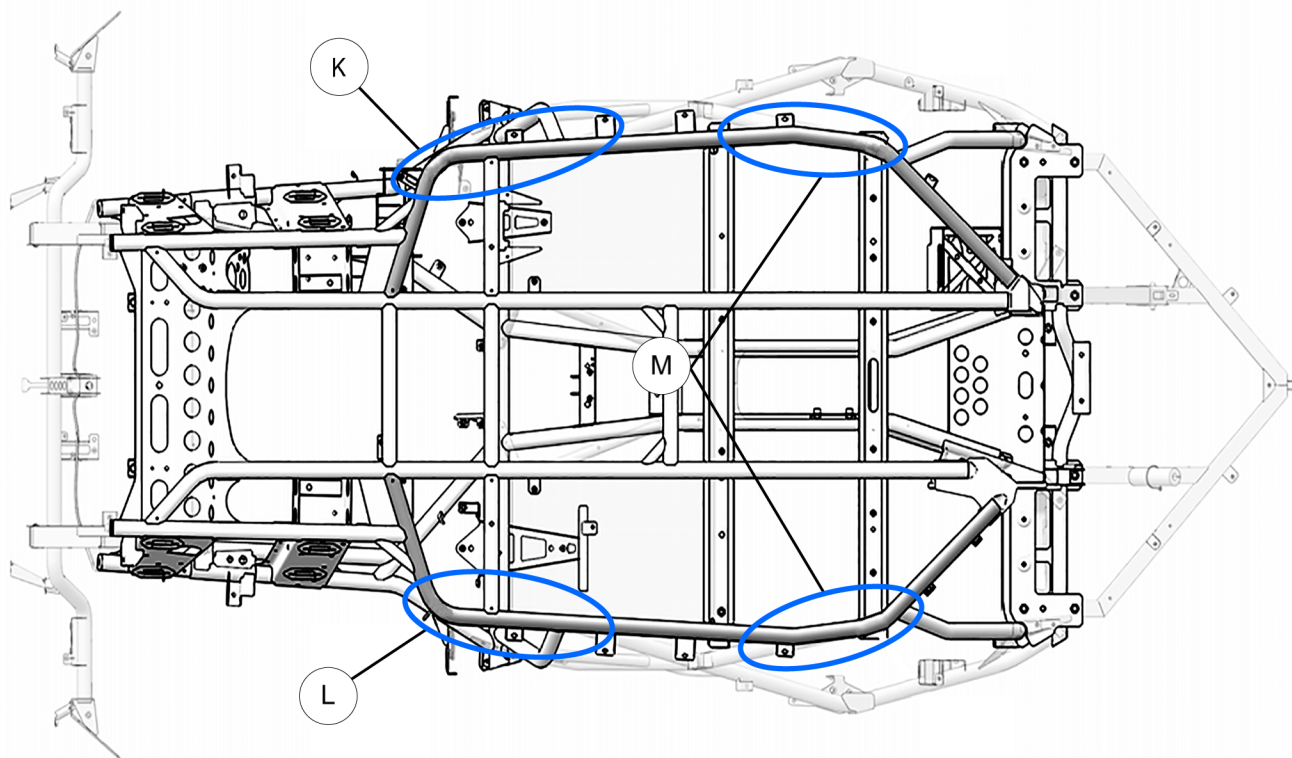

Ref	Part Description
K	For Driver Caliper
L	For Passenger Caliper
M	For Rear Caliper (Either Spot Works)