

CENTER CONSOLE BAG KIT



SLINGSHOT

P/N 2884992

BEFORE YOU BEGIN

Read these instructions and check to be sure all parts and tools are accounted for. Please retain these installation instructions for future reference and parts ordering information.

DISCLAIMER ACCESSORY WEIGHT

When adding accessories, equipment, passengers and luggage to your vehicle, do not exceed the total weight capacity of the vehicle or of the front or rear axle (GVWR or GAWR as indicated on the Safety Compliance Certification label). Ask an authorized dealer for specific weight information if you need assistance. It is the owner's responsibility to use the Polaris Slingshot Accessories website as a tool for limiting the amount of accessories, based on maximum allowable vehicle weight requirements. It may be a violation of the Clean Air Act or the NHTSA regulations to disregard these requirements. For a complete listing of the accessories that are available for your vehicle, please contact your authorized dealer or visit the online store web site:

Web Address (United States): <http://www.polaris.com/en-us/slingshot/shop/accessories>.

APPLICATION

Verify accessory fitment at www.polarisslingshot.com.

KIT CONTENTS

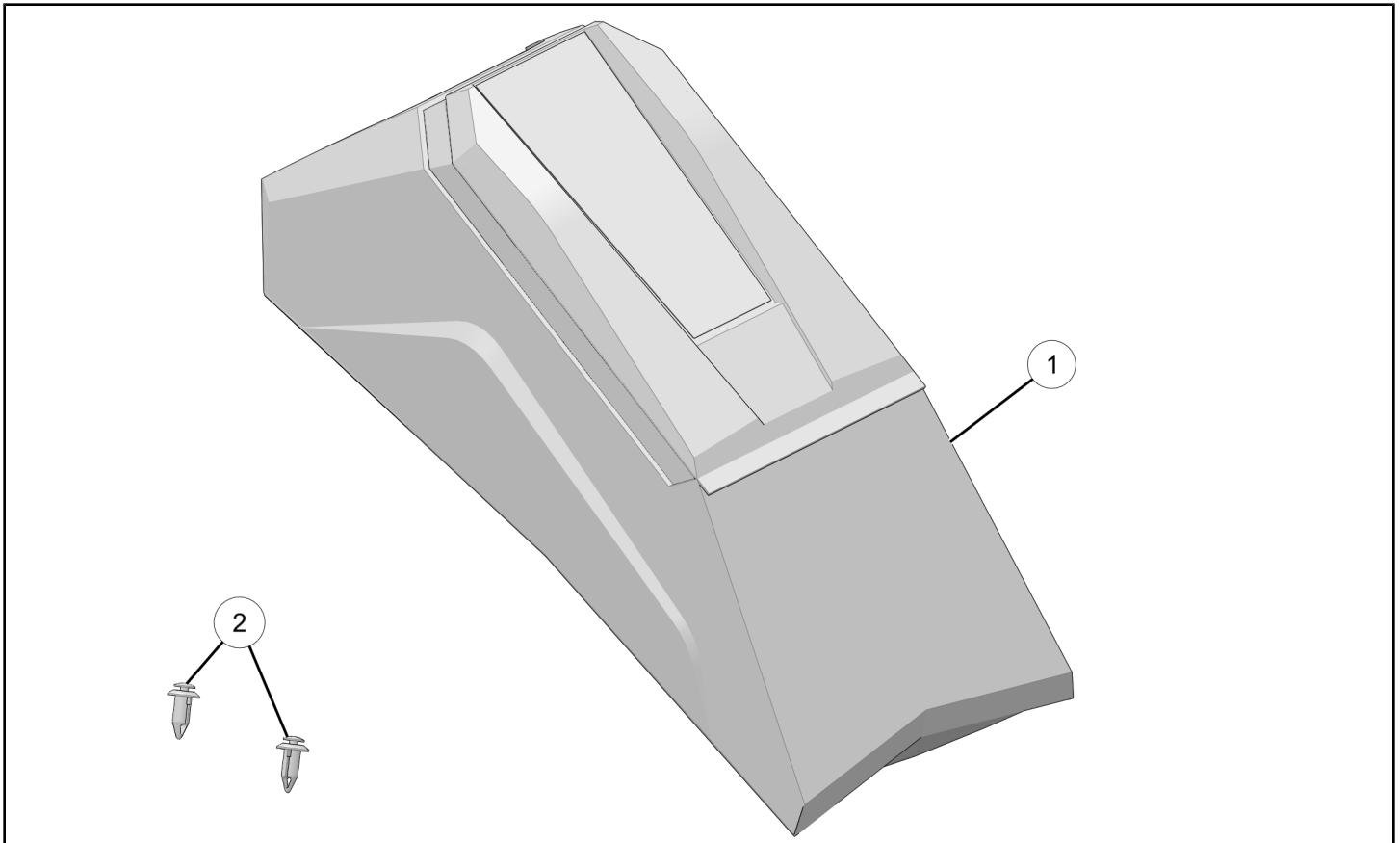

REF	QTY	PART DESCRIPTION	P/N AVAILABLE SEPARATELY
1	1	Bag, Center Console	2690277
2	2	Rivet, Push-Pin, 0.315-0.325 X 0.787 in	7661855
3	2	Washer, Plastic, Black (Not shown)	n/a

TOOLS REQUIRED

- Safety Glasses
- Drill
- Drill Bit:
 - 11/32 in (8.5 mm)
- Marking Pen
- Socket Set, Torx® Bit
- Torque Wrench

IMPORTANT

Your Center Console Bag Kit is exclusively designed for your vehicle. Please read the installation instructions thoroughly before beginning. Installation is easier if the vehicle is clean and free of debris. For your safety, and to ensure a satisfactory installation, perform all installation steps correctly in the sequence shown.

INSTALLATION INSTRUCTIONS

VEHICLE PREPARATION

GENERAL

1. Park vehicle on a flat surface.
2. Shift vehicle to NEUTRAL.
3. Press START/STOP button to turn vehicle OFF.
4. Apply parking brake.
5. Remove key fob from proximity of vehicle.

ACCESSORY INSTALLATION

1. Set bag in place between seats.

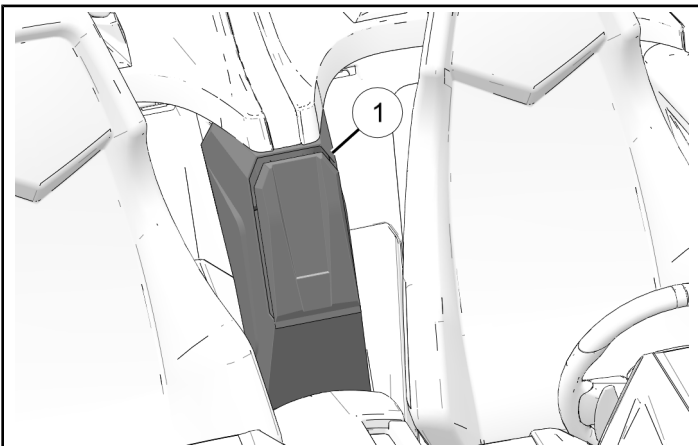

2. Open bag and lower flap to access inside of bag.

3. Mark hole locations through bottom of bag onto center console with a marking pen.

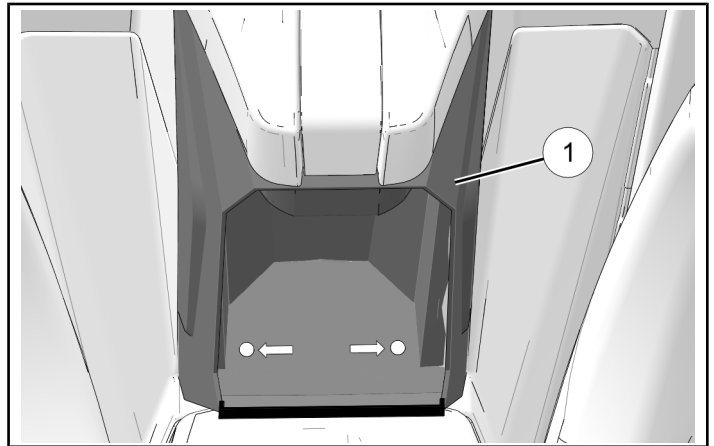

4. Remove bag and set aside.

5. Drill two 11/32 in (8.5 mm) in center of marked holes.

IMPORTANT

Control tool depth. Ensure tool is clear of all other parts and components to prevent damage to vehicle.

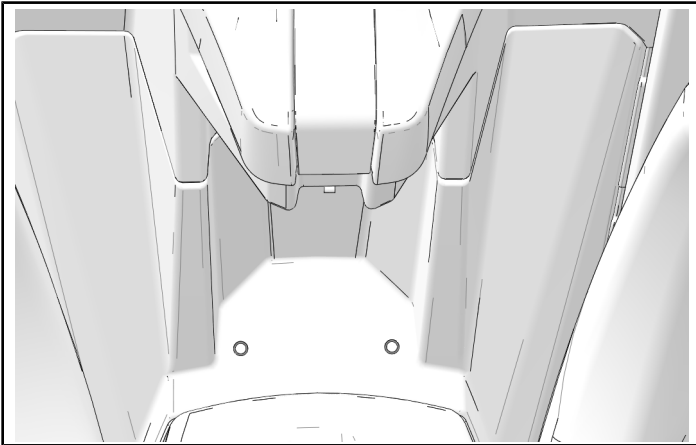

6. Remove and keep two screws (A) from center console opening as shown.

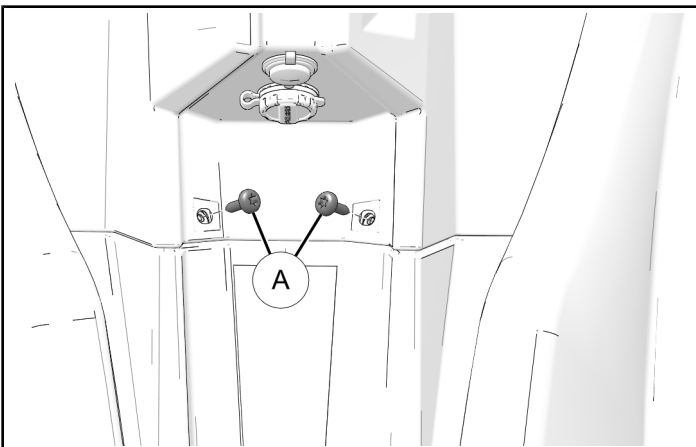

7. Set bag back into place.

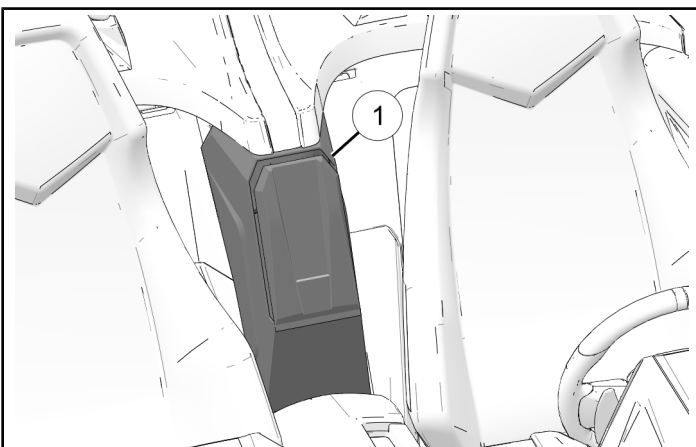

8. Open bag and lower flap to access inside of bag.
9. Loosely install two retained screws (A) into two new washers (3) and mount bag to center console.

DO NOT torque fasteners at this time.

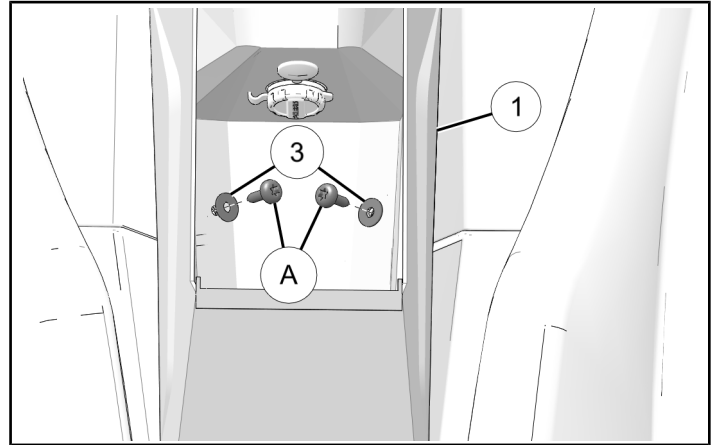

10. Align lower holes and install two push pin rivets (2) into holes.

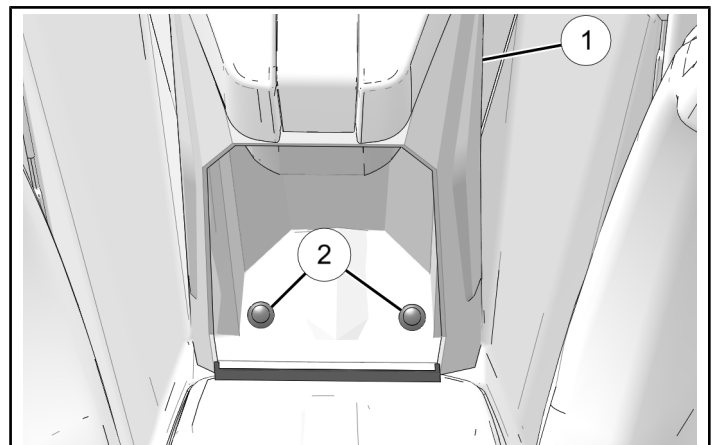

11. Torque screws (A) to specification.

TORQUE

Center Console Screws (A):
35 in-lbs (4 N·m)

CLEANING AND CARE

CLEANING

Use a non-abrasive cloth and mild soap to clean bag.

CARE

Leave zipper open when bag is not in use to allow moisture inside to escape.

INSTRUCTION FEEDBACK FORM

A feedback form has been created for the installer to provide any comments, questions or concerns about the installation instructions. The form is viewable on mobile devices by scanning the QR code or by clicking [HERE](#) if viewing on a PC.

