

RIPPER SERIES WIND DEFLECTOR KIT



SLINGSHOT

P/N 2882154

APPLICATION

Slingshot; Base, SL and LE Models

Verify accessory fitment at www.polarisslingshot.com.

BEFORE YOU BEGIN

Read these instructions and check to be sure all parts and tools are accounted for. Please retain these installation instructions for future reference and parts ordering information.

DISCLAIMER ACCESSORY WEIGHT

When adding accessories, equipment, passengers and luggage to your vehicle, do not exceed the total weight capacity of the vehicle or of the front or rear axle (GVWR or GAWR as indicated on the Safety Compliance Certification label). Ask an authorized dealer for specific weight information if you need assistance. It is the owner's responsibility to use the Polaris Slingshot Accessories website as a tool for limiting the amount of accessories, based on maximum allowable vehicle weight requirements. It may be a violation of the Clean Air Act or the NHTSA regulations to disregard these requirements. For a complete listing of the accessories that are available for your vehicle, please contact your authorized dealer or visit the online store web site: Web Address (United States): <http://www.polaris.com/en-us/slingshot/shop/accessories>.

KIT CONTENTS

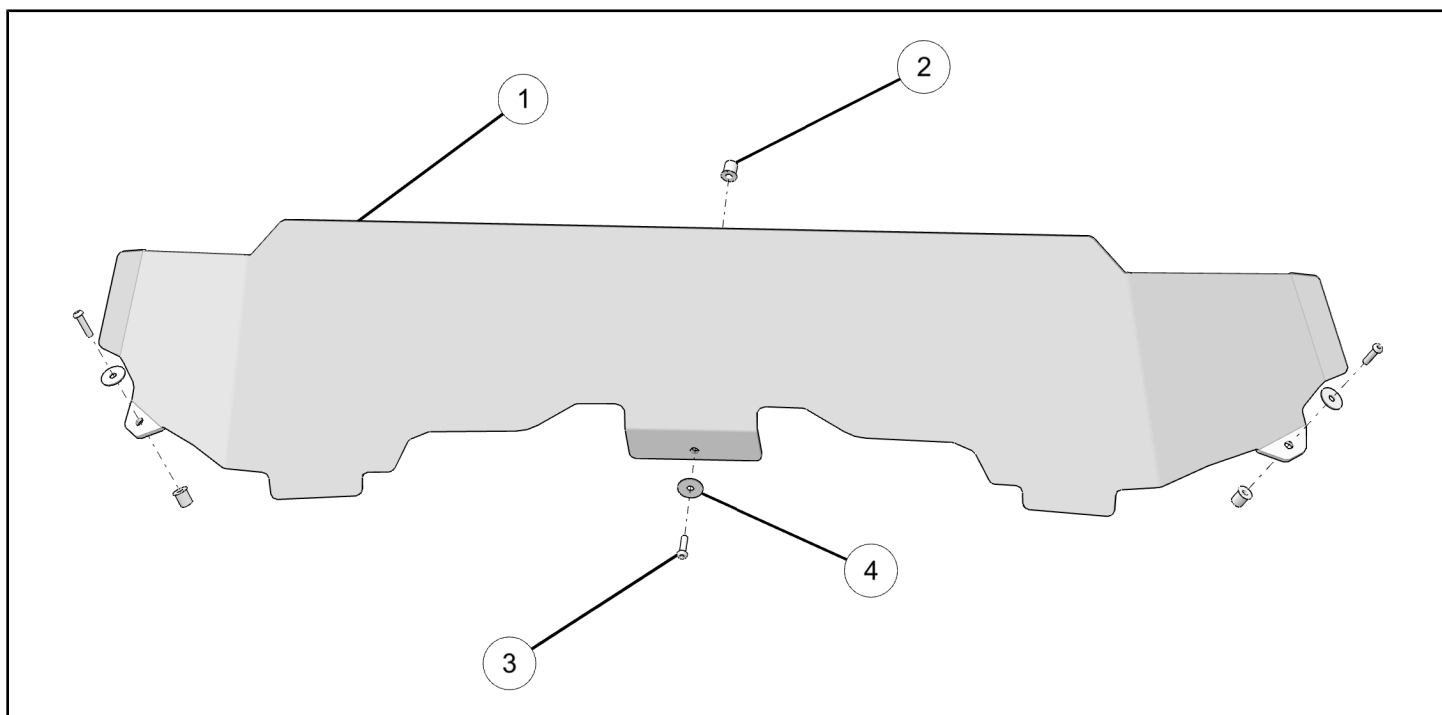

REF	QTY	PART DESCRIPTION	PART NUMBER
1	1	Tinted Windshield	5455970
2	3	Wellnut - M6 X 1.0	7547772
3	3	Screw - M6 X 1.0 X 25	7520236
4	3	Washer - M6 X 1.0	7556879
	1	Instructions	9927307

TOOLS REQUIRED

- Safety Glasses
- Drill with
- Drill Bit: 1/2 inch
- Marker/Pencil
- Socket Set, Hex Bit, Metric
- Socket Set, Torx® Bit
- Torque Wrench

IMPORTANT

Your Ripper Series Wind Deflector Kit is exclusively designed for your vehicle. Please read the installation instructions thoroughly before beginning. Installation is easier if the vehicle is clean and free of debris. For your safety, and to ensure a satisfactory installation, perform all installation steps correctly in the sequence shown.

INSTALLATION INSTRUCTIONS

1. Put transmission in “NEUTRAL” and turn key to “OFF” position. Remove key from vehicle. Apply parking brake.
2. Open hood (A) using latch (B) located in front of vehicle between middle set of lights. Pull rearward and up to open.

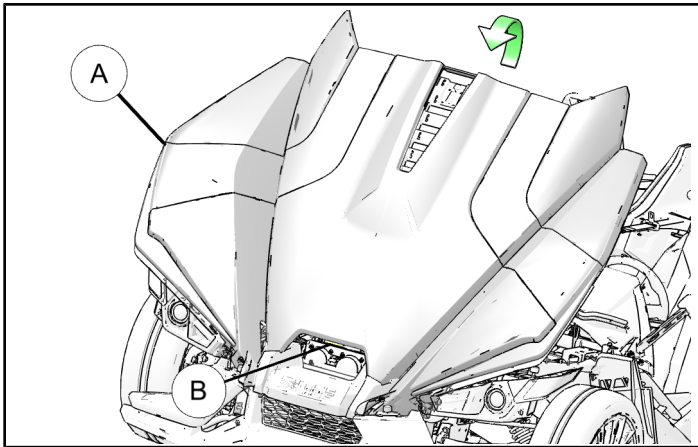

3. Press two wellnuts (2) into driver and passenger side main visor panel holes (C) as shown.

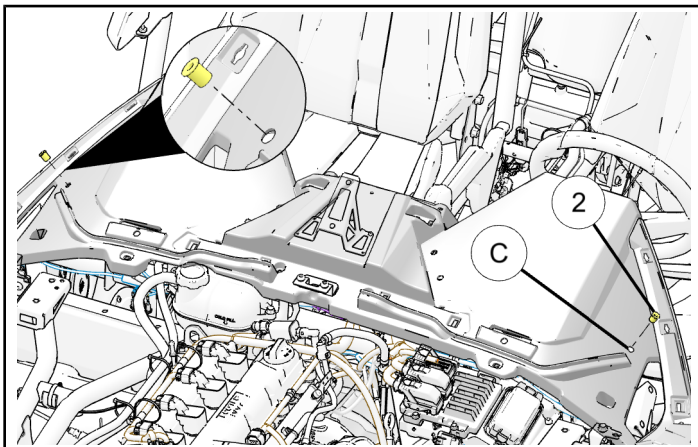

4. Install windscreen (1) by first engaging tab and slot in front then align mounting holes on windshield and main visor.

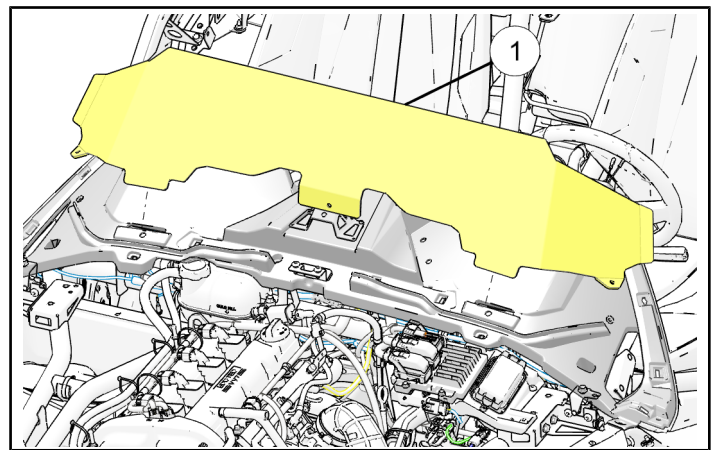

5. Mark location of center hole in front of windshield with a marker/pencil. Remove windshield from vehicle. Drill 1/2 inch hole in marked area. Insert third wellnut (2) into new hole.

NOTE

Before drilling, wrap electrical or painter's tape around drill bit at 1/2 inch depth and use as a depth gauge.

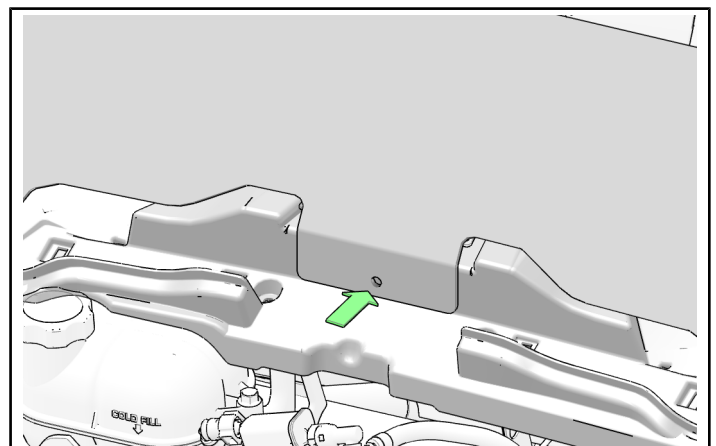

6. Reinstall windshield ① by engaging tab and slot in front and aligning three holes on windshield. Install screw ③ and washer ④ onto windshield. Torque screws to specification.

TORQUE

Windscreen screws: **84 in-lbs (9.5 Nm)**

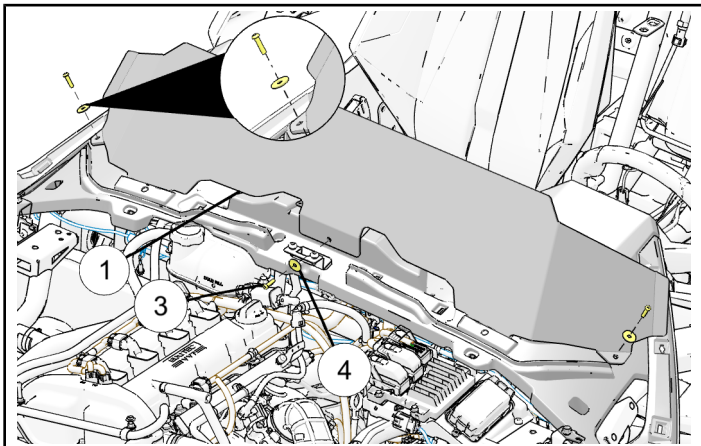

FEEDBACK FORM

A feedback form has been created for the installer to provide any comments, questions or concerns about the installation instructions. The form is viewable on mobile devices by scanning the QR code or by clicking [HERE](#) if viewing on a PC.

