

AXYS ROX RISER HANDLEBAR KIT



P/N 2881410

APPLICATION

All AXYS Rush and Switchback models

BEFORE YOU BEGIN

Read these instructions and check to be sure all parts and tools are accounted for. Please retain these installation instructions for future reference and parts ordering information.

KIT CONTENTS

This Kit includes:

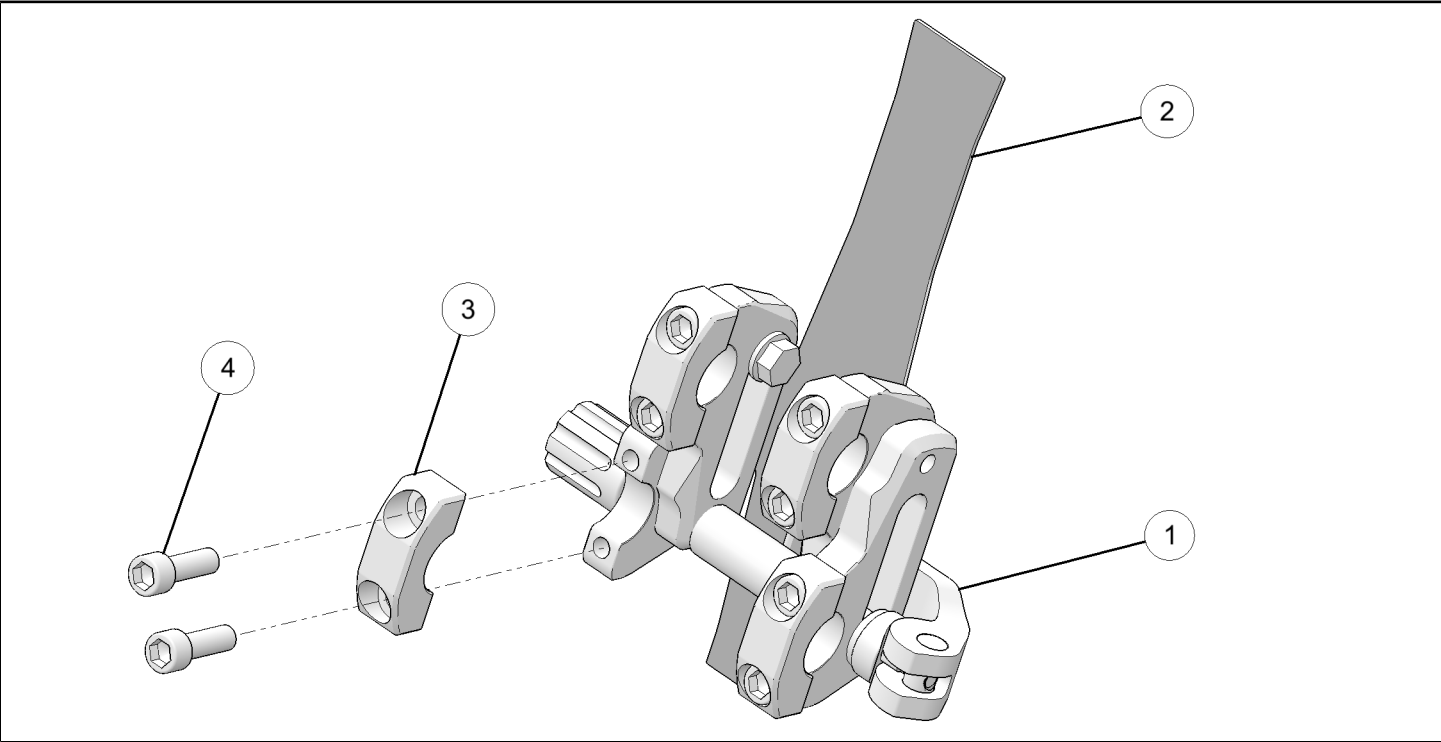

REF	QTY	PART DESCRIPTION	PART NUMBER
1	1	ROX Riser Assembly	1824445
2	1	Handlebar Cover ROX Assembly	2686650
3	4	ROX Riser Cap	5139887
4	8	Screw-SH-M8 X 1.25 X 25	7518142
	1	Instructions	9926692

TOOLS REQUIRED

- 6 mm Allen Head Socket
- 13 mm Wrench
- Torque Wrench

IMPORTANT

Your AXYS ROX RISER HANDLEBAR KIT is exclusively designed for your vehicle. Please read the installation instructions thoroughly before beginning. Installation is easier if the vehicle is clean and free of debris. For your safety, and to ensure a satisfactory installation, perform all installation steps correctly in the sequence shown.

ASSEMBLY TIME

Approximately 15 minutes

INSTALLATION INSTRUCTIONS

1. Remove bar pad (A).

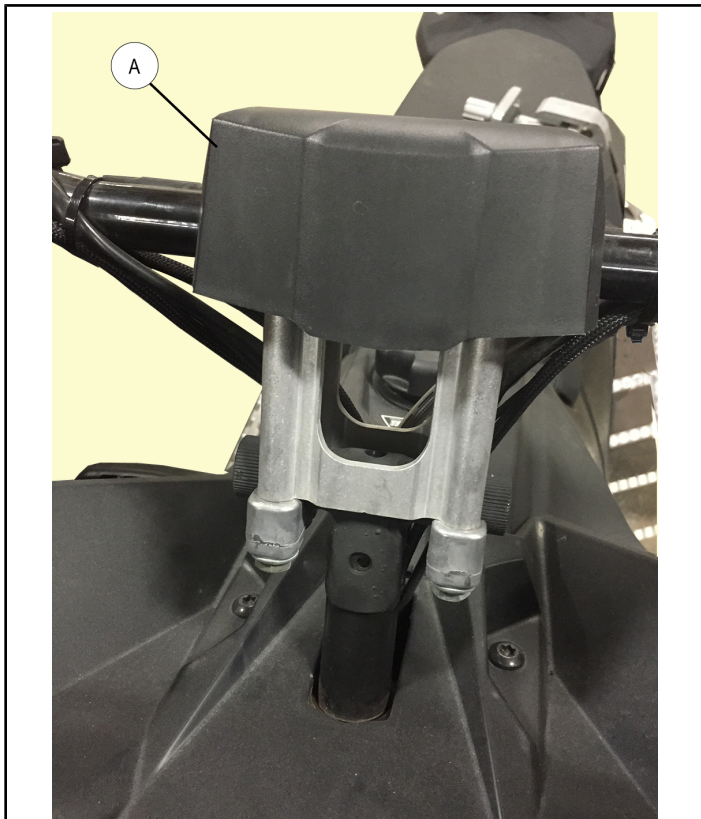

2. Remove four upper handlebar mounting bolts (B) and gently move handlebar assembly forward.

Remove four lower handlebar mounting bolts (C) and remove handlebar riser from steering post.

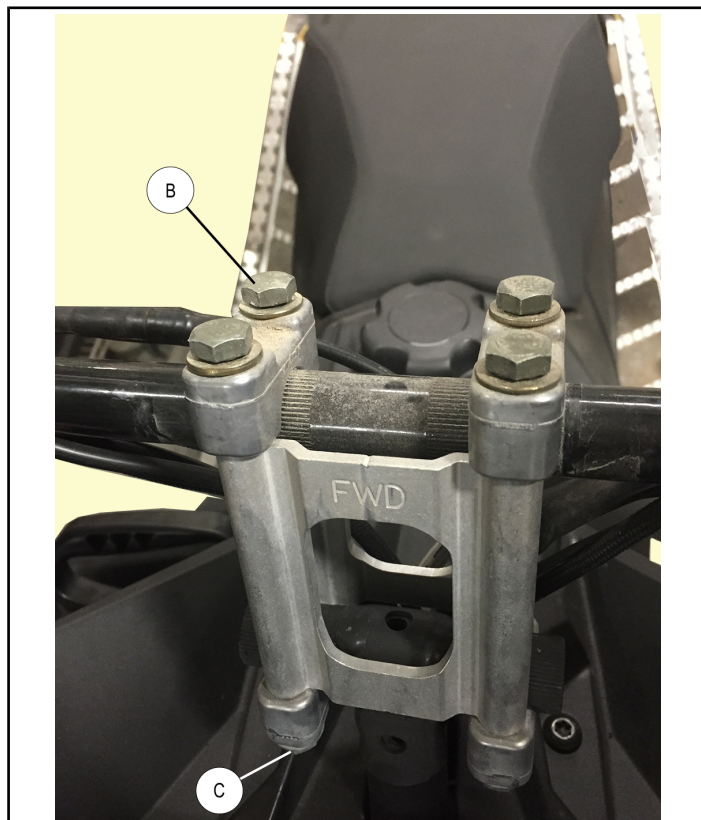

3. Install ROX handlebar riser ① on steering post with ROX riser cap ③ and mounting screws ④.

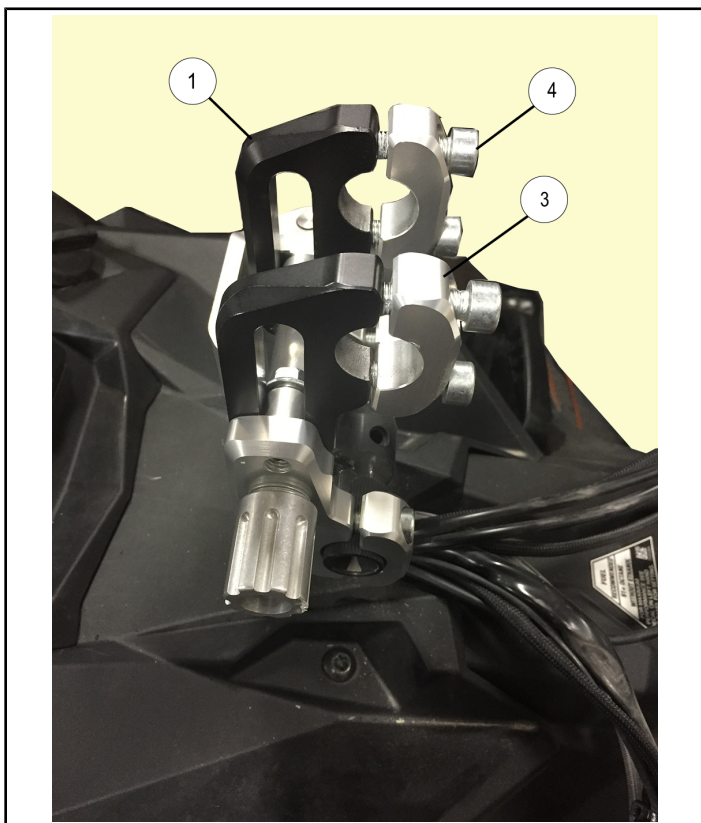

6. Adjust handlebar height by loosening the height adjustment levers (E) and moving handlebars up or down. When a comfortable height is determined, tighten adjustment levers.

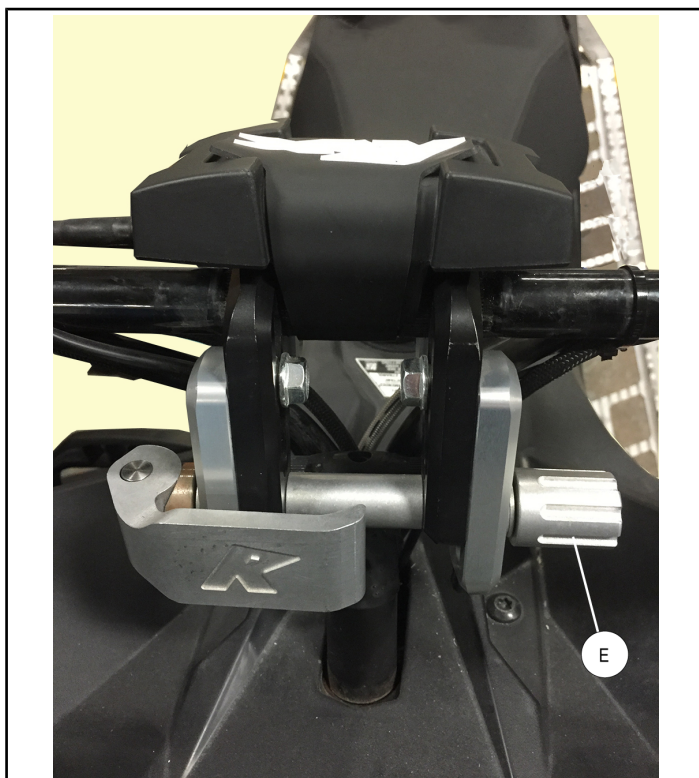

4. Adjust handlebar (D) and riser ① to a comfortable position.

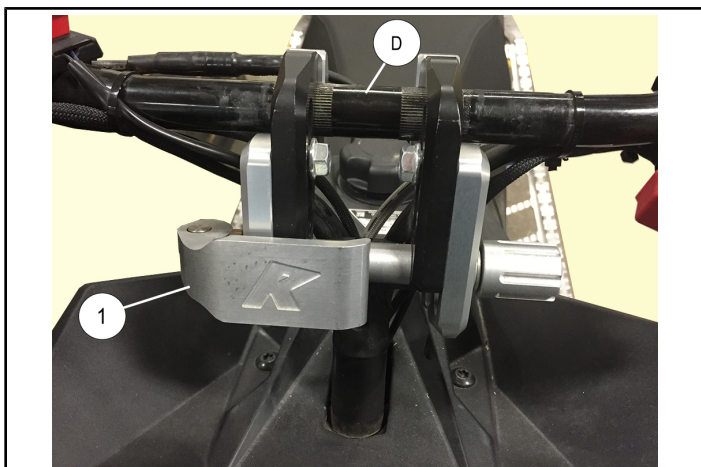

5. Torque the top and bottom mounting screws ④ to specification.

TORQUE

16 ft. lbs (21.69 Nm)

IMPORTANT

You must check the throttle cable length to make sure it is long enough for proper operation. To do this, securely support the machine using a jackstand or hoist. The track must be off the ground. Start the engine and make sure the engine RPMs don't change when the handlebars are turned full right and full left.

Repeat with the ROX risers in the extended position. Inspect the cable for proper routing.

NOTE

Optional throttle cables are available that are 1.5 inches longer (PN 7081711).

⚠ WARNING

If the engine RPMs change when the handlebars are turned, bring the machine to your dealer to correct the issue before riding. Failure to do so could result in serious injury or death.