

XCR REAR AXLE WHEELS KIT



P/N 2881954

APPLICATION

Axys Rush 120" and Axys Switchback 137"

BEFORE YOU BEGIN

Read these instructions and check to be sure all parts and tools are accounted for. Please retain these installation instructions for future reference and parts ordering information.

KIT CONTENTS

This Kit includes:

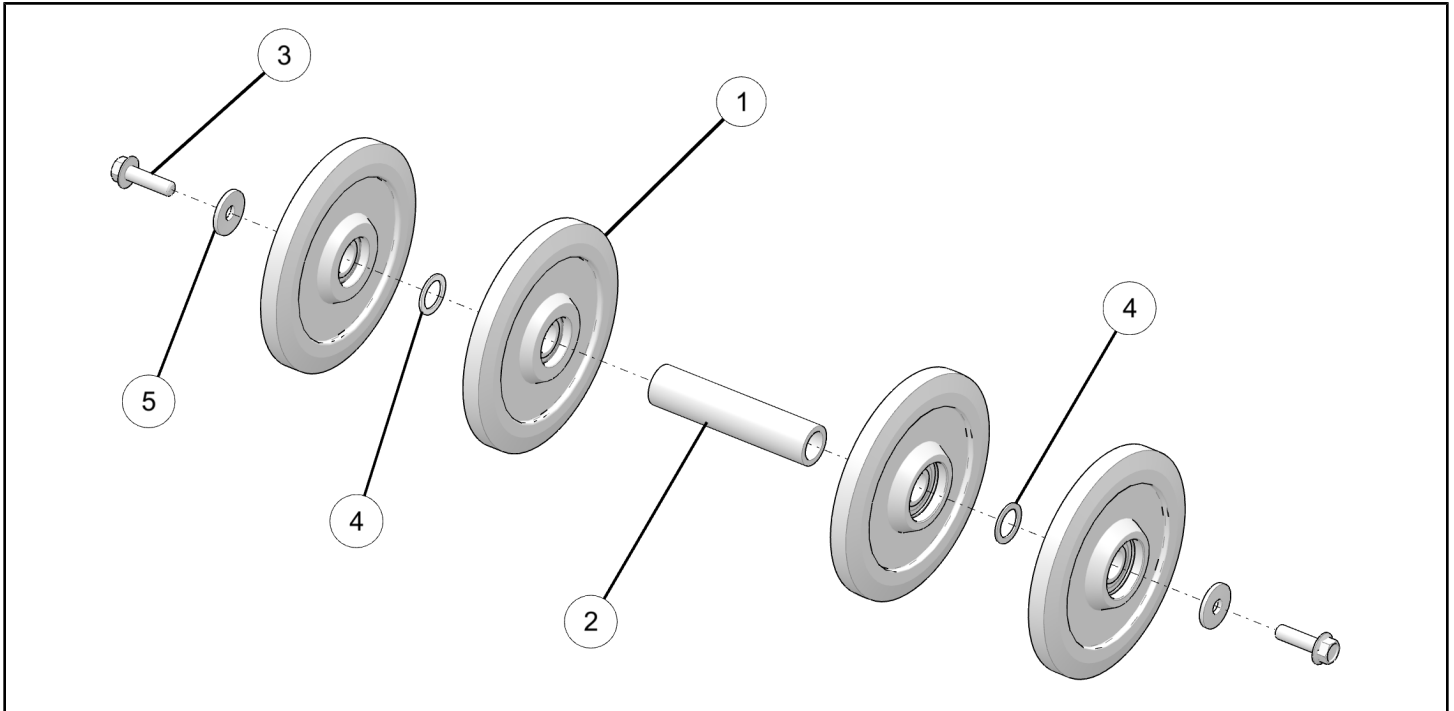

REF	QTY	PART DESCRIPTION	PART NUMBER
1	4	Wheel Assembly	1590426
2	1	Spacer	5333283
3	2	Screw, Hex Flange - M10 X 1.5 X 35	7518957
4	2	Bushing - 0.8 X 1.25 X 0.06	7555918
5	2	Spring Washer - 0.406 X 1.25 X 0.125	7556490
	1	Instructions	9927065

TOOLS REQUIRED

- Safety Glasses
- 15mm Wrench
- Ratchet
- 15mm Socket

IMPORTANT

Your XCR REAR AXLE WHEELS KIT is exclusively designed for your vehicle. Please read the installation instructions thoroughly before beginning. Installation is easier if the vehicle is clean and free of debris. For your safety, and to ensure a satisfactory installation, perform all installation steps correctly in the sequence shown.

ASSEMBLY TIME

Approximately 20 minutes

INSTALLATION INSTRUCTIONS

1. Raise the snowmobile by the running boards using a hoist. Do not lift snowmobile by the rear bumper as doing so will compress the rear track shock.
2. Using a 15mm wrench loosen track adjuster bolt jam nut (A) and back out the bolt (B) until flush with inside of adjuster block (C). Repeat the same on other side of sled.

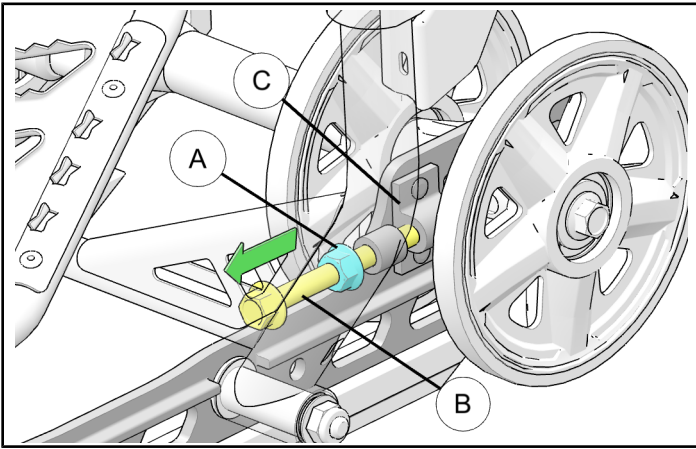

3. Using a 15mm wrench, socket and ratchet, loosen rear axle bolt (D) from outer axle wheel (E). Push rear axle as far forward as possible to loosen track tension. Repeat the same on other side of sled.

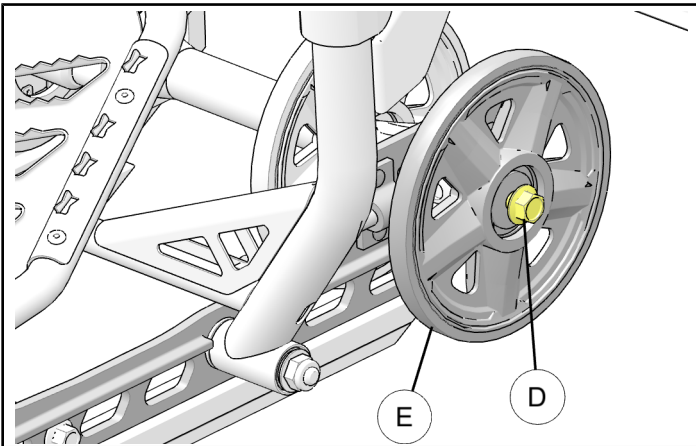

4. Remove rear axle bolt (D), washer (F), and outer axle wheel (E). Discard the bolt (D) and washer (F). New hardware is provided in the kit for installation. Repeat the same on other side of sled.

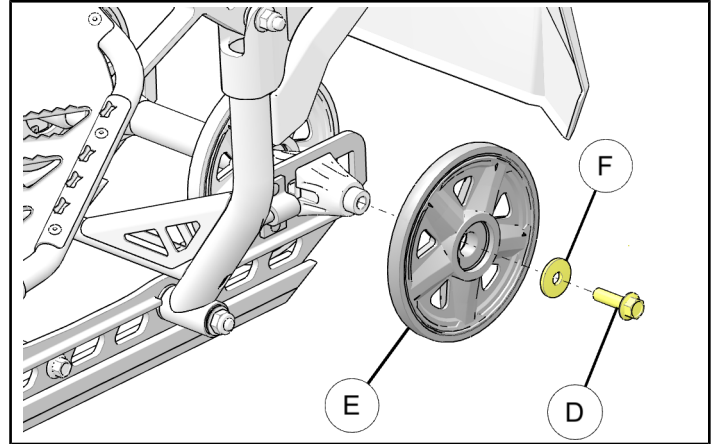

5. Remove outer black plastic spacers (G) from axle shaft (H) on both sides of sled. Retain spacers (G) for installation of new wheels.

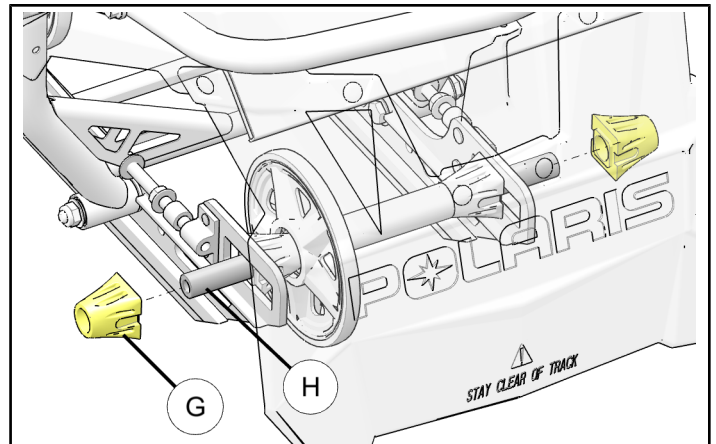

6. Remove axle shaft (H) holding inner black plastic spacers (M), bushings (L), center wheel (E), and spacer (K) in place on side rails (J). Discard bushings (L) and spacer (K). Retain all other parts for installation of new wheels.

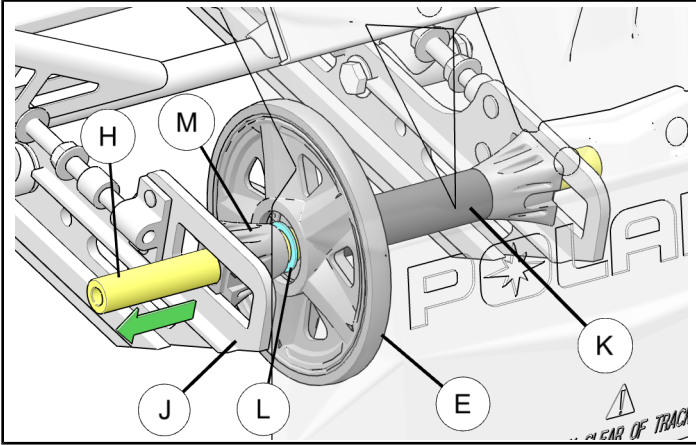

7. Insert axle shaft (H) from either side of rails (J) and install original inner black plastic spacers (M), new bushings (4), new inner wheels (1), and new spacer (2) onto the shaft (H) in the sequence as shown.

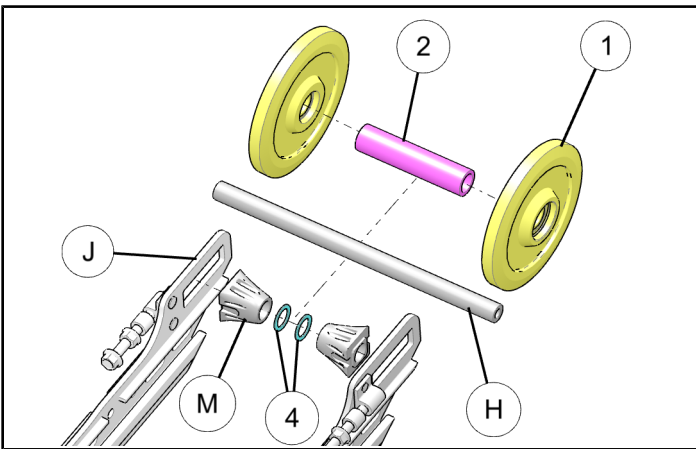
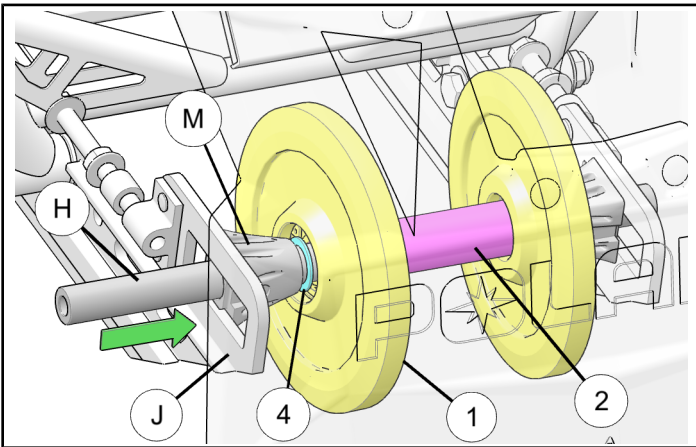

8. Install original outer black plastic spacers (G) onto the axle shaft (H).

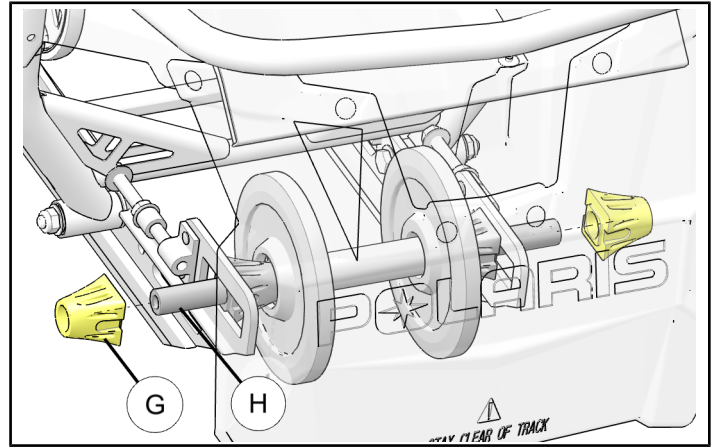

9. Loosely install new outer wheel (1) onto the shaft (H) using bolt (3) and spring washer (5). Don't tighten the bolt (3). Repeat the same on other side of sled.

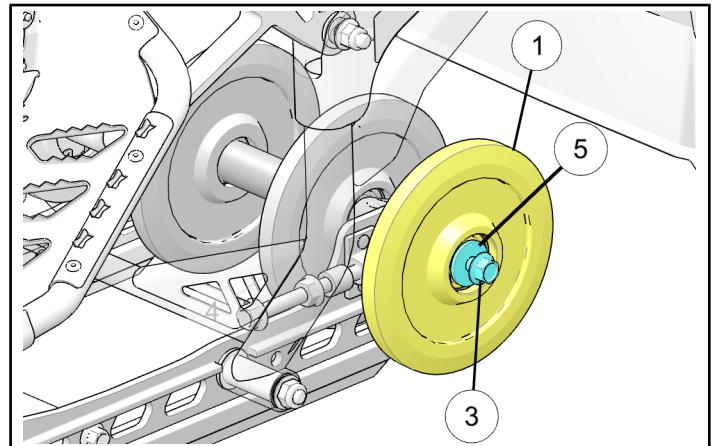

10. Tighten adjuster bolt (B) and jam nut (A) until proper track tension is achieved. Repeat the same on other side of sled. Refer to Owner's manual for required track tension.

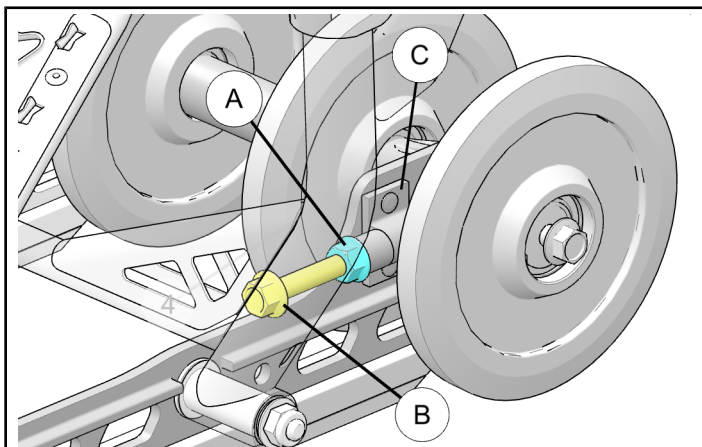

11. Tighten both rear axle wheel bolts ③ at this time to specification.

TORQUE
35 ft. lbs. (47.5 Nm)

