

AXYS SWITCHBACK FOX REAR SUSPENSION KIT

P/N 2881412



APPLICATION

AXYS Switchback only

BEFORE YOU BEGIN

Read these instructions and check to be sure all parts and tools are accounted for. Please retain these installation instructions for future reference and parts ordering information.

KIT CONTENTS

This Kit includes:

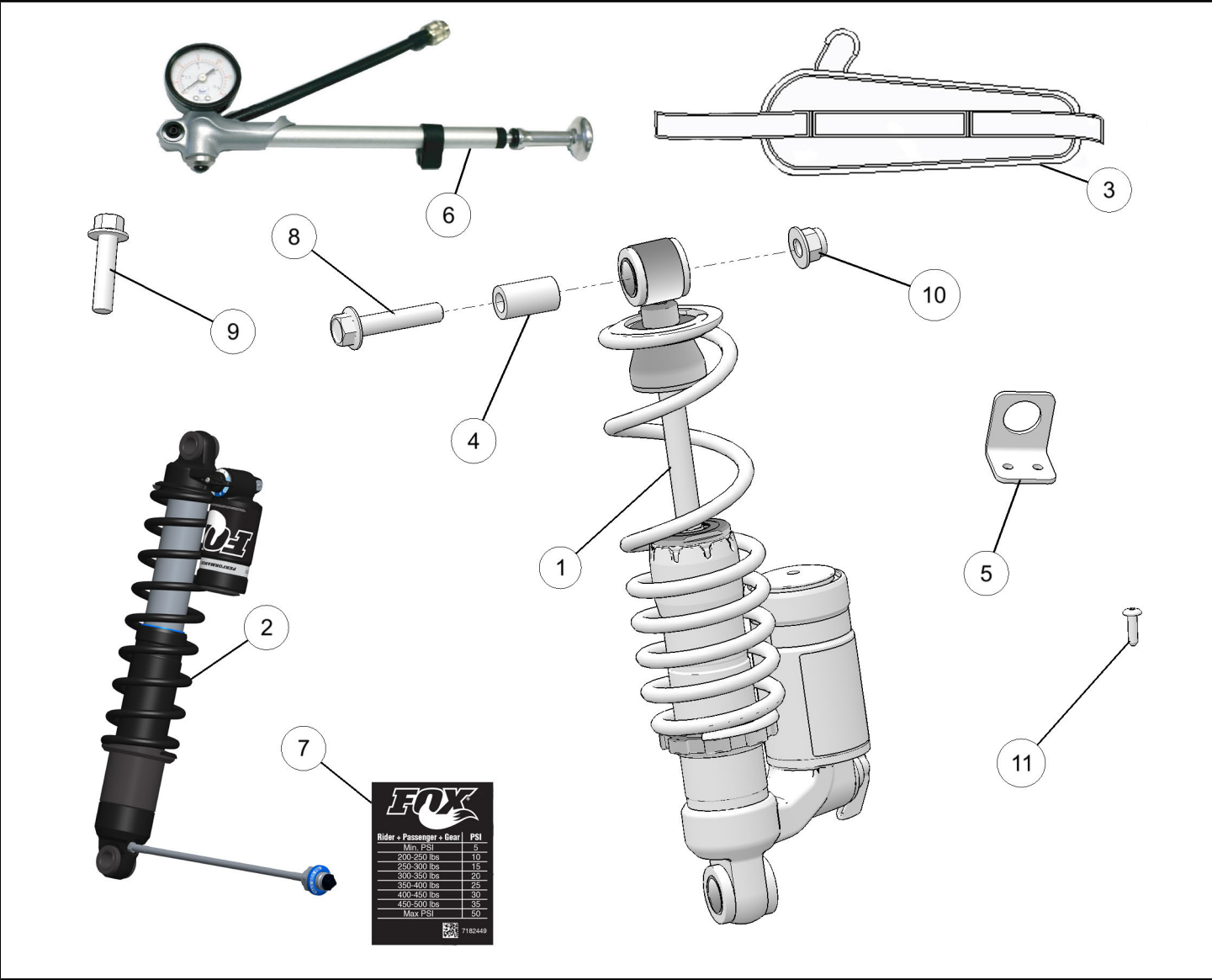

REF	QTY	PART DESCRIPTION	PART NUMBER
1	1	Shock Assembly, Front Track	1543573-133
2	1	Shock Assembly, Rear Track	1543574

REF	QTY	PART DESCRIPTION	PART NUMBER
3	1	Bag-Air Pump	2686659
4	1	Bushing-M10X17.5X30	5137360
5	1	Bracket-Port	5261966-458
6	1	Shock-Pump,Fox Float	7043487
7	1	Decal-Fox Shock SetUp	7182449
8	1	Screw-M10X1.5X50	7518971
9	2	Screw-HXFL-M10X1.5X40	7519216
10	1	Nut-M10X1.5	7547423
11	2	Rivet-3/16	7661637
	1	Instructions	9927050

TOOLS REQUIRED

- 15 mm Wrench or Socket (2X)
- Torque Wrench
- Floor Jack
- Drill
- 3/16" Drill Bit
- 3/8" Ratchet
- 13 mm Socket
- 10 mm Socket
- 10 mm Wrench
- T-40 Torx®
- Rivet Gun
- Adjustable Wrench

IMPORTANT

Your AXYS SWITCHBACK FOX REAR SUSPENSION KIT is exclusively designed for your vehicle. Please read the installation instructions thoroughly before beginning. Installation is easier if the vehicle is clean and free of debris. For your safety, and to ensure a satisfactory installation, perform all installation steps correctly in the sequence shown.

ASSEMBLY TIME

Approximately 2 hours

INSTALLATION INSTRUCTIONS

FOX FRONT TRACK SHOCK INSTALLATION

1. With the snowmobile sitting on a flat surface, note where the limiter strap screw (A) is installed. Remove the screw (A), washer (B) and nut (C) securing the top of the limiter strap (D) to the front torque arm cross shaft. Keep hardware for reassembly.

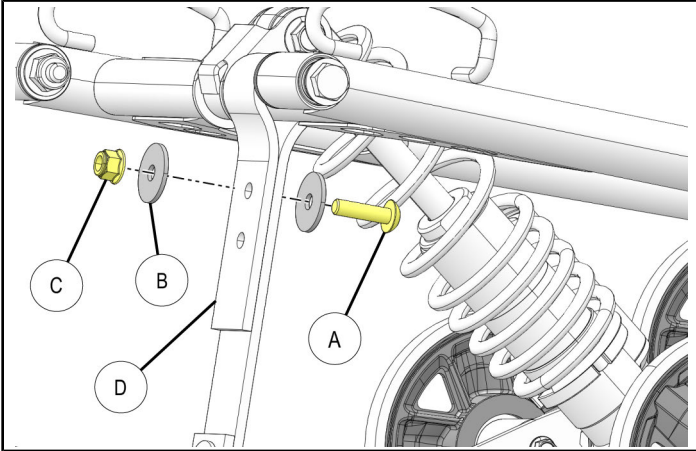

2. Raise the rear of the snowmobile off of the ground using a dedicated track stand or similar device. Do not lift snowmobile by the rear bumper as doing so will compress the rear track shock.
3. To access the front track shock (FTS) lower cross shaft rail beam screws, remove the left and right bogie wheels. Note the orientation of the screws (E), washers (F) and nuts (G).

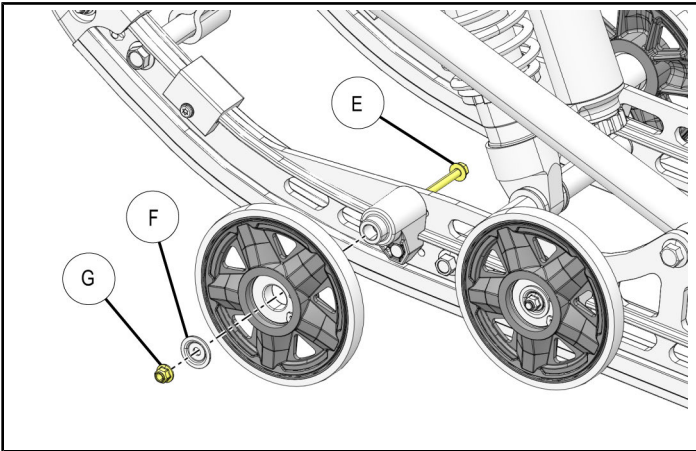

4. Measure the shock preload setting. Loosen the spring (H) preload by turning the preload adjuster clockwise.

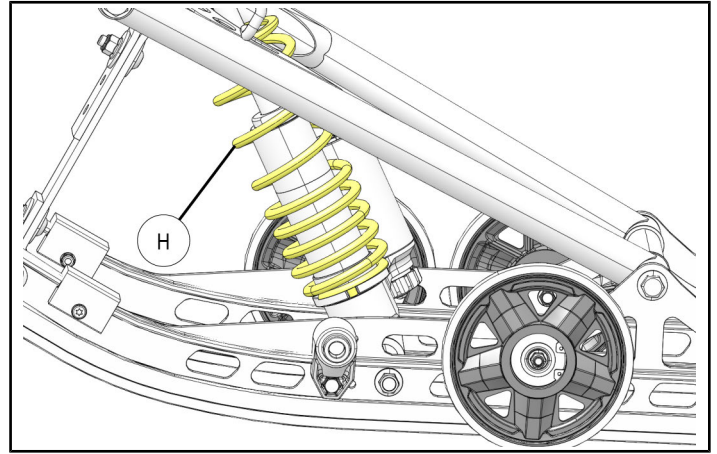

5. Remove the screw (J) and nut (K) securing the shock rod (L) to the front torque arm. Discard all hardware. New Hardware provided for reassembly.

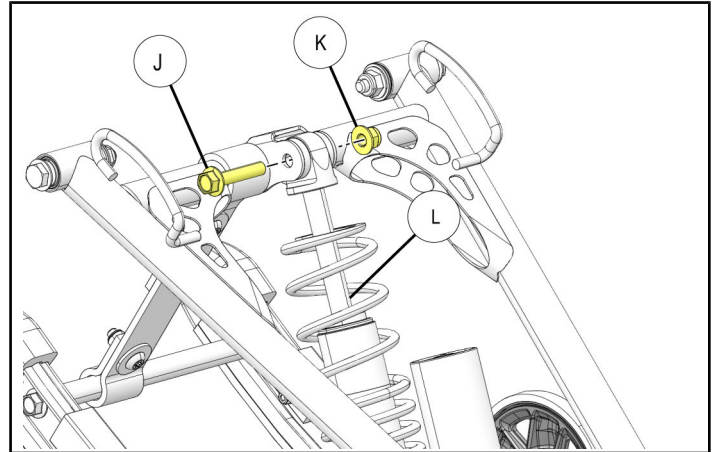

6. Remove two screws (M) securing the front track shock (FTS) cross shaft to the left and right rail beams. Note there is a washer (N) on each screw. Discard bolt only. New screw provided for reassembly.

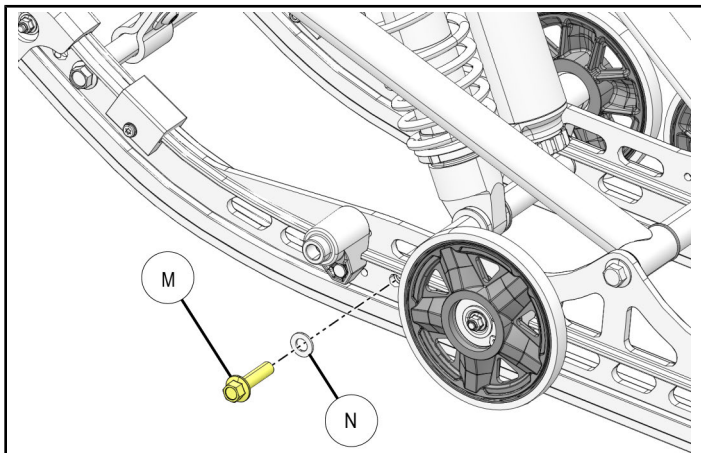

7. Slide the FTS cross shaft assembly rearward and at an angle to remove from the rail beams.

NOTE

The cross shaft washers will stay in the rail beams. Do not misplace these washers.

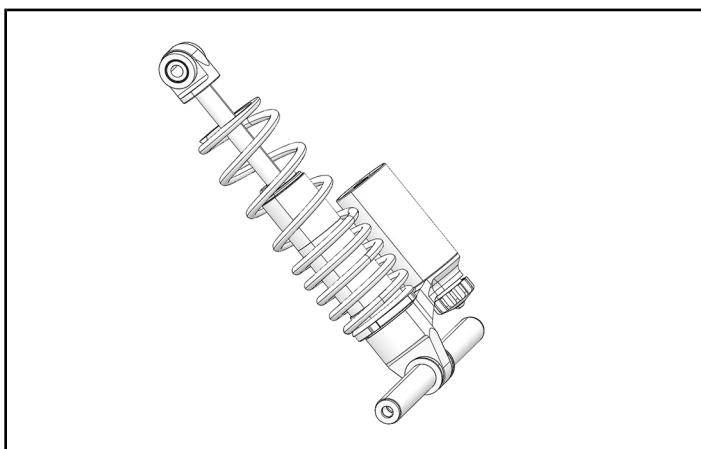

8. With the assembly removed, the shock can be removed from the cross shaft.

Ref	Description
P	Cross shaft
Q	Spacer
R	Washer (.813" x .406" x .105")
S	Washer (.719" x 1.25" x .065")

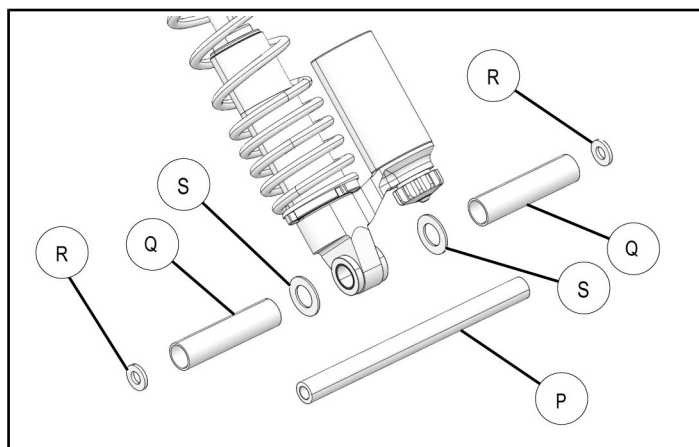

9. Inspect the cross shaft mounting holes in the left and right rail beams. If the holes are elongated, the rail(s) must be replaced.
10. Clean the cross shaft rail beam fastener threads and apply Loctite 263 to the threads.
11. Begin to reassemble with existing hardware verifying the cross shaft washers are installed between the cross shaft and rail beams. Assemble as shown in assembly. Note proper reservoir orientation for new shock ① as shown below.

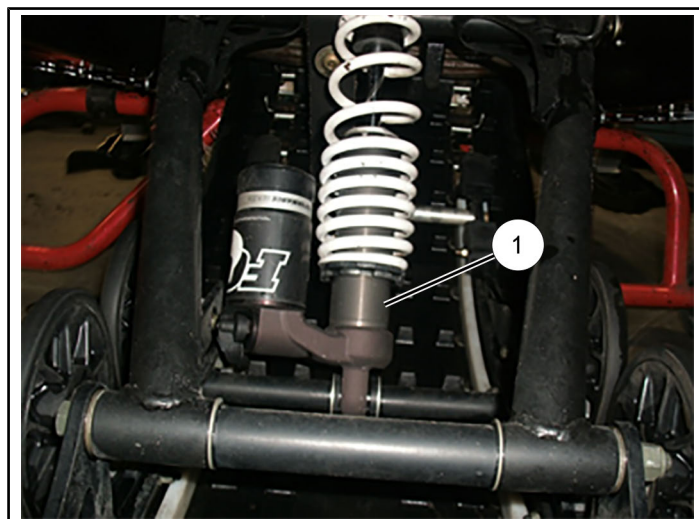

12. Once lower shock mounting components are accurately reassembled and aligned within rails. Use new screws ⑨ from kit to fasten back onto rails. Note there is a washer (N) that needs to be placed onto each screw. Ensure the Fox shock reservoir is orientated properly as shown above.

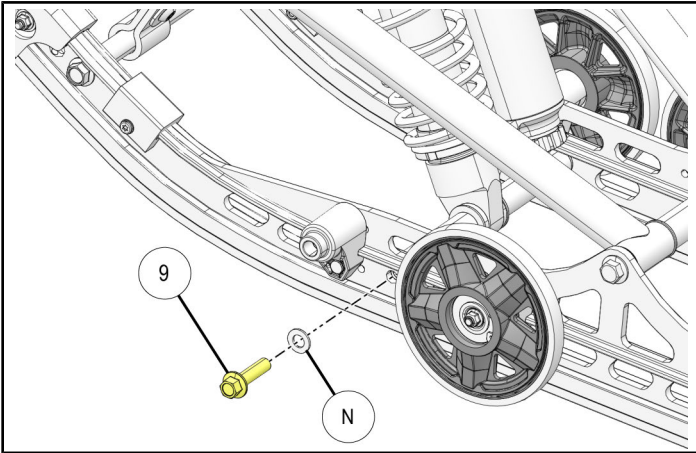

13. Using new hardware provided from kit, place new bushing ④ into upper shock rod ①. Place shock into skid for mounting. Place new screw ⑧ through shock rod mounting and torque arm bracket as shown below in assembly from left to right and tighten with nut ⑩.

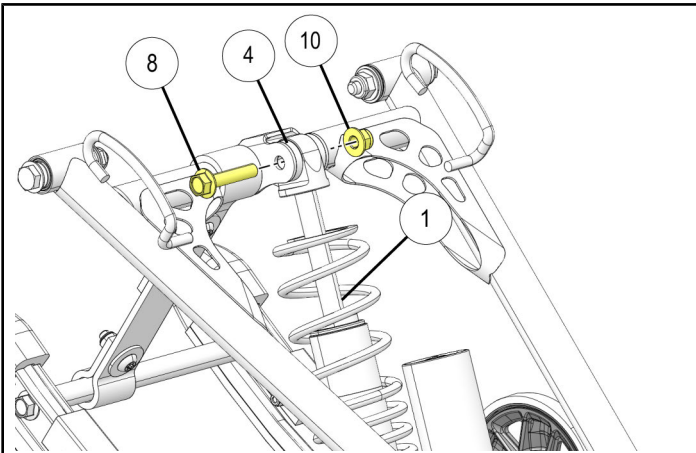

14. Assemble bogey wheels back onto rails. Note the orientation of the screws (E), washers (F), and nuts (G). Bolt will come from the inside out with the washer and nut on the outside.

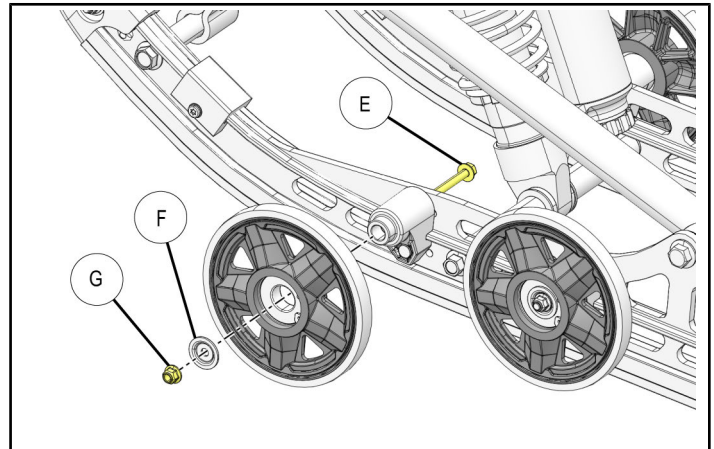

15. Secure the limiter strap (D). Lower the front of the track onto a floor jack. Jack the front of the suspension upwards until the limiter strap screw (A) can be installed. Note where the limiter strap screw is installed and utilize existing washer (B) and nut (C).

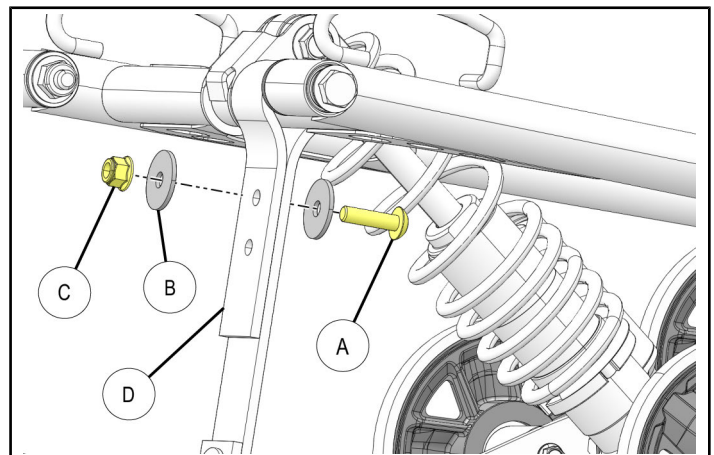

16. Reset the FTS spring preload to the measurement per guidance card.

17. Torque fasteners / lock nuts to specifications.

TORQUE

FTS Service Torque Specification:
 FTS Cross Shaft Rail Beam Screws ⑨ : 50 ft. lbs.
 (67 Nm) Apply Loctite 263
 Shock Rod-Front Toque Arm Lock Nut ⑩ : 33 ft. lbs.
 (45 Nm)
 Bogie Wheel Lock Nuts (G) : 10 ft. lbs. (13.6 Nm)
 Limiter Strap Lock Nuts (C) : 12 ft. lbs. (16 Nm)

FOX REAR TRACK AIR SHOCK INSTALLATION

1. Remove the screw (T) securing the seat (U) to the seat bracket. Remove the seat.

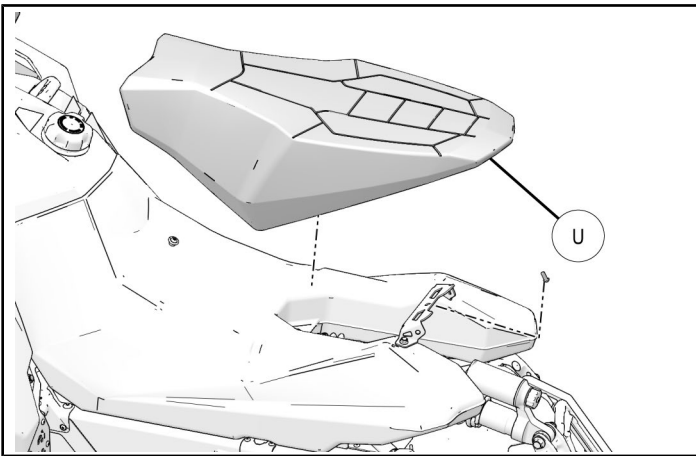
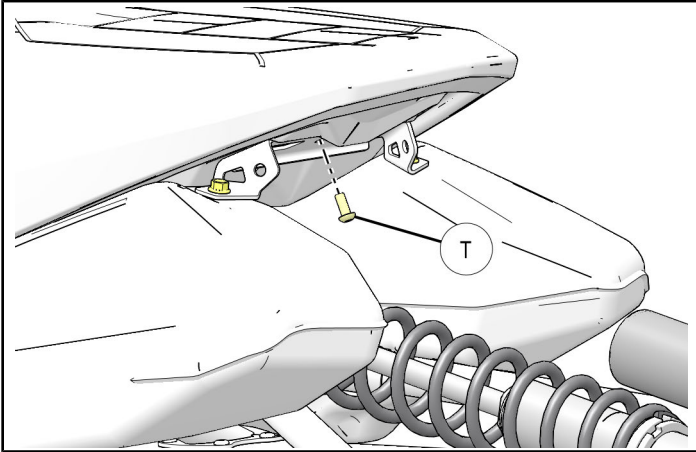

2. Remove the screw (V) securing the fuel tank to the rear track shock mount.

NOTE

If vehicle is equipped with a rear cargo rack remove cargo rack before proceeding.

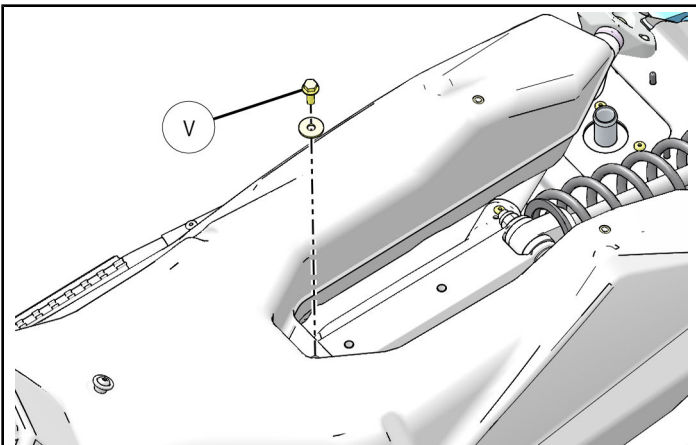

3. Gently raise and block the rear of the fuel tank enough to remove the forward shock mounting bolt (W) and nut (Y). Remove the bolt (W) and nut (Y) securing the shock to the X-brace and rear pivot.

NOTE

The screw securing the fuel tank on the X-Brace may have to be removed to allow the fuel tank to move to access the shock fastener. Do not shift the fuel tank too far to the left or right as it is secured at the front to the steering support.

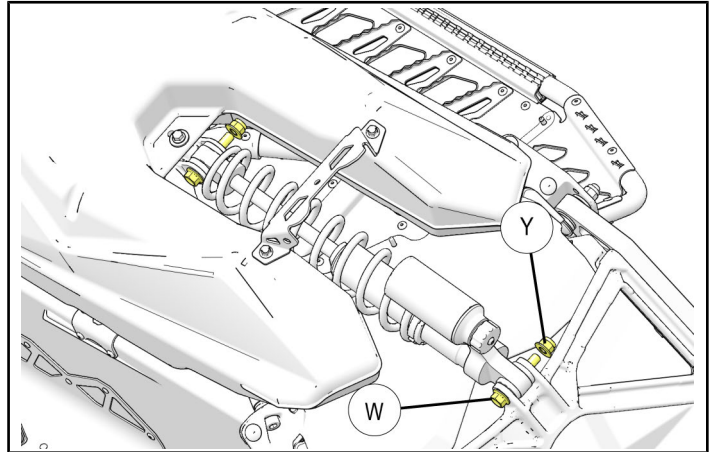

4. With the fuel tank still raised and moved slightly to the right, place the Fox air hose bracket ⑤ on left side of tunnel as shown. Using the bracket as a template mark and drill two 3/16" holes in the top of the tunnel. Using supplied rivets, rivet ⑪ the bracket ⑤ to the tunnel as shown below.

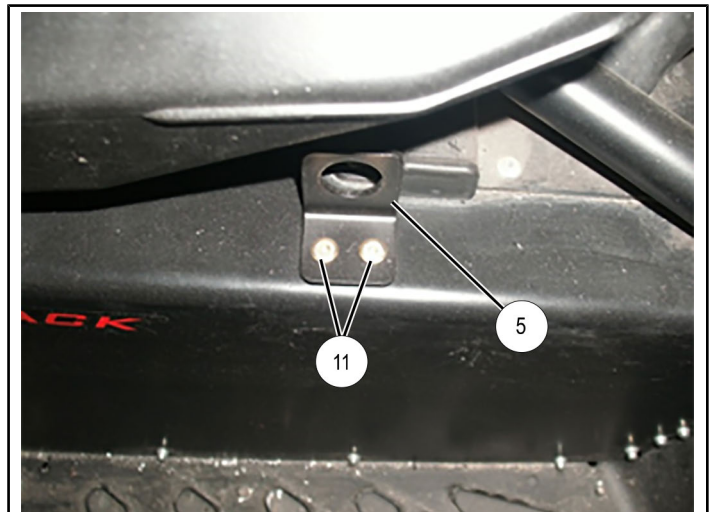

5. Place the new Fox air shock ② into position as shown below. Install new provided fasteners and torque to below specification. Route air filler hose as shown below.

NOTE

35 ft. lbs. (47.45 Nm)

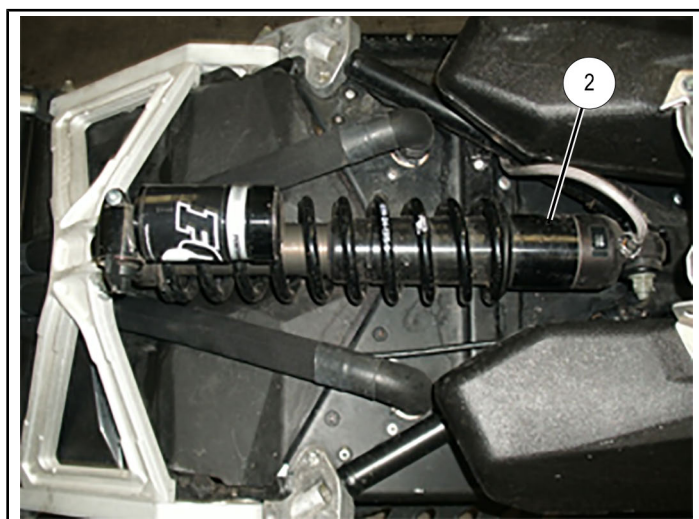

6. Install air fill assembly in bracket that was previously installed on tunnel and tighten lock nut as shown.



7. Reposition fuel tank in proper position and install fuel tank fastener. If vehicle is equipped with a rear cargo rack, reinstall cargo rack. Reinstall seat and seat fastener.
8. Clean tunnel side directly below the air fill port with alcohol or other suitable cleaner/degreaser and install the Fox setup decal ⑦.