

2" FRONT TRACK SHOCK KIT



P/N 2881947

APPLICATION

AXYS Trail Performance and Crossover 120-137

BEFORE YOU BEGIN

Read these instructions and check to be sure all parts and tools are accounted for. Please retain these installation instructions for future reference and parts ordering information.

KIT CONTENTS

This Kit includes:

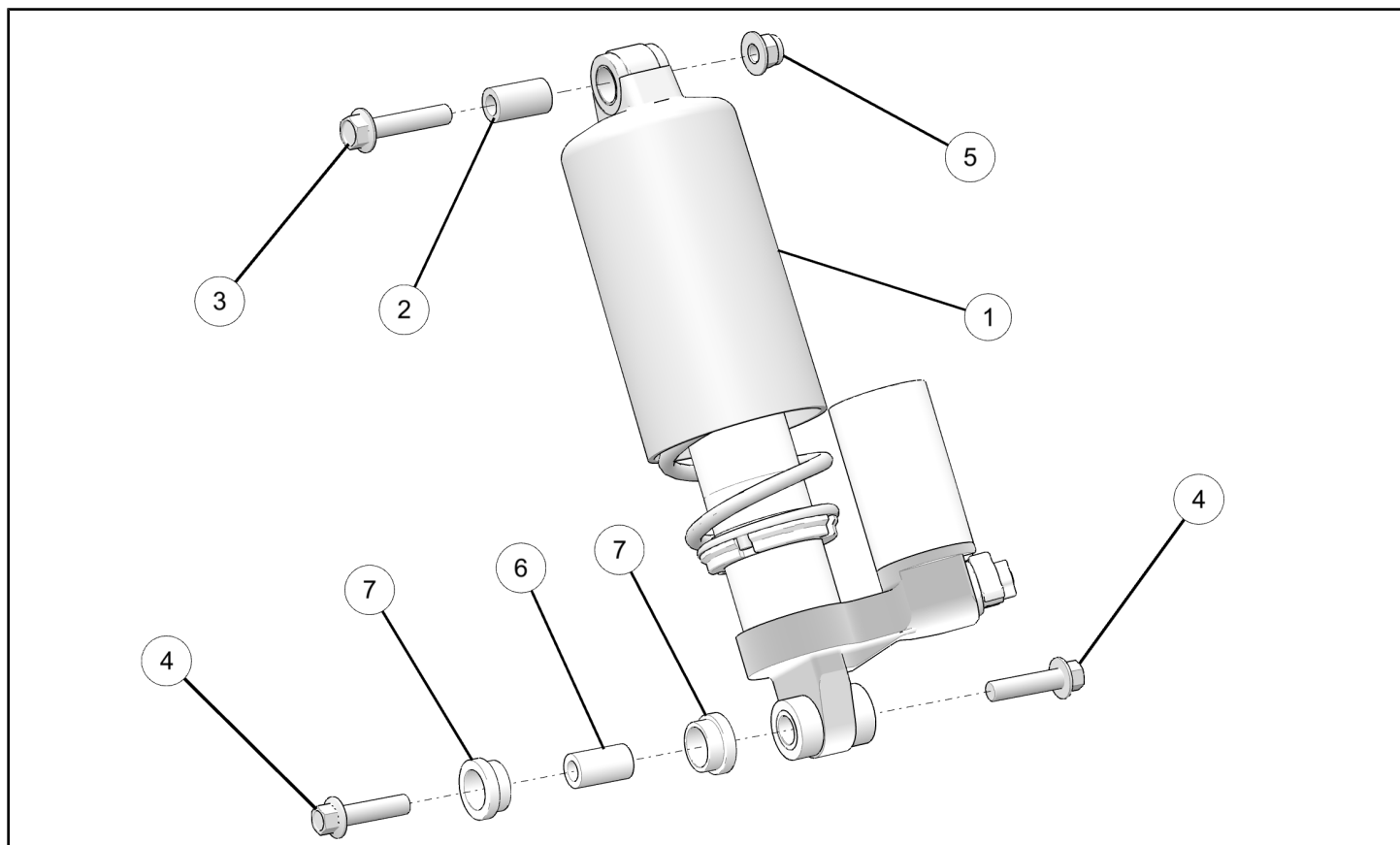

REF	QTY	PART DESCRIPTION	PART NUMBER
1	1	Shock Assembly, Front Track	1543713
2	1	Bushing - M10 X 17.5 X 30	5137360
3	1	Screw - M10 X 1.5 X 50	7518971
4	2	Screw, Hex Flange - M10 X 1.5 X 40	7519216
5	1	Nut - M10 X 1.5	7547423
6	1	Sleeve (Upfit for Pro-S and Pro-X models)	5140639
7	2	Bushing (Upfit for Pro-S and Pro-X models)	5415927
	1	Instructions	9927059

TOOLS REQUIRED

- Safety Glasses
- 15mm Wrench or Socket (2X)
- Torque Wrench
- Floor Jack
- 3/8" Ratchet
- 13mm Socket
- 10mm Socket
- 10mm Wrench

IMPORTANT

Your 2" FRONT TRACK SHOCK KIT is exclusively designed for your vehicle. Please read the installation instructions thoroughly before beginning. Installation is easier if the vehicle is clean and free of debris. For your safety, and to ensure a satisfactory installation, perform all installation steps correctly in the sequence shown.

ASSEMBLY TIME

Approximately 2 hours

INSTALLATION INSTRUCTIONS

1. With the snowmobile sitting on a flat surface, note where the limiter strap screw (A) is installed. Remove the screw (A), washers (B), and nut (C) securing the top of the limiter strap (D) to the front torque arm cross shaft. Retain hardware for reassembly.

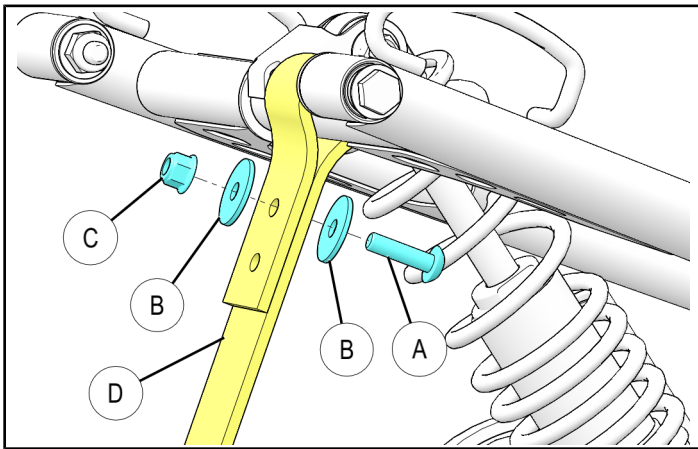

2. Using a hoist, raise the snowmobile by running boards. Do not lift snowmobile by the rear bumper, as doing so will compress the rear track shock.
3. To access the front track shock (FTS) lower cross shaft rail beam screws, remove the left and right bogie wheels. Note the orientation of the screws (E), washers (F), and nuts (G).

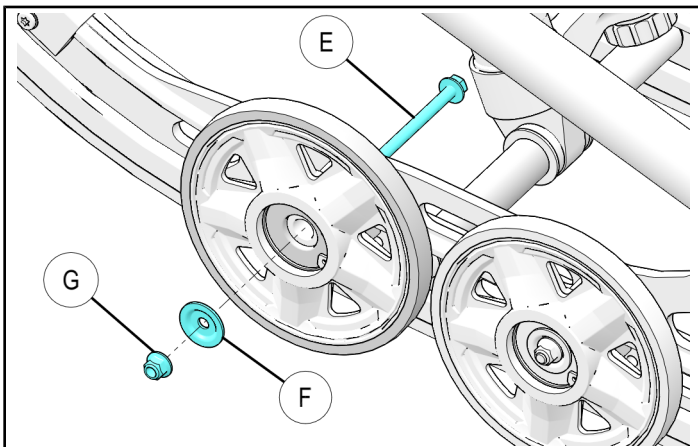

4. Remove screw (H) and nut (J) and the bushing securing shock rod (K) to the front torque arm. Discard all hardware and bushing.

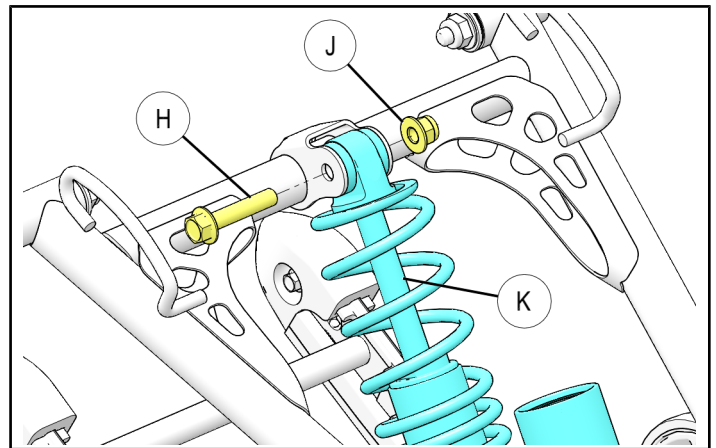

5. Remove two screws (L) securing the front track shock (FTS) cross shaft to the left and right rail beams. Note there is a washer (M) on each screw. Discard screw (L) and retain the washer (M). New screw ④ is provided in the kit for reassembly.

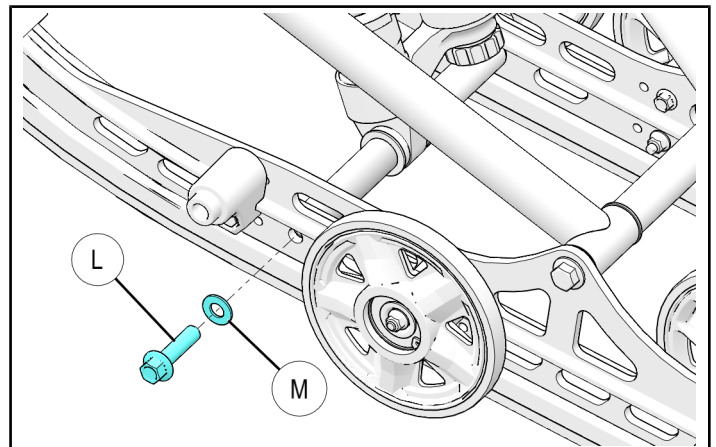

6. Slide the front track shock (FTS) cross shaft assembly rearward and at an angle to remove from the rail beams.

NOTE

The cross shaft washers (N) will stay in the rail beams. Do not misplace these washers.

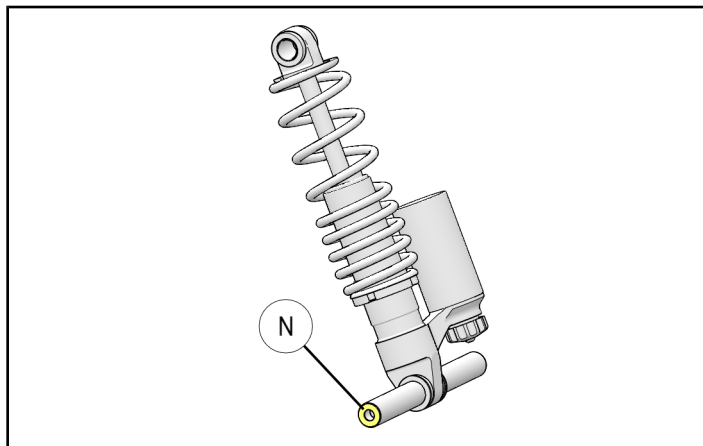

7. With the assembly removed, the shock can be removed from the cross shaft.

Ref	Description
P	Cross shaft
Q	Spacer
N	Washer (.813" x .406" x .105")
R	Washer (.719" x 1.25" x .065")

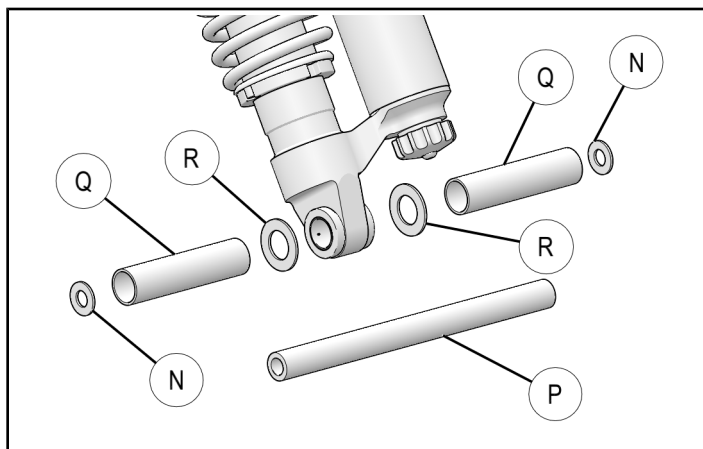

8. Inspect the cross shaft mounting holes in the left and right rail beams. If the holes are elongated, the rail(s) must be replaced.
9. Clean the cross shaft rail beam fastener threads and apply Loctite™ 263 to the threads.

10. Begin to reassemble with existing hardware verifying the cross shaft washers (N) are installed between the cross shaft (P) and rail beams. Assemble as shown below.

IMPORTANT

New shock reservoir orientation should be on the right side when installed on the sled as shown.

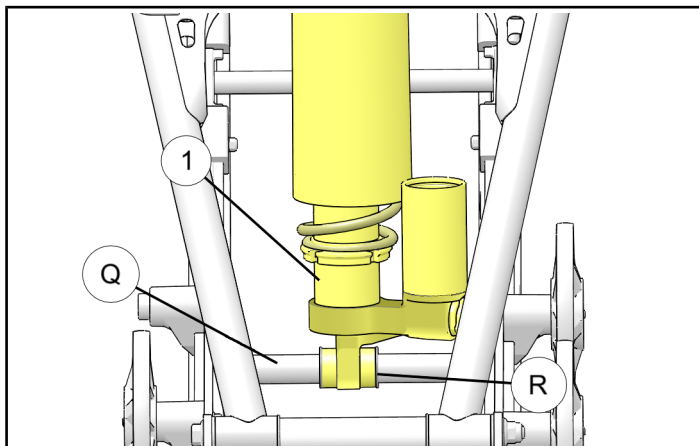

NOTE

For installing shock kit on Pro-S and Pro-X models, remove existing lower bushings (S) and inner sleeve from shock assembly ① and replace with new sleeve ⑥ and bushings ⑦ provided in the kit.

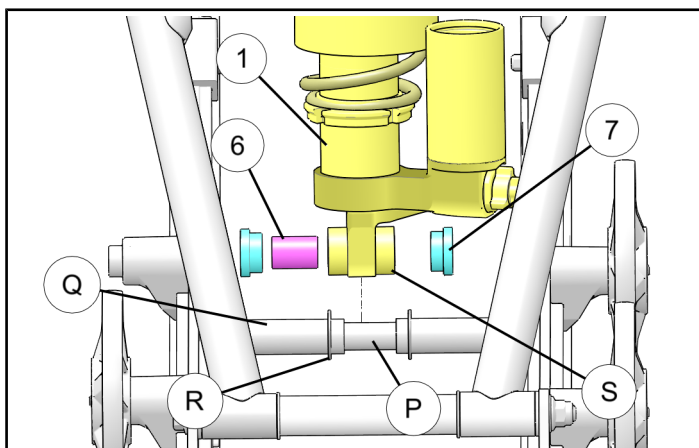

11. Once lower shock mounting components are accurately reassembled and aligned within rails, use new screws ④ from kit to fasten back onto rails.

NOTE

There is a washer (M) that needs to be placed onto each screw ④. Ensure the shock reservoir is orientated properly as shown above.

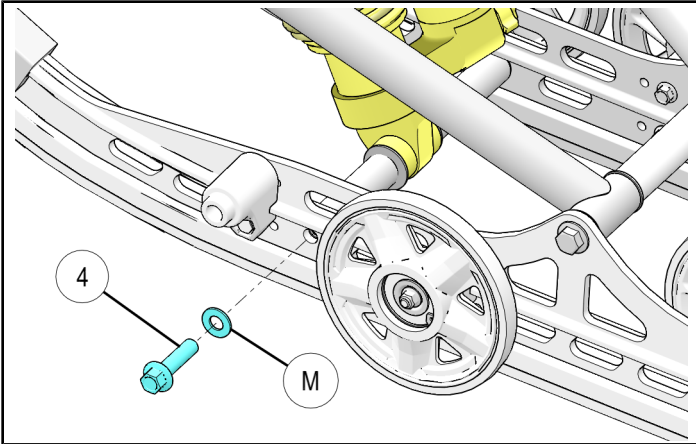

12. Using new hardware provided in the kit, place new bushing ② into upper shock rod ①. Install new screw ③ through shock rod mounting and front torque arm bracket as shown below in assembly from left to right and tighten with nut ⑤.

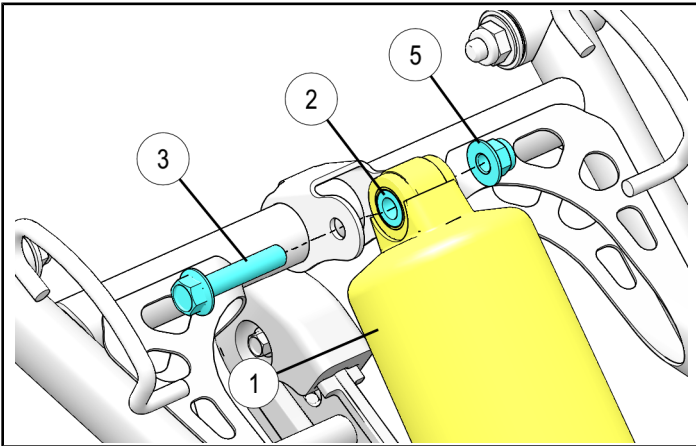

13. Assemble bogie wheels back onto rails. Note the orientation of the screws (E), washers (F), and nuts (G). screws (E) will come from the inside out with the washer (F) and nut (G) on the outside.

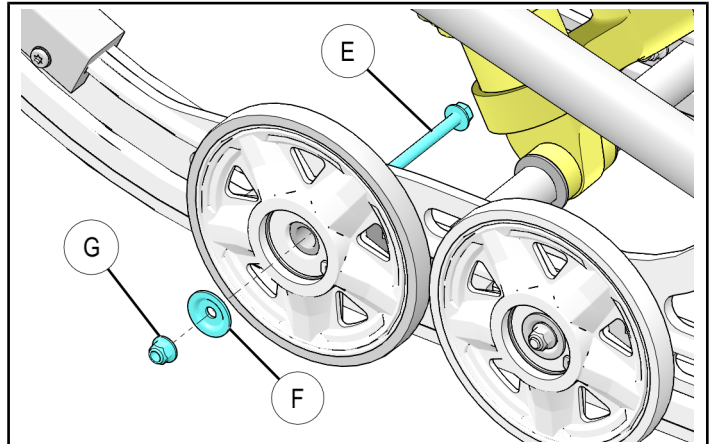

14. Secure the limiter strap (D). Lower the front of the track onto a floor jack. Jack the front of the suspension upwards until the limiter strap screw (A) can be installed. Note where the limiter strap screw is installed and utilize existing washers (B) and nut (C).

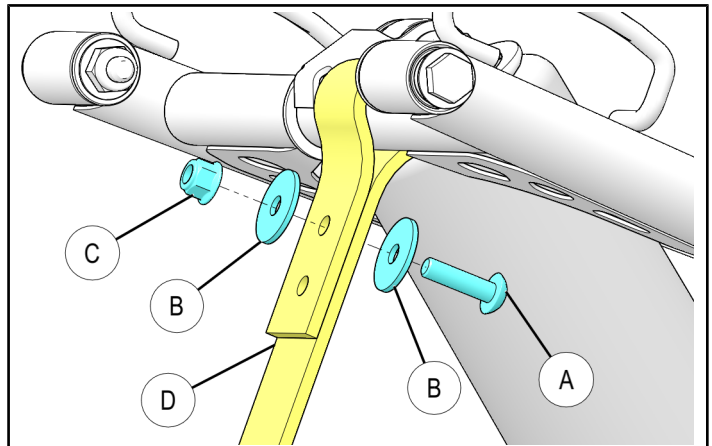

15. Torque fasteners/lock nuts to specification.

TORQUE

FTS Service Torque Specification:
 FTS Cross Shaft Rail Beam Screws ④ : 50 ft. lbs.
 (67 Nm), Apply Loctite™ 263
 Shock Rod-Front Toque Arm Lock Nut ⑤ : 33 ft. lbs.
 (45 Nm)
 Bogie Wheel Lock Nuts (G) : 10 ft. lbs. (13.6 Nm)
 Limiter Strap Lock Nut (C) : 12 ft. lbs. (16 Nm)