

SWAY BAR KIT



P/N 2881950

APPLICATION

Axys Rush, Switchback, Switchback Assault, and Switchback SP

BEFORE YOU BEGIN

Read these instructions and check to be sure all parts and tools are accounted for. Please retain these installation instructions for future reference and parts ordering information.

KIT CONTENTS

This Kit includes:

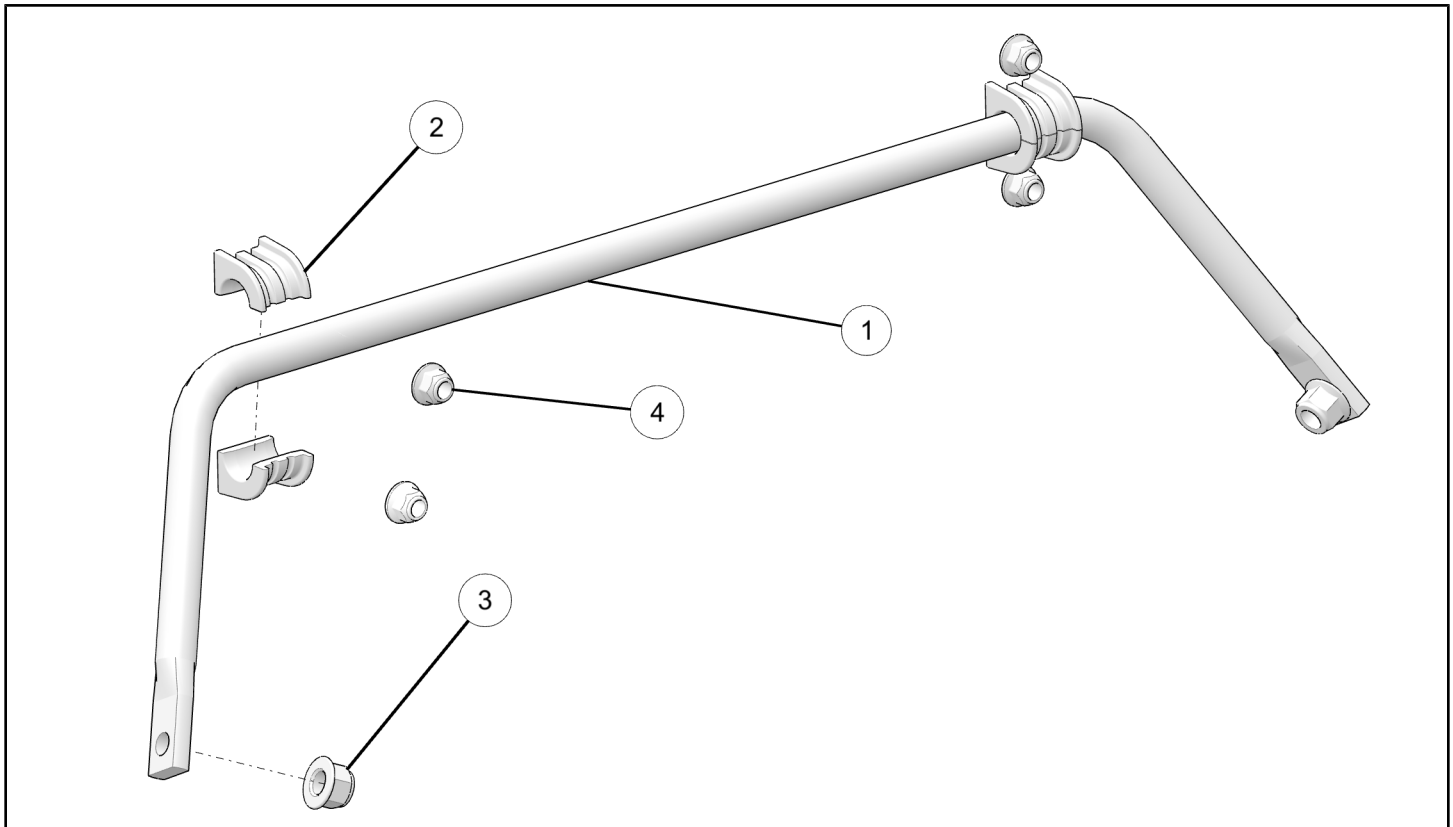

REF	QTY	PART DESCRIPTION	PART NUMBER
1	1	Sway Bar	5252629
2	4	Bushing	5437540
3	2	Nut - M8 X 1.25	7547332
4	4	Nut - M6 X 1.0	7547339
	1	Instructions	9927061

TOOLS REQUIRED

- Safety Glasses
- 10mm Socket
- 13mm Socket
- Torque Wrench
- Ratchet Wrench
- 11mm Wrench

IMPORTANT

Your SWAY BAR KIT is exclusively designed for your vehicle. Please read the installation instructions thoroughly before beginning. Installation is easier if the vehicle is clean and free of debris. For your safety, and to ensure a satisfactory installation, perform all installation steps correctly in the sequence shown.

ASSEMBLY TIME

Approximately 15 minutes

INSTALLATION INSTRUCTIONS

1. Use the 11mm wrench and the 13mm socket with ratchet wrench to remove the sway bar (B) link joints on each side of the sled by removing two nuts (A) from stud (C). Discard the nuts.

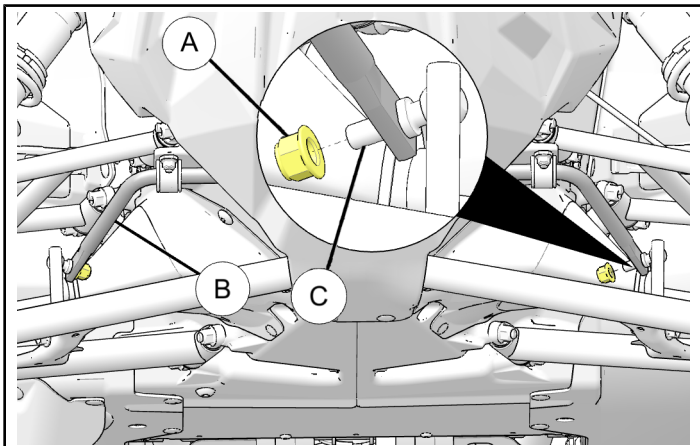

2. Use the 10mm socket and ratchet wrench to remove the four nuts (D) and mounting clamps (E) that secure the sway bar bushing mounts (F). Discard the nuts, bushing mounts and retain mounting clamps for reuse.

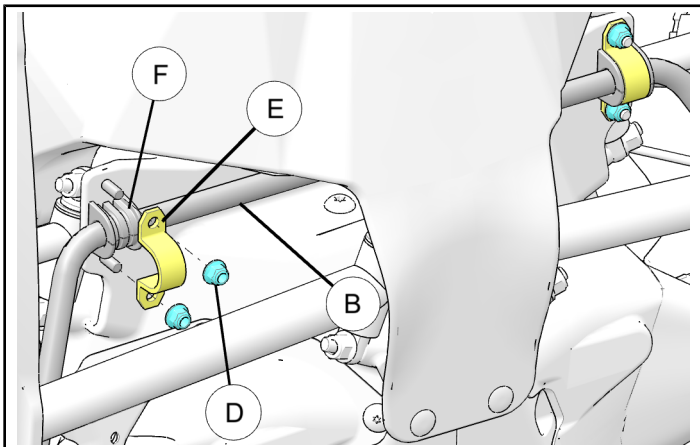

3. Remove sway bar (B) and bushings (F) from vehicle.

4. Install the four nuts (4) and retained mounting clamps (E) that secure the sway bar bushing mounts (2). Torque nut to specification.

TORQUE

7 ft. lbs. (9.49 Nm)

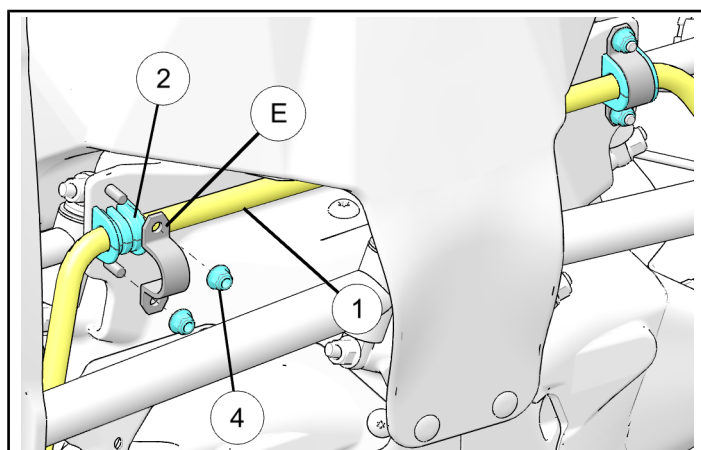

5. Install the sway bar (1) link joints on each side of the sled by installing two nuts (3) on stud (C). Torque nuts to specification.

TORQUE

20 ft. lbs. (27.11 Nm)

