

# WALKER EVANS CROSSOVER FRONT TRACK SHOCK KIT

P/N 2881971



## APPLICATION

AXYS Switchback only

## BEFORE YOU BEGIN

Read these instructions and check to be sure all parts and tools are accounted for. Please retain these installation instructions for future reference and parts ordering information.

## KIT CONTENTS

This Kit includes:

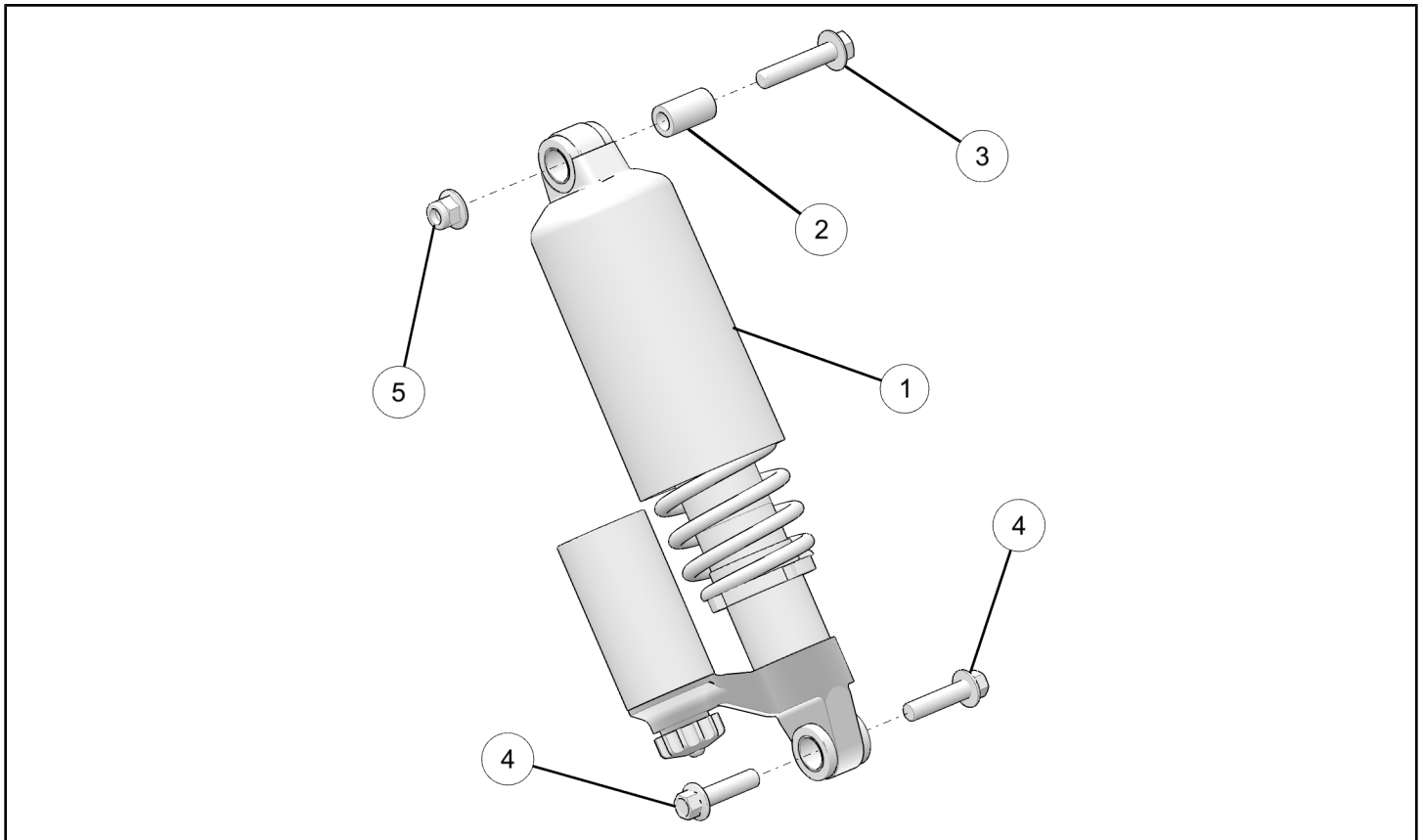

REF	QTY	PART DESCRIPTION	PART NUMBER
1	1	Shock Assembly, Front Track	1543562
2	1	Bushing - M10 X 17.5 X 30	5137360
3	1	Screw - M10 X 1.5 X 50	7518971
4	2	Screw, Hex Flange - M10 X 1.5 X 40	7519216
5	1	Nut - M10 X 1.5	7547423
	1	Instructions	9927077

## TOOLS REQUIRED

- 15mm Wrench or Socket (2X)
- Torque Wrench
- Floor Jack
- 3/8" Ratchet
- 13mm Socket
- 10mm Socket
- 10mm Wrench

## IMPORTANT

Your WALKER EVANS CROSSOVER FRONT TRACK SHOCK KIT is exclusively designed for your vehicle. Please read the installation instructions thoroughly before beginning. Installation is easier if the vehicle is clean and free of debris. For your safety, and to ensure a satisfactory installation, perform all installation steps correctly in the sequence shown.

## ASSEMBLY TIME

Approximately 2 hours

## INSTALLATION INSTRUCTIONS

1. Turn key to "OFF" and remove from vehicle.
2. Remove rear skid from the snowmobile following instructions outlined in the service manual.
3. With the skid sitting on a flat surface, note where the limiter strap screw (A) is installed. Remove the screw (A), washer (B) and nut (C) securing the top of the limiter strap (D) to the front torque arm cross shaft. Keep hardware for reassembly.

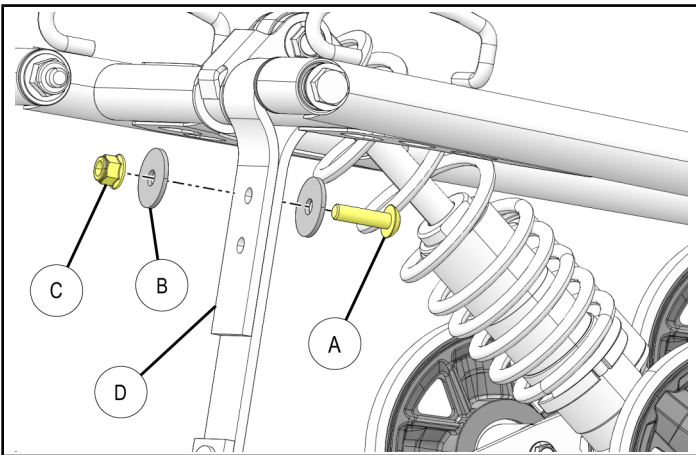

4. To access the front track shock (FTS) lower cross shaft rail beam screws, remove the left and right bogie wheels. Note the orientation of the screws (E), washers (F) and nuts (G).

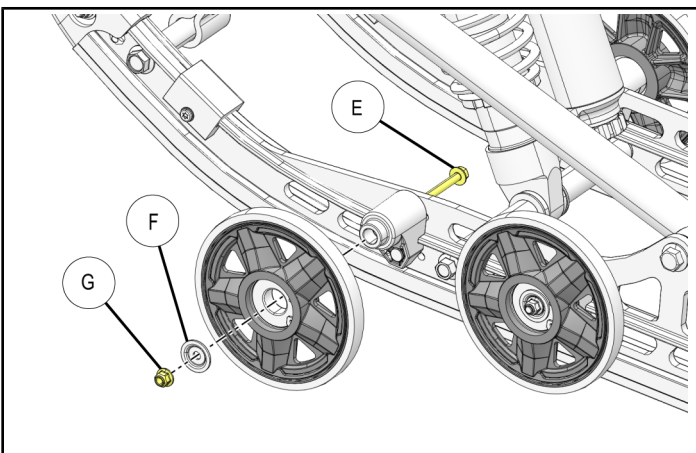

5. Measure the shock preload setting. Loosen the spring (H) preload by turning the preload adjuster clockwise.

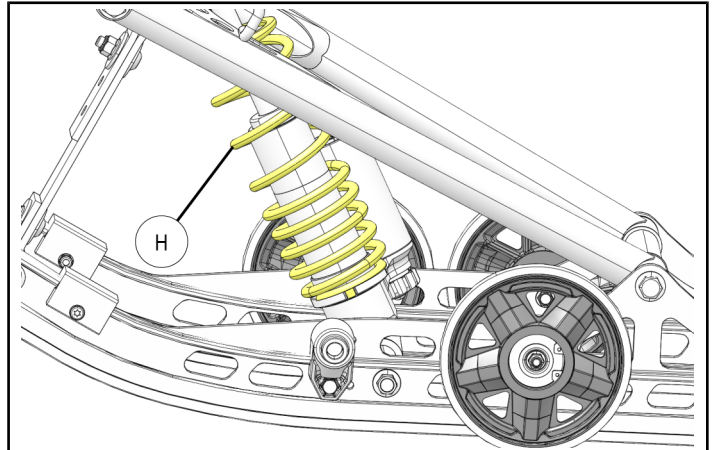

6. Remove the screw (J) and nut (K) securing the shock rod (L) to the front torque arm. Discard all hardware. New Hardware provided for reassembly.

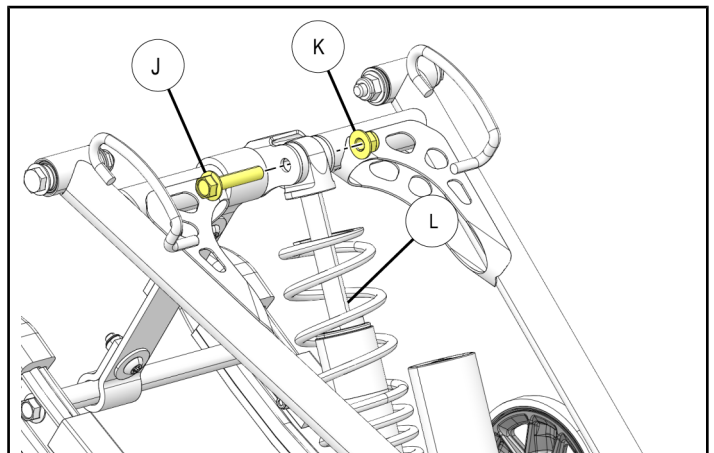

- Remove two screws (M) securing the front track shock (FTS) cross shaft to the left and right rail beams. Make sure to break both bolts loose before removing. Note there is a washer (N) on each screw. Discard bolt only. New screw provided for reassembly.

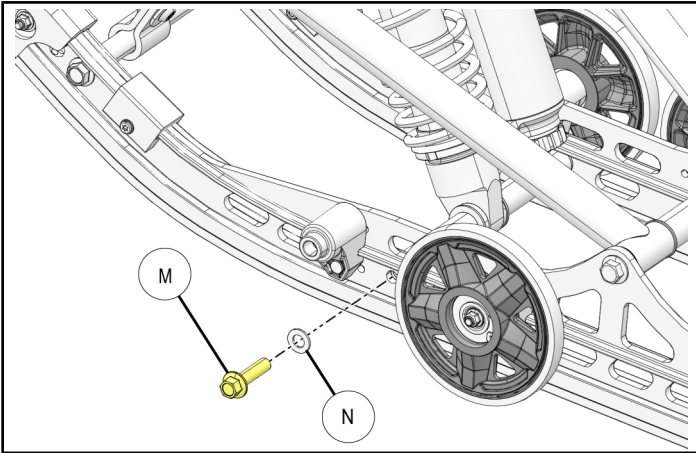

- Slide the FTS cross shaft assembly rearward and at an angle to remove from the rail beams.

#### NOTE

The cross shaft washers will stay in the rail beams. Do not misplace these washers.

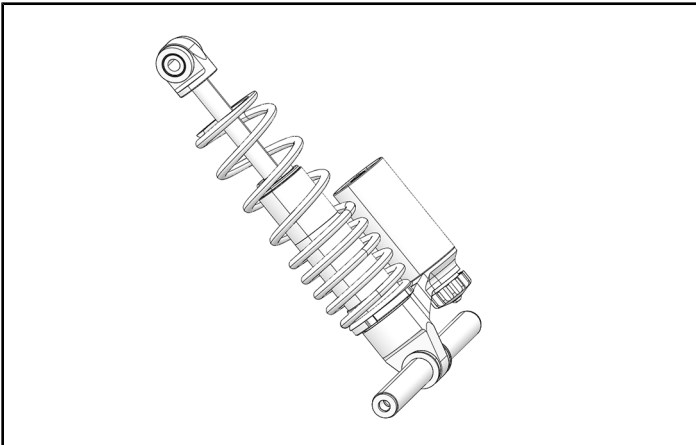

- With the assembly removed, the shock can be removed from the cross shaft.

Ref	Description
P	Cross shaft
Q	Spacer
R	Washer (.813" x .406" x .105")
S	Washer (.719" x 1.25" x .065")

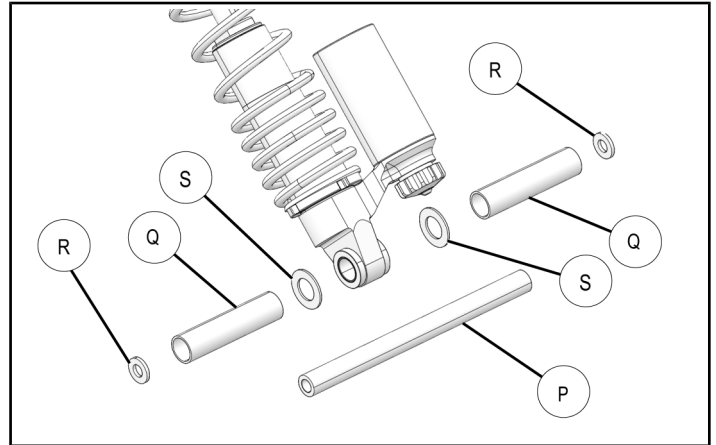

- Inspect the cross shaft mounting holes in the left and right rail beams. If the holes are elongated, the rail(s) must be replaced.
- Clean the cross shaft rail beam fastener threads and apply Loctite 263 to the threads.
- Begin to reassemble with existing hardware verifying the cross shaft washers are installed between the cross shaft and rail beams. Assemble as shown in assembly. Note proper reservoir orientation for new shock ① as shown below.

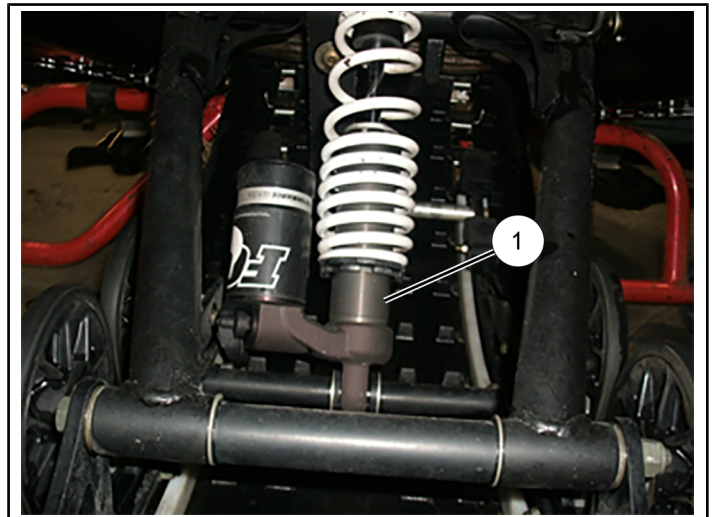

13. Once lower shock mounting components are accurately reassembled and aligned within rails. Use new screws ④ from kit to fasten back onto rails. Note there is a washer (N) that needs to be placed onto each screw. Ensure the shock reservoir is orientated properly as shown above.

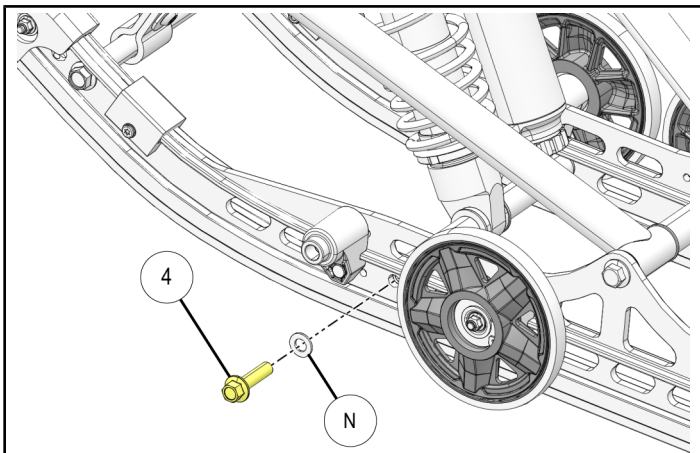

14. Using new hardware provided from kit, place new bushing ② into upper shock rod ①. Place shock into skid for mounting. Place new screw ③ through shock rod mounting and torque arm bracket as shown below in assembly from left to right and tighten with nut ⑤.

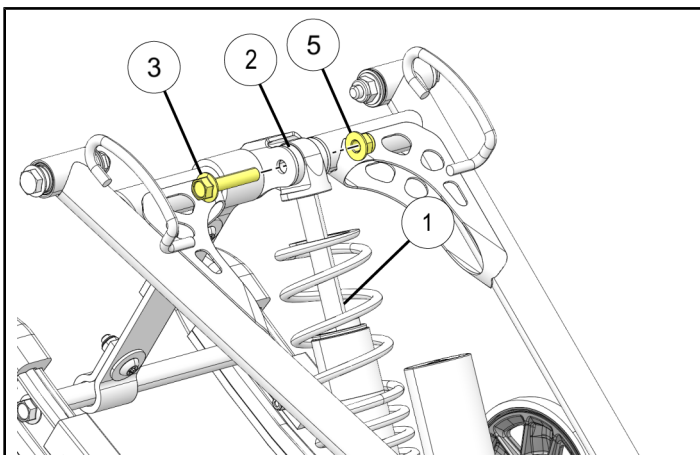

15. Assemble bogey wheels back onto rails. Note the orientation of the screws (E), washers (F), and nuts (G). Bolt will come from the inside out with the washer and nut on the outside.

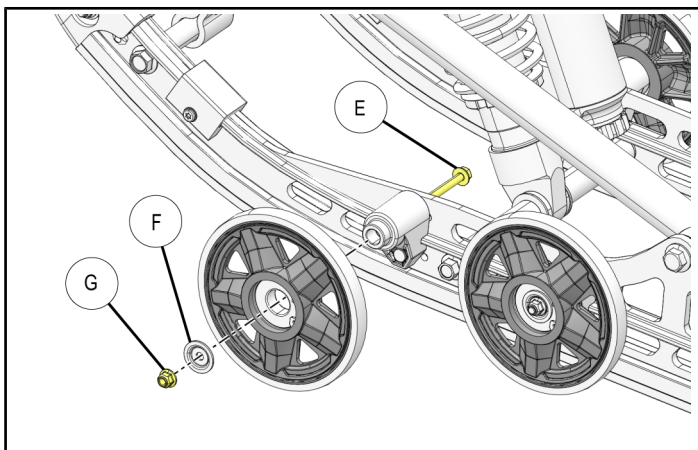

16. Reinstall skid into snowmobile according to service manual instructions.

17. Secure the limiter strap (D). Lower the front of the track onto a floor jack. Jack the front of the suspension upwards until the limiter strap screw (A) can be installed. Note where the limiter strap screw is installed and utilize existing washer (B) and nut (C).

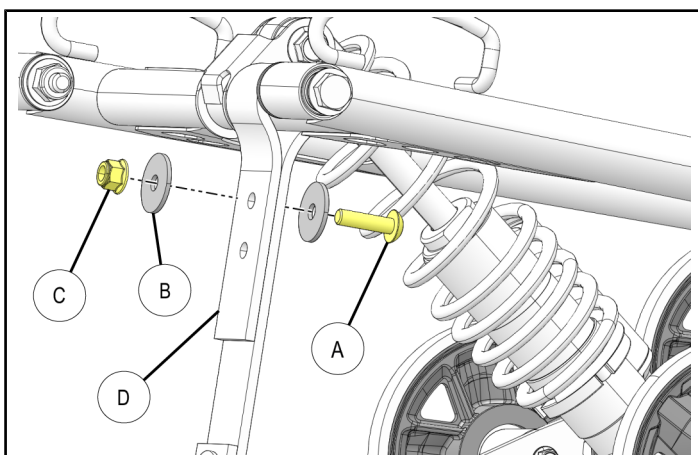

18. Reset the FTS spring preload to the measurement per guidance card.

19. Torque fasteners / lock nuts to specifications.

## TORQUE

FTS Service Torque Specification:  
 FTS Cross Shaft Rail Beam Screws ④ : 50 ft. lbs.  
 (67 Nm) Apply Loctite 263  
 Shock Rod-Front Toque Arm Lock Nut ⑤ : 33 ft. lbs.  
 (45 Nm)  
 Bogie Wheel Lock Nuts (G) : 10 ft. lbs. (13.6 Nm)  
 Limiter Strap Lock Nuts (C) : 12 ft. lbs. (16 Nm)