

HANDGUARD MOUNT KIT



P/N 2880939

APPLICATION

MY13 AND NEWER RUSH AND SWITCHBACK, INDY SP

BEFORE YOU BEGIN

Read these instructions thoroughly and make sure all parts and tools are accounted for. Please retain these installation instructions for future reference and parts ordering information.

KIT CONTENTS

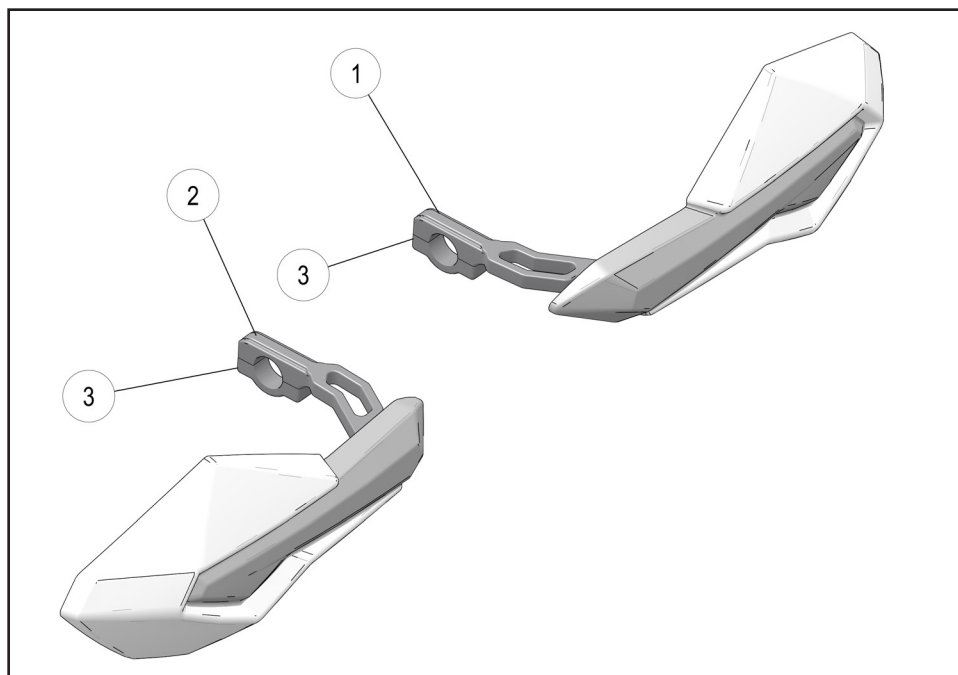

Ref	Qty	Part Description	Part Number
1	1	Mount-Handguard Top, LH	5139858
2	1	Mount-Handguard Top, RH	5139859
3	2	Mount-Handguard Bottom	5139860
	1	Instructions	9926278

TOOLS NEEDED

4 mm Hex Wrench

APPROXIMATE ASSEMBLY TIME

10 mins

IMPORTANT

Your Polaris HANDGUARD MOUNT KIT is exclusively designed for your vehicle. Please read the installation instructions thoroughly before beginning. Installation is easier if the vehicle is clean and free of debris. For your safety, and to ensure a satisfactory installation, perform all installation steps correctly in the sequence shown.

INSTALLATION INSTRUCTIONS

1. Match up the correct LH and RH top mounts (1, 2) with the LH and RH guards. The mounts are designed so that the clamp goes on the underside of the bars.
2. Install the top mount to handguard (A) by inserting the mount at an angle so that the peg can install in the hole closest to the face of the guard. See figure.

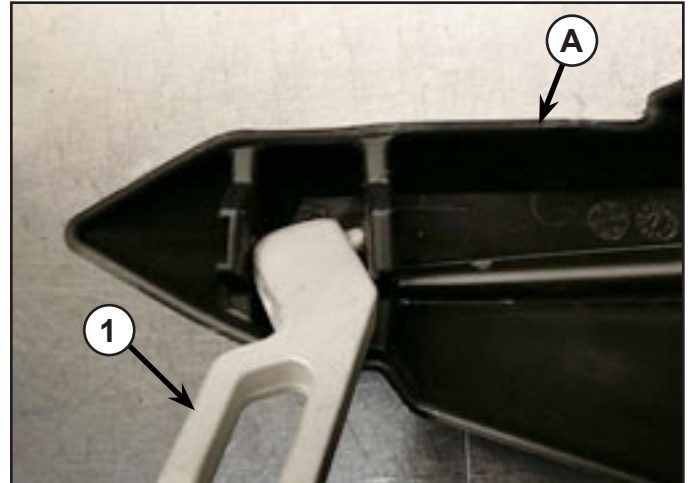

3. Pivot the mount so that that it falls naturally into the slot of the handguards. See figure.



4. Rotate the mount so that rearward holes line up with the second set of holes in the handguards. Line up nut plate (C) to the slot of the inboard mount and install the 35 mm long screw (B) and star washer from the outboard side. Tighten in the nut plate (C). See figure.
5. Mount the assembly to the handlebars in desired position and install secure with the bottom mount and two 15 mm long screws. Torque the screws to 2.95 ft. lbs. (4 Nm).

