

PREMIUM SEAT KIT

P/N 2882013, 2882014, 2882015, 2881975, 2881976, 2881977, 2881978



APPLICATION

Indy and RMK Models

BEFORE YOU BEGIN

Read these instructions and check to be sure all parts and tools are accounted for. Please retain these installation instructions for future reference and parts ordering information.

KIT CONTENTS

This Kit includes:

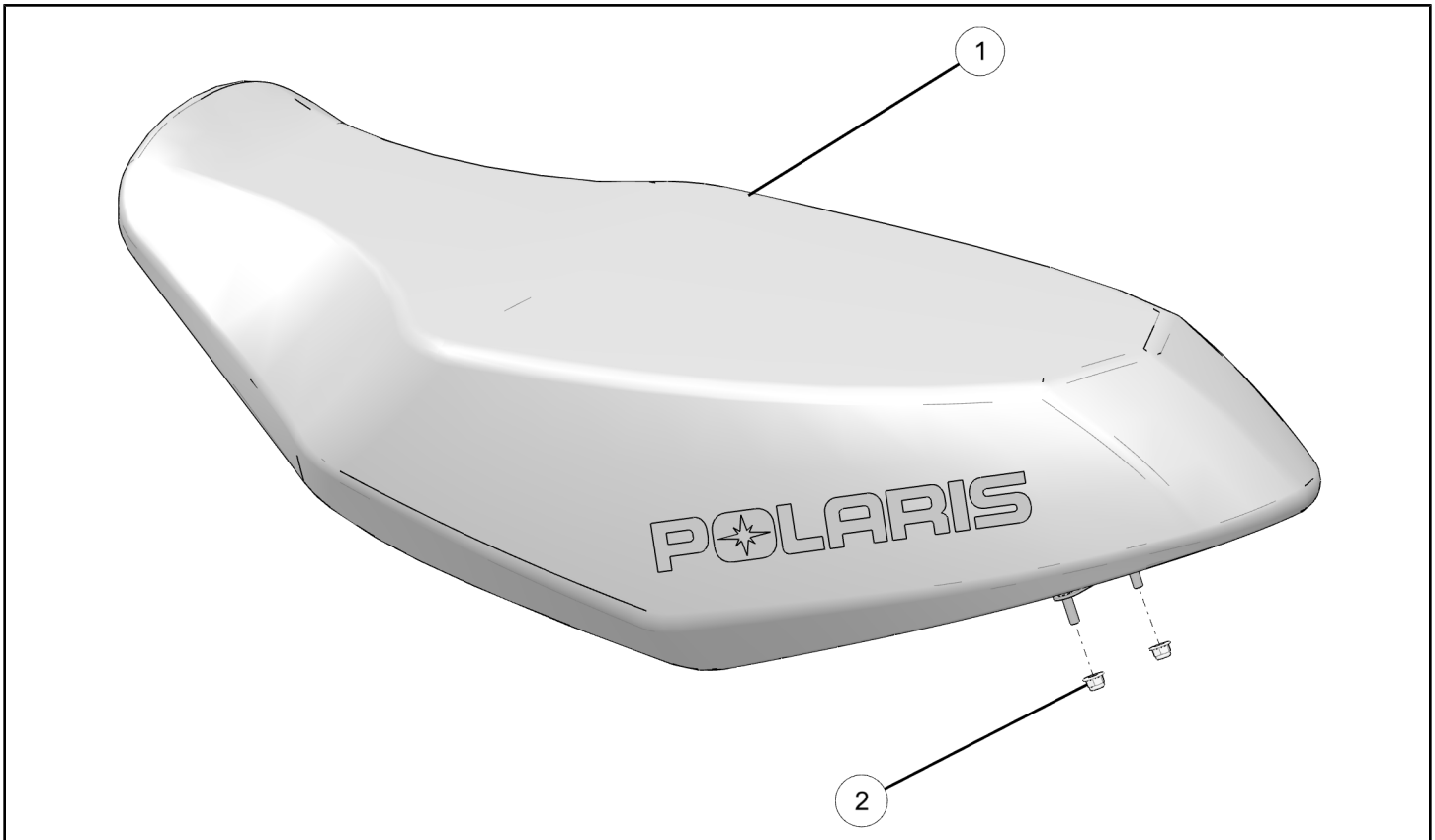

REF	QTY	PART DESCRIPTION	PART NUMBER
1	1	Seat Assembly	2686042, 2686495, 2687289, 2687406, 2686107, 2686475, 2686161
2	2	Nut, Hex Flange - M6 X 1.0	7547487
	1	Instructions	9927134

TOOLS REQUIRED

- 10mm Socket
- Ratchet Wrench
- Torque Wrench

IMPORTANT

Your PREMIUM SEAT KIT is exclusively designed for your vehicle. Please read the installation instructions thoroughly before beginning. Installation is easier if the vehicle is clean and free of debris. For your safety, and to ensure a satisfactory installation, perform all installation steps correctly in the sequence shown.

ASSEMBLY TIME

Approximately 15 minutes

INSTALLATION INSTRUCTIONS

1. Remove two nuts (A) from the seat hoop (B) as shown.

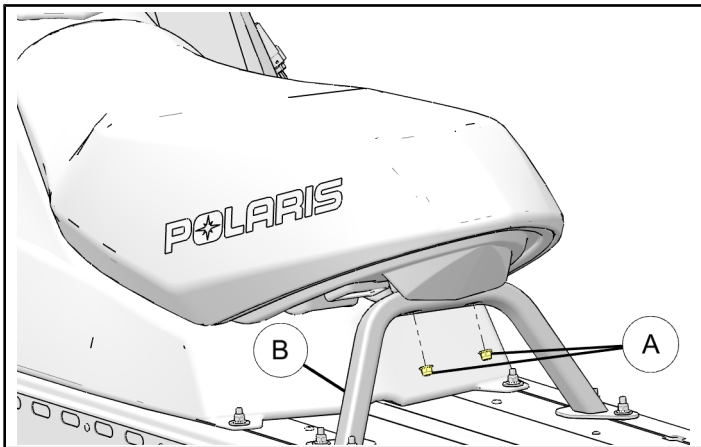

2. Pull up on rear of seat to disconnect from seat hoop.

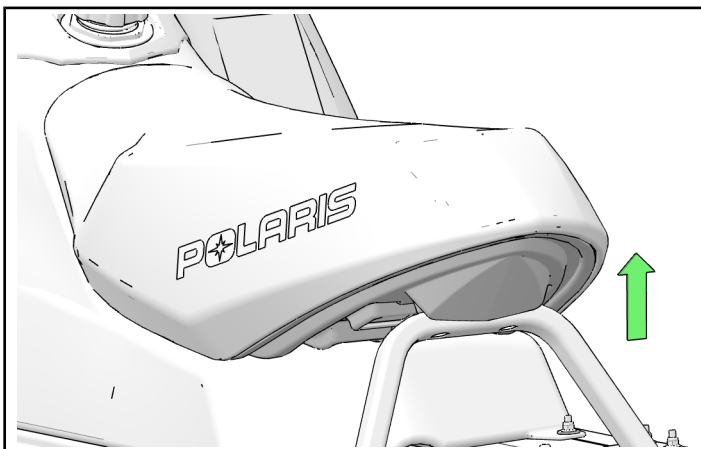

3. Install new kit supplied seat ① making sure that the front seat tab (D) mounted on the gas tank tab gets inserted into the slot (C) on the seat as shown.

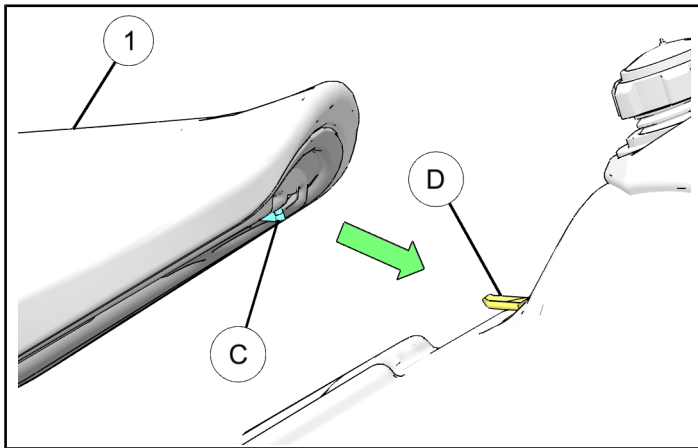

4. Insert seat studs (E) through two holes in the seat hoop and install new nuts ② onto the studs (E). Torque nuts ② to specification.

TORQUE

7 ft. lbs. (9.4 Nm)

