

DELUXE RACK INSTALLATION KIT



P/N 2880275

APPLICATION

POLARIS 550 INDY VOYAGER 155

BEFORE YOU BEGIN

Read these instructions thoroughly and make sure all parts and tools are accounted for. Please retain these installation instructions for future reference and parts ordering information.

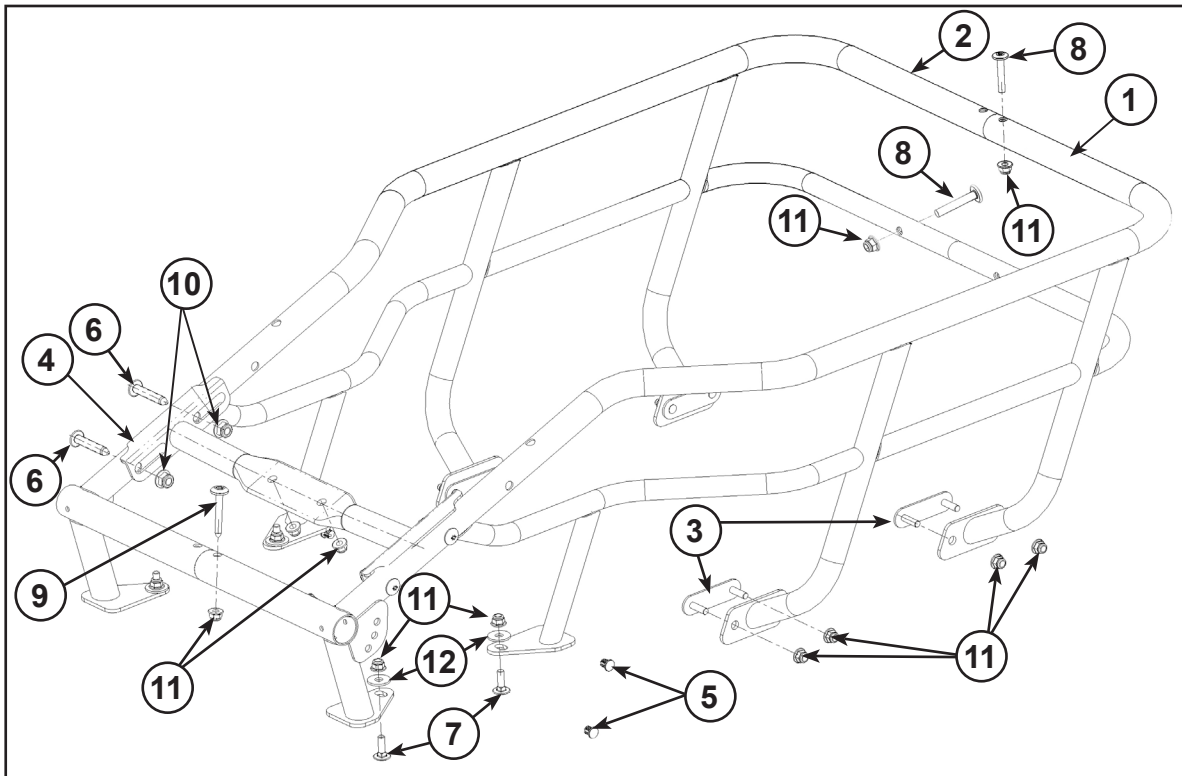

KIT CONTENTS

Ref	Qty	Part Description	Part Number
1	1	Weld - Deluxe Rack, LH	1020508
2	1	Weld - Deluxe Rack, RH	1020511
3	4	Stud Plate Assembly, M6X1.0	1020654
4	1	Weld Seat Mount	1020830
5	4	Clip-Dart, 10.8	5451583
6	4	Screw-5/16-18X1.75	7518235
7	4	Bolt-Carriage, M6X1.0X20 8.8	7518994
8	4	Screw, M6X1.0X35 8.8 TXPH	7519002
9	1	Screw-TXTH, M6X1.0X45	7519722
10	4	Nut-5/16-18, HX FLG	7542343
11	20	Nut-HXFL, M6X1.08	7547453
12	4	Washer, .28X.81X.06	7555935
	1	Instructions	9925400

TOOLS NEEDED

Metric Socket Set
Philips Screwdrivers

Metric Wrench Set
Torx Wrench

Pliers

APPROXIMATE ASSEMBLY TIME

30 - 45 mins

IMPORTANT

Your Polaris DELUXE RACK INSTALLATION KIT is exclusively designed for your vehicle. Please read the installation instructions thoroughly before beginning. Installation is easier if the vehicle is clean and free of debris. For your safety, and to ensure a satisfactory installation, perform all installation steps correctly in the sequence shown.

INSTALLATION INSTRUCTIONS

1. Remove seat (A) by removing two M6 nuts (B) from weld support (C).

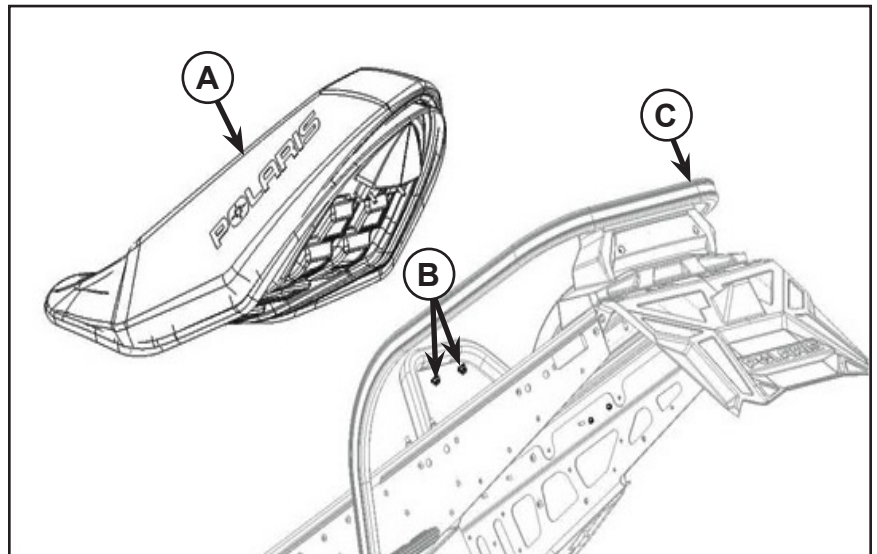

2. Remove four M6 nuts (B) and relevant washers (D) to remove weld support (C) and also remove four M6 bolts (E) by slide from tunnel panel.

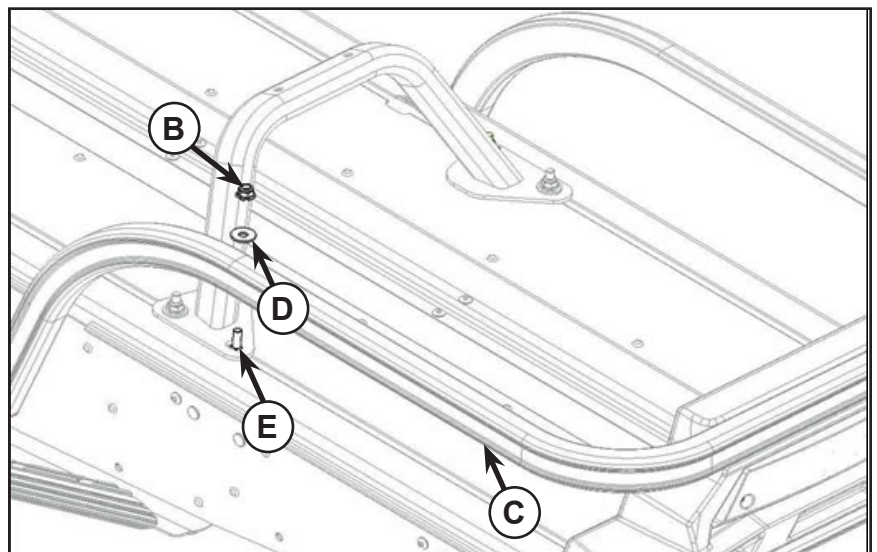

3. Remove taillight cover plate (G) by removing four screws (F) as shown. Retain the screws for reuse.

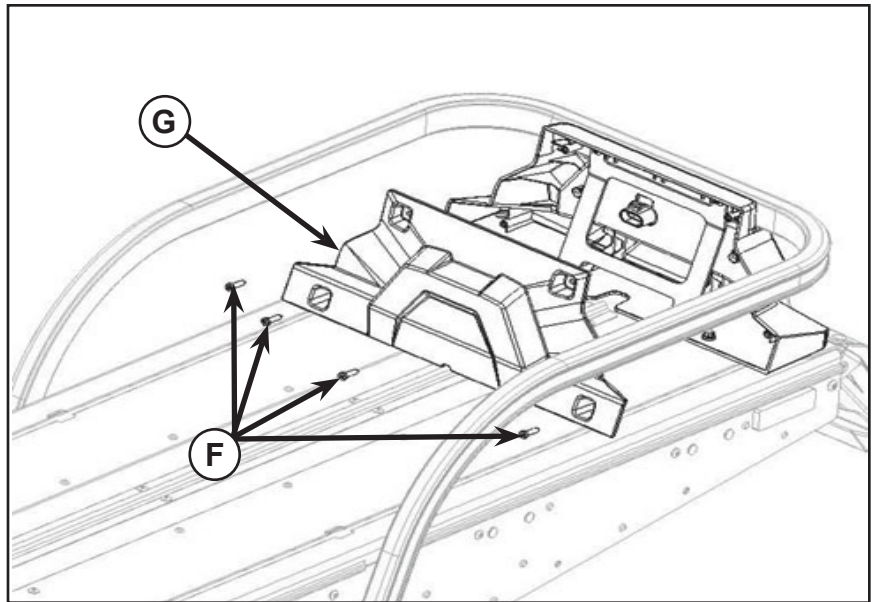

4. Remove existing rear rack (H) by removing two screws (J) from taillight reinforcement bracket as shown in figure. Do not use screws during installation.

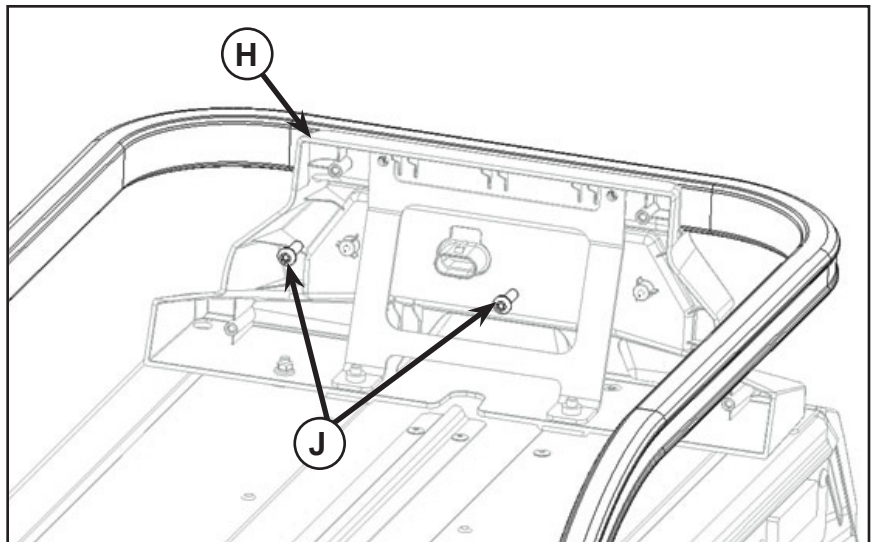

5. Remove four screws (K) under the body of the vehicle as shown in figure.

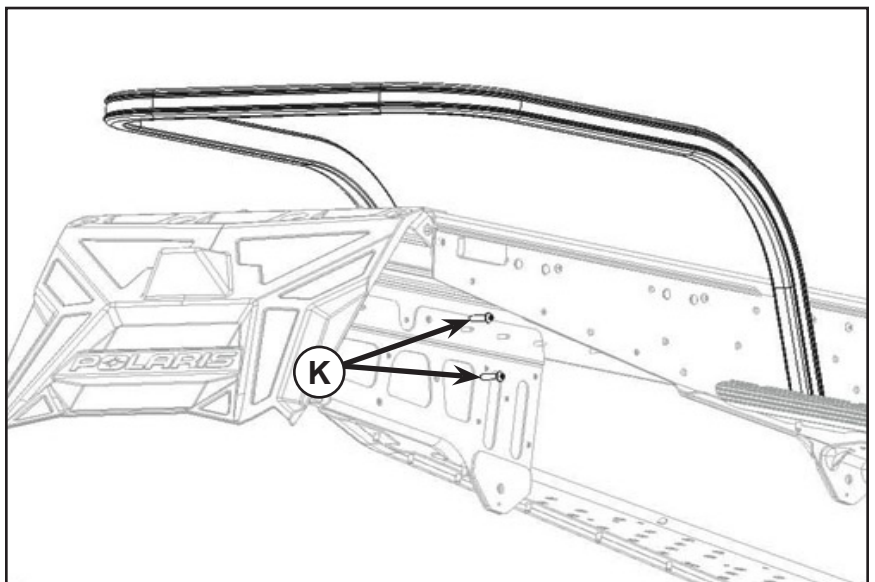

6. Remove eight plastic darts (5) from both sides of vehicle chassis as shown in figure.

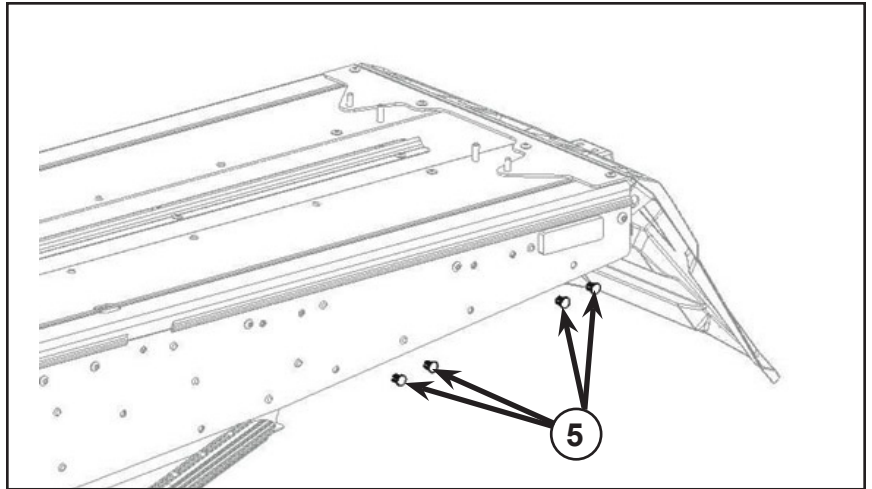

7. **NOTE:** First slide four M6 bolts in to the tunnel panel and adjust according to deluxe rack mounting. Install deluxe rack kit (M) by attaching four stud plates (3) with relevant M6 nuts (11) from under the chassis as shown in figure.

Torque: 7.4 ± 1.5 ft. lbs. (10 ± 2 Nm).

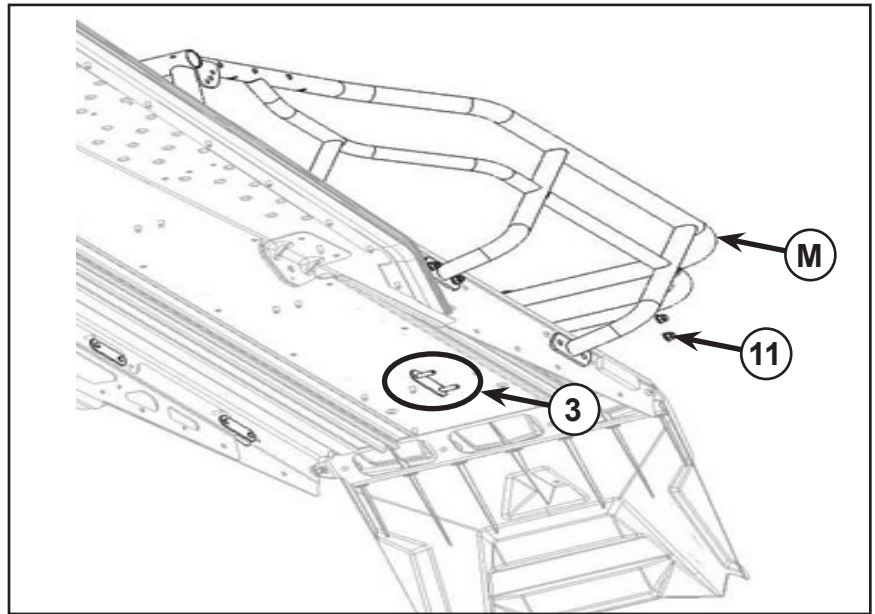

8. Mount deluxe rack on front side by attaching M6 nuts (11) and relevant washers (12) as shown.

Torque: 7.4 ± 1.5 ft. lbs. (10 ± 2 Nm).

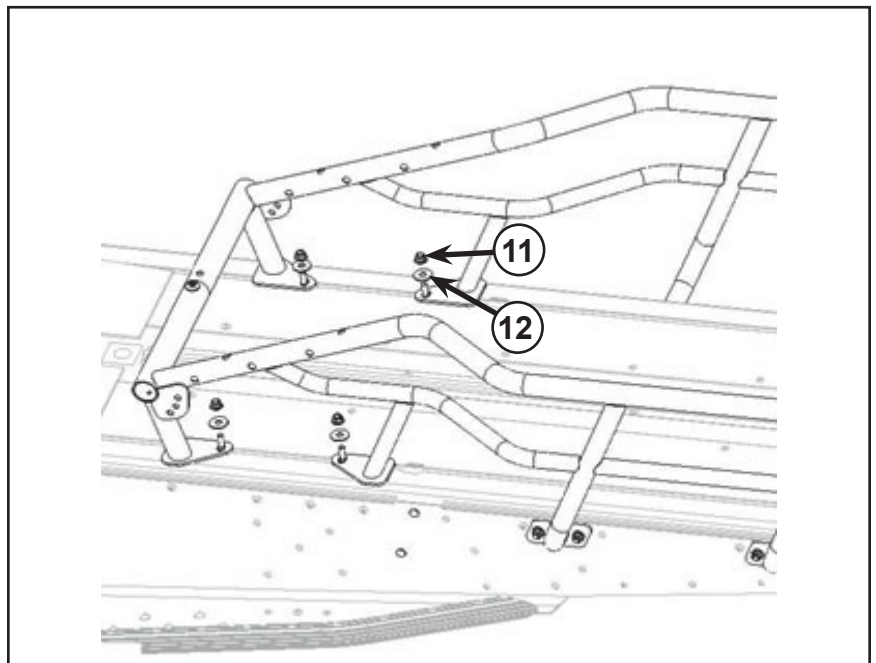

9. Assemble seat mount (4) on to the deluxe rack by four screws (6) and relevant nuts (10) as shown in figure. Do not tighten screws at this time.

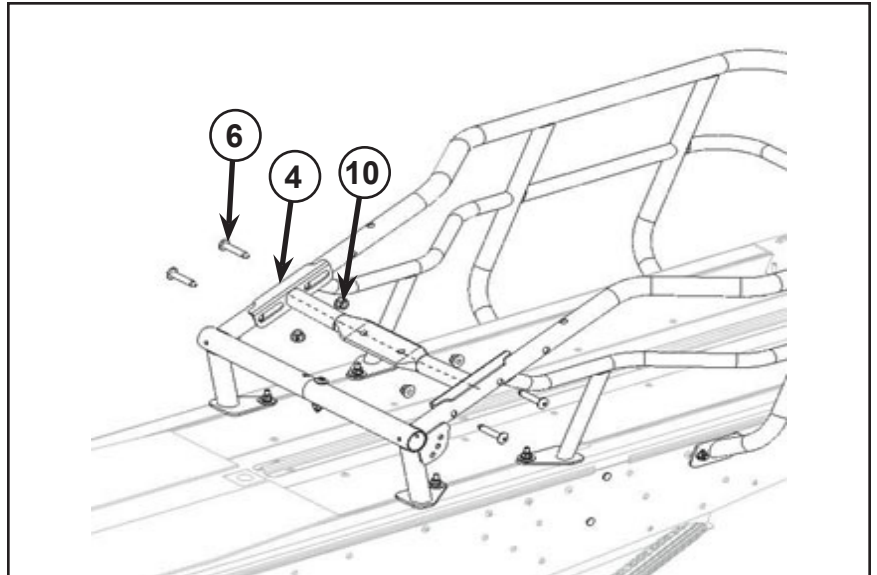

10. Install deluxe rack with taillight assembly (N) that was removed in step 3 and 4 using screws (8) and nuts (11) as shown in figure.
Torque: 7.4±1.5 ft. lbs. (10±2 Nm).

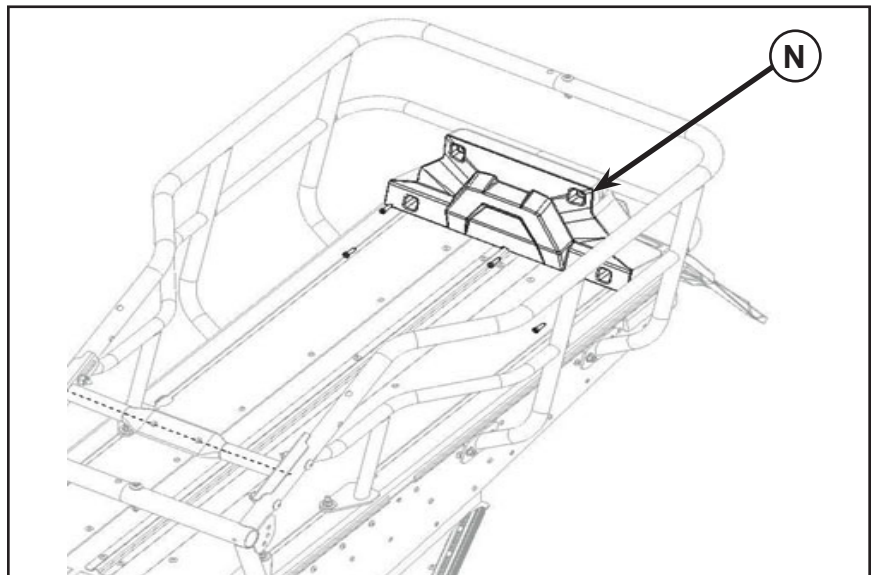
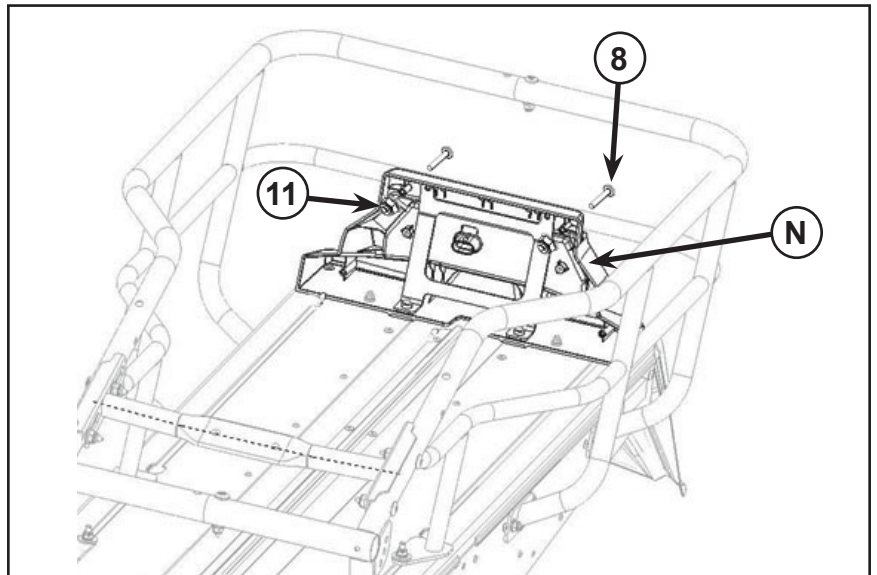

11. Install seat (P) on to the deluxe seat mount by attaching two M6 nuts (11). Slide front of the seat into locking tab on fuel tank.

Torque: 6.3 ± 1.5 ft. lbs. (8.5 ± 2 Nm).

NOTE: Make sure front of the seat is locked down and then torque screws installed in Step 9 to 6.3 ± 1.5 ft. lbs. (8.5 ± 2 Nm).

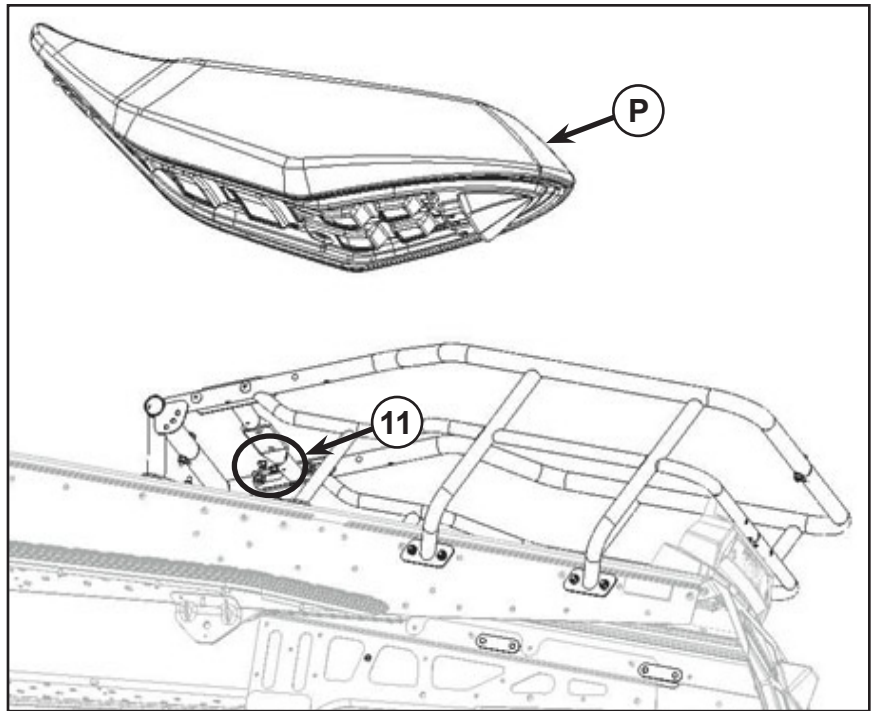

12. Push the plastic darts (5) on both sides of chassis holes as shown in figure.

