

TUNNEL BAG KIT



P/N 2884453; 2884454; 2884455; 2884456

BEFORE YOU BEGIN

Read these instructions and check to be sure all parts and tools are accounted for. Please retain these installation instructions for future reference and parts ordering information.

APPLICATION

Verify accessory fitment at www.polaris.com.

IMPORTANT

If snowmobile is not equipped with Lock & Ride™ integrated gas tank, Lock & Ride Flex™ Retrofit Kit, P/N 2884939 is required.

REQUIRED SOLD SEPARATELY

Only parts for installation of the Tunnel Bag Kit are included. Prior installation of the following additional kits is also required (sold separately), if snowmobile does not have the Lock & Ride Flex™ (A) integrated into the gas tank:

- Lock & Ride Flex™ Retrofit Kit, P/N 2884939

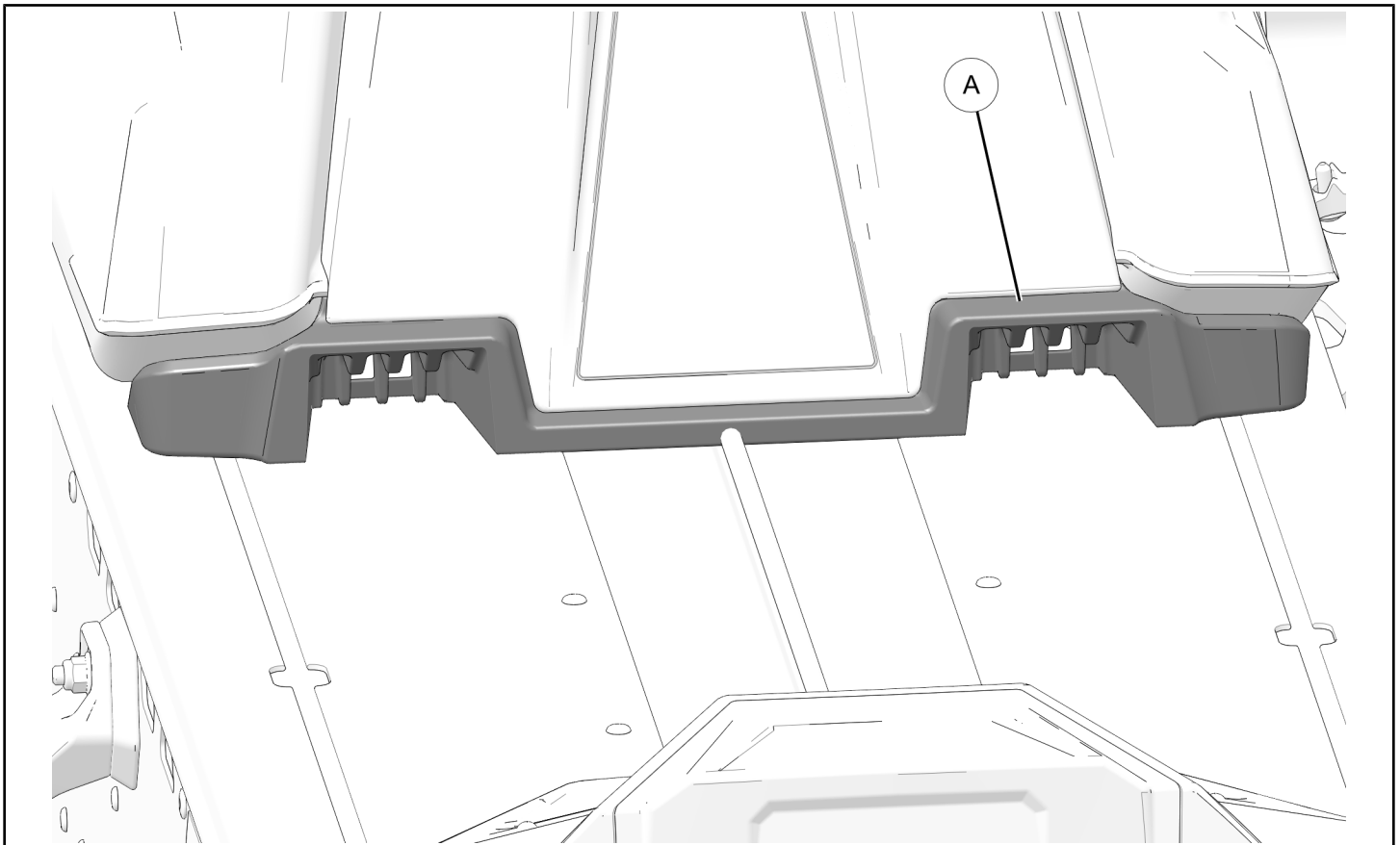

KIT CONTENTS

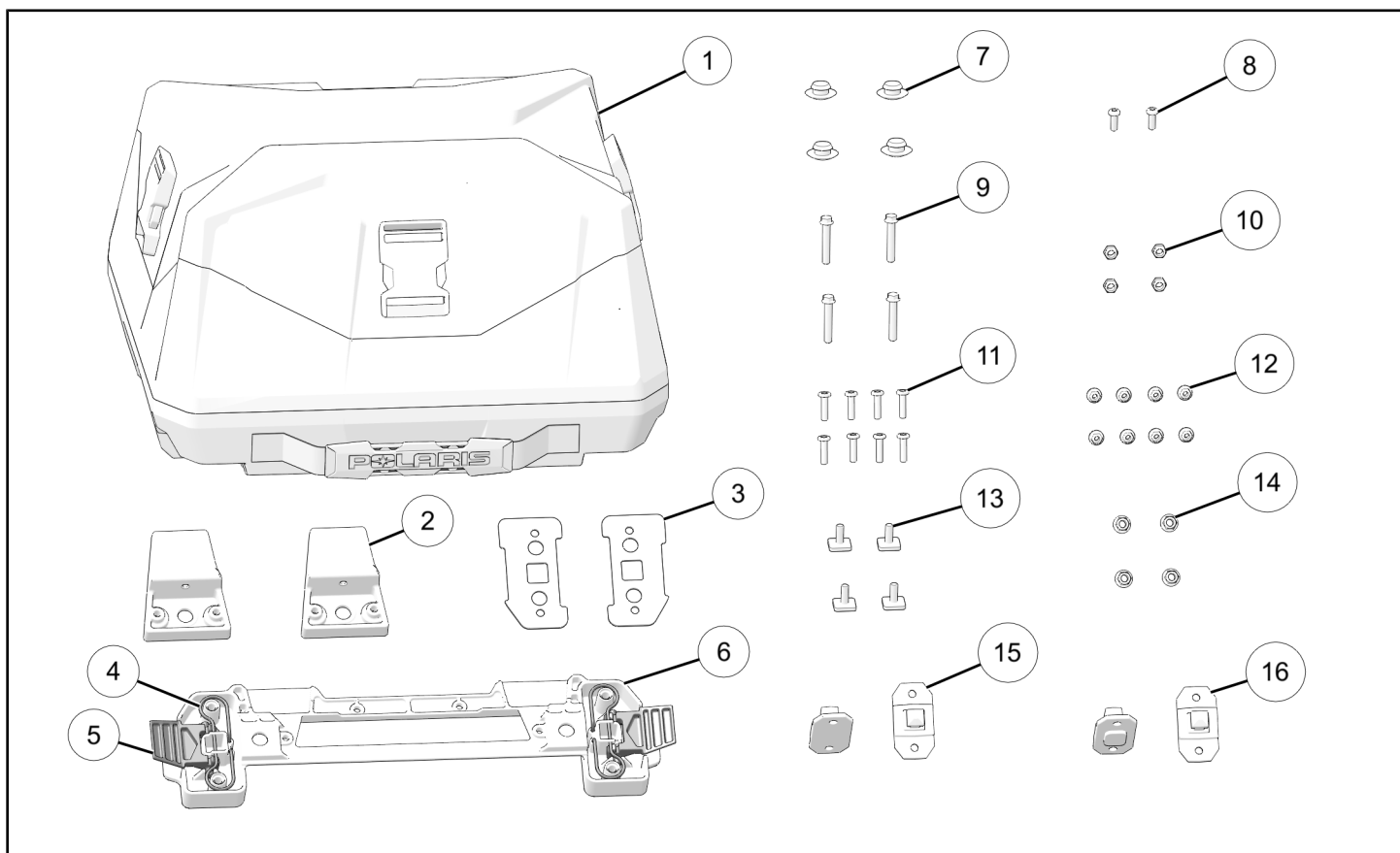

NOTICE

All images show 16" Tall Tunnel Bag.

REF	QTY	PART DESCRIPTION	P/N AVAILABLE SEPARATELY
1	1	Adventure Tunnel Bag, Tall Adventure Tunnel Bag, Low Sport Tunnel Bag, Tall Sport Tunnel Bag, Low	n/a
2	2	Front Feet, Bag	5457028
3	2	Latch Housing, Bag	5269317
4	2	Latch Spring	7081466
5	2	Latch Handle	5457021
6	1	Latch Housing	5457031
7	4	Rubber Grommet	5413441
8	2	Screw, Torx® Pan Head, 10 x 5/8	7518577
9	4	Screw, Hex Flange, M6 x 1.0 x 35	7518578
10	4	Nut, Hex, M6 x 1.0	7547650
11	8	Screw, M5 x 0.8 x 20	7518980
12	8	Nut, Hex Flange, M5 x 0.8	7547427

REF	QTY	PART DESCRIPTION	P/N AVAILABLE SEPARATELY
13	4	T-Slot Bolt, M6 x 1.0 x 16	7520514
14	4	Nut, Hex Flange, M6 x 1.0	7547453
15	2	Latch, Dowel Upfit	5457494
16	2	Latch, Dowel	5457032

TOOLS REQUIRED

- Safety Glasses
- Screwdriver Set, Torx®
- Socket Set, Metric
- Socket Set, Torx® Bit
- Torque Wrench
- Wrench Set, Metric

IMPORTANT

Your Tunnel Bag Kit is exclusively designed for your vehicle. Please read the installation instructions thoroughly before beginning. Installation is easier if the vehicle is clean and free of debris. For your safety, and to ensure a satisfactory installation, perform all installation steps correctly in the sequence shown.

INSTALLATION INSTRUCTIONS

VEHICLE PREPARATION

GENERAL

1. Park snowmobile on a flat surface.
2. Push the engine stop switch down to the OFF position.
3. Turn the key to the OFF position and remove key.

ACCESSORY INSTALLATION

TUNNEL BAG ASSEMBLY

NOTICE

All images have top of bag and all fabric hidden for clarity of images.

1. Unzip bag. Remove and set aside internal dividers.
2. Unzip inside bottom panel of bag to access hard plastic bag bottom.

3. Align front feet ② in grooves on bottom of bag ①.

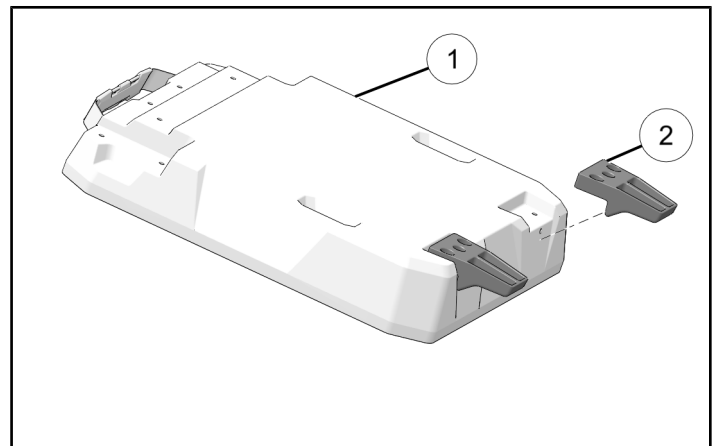

4. Insert screw ⑧ through inside of bag into front foot ②. Tighten until fully seated.

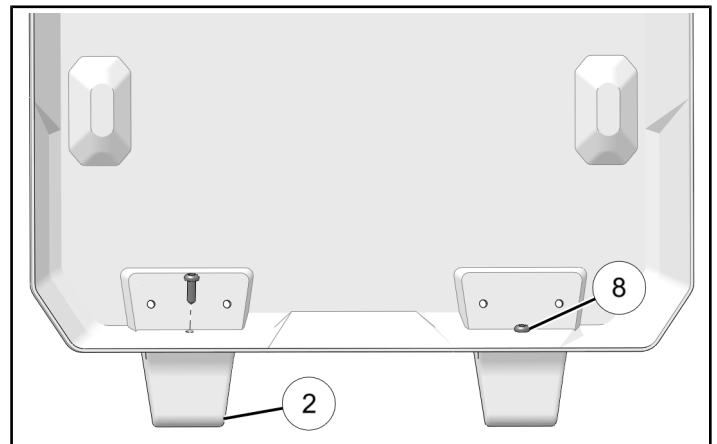

5. Insert screw ⑪ into front foot ②.

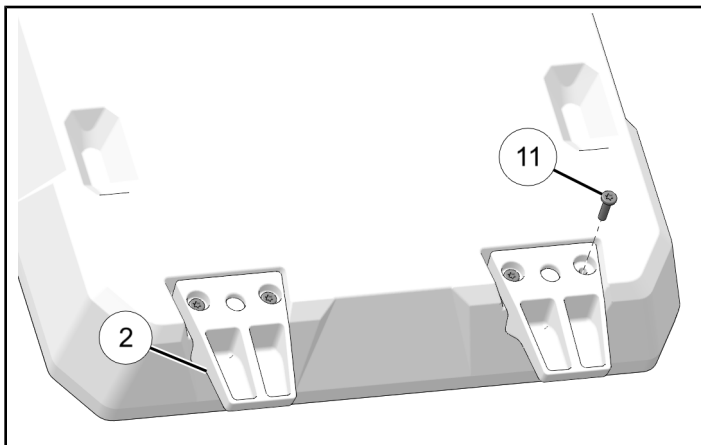

6. Attach nut ⑫ to screw. Torque to specification.

TORQUE

Front Foot Nut ⑫:
44 in-lbs (5 N·m)

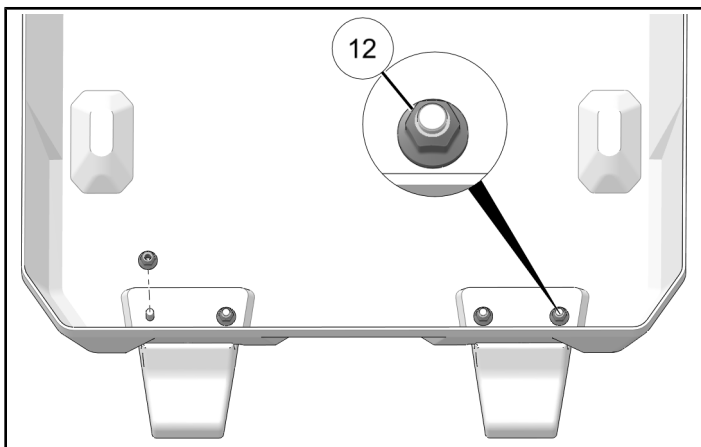

7. Place latch housing ⑥ onto bottom of bag.

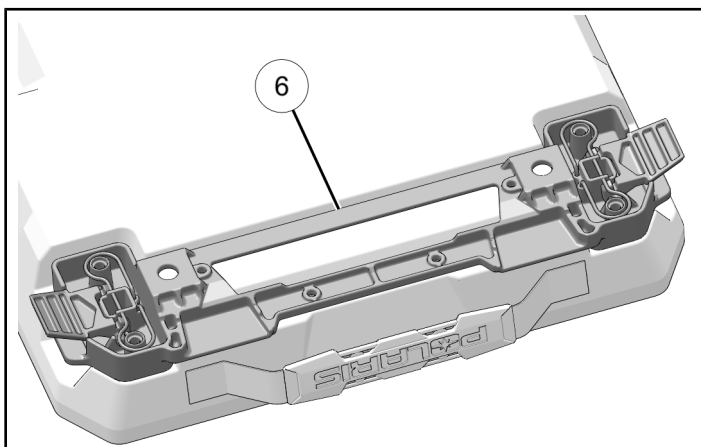

8. Place latch housing cover ③ onto latch housing ⑥. Make sure corners are properly aligned.

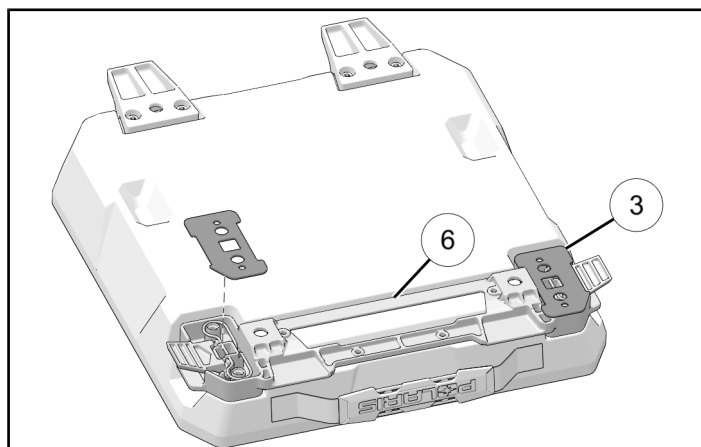

9. Insert screw ⑨ through latch housing cover, latch housing, and bag.

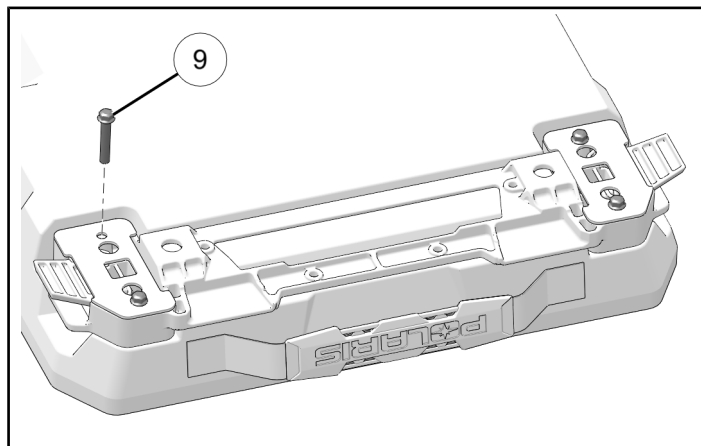

10. Counter-hold nut ⑩ and torque latch housing screw ⑨ to specification.

TORQUE

Latch Housing Cover Screw ⑨:
70 in-lbs (8 N·m)

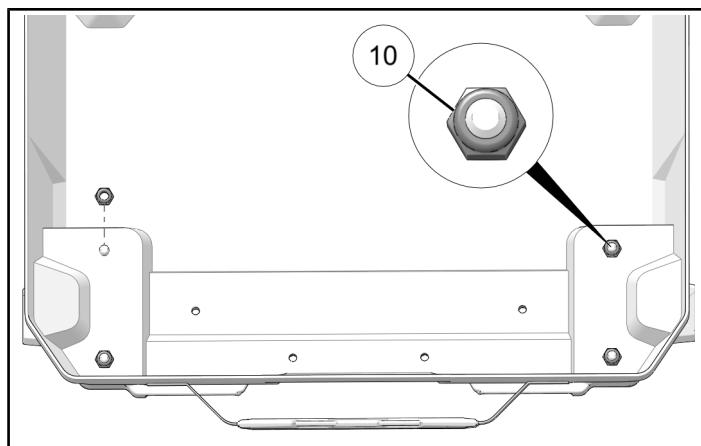

11. Insert screw ⑪ into latch housing.

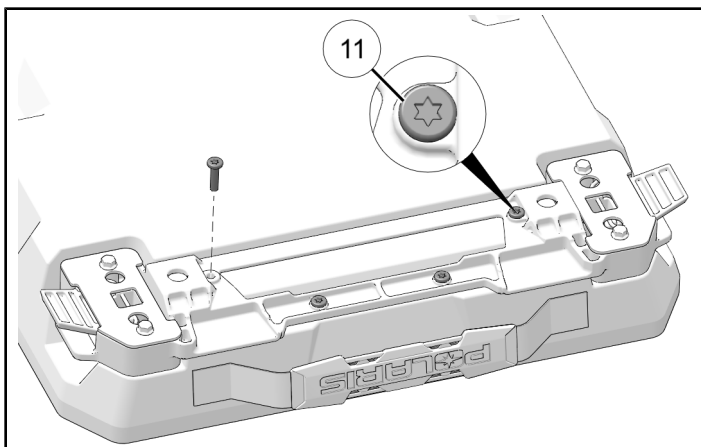

12. Attach nut ⑫ to screw. Torque to specification.

TORQUE

Latch Housing Screw ⑪:
44 in-lbs (5 N·m)

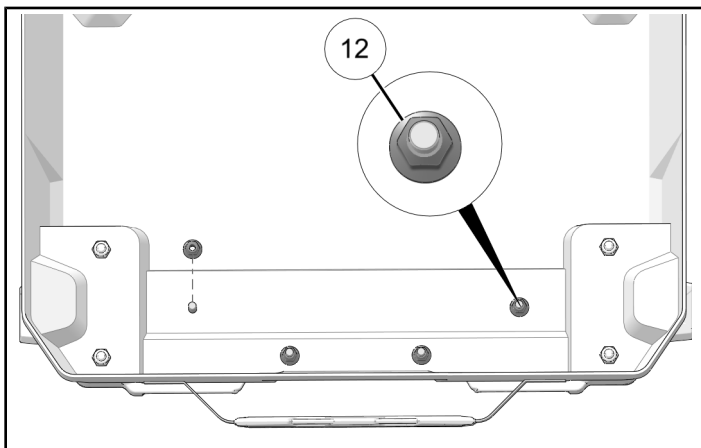

13. Insert rubber bumper ⑦ into holes in front feet and latch housing.

TIP

Use soapy water on bumpers to aid installation.

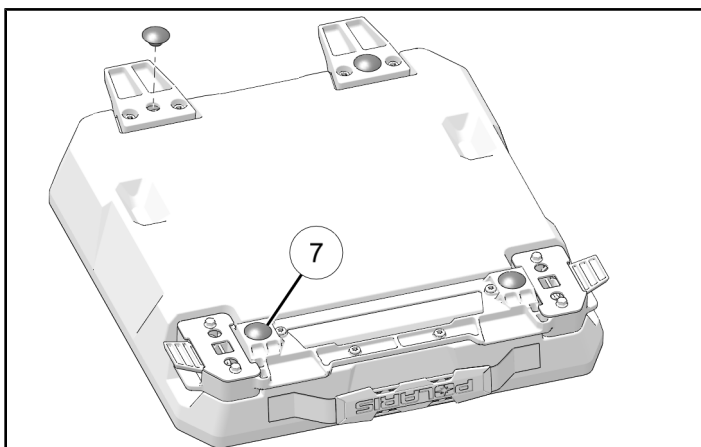

14. Zip up inside bottom fabric panel.

15. Install plastic internal dividers as desired.

TUNNEL BAG INSTALLATION

INSTALLATION FOR MATRYX

NOTICE

16" Tunnel Bag shown, for 8" Tunnel Bag use slots closer to the gas tank.

1. Insert two T-slot bolts ⑬ into slot opening and slide to left and right of opening.

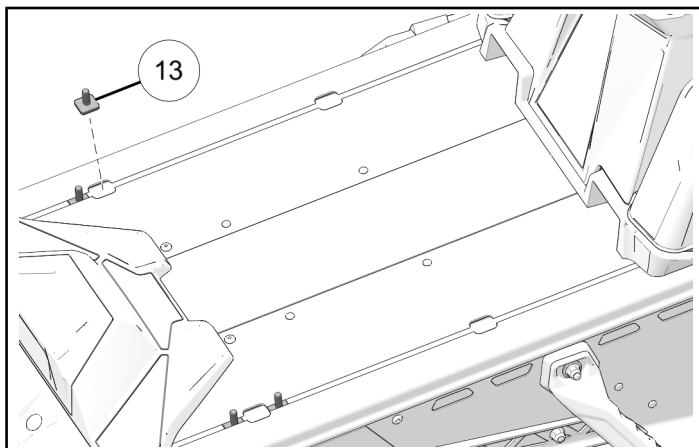

2. Slide latch ⑯ onto T-slot bolts. Bottom of latch should insert into slot.

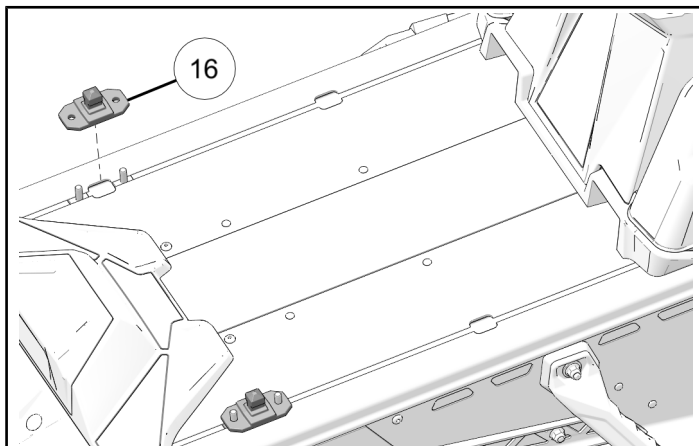

3. Attach nuts ⑩. Torque to specification.

TORQUE

Latch Nut ⑩:
70 in-lbs (8 N·m)

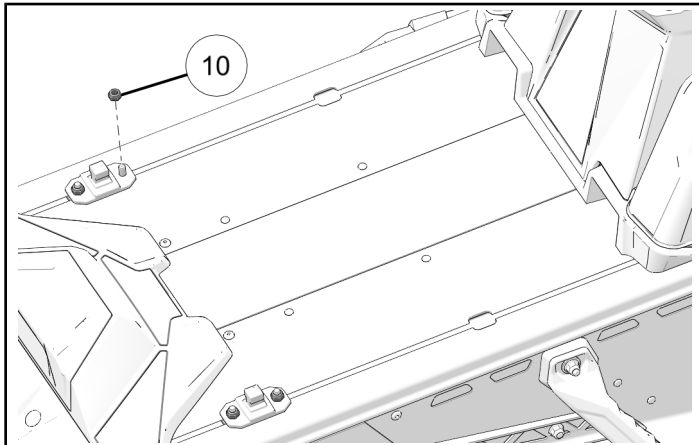

2. Slide latch ⑮ onto T-slot bolts.

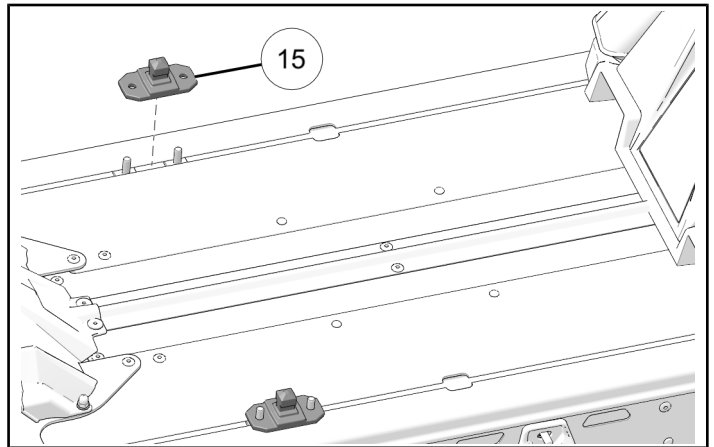

4. Insert feet of Tunnel Bag ① into Lock & Ride Flex™. Place bag down on latches, lift and release clamps ⑤ to secure. To remove bag, lift clamps and lift up bag.

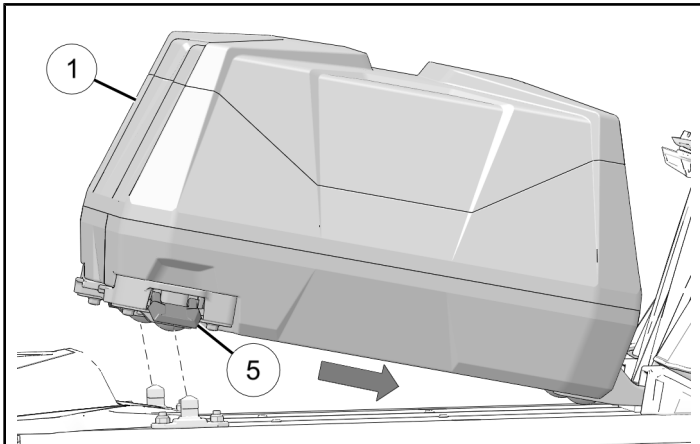

3. Attach nuts ⑩ loosely so latch can still be moved.

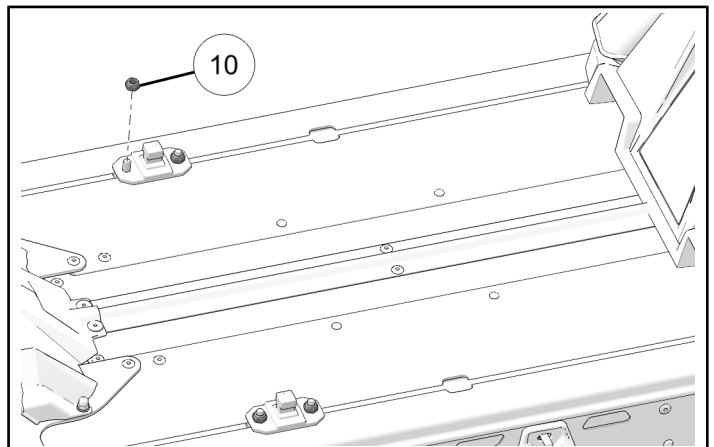

4. Place bag onto snowmobile to position latches so they insert into holes in bag. Carefully remove bag.

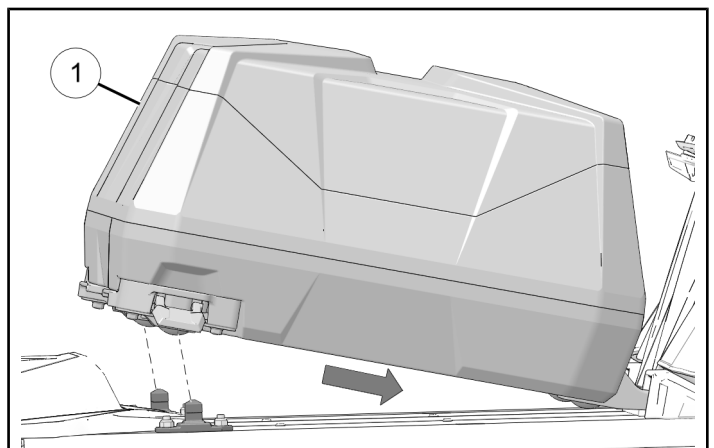

INSTALLATION FOR RETROFIT KITS WITH ACCESS SLEDS

1. Insert T-slot bolt ⑬ into slot and slide to approximate desired position.

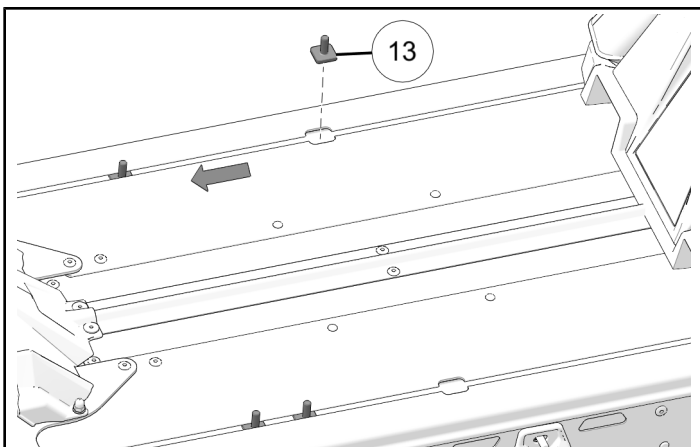

5. Torque nuts ⑩ to specification.

TORQUE

Latch Nut ⑩:
70 in-lbs (8 N·m)

6. Insert feet of Tunnel Bag ① into Lock & Ride Flex™. Place bag down on latches, lift and release clamps ⑤ to secure. To remove bag, lift clamps and lift up bag.

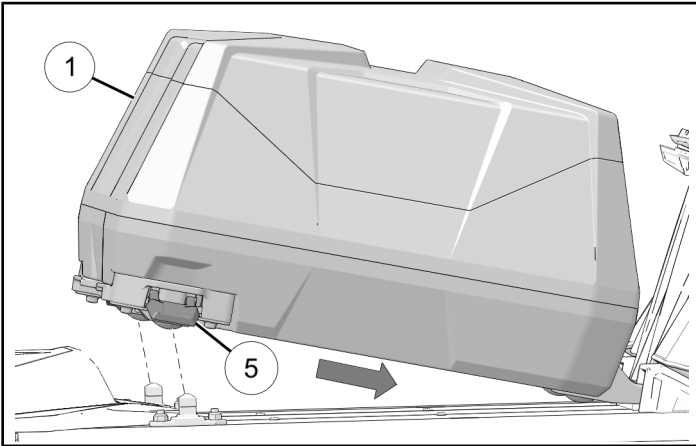

INSTRUCTION FEEDBACK FORM

A feedback form has been created for the installer to provide any comments, questions or concerns about the installation instructions. The form is viewable on mobile devices by scanning the QR code or by clicking [HERE](#) if viewing on a PC.

