

AXYS PRO-RMK SPINDLES KIT



P/N 2881437

APPLICATION

AXYS PRO RMK, SKS

BEFORE YOU BEGIN

Read these instructions and check to be sure all parts and tools are accounted for. Please retain these installation instructions for future reference and parts ordering information.

KIT CONTENTS

This Kit includes:

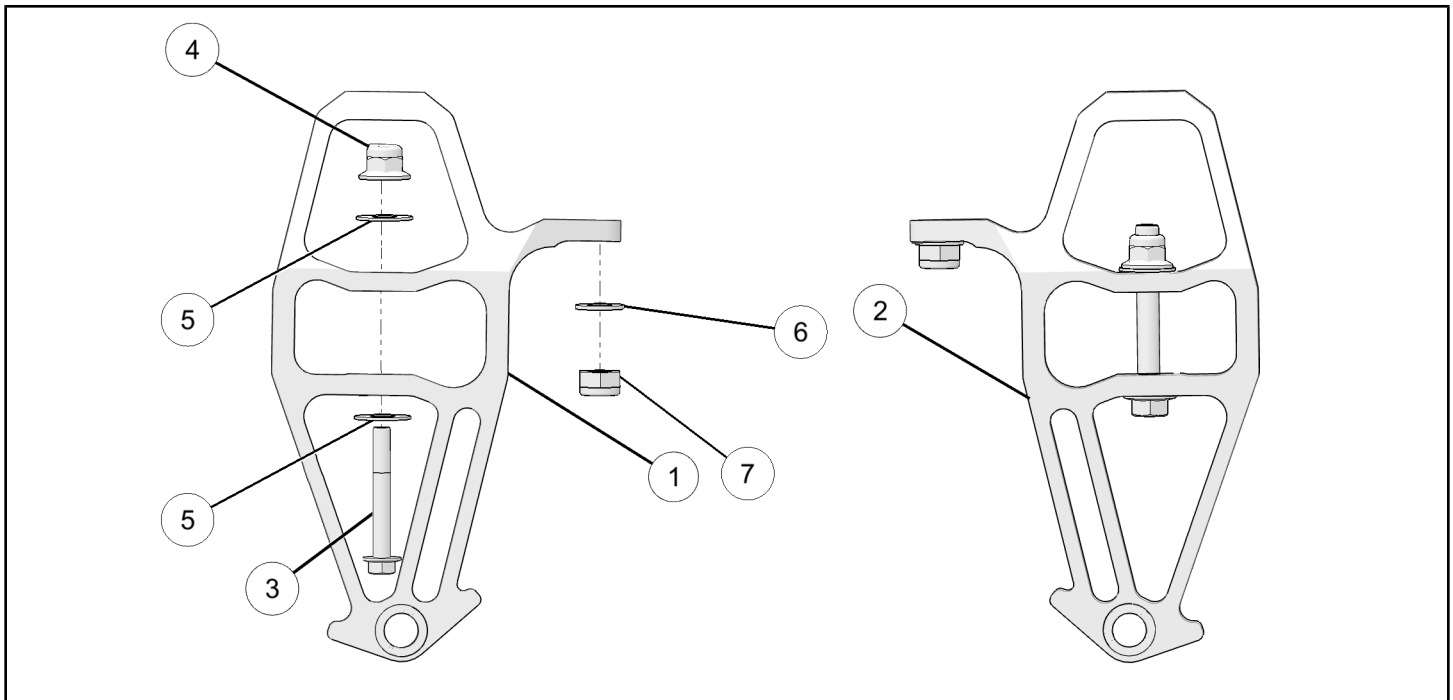

| REF | QTY | PART DESCRIPTION | PART NUMBER |
|-----|-----|------------------------------------|-------------|
| 1 | 1 | Assembly, Spindle RMK, LH | 1824040 |
| 2 | 1 | Assembly, Spindle RMK, RH | 1824041 |
| 3 | 2 | Screw, Hexflange - M10 X 1.25 X 75 | 7519286 |
| 4 | 4 | Flange, Nut - M10 X 1.25 Nyloc | 7547333 |
| 5 | 8 | Washer, 10.5 X 24 X 1.24 | 7556545 |
| 6 | 4 | Washer, Flange, .406 X .812 X .065 | 7555806 |
| 7 | 2 | Nut-Nyloc, M10 X 1.5 | 7547442 |
| | 1 | Instructions | 9926858 |

TOOLS REQUIRED

- 8 mm Allen Wrench
- 13 mm Wrench or Socket
- 15 mm Wrench or Socket
- 16 mm Wrench or Socket
- 17 mm Wrench or Socket
- Floor Jack

IMPORTANT

Your AXYS PRO-RMK SPINDLES KIT is exclusively designed for your vehicle. Please read the installation instructions thoroughly before beginning. Installation is easier if the vehicle is clean and free of debris. For your safety, and to ensure a satisfactory installation, perform all installation steps correctly in the sequence shown.

ASSEMBLY TIME

Approximately 30 minutes

INSTALLATION INSTRUCTIONS

1. Securely raise front end of snowmobile 4 inches off the ground using floor jack.
2. Remove ski (A) by removing ski bolt (B), nut (C) and washers (D). Retain hardware for reuse. Use 16 mm socket and 15 mm wrench for removing hardware.

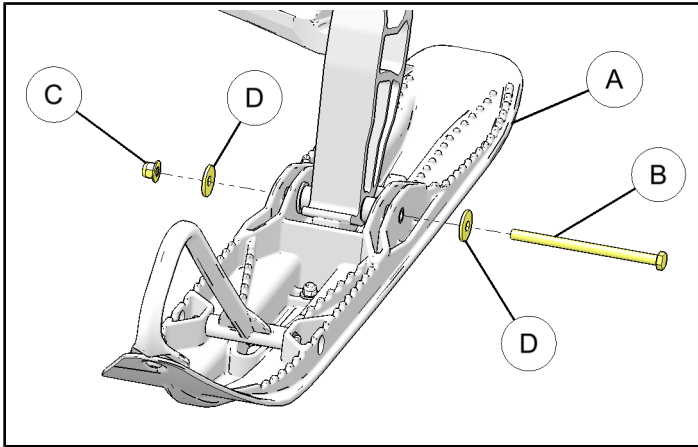

3. Remove sleeve (F), ski spacers (G) and spindle bushings (E) from spindle bottom mount. Retain hardware for reuse.

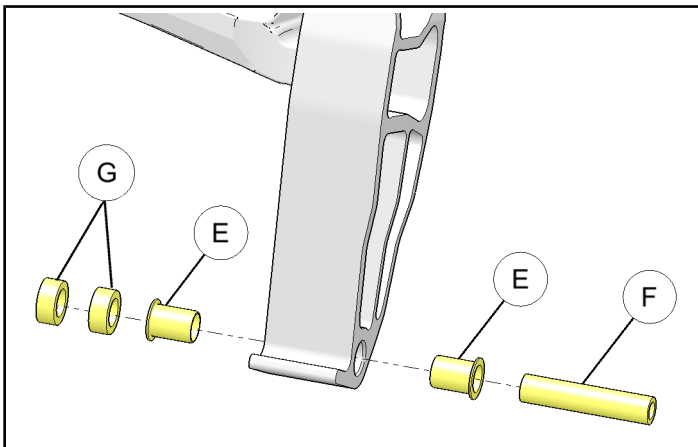

4. Remove tie rod (H) from spindle (J) using 13 mm and 17 mm wrenches. Discard hardware.

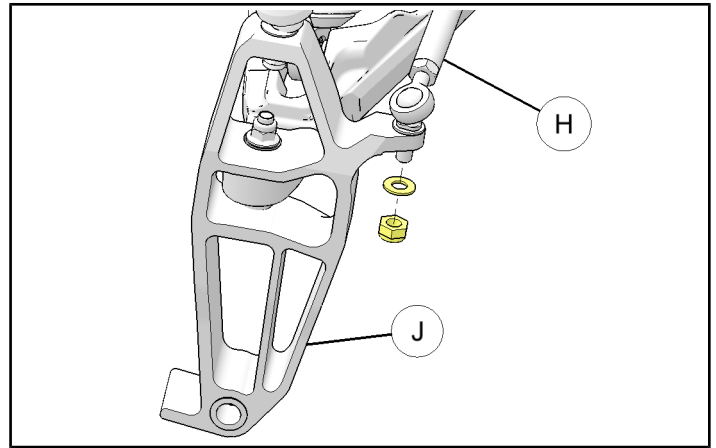

5. Using 8 mm Allen wrench and 15 mm wrench, remove upper control arm (K) joint. Discard hardware.

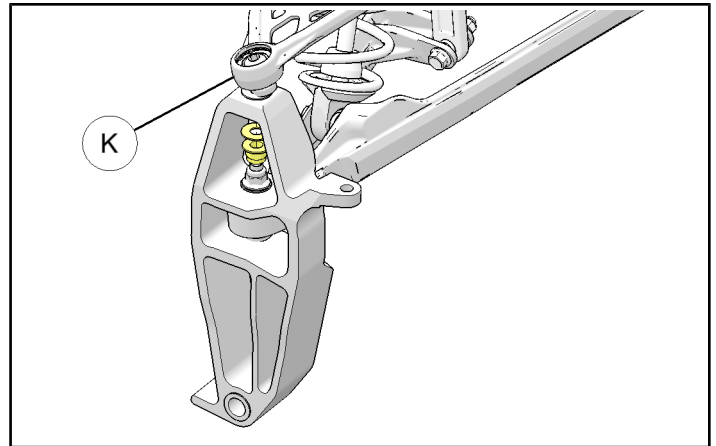

6. Remove lower control arm (L) joint using two 15 mm wrenches. Discard hardware.

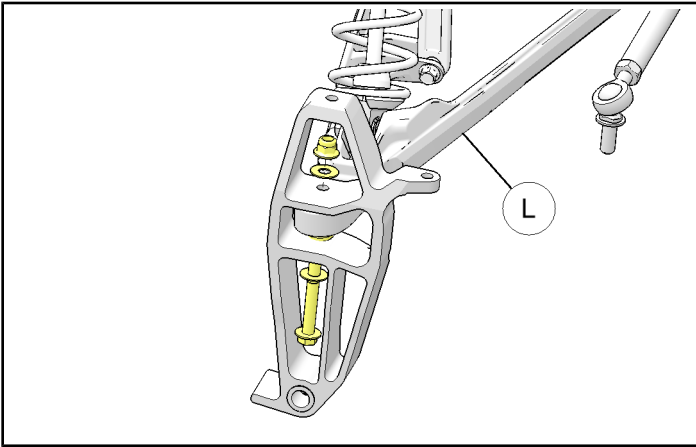

7. Place new spindle ① onto lower control arm (L), install M10 screws ③ from bottom up, ensure washers ⑤ are properly in place and securely fasten using two 15 mm wrenches. Torque to specification.

TORQUE

40 ft. lbs. (54 Nm)

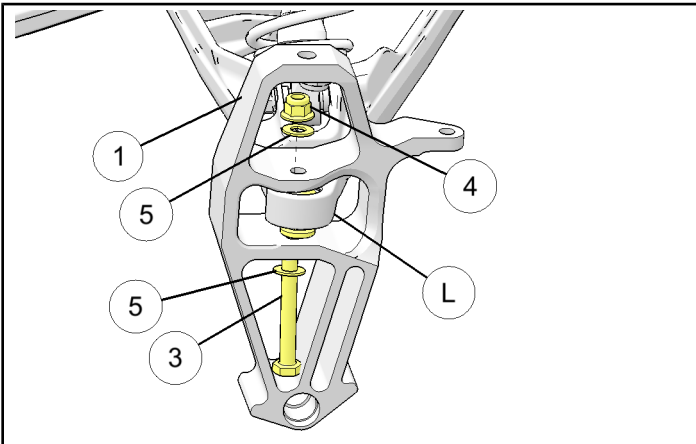

8. Place upper control arm (K) onto spindle ①. Ensure washers ⑤ are placed on top and bottom of spindle and tighten using 8 mm Allen wrench and 15 mm wrench. Torque to specification.

TORQUE

40 ft. lbs. (54 Nm)

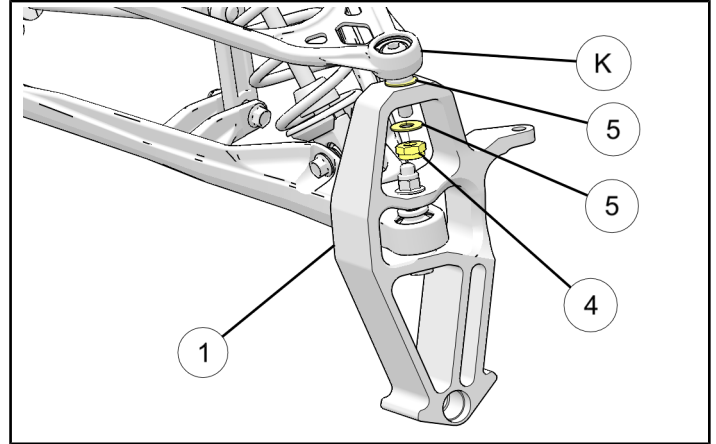

9. Place tie rod (H) onto spindle ①. Make sure to place washers ⑥ on top and bottom before tightening tie rod using 13 mm and 17 mm wrenches. Torque to specification.

TORQUE

37 ft. lbs. (50 Nm)

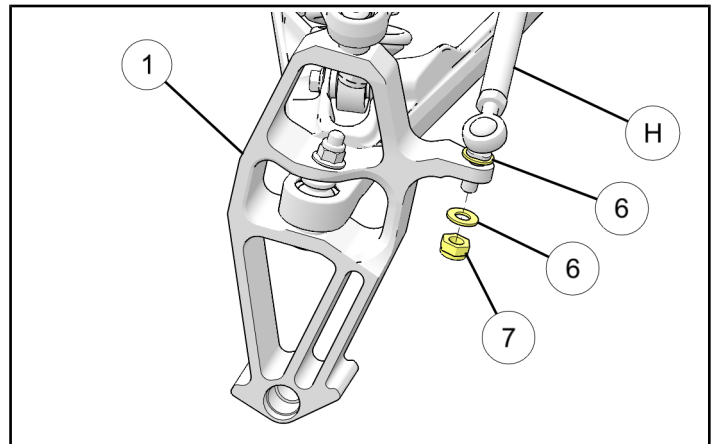

10. Place sleeve (F), ski spacers (G) and spindle bushings (E) from spindle bottom mount from the left to right. Ensure ski spacers are on the inside of the spindle.

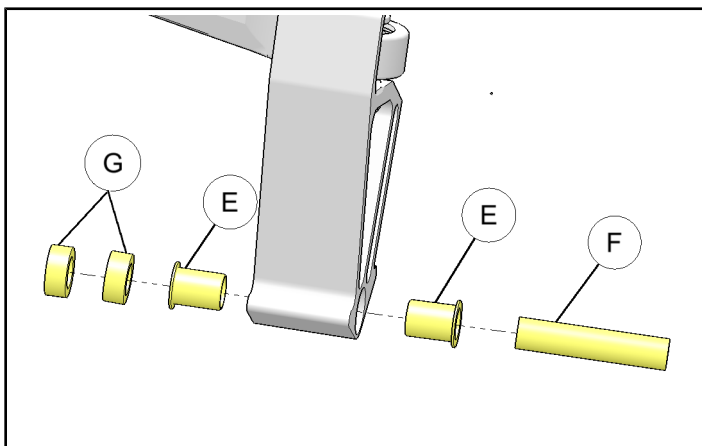

11. Place ski (A) back onto spindle ① and place through bolt (B) from outside in. Ensure washers and rubber spacer are properly in place and tighten. Proper installation will look as below.

