

# DRIVER GAUNTLETS



**P/N 2883716**

## APPLICATION

Verify accessory fitment at [Polaris.com](http://Polaris.com).

## BEFORE YOU BEGIN

Read these instructions and check to be sure all parts and tools are accounted for. Please retain these installation instructions for future reference and parts ordering information.

## KIT CONTENTS

This Kit includes:

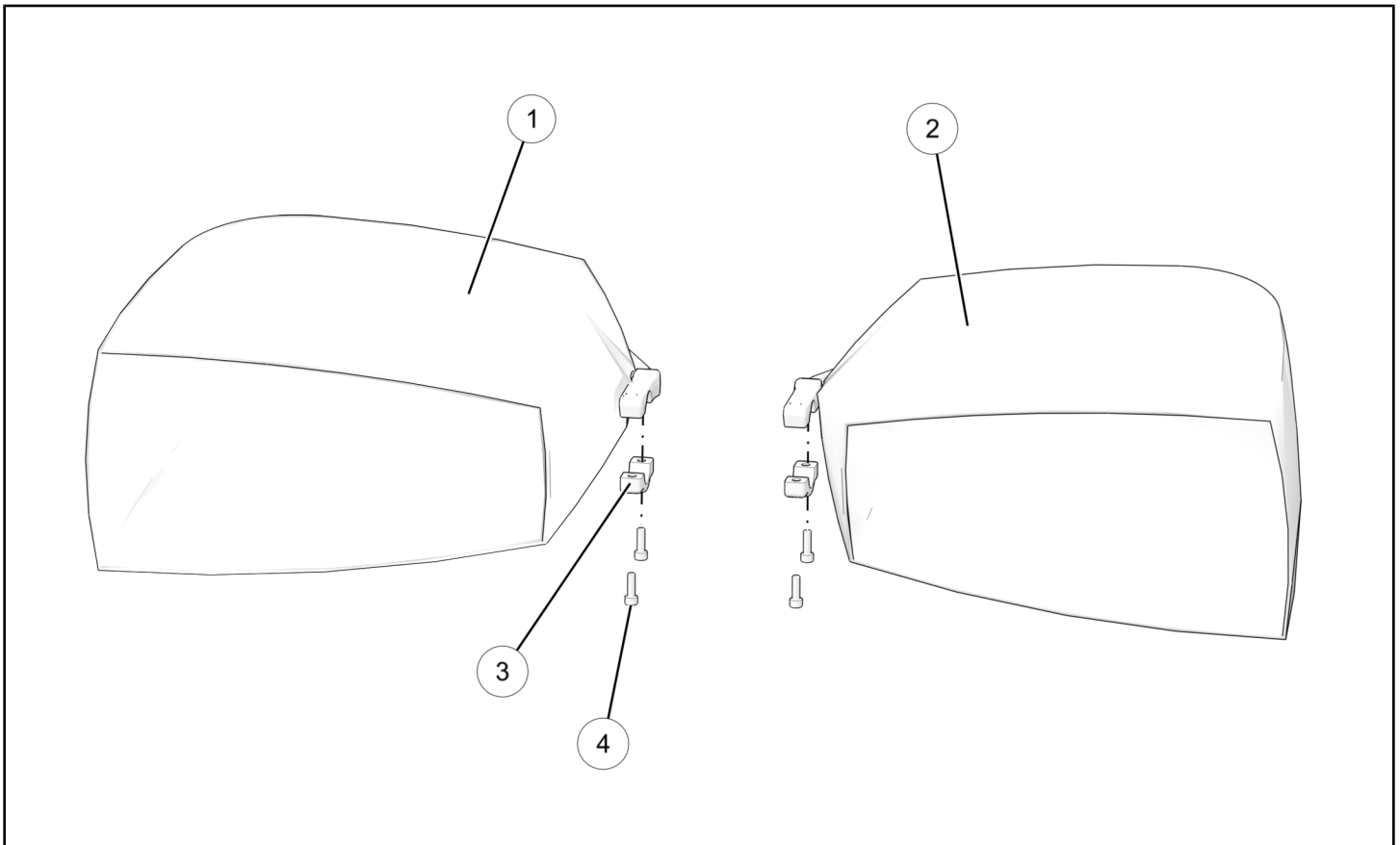

REF	QTY	PART DESCRIPTION	PART NUMBER
1	1	Gauntlet Assembly - LH (Includes items 3, Qty-1 & 4, Qty-2)	2689143
2	1	Gauntlet Assembly - RH (Includes items 3, Qty-1 & 4, Qty-2)	2689144
3	2	Mounting Clamp	-
4	4	Screw	-
	1	Instructions	9928857

## TOOLS REQUIRED

- Safety Glasses
- Socket Set, Hex Bit, Metric
- Torque Wrench

## CONSUMABLES REQUIRED

- None

## IMPORTANT

Your Driver Gauntlets is exclusively designed for your vehicle. Please read the installation instructions thoroughly before beginning. Installation is easier if the vehicle is clean and free of debris. For your safety, and to ensure a satisfactory installation, perform all installation steps correctly in the sequence shown.

## ASSEMBLY TIME

Approximately 6 minutes

### NOTE

Additional time may be required for optional steps, or to accommodate other installed accessories.

## INSTALLATION INSTRUCTIONS

### CAUTION

**BEFORE STARTING INSTALLATION**, always ensure vehicle is on a flat stable surface and is properly secured to avoid accidental tipping or other movement to prevent personal injury and/or damage to equipment. If applicable, turn key to "OFF" position and remove from vehicle.

1. Open hook and loop fastener panels (A) on the end of the gauntlet and start over the end of the handlebar as show.

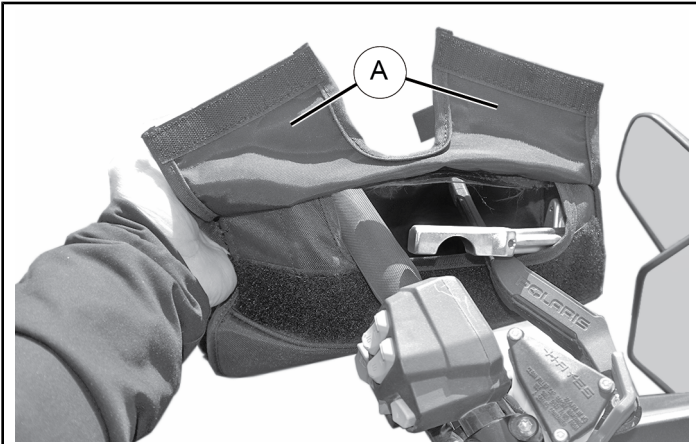

2. Pull gauntlet completely over handlebar controls and into position as shown.

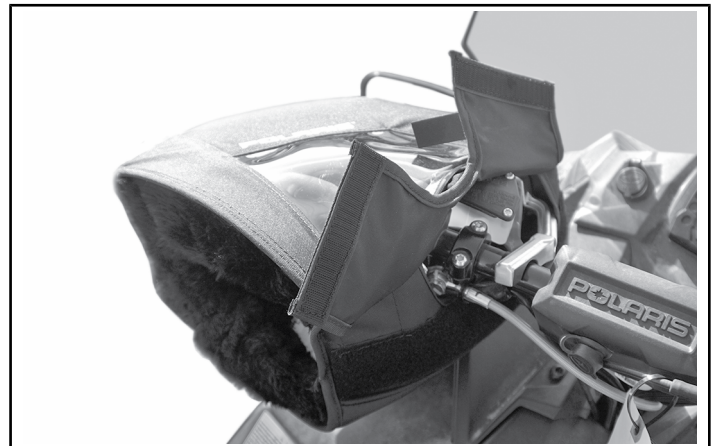

- Place the lower mounting clamp ③ into position as shown and loosely start the two mounting screws ④ by hand until they are slightly snug.

#### NOTE

Make sure that you **DO NOT** pinch any electrical wiring between the mounting clamp and handlebars.

Adjust the position of the gauntlet as needed before tightening the mounting screws.

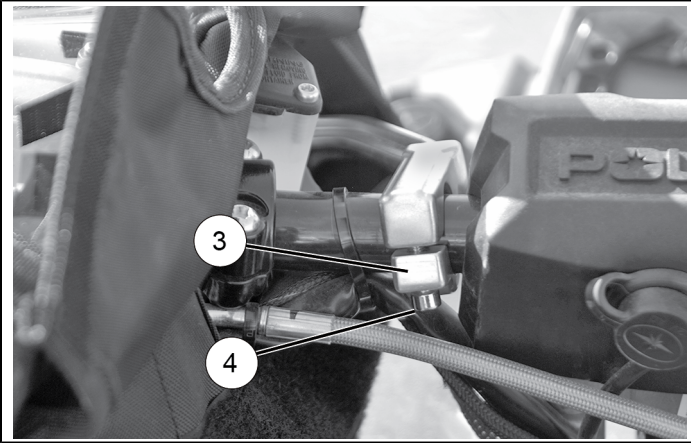

- Torque mounting screws ④ to specification listed below.

#### TORQUE

7 ft. lbs (9.5 Nm)

- Close hook and loop fastener panels ① and secure the small hook and loop strap ② on the bottom side of the handlebar as shown to secure hand gauntlet.

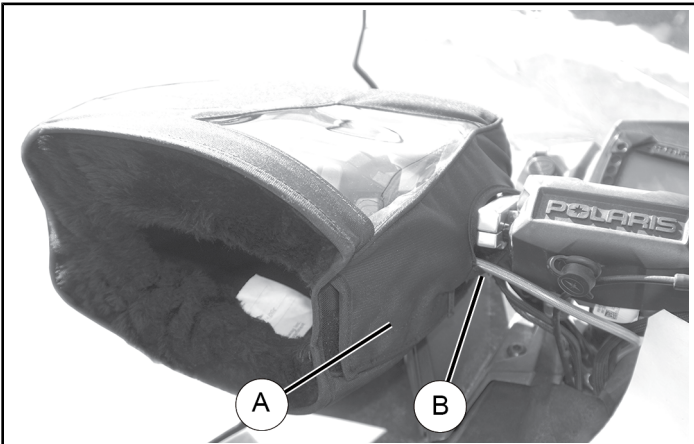

#### WARNING

You **MUST VERIFY** brake mechanism has full brake and parking brake functions after installation of hand gauntlets and **BEFORE** starting engine. Adjust gauntlets if necessary to avoid any interference with brake function.

Failure to comply could result in death or serious personal injury.

- Repeat steps 1-5 for opposite side.



#### WARNING

You **MUST VERIFY** throttle mechanism has the recommended amount of free-play listed in the service manual for your specific model after installation of hand gauntlets and **BEFORE** starting engine. Adjust gauntlet if necessary to avoid any interference with throttle function.

Failure to comply could result in death or serious personal injury.

- Verify all steps have been completed and all tools are accounted for.

## FEEDBACK FORM

A feedback form has been created for the installer to provide any comments, questions or concerns about the installation instructions. The form is viewable on mobile devices by scanning the QR code or by clicking [HERE](#) if viewing on a PC.

