

# M2 SEAT KIT



P/N 2884725 / 2884957

## APPLICATION

Verify accessory fitment at [www.polaris.com](http://www.polaris.com).

### IMPORTANT

Polaris recommends adjusting suspension settings for 2-person riding. Refer to your owner's manual for set-up instructions and information regarding optional heavy duty springs.

## BEFORE YOU BEGIN

Read these instructions and check to be sure all parts and tools are accounted for. Please retain these installation instructions for future reference and parts ordering information.

## KIT CONTENTS

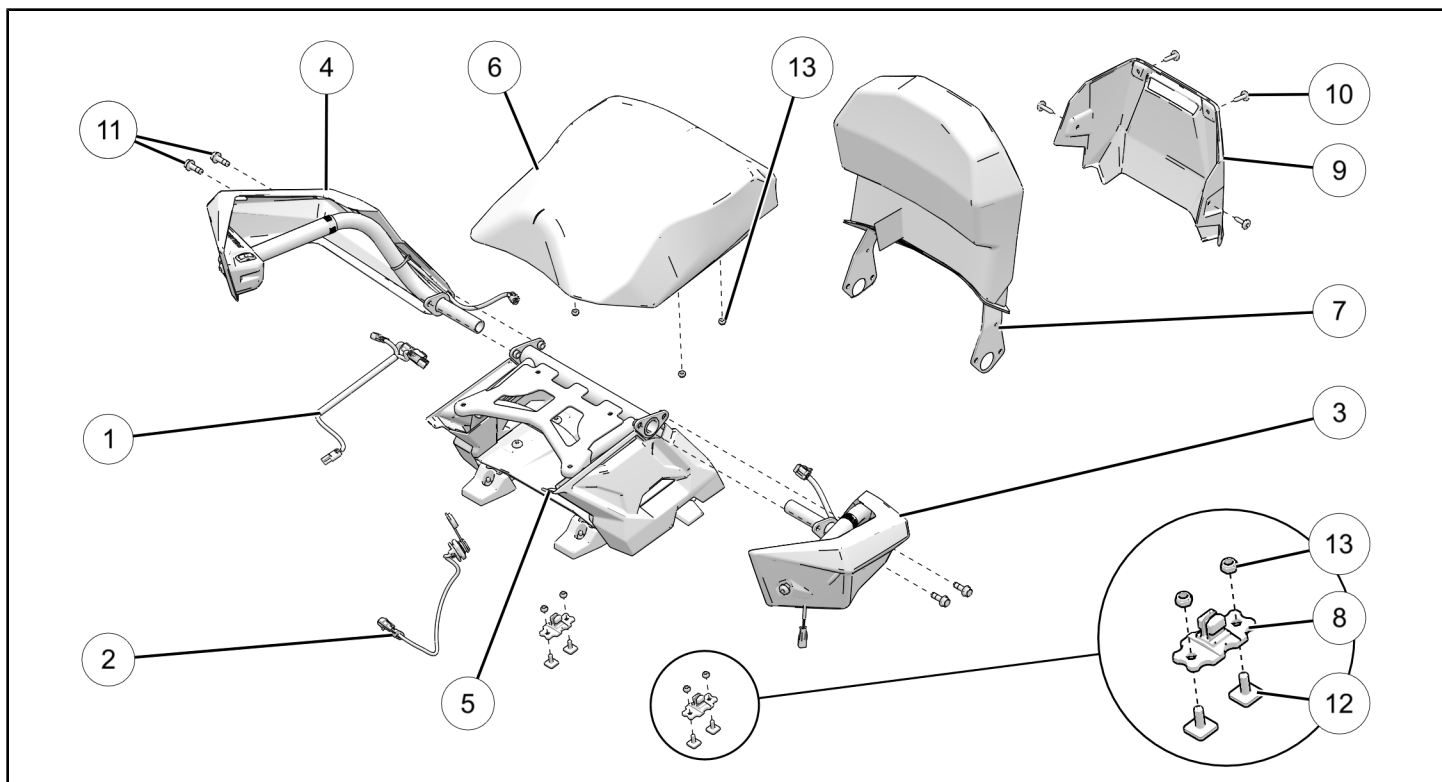

REF	QTY	PART DESCRIPTION	P/N AVAILABLE SEPARATELY
1	1	Main Harness Without Heated Seat Main Harness With Heated Seat	2415570 2415571
2	1	M2 Harness Plug	2415844
3	1	LH Hand Hold Assembly	2638003
4	1	RH Hand Hold Assembly RH Hand Hold Assembly Heat	2638004 2638113
5	1	Seat Frame Assembly	2638025
6	1	Passenger Seat Bun Assembly	2689984

REF	QTY	PART DESCRIPTION	P/N AVAILABLE SEPARATELY
		Passenger Seat Bun Assembly With Heat	2690253
7	1	Seat Backrest Assembly	2689985
8	2	Latch, Pin	5143370
9	1	Passenger Seat Back Cover	5457179
10	4	Screw, Torx Drive Truss Head, M6 X 1.0 X 25	7519650
11	4	Screw, Hex Flange Head, M8 X 1.25 X 25	7519739
12	4	Screw, T-Slot, M6 X 1.0 X 16	7520514
13	8	Hex Nut, M6 X 1.0, Nylon Locking	7547650

## HARNESS DETAIL

### MAIN HARNESS WITHOUT HEATED SEAT (P/N 2415570)

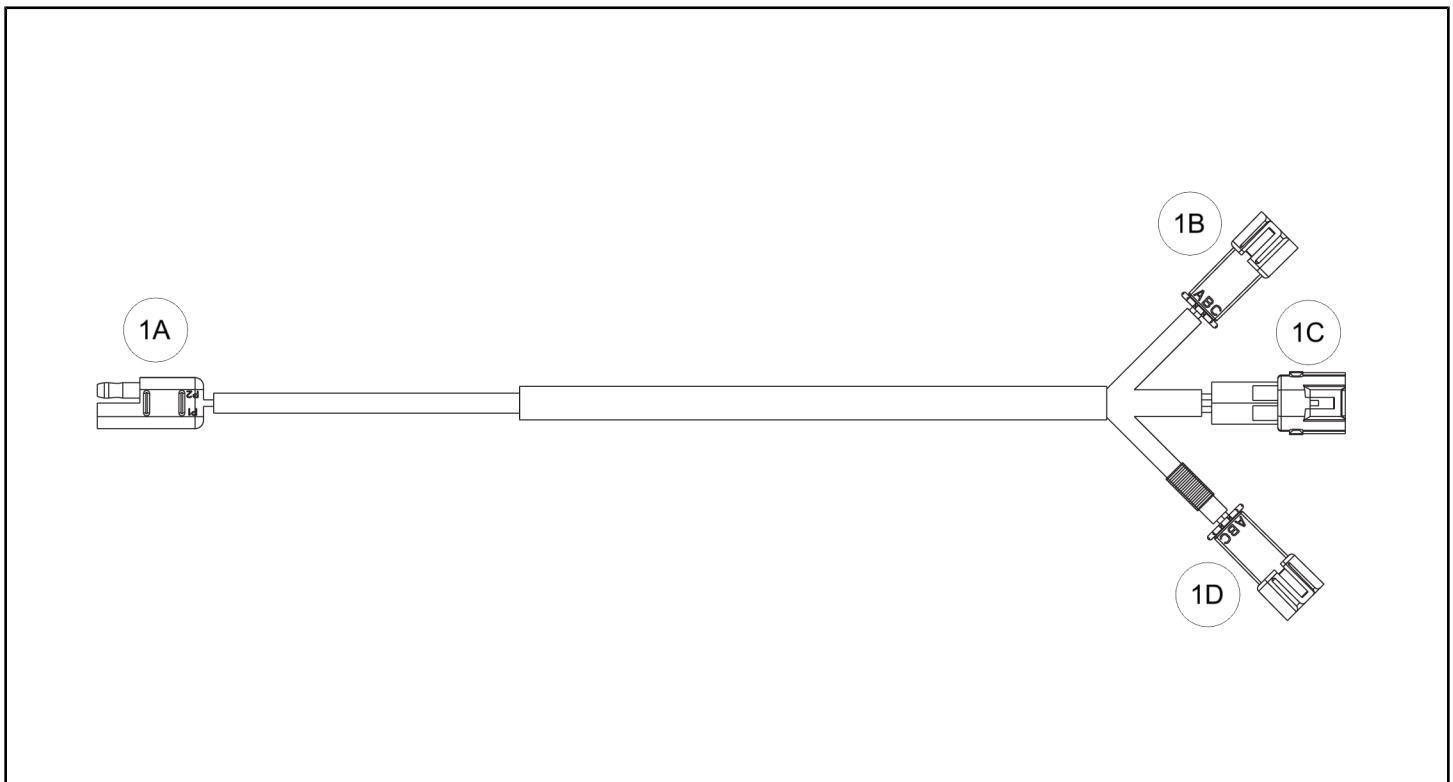

REF	PART DESCRIPTION	PIN QTY/ GENDER	CONNECTS TO
1A	Chassis Power Connector	2/Male/ Female	Chassis
1B	Right Handwarmer Connector	3/Female	Right Handwarmer
1C	Left Handlebar Connector	4/Female	Left Handlebar
1D	Left Handwarmer Connector	3/Female	Left Handwarmer

## MAIN HARNESS WITH HEATED SEAT (P/N 2415571)

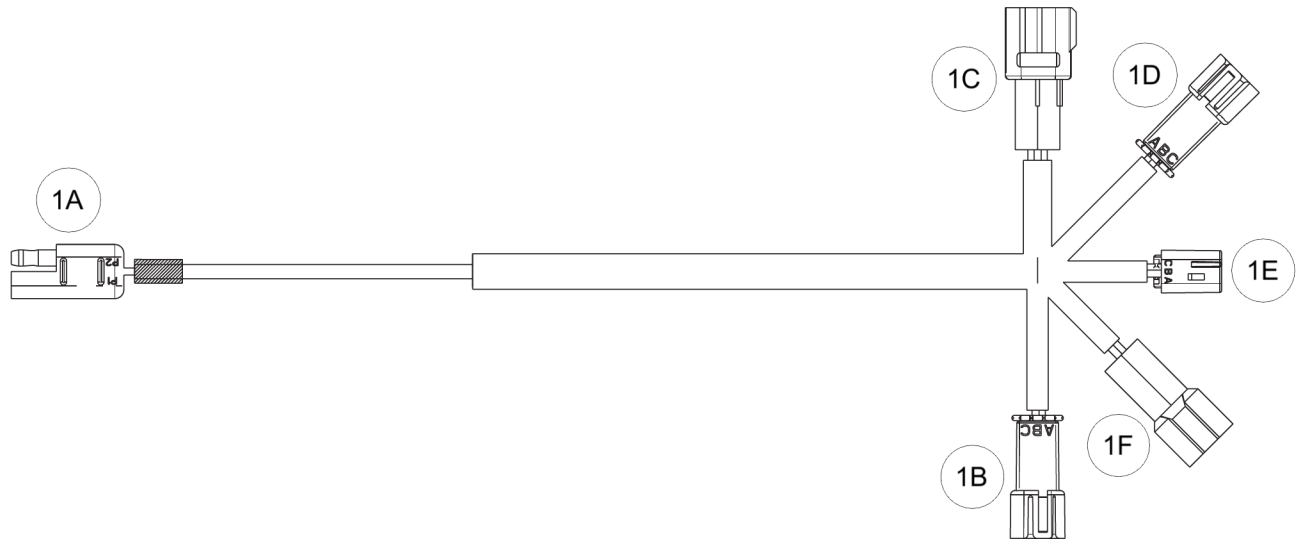

REF	PART DESCRIPTION	PIN QTY/ GENDER	CONNECTS TO
1A	Chassis Power Connector	2/Male/ Female	Chassis
1B	Right Handwarmer Connector	3/Female	Right Handwarmer
1C	Left Handlebar Connector	4/Female	Left Handlebar
1D	Left Handwarmer Connector	3/Female	Left Handwarmer
1E	Seat Heater Connector	3/Female	Seat Heater
1F	Right Handlebar Connector	3/Female	Right Handlebar

M2 HARNESS PLUG (P/N 2415844)

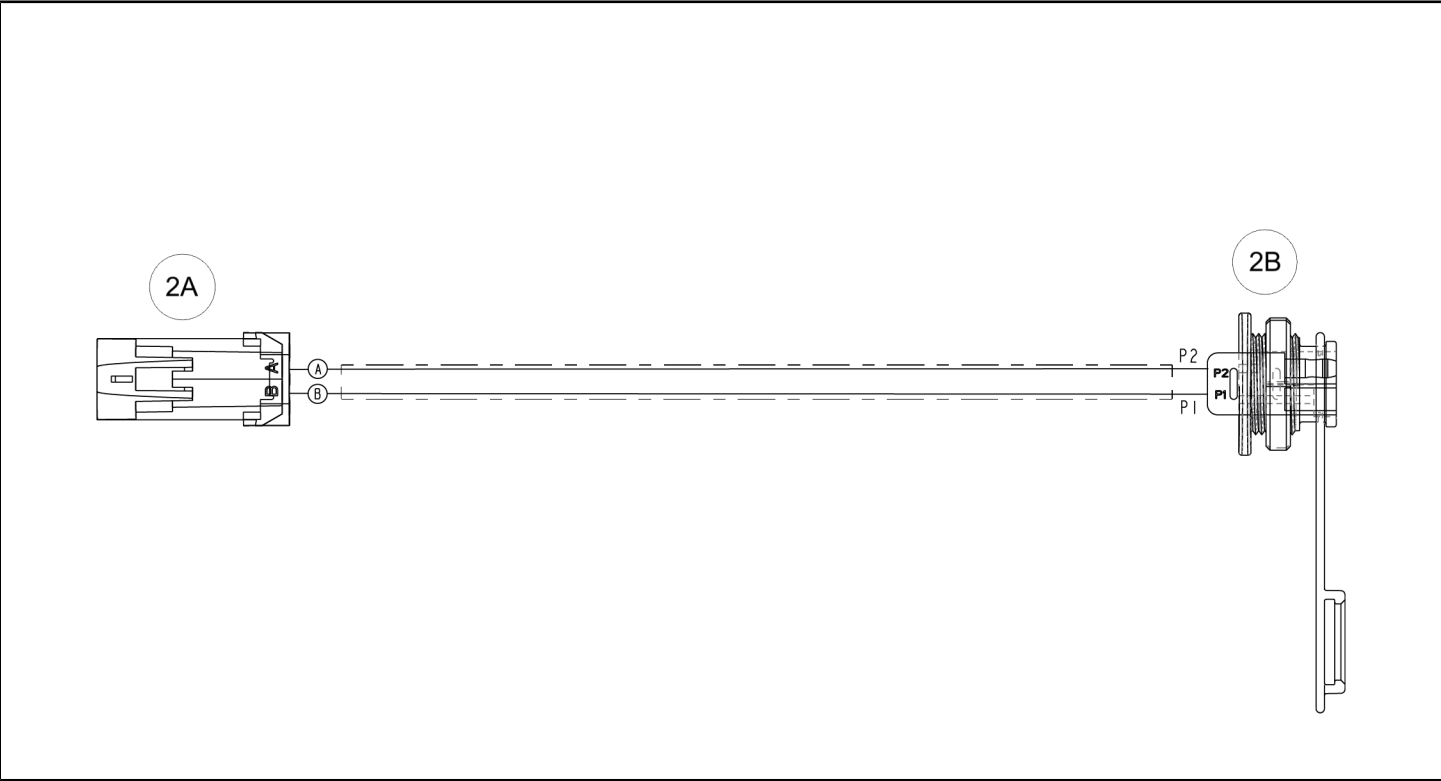

REF	PART DESCRIPTION	PIN QTY/ GENDER	CONNECTS TO
2A	Chassis Connector	2/Female	Chassis
2B	Accessory Power Port	2/Male/ Female	Passenger Seat Harness

TOOLS REQUIRED

- Safety Glasses
- Drill
- Hole Saw:
  - 1 in
- Socket Set, Metric
- Socket Set, Torx® Bit
- Torque Wrench
- Wrench Set, Metric

CONSUMABLES REQUIRED

- Cleaning Solution (99% water + 1% mild dishwashing detergent)
- Cloth, Non-Abrasive (Cheesecloth or equivalent)

IMPORTANT

Your M2 Seat Kit is exclusively designed for your vehicle. Please read the installation instructions thoroughly before beginning. Installation is easier if the vehicle is clean and free of debris. For your safety, and to ensure a satisfactory installation, perform all installation steps correctly in the sequence shown.

# INSTALLATION INSTRUCTIONS

## VEHICLE PREPARATION

### GENERAL

1. Park snowmobile on a flat surface.
2. Push the engine stop switch down to the OFF position.
3. Turn the key to the OFF position and remove key.
4. Turn the 1/4 turn latch at the rear of the seat and lift up to remove the seat.

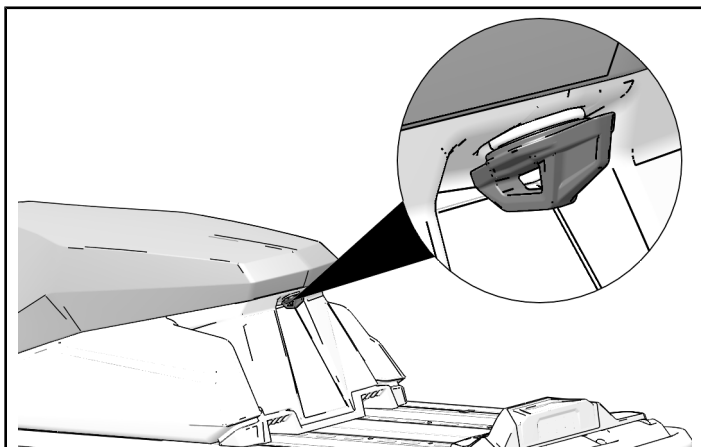

### NOTICE

Any previously installed accessories that may interfere with the installation of the M2 Seat Kit may need to be removed from the vehicle and set aside for later reinstallation before proceeding with this installation. See the installation manuals that accompanied previously installed accessory kits for details on removal and reinstallation.

## ACCESSORY INSTALLATION

1. Detach template page located at the end of this instruction.
2. Locate REFERENCE DIMENSION on each template page.

Verify REFERENCE DIMENSION is exact and template(s) were printed to proper scale.

### NOTICE

If REFERENCE DIMENSION is not exact, reprint template page from electronic file. Adjust print setting to **“Actual Size”** to obtain 1:1 scale. Electronic file available from your **Authorized Dealer**.

3. Place passenger seat power port template into position as shown and mark the location of the hole. Once marked, drill the required 1 inch hole in the rear tank cover.

### IMPORTANT

Control tool depth. Ensure tool is clear of all other parts and components to prevent damage to vehicle.

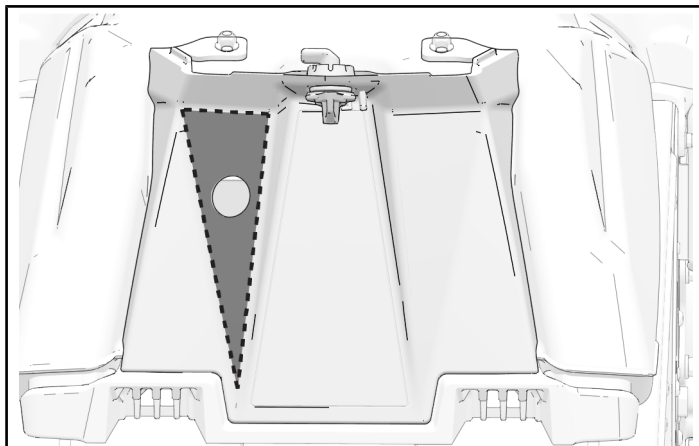

4. Install 12V power harness plug ② by removing the harness plug nut and inserting the harness plug through the rear tank cover from the inside to the outside and secure with previously removed harness plug nut. Tighten nut enough to securely hold plug in place being careful not to overtighten.

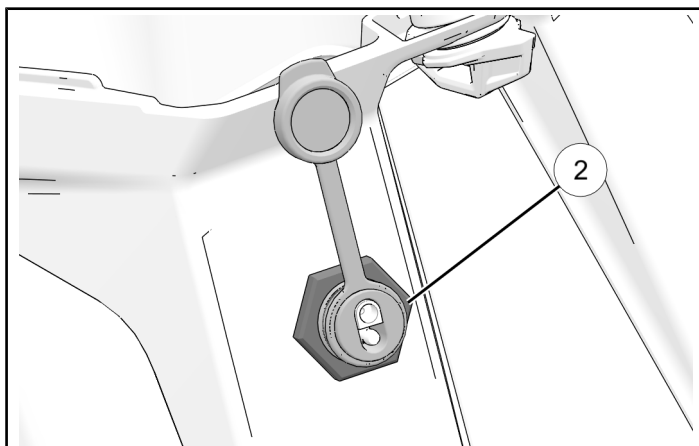

5. After installing harness plug, connect the female connector **2A** to the mating connector on the chassis harness as shown.

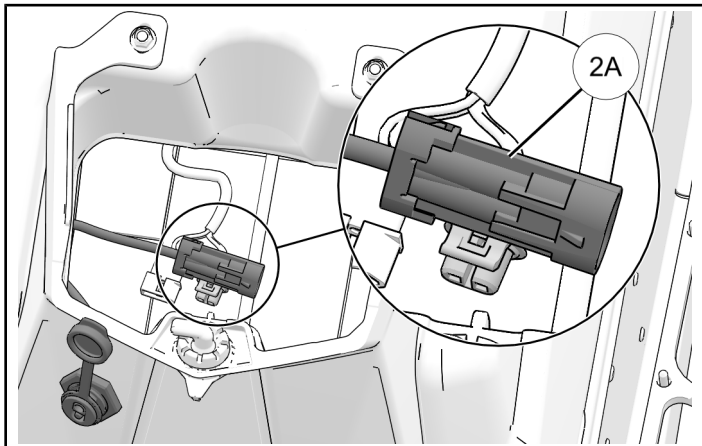

6. Reinstall the seat and secure with 1/4 turn latch.
7. Next, clean off the top of the tunnel and ensure hardware mounting channels are clean and free of debris using a non-abrasive cloth and mild cleaning solution.
8. Insert mounting t-slot screws **12** into opening in top of tunnel and slide into the approximate positions as shown.

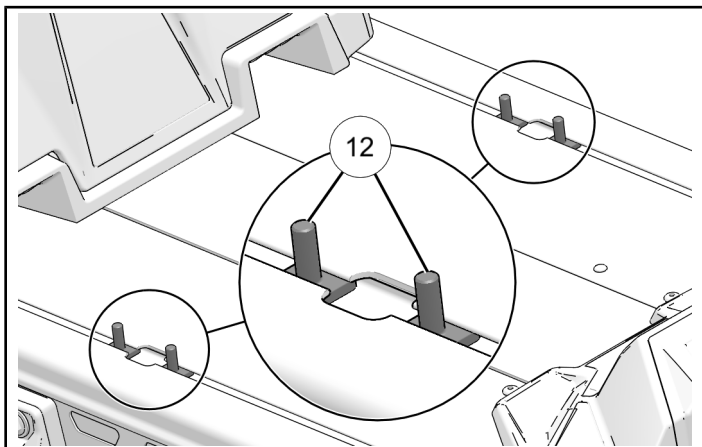

9. Install latch pin **8** and nuts **13**. Torque nuts to specification.

#### TORQUE

Latch Pin Nuts:  
**5 ft-lbs (7 N·m)**

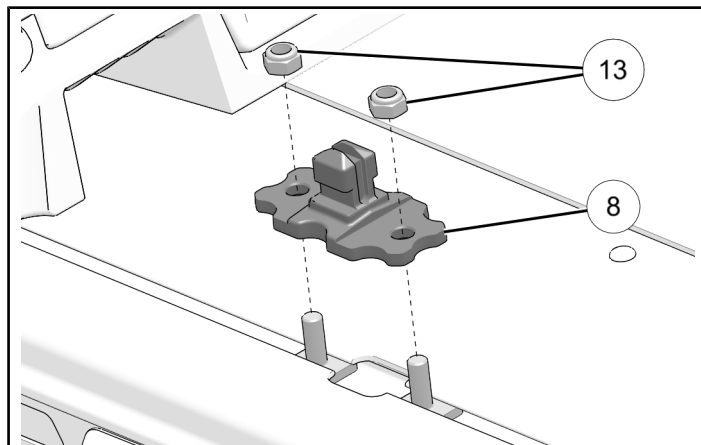

10. Repeat step 9 for the remaining latch pin on the other side.
11. Route the main seat harness **1** across the top of the seat frame assembly as shown.

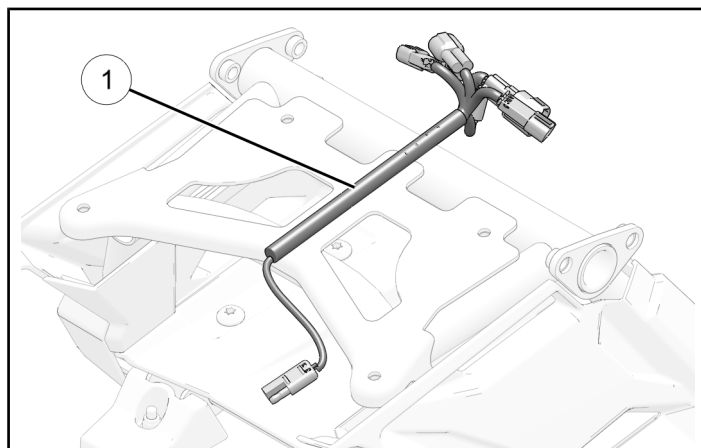

12. Install the passenger seat bun ⑥ onto the seat frame assembly by aligning the studs on the bottom of the seat bun with the mounting holes of the seat frame. Make sure the main seat harness is placed in the routing notch of the passenger seat bun.

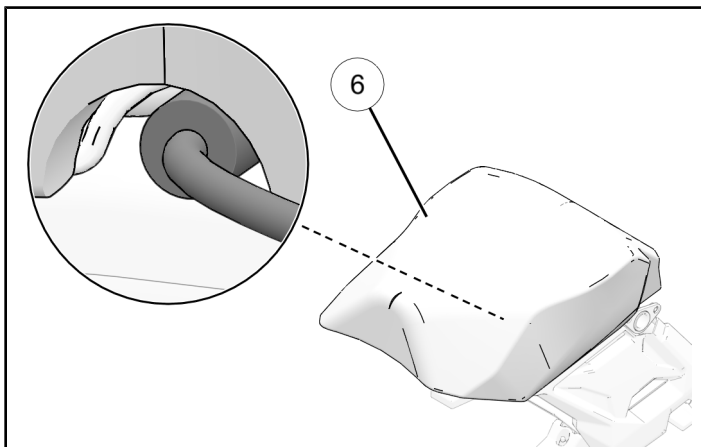

13. Install the four nuts ⑬ to secure the passenger seat bun and torque nuts to specification.

#### TORQUE

Seat Bun Nuts:  
5 ft-lbs (7 N·m)

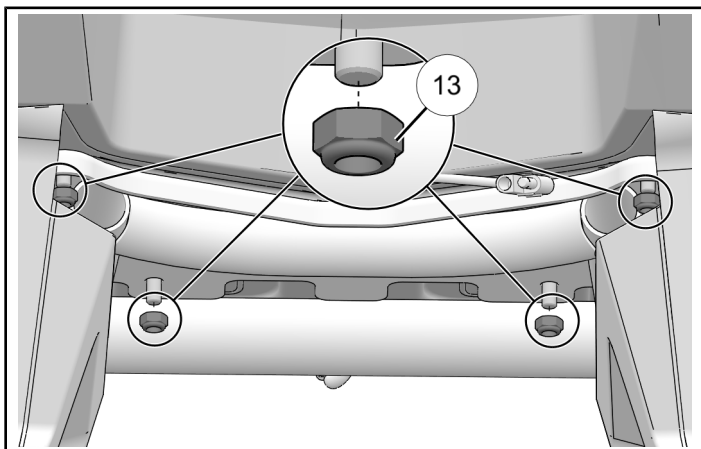

14. Carefully install the backrest seat assembly ⑦ onto the seat frame assembly.

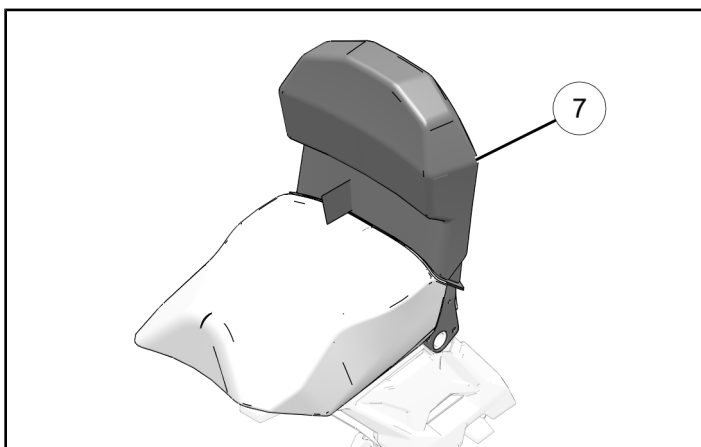

15. Loosely install the two rear fasteners ⑪ to secure the backrest seat assembly onto the seat frame assembly. Do not torque fasteners at this time.



16. Install left ③ and right ④ handhold assemblies into the seat frame assembly.

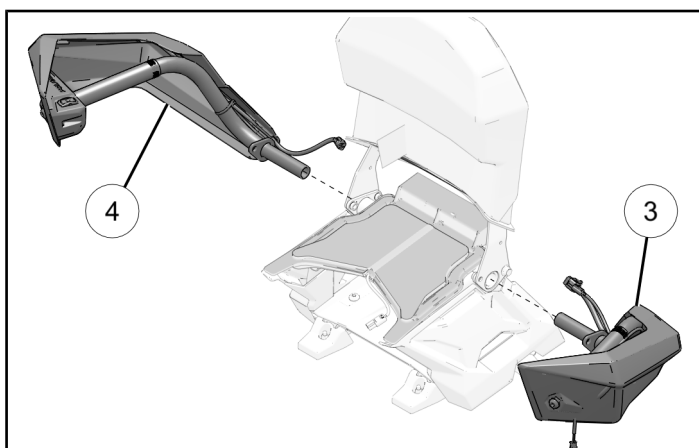

17. Install the two fasteners ⑪ to secure the handhold assemblies onto the seat frame assembly. Torque fasteners to specification.

#### TORQUE

Handhold Fasteners:  
22 ft-lbs (30 N·m)

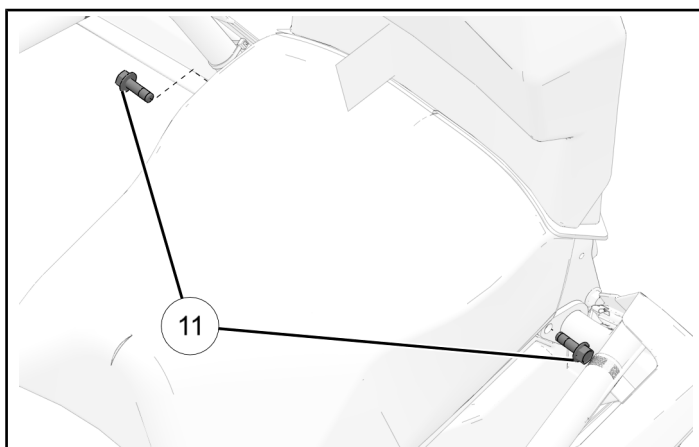

18. Remove the rear two fasteners (A) that secure the passenger handguards to the handholds.

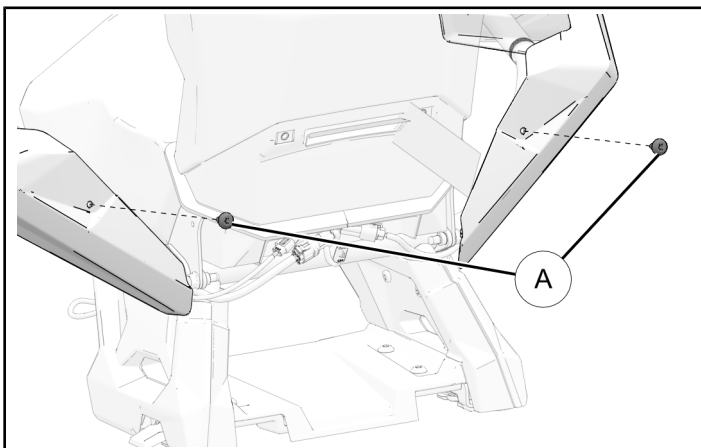

19. Carefully flex the passenger handguards downward and torque the two previously installed fasteners (11) to specification.

#### **TORQUE**

**Backrest Seat Assembly Fasteners:**  
**22 ft-lbs (30 N·m)**

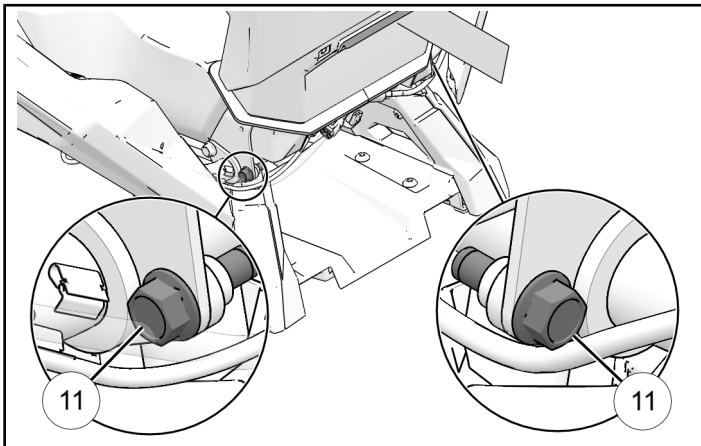

20. Reinstall the rear two fasteners (A) that secure the passenger handguards to the handholds. Torque fasteners to specification.

#### **TORQUE**

**Handguard Fasteners:**  
**7 ft-lbs (10 N·m)**

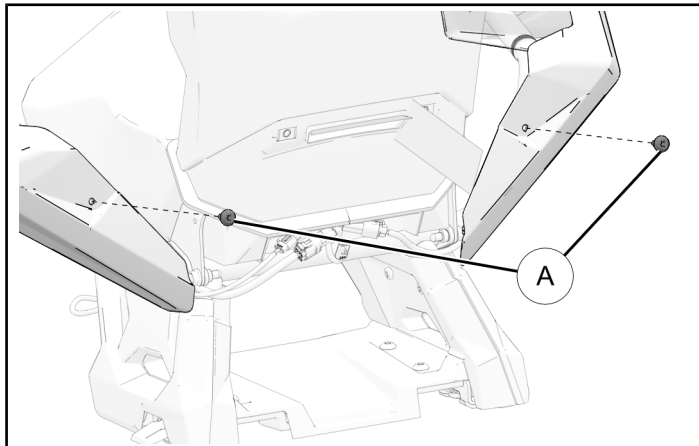



21. At the rear of the passenger seat, connect each handhold assembly harness connector and seat bun connector if applicable to the mating connectors on the main seat harness as shown.

**NOTICE**

Each connector of the main seat harness is different and can only be connected to the respective connector of the handhold assemblies and seat bun if applicable.

**Without Heated Seat**

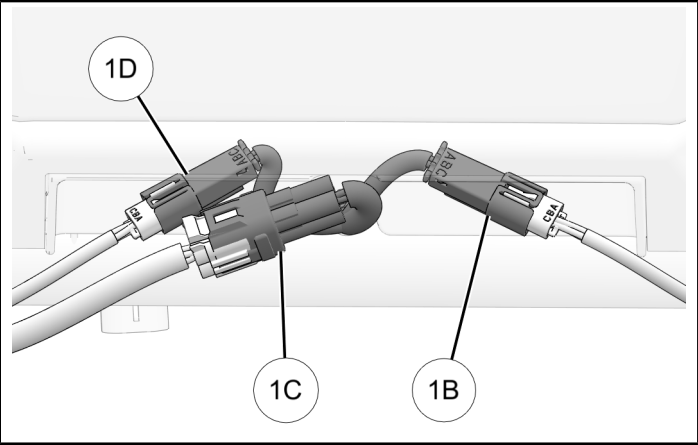

REF	PART DESCRIPTION	CONNECTS TO
1B	Right Handwarmer Connector	Right Handwarmer
1C	Left Handlebar Connector	Left Handlebar
1D	Left Handwarmer Connector	Left Handwarmer

**With Heated Seat**

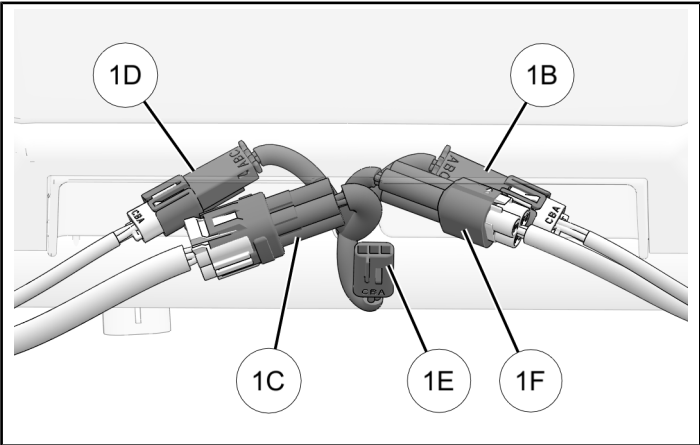

REF	PART DESCRIPTION	CONNECTS TO
1B	Right Handwarmer Connector	Right Handwarmer
1C	Left Handlebar Connector	Left Handlebar
1D	Left Handwarmer Connector	Left Handwarmer
1E	Seat Heater Connector	Seat Heater
1F	Right Handlebar Connector	Right Handlebar

22. Install the passenger seat backrest cover ⑨ and four fasteners ⑩. Torque fasteners to specification.

**TORQUE**

Backrest Cover Fasteners:  
**5 ft-lbs (7 N·m)**

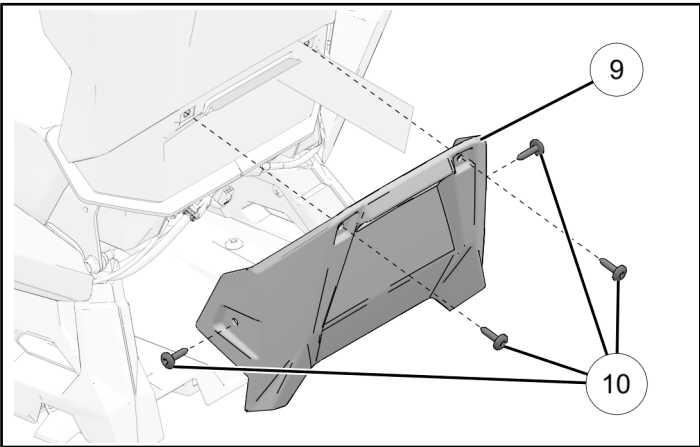

23. Position the seat assembly near the mounting position and plug in the main seat harness connector **1A** to the 12V power harness plug **2B** as shown.

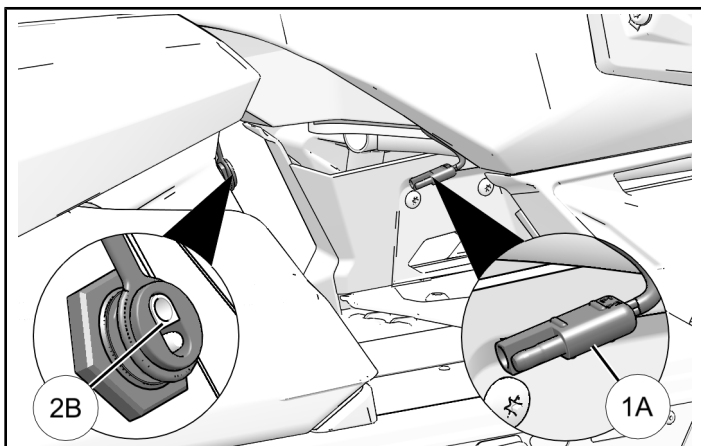

24. Install the seat frame assembly by carefully aligning the latch pins and then lift up on the latch handles to engage the latches of the seat frame assembly in place. Test to make sure the seat frame assembly is fully secured by pulling on the assembly.

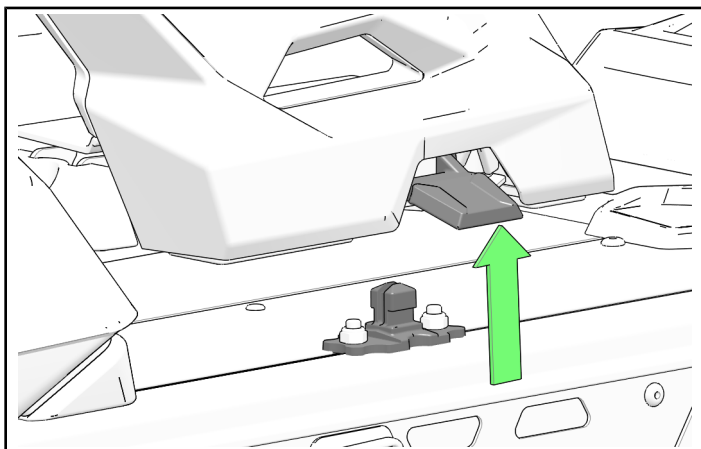

## OPERATION

### HANDWARMER SWITCH

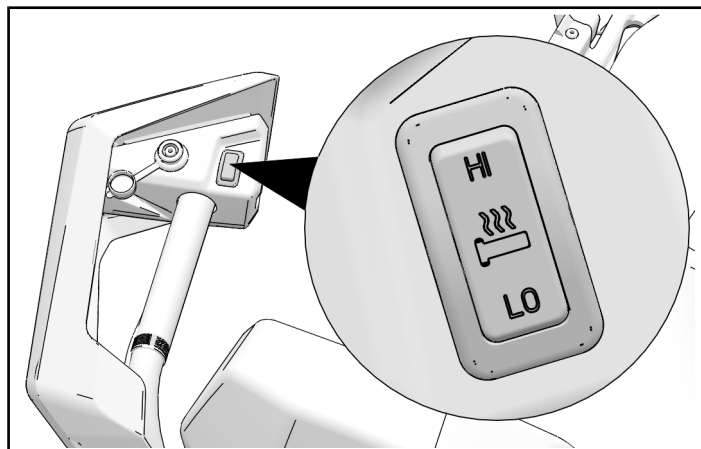

Push the switch up to activate the High heat setting or push the switch down to activate the Low heat setting. Return the switch to the middle position to turn the handwarmers off.

### HEATED SEAT SWITCH

Applicable to heated seat models only.

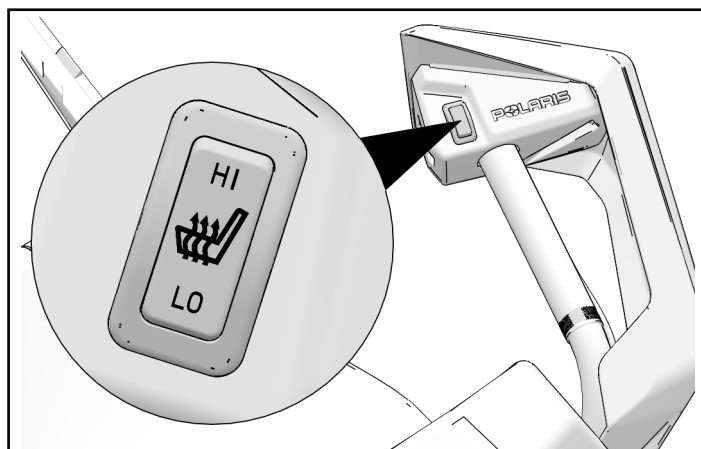

Push the switch up to activate the High heat setting or push the switch down to activate the Low heat setting. Return the switch to the middle position to turn the heated seat off.

## INSTRUCTION FEEDBACK FORM

A feedback form has been created for the installer to provide any comments, questions or concerns about the installation instructions. The form is viewable on mobile devices by scanning the QR code or by clicking [HERE](#) if viewing on a PC.



TEMPLATE

