

PIDD POWER-UP KIT



P/N 2882200

APPLICATION

All Axys Models

NOTE

This kit consists of battery mounting and harness only. You will need to purchase a 12V battery (sold separately) for installation. Polaris recommends using battery (Polaris PN 4016625) for installation.

BEFORE YOU BEGIN

Read these instructions and check to be sure all parts and tools are accounted for. Please retain these installation instructions for future reference and parts ordering information.

KIT CONTENTS

This Kit includes:

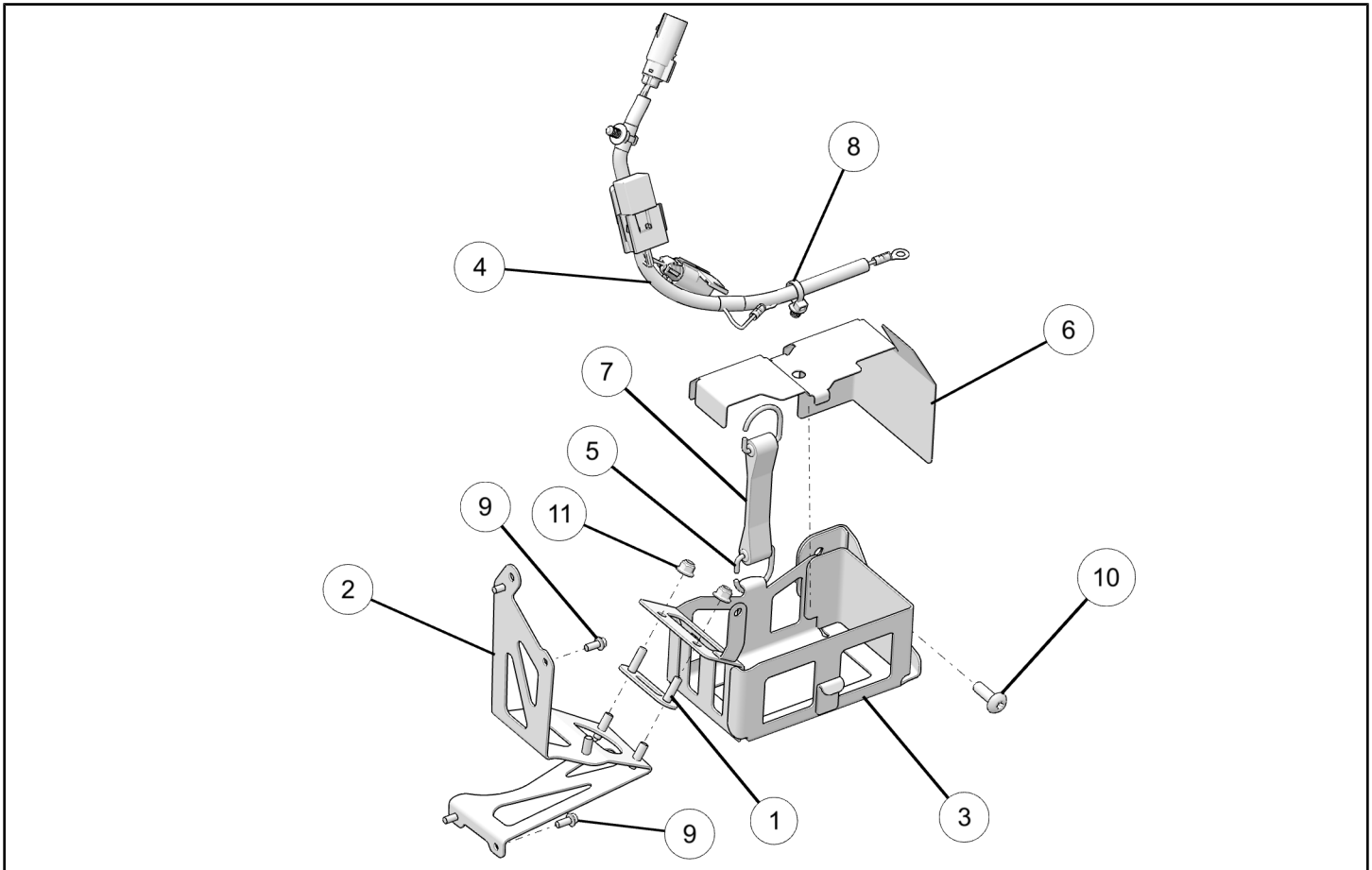

REF	QTY	PART DESCRIPTION	PART NUMBER
1	1	Stud Plate (For Trail Performance Only)	1017181
2	1	Battery Box Bracket (For RMK Only)	1020323
3	1	Battery Box	1022721

REF	QTY	PART DESCRIPTION	PART NUMBER
4	1	Harness, PIDD Power-Up	2413633
5	2	D-Hook	5224468
6	1	Battery Shield	5263152
7	1	Rubber Strap	5410608
8	1	Panduit Strap with Christmas Tree Clip	7081334
9	4	Screw Hex Flange - M5 X 0.8 X 12	7518894
10	1	Screw Hex Flange - M8 X 1.25 X 25	7518906
11	2	Nut - M6 X 1.0	7547339
	1	Instructions	9927360

TOOLS REQUIRED

- Safety Glasses
- Spring Puller
- 10mm Wrench
- T40 Torx®
- 7mm Wrench

IMPORTANT

Your PIDD POWER-UP KIT is exclusively designed for your vehicle. Please read the installation instructions thoroughly before beginning. Installation is easier if the vehicle is clean and free of debris. For your safety, and to ensure a satisfactory installation, perform all installation steps correctly in the sequence shown.

ASSEMBLY TIME

Approximately 30 minutes

INSTALLATION INSTRUCTIONS

1. Rotate the two 1/4 turn latches (A) at the front and rear of the panel (C) and release the strap (B) at the lower edge of the panel.

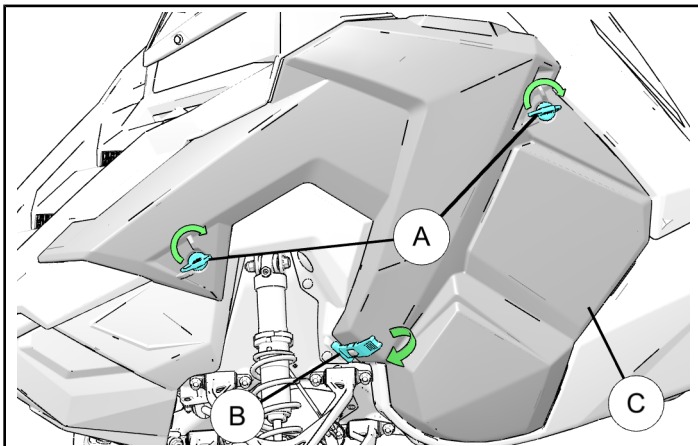

2. Open the side panel (C), then pull the panel outward to release the tabs at the bottom. Similarly, remove side panel on other side of the vehicle.

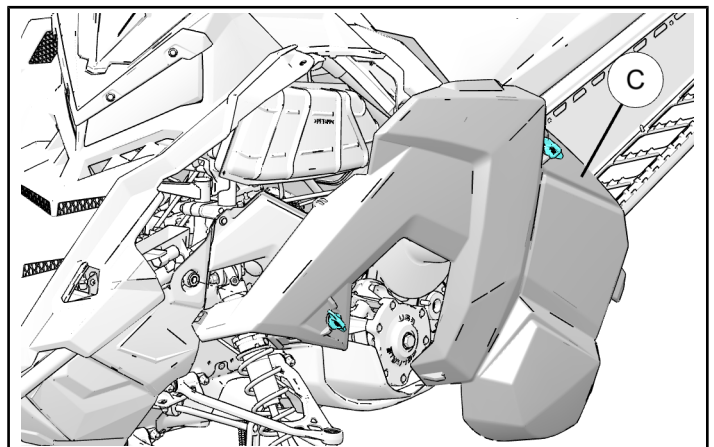

3. Rotate the 1/4 turn knobs (D) at the rear corners of the hood (E).

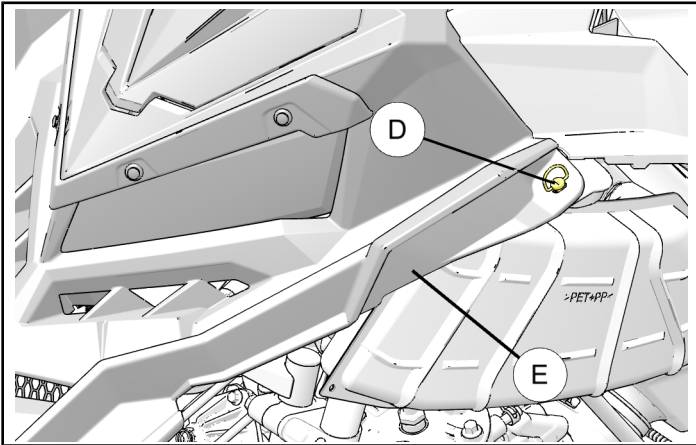

6. Using spring puller, detach four springs (H) and remove exhaust silencer assembly (G) from the sled.

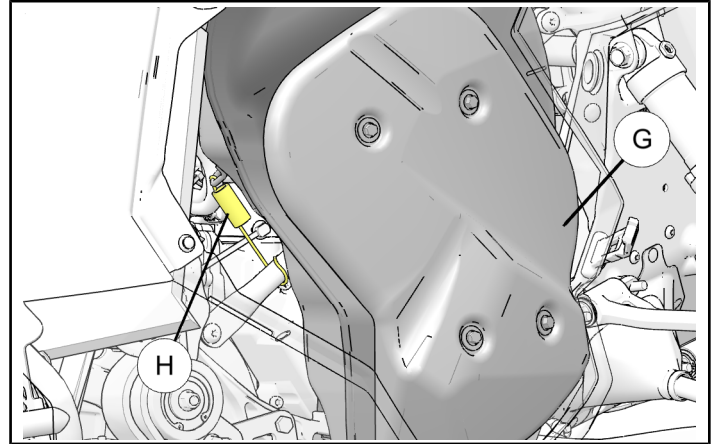

4. Disconnect the hood wire harness connector (F).

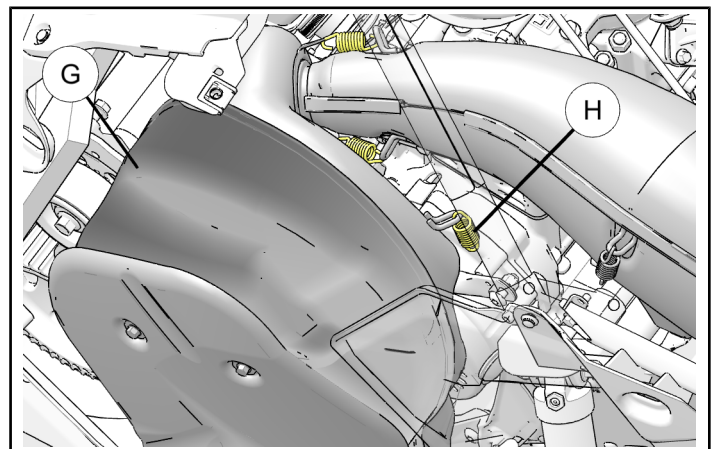

5. Remove the hood assembly (E) from your sled.

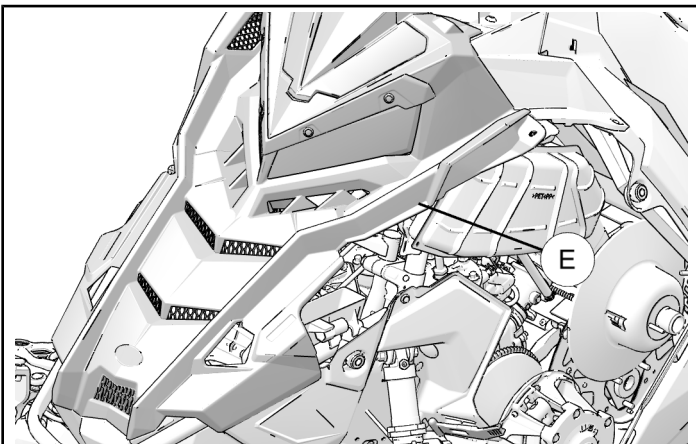

7. **For RMK Models:** Align and install battery box bracket ② onto four nutserts (J) using screws ⑨ as shown. Mount the battery box ③ to battery box bracket ② using two nuts ⑪ and to the bulkhead side using one screw ⑩ as shown. Use 7mm wrench for screws ⑨, 10mm wrench for nuts ⑪, and T40 Torx® for screw ⑩ installation.

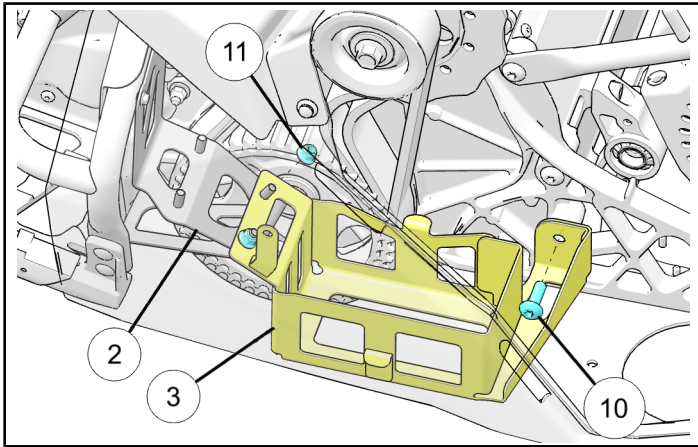
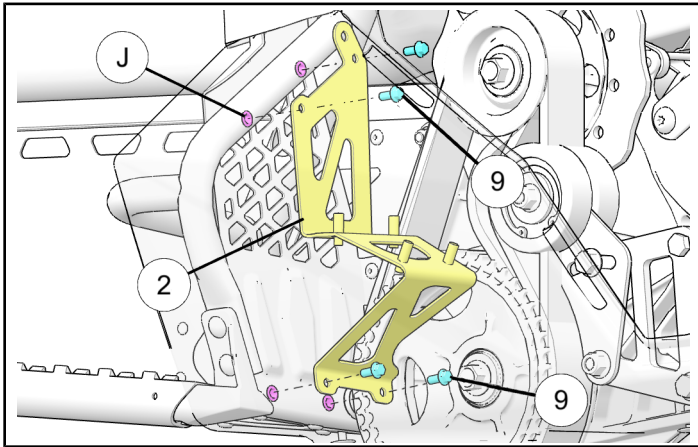

8. **For Trail Performance Models:** Insert two studs on stud plate ① through holes on RH footrest (K) from underside as shown. Hold stud plate in this location and mount the battery box ③ onto studs and install two nuts ⑪. Mount the battery box to bulkhead side using one screw ⑩ as shown. Use 10mm wrench for nuts ⑪ and T40 Torx® for screw ⑩ installation.

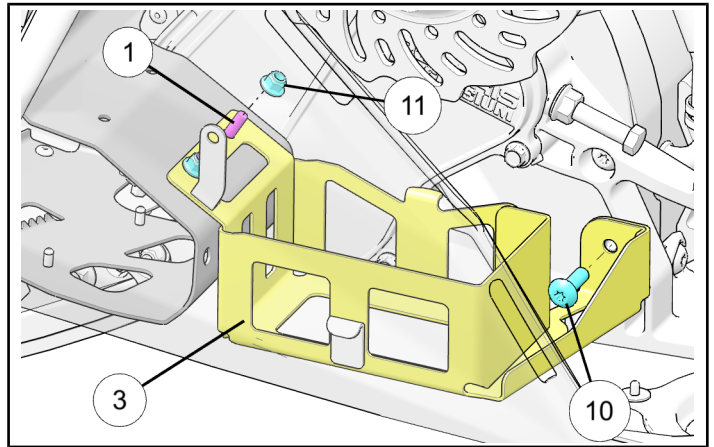
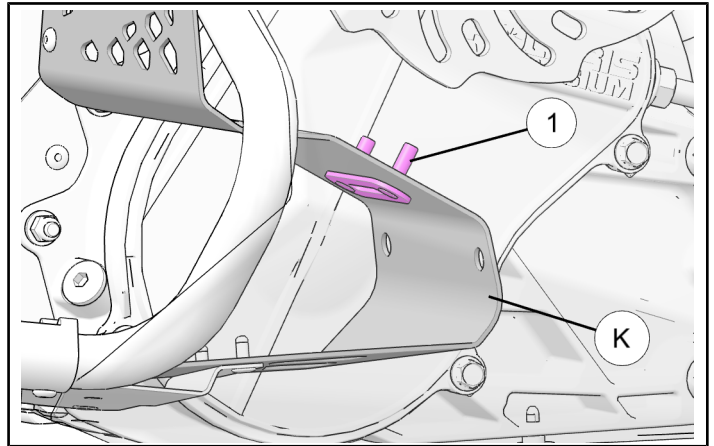

9. Place the battery (M) into the battery box and connect two terminals on harness ④ to their respective battery terminals (L) as shown. Connect positive terminal first, followed by negative terminal.

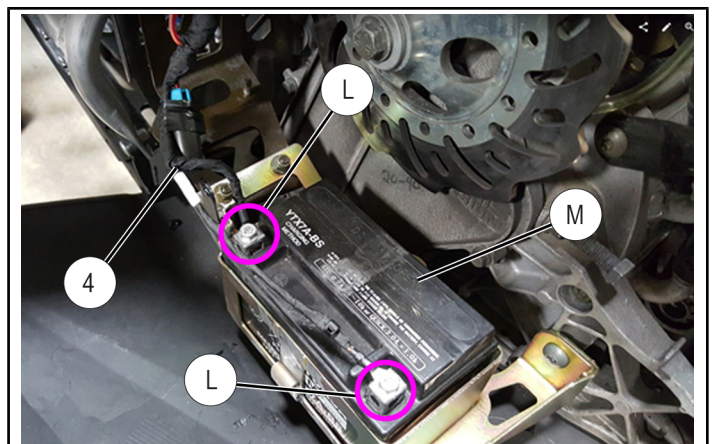

10. Install Panduit strap with Christmas tree clip ⑧ onto the harness ④ at the white tape closest to terminal and install clip into hole on the tab of the battery box as shown.

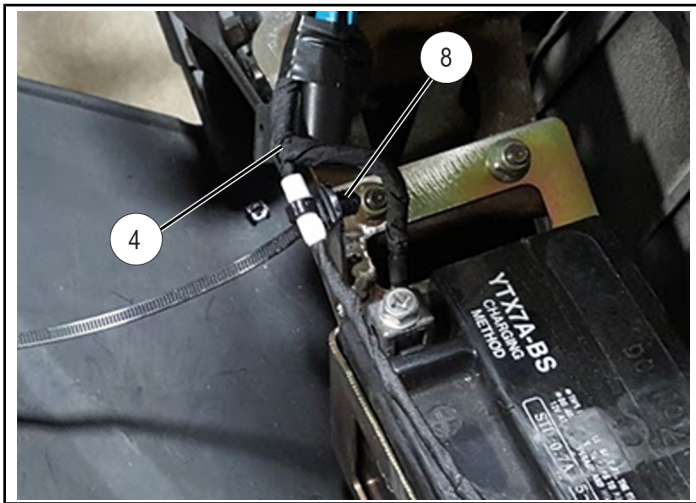

11. Install harness mounted Christmas tree clip (P) to the white tape nearest to main harness plug and install onto the hole on the aluminum tube as shown.

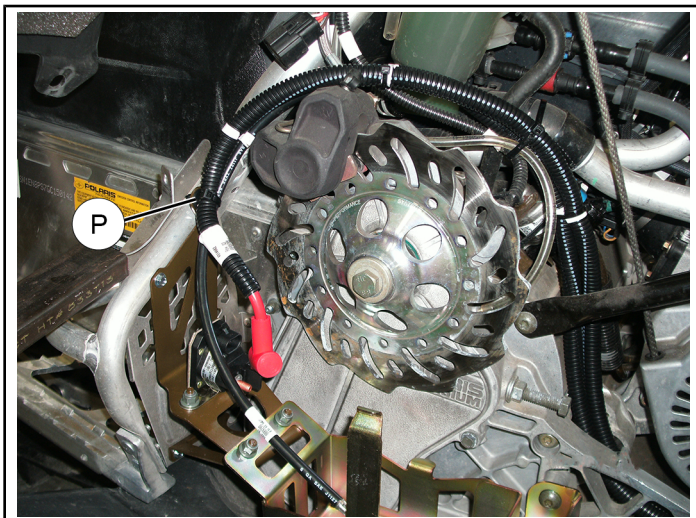

12. Mount the battery shield ⑥ onto battery and secure in place using rubber strap ⑦. Install rubber strap hook ⑤ onto the tab on battery box bracket as shown.

NOTE

Battery and harness are not shown in the below image.

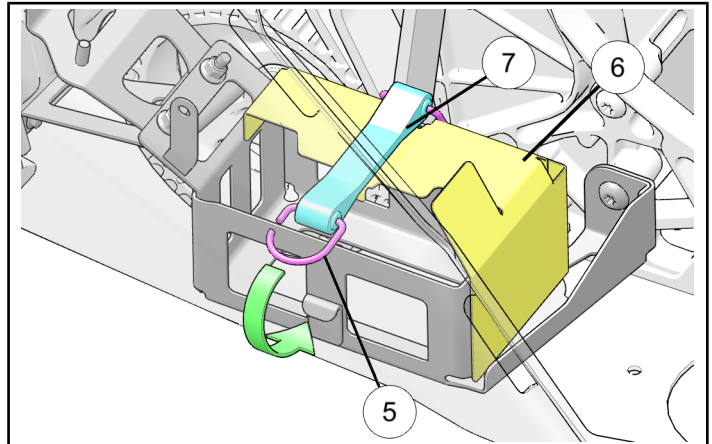

13. Plug PIDD power-up harness ④ into main harness (N).

