

ARO™ EXTREME BUMPER KIT



P/N 2883657

APPLICATION

The ARO Extreme Bumper Kit fits all Timbersled ARO models.

BEFORE YOU BEGIN

Read these instructions and check to be sure all parts and tools are accounted for. Please retain these installation instructions for future reference and parts ordering information.

KIT CONTENTS

This Kit includes:

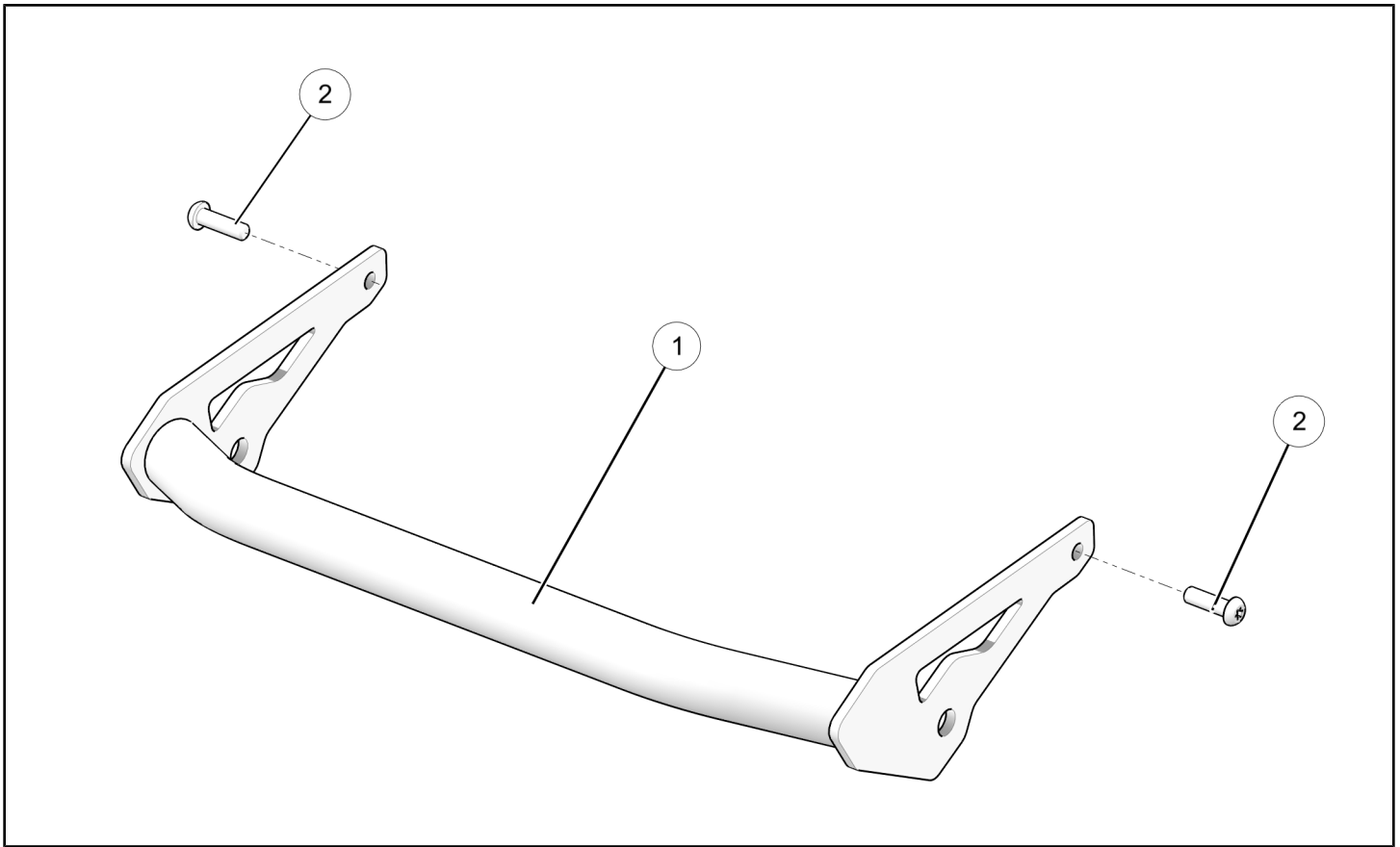

REF	QTY	PART DESCRIPTION	PART NUMBER
1	1	ARO Extreme Bumper	1024426
2	2	Torx Head Screw - M6 X 1.0 X 25	7520239
	1	Instructions	9928964

TOOLS REQUIRED

- Safety Glasses
- Torque Wrench
- Socket Set, Torx® Bit

CONSUMABLES REQUIRED

- LOCTITE® 243™ Blue

IMPORTANT

Your ARO™ Extreme Bumper Kit is exclusively designed for your vehicle. Please read the installation instructions thoroughly before beginning. Installation is easier if the vehicle is clean and free of debris. For your safety, and to ensure a satisfactory installation, perform all installation steps correctly in the sequence shown.

ASSEMBLY TIME

Approximately 12 minutes

NOTE

Additional time may be required for optional steps, or to accommodate other installed accessories.

INSTALLATION INSTRUCTIONS

CAUTION

BEFORE STARTING INSTALLATION, always ensure vehicle is on a flat stable surface and is properly secured to avoid accidental tipping or other movement in order to prevent personal injury and/or damage to equipment. If applicable, turn key to “OFF” position and remove from vehicle.

1. Remove the two rear most bolts **A** and **B** on each side of the tunnel as shown. Discard forward most bolts **A** as they will be replaced with provided new bolts **2**.

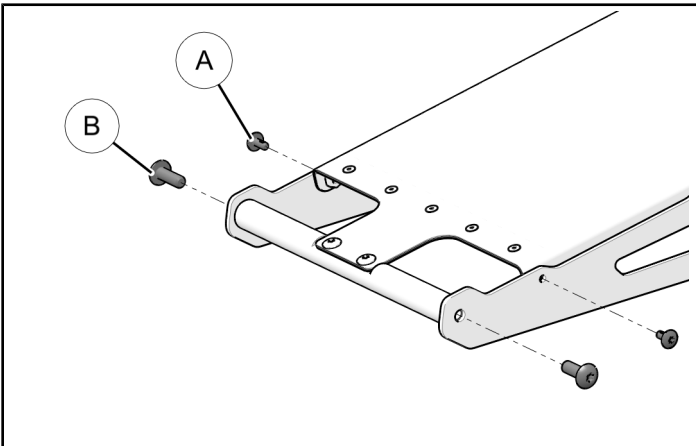

2. Place ARO Extreme Bumper **1** over the top and outsides of the tunnel as shown being sure to line up the mounting holes with the side panel bolt holes.

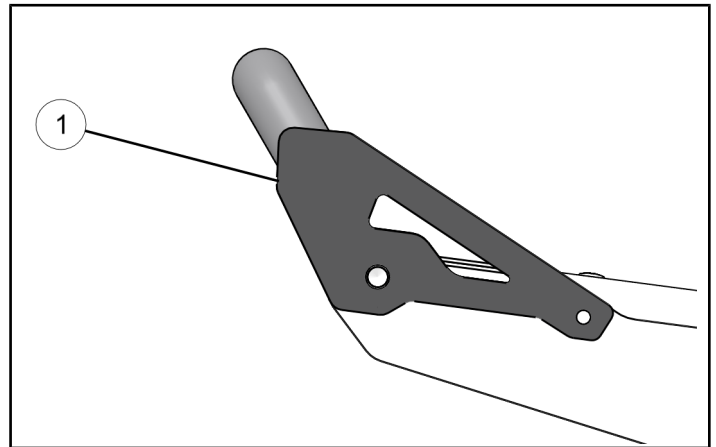

3. Apply LOCTITE® 243™ Blue to threads of provided two bolts **2** and install into the forward most mounting holes as shown. **DO NOT TIGHTEN** at this time.

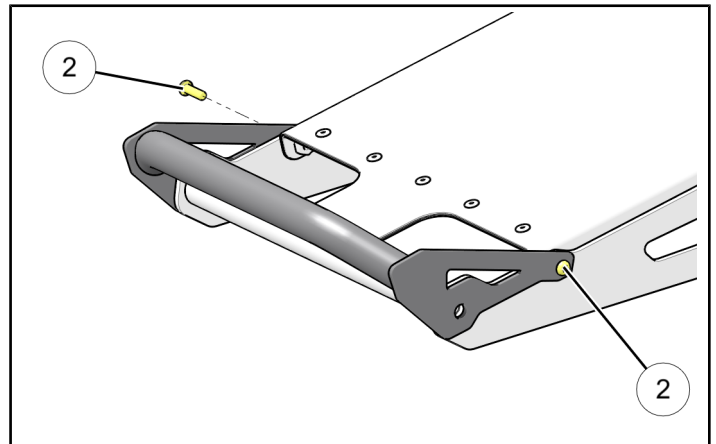

4. Next apply LOCTITE® 243™ Blue to the two rear most bolts ② previously removed and reinstall into two rear most mounting holes as shown. DO NOT TIGHTEN at this time.

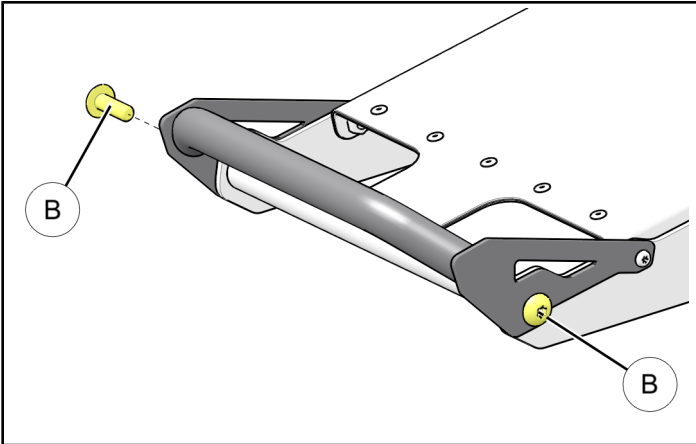

5. After starting all mounting bolts by hand, torque the forward most bolts ② to specification provided starting with the left side (drive-side) bolt FIRST followed by the right side.

TORQUE

57.5 in. lbs. (6.5 Nm)

6. Next, torque the two rear most bolts ② to specification provided starting with the left side (drive-side) bolt FIRST followed by the right side bolt.

TORQUE

18.5 ft. lbs. (25 Nm)

7. Check to ensure all tools are accounted for and all steps have been completed as required.

FEEDBACK FORM

A feedback form has been created for the installer to provide any comments, questions or concerns about the installation instructions. The form is viewable on mobile devices by scanning the QR code or by clicking [HERE](#) if viewing on a PC.

FEEDBACK FORM

