

# TIMBERSLED® FUEL CAN STRAP KIT



P/N 2882635

## APPLICATION

Timbersled Mountain Horse SX120, SX137, ST120, LT137, and RAW models.

## BEFORE YOU BEGIN

Read these instructions and check to be sure all parts and tools are accounted for. Please retain these installation instructions for future reference and parts ordering information.

## KIT CONTENTS

This Kit includes:

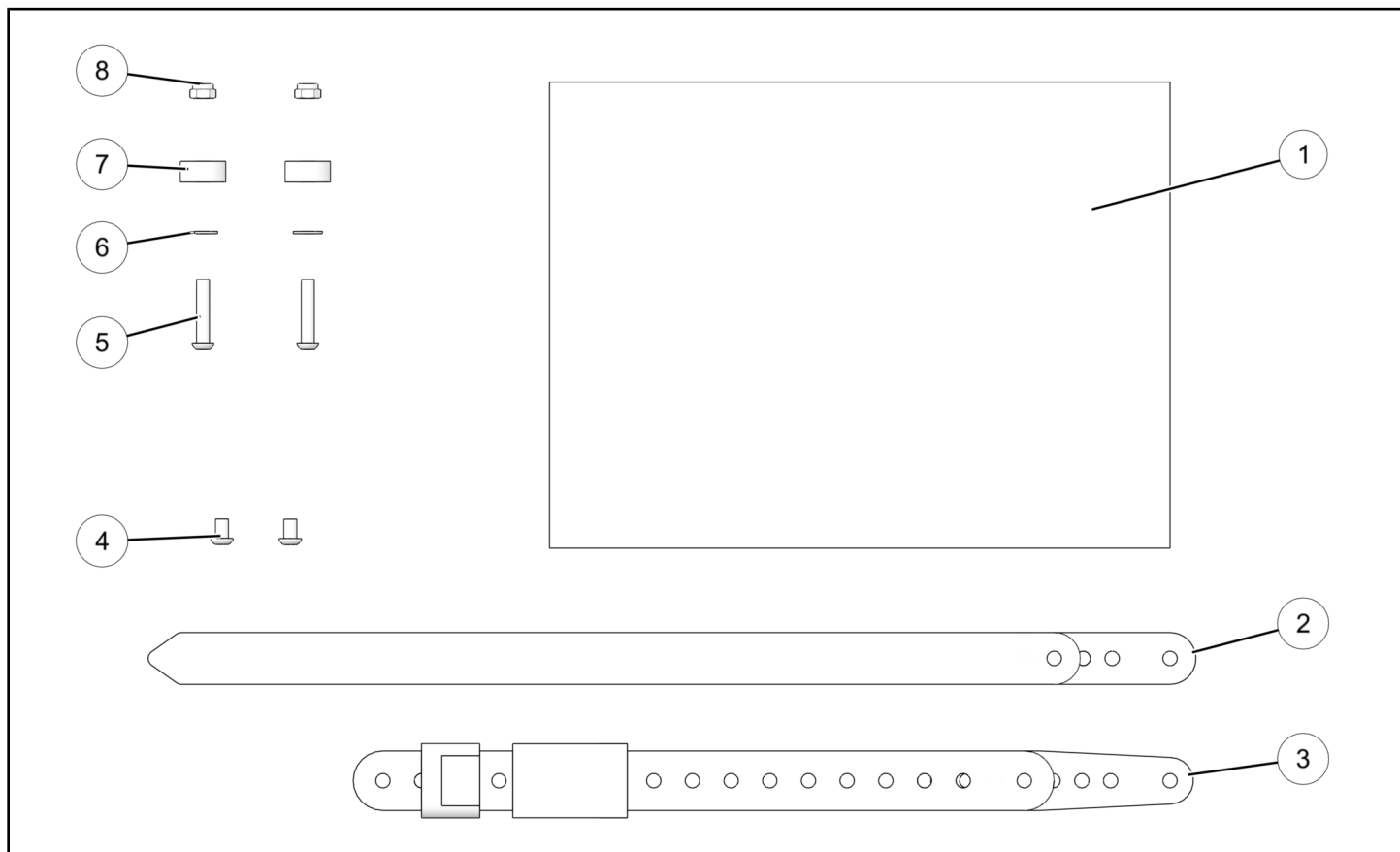

REF	QTY	PART DESCRIPTION	PART NUMBER
1	1	Gas Mat	5416582
2	1	Ladder Strap	1590593
3	1	Ratchet Strap	1590593
4	2	Bolt, 1/4-20 X .375	7520616
5	2	Bolt, 1/4-20 X 1.25	7520627
6	2	Washer, .250 X .563 X .047	7558203
7	2	Strap Spacer - Mountain Horse Models ONLY	5142447

REF	QTY	PART DESCRIPTION	PART NUMBER
8	2	Nut, Locking 1/4-20	7542122
	1	Instructions	9928963

## TOOLS REQUIRED

- Safety Glasses
- Hex Key Set, Metric
- Socket Set, Metric
- Socket Set, SAE
- Tie-Down Straps (or equivalent)
- Torque Wrench
- Wrench Set, Metric
- Wrench Set, SAE
- Vehicle Lift/Support Equipment

## CONSUMABLES REQUIRED

- Lint Free Cloth, Non-Abrasive
- Isopropyl Alcohol (IPA)

### WARNING

Isopropyl alcohol is hazardous to your health. See isopropyl alcohol packaging for proper handling instructions, including recommended personal protective equipment such as goggles and chemical resistant gloves.

## IMPORTANT

Your Timbersled® Fuel Can Strap Kit is exclusively designed for your vehicle. Please read the installation instructions thoroughly before beginning. Installation is easier if the vehicle is clean and free of debris. For your safety, and to ensure a satisfactory installation, perform all installation steps correctly in the sequence shown.

## ASSEMBLY TIME

Approximately 18 minutes

### NOTE

Additional time may be required for optional steps, or to accommodate other installed accessories.

## INSTALLATION INSTRUCTIONS

### CAUTION

**BEFORE STARTING INSTALLATION**, always ensure vehicle is on a flat stable surface and is properly secured to avoid accidental tipping or other movement to prevent personal injury and/or damage to equipment. If applicable, turn key to "OFF" position and remove from vehicle.

### TIMBERSLED® ST, LT AND RAW MODELS

1. At room temperature, allow gas mat ① to lay flat until all folds are out.
2. Clean tunnel top with isopropyl alcohol.
3. Align widest edge of gas mat with front tunnel top gusset rivets and center mat sides between snow bike side panels.
4. Remove adhesive backing at front corner and carefully adhere mat to tunnel top as shown.

### NOTE

Be careful to insure alignment during adhesion.

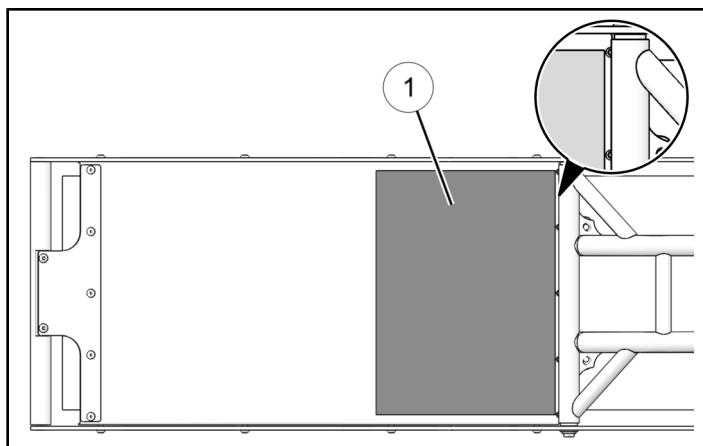

5. Install ratchet strap ③ to drive side panel in the location indicated below using the supplied fasteners ④ as shown. DO NOT use flat washers on Timbersled RAW kits.

Torque to specification.

### TORQUE

24 in. lbs (2.7 Nm)

### IMPORTANT

Apply LOCTITE® 243™ threadlocker or equivalent to threads of fastener before installing.

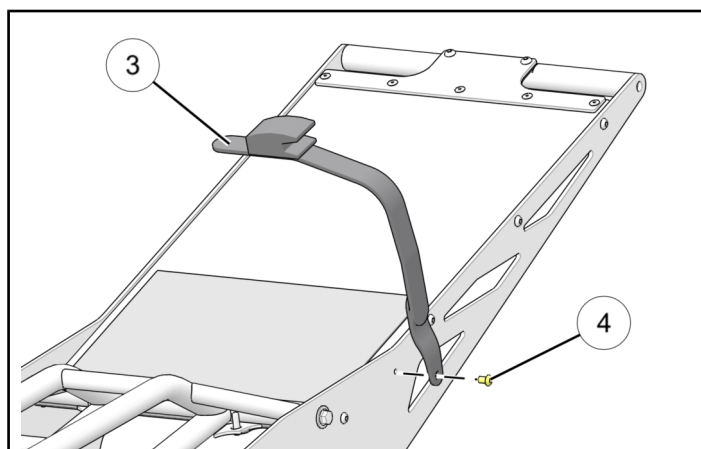

6. Install ladder strap ② to non drive side panel in the location indicated below using the supplied fasteners ④ as shown. DO NOT use flat washers on Timbersled RAW kits.

Torque to specification.

#### TORQUE

24 in. lbs (2.7 Nm)

#### IMPORTANT

Apply LOCTITE® 243™ threadlocker or equivalent to threads of fastener before installing.

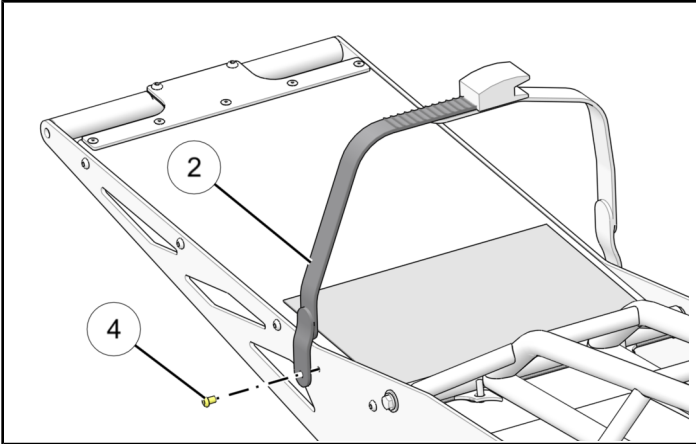

7. Check to make sure all tools are accounted for and all necessary steps have been completed.

### TIMBERSLED® SX MODELS

1. At room temperature, allow gas mat ① to lay flat until all folds are out.
2. Clean tunnel top with isopropyl alcohol.
3. Align widest edge of gas mat with front tunnel top gusset rivets and center mat sides between snow bike side panels.
4. Remove adhesive backing at front corner and carefully adhere mat to tunnel top as shown.

#### NOTE

Be careful to insure alignment during adhesion.

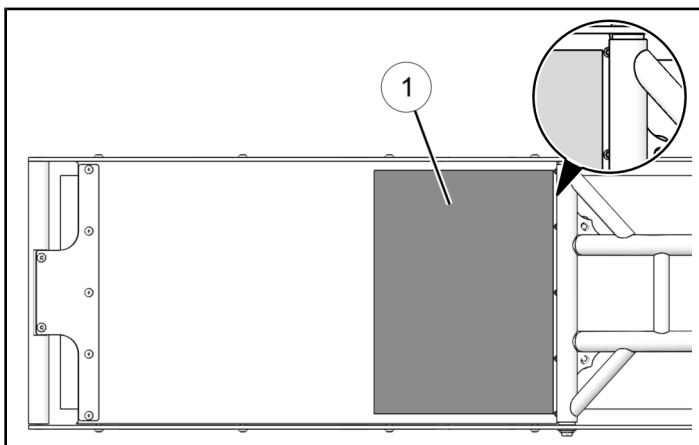

5. Remove the first side panel/tunnel top side screw located directly back from the center of the rear sub-frame cross mount tube on both sides of vehicle.
6. Install ratchet strap ③ to drive side panel ① in the location of the previously removed screw using the supplied fasteners ⑤, ⑥, ⑦ and ⑧ as shown.

Torque to specification.

#### TORQUE

24 in. lbs (2.7 Nm)

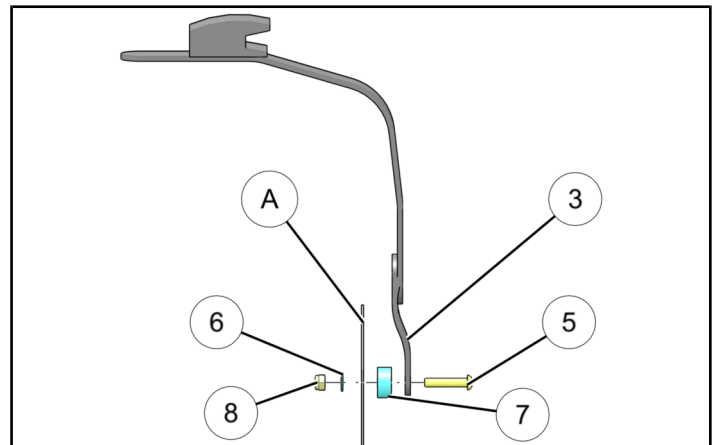

7. Install ladder strap ② to non drive side panel ⑧ in the location of the previously removed screw using the supplied fasteners ⑤, ⑥, ⑦ and ⑧ as shown.

Torque to specification.

TORQUE
24 in. lbs (2.7 Nm)

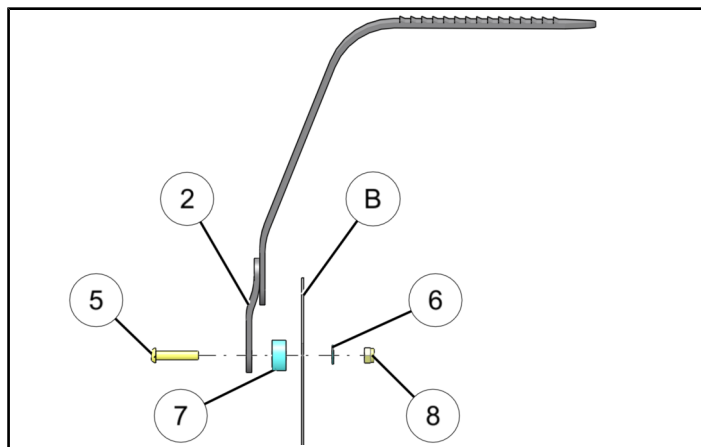

## FEEDBACK FORM

A feedback form has been created for the installer to provide any comments, questions or concerns about the installation instructions. The form is viewable on mobile devices by scanning the QR code or by clicking [HERE](#) if viewing on a PC.

### FEEDBACK FORM

