



CONTENTS:
1- SIDE MIRRORS WITH CLAMPS (2)
2- STICKER DECALS

TOOLS REQUIRED:
» 5MM HEX KEY WRENCH

SIDE VIEW MIRRORS (A19UM481)



1 Remove bolts from the supplied clamps and install clamps in the desired position on the cage A-Pillar. Re-install the bolts. Finger tighten.

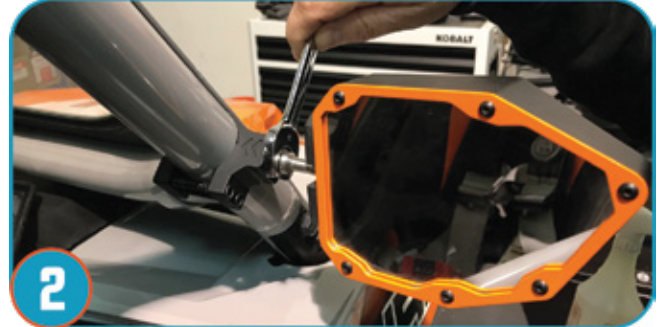

2 Thread the mirror into the clamp as far as it will go. Use a wrench to tighten the locking nut against the clamp body.



3 A. Use a 5mm hex key to tighten the clamp into its final position. Adjust the break away mechanism bolt to desired stiffness using a 5mm hex key.



B. Apply Graphic decals as shown.

Note: Over-tightening front bezel screws can cause glass to shatter. The low-profile side of the clamps will provide adequate clearance for the wind- shield.

A16UM480 - 1.75" clamp size
A19UM481 - 2" clamp size



⚠ WARNING

Improper Use of Off Highway Vehicles Can Cause Severe Injury or Death

Be Prepared

- Fasten seat belts.
- Wear an approved helmet and protective gear.
- (Reserved for message about other occupant restraint devices.)
- Each rider must be able to sit with back against seat, feet flat on floor (and foot rests), and hands on steering wheel or handhold(s), where equipped. Stay completely inside the vehicle.

Be Sure Riders Pay Attention and Plan Ahead

If you think or feel the vehicle may tip or roll, reduce your risk to injury:

- Keep a firm grip on the steering wheel or handholds and brace yourself!
- Do not put any part of your body outside of the vehicle for any reason.

⚠ WARNING

- **Never** stick hands, head or arms outside of vehicle at any time when it is in motion.
- **Always** wear and use proper safety equipment when using any Pro Armor product.
- Improper use of directions and/or product can result in injury to yourself or damage to your vehicle.
- **Disclaimer please read:** This product is sold without warranty expressed or implied. No warranty or representation is made as to the products ability to protect the user / occupant from any injury or death in any manner of use. The user assumes that risk. The effectiveness of this equipment is directly related to the manner in which it is installed, used, and / or maintained.

Proper installation is solely the responsibility of the installer, and will not be assumed by Pro Armor.

- If you have questions about your installation or are unable able to complete installation, contact Pro Armor Customer Service (888)312-7667 or have an authorized dealer or trained technician, inspect your installation.