



CONTENTS:

- 1- (2) ROCK SLIDERS
- 2- (6) TUBE EXPANSION ANCHOR
- 3- (6) WEDGE ANCHOR
- 4- (6) M8 BOLTS & WASHERS

TOOLS REQUIRED:

- 1- 1/4" DRIVE RATCHET
- 2- 6 IN. EXTENSION
- 3- 13MM SOCKET

ROCK SLIDERS INSTALL - RZR XP 1000/2015+ 900S (P41221)

Note: For further information on installation instructions please visit our website www.proarmor.com

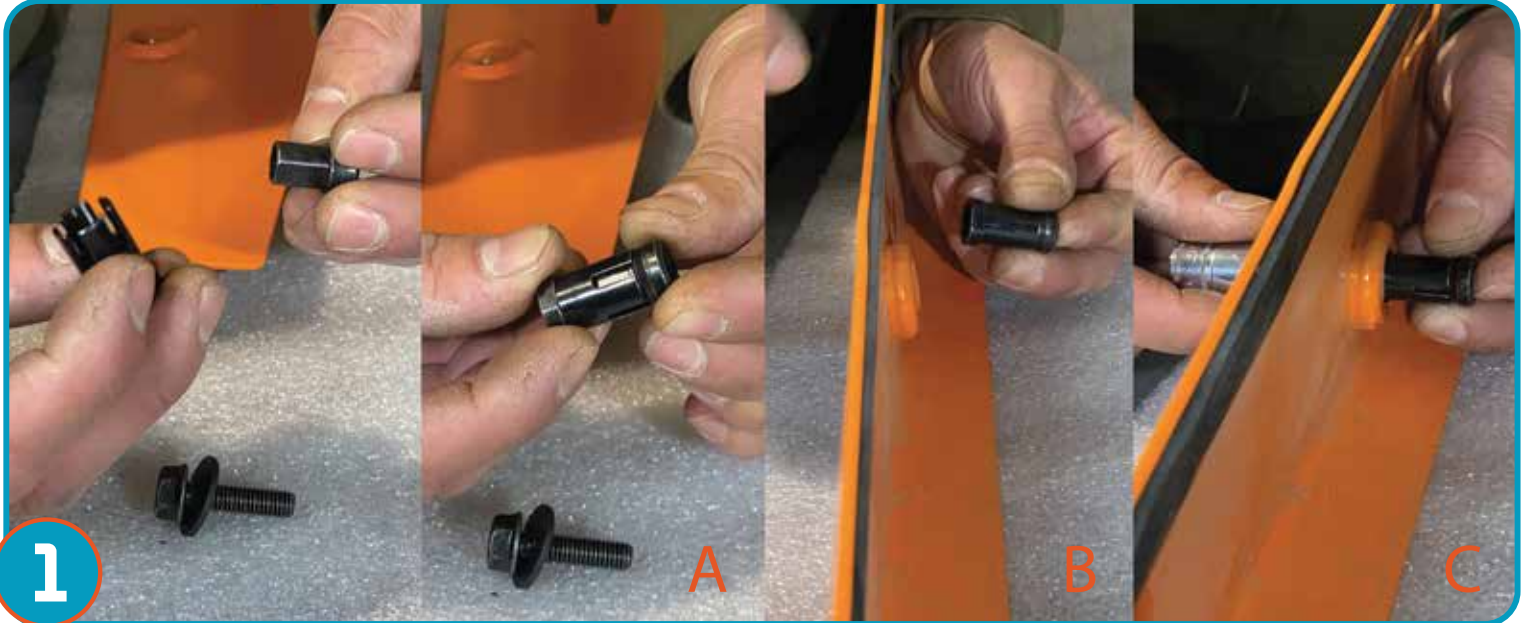

Begin by removing any dirt/obstructions that may interfere with the installation of the rock slider. Make sure all of the mounting holes and surfaces are clear.

- A. Assemble the supplied expansion anchors with the rock slider as shown above. (3) for each rock slider.
- B. Insert the bolt, washer, and sleeve into the mounting hole first. The flat surfaces of the sleeve of the expansion anchor should fit into the groove in the mounting hole of the rock slider.
- C. Thread the nut on the back side, against the fingers of the sleeve. The flat surfaces of the nut should fit into the groove in the sleeve and create a snug fit.

DO NOT OVER-TIGHTEN WHILE THREADING IN THIS STEP. YOU DO NOT WANT THE WINGS OF SLEEVE TO EXPAND.



Make sure the expansion anchors are flush with no gap.



Make sure the expansion anchors are flush with no gap.



ROCK SLIDERS INSTALL - RZR XP 1000/2015+ 900S (P41221)



Pressure to keep in place to keep proper placement

2

Once you have all (3) anchors in the chassis holes, maintain pressure and tighten down until snug. Do not stop tightening so anchor remains in place.



Keep the rock slider snug up against the plastic as you go around and evenly torque down the three anchors. DO NOT OVERTIGHTEN as you may shear the bolt in the expansion anchor.

PRO ARMOR

EVERY RIDE HAS A STORY



ROCK SLIDERS INSTALL - RZR XP 1000/2015+ 900S (P41221)



Insert (3) Rubber plugs as shown.

Repeat steps for other side. Installation is now complete.

⚠ WARNING

- **Never** stick hands, head or arms outside of vehicle at any time when it is in motion.
- **Always** wear and use proper safety equipment when using any Pro Armor product.
- Improper use of directions and/or product can result in injury to yourself or damage to your vehicle.
- **Disclaimer please read:** This product is sold without warranty expressed or implied. No warranty or representation is made as to the products ability to protect the user / occupant from any injury or death in any manner of use. The user assumes that risk. The effectiveness of this equipment is directly related to the manner in which it is installed, used, and / or maintained.
Proper installation is solely the responsibility of the installer, and will not be assumed by Pro Armor.
- If you have questions about your installation or are unable able to complete installation, contact Pro Armor Customer Service (888)312-7667 or have an authorized dealer or trained technician, inspect your installation.

