

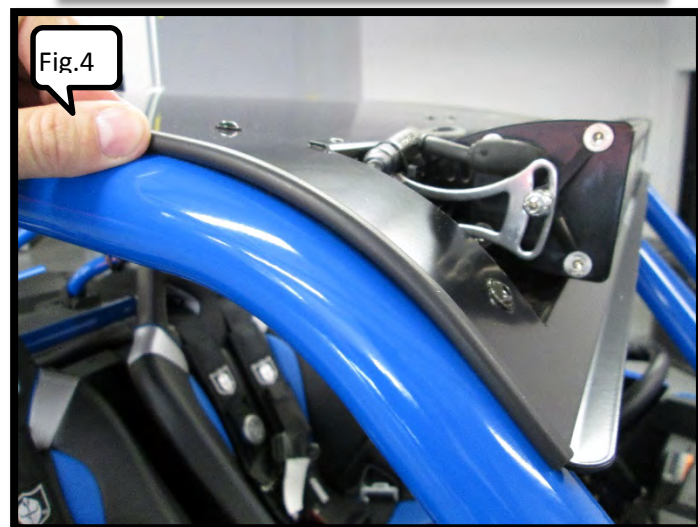

XP1K FRENCHED ROOF (P141297) INSTALLATION INSTRUCTIONS

- 1) Remove contents from the package and attach front and rear sections of the roof using M6 x 10mm bolts and Acorn Hex Nuts.
- 2) Use the supplied tube clamp bracket and wrap it around the roll cage tube and loosely secure the M6 bolt through the roof panel and thread it into the clamp (fig.1). Now repeat this process for all 8 (fig.2-3) of the tube clamp brackets and make sure they are loosely secured and not fully tightened yet.
- 3) After all clamps are in place, add rubber edge trim to both Sides from front to back. (fig.4-5)
- 4) After all clamps are in place, adjust the roof so the front edge runs parallel to the front top cage tube. The roof will cover approximately half of the roll cage front top tube. Once you have achieved proper fitment secure all hardware with a #4 Allen key and make sure all bolts are fully tightened. (fig.6)
- 5) Vibration pads have been included. (Item 5) Place between roof and roll cage as necessary Use as needed to eliminate any vibrations.

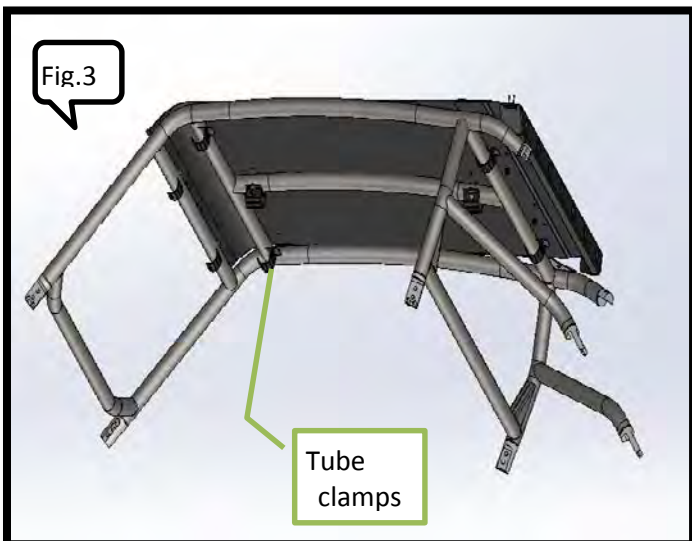

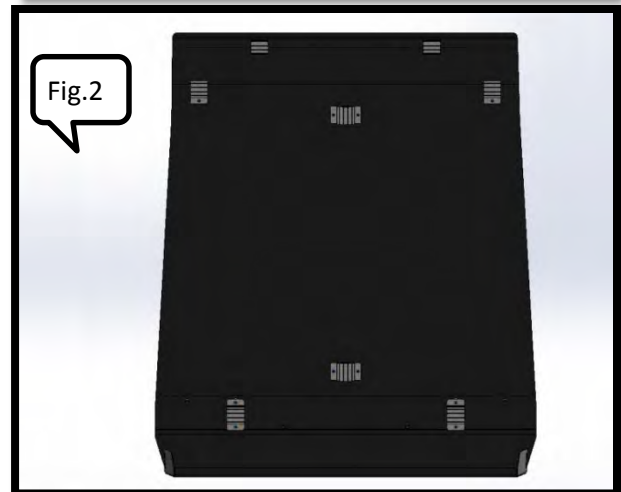
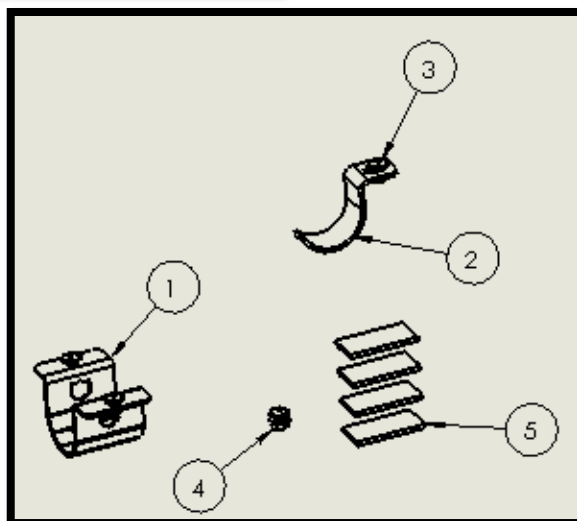
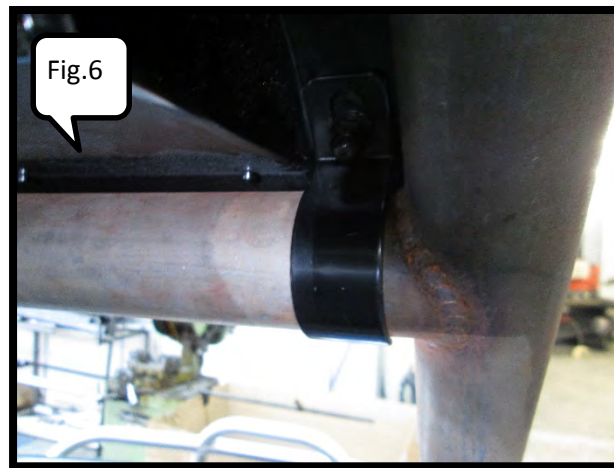
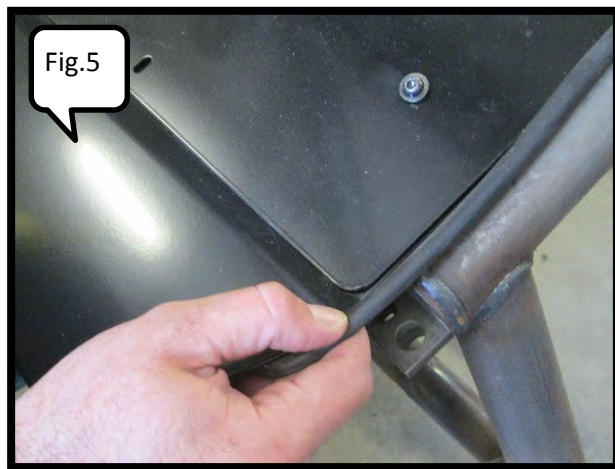

ITEM NO.	PART NUMBER	DESCRIPTION	QTY.
1	P1 41295-07	FULL CLAMP SUBASSEMBLY	4
2	5258479	CLAMP-ROOF, RZN4, BLK	4
3	HDWB0309	BOLT, M6 x 1.2MM, BUTTON HEAD FLANGE, BLACK ZINC	16
4	HDWN0042	NUT, M6 X 1.0 NYLOC FLANGED HEX , BLACK OXIDE	8
5	HDW00009	ADHESIVE BACKED NEOPRENE RUBBER_2"	4

⚠ WARNING

- **Never** stick hands, head or arms outside of vehicle at any time when it is in motion.
- **Always** wear and use proper safety equipment when using any Pro Armor product.
- **Improper use of directions and/or product** can result in injury to yourself or damage to your vehicle.
- **Disclaimer please read:** This product is sold without warranty expressed or implied. No warranty or representation is made as to the products ability to protect the user / occupant from any injury or death in any manner of use. **The user assumes that risk.** The effectiveness of this equipment is directly related to the manner in which it is installed, used, and / or maintained. **Proper installation is solely the responsibility of the installer, and will not be assumed by Pro Armor.**
- If you have questions about your installation or are unable able to complete installation, contact Pro Armor Customer Service (888)312-7667 or have an authorized dealer or trained technician, inspect your installation.

[For further information on installation instructions and warnings please visit our website WWW.PROARMOR.COM or contact customer service at 1-888-312-7667.]