



LE BENCH SUSPENSION SEAT INSTALL (P144S191)



1

Start the LE rear bench seat installation by first removing the two OEM rear seats. Reach through the space between top/bottom cushions and press the plastic latch to release seat base and remove from vehicle.

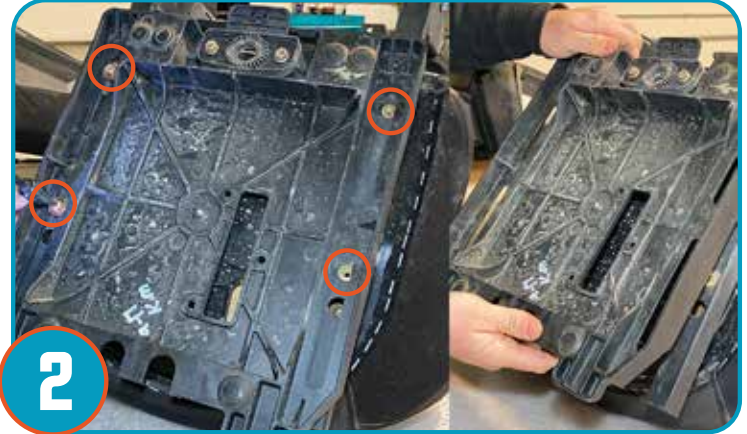

2

Remove four (4) Torx bolts that attach OEM seat to its base. Repeat for opposite seat.



3

Using a 1/4 drill bit widen a single hole on each seat base to allow for bench seat strap attachment for easy seat removal should you have the need to remove seat in future.



4

Apply seat bases removed in step 2 onto the bench seat using the same Torx bolts securing the seat bases to the bench seat. Adjust seat and base forward or back for desired placement/fitment. Repeat for opposite side.

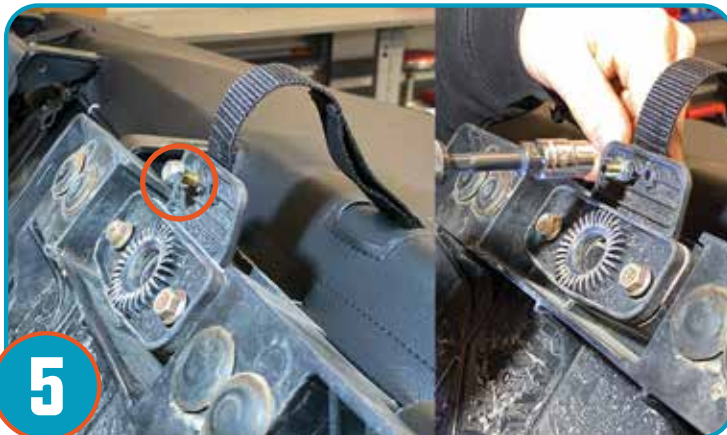

5

Using the provided hardware attach the latch strap to seat bases as shown for both sides of the bench seat. Tighten nut down to secure.



6

Once the release straps and bases has been attached and satisfied with placement, the bench can be placed into vehicle.

PRO ARMOR

EVERY RIDE HAS A STORY



LE FRONT/REAR SUSPENSION SEAT INSTALL (P141S188)



Position the seat base as shown and run the seat belt receivers or Harnesses (depending on whether you have OEM belts or Pro Armor aftermarket harness's) through the slots in bench seat. Click the bench seat in place to secure.



- **Never** stick hands, head or arms outside of vehicle at any time when it is in motion.
- **Always** wear and use proper safety equipment when using any Pro Armor product.
- Improper use of directions and/or product can result in injury to yourself or damage to your vehicle.
- **Disclaimer please read:** This product is sold without warranty expressed or implied. No warranty or representation is made as to the products ability to protect the user / occupant from any injury or death in any manner of use. The user assumes that risk. The effectiveness of this equipment is directly related to the manner in which it is installed, used, and / or maintained.
- **Proper installation is solely the responsibility of the installer, and will not be assumed by Pro Armor.**
- If you have questions about your installation or are unable able to complete installation, contact Pro Armor Customer Service (888)312-7667 or have an authorized dealer or trained technician, inspect your installation.

⚠ WARNING