

PRO ARMOR

EVERY RIDE HAS A STORY



PRO XP CAGE SYSTEM

CONTENTS:
1- PRO XP CAGE SYSTEM
2- GLOVE BOX HINGE
3- (4) CAGE BOLTS

TOOLS REQUIRED:
18MM SOCKET/WRENCH,
15MM SOCKET/WRENCH,
3/8 ALLEN HEAD,
T40 TORX

PRO XP CAGE INSTALL INSTRUCTIONS (P199C049)

Note: For further information on installation instructions please visit our website www.proarmor.com



1 Remove side plastics. A. Remove bolt/bracket at upper hinge as shown. B. Remove B-Pillar bolts located on inside of b-pillar plastics as shown. C. At rear side of vehicle remove bolt as shown. D. Remove push pin as shown.



E. Remove push pins (2) located on top-side near down tubes as shown. F. Remove push pins (2) in rear wheel well. G. Depress clip to separate plastics at top-rear of the wheel well. H. Remove push pin between plastics located between the plastics of the rear tail light assembly.



I. Remove plastics and repeat for opposite side of vehicle.



PRO XP CAGE INSTALL INSTRUCTIONS (P199C049)

Note: For further information on installation instructions please visit our website www.proarmor.com



Remove stock cage. A. Starting at the B-pillar, loosen & remove bolts (2). B. Remove A-Pillar boot to expose A-Pillar bolts (2), C. Loosen and remove A-pillar bolts (2). Repeat for opposite side of cage.

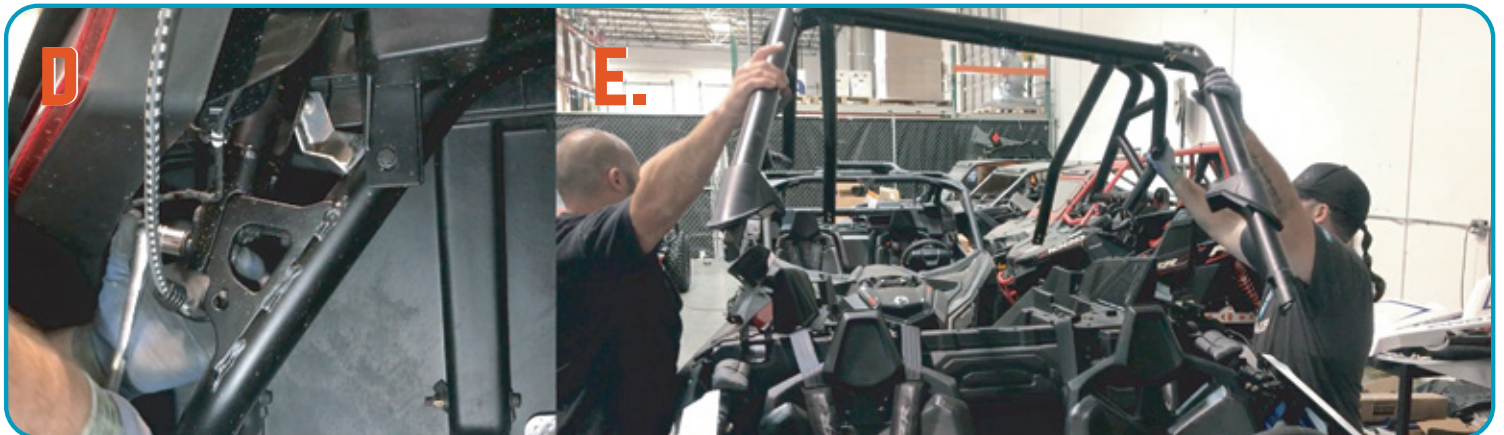

D. Loosen and remove bolts (2) at rear of vehicle and repeat for opposite side. E. With a little help, remove stock cage from vehicle and set aside.

PRO XP CAGE INSTALL INSTRUCTIONS (P199C049)

NOTE: Prior to installation, please verify if a revised version of this instruction sheet is available on proarmor.com.

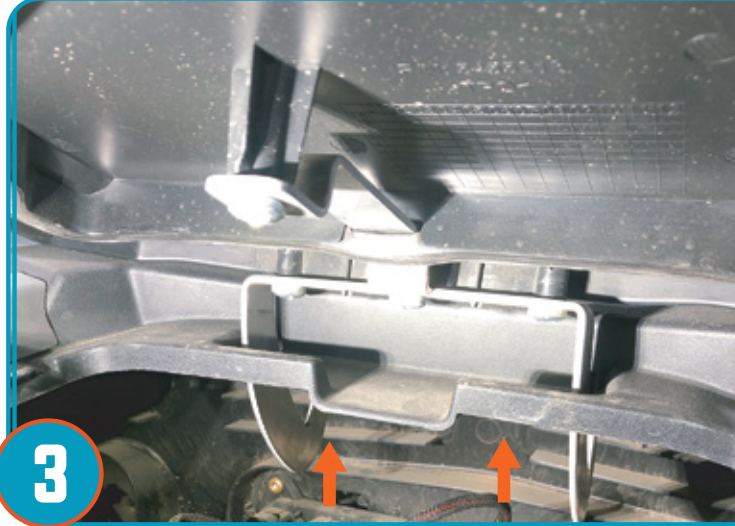

While cage is removed from vehicle, remove glove box and remove (2) bolts at the base of the hinge separating it from the plastics. Remove (4) screws holding the hinge to glove box panel/lid.

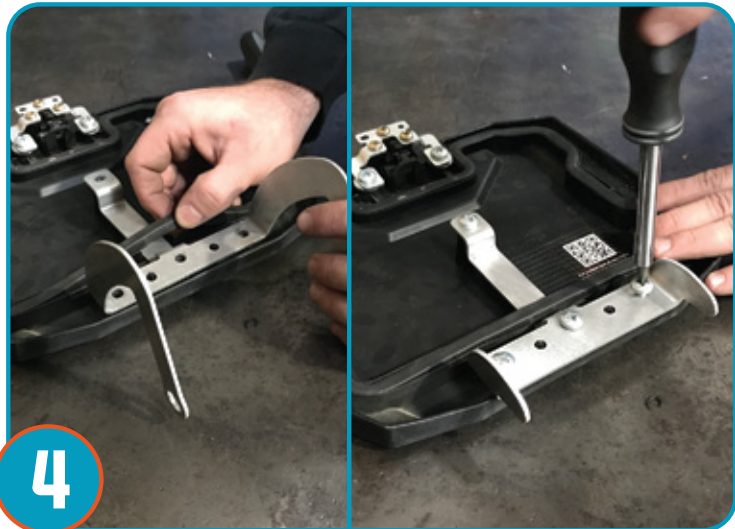

Replace new hinge using the (4) bolts removed in step 1. Slide hinge between rubber gasket and glove box plastics.

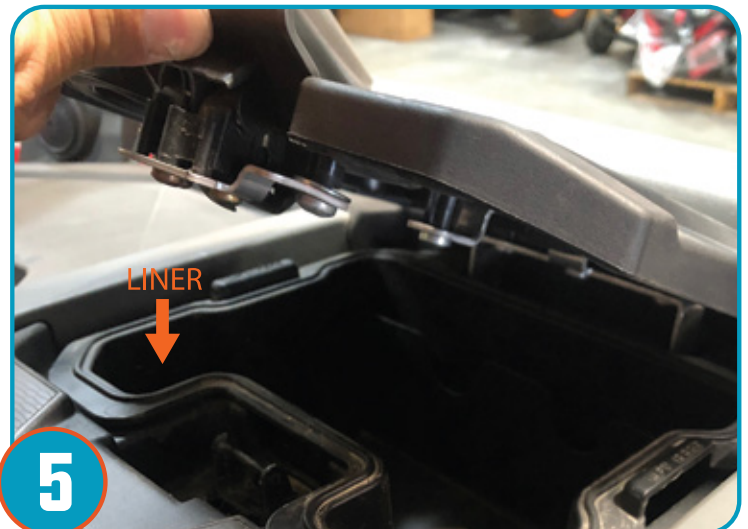

Re-insert glove box lid with new hinge sliding lid into place. Re-insert the glove box liner. Proceed with Pro Armor cage install.



PRO XP CAGE INSTALL INSTRUCTIONS (P199C049)

Note: For further information on installation instructions please visit our website www.proarmor.com



A. Remove A-pillar boots from stock cage and place onto A-pillars of your new Pro Armor Pro XP cage. B. With some help, lift and place cage onto vehicle, placing rear pillar into place first. Then lower A/B pillars of cage into place.



A. For ease of installation jack rear of vehicle up. B. Remove rear exhaust plastics removing (2) upper bolts & (2) lower bolts as shown. C. Remove exhaust cover plastics.



A. Remove (4) bolts to remove rear radius rod bracket. B. Once bolts are removed, remove and set rear plate to the side allowing rear arms to rest as shown.



PRO XP CAGE INSTALL INSTRUCTIONS (P199C049)

Note: For further information on installation instructions please visit our website www.proarmor.com

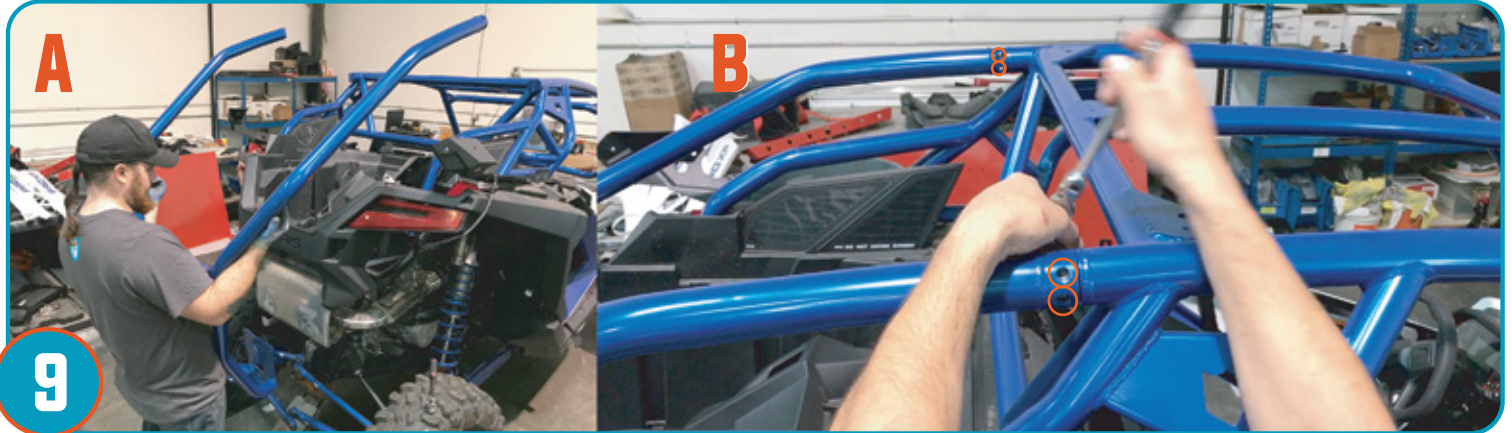

9 A. Place rear section of cage onto your Pro XP. B. Tighten 4 cage bolts joining the rear to the main section of the cage. Adjusting jack height up or down may assist in aligning the cage sections. Inside bolts thread from inside-out of cage tubing. Outside bolts thread from the outside-in.

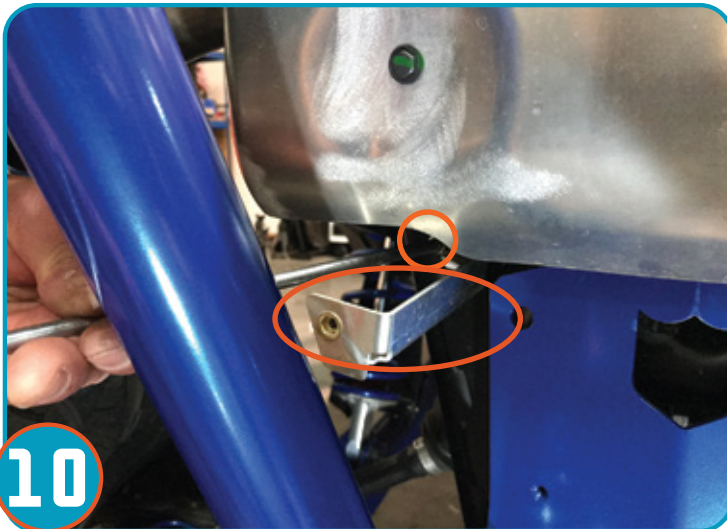

10 Remove (1) bolt holding two brackets shown for each side of exhaust to allow for arm clearance.



11 Re-position arms in place between vehicle & rear radius rod plate aligning with the bolt holes.



12 Re-Insert radius plate bolts removed in step 8. Torque to factory cage specs.



PRO XP CAGE INSTALL INSTRUCTIONS (P199C049)

Note: For further information on installation instructions please visit our website www.proarmor.com

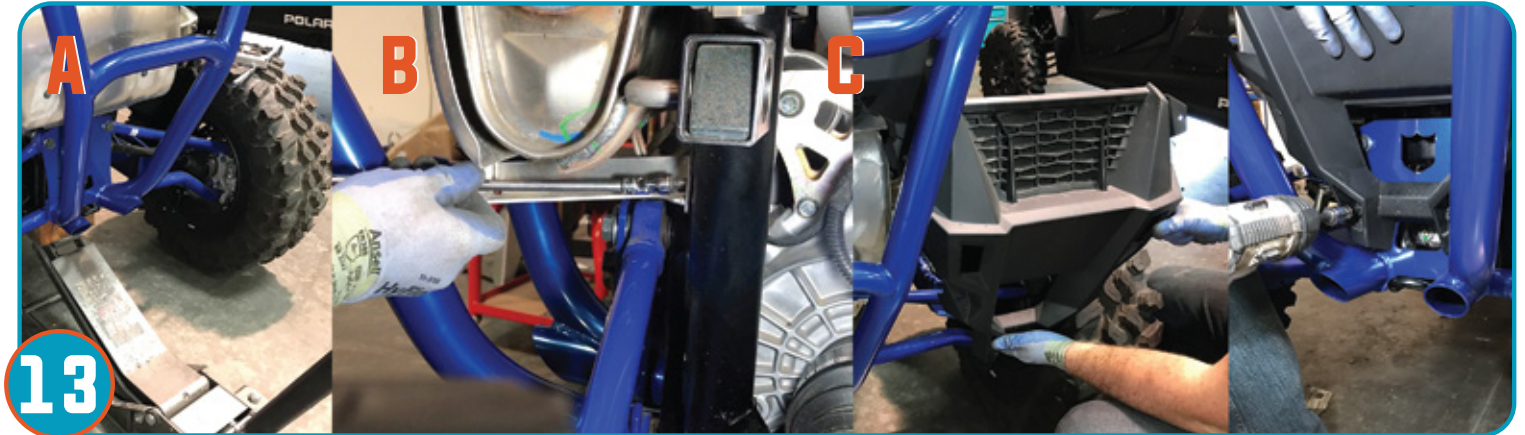

- 13**
- A. Once radius rods and rear section is tightened & secure, lower your jack to original resting position.
 - B. Re-apply brackets (2) using the (2) bolts removed in step 10. C. Re-apply rear exhaust cover plastics using the (4) bolts removed in step 7.



- 14**
- A. Use floor jack to lift vehicle even with B-Pillar location for ease of install. B. Insert B-pillar bolts and torque to factory specs. C. Repeat for opposite B-pillar.



- 15**
- A. Re-apply A-Pillar bolts removed in step 2, tighten to factory specs. B. re-apply A-pillar boot. Repeat for opposite side of cage.



PRO XP CAGE INSTALL INSTRUCTIONS (P199C049)

Note: For further information on installation instructions please visit our website www.proarmor.com



Insert cage bolts removed in step 2D for C-pillar at rear of vehicle. Tighten to factory specs.



A. Apply plastics bracket in place on cage to be attached to upper arm of plastics and cage in step 19. B. Position vehicle plastics removed in step 11. C. Using clips re-apply plastics to vehicle as shown.

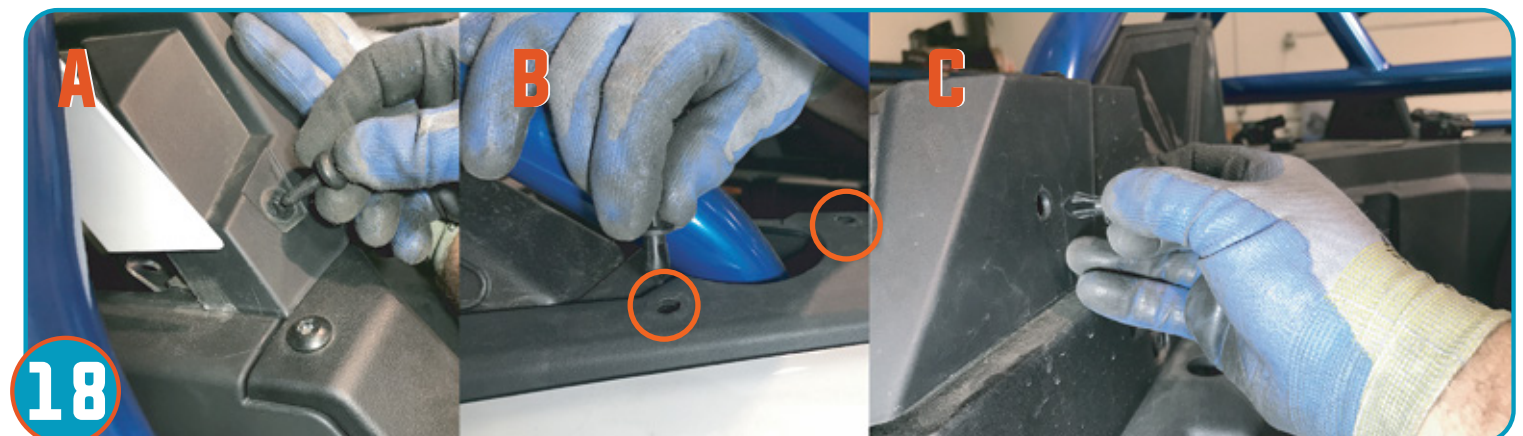

Re-apply bolts & push pins removed in step 1. A. Re-apply at rear side of vehicle near B-pillar. B. Re-apply push pins (2) located on top-side near down tubes as shown. C. Insert push pin on inside B-pillar removed in 1D. Repeat for opposite side of vehicle.



PRO XP CAGE INSTALL INSTRUCTIONS (P199C049)

Note: For further information on installation instructions please visit our website www.proarmor.com

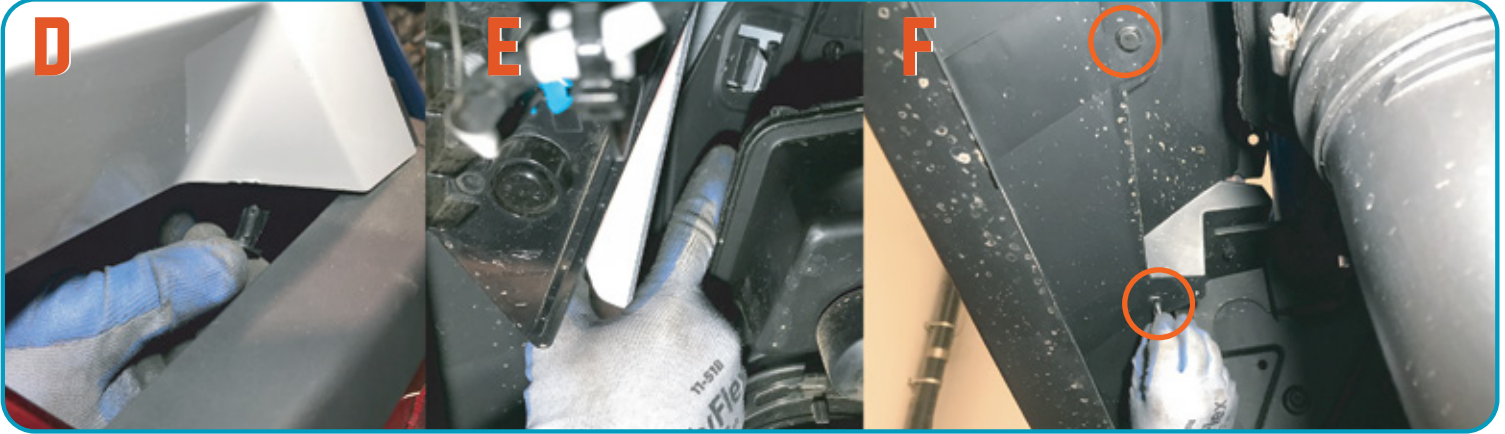

Step 18 (Cont.) D. Insert push pin removed in 1H, at rear plastics above the rear tail light under plastics pushing upward. E. Push plastics clipping in to body plastics (Step 1G). F. Re-apply rear wheel well push pins removed in step 1F. Make sure all bolts and push pins are applied and repeat for opposite side of vehicle.



A. Using bolts removed for stock doors in step 1A, re-apply bolts for upper hinge plastics. Adjust doors as needed for proper alignment. Repeat for opposite vehicle door. B. Tighten the clamp applied in step 17A to secure outer plastics. Repeat for opposite plastics clamp. Installation is complete.

- **Never** stick hands, head or arms outside of vehicle at any time when it is in motion.
 - **Always** wear and use proper safety equipment when using any Pro Armor product.
 - Improper use of directions and/or product can result in injury to yourself or damage to your vehicle.
 - **Disclaimer please read:** This product is sold without warranty expressed or implied. No warranty or representation is made as to the products ability to protect the user / occupant from any injury or death in any manner of use. The user assumes that risk. The effectiveness of this equipment is directly related to the manner in which it is installed, used, and / or maintained.
- Proper installation is solely the responsibility of the installer, and will not be assumed by Pro Armor.**
- If you have questions about your installation or are unable able to complete installation, contact Pro Armor Customer Service (888)312-7667 or have an authorized dealer or trained technician, inspect your installation.

⚠ WARNING