



# PRO XP TRAILING GUARD INSTRUCTIONS (P199P366)

\*\*\*NOTE: Prior to installation, please verify if a revised version of this instruction sheet is available on [proarmor.com](http://proarmor.com).\*\*\*



Using a floor jack, raise the rear section of vehicle to easily allow for removal of rear tire. Making sure vehicle is stable, for safety use an additional jack stand.

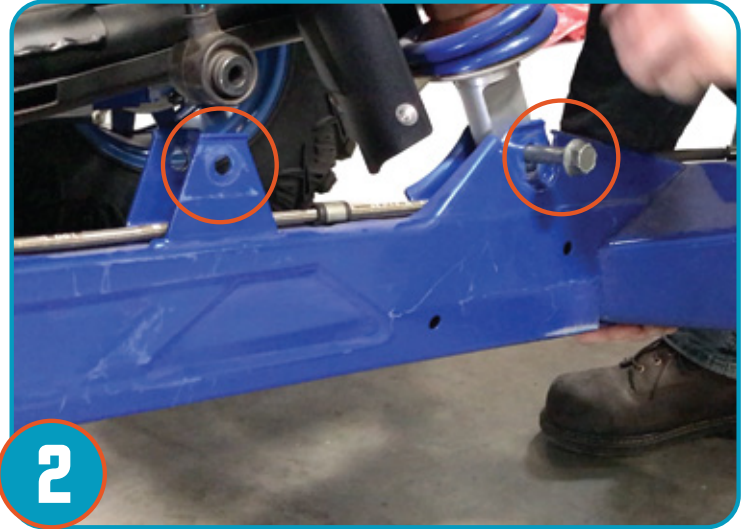

Loosen and remove the (2) bolts joining the stabilizing bar link and the shock to the frame of vehicle.

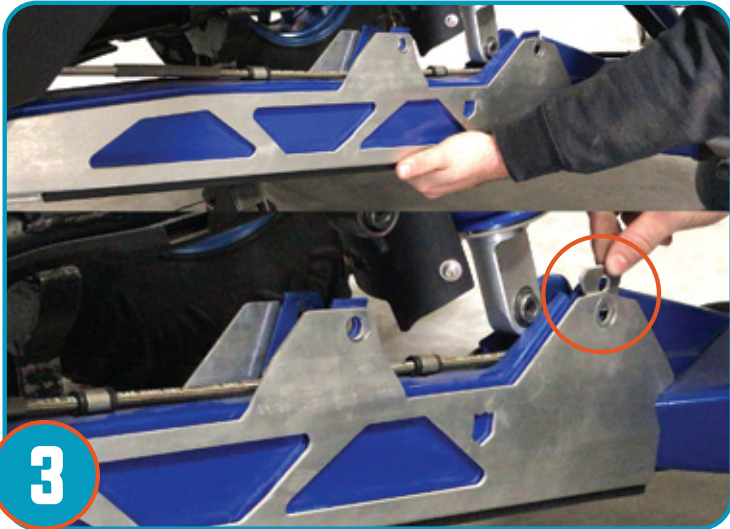

Position the Trailing Guard, aligning bolt holes and apply the provided spacer to rear shock bolt hole as shown.

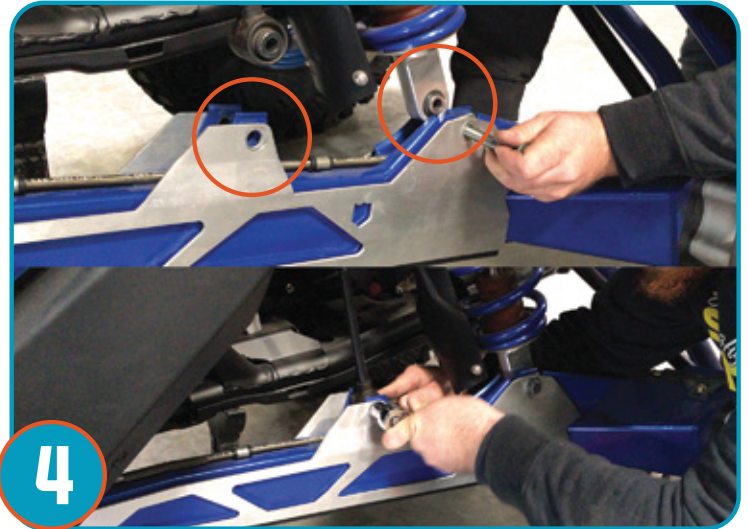

Insert (2) bolts removed in step 2 running the bolts through frame, stabilizing bar link and shock. Tighten securely.



Secure wheel back onto vehicle using a jack, torquing the lug nuts to factory specs. REPEAT FOR OPPOSITE SIDE.



**WARNING**

- Never stick hands, head or arms outside of vehicle at any time when it is in motion.
- Always wear and use proper safety equipment when using any Pro Armor product.
- Improper use of directions and/or product can result in injury to yourself or damage to your vehicle.
- **Disclaimer please read:** This product is sold without warranty expressed or implied. No warranty or representation is made as to the products ability to protect the user / occupant from any injury or death in any manner of use. The user assumes that risk. The effectiveness of this equipment is directly related to the manner in which it is installed, used, and / or maintained.
- **Proper installation is solely the responsibility of the installer, and will not be assumed by Pro Armor.**
- If you have questions about your installation or are unable able to complete installation, contact Pro Armor Customer Service (888)312-7667 or have an authorized dealer or trained technician, inspect your installation.