



**CONTENTS:**

- 1 - CENTER GRILLE
- 1 - LEFT SIDE OUTER FRAME
- 1 - LEFT SIDE MOUNTING FRAME
- 1 - RIGHT SIDE OUTER FRAME
- 1 - RIGHT SIDE MOUNTING FRAME
- 1 - CENTER MOUNTING BRACKET
- 2 - M6X16MM BOLTS
- 10 - M4X25MM BOLTS

TOOLS REQUIRED: 2MM ALLEN HEAD, 4MM ALLEN HEAD, 11MM SOCKET

## PRO ARMOR GRILLE INSTALL INSTRUCTIONS PRO R/TURBO R MODELS(P2111U305)

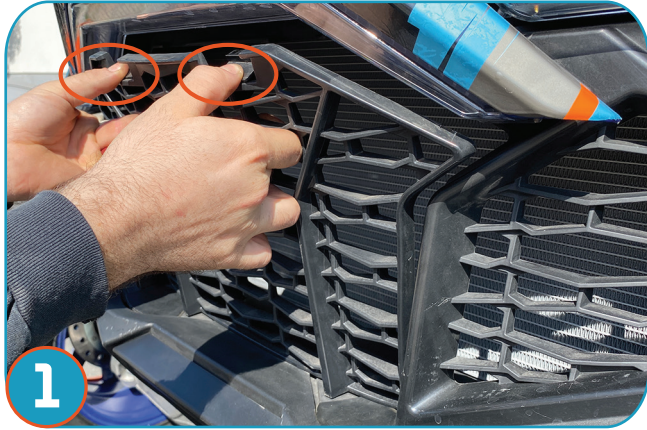

**1** REMOVE FRONT OEM GRILLE FROM YOUR VEHICLE, PRESSING DOWN ON TWO TABS.



**2** START WITH THE SIDE INSERTS, LINING UP THE BLACK BACK-PLATE (PLACED BEHIND PLASTICS) TO YOUR COLOR FRAME (PLACED IN FRONT OF PLASTICS) AS SHOWN.



**3** THREAD (5- BOLTS) JOINING THE GRILLE FRAME TO THE BACK PLATE, USING A (2MM) ALLEN WRENCH AS SHOWN. +REPEAT FOR OPPOSITE SIDE.

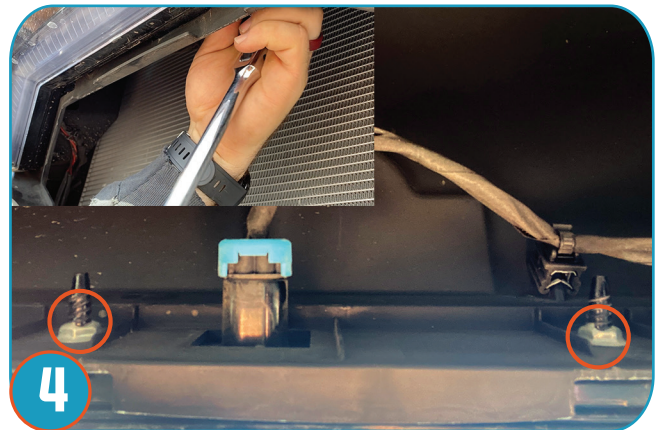

**4** REMOVE THE TWO NUTS INSIDE AND ABOVE THE RADIATOR SCREEN USING A 11MM SOCKET.



**5** USING THE 2-NUTS REMOVED IN STEP 4, PLACE PROVIDED GRILLE BRACKET AND RE-APPLY NUTS TO SECURE BRACKET IN PLACE (DO NOT OVER-TIGHTEN).



**6** SECURE PRO ARMOR GRILLE BY THREADING THE TWO PROVIDED BOLTS (4MM OR H4 ALLEN) AS SHOWN JOINING THE GRILLE AND THE BRACKET INSTALLED IN STEP 5.



## PRO ARMOR GRILLE INSTALL INSTRUCTIONS PRO R/TURBO R MODELS(P2111U305)

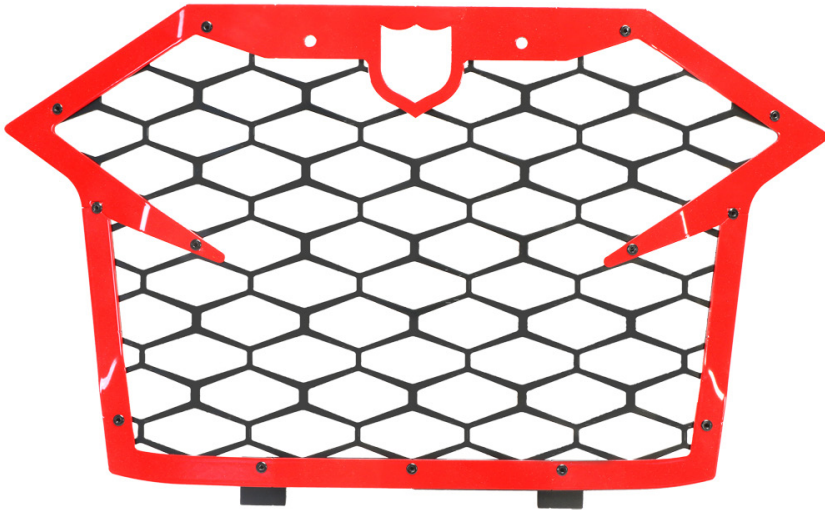

RZR PRO R/R4 & TURBO R/R4 BRACKET (STEP 4/5)

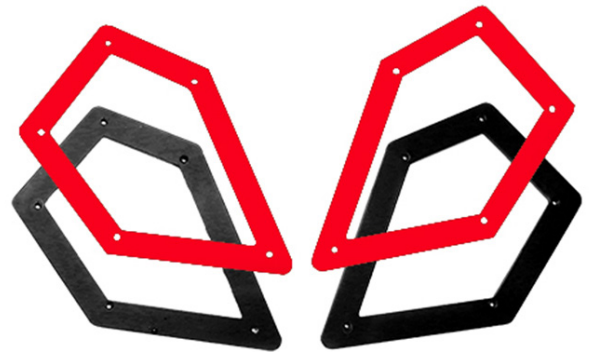

RZR PRO R/R4 & TURBO R/R4 SIDE GRILLE INSERTS (STEP 3)



- **Never** stick hands, head or arms outside of vehicle at any time when it is in motion.
- **Always** wear and use proper safety equipment when using any Pro Armor product.
- Improper use of directions and/or product can result in injury to yourself or damage to your vehicle.
- **Disclaimer please read:** This product is sold without warranty expressed or implied. No warranty or representation is made as to the products ability to protect the user / occupant from any injury or death in any manner of use. The user assumes that risk. The effectiveness of this equipment is directly related to the manner in which it is installed, used, and / or maintained.
- **Proper installation is solely the responsibility of the installer, and will not be assumed by Pro Armor.**
- If you have questions about your installation or are unable able to complete installation, contact Pro Armor Customer Service (888)312-7667 or have an authorized dealer or trained technician, inspect your installation.

**⚠ WARNING**