

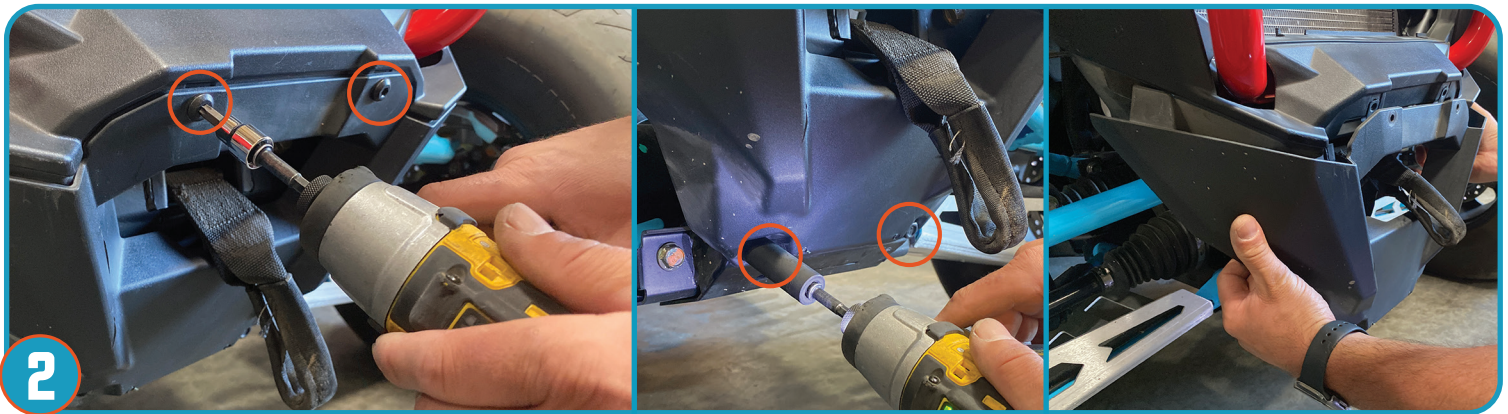

PRO ARMOR GRILLE INSTALLATION INSTRUCTION (P2214U305)



1 REMOVE STOCK GRILLE BY DEPRESSING THE TWO CLIPS ON EITHER SIDE OF GRILLE AS SHOWN.



2 REMOVE 4 BOLTS HOLDING PLASTICS LOCATED UNDER THE STOCK BUMPER.

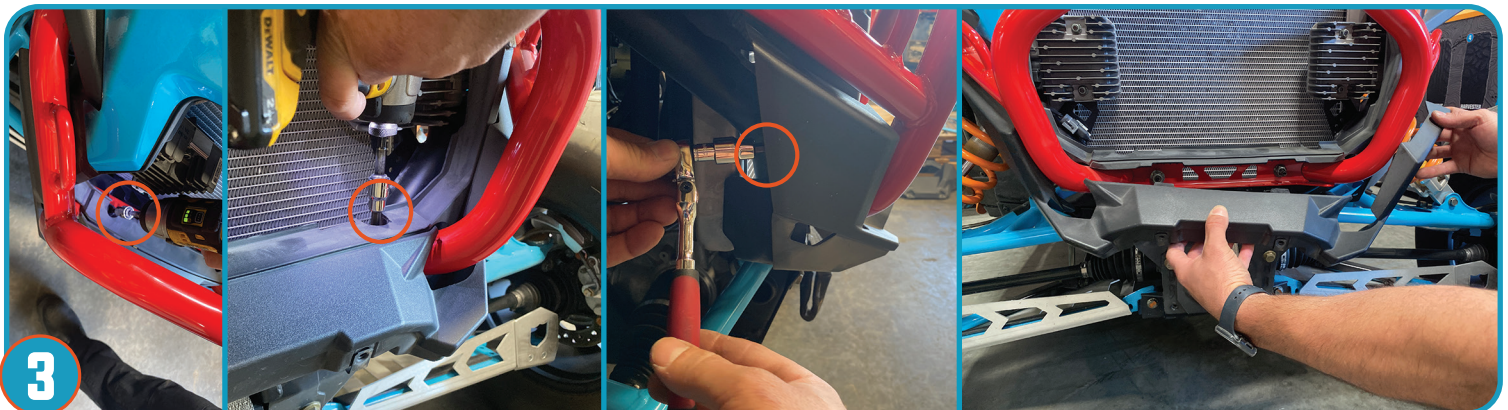

3 REMOVE 4 BOLTS HOLDING PLASTICS AS SHOWN. 2 BOLTS ACCESSED FROM THE BACK OF PLASTICS AS SHOWN.



PRO ARMOR GRILLE INSTALLATION INSTRUCTION (P2214U305)



4 REMOVE 4 BOLTS HOLDING STOCK BUMPER. TWO LOWER AND ONE LOCATED ON EACH SIDE OF FRONT BUMPER.



5 REMOVE THE HOOD PLASTICS (2-BOLTS). REMOVE TWO BOLTS LOCATED UNDER HOOD, AS SHOWN.

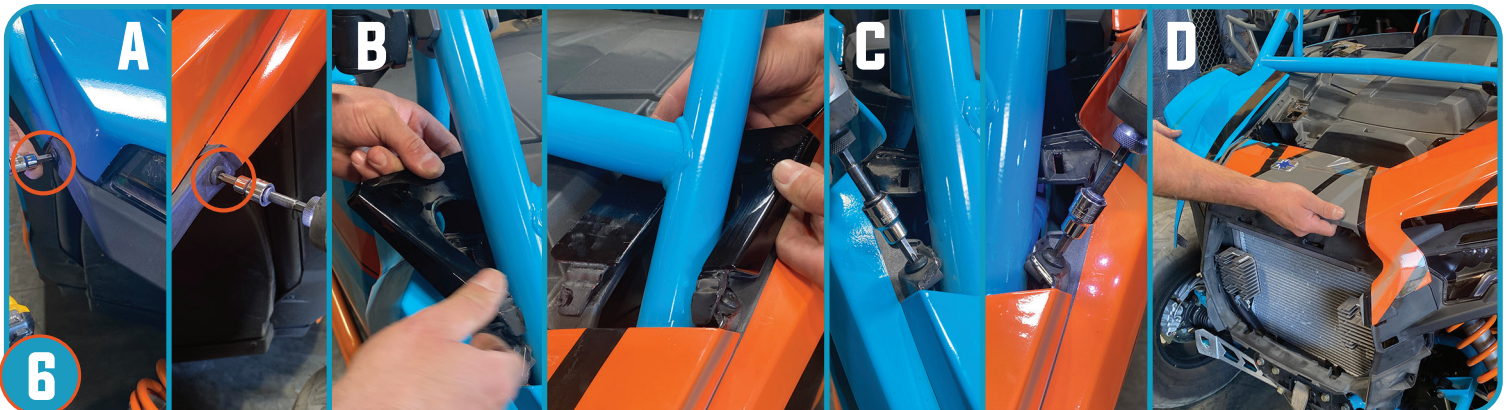

6 A. REMOVE BOLTS LOCATED ON EACH SIDE OF VEHICLE NEAR HEADLIGHTS. B. UNCLIP A-PILLAR PLASTICS ON BOTH SIDES OF VEHICLE AND SET ASIDE. C. REMOVE BOLTS LOCATED UNDER A-PILLAR PLASTICS AS SHOWN. D. REMOVE TOP PLASTICS AND SET ASIDE



PRO ARMOR GRILLE INSTALLATION INSTRUCTION (P2214U305)

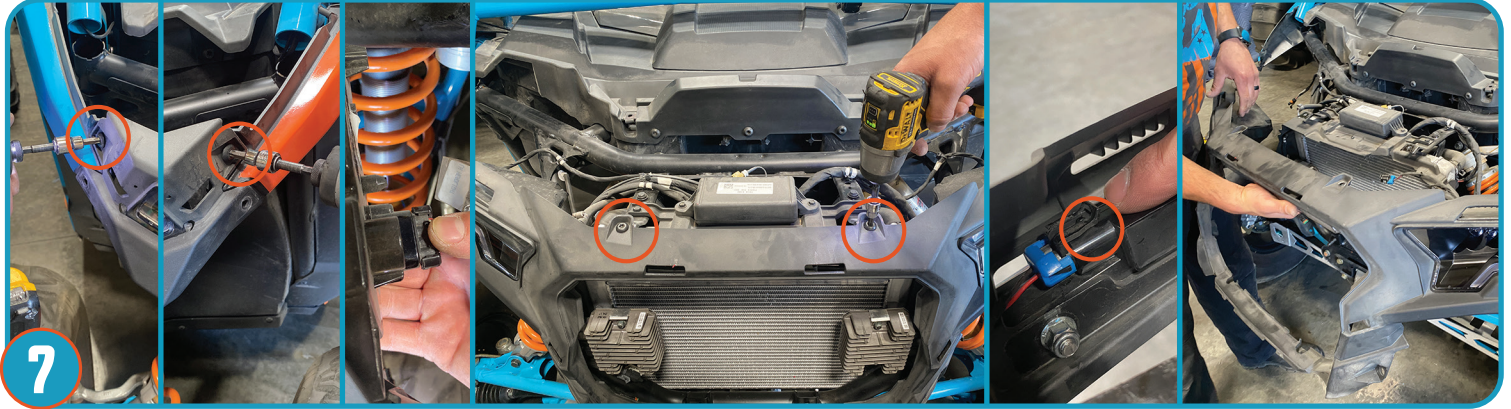

REMOVE 4 BOLTS AND UNPLUG CENTER ACCENT LIGHT CONNECTOR THEN REMOVE FRONT FASCIA.

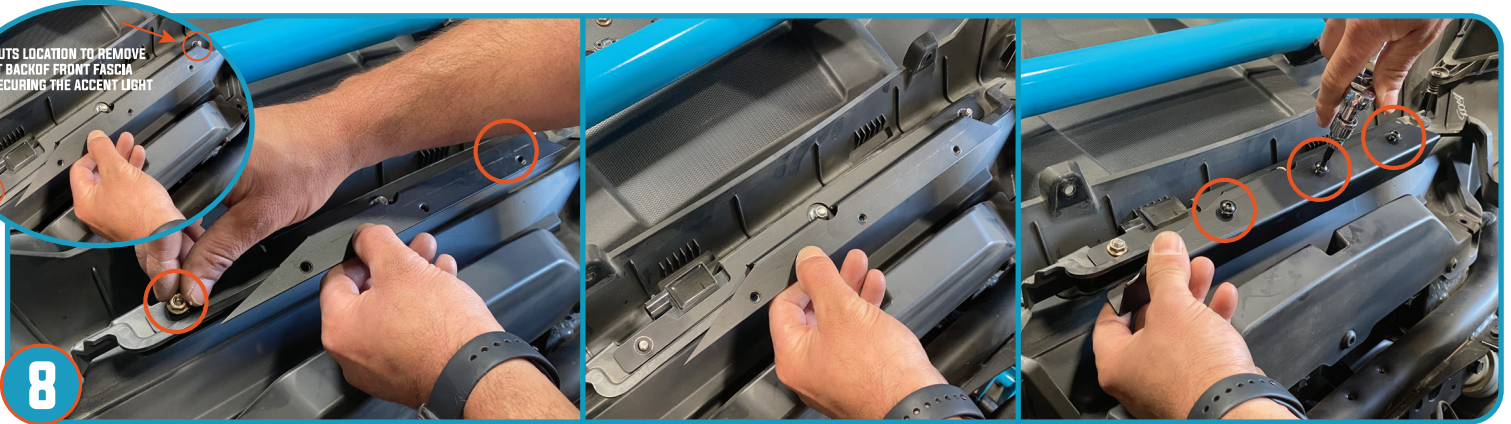

REMOVE TWO NUTS ON EACH SIDE OF BRACKET MOUNTING LOCATION (NUTS ARE ON THE BACK OF THE FRONT FASCIA/ SECURING THE ACCENT LIGHT). PLACE THE PROVIDED BRACKETS (2) OVERLAYING THEM AS SHOWN. REPLACE TWO NUTS JUST REMOVED AT SAME LOCATION AND USING PROVIDED HARDWARE, SECURE THE BRACKETS.

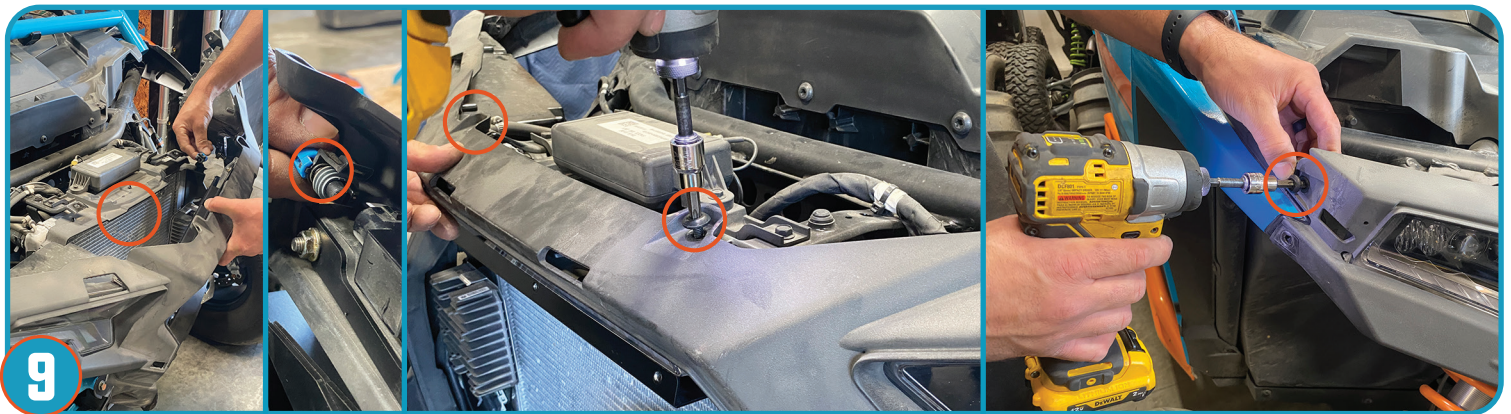

RE-CONNECT ACCENT LIGHT AND HEADLIGHTS, THEN RE-APPLY FRONT FASCIA AND BOLTS REMOVED IN STEP 7.



PRO ARMOR GRILLE INSTALLATION INSTRUCTION (P2214U305)

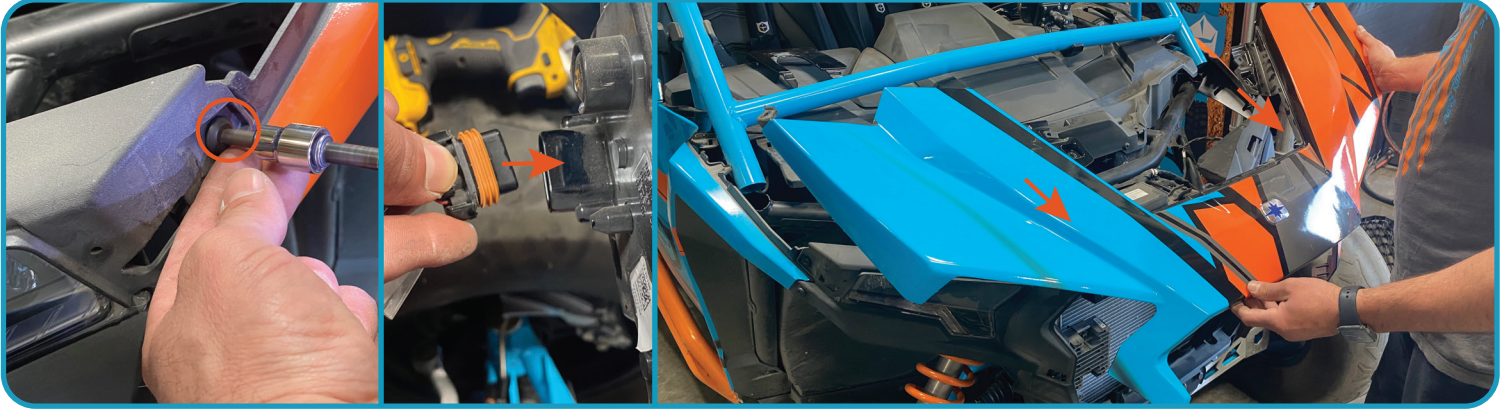

(STEP 9 CONTINUED) - RE-APPLY THE PLASTICS AND BOLTS REMOVED IN STEP 6.

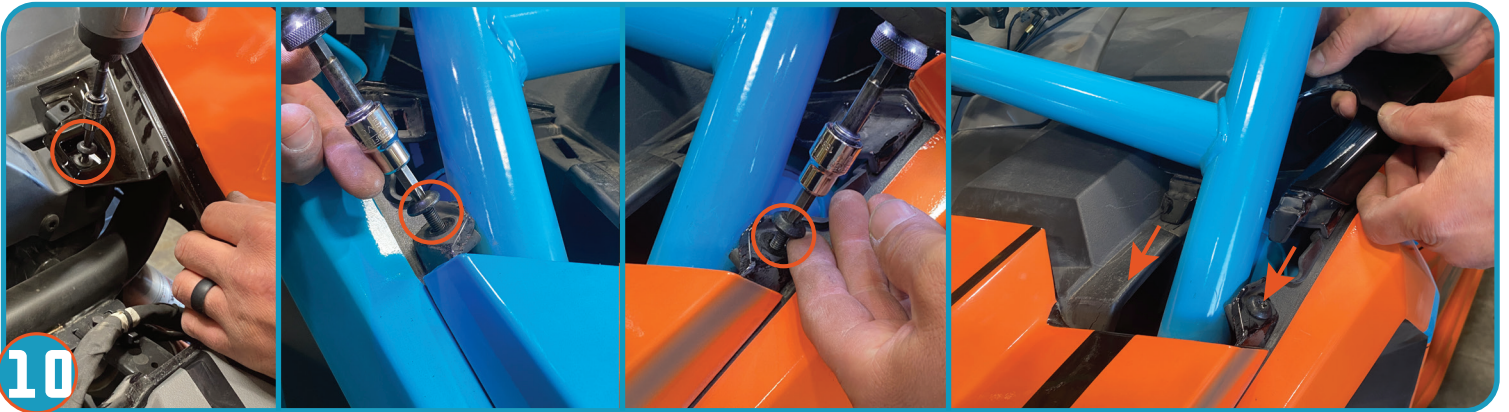

10

RE-APPLY THE PLASTICS AND BOLTS REMOVED IN STEP 6.



11

RE-APPLY THE PLASTICS AND BOLTS REMOVED IN STEP 5.



PRO ARMOR GRILLE INSTALLATION INSTRUCTION (P2214U305)



RE-APPLY THE FRONT STOCK BUMPER USING BOLTS REMOVED IN STEP 4.

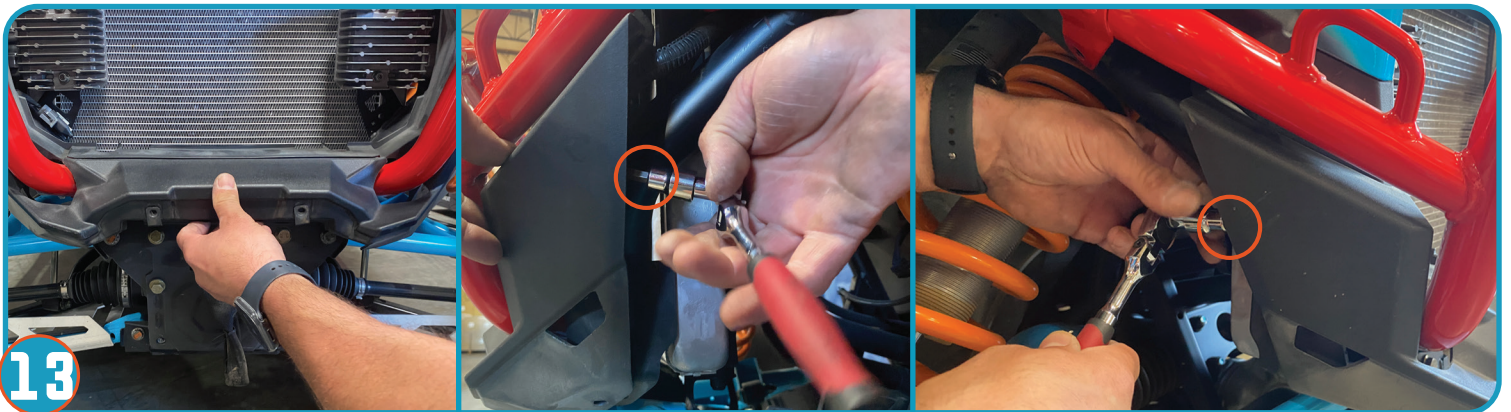

RE-APPLY THE PLASTICS AND BOLTS REMOVED IN STEP 3.



FEED TOW STRAP THROUGH PLASTICS AS SHOWN AND RE-APPLY THE PLASTICS AND BOLTS REMOVED IN STEP 2.



PRO ARMOR GRILLE INSTALLATION INSTRUCTION (P2214U305)

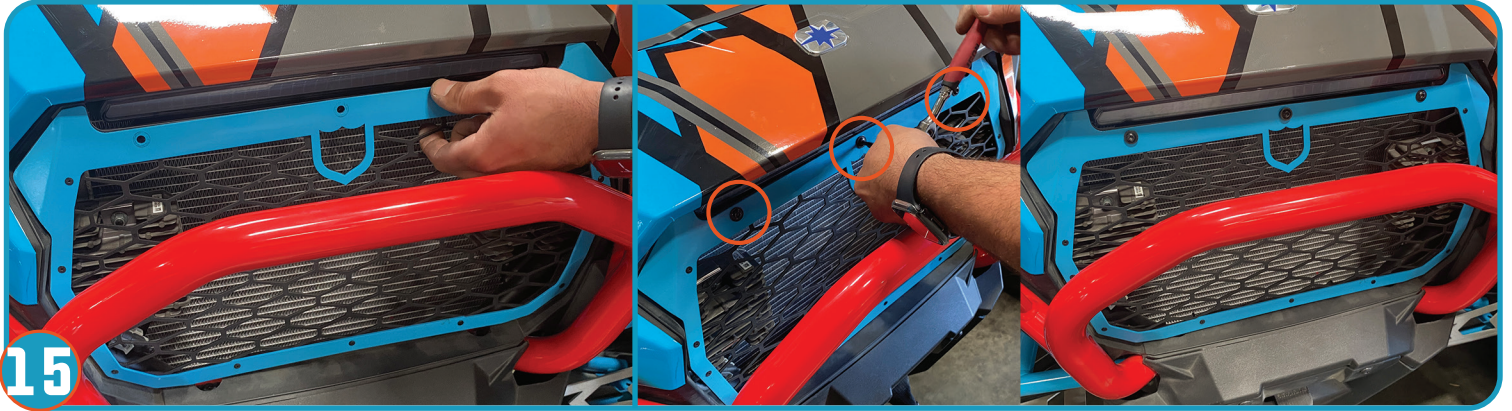

INSERT NEW GRILLE SECURING WITH 3 PROVIDED BOLTS AS SHOWN.



- **Never** stick hands, head or arms outside of vehicle at any time when it is in motion.
- **Always** wear and use proper safety equipment when using any Pro Armor product.
- Improper use of directions and/or product can result in injury to yourself or damage to your vehicle.
- **Disclaimer please read:** This product is sold without warranty expressed or implied. No warranty or representation is made as to the products ability to protect the user / occupant from any injury or death in any manner of use. The user assumes that risk. The effectiveness of this equipment is directly related to the manner in which it is installed, used, and / or maintained.
- **Proper installation is solely the responsibility of the installer, and will not be assumed by Pro Armor.**
- If you have questions about your installation or are unable able to complete installation, contact Pro Armor Customer Service (888)312-7667 or have an authorized dealer or trained technician, inspect your installation.

⚠ WARNING