



2025 Indy Matryx Cross Country Factory 600 Terrain Racing settings

All part numbers listed are Polaris part numbers unless otherwise noted.

Fuel: Use **non-ethanol** 91 octane premium pump gas with Polaris Anti-Static fuel treatment, select 91-NON-fuel curve on vehicles digital dash display

Oil Injection: Use Polaris VES-Extreme synthetic 2-cycle oil (#2883733 -quart) or (#2883732 -gallon)

Clutching Spec: 10-64 weights (stock), 150/290 primary spring (stock), 160/240 secondary spring (stock), 58/44/.36 helix (stock) and #3212338 belt (stock). Target RPM is 8300 to 8400

Optional Clutching parts: 165/310 primary spring (#7041988)

Gearing: 22 tooth top gear (Stock), 41 tooth bottom gear (Stock)

Controls: Order the #RR-001-SGL Race Rubber from www.race-rubber.com and install over the kill switch knob

Tracks: Camso 136" Cobra (#5413655*Stock) or Camso 136" Ripsaw2 (#2839216)

Traction Products: Contact Stud Boy Traction products at www.studboytraction.com .

Sway Bar: stock sway bar (.438") or no sway bar depending on course conditions

Brakes: Custom angled brake lever for stealth 88 master cylinder (#0818061 *Order from Race Dept)

Suspension spring preloads:

IFS springs: .500" preload on stock 150lb IFS spring

*Optional softer IFS Springs are available: #7045096-458 – 125lb

FT spring: .125" preload on stock race dual rate 135/185lb front track spring

RT springs: Medium/Medium on stock 18lb@95 degree torsion spring preload blocks

*Optional rear torsion springs are available:

#7046316-329 – LH 20lb@95 degree and #7046317-329 – RH 20lb@95 degree

#7046150-329 – LH 16lb@87 degree and #7046151-329 – RH 16lb@87 degree

WER Shocks: The Walker Evans Racing shocks are calibrated for Terrain Racing. Below are the stock shock settings.

IFS shocks: Gas Pressure: 150-PSI, High Speed Comp: 6, Low Speed Comp: 11, Rebound: 6

FT shock: Gas Pressure: 200-PSI, High Speed Comp: 5, Low Speed Comp: 8

RT shock: Gas Pressure: 200-PSI, High Speed Comp: 5, Low Speed Comp: 5, Rebound: 5



Venting: Permitted Cross Country Factory 600 Venting: Additional venting is allowed on the 2025 Indy Cross Country sled. You must follow the Polaris Racing templates/directions exactly! No deviations will be allowed. To download the venting templates and directions visit the Polaris Snowmobile Racing website at <https://snowmobiles.polaris.com/en-us/team-polaris/racer-resources/>. Go to the **Cross-Country** section.

The Polaris Race Dept. has IFS shock covers available to protect the IFS shocks from roost (#0818049). Contact Scott Wilczek at Scott.Wilczek@polaris.com to order.

The Polaris Race Dept. has service manuals available for the MY25 Cross Country sled (#9941914). Contact Scott Wilczek at Scott.Wilczek@polaris.com to order.

Data Acquisition: Order SnoPro Kompact from Precision Auto Research (www.precisionautoresearch.com)

Rules: for the rules pertaining to this class go to the International Snowmobile Racing website, www.isrracing.org

The suspension settings listed here are the starting point. Adjust suspension calibrations to course/snow conditions to maximize the vehicles handling.

To order any of the Polaris Parts listed on this sheet contact Scott Wilczek at the Polaris Race Dept. 715-355-3008 or Scott.Wilczek@polaris.com

For any race setup questions contact Ben Hayes at the Polaris Race Dept. 715-355-5157 or Ben.hayes@polaris.com



**Attention Polaris 2025 600 Cross Country Racers*

The MY25 600CC Race sleds have been built with the standard steering rack link #7061190. Number 15 in the below picture. Replace the standard steering link with the **Heavy Duty** steering rack link #7061308 that was shipped with the sled.

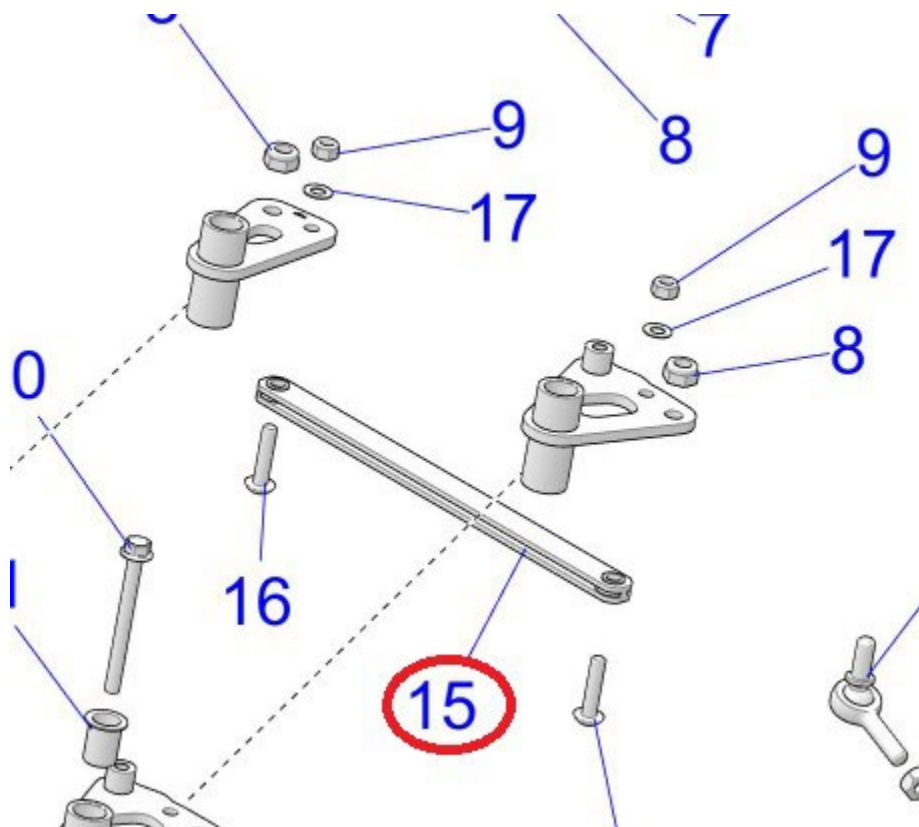

Details

Date	
Location	
Driver	
Sled	
Class	



	Practice	Heat 1	Heat 2	Final
--	----------	--------	--------	-------

Engine

ECU Curve				
Gauge setting	PREM REG	PREM REG	PREM REG	PREM REG
Fuel Blend				
Speed MPH				
Spark plugs & Gap				
EGT temp F°				

Clutching

Drive Belt				
Belt length/Width	/	/	/	/
Flyweight style				
Total flyweight				
Added weight				
Spider shims				
Engage/Peak RPM	/	/	/	/
Primary spring				
Secondary spring				
Helix				
Top/Bottom gear	/	/	/	/

Suspension

Skis/Toe out	/ "	/ "	/ "	/ "
Carbides				
SwayBar				
IFS shock valve #				
Clicker settings	H- L- R-	H- L- R-	H- L- R-	H- L- R-
Spring rate				
Preload				
Oil side spacers				
FT shock valve #				
Clicker settings	H- L-	H- L-	H- L-	H- L-
Spring rate				
Preload				
FT arm height				
RT shock valve #				
Clicker settings	H- L- R-	H- L- R-	H- L- R-	H- L- R-
Spring rate				
Preload	/	/	/	/
Oil side spacers				
Coupling blocks				
Stud style				
Stud count				
Stud pattern				

Comments

Practice Comments:

Heat 1 Comments:

Heat 2 Comments:

Final Comments: