



BIGFOOT AMBULANCE

- 36 & 48V AC powered
- 12 mph (19 km/h) speed
- 30-40 mi (48-64 km) range
- 2,000 lb (907 kg) load capacity*



Vehicle is shown with a custom nurse's supply cabinet.

ERGONOMIC COMFORT & VEHICLE PERFORMANCE



Taylor-Dunn's BIGFOOT AMBULANCE includes a nurses seat and stretcher area in addition to the standard Bigfoot's large operator's compartment, tilted steering, and sliding adjustable seats.

Additional standard features include our GT Drive system, AC power, Smart View Display, hydraulic disc brakes, recessed tie-downs, 12 gauge smooth skin, unitized steel body, DC/DC converter and a heavy duty all gear drive train that ensures reliability and low maintenance costs.

Visit our website for additional vehicle images, videos, information and custom modifications at www.taylor-dunn.com.

VOLTAGE	36 & 48 volt	
SPEED	up to 12 mph	up to 19 km/h
RANGE	up to 30-40 mi	up to 48-64 km
LOAD CAPACITY	up to 2,000 lb	up to 907 kg
TOW CAPACITY	up to 5,000 lb	up to 2268 kg

* Based on Standard Configuration

Typical Capacity: Actual load capacity depends on application and vehicle configuration.

FEATURES & BENEFITS:

- Large Operator's Compartment
- Tilted Steering
- Adjustable Seats



Dual USB Port



Adjustable Seats



Emergency Cut-off



Recessed Tie-downs



Large Compartment



LED Lighting



Tilted Steering





PERFORMANCE

LOAD CAPACITY	2,000 lb	907 kg
MAX SPEED (UNLOADED)	12 mph	19 km/h
TURNING RADIUS	n/a	
TOW CAPACITY	5,000 lb	2268 kg

DIMENSIONS

OVERALL LENGTH	140.5 in	357 cm
OVERALL WIDTH	44 in	112 cm
HEIGHT (- cab)	51.5 in	131 cm
HEIGHT (+ cab)	73 in	185 cm
WHEEL BASE	72 in	183 cm
GROUND CLEARANCE	5.5 in	14 cm
DECK	Galvanized, flush deck, two-piece	

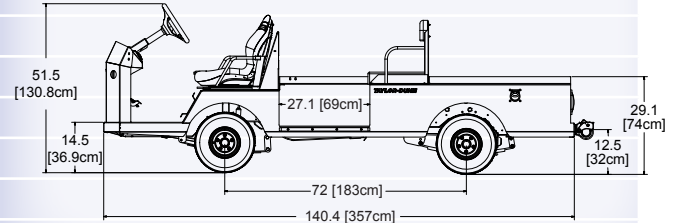
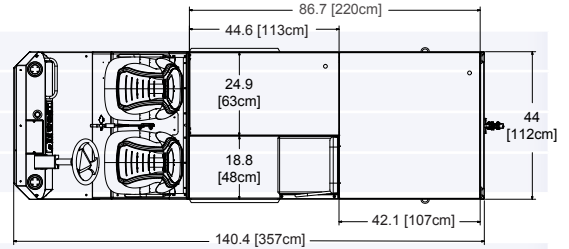

POWER SUPPLY / DRIVE TRAIN

SYSTEM VOLTAGE	36 or 48 volt configuration
MOTOR	36V: 7.5 hp, 5.5 kW, AC, 48V: 12.5 hp, 9.5 kW AC
DRIVE AXLE	Helical gear, oil bath transaxle, GT automotive differential
BATTERIES	210 amp-hour, lead acid, 6 volt
CHARGER	Built-in, 115 VAC/60 Hz, 1kW w/ interlock, 48V: 17 amp SCR, High Frequency Technology
CONTROLLER	Solid state self diagnostic AC speed controller

CHASSIS

FRAME	Fully welded, unitized, 12 gauge, smooth skin steel body
STEERING	Rack and pinion
SUSPENSION	Multi-leaf springs, front and rear
BRAKES	Rear hydraulic disc brakes with hand-operated parking brake
BUMPERS	Heavy duty steel integrated front & rear
TIRES	5.70 x 8, load range C, pneumatic



GT Automotive Drive

GENERAL

UNIT WEIGHT	36V: 2100 lb (952 kg), 48V: 2250 lb (1020 kg)
SEATS	Black adjustable bucket seats, driver's seat electrical interlock, 2 person
INSTRUMENTATION	Smart View Display: (battery status indicator, hour meter, fault code display), reverse buzzer, F-N-R switch, key switch, light switch, high/low speed switch, emergency power cut-off switch, DC/DC converter, dual USB port, electric horn
LIGHT ACCESSORIES	Dual LED headlights, taillights and brake lights
CONFORMANCE	Type E OSHA 1910.178, ANSI B56.8

OPTIONS

- ELECTRIC SIREN
- STROBE LIGHT
- SIDE VIEW MIRRORS
- PORTABLE CHARGER
- FIBERGLASS TOP
- ECONO CAB & VINYL DOORS
- STORAGE COMPARTMENT
- DIRECTIONAL SIGNALS
- BATTERY WATERING SYSTEM
- ALUMINUM DROP-DOWN SIDES
- FRONT HYDRAULIC DISC BRAKES
- VARIOUS HITCHES
- UNDERCOATING
- GALVANIZED FRAME
- OPTIONAL PAINT COLORS

Specifications, standard equipment, accessories and modifications are subject to change without notice.