

HUSABERG 2009-2012 FE 390/450/570 IGNITION MAP SWITCH INSTALLATION

MAP SWITCH OVERVIEW:

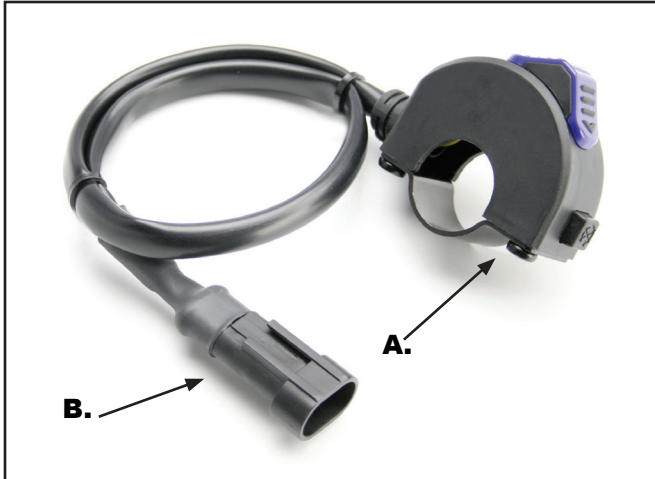

TRAIL TECH IGNITION MAP SWITCH

- A. Trail Tech Map Switch.
 B. OEM Harness Connection.

INSTALL MAP SWITCH:

1. Remove front number plate or headlight assembly.
2. Install Trail Tech's Ignition Map Switch (Fig. 1) Note: Adjust switch body for comfortable control, also making sure the leads coming from the switch clear the hydraulic clutch adjuster.

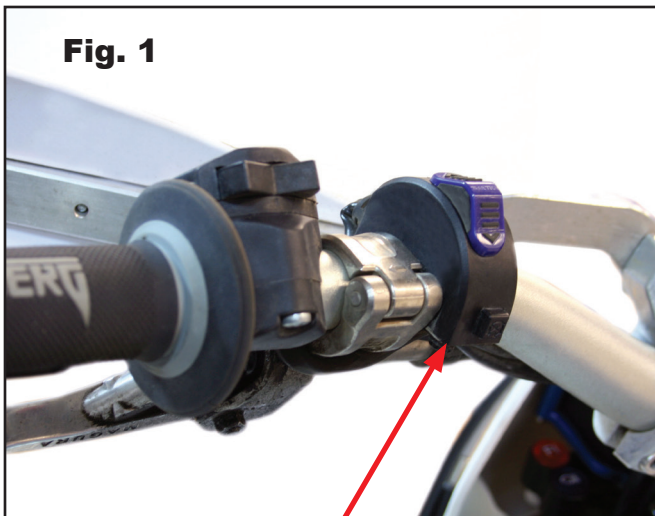

TRAIL TECH IGNITION MAP SWITCH INSTALLED

Note: Trail Tech's Husaberg map switch does not provide a kill switch replacement & is used for mapping functions only!

INSTALL MAPPING CONNECTION:

1. Locate mapping connection behind number plate or headlight assembly (Fig. 2.)
2. Remove harness mapping connection plug cover, exposing stock map switch connection (Fig. 2.)

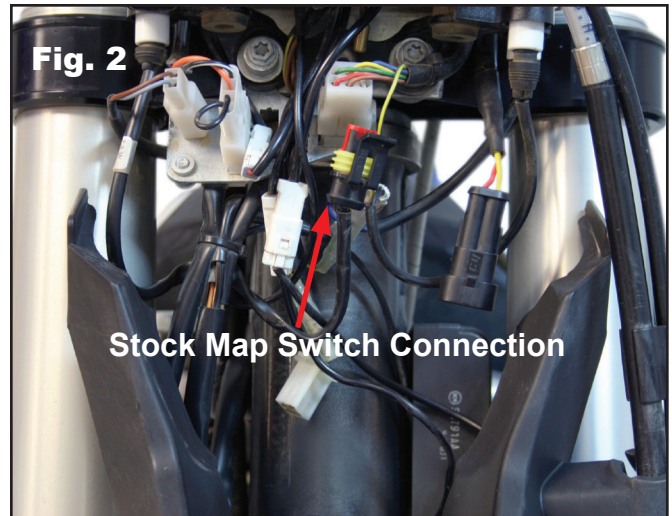

STOCK MAP SWITCH CONNECTION EXPOSED

3. Connect Trail Tech Mapping Switch to harness mapping connection. (Fig. 3)



TRAIL TECH IGNITION MAP SWITCH CONNECTION

- **Stock** = Standard map used from the factory.
- **Mild** = Slightly less aggressive power delivery.
- **Wild** = Most aggressive power delivery.